

The Butterfly Leaf Dining Table

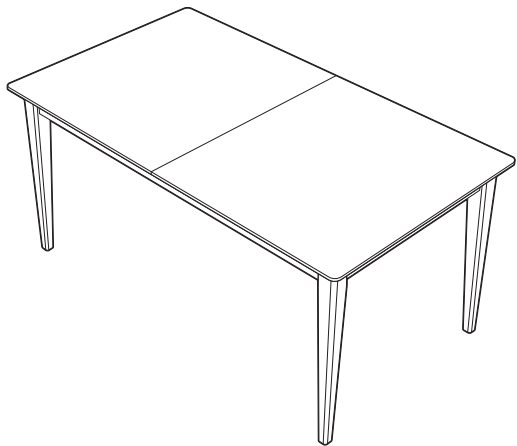

**Assembly
Instructions**

levity

What's inside

Eight longer bolts (2.4") 

Eight washers 

Eight crush washers 

Hex key 

Table body (A)

Four legs (B)

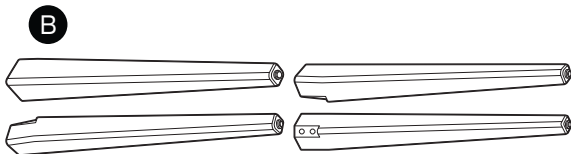
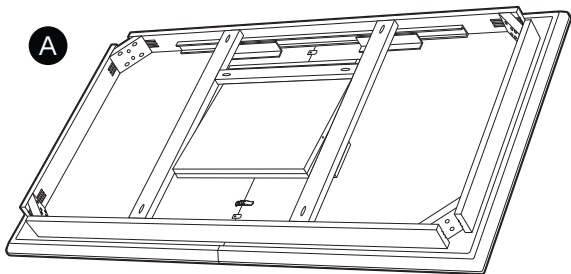

1 Align the table legs

- A. Align the legs in each corner of the table top
- B. Make sure each leg is flush with the sides of the base and the front corner of the leg hangs over

Tip: any of the legs will fit in any of the four corners of the table

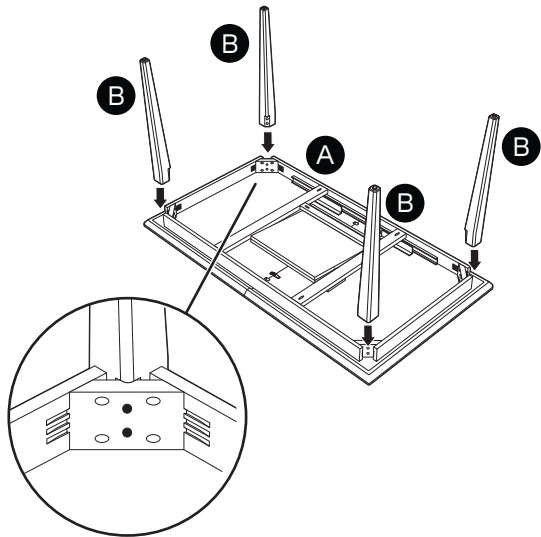

2 Secure the table legs

- A. Hand screw two bolts (with one crush washer and one standard washer each) into each leg
- B. Tighten all eight bolts with the hex key

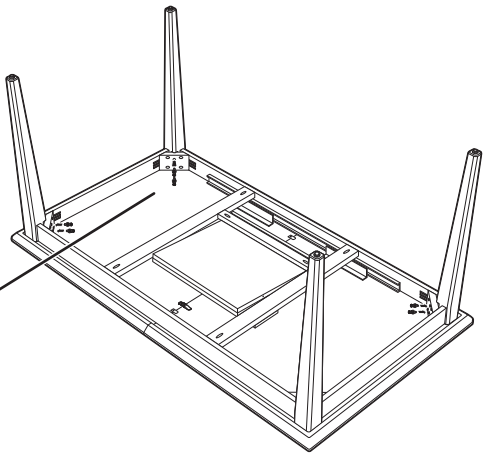
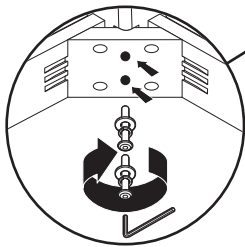

3 Stand the table upright

- A. Enlist a friend to help you carefully flip the table back over onto its legs

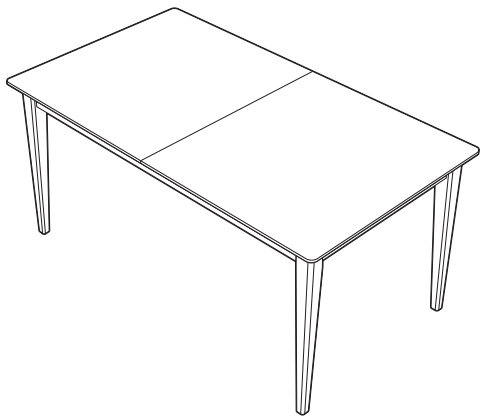

4 Enjoy your table!

Note: continue to the next page for instructions on how to extend your table

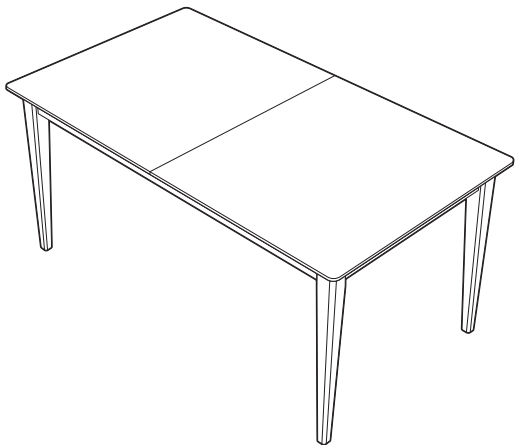

Extend Your Table

1 Unlock the latches

- A. Unlock the latches underneath each side of the table

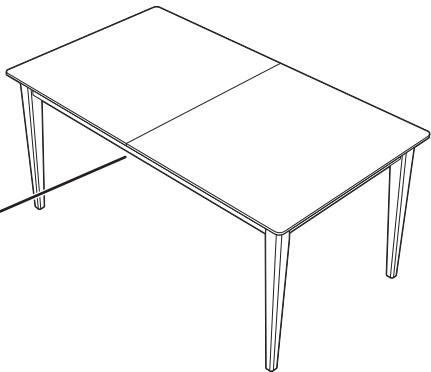
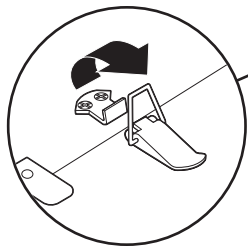

2 Extend the table

- A. Pull one side of the table all the way out to open up the butterfly leaf
- B. Flip the butterfly leaf so it rests on the side of the table
- C. Flip the top half of the butterfly leaf back over so it rests on the other side of the table

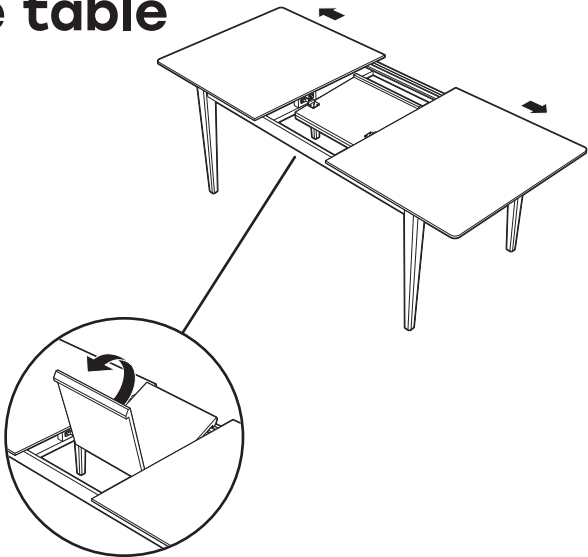

3 Relock the latches

- A. Push one end of the table back in so that the sides are flush with the butterfly leaf
- B. Relock the latches underneath each side of the table

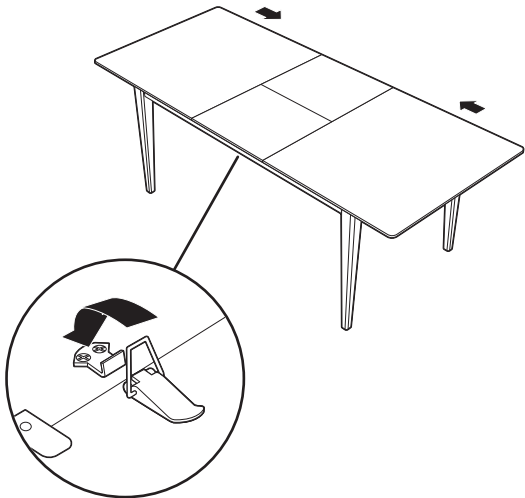

4 Enjoy your extended table!

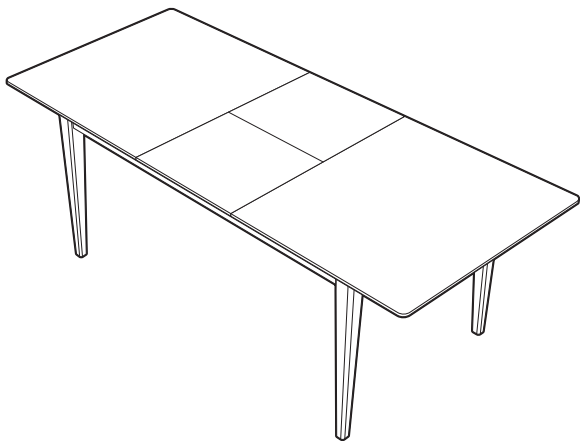

ASSEMBLY: Use caution when assembling. Do not change the specifications, modify this product, or use for any other purpose beyond its intended use as a table. Incorrect assembly can cause the product to fail and cause personal injury. Double check that all fasteners are tightened securely in place before use.

USAGE: Remove all packaging before first use. Check periodically that all fasteners are securely tightened and in place. Be aware that fasteners may become loose with prolonged use. The legs, table body and hardware components are only intended as shown for use with the specific table you ordered. The table is only meant for use indoors. Using the table for any other purpose beyond its intended use as a table may cause personal risk or injury.

CARE: Wipe down with soap and water, any regular wood cleaners or natural cleaners

For more information, visit our FAQs on our website at:
<https://levityhome.com/pages/faqs>