

# SANCTUARY LARGE RUINS

## ASSEMBLY INSTRUCTIONS

**Tips:**

Test fit each part prior to gluing  
Recommend PVA (wood) glue or Super Glue

- 1 Glue large walls to base
- 2 Glue trusses to walls

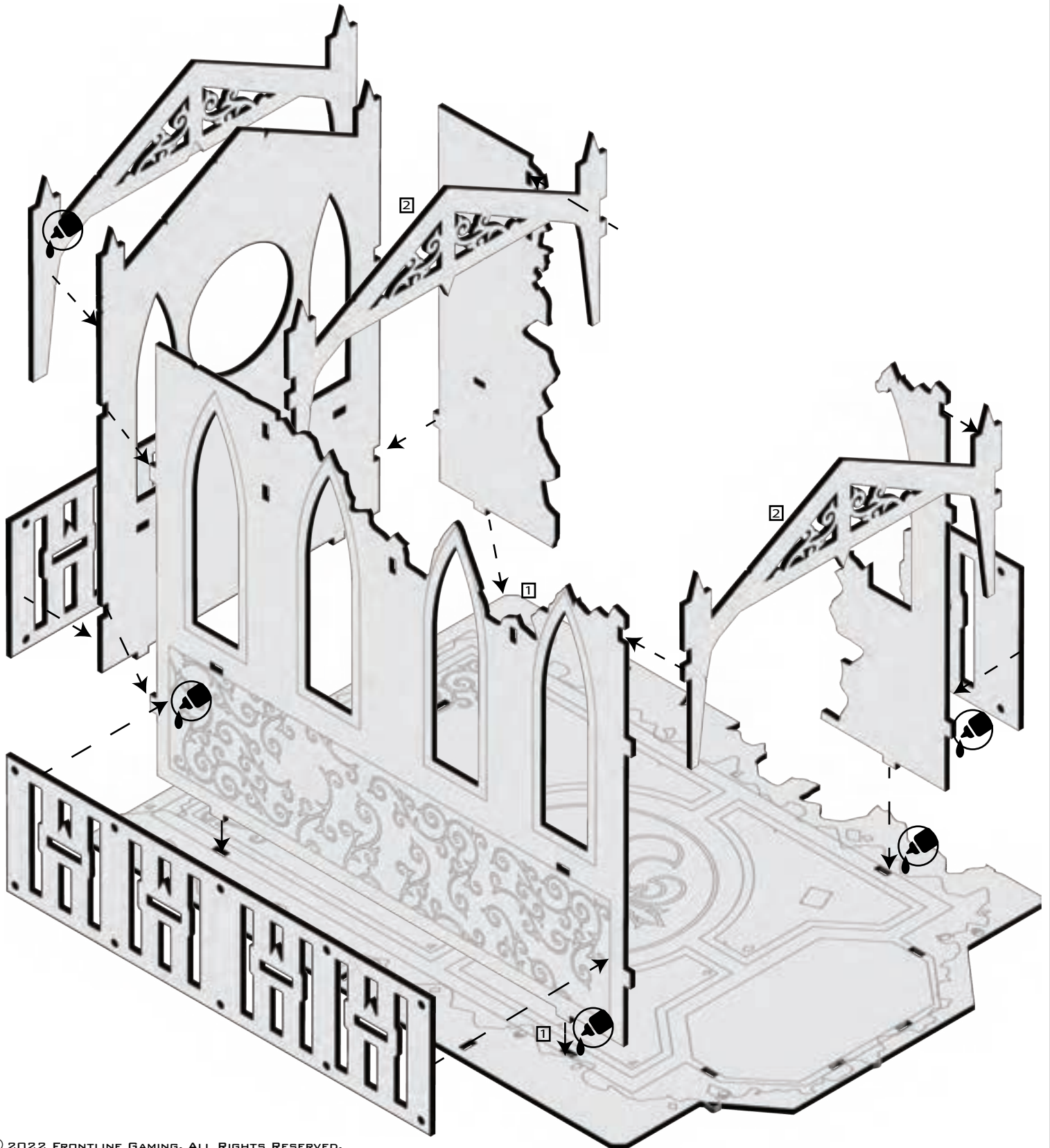

**Tips:**

Test fit each part prior to gluing  
Recommend PVA (wood) glue or Super Glue

- 1 Glue Fleur de lis to base in center of ruin
- 2 Glue eagle flying buttress(s) in place
- 3 Glue Roof in place

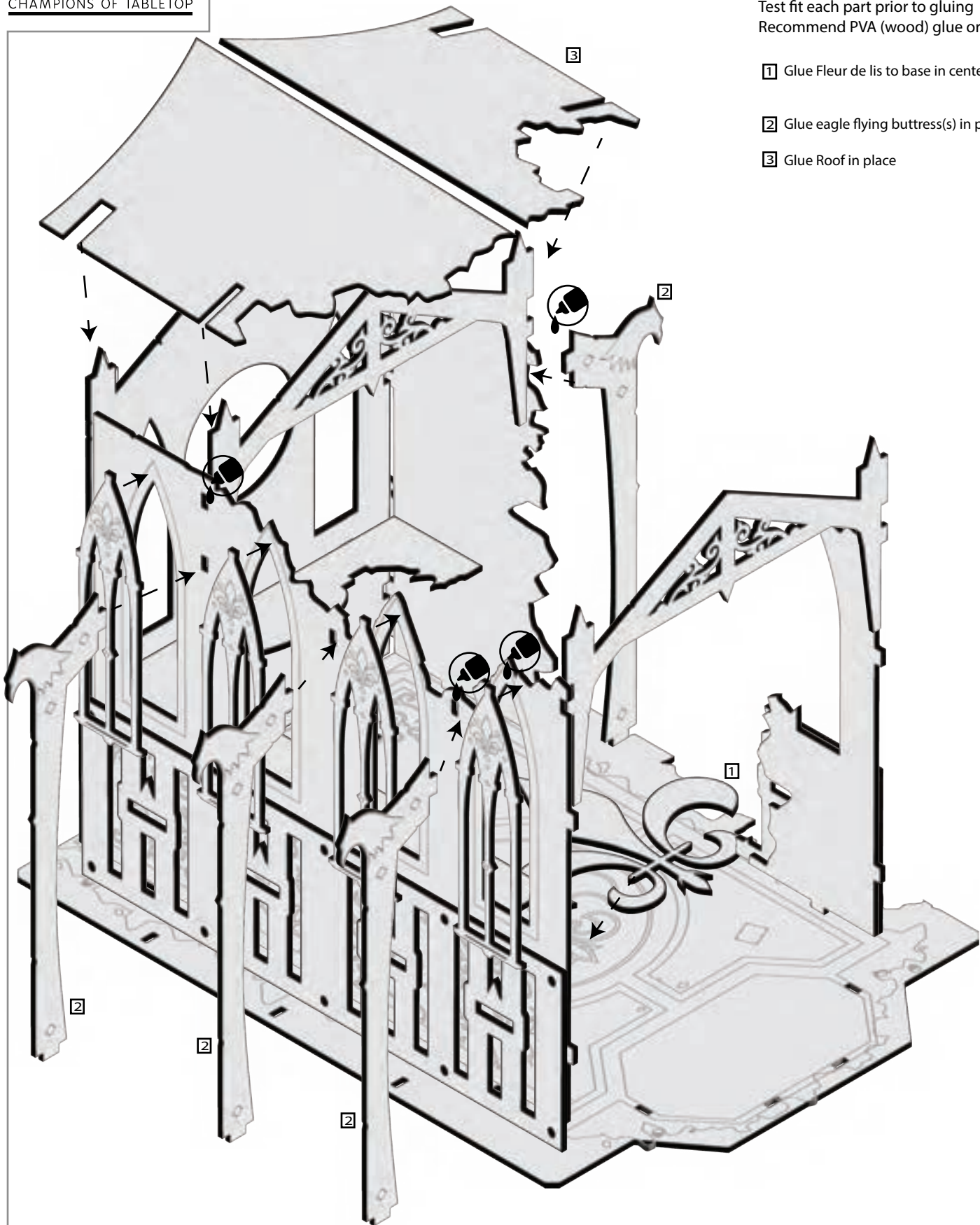



**Tips:**

Test fit each part prior to gluing  
Recommend PVA (wood) glue or Super Glue

1 Glue rear walls in place

2 Glue altar platform onto floor after walls are securely glued in place

