

USER MANUAL

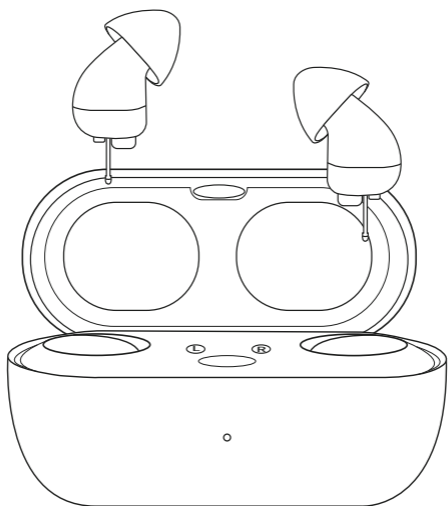

16-Channel Digital OTC Hearing Aids



+1 833 938 1277



support@vivtone.com

Accessories List

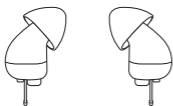

1 OTC Hearing Aid*2

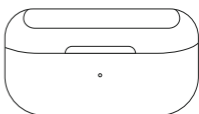

2 Charging Case*1

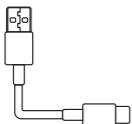

3 USB Cable*1



4 Cleaning Brush*1

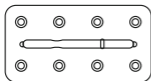

5 Cerumen Cap*8



6 Silicone Ear Dome*8



7 Tips Card*1



8 User Manual*1

💡 Tips:

The hearing aids are pre-assembled with "M" size ear domes.

Product Overview

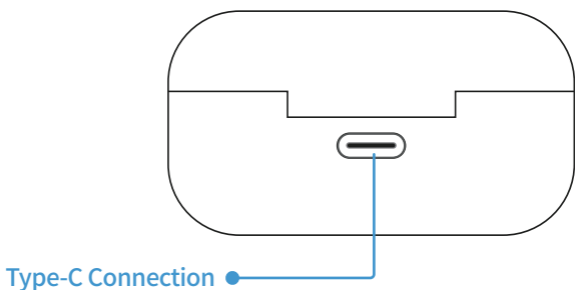
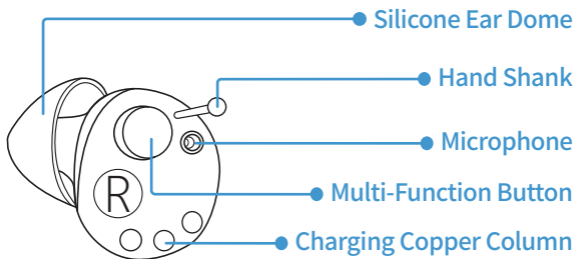

- Recycle charging: \approx 3 times
- working time: \approx 16 hrs
- Fully charge time: \approx 2 hrs
- Comprehensive duration: \approx 70 hrs

Instructions For Use

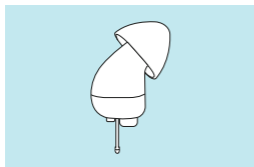

L: Left ear

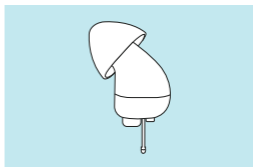

R: Right ear

How to apply ear dome

- Put the silicone ear dome on the groove of the hearing aids to install.

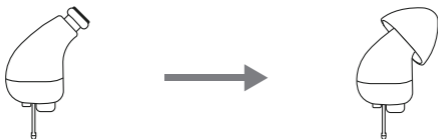

Instruction

 The hearing aids come with 4 pairs of silicone ear dome. Choose the one that fits best. Wrong size of ear domes may cause whistling.

 The device has an automatic memory function, which automatically saves the mode and volume after 10 minutes of use.

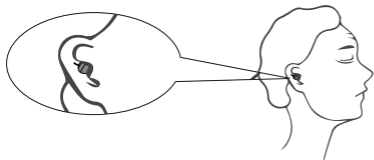

- Please choose the appropriate size ear dome according to your ear canal size, and wear it in the correct way.

Volume Control

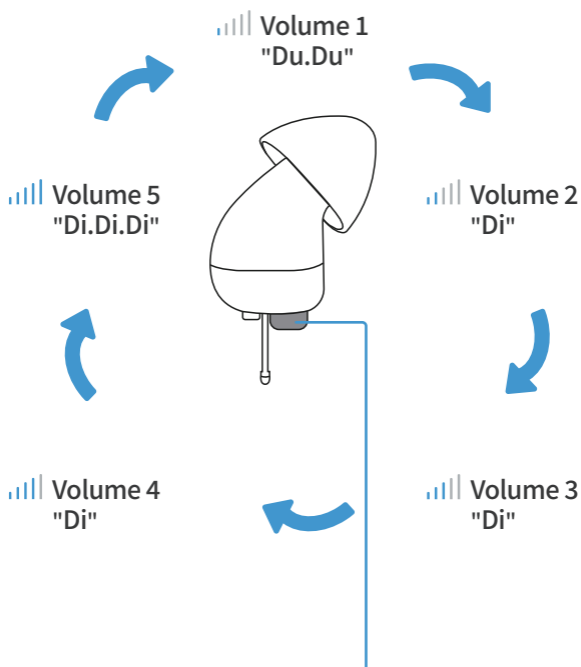

- There are 5 levels of volume, short press to adjust the volume.

💡 Tips:

The volume is adjusted in increments in a cycle from the lowest (volume 1) to the highest (volume 5) and back to the lowest (volume 1).

Switch Mode

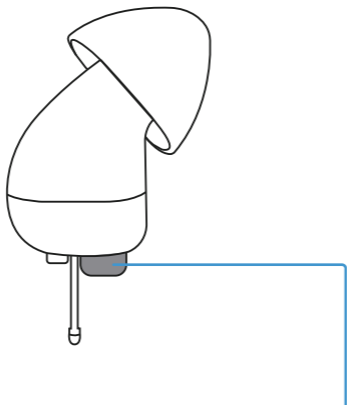

- Long press the button for 3 seconds to switch the hearing aids mode.

Mode 1

When you hear "Du", it means that the hearing aids have been adjusted to general mode. The general mode is used in daily life and can be used in most daily scenarios.

Mode 2

When you hear "Du.Du", it means that the hearing aids have been adjusted to noise reduction mode, and the noise reduction mode is applied to some noisy environments such as outdoors, parties, and airplanes.

On Or Off

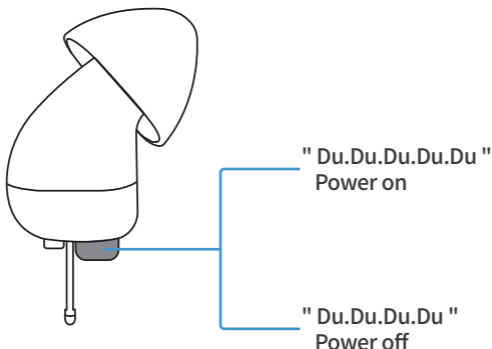

- Press and hold the button for 5 seconds to turn on or off. Or put it back into the charging case, it will automatically turn off, and when you take it out of the charging case, it will automatically turn on.

Turn on : Take the hearing aids out of its charging case or press and hold the button for 5 seconds. A signal sound of "Du...Du...Du...Du...Du" means the hearing aids is on.

Turn off : Put the hearing aids back into its charging case or press and hold the button for 5 second. A signal sound of "Du.Du.Du.Du" means the hearing aids is off.

Charging Indicator

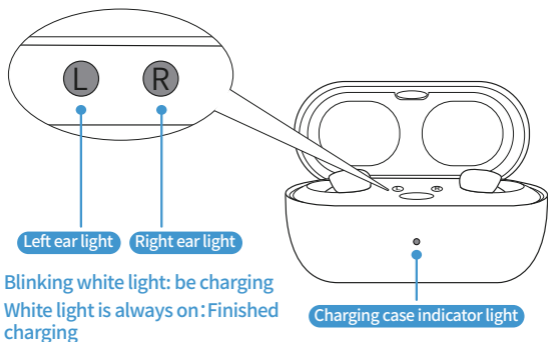

Hearing aids charging state

- When the hearing aids are placed in the charging case, the left and right ear indicator lights flash white, indicating that the hearing aid is being charged; When the white light is always bright, it means that the hearing aid is finished charging.

Charging case charging state

- After opening the charging case, the white light of the charging case indicator blinks for 4 seconds, indicating that the charging case begins to conduct self-check. After the self-check is completed, the indicator goes off if the charging case has sufficient power; if the self-check is completed and the indicator always light is flashing white, it indicates that the charging case has insufficient power.
- When the charging case is connected to the charging cable, the charging case indicator light will light up and flash blue, indicating that the charging case is charging; when the blue light is always on, it means that charging of the charging case is complete.

How To Put On (Left ear)

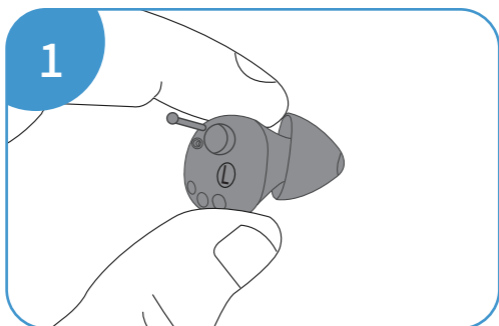

- As shown in the figure, hold the tail of the left ear hearing aids and confirm that the direction of the hand shank at the tail is upwards.

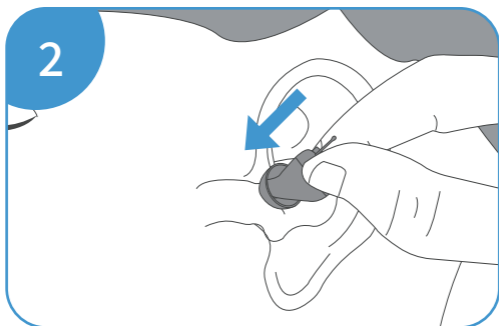

- After confirming that the hearing aid's hand shank is facing upwards, slowly insert the hearing aids along the auricle into the ear canal.

How To Put On (Left ear)

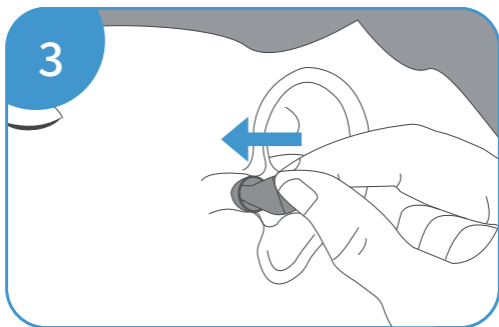

- Adjust the Angle and gently push the hearing aids deep into the ear canal until it is worn firmly and feels comfortable.

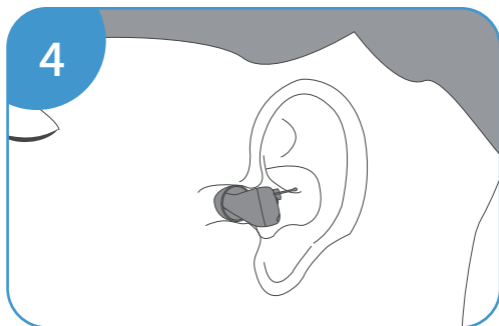

- After putting them on, shake the hearing aids from side to side to ensure a comfortable and secure fit.

How To Put On(Right ear)

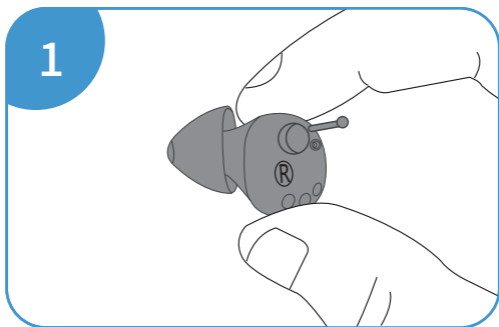

- As shown in the figure, hold the tail of the right ear hearing aids and confirm that the direction of the hand shank at the tail is upwards.

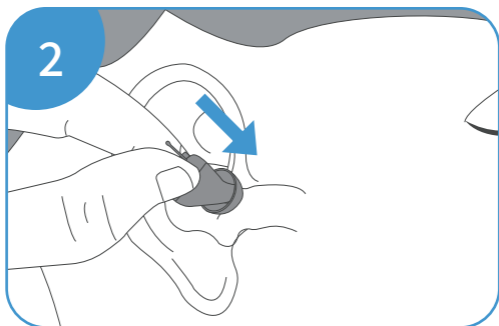

- After confirming that the hearing aid's hand shank is facing upwards, slowly insert the hearing aids along the auricle into the ear canal.

How To Put On(Right ear)

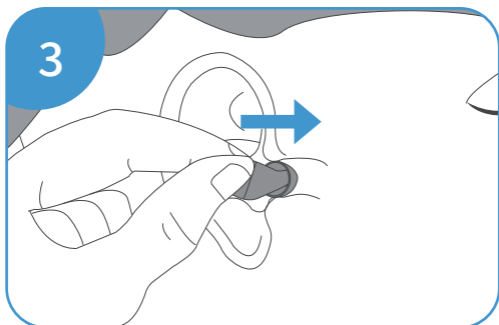

- Adjust the Angle and gently push the hearing aids deep into the ear canal until it is worn firmly and feels comfortable.

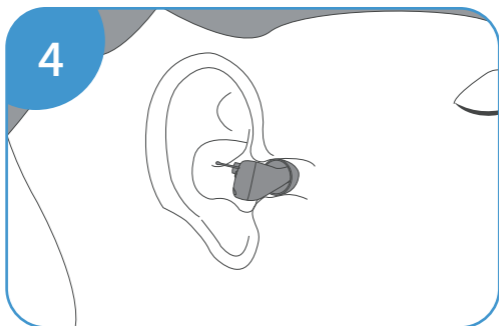

- After putting them on, shake the hearing aids from side to side to ensure a comfortable and secure fit.

How To Remove

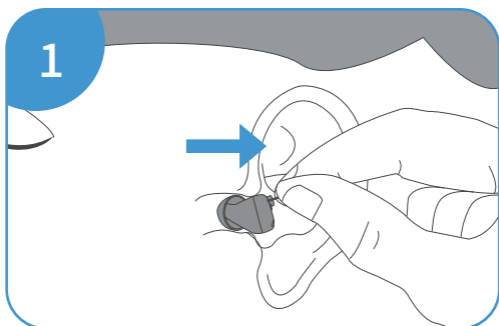

- When it is necessary to remove the left ear hearing aids pinch the hand shank at the end of the left ear hearing aids and gently remove it.

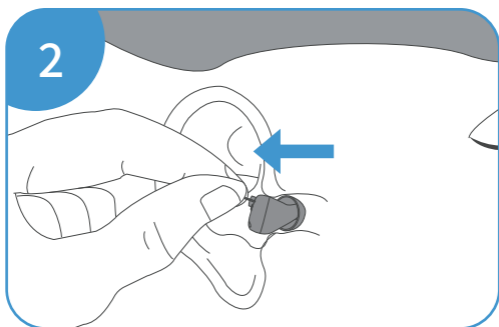

- When it is necessary to remove the right ear hearing aids pinch the hand shank at the end of the right ear hearing aids and gently remove it.

Cleaning Hearing aids

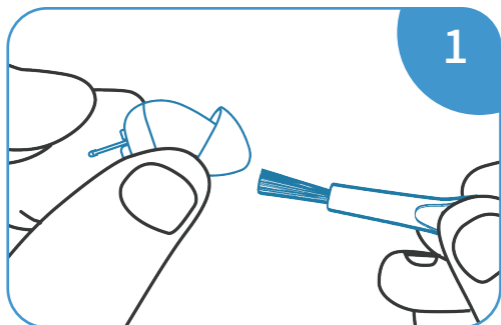

- When cleaning the silicone earmuffs, the sound outlet should face down, and use a cleaning brush to clean the dirt on the silicone ear dome.

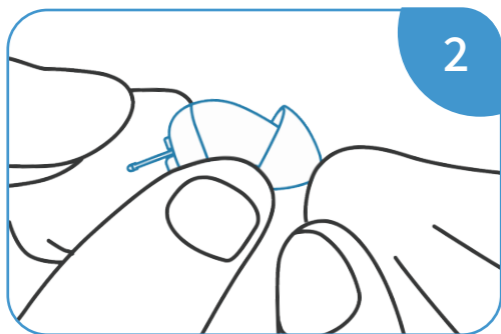

- Remove smudge or oil stains from the silicone ear dome with a cleaning wipe or rag.

Replace Cerumen Cap

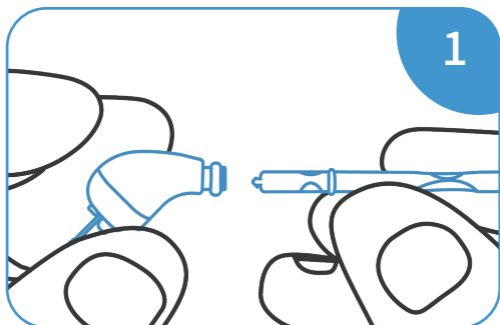

- Remove the silicone ear dome, then use the tip of the cerumen stick to remove the old cerumen cap.

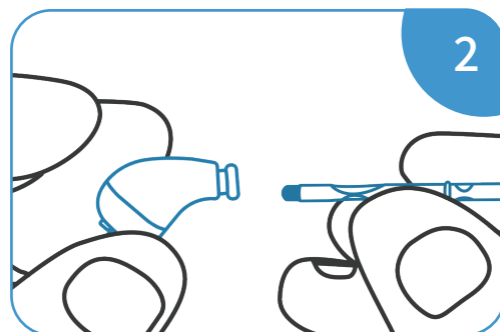

- Install the new cerumen cap using the round end of the cerumen stick, then reinstall the silicone ear dome.

Technical Specifications

Maximum Output	$\leq 108+3\text{dB SPL}$
Average Output	$106 \pm 4\text{dB SPL}$
Peak Gain	$31 \pm 5\text{dB}$
Average Gain	$26 \pm 5\text{dB}$
Frequency Range	200Hz~6000Hz
Total Harmonic Distortion(THD)	500Hz: $\leq 2\%$
	800Hz: $\leq 2\%$
	1600Hz: $\leq 2\%$
Equivalent Input Noise	$\leq 15\text{dB}$
Operating Power Supply	$\leq 1.25\text{mA}@3.7\text{V}$

Troubleshooting

Problem	Possible Cause	Solution
Whistling	Device is put on incorrectly.	Re-adjust the device to make sure it is in the correct position.
	Too much earwax.	Clean ear wax, replace the silicone ear dome.
	Wrong size of ear domes.	Choose the best fit ear dome.
No sound or Intermittent sound	Device is turned off.	Turn on the device.
	Sound hole is blocked by dirt.	Clean the device, replace the silicone ear dome.
	Volume is set to be low.	Increase volume.
Short battery life	Device is on while not in use.	Turn off the device when not in use, and recharge it before using it again.

NOTE: If the problem cannot be solved by the above list of methods, please contact our customer service.



+1 833 938 1277



support@vivtone.com

Cautions

- For any injuries or pain after using the device, stop using it immediately and seek professional help from a hearing aids center or ENT physician.
- Do NOT take NMR OR CT scan exams with your device as it may cause damage to the device.
- In extremely noisy settings such as mining fields or explosion, turn off the device to avoid hearing damage.
- Products with high moisture level can cause damage to the device. Remove the device before using such products such as hair gel or face cream etc.
- Turn off the device when not in use. Charge it at least once every 6 months to promote optimal battery life.



Avoid water: Keep the device from water. Remove the device before swimming, bathing, showering or face washing.



Avoid heat: Do not leave the device under direct sunlight or in places with excess heat.



Avoid shock: Avoid dropping the device to the ground from high above. Keep it from violent shock.

Thank You For Reading



+1 833 938 1277



support@vivtone.com

CERTIFICATE

Product name	Hearing aids
Manufacturer Part Number	6116A
Product life	5 years
Inspectors	
This product conforms to national standards and industry standards, and has passed the inspection.	

Please keep the manual properly and use the operating instructions on the manual. If you have any questions, please feel free to call us, thank you!

LISTEN TO THE WORLD

