



HY10.10.HRP.H High Resolution Scale

More information on the website
radwag.com/en/info,w1,0CC



The drawings, photos and graphics used are for illustrative purposes only.

Functions

-  Dosing
-  Labelling
-  Plus/Minus Control
-  Percent Weighing
-  Totalizing
-  Parts counting
-  Peak hold
-  Formulation
-  Newton unit measurement
-  Statistics
-  Checkweighing
-  GLP Procedures
-  Animal weighing
-  Differential weighing
-  Replaceable unit
-  Statistical Quality Control
-  ALIBI Memory
-  Transactions

Datasheet

Metrological parameters	
Maximum capacity [Max]	10 kg
Minimum load	5 g
Preload range	4 kg
Readability [d]	0.02 g

Metrological parameters	
Tare range	-10 kg
Repeatability	0.03 g
Linearity	±0.06 g
Stabilization time	2 s
Adjustment	internal (automatic)
Physical parameters	
Display	10.1" graphic colour touchscreen
Weighing pan dimensions	360×280 mm
Net weight	24.7 kg
Gross weight	28.7 kg
Construction	
Protection class	IP 66/67 construction, IP 68/69 indicator
Construction	Stal nierdzewna AISI304
Weighing pan material	Stal nierdzewna AISI304
Communication interface	
Communication interface	2×RS232, 2×USB-A, Ethernet, 4 IN / 4 OUT (digital)
USB	×2
Ethernet	×1
RS232	×2
Inputs/Outputs	4IN / 4OUT
Relative humidity	40% ÷ 80%
Optional add-on modules	
Wi-Fi module (option)	802.11 b/g/n
RS485 module (option)	1
Profibus module (option)	DP SLAVE
PROFINET module (option)	1 × RJ45
Analog output module (option)	4-20mA, 0-20mA, 0-10V
Inputs/Outputs (option)	12IN / 12OUT (IN – 5-24 VDC, OUT – max 30 VDC, 0.5 ADC)
Electrical parameters	
Power supply	100 – 240 V AC 50/60 Hz
Environmental conditions	
Operating temperature	+10 ÷ +40 °C

Repeatability is expressed as the standard deviation of ten load placements.

Relative humidity under non-condensing conditions.

Stabilization time under optimal environmental conditions.

* Wi-Fi® is a registered trademark of Wi-Fi® Alliance.



Accessories

RS 232 cables (scale - printer)

- PT0019.5 Cable [WX-013-0145]
- PT0232.2 Cable [WX-013-0172]
- PT0019 Cable [WX-013-0033]
- PT0019.2 Cable [WX-013-0144]
- PT0019.10 Cable [WX-013-0143]

Transponder card readers

- CK-02/3 Transponder Card Reader [WX-004-0147]

RS 232 cables (scale - ZEBRA printer)

- PT0022 Cable [WX-013-0149]

RS 232 cables (scale - Ethernet)

- PT0212.15 Cable [WX-013-0199]
- PT0212 Cable [WX-013-0044]

Displays

- WWG-2/4 Large-Size Display [WX-004-0128]
- WD-4/3 Additional Display [WX-004-0011]

IN/OUT Cables

- Cable PT0256.10 [WX-013-0116]
- Cable PT0256.5 [WX-013-0115]
- Cable PT0256.2 [WX-013-0114]

Barcode scanners

- LS2208 Barcode Scanner [WX-006-0005]
- PM9501-433RBK20 Barcode Scanner [WX-006-0051]
- PD9531-K1 Barcode Scanner [WX-006-0046]
- DS2208 Barcode Scanner [WX-006-0036]
- PM9501-433RBK10 Barcode Scanner [WX-006-0045]
- PD9531-K2 Barcode Scanner [WX-006-0050]

Label Printers

- ZD 421t Zebra Printer [WX-007-0114]

Stands, wall mounting kits and mounting brackets

- Stand for measuring indicator PUE HY10 / PUE HX7 / PUE HX5.EX - stainless steel version [WX-004-0260]

RS 232, RS 485 cables

- PT0020 Cable [WX-013-0031]

Keypad, external switches

- Tare and Print External Buttons [WX-004-0162]

Receipt Printer

- RTP-UEW80 Radwag Thermal Receipt Printer (USB + Ethernet + WiFi) [WX-007-0118]
- RTP-RU80 Radwag Thermal Receipt Printer (RS232 + USB) [WX-007-0119]

USB cable (scale - printer)

- PT0087 Cable [WX-013-0038]

Additional Weighing platforms Module

- DP-6 Module [WX-016-0244]

Additional modules

- RES Radwag Extended SI Module (PUE HY10) [WX-016-0154]

RS 232 – USB Converter

- Moxa UPort 1110 Converter [WX-015-0278]

Software

- E2R Weighing [WX-010-0099]
- E2R Weighing Records [WX-010-0038]
- Audit Trail Reader [WX-010-0186]
- Label Editor R02 [WX-010-0094]
- R-Lab [WX-010-0080]
- R-Barcode [WX-010-0109]

- E2R Formulations [WX-010-0043]
- RAD Key [WX-010-0005]
- LabVIEW "Radwag Balances & Scale" Driver [WX-010-0105]
- RADWAG Remote Desktop [WX-010-0107]
- RADWAG Development Studio [WX-010-0104]

Device dimensions

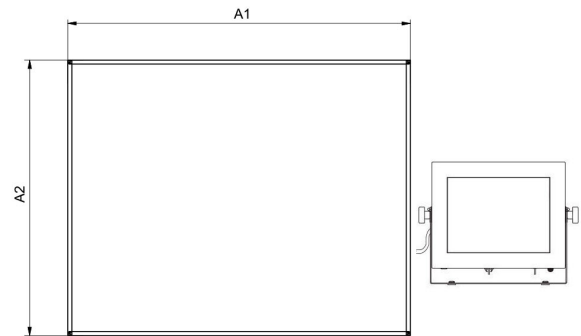
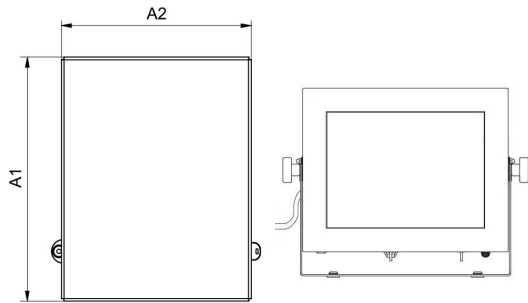
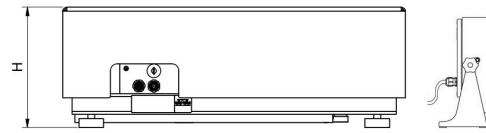
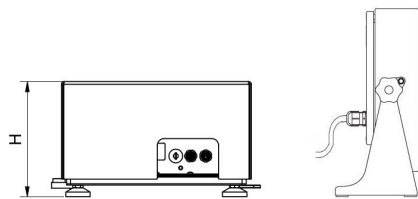

HY10.16 - 32.HRP.H

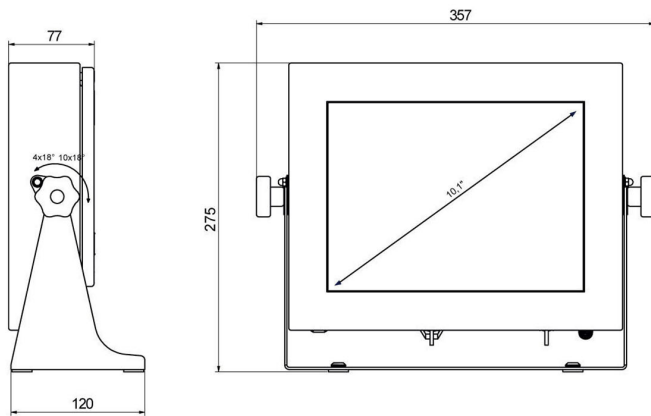

Scale type	A1	A2	H
HY10.(16-32).HRP.H	360	280	180±5
HY10.(62-150).HRP.H	500	400	180±5
HY10.150.2.HRP.H	500	500	180±5
HY10.(150.1-300).HRP.H	800	600	180±5
HY10.(300.1-1100).HRP.H	1000	800	180±5
HY10.(2000).HRP.H	1250	1000	180±5

Dimensions in mm

PUE HY10