



THE OUTDOOR  
GREATROOM  
COMPANY

# The Cove Fire Pit

Installation Instructions for CV-1242



## IMPORTANT

Please consult your Crystal Fire instruction manual for detailed instructions and important information related to the burner installation including: lighting and operating instructions, safety information, and proper tightening of connections with two wrenches.

**DO NOT ATTEMPT TO INSTALL CF-1242 BURNER WITHOUT FIRST CONSULTING THE CRYSTAL FIRE OWNER'S MANUAL.**

## Contents

Required Tools.....	2
Included with your Fire Pit.....	3
Assembly Instructions.....	4
Sparker Box Installation.....	4
Gas Connections.....	5
Burner installation.....	6
Glass Installation.....	7

## Required Tools

**FOUR people are required for this installation.**



- 2 Open Ended Wrenches  
To secure gas connections.



- Leather Gloves  
To protect hands from rough edges found on fire pit during installation.



- One AAA Battery (not included)  
Required for electric spark igniter installation.



- Utility Knife  
To cut and remove packaging.



- Power Drill  
To remove support board from crate.

# Included With Your Fire Pit



CV-1242-BASE with Control Panel



CF-1242 Crystal Fire Burner Kit

# Assembly Instructions

## 1. Remove Cove-1242-Base from Packaging crate

- Four People are required to lift base out of packaging and place into final location.



## 2. Sparker Box Installation

- Remove sparker cap and hex nut. Insert AAA battery (not included) with + end out.
- Install sparker into control panel as shown below, secure using hex nut and replace sparker cap.
- Depress sparker button to ensure your sparker is working properly. You should hear the spark behind the sparker box.

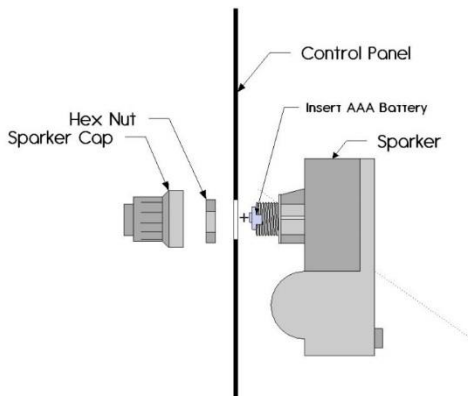

### 3. Gas Connections

**Read and understand your Crystal Fire Burner Owner's manual before beginning burner hookups or using the device. Do not use Teflon tape or pipe dope on flare fittings.**

- Reach inside the base and attach gas supply line to the input shown below, using a 3/8" flare fitting. **Use two wrenches to ensure a gas tight connection.**

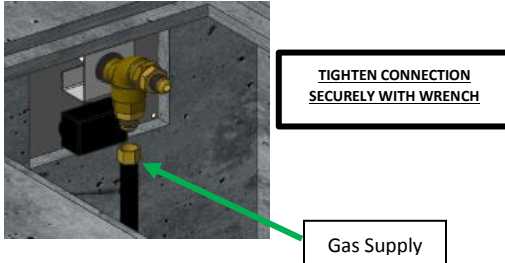

- Ensure the correct orifices are installed for the fuel type you are using (see Crystal Fire Burner Owner's manual included with burner for orifice sizing information).

#### **TIGHTEN ALL CONNECTIONS SECURELY WITH TWO WRENCHES**

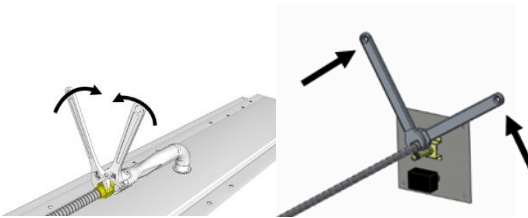

- Attach flex line from the burner to gas valve as shown below. **Use two wrenches to secure connection.**

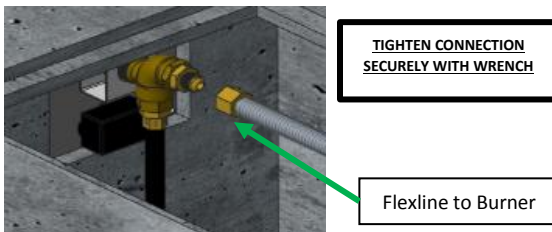

4. Connect Ground wire and Electrode wire from burner to sparker box.

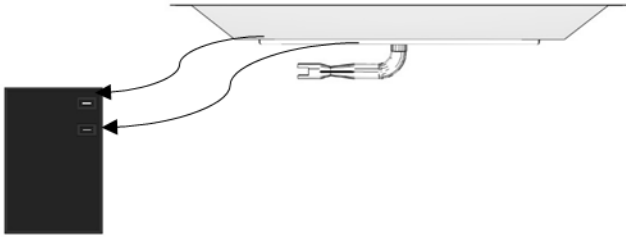

- Plug both **BLACK** wires hanging from the burner into the back of the sparker box. If an orange wire is present, do not use it. The orange wire is for automatic ignition system add-on only.
- Test system by pushing the button on the igniter. Consult the troubleshooting section of the Crystal Fire Burner Owner's Manual, if the spark is weak, intermittent, or not present.

5. Drop Burner into base.

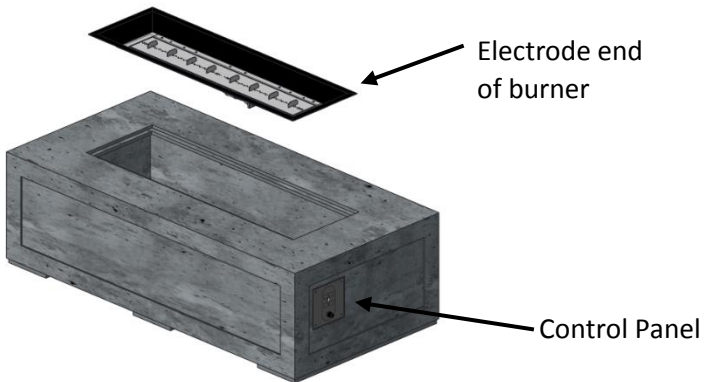

- Orient burner so that the electrode is nearest to the control panel in order to make sparker box connections.

**6. Install Fire Media**

- Scatter all included glass beads, lava rock, or other approved fire media evenly across entire burner surface.

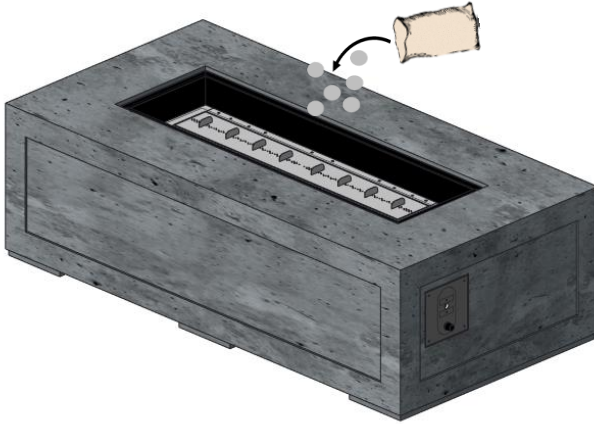

**DO NOT OPERATE CRYSTAL FIRE BURNER WITHOUT INCLUDED GLASS BEADS OR OTHER APPROVED FIRE MEDIA**

**IMPORTANT**

Please consult your Crystal Fire instruction manual for detailed instructions and important information related to the burner installation including: lighting and operating instructions, safety information, and proper tightening of connections with two wrenches.

**DO NOT ATTEMPT TO INSTALL CF-1242 BURNER WITHOUT FIRST CONSULTING THE CRYSTAL FIRE OWNER'S MANUAL.**

**WARNING**

**After consulting the manual and following instructions, remember; before operating, all gas connections must be fully checked for leaks**

**Warranty:** Fire pit tables are covered under a 1-year manufacturer's warranty. Please visit <http://www.outdoorrooms.com/warranty-form/> to register your product.

Thank you for purchasing an Outdoor GreatRoom Company product! This fire pit was made with pride in the USA.

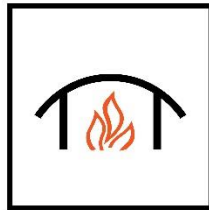

14400 Southcross Drive West • Suite 100 • Burnsville, MN 55306  
Toll Free: 1-866-303-4028 • [Sales@OutdoorRooms.com](mailto:Sales@OutdoorRooms.com)