

Ford Bronco

PRINSUROOFRACK



Applications

installation instructions

These installation instructions apply to the following Prinsu products

– **Ford Bronco 4-door** Prinsu Roof Rack | 2022 - Present SKU: 600-000-027-063

IMPORTANT!

THANK YOU for purchasing this Prinsu product. Please read through this entire document before proceeding with installation. If you are not confident in your mechanical skills, please seek the help of a professional to perform the installation. Check your packages immediately upon arrival to ensure that everything listed is included, and to check for damage during shipping. ***If anything is missing or damaged, or if you need technical assistance with any aspect of this installation, call Prinsu at (208) 528-0664 as soon as possible.***

IMPORTANT!

If your Prinsu product comes as unpainted, bare steel or aluminum. You will want to either powder coat or paint prior to final installation, however it is very important to PRE-INSTALL the unpainted product first, following these instructions, BEFORE painting or powder coating any of the components! This will ensure that all parts are correct and any incidental trimming or drilling will have been done prior to coating. Also, it will give you a practice run to familiarize yourself with the process, to lessen the likelihood of damaging the finish during final installation. Prinsu is NOT RESPONSIBLE for paint or powder coating costs, damage to paint or powder coating, or costs associated with inadvertently painting or powder coating components that are defective or were shipped or assembled in error. It is the customer's responsibility to pre-install and verify that all parts are correct prior to paint or powder coat

Hardware

Ford Bronco Hard Top Roof Rack Mounting Hardware	
DESCRIPTION	QTY
1/4"-20 Steel Nylon Insert Flange Zinc	4
#10-24 Steel Hex Machine Screw Nut Zinc	4
#10-24 X 1/2" Steel Carriage Bolt Zinc	4
Crossbar Hardware (For 11 Cross Bars - 48.5")	
DESCRIPTION	QTY
1/4"-20 x 1" Steel 6-Lobe Pan Machine Screw Black Zinc	70
Vibra-Tite 111 Low Strength Threadlocker Pack of 3 Tubes	1
1/4" x .557" - .567" x .044" - .052" Steel Flat Washer	70
Wind Deflector Hardware	
DESCRIPTION	QTY
1/4"-20 Steel T-nut Plain	12
1/4"-20 x 1/2" Steel Pan Head Phillips Black Zinc	12
1/4" x .557" - .567" x .044" - .052" Steel Flat Washer	12

Tools Required

- 3/16" Drill Bit
- Power Drill
- Saw or cut off wheel *(for plastic)*
- 3/8" Wrench/Socket
- 7/16" Wrench/Socket
- 10mm Wrench/Socket
- T-30 Torx Driver
- Phillips ScrewDriver
- Isopropyl Alcohol *(or something to prepare a surface for adhesive)*

Note for Dealers and Installers:
It is your responsibility to ensure instructions are given to the end user or client.

Sequence of Steps

Remove OEM roof rails. To remove the rear feet, you will need to use a special tool from the glove box. If the vehicle doesn't have OEM roof rails remove the two caps located at the top of the windshield along with the black pieces beneath them (10mm socket needed).

Modify caps:

Drill 3/16" hole in the following location on both caps:



Remove the top 1/8" of the cap as shown on the image above (cap on right)

Attach Cap Mounting Brackets to caps

(Note orientation. Brackets are side-specific):



(3/8" wrench needed)

Install Front Mounting feet on the studs which are covered by the caps shown in the previous step.

Use OEM nuts (10mm black flange nuts) with a dab of thread locker. (parts shown below)



FRONT MOUNTING FOOT DRIVER SIDE FRONT MOUNTING FOOT PASSENGER SIDE

Using two cross bars in the highlighted slots, assemble the front portion of the roof rack

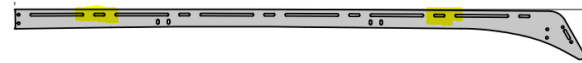

Apply rubber pads to the following parts in the locations marked in yellow. Be sure to properly clean the area beforehand.

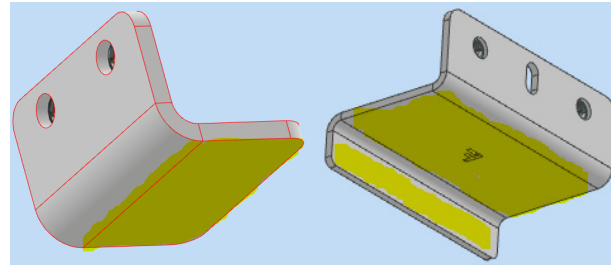

(Same for both "F" and "R", but sizes will be slightly different.)

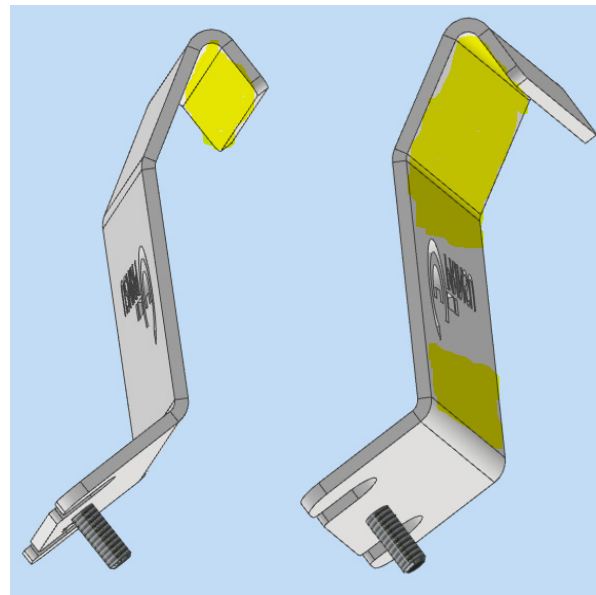

(Same for both "F" and "R", but sizes will be slightly different.)

Install the four Short Mounting Feet (shown in step 6a) onto the partially assembled rack. (locations marked in red)

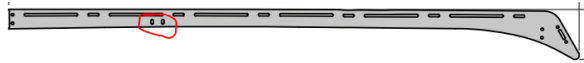

Note: at this step, install all Short Mounting Feet as high up in the slot as possible

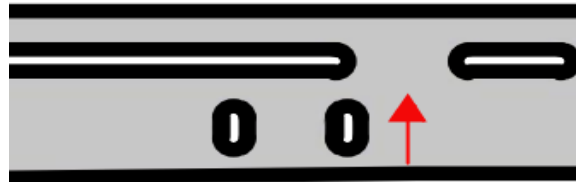

Place the partially assembled rack onto the vehicle. Using four screws with washers, attach Side Rail Front Halves to Front Mounting Feet in the holes shown

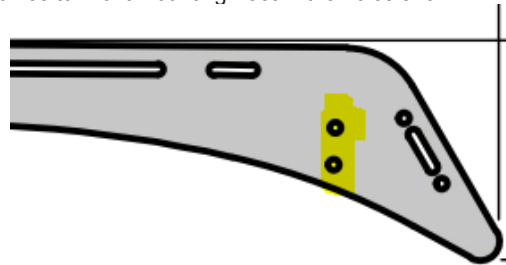

Using a 7/16" wrench or socket and nuts, loosely install the clamp mounting feet. They should be loose enough to be able to adjust fwd-rear location by hand. Parts labeled with "F" and "R" are meant to be paired together in either the front or rear positions:

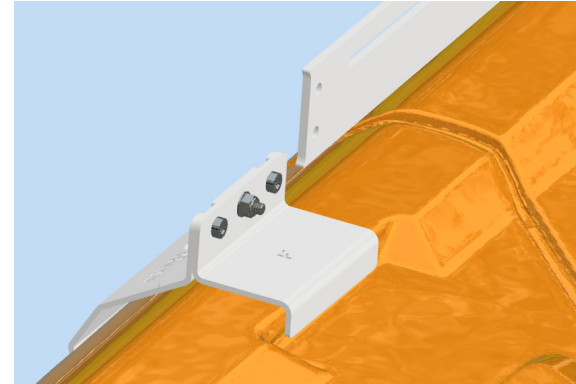

(a pair of front ("F") mounting brackets installed properly) Loosely install the Side Rail Rear Halves using the Side Rail Connector Bracket. Screws and washers should be installed hand-tight in the marked locations:

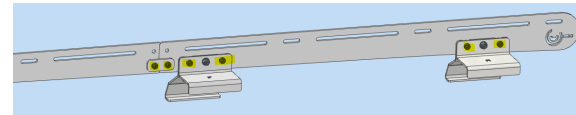

Tighten mounting feet from step 9 and connector brackets from step 10

Using small carriage bolts and nuts, install Caps and Cap Mounting Brackets from steps 2-3 on the front of the rack as shown. Note this step may require a good amount of adjusting in order to make the caps look flush with the rest of the vehicle.

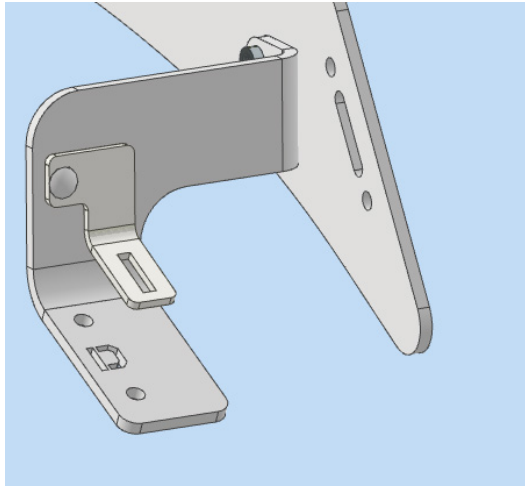

Assemble Wind Deflector including noise reducing trim
Install the assembled Wind Deflector. Note that using the lower mounting location may cause the silver cross bar to hit the front of the vehicle. Using the middle (slot) location is advised.

Loosen the four Short Mounting Feet (shown in step 6a)

Re-tighten the Short Mounting Feet while using a pry bar, screw driver, or wrench, pry upward on the bottom side of the side rail near the foot being tightened. This step is to make sure the Short Mounting Feet are properly making contact with the roof and supporting the rack.



792 E Iona Rd.
Idaho Falls, ID 83274
cbioffroadfab.com
208.528.0664