

PATHFINDER
Owner's Manual



Members of the ATA

2200 Stringtown Rd.
Evansville, IN 47711

800 - 694 - 9494 • fax 812 - 467 - 1245

www.BearArchery.com

CONTENTS

Important Press Information	_____	3
Archery Safety & Warnings	_____	4-5
Bow Diagram	_____	6
Care & Maintenance	_____	7
Limb Bolt Adjustments	_____	8
PATHFINDER Cam Adjustments	_____	9-12
Initial Bow Setup	_____	13 -16
Arrow Information	_____	17
General operating instructions	_____	18
Warranties & Contact Information	_____	19-20

**Record important bow information here
and keep for future reference.**

Model _____

Weight Range _____

Draw Length _____

String Length _____

Cable Length _____

Purchased From _____

Date Purchase _____

Serial Number _____

IMPORTANT PRESS INFORMATION

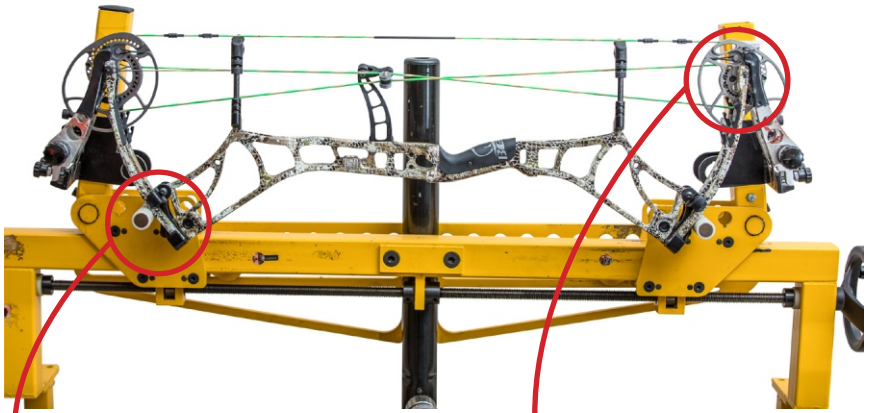

Certain bow models require the use of fixed stops to prevent the press forces from pushing the bow out of the bottom of the press.

Bow press **MUST** only be applied to the outer 2" of the limb tips.

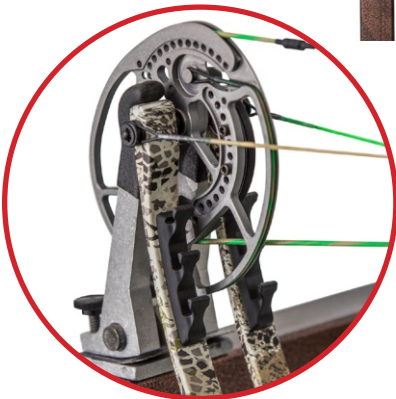

Press must **ONLY** apply pressure to the limbs in this area.

! SAFETY FIRST !

Before using this equipment, read and follow these manufacturer's instructions carefully. If you have any questions, contact the manufacturer or a qualified dealer.

⚠ WARNING ⚠

Dry-firing a bow severely reduces the life expectancy of the bow and may cause immediate damage to the bow resulting in injury to yourself or others. Never dry fire your bow! If a bow is dry fired, it should be fully inspected before being shot again.

Never pull back and release the bowstring without an arrow attached to the string. Your bow is designed to transfer energy to a properly weighted arrow.

Shooting underweight arrows has the same effect as dry-firing a bow and may cause serious injury. Use the proper arrow for you and your bow. If you are unsure about your arrow choice, contact your local Bear Archery dealer or an arrow manufacturer.

Do not use wooden arrows. They are not designed for use with this compound bow and may cause serious injury. Use the provided safety glass arrows or a properly spined carbon arrow for your bow. Your local archery dealer can help with choosing the proper arrow. If order additional arrows, contact your local dealer or you can purchase online.

Inspect your arrows and nocks regularly. Immediately discard any dented, split, splintered or otherwise damaged arrows and replace cracked or broken nocks.

Do not draw your bow beyond its maximum draw length as damage to the limbs, cables and strings could occur.

The use of safety glasses is recommended with any archery product.

Bear Archery compound bows are designed to be shot using a Mechanical Release Aid, Bear Archery does not recommend shooting with your fingers.

! SAFETY FIRST !

Target Safety

- Be sure of your target.
- Never aim at anything you don't intend to shoot.
- Never point or aim a drawn bow at another person.
- Never draw or shoot when anyone is between you and your target.
- Never shoot at a target or object unless you are sure that it can stop your arrows.
- Make sure the area behind and around your target is clear.
- Before shooting, be sure that no part of the bow will strike any tree branches or other obstacles.
- Never shoot arrows straight up in the air or in any direction where you might destroy property or endanger life.

Pre-shooting checklist
Are these items in good condition?
Properly installed? In working order?

___ Cables

___ Sight

___ String

___ Arrow Rest

___ String Serving

___ Arrow Nocks

___ Loop/Nock set

___ Arrow Shafts

___ Cable Slide

___ Set Screws

BOW DIAGRAM - PATHFINDER

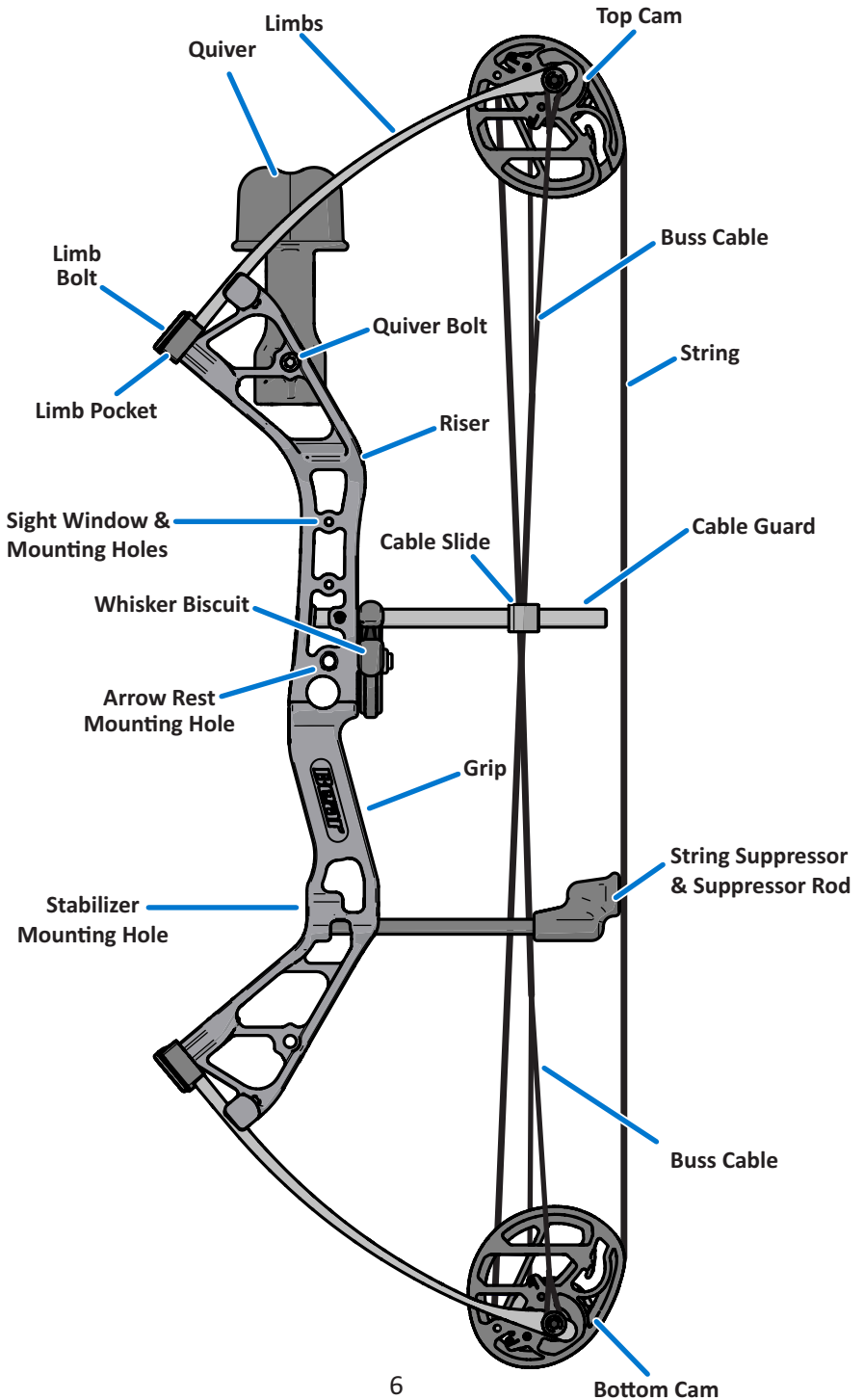

CARE AND MAINTENANCE

With proper care and a minimum amount of routine maintenance, your bow will be kept in top condition. However, it is still important to carefully inspect your bow on a regular basis.

Cleaning

Your bow should be kept clean of dust, mud and grime. Use a damp soft cotton cloth to remove dirt and moisture. Do not use solvents such as acetone or mineral spirits as they may damage the finish.

Storage and Transportation

Avoid exposing your bow to temperatures over 125 degrees. Excessive heat may damage your bow. Do not leave your bow in your vehicle on a hot sunny day or store in a hot attic or other hot enclosed area. Clean your bow thoroughly after each use. Never put your bow away wet or store it in a damp place. Lightly oil all steel parts (axles, mounting screws) to prevent rust. You can relax the limbs if storing for more than a year. Follow the instructions under Peak Draw Weight Adjustment in the bow adjustment section.

Bow Presses

Use only APPROVED bow presses. Older style “single-pull” bow presses that contact the bow only in the grip area can result in bent or broken risers.

See page 2 and/or www.BearArchery.com for additional bow press information.

Lubrication

Your Bear Archery compound bow requires very little lubrication. Wipe the cable guard periodically with a dry cloth to keep the cable slide running smoothly and free of dust. Cam and idler wheel bearings do not require lubrication. If other lubrication is necessary, use white lithium grease or Teflon lubricants. Avoid excessive lubrication of any item, as this can attract dirt. On hunting bows, avoid lubricants with obvious odors.

String and Cable Maintenance

Regularly apply a high quality bowstring wax to your string and cable system. Regular waxing protects your cables and strings from abrasion, wear and separation. Smear the wax into position. Then, rub it gently with your fingers or a soft piece of leather to work the wax into the strands. Replace frayed or worn bowstrings and cables immediately.

Bear Archery strongly recommends replacing the bowstring and cable annually. Please visit your local Bear Archery dealer for assistance.

LIMB BOLT ADJUSTMENT

Peak Draw Weight Adjustment

Bear Archery bows have an approximate 2lb / Limb bolt turn peak weight adjustment range.

Using a hex wrench, turn the limb bolts clockwise to increase peak weight and counter-clockwise to reduce peak weight. Bow weight will increase or decrease approximately two pounds per turn. **IMPORTANT** Both limb bolts must be adjusted equally. Likewise, do not turn one limb bolt more than two turns ahead of the other when making adjustments. Finally, limb bolts must never be backed out more than the specified number of full turns on any bow.

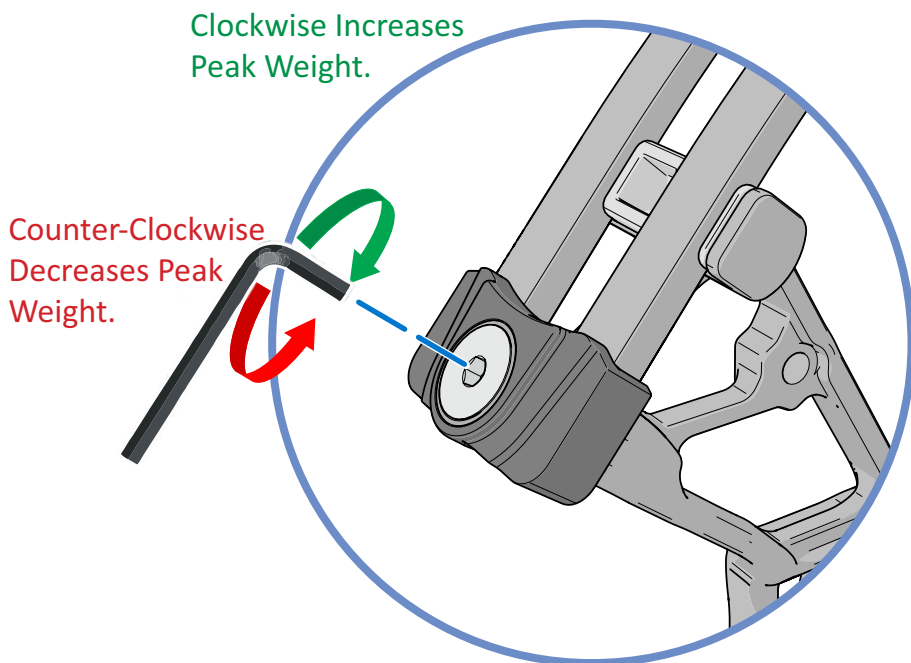

Limb Bolt Adjustment

Bows

PATHFINDER

Max Turns

7

CAM ADJUSTMENTS

Pathfinder Bow

TOP CAM - Front View

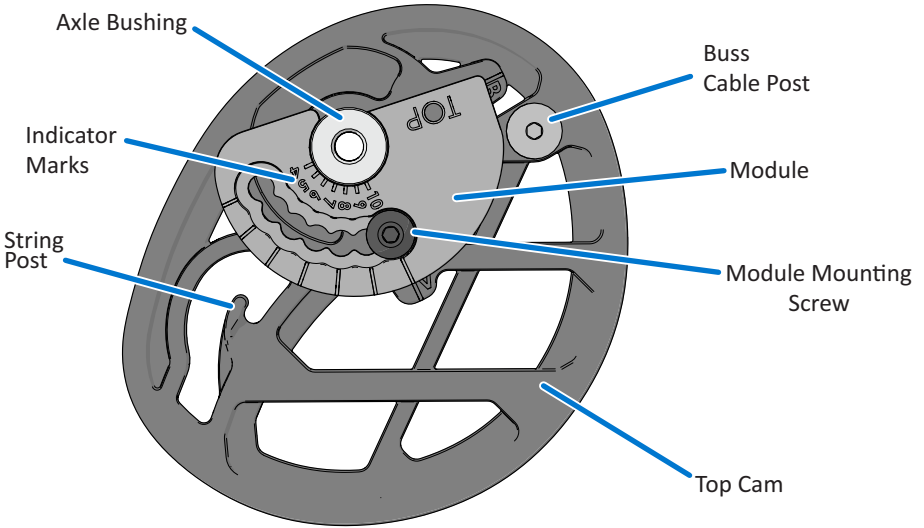

TOP CAM - Back View

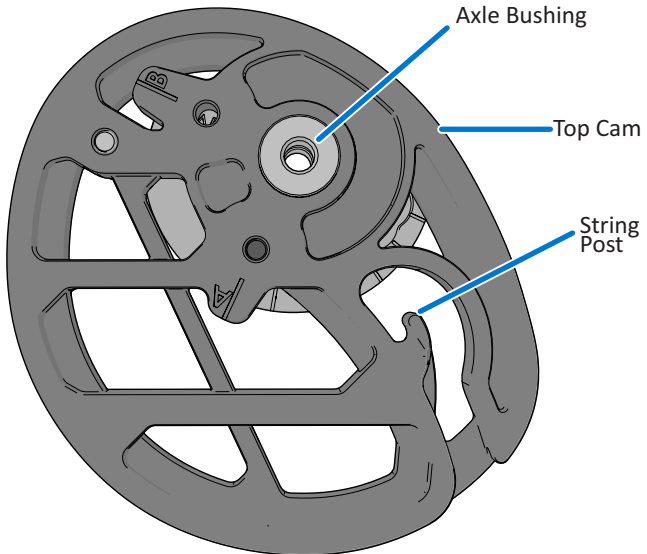

CAM ADJUSTMENTS

Pathfinder Bow

TOP CAM - 3D View

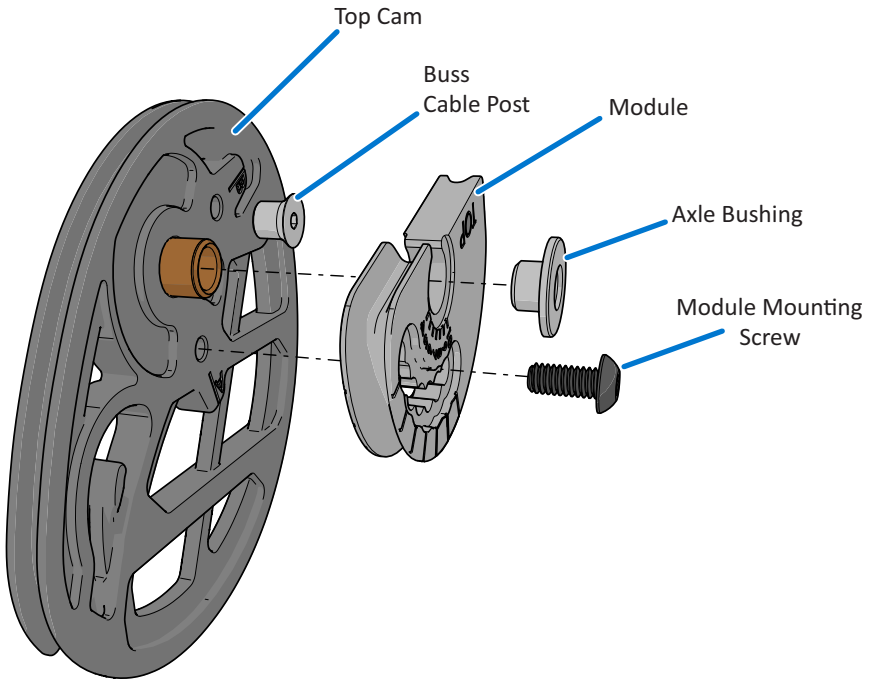

CAM ADJUSTMENTS

Pathfinder Bow

BOTTOM CAM - Front View

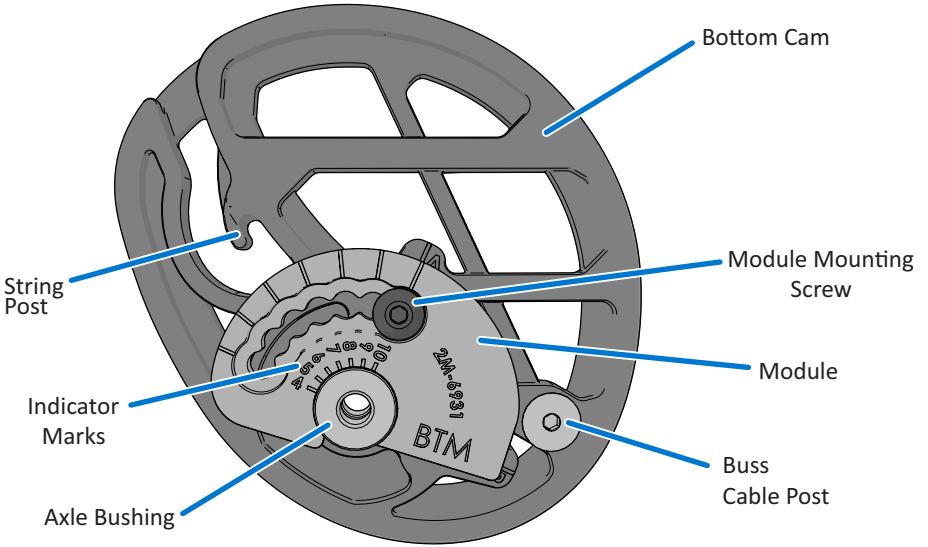

BOTTOM CAM - Back View

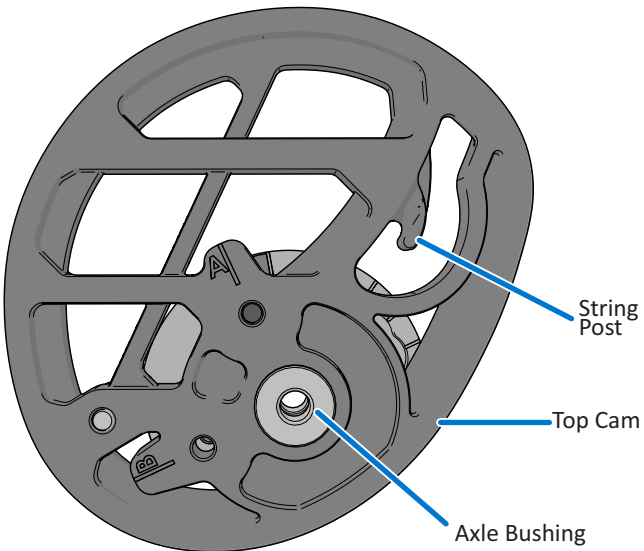

This bow is designed to have 13 different draw lengths (14"-25"). The higher number, the higher the draw length.

DRAW LENGTH ADJUSTMENT

To increase the draw length, rotate the module to the higher number using the chart below to ensure desired length.

Use an allen key to loosen the module screw until the module is free. Then place in the desired draw length hole and tighten the screw. **Do not over tighten screw. See Figure 1.**

Make sure the module is flush against the face of the cam while tightening the screws. Then perform the same operation on the opposite cam. Be sure that both the top and bottom cams are using the same draw length number.

FIGURE 1.

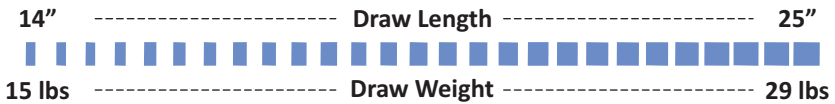
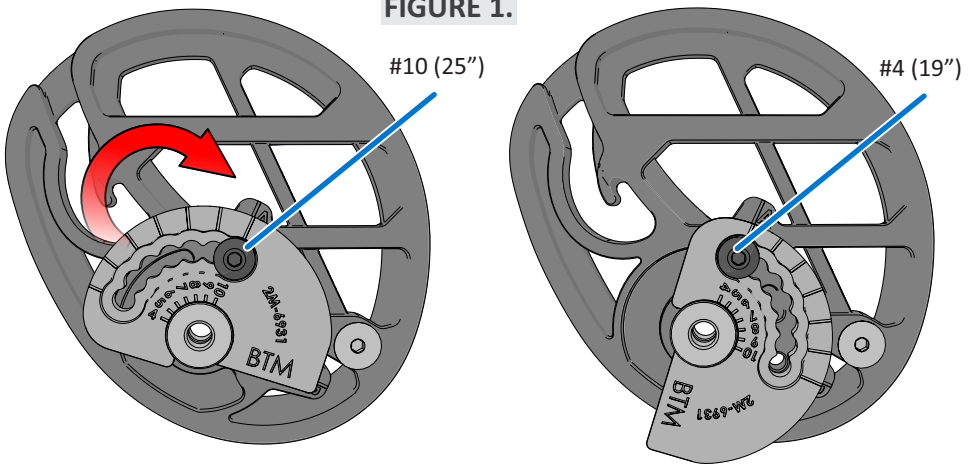

DRAW LENGTH CHART - PATHFINDER BOW		
CAM MARK	MODULE MARK	DRAW LENGTH (in)
A	10	25
A	9	24
A	8	23
A	7	22
A	6	21
A	5	20
A	4	19
B	10	19
B	9	18
B	8	17.25
B	7	16.25
B	6	15.5
B	5	14.75
B	4	14

*Some draw weights are not attainable at certain draw lengths.

INITIAL BOW SETUP

Before you can safely and effectively shoot your bow, a number of specific initial bow setup steps must be taken. These steps can be performed on your own, if your level of expertise is adequate. Or, your local Bear Archery dealer can help you.

Arrow Rest Installation & Setup

Arrow rests should be installed according to the manufacturer's specifications. The first adjustment you need to perform is setting the vertical height of your arrow rest. When properly adjusted, your arrow rest should align the centerline of the arrow with the center of the two holes used to mount the rest to the riser. To check this, place an arrow in the rest and nocked on the string. Visually confirm the center of the arrow passes directly through the center of the arrow rest mounting holes when viewed from the side. If not, adjust your rest up or down to correct.

Next, the rest should be adjusted for proper "Center shot". With an arrow in the rest and nocked on the string, firmly hold another arrow against the inside of the riser near the arrow rest mounting holes as illustrated. Look down the arrows and verify that the arrows are parallel to each other. In other words, the spacing between the two arrows should be the same along the entire length of the arrows. If not, adjust your rest side to side to correct. This is only your "initial" center shot and additional fine tuning may be required depending on your shooting style and equipment. Please refer to the images on the next page for further reference.

Nocking Point and Nock Adjustment

Now that the initial center shot setting is complete, you need to verify your arrow nocking point. Install the nocking point or string loop on the bowstring so that when an arrow is nocked it creates a 90 degree angle to the string. Another option is to use a process similar to the one used to determine center shot. With an arrow in the rest and nocked on the string, firmly hold another arrow against the shelf of the riser as illustrated. Look down the arrows and verify that the arrows are parallel. In other words, the spacing between the two arrows should be the same along the entire length of the arrows. If not, adjust your nocking point up or down to correct.

At this time, adjust arrow fletch position to correspond with the arrow rest you are using. Such adjustments are done by simply rotating or replacing the arrow's nock. Carefully position the nock to provide proper fletch clearance through the arrow rest. Your local Bear Archery dealer can show you how to do this or can provide the service for you. Please refer to the images on the next page for further reference.

INITIAL BOW SETUP



Place arrow firmly against inside of riser shown.

Arrow rest should support the arrow in such a way that the arrow's centerline passes directly through the center of the two arrow rest mounting holes.

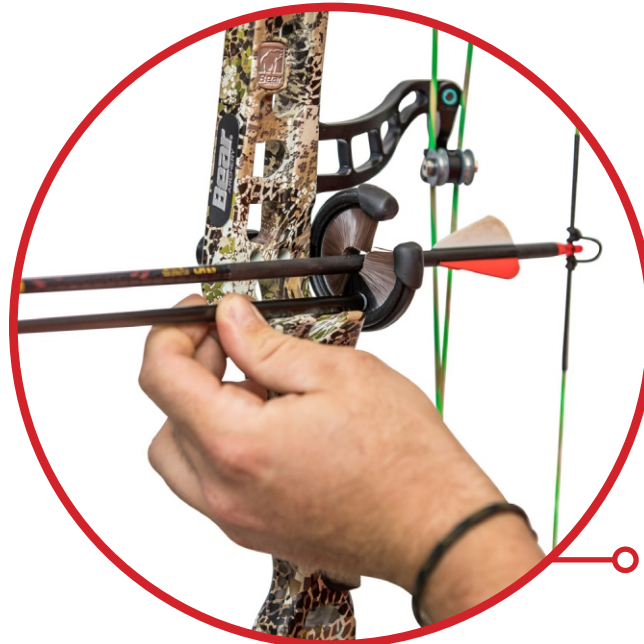

Arrows should be parallel along their entire length.

INITIAL BOW SETUP

Arrow Alignment

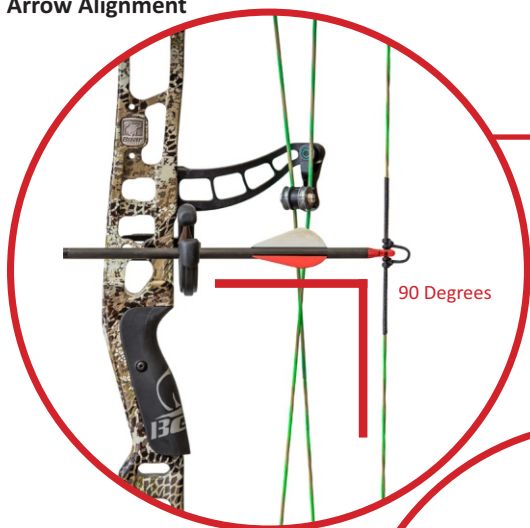

The arrow should make a 90 degree angle with the string.

Place arrow firmly against shelf of riser as shown.



Arrows should be parallel along their entire length.

INITIAL BOW SETUP

Sight Adjustment

When first sighting in your new bow or bow sight, the key thing to remember is “Chase the arrows”. In other words, if your arrows are hitting the target to the right of the bull’s-eye, move your sight to the right. If the arrows hit low on the target, lower your sight.



Arrow
Group

In the picture above, the arrows are hitting the target low and to the right of the bull’s-eye. To correct this, adjust your sight down and to the right. Remember, “Chase the arrows.”

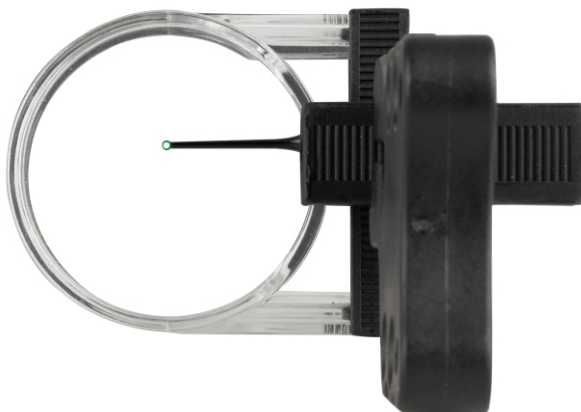

SAFETY GLASS ARROWS

WARNING

Arrow shafts can become damaged from impact with hard objects, animals, or other arrows. Damaged arrows could break upon release and injure you or other people. Carefully inspect each arrow shaft, nock, and other components for damage before each shot. Before shooting check shaft for nicks, cracks, splits or dents, or any other imperfections that could indicate damage to the arrow by flexing the arrow in a gradual arc. If an arrow has been damaged, **DO NOT** shoot the arrow again. Damaged arrows could break upon release and sharp arrow pieces could cause injury. Note: Maximum bow weight is printed on arrows. Never use arrows with a bow that exceeds the draw weight printed on the arrow. Do not shoot arrow if cracked or damaged.

GENERAL OPERATING INSTRUCTIONS.

- Always inspect your bow thoroughly before each shooting session to insure that it is in good working order. Check for worn or missing components and have them replaced as required, i.e. bushings, spacers, etc.
- Inspect your arrows to insure that they are straight and that each nock is in good condition. A cracked nock can break when fired from the bow and cause the bow to "dry fire" resulting in possible injury to the archer and damage to the bow.
- Only use safety arrows for this youth bow, replacement arrows can be purchased online from Bear Archery.

BOW MAINTENANCE

Your bow will give you many years of service if maintained and cared for properly.

- Keep synthetic cables and strings waxed. Apply bow string wax to your synthetic cables and string before each shooting session.
- Strings and cables must be replaced periodically. A worn cable or string can suddenly break causing serious injury to the archer and damage to the bow. It is recommended that the string and cables be replaced at least every 5,000 shots or 12 months.
- Always store your bow in a cool dry place. High temperatures, such as those that can occur in a truck or interior of a vehicle, can cause serious damage to your bow.

SAFETY

As with any weapon, safe operation of your bow must always be the highest priority.

ALWAYS WEAR SAFETY GLASSES WHEN HANDLING A BOW.

Do not attempt to use your bow without proper instruction. Doing so can result in serious injury.

- a. Never "dry-fire" any bow. Dry-fire is to draw and release the bowstring without an arrow on the string. Dry-firing will likely cause damage to the bow and serious injury to the archer.
- b. Always be sure of your intended target as well as what lies behind the target area. An arrow can travel a considerable distance, so it is important to have a safe and sound backstop.
- c. If you draw a bow and need to let it down, do so in a slow and careful manner. Keep your support arm straight and prepare for a rapid and violent let-down. Avoid hitting your hand on protruding accessories such as the cable guard or quiver. Keep your head and face back and out of danger during let-down. Never draw a bow with a peak weight above your comfort level. Always use a bow sling when drawing a bow.
- d. Never modify any part of the bow or its components by drilling extra holes or removing material. This voids the warranty and presents safety problems.

BEAR ARCHERY WARRANTY STATEMENT

All Bear Archery compound bows are backed with a limited lifetime warranty to the original owner. The warranty on this product is 3 years.

Original Owner

Warranty applies only to the original owner and is not transferable. Proof of purchase may be required.

Items Not Covered

Cables, strings, bearings, string suppressors, shockwave limb dampeners, paint and/or film dipped finishes resulting from normal wear and tear are not included in this warranty.

Damage Not Covered

Damage caused by abuse, mishandling, dry firing, alteration or modification made to original products are not covered under this warranty. The use of any bow press other than those approved by Bear Archery will void this warranty. Additionally, shooting of arrows less than 5 grains per pound of peak draw weight will void this warranty. Bear Archery reserves the right to make parts substitutions on warranty coverage at Bear Archery's sole discretion, for any reason.

Bow Warranty Registration

For this warranty to be in effect, the on-line warranty registration process must be completed at BearArchery.com and submitted within 30 days of purchase.

Traditional Bows

1 year Limited Warranty to the original owner.

Youth Bows

90 Day Limited Warranty to the original owner.

In the event a bow requires warranty service, please contact the Bear Archery Customer Department at 800-694-9494 for a return authorization (RA) number and return shipping instructions. For full warranty details, please log on to BearArcheryProducts.com for further information.

Key Contact data

Dealer 800 Number: 800-694-9494

Dealer Fax Number: 812-467-1245

Web: www.BearArchery.com

©2022 Bear Archery

AYS501PF - MAN2022