

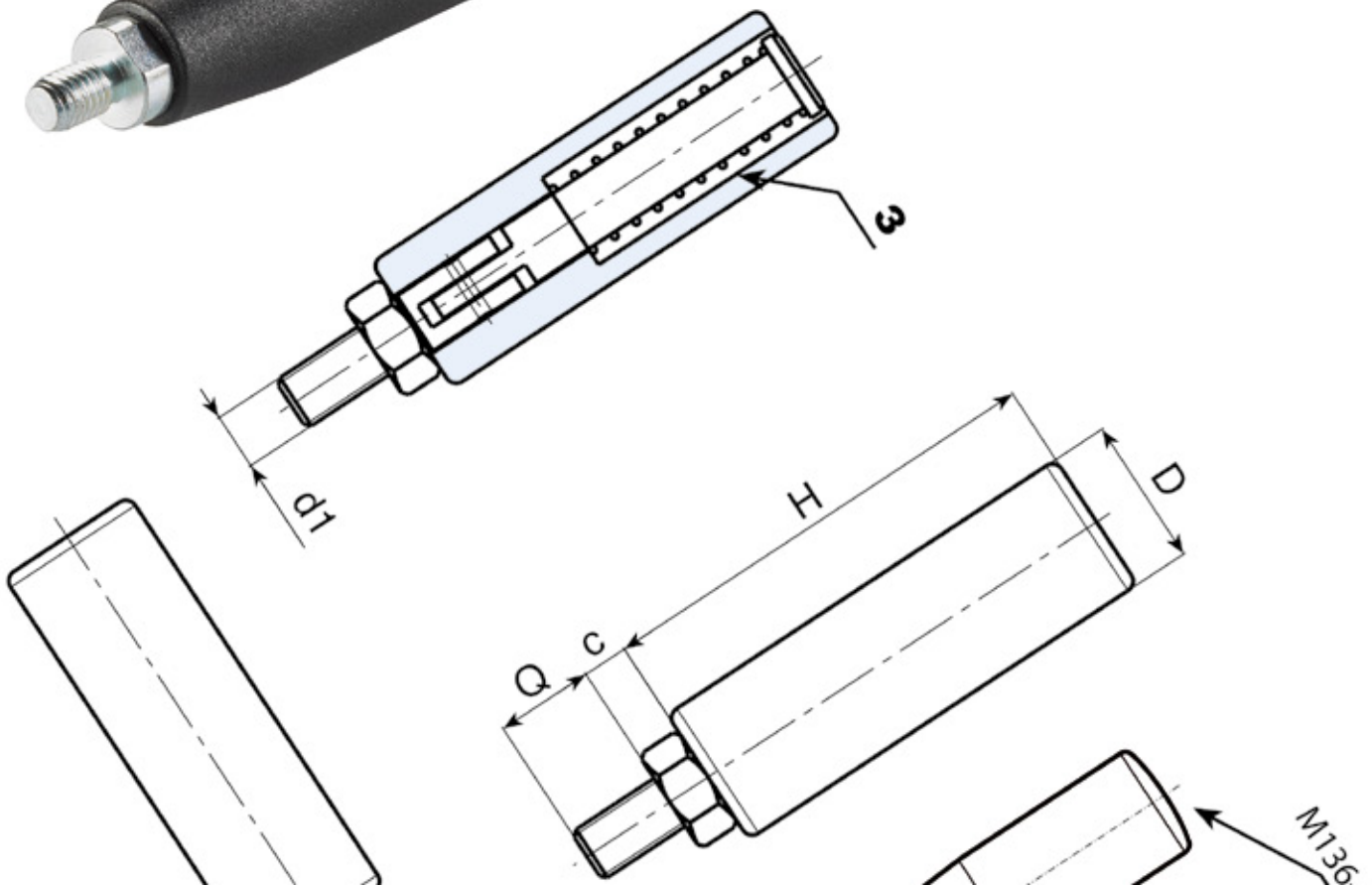

BOTTECO[®]

Family M

TAPERED AND REVOLVING HANDLES



M151



REVOLVING HANDLE WITH FIXED SCREW AND HEXAGON SOCKET HEAD

Material:
Reinforced polyamide.
Resistant to oils and greases.

Surface finish:
Satin.

Colour:
Black (RAL 9011).

Inserti:
Special turned nickel-plated screw, with partially threaded stud.
Hexagon socket head. (thread tolerance 6g).

SPECIAL REQUESTS:

- Upon request and for special quantities available in the colours indicated in the chart on page M-27.

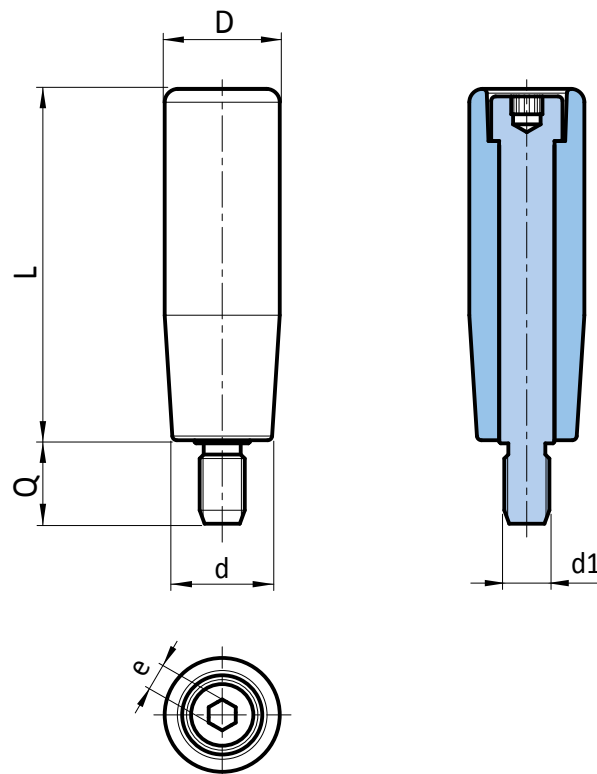

	art.	L	D	d	e	d1 6g	Q	g
●	M15150.TM08X1501H	49	20	15	5	M08	15	49
●	M15170.TM08X1701H	68	23	20	6	M08	17	79
●	M15170.TM10X1701H	68	23	20	6	M10	17	98
●	M15180.TM10X1801H	79	25	22	6	M10	18	119
●	M15190.TM10X1801H	90	28	22,5	8	M10	18	144

M138



HANDLE WITH THREADED HOLE

Material:

Reinforced polyamide.
Oils and greases resistant.

Surface:

Satin.

Colour:

Black (RAL 9011).

Hole:

Female threaded blind hole obtained by moulding the plastic. (tolerance in not applicable).

SPECIAL REQUEST:

- It is possible to supply colours as shown in the table at pag. M-27, on request and for quantities.

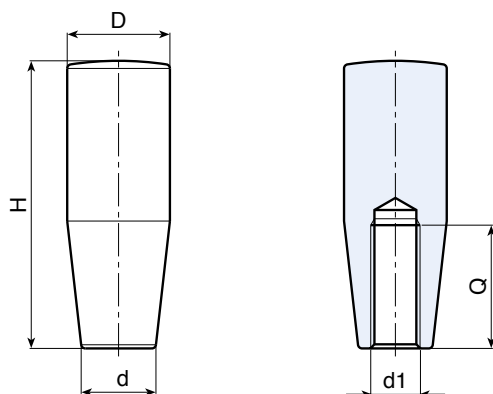

M

	art.	H	D	d	d1	Q	g
●	M13827.TM0401	27	14	10	M04	20	6
●	M13827.TM0501	27	14	10	M05	20	5
●	M13827.TM0601	27	14	10	M06	20	5
●	M13840.TM0501	40	18	16	M05	20	10
●	M13840.TM0601	40	18	16	M06	27	10
●	M13840.TM0801	40	18	16	M08	27	10
●	M13850.TM0601	50	20	15	M06	24	16
●	M13850.TM0801	50	20	15	M08	25	14
●	M13850.TM1001	50	20	15	M10	25	14
●	M13860.TM0801	60	23	18	M08	30	24
●	M13860.TM1001	60	23	18	M10	30	24
●	M13860.TM1201	60	23	18	M12	29	22
●	M13870.TM0801	70	25	19	M08	30	34
●	M13870.TM1001	70	25	19	M10	30	32
●	M13870.TM1201	70	25	19	M12	31	28
●	M13880.TM0801	80	26	21	M08	31	40
●	M13880.TM1001	80	26	21	M10	31	38
●	M13880.TM1201	80	26	21	M12	30	36
●	M13880.TM1401	80	26	21	M14	40	34
●	M13890.TM0801	90	27	22	M08	30	58
●	M13890.TM1001	90	27	22	M10	31	54
●	M13890.TM1201	90	27	22	M12	37	50
●	M13890.TM1401	90	27	22	M14	40	46
●	M138110.TM1001	109	32	27	M10	31	105
●	M138110.TM1201	109	32	27	M12	50	104
●	M138110.TM1401	109	32	27	M14	50	100

M238



“EUROMODEL” HANDLE WITH THREADED HOLE

Material:

Reinforced polyamide.
Oils and greases resistant.

Surface:

Satin.

Colour:

Black (RAL 9011).

Central Cap:

Grey polyamide (RAL 7035 cod. 13).

Alternative Cap Colour:

Orange (RAL 2004 cod. 02)
Blue (RAL 5015 cod. 07)
Yellow (RAL 1021 cod. 10)
Red (RAL 3000 cod. 16)
Green (RAL 6024 cod. 17)
Black (RAL 9011 cod. 01)

Hole:

Female threaded blind hole obtained by moulding the plastic. (tolerance in not applicable).



SPECIAL REQUEST:

- It is possible to supply colours as shown in the table at pag. M-27, on request and for quantities.

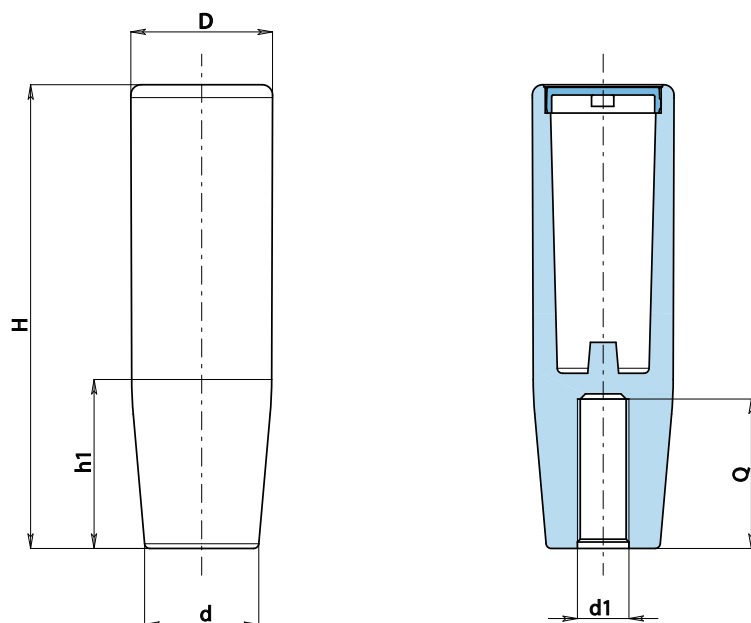

	art.	H	D	d	h1	d1	Q	g
●	M23890.TM080113	89,5	27	22	32	M08	30	40
●	M23890.TM100113	89,5	27	22	32	M10	30	39
●	M23890.TM120113	89,5	27	22	32	M12	30	37

Presumable presence in the stock in %

90% ● 40% ● 5% ●

M139



HANDLE WITH SMOOTH RIGHT THROUGH HOLE

Material:

Reinforced polyamide.
Oils and greases resistant.

Surface:

Satin.

Colour:

Black (RAL 9011).

Hole:

Smooth right through hole obtained by moulding the plastic (tolerance in not applicable).

SPECIAL REQUEST:

- It is possible to supply colours as shown in the table at pag. M-27, on request and for quantities.

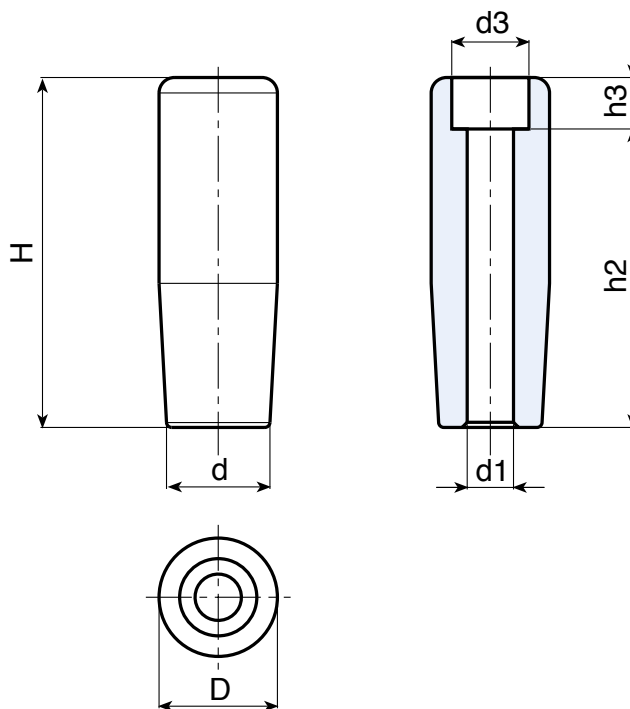

	art.	H	D	d	h2	h3	d1	d3	g
●	M13950.TG06,501	49	20	15	42,5	6,5	6,5	11	13
●	M13950.TG08,501	49	20	15	42,5	6,5	8,5	11	10
●	M13960.TG06,501	59	21	19	51	8	6,5	12	23
●	M13960.TG08,501	59	21	19	49	10	8,5	14	20
●	M13970.TG08,501	68	23	20	57,5	10,5	8,5	14	28
●	M13970.TG10,501	68	23	20	56	12	10,5	17	25
●	M13980.TG10,501	79	25	22	67	12	10,5	17	38
●	M13990.TG08,501	90	28	22,5	80,5	9,5	8,5	14	46
●	M13990.TG12,501	90	28	22,5	76	14	12,5	19	42

M141



CYLINDRICAL HANDLE WITH SMOOTH RIGHT THROUGH HOLE

Material:
Reinforced polyamide.
Oils and greases resistant.

Surface:
Satin.

Colour:
Black (RAL 9011).

Hole:
Smooth right through hole obtained by moulding the plastic (tolerance in not applicable).

SPECIAL REQUEST:

- It is possible to supply colours as shown in the table at pag. M-27, on request and for quantities.

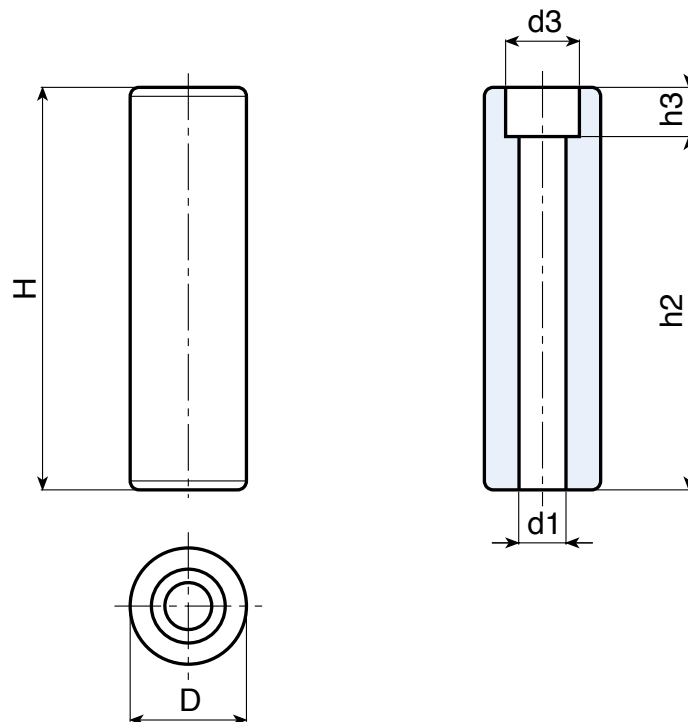

	art.	H	D	h2	h3	d1	d3	Δ g
●	M14182.TG10,501	80	26	69	11	10,5	16,5	44
●	M14190.TG10,501	89	26	78	11	10,5	16,5	51

M140



HANDLE WITH THREADED STUD

Material:

Reinforced polyamide. Oils and greases resistant.

Surface:

Satin.

Colour:

Black (RAL 9011).

Main Insert:

Zinc plated steel threaded stud (tolerance 6g).

SPECIAL REQUEST:

- It is possible to supply inserts in different lengths or by special design, on request and for quantities.
- It is possible to supply inserts in different materials, on request and for quantities.
- It is possible to supply colours as shown in the table at pag. M-27, on request and for quantities.

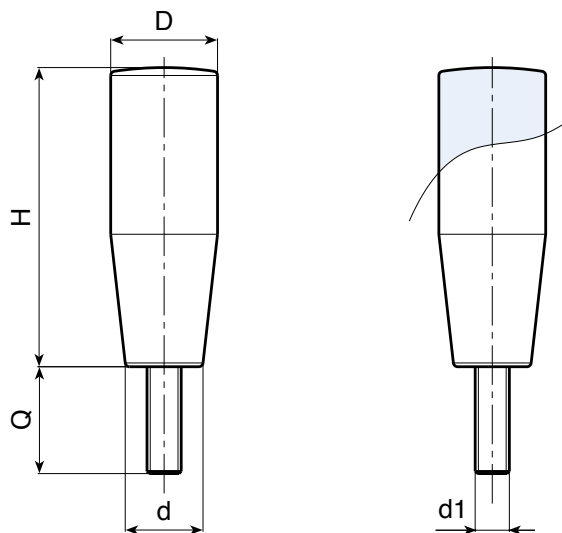

art.	H	D	d	LM	d1 6g	Q	g
M14027.TM04X2001	27	14	10	30	M04	20	10
M14027.TM05X2001	27	14	10	30	M05	20	15
M14027.TM06X2001	27	14	10	30	M06	20	20
M14040.TM05X2001	40	18	15,5	30	M05	20	20
M14040.TM06X..01	40	18	15	30	M06	10-16-25	18-19-21
M14050.TM06X..01	50	20	15	35	M06	10-20	24-27
M14050.TM08X..01	50	20	15	35	M08	10-15-20	34-32-30
M14060.TM06X2001	60	23	17,5	35	M06	20	40
M14060.TM08X..01	60	23	17,5	35	M08	10-20-30	34-42-50
M14060.TM10X1501	60	23	17,5	35	M10	15	40
M14070.TM08X..01	70	25	18	35	M08	10-20-30	51-54-57
M14080.TM08X..01	80	26	21	35	M08	10-20-25	74-77-78,5
M14080.TM10X..01	80	26	21	35	M10	10-20-30	84-86-88
M14090.TM08X..01	90	27	22	35	M08	10-20	74-77
M14090.TM10X..01	90	27	22	35	M10	10-20-30	95-100-105
M14090.TM12X..01	90	27	22	40	M12	20-30	104-112
M140110.TM12X2001	109	32	27	80	M12	20	162
M140110.TM14X..01	109	32	27	80	M14	A.R.	-

Enter the stud length choice in the two .. of the article code. Lengths by request with 100 pieces minimum quantity.

LM = Maximum mouldable length.

A.R.= By request with 100 pieces minimum.

M240



“EUROMODEL” HANDLE WITH THREADED STUD

Material:

Reinforced polyamide. Oils and greases resistant.

Surface:

Satin.

Colour:

Black (RAL 9011).

Central Cap:

Grey polyamide (RAL 7035 cod. 13).

Alternative Cap Colour:

- Orange (RAL 2004 cod. 02)
- Blue (RAL 5015 cod. 07)
- Yellow (RAL 1021 cod. 10)
- Red (RAL 3000 cod. 16)
- Green (RAL 6024 cod. 17)
- Black (RAL 9011 cod. 01)

Main Insert:

Zinc plated steel threaded stud (tolerance 6g).



SPECIAL REQUEST:

- It is possible to supply inserts in different lengths or by special design, on request and for quantities.
- It is possible to supply inserts in different materials, on request and for quantities.
- It is possible to supply colours as shown in the table at pag. M-27, on request and for quantities.

Studs lengths already setup on the tool:

For all threaded size:

10-15-20-25-30-35-40-45-50-55-60-65-70-75-80

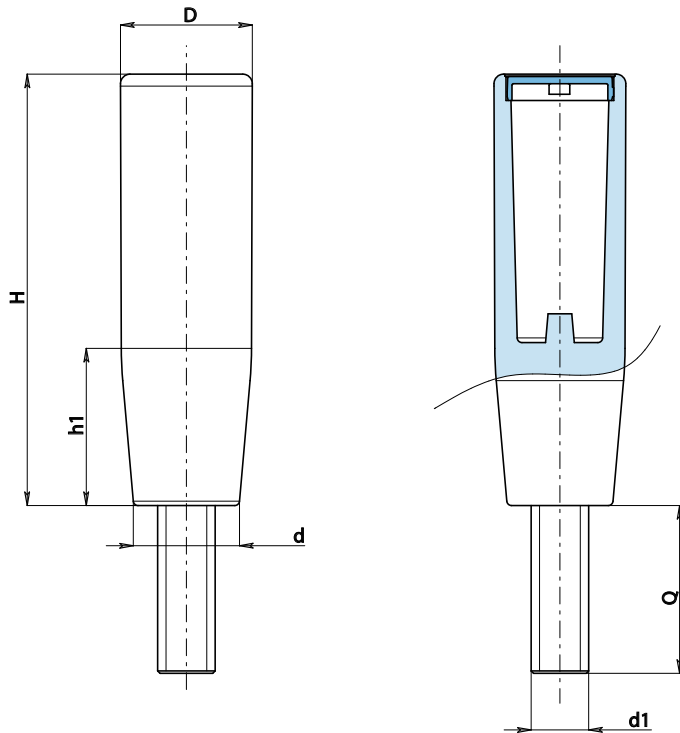

art.	H	D	d	h1	LM	d1 6g	Q	g
M24090.TM08X..0113	89,5	27	22	32	80	M08	10-15	65-66,5
M24090.TM10X..0113	89,5	27	22	32	80	M10	10-20	70-75
M24090.TM12X200113	89,5	27	22	32	80	M12	20	83

Enter the stud length choice in the two .. of the article code. Lengths by request with 100 pieces minimum quantity.

LM = Maximum mouldable length.

Presumable presence in the stock in %
 90% ● 40% ● 5% ●



M144



REVOLVING HANDLE WITH SCREW AND NUT

Material:

Reinforced polyamide.
Oils and greases resistant.

Surface:

Satin.

Colour:

Black (RAL 9011).

Inserts:

M144:

- (1) Threaded black- oxide steel screw DIN 912.
- (2) Threaded black- oxide steel nut DIN 934.

M144CIN:

- (1) Threaded stainless steel screw DIN 912, (Aisi304).
- (2) Threaded stainless steel nut DIN 934, (Aisi304).

SPECIAL REQUEST:

- It is possible to supply inserts in different materials, on request and for quantities.
- It is possible to supply colours as shown in the table at pag. M-27, on request and for quantities.

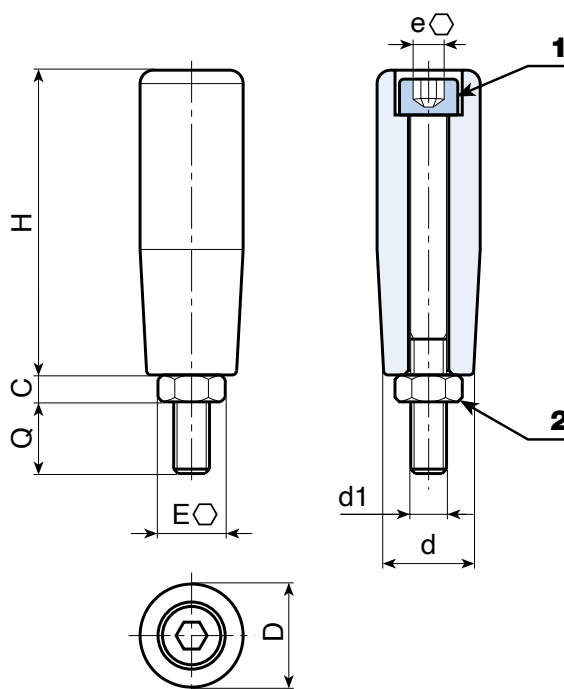

Version M144 - Zinc-plated steel version

art.	H	D	d	c	E	e	d1 6g	Q	g
M14450.TM06X0901	49	20	17	5	10	05	M06	09	30
M14450.TM08X1401	49	20	17	6,5	10	05	M08	14	32
M14460.TM08X1501	59	21	19	6,5	13	06	M08	15	56
M14470.TM08X1601	68	23	20	6,5	17	08	M08	16	68
M14470.TM10X1601	68	23	20	8	17	08	M10	16	92
M14480.TM10X1501	79	25	22	8	17	08	M10	15	110
M14490.TM12X1701	89	28	24,5	7	19	10	M12	17	150

Version M144 CIN - Stainless steel version

INOX

art.	H	D	d	c	E	e	d1 6g	Q	g
M14450.TM06X1401CIN	49	20	17	5	10	05	M06	14	30
M14450.TM08X1401CIN	49	20	17	6,5	10	05	M08	14	32
M14460.TM08X1501CIN	59	21	19	6,5	13	06	M08	15	56
M14470.TM08X1601CIN	68	23	20	6,5	17	08	M08	16	68
M14470.TM10X1601CIN	68	23	20	8	17	08	M10	16	92
M14480.TM10X1501CIN	79	25	22	8	17	08	M10	15	110
M14490.TM12X1701CIN	89	28	24,5	7	19	10	M12	17	150

M129



REVOLVING HANDLE WITH HEXAGON SOCKET HEAD SCREW

Material:

Reinforced polyamide.
Oils and greases resistant.

Surface:

Satin.

Colour:

Black (RAL 9011).

Revolving Insert:

M129:

Revolving zinc-plated steel threaded stud, with hexagon socket head and steel rotative spring ring, (thread tolerance 6g).

M129CIN:

Revolving stainless steel threaded stud (Aisi 303), with hexagon socket head and stainless steel rotative spring ring, (thread tolerance 6g).

SPECIAL REQUEST:

- It is possible to supply colours as shown in the table at pag. M-27, on request and for quantities.

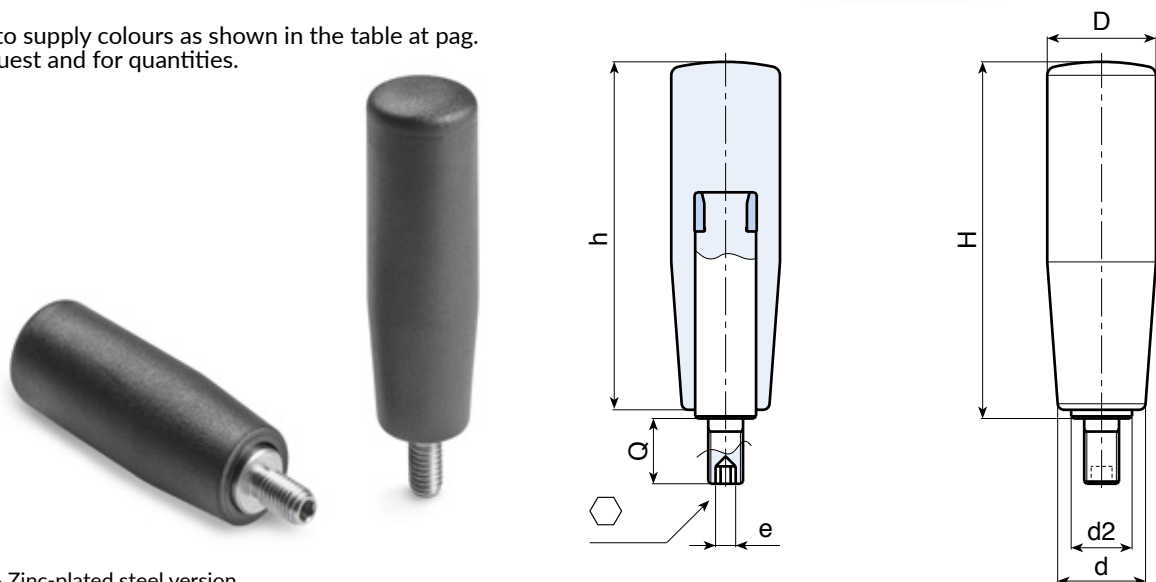

Version M129 - Zinc-plated steel version

art.	H	D	h	d	d2	e	d1 6g	Q	Δ g
M12950.TM06X1201	51,5	20	50	15	10	3	M06	12	42
M12960.TM06X1201	61,5	23	60	18	10	3	M06	12	54
M12960.TM08X1501	61,5	23	60	18	10	4	M08	15	60
M12970.TM08X1501	71,5	25	70	19	10	4	M08	15	92
M12970.TM10X1501	71,5	25	70	19	10	4	M10	15	94
M12980.TM08X1501	81,5	26	80	21	14	4	M08	15	98
M12980.TM10X1501	81,5	26	80	21	14	5	M10	15	104
M12980.TM12X1501	81,5	26	80	21	14	5	M12	15	104
M12990.TM10X1501	91,5	27	90	22	14	5	M10	15	118
M12990.TM12X1501	91,5	27	90	22	14	5	M12	15	120

Version M129 CIN - Stainless steel version

art.	H	D	h	d	d2	e	d1 6g	Q	Δ g
M12950.TM06X1201CIN	51,5	20	50	15	10	3	M06	12	42
M12960.TM06X1201CIN	61,5	23	60	18	10	3	M06	12	54
M12960.TM08X1501CIN	61,5	23	60	18	10	4	M08	15	60
M12970.TM08X1501CIN	71,5	25	70	19	10	4	M08	15	92
M12970.TM10X1501CIN	71,5	25	70	19	10	4	M10	15	94
M12980.TM08X1501CIN	81,5	26	80	21	14	4	M08	15	98
M12980.TM10X1501CIN	81,5	26	80	21	14	5	M10	15	104
M12980.TM12X1501CIN	81,5	26	80	21	14	5	M12	15	104
M12990.TM10X1501CIN	91,5	27	90	22	14	5	M10	15	118
M12990.TM12X1501CIN	91,5	27	90	22	14	5	M12	15	120

INOX

Presumable presence in the stock in %
 90% ● 40% ● 5% ●

M229



“EUROMODEL” REVOLVING HANDLE WITH HEXAGON SOCKET HEAD SCREW

Material:
Reinforced polyamide.
Oils and greases resistant.

Surface:
Satin.

Colour:
Black (RAL 9011).

Central Cap:
Grey polyamide (RAL 7035 cod. 13).

Alternative Cap Colour:
Orange (RAL 2004 cod. 02)
Blue (RAL 5015 cod. 07)
Yellow (RAL 1021 cod. 10)
Red (RAL 3000 cod. 16)
Green (RAL 6024 cod. 17)
Black (RAL 9011 cod. 01)

Revolving Insert:
M229:
Revolving zinc-plated steel threaded stud, with hexagon socket head and brass rotative ring. (thread tolerance 6g).
M229 CIN:
Revolving stainless steel threaded stud (AISI 303), with hexagon socket head and brass rotative ring. (thread tolerance 6g).

SPECIAL REQUEST:

- It is possible to supply colours as shown in the table at pag. M-27, on request and for quantities.

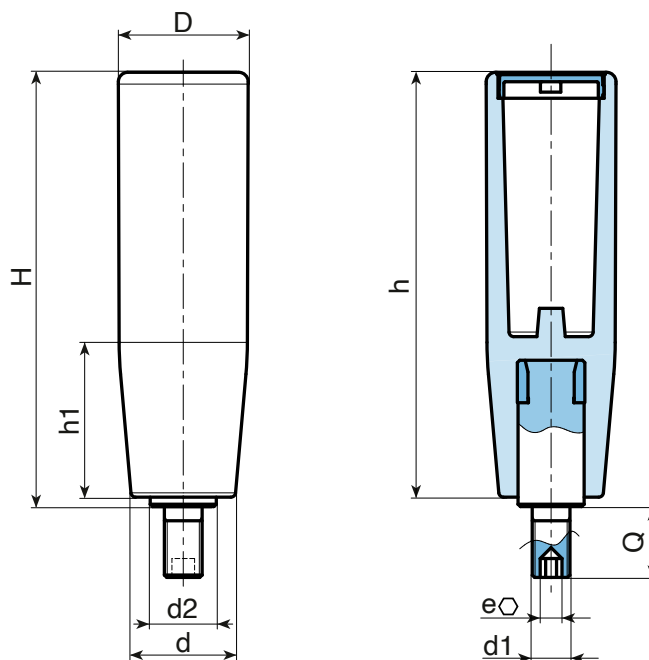

INOX



Version M229 - Zinc-plated steel version

art.	H	D	d	d2	e	h	h1	d1 6g	Q	Δ g
M22990.TM10X150113	91,5	27	22	14	5	89,5	32	M10	15	78
M22990.TM12X150113	91,5	27	22	14	5	89,5	32	M12	15	82

Version M229 CIN - Stainless steel version

art.	H	D	d	d2	e	h	h1	d1 6g	Q	Δ g
M22990.TM10X150113CIN	91,5	27	22	14	5	89,5	32	M10	15	78
M22990.TM12X150113CIN	91,5	27	22	14	5	89,5	32	M12	15	82

INOX

M245



“EUROMODEL” REVOLVING HANDLE WITH RING NUT

Material:

Reinforced polyamide.
Oils and greases resistant.

Surface:

Satin.

Colour:

Black (RAL 9011).

Central Cap:

Grey polyamide (RAL 7035 cod. 13).

Alternative Cap Colour:

Orange (RAL 2004 cod. 02)
Blue (RAL 5015 cod. 07)
Yellow (RAL 1021 cod. 10)
Red (RAL 3000 cod. 16)
Green (RAL 6024 cod. 17)
Black (RAL 9011 cod. 01)

Revolving Insert:

M245:

Revolving zinc-plated steel threaded stud, with ring nut with wrench seat and brass rotative ring. (thread tolerance 6g).

M245 CIN:

Revolving stainless steel threaded stud (AISI 303), with ring nut with wrench seat and brass rotative ring. (thread tolerance 6g).

SPECIAL REQUEST:

- It is possible to supply colours as shown in the table at pag. M-27, on request and for quantities.

INOX

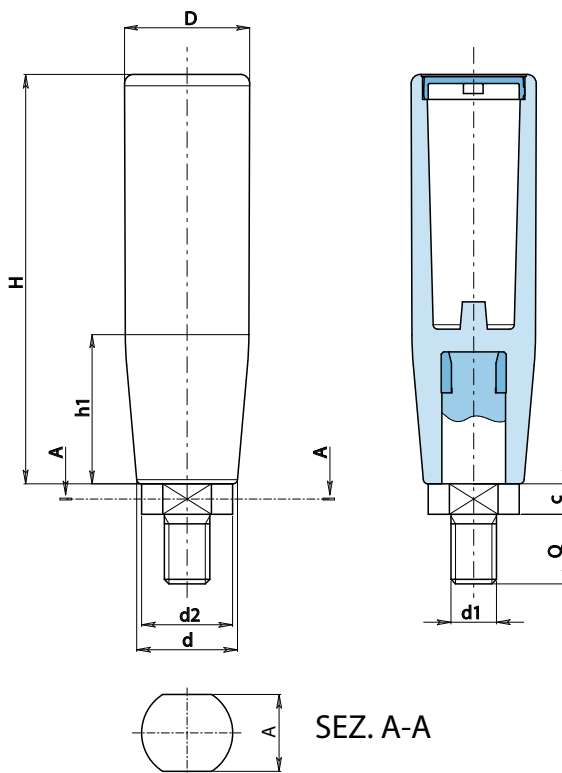

Versione M245 - Zinc-plated steel version

art.	H	D	d	A	c	h1	d1 6g	Q	⚖ g
● M24590.TM10X150113	89,5	27	22	17	7	32	M10	15	89
● M24590.TM12X150113	89,5	27	22	17	7	32	M12	15	89

Versione M245 CIN - Stainless steel version

art.	H	D	d	A	c	h1	d1 6g	Q	⚖ g
● M24590.TM10X150113CIN	89,5	27	22	17	7	32	M10	15	89
● M24590.TM12X150113CIN	89,5	27	22	17	7	32	M12	15	89

INOX

Presumable presence in the stock in %
 90% ● 40% ● 5% ●

M145



REVOLVING HANDLE WITH RING NUT

Material:

Reinforced polyamide. Oils and greases resistant.

Surface:

Satin.

Colour:

Black (RAL 9011).

Revolving Insert:

M145:

Revolving zinc-plated steel threaded stud, with hexagon socket head and steel rotative spring ring, (thread tolerance 6g).

M145CIN:

Revolving stainless steel threaded stud (Aisi 303), with hexagon socket head and stainless steel rotative spring ring, (thread tolerance 6g).



SPECIAL REQUEST:

- It is possible to supply colours as shown in the table at pag. M-27, on request and for quantities.

M

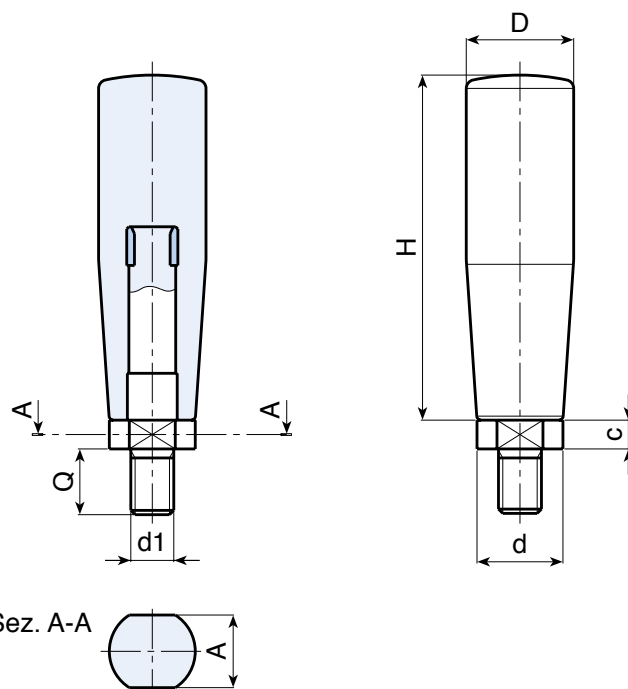

Version M145 - Zinc-plated steel version

art.	H	D	d	c	A	d1 6g	Q	g
M14550.TM06X1201	50	20	12	5	10	M06	12	32
M14560.TM08X1501	60	23	14	7	13	M08	15	74
M14570.TM08X1501	70	25	14	7	13	M08	15	82
M14570.TM10X1501	70	25	14	7	13	M10	15	86
M14580.TM10X1501	80	26	18	6,5	16	M10	15	92
M14580.TM12X1501	80	26	18	6,5	16	M12	15	96
M14590.TM10X1501	90	27	18	6,5	16	M10	15	104
M14590.TM12X1501	90	27	18	6,5	16	M12	15	108

Version M145 CIN - Stainless steel version

art.	H	D	d	c	A	d1 6g	Q	g
M14550.TM06X1201CIN	50	20	12	5	10	M06	12	32
M14560.TM08X1501CIN	60	23	14	7	13	M08	15	74
M14570.TM08X1501CIN	70	25	14	7	13	M08	15	82
M14570.TM10X1501CIN	70	25	14	7	13	M10	15	86
M14580.TM10X1501CIN	80	26	18	6,5	16	M10	15	92
M14580.TM12X1501CIN	80	26	18	6,5	16	M12	15	96
M14590.TM10X1501CIN	90	27	18	6,5	16	M10	15	104
M14590.TM12X1501CIN	90	27	18	6,5	16	M12	15	108

INOX

M136



BLACK-OXIDE STEEL AND STAINLESS STEEL REVOLVING AND FOLDING HANDLE

Material:

Reinforced polyamide.
Oils and greases resistant.

Surface:

Satin.

Colour:

Black (RAL 9011).

Inserts:

M136

- 1) Black-oxide treated steel revolving and folding mechanism with head for screwdriver fitting.
- 2) Black-oxide treated steel nut DIN 934.
- 3) Zinc-plated steel spring.

M136 CIN

- 1) Stainless steel revolving and folding mechanism (AISI 303) with head for screwdriver fitting.
- 2) Stainless steel nut (AISI 304) DIN 934.
- 3) Stainless steel spring.



SPECIAL REQUEST:

- It is possible to supply the inserts with a zinc-plated complete treatment, (just add CVZ letters on the end of standard code for black-oxide).
- It is possible to supply colours as shown in the table at pag. M-27, on request and for quantities.



INOX

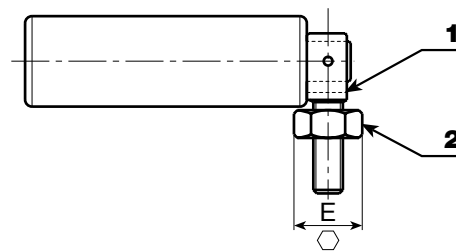
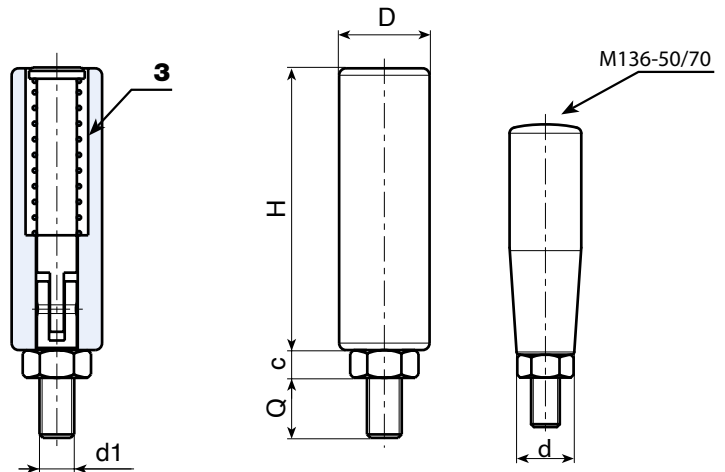

Version M136 - Black-oxide version

art.	H	D	d	E	c	d1 6g	Q	g	F1 (N)
M13650.TM06X0901	49	20	15	10	5	M06	9	39	270
M13670.TM08X1001	69	25	19	13	6,5	M08	10	71	840
M13682.TM10X1501	81	26	-	17	8	M10	15	152	1700
M13690.TM10X1501	89	26	-	17	8	M10	15	160	2700

Version M136 CIN - Stainless steel version

art.	H	D	d	E	c	d1 6g	Q	g	F1 (N)
M13650.TM06X0901CIN	49	20	15	10	5	M06	9	39	270
M13670.TM08X1001CIN	69	25	19	13	6,5	M08	10	71	840
M13682.TM10X1501CIN	81	26	-	17	8	M10	15	152	1700
M13690.TM10X1501CIN	89	26	-	17	8	M10	15	160	2700

INOX

Presumable presence in the stock in %
90% ● 40% ● 5% ●

M336



FULL STEEL REVOLVING, FOLDING HANDLE

Material:

M336: Automatic steel, (AVP).

M336CIN: Stainless steel, (Aisi 303).

Surface finish:

M336: Fine turned, galvanised.

M336CIN: Fine turned, natural.

Colour:

Black (RAL 9011).

Inserts:

M336:

- (1) Zinc plated steel revolving and folding mechanism with head for screwdriver fitting.
- (2) Zinc plated steel threaded nut DIN 934.
- (3) Zinc plated steel spring.

M336 CIN:

- (1) Stainless steel revolving and folding mechanism (AISI 303) with head for screwdriver fitting.
- (2) Stainless steel (Aisi 304), threaded nut DIN 934.
- (3) Stainless steel spring.



SPECIAL REQUEST:

- None.

M

INOX

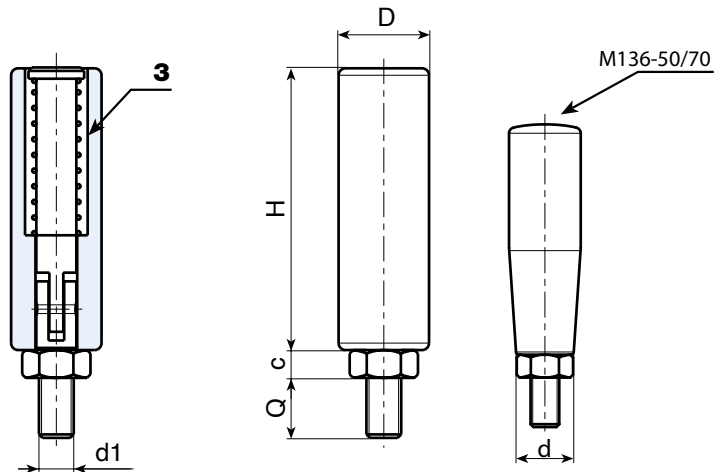

Version M336 - Zinc plated version

art.	H	D	d	E	c	d1 6g	Q	g	F1 (N)
M33650.VZM06X09	49	20	15	10	5	M06	9	-	270
M33670.VZM08X10	69	25	19	13	6,5	M08	10	-	840
M33682.VZM10X15	81	26	-	17	8	M10	15	-	1700
M33690.VZM10X15	89	26	-	17	8	M10	15	-	2700

Version M336 CIN - Stainless steel version

art.	H	D	d	E	c	d1 6g	Q	g	F1 (N)
M33650.INM06X09CIN	49	20	15	10	5	M06	9	-	270
M33670.INM08X10CIN	69	25	19	13	6,5	M08	10	-	840
M33682.INM10X15CIN	81	26	-	17	8	M10	15	-	1700
M33690.INM10X15CIN	89	26	-	17	8	M10	15	-	2700

INOX

M204 CIN



INOX

REVOLVING AND FOLDING HANDLE WITH ROUND STAINLESS STEEL BASE

Material:

Reinforced polyamide.
Oils and greases resistant.

Surface:

Satin.

Colour:

Black (RAL 9011).

Inserts:

- (1) Stainless steel (AISI 303) revolving and folding mechanism.
- (2) Stainless steel (AISI 304) reference pin DIN934.
- (3) Stainless steel spring.

SPECIAL REQUEST:

- It is possible to supply colours as shown in the table at pag. M-29, on request and for quantities.
- It is possible to supply the mechanism:
 - on black-oxide treatment (change CIN with ZB at the end of the code),
 - on zinc-plated steel treatment (change CIN with CVZ at the end of the code),
 - on AISI 304 (change CIN with CIH at the end of the code).

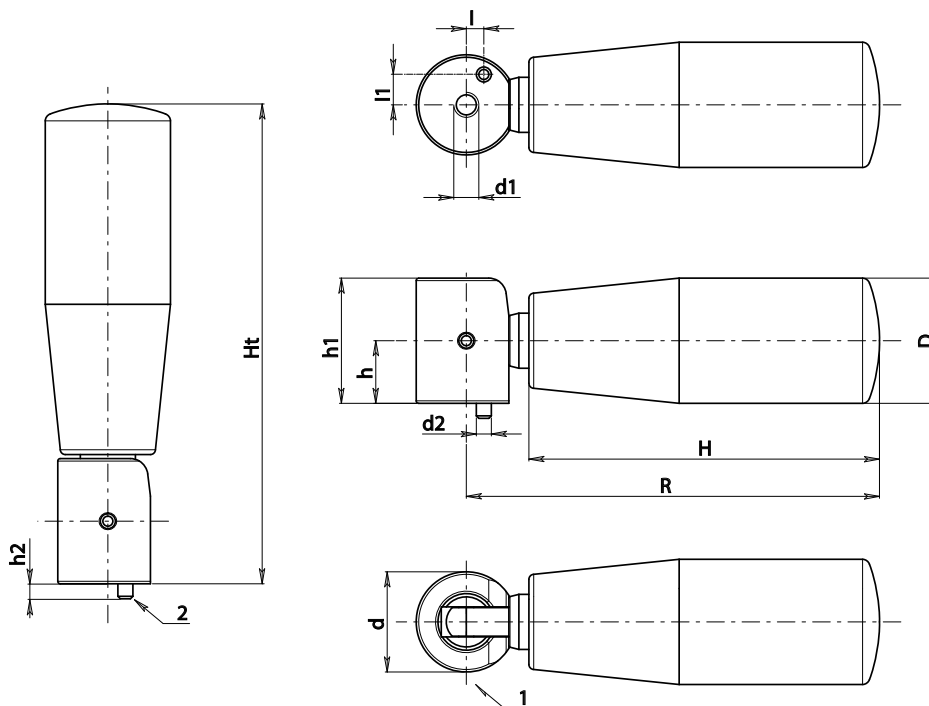

art.	H	D	d	R	Ht	h	h1	h2	d1	d2	l	l1	Δ g
M20470.TM0501CIN	70	25	19	82,5	96	12,5	25	3	M05	3	3,5	6,1	114
M20480.TM0501CIN	80	26	21	92,5	106	12,5	25	3	M05	3	3,5	6,1	145

M202



“EUROMODEL” REVOLVING HANDLE WITH SCREW AND BUSH ADAPTER

Material:

Reinforced polyamide. Oils and greases resistant.

Surface:

Satin.

Colour:

Black (RAL 9011).

Central Cap:

(1) Grey polyamide (RAL 7035 cod. 13).

Alternative Cap Colour:

Orange (RAL 2004 cod. 02)

Blue (RAL 5015 cod. 07)

Yellow (RAL 1021 cod. 10)

Red (RAL 3000 cod. 16)

Green (RAL 6024 cod. 17)

Black (RAL 9011 cod. 01)



Inserts:

(2) Zinc-plated steel screw DIN 912/UNI 5931.

(3) Zinc plated steel adapter bush with through-hole.

CAUTION: The handle is delivered unassembled and packaged separately.

SPECIAL REQUEST:

- It is possible to supply inserts in different lengths or by special design, on request and for quantities.
- It is possible to supply inserts in different materials, on request and for quantities.
- It is possible to supply colours as shown in the table at pag. M-27, on request and for quantities.

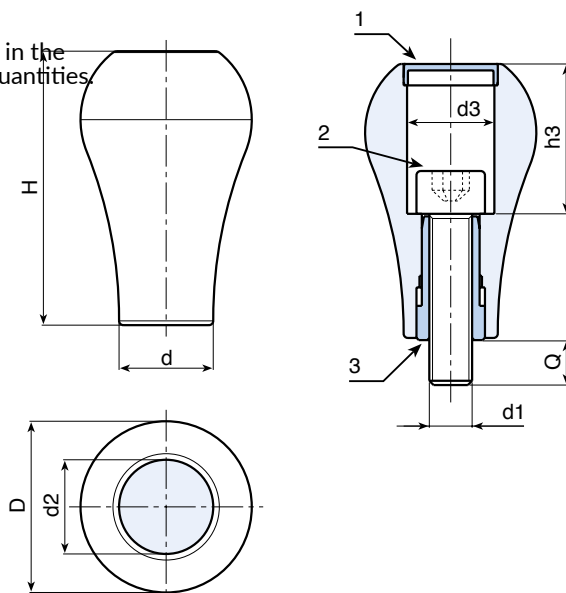

	art.	H	D	d	d2	d3	h3	d1 6g	Q	⚖ g
●	M20264.TM08X1101Z1	64	40	22,5	22	20,5	34,5	M08	11	95
●	M20264.TM10X1101Z1	64	40	22,5	22	20,5	34,5	M10	11	95

M135



ROUNDED HANDLE WITH SELF-FIX HOLE

Material:

Reinforced polyamide.
Oils and greases resistant.

Surface:

Satin.

Colour:

Black (RAL 9011).

Hole:

Female smooth hole, with special deformable fixing ribs, obtained by moulding the plastic.

Fixing:

Push fit.

SPECIAL REQUEST:

- It is possible to supply the handle with a threaded blind hole, on request and for quantities. (change TG with TM on the art. code).
- It is possible to supply the handle with d1 diameter by customer design, on request and for quantities.
- It is possible to supply colours as shown in the table at pag. M-27, on request and for quantities.
ATTENTION: Reduced colour range.

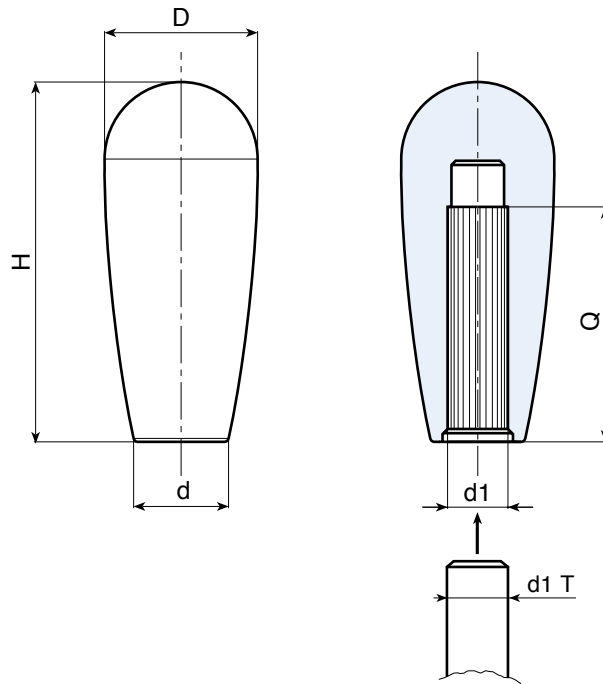

Version TM - With threaded bore

art.	H	D	d	d1	Q	g
M13583.TM1001	84	35	22	M10	58	64

Version TG - With self-fix bore

art.	H	D	d	d1 T	d1	Q	g
M13583.TG1001	84	35	22	+0 -0,058	10	50	64
M13583.TG1201	84	35	22	+0 -0,070	12	50	62
M13583.TG1401	84	35	22	+0 -0,070	14	50	59

Presumable presence in the stock in % **90%** ● **40%** ● **5%** ●

M128



GEAR STICK HANDLE

Material:

Reinforced polyamide.
Oils and greases resistant.

Surface:

Satin.

Colour:

Black (RAL 9011).

Hole:

Female smooth hole, with special deformable fixing ribs, obtained by moulding the plastic.

Fixing:

Push fit.

SPECIAL REQUEST:

- It is possible to supply the handle with d1 diameter by customer design, on request and for quantities.
- It is possible to supply colours as shown in the table at pag. M-27, on request and for quantities.
ATTENTION: Reduced colour range.

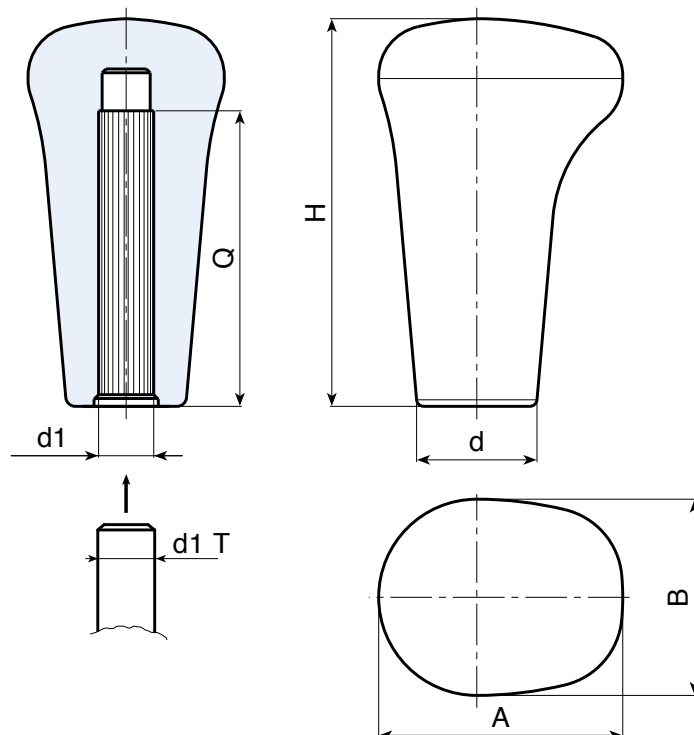

	art.	H	A	B	d	d1 T	d1	Q	g
●	M12880.TG1201	80	50	40	26	+0 -0,058	12	58	64
●	M12880.TG1401	80	50	40	26	+0 -0,070	14	62	62
●	M12880.TG1601	80	50	40	26	+0 -0,070	16	60	59

M510



HANDLE WITH SELF-FIX HOLE

Material:

Blend of polypropylene and thermoplastic rubber TPV.

Surface:

Glossy.

Colour:

Black (RAL 9011).

Hole:

Female smooth hole, obtained by moulding the plastic.

Fixing:

Push fit.

SPECIAL REQUEST:

- None.

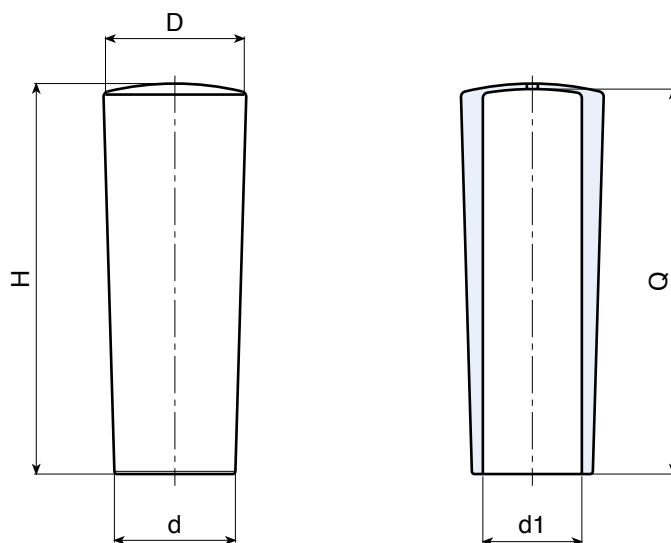

	art.	H	D	d	d1	Q	⚖ g
●	M51034.TG0801	34	16	14	8	32	4
●	M51034.TG0901	34	16	14	9	32	3
●	M51038.TG1001	38	18	15,5	10	35	6
●	M51038.TG1101	38	18	15,5	11	35	5
●	M51043.TG1201	43	20	16	12	40	7
●	M51048.TG1401	48	23	18	14	44	10
●	M51062.TG1601	62	25	20	16	59	12
●	M51072.TG1801	72	27	22	18	69	16
●	M51079.TG2001	79	30	24	20	76	20

Presumable presence in the stock in % 
 90% ● 40% ● 5% ●

M146



HANDLE WITH SELF-FIX HOLE

Material:

Reinforced polyamide.
Oils and greases resistant.

Surface:

Satin.

Colour:

Black (RAL 9011).

Hole:

Female smooth hole, with special deformable fixing ribs, obtained by moulding the plastic.

Fixing:

Push fit.

SPECIAL REQUEST:

- It is possible to supply colours as shown in the table at pag. M-27, on request and for quantities.

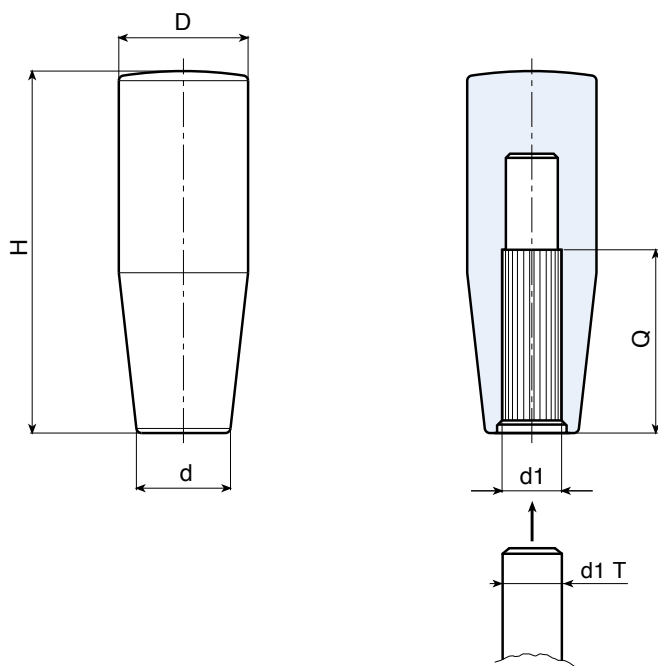

	art.	H	D	d	d1 T	d1	Q	⚖ g
●	M14650.TG0801	50	20	15	+0 -0,058	08	38	14
●	M14650.TG1001	50	20	15	+0 -0,058	10	38	12
●	M14660.TG0801	60	23	17	+0 -0,058	08	50	24
●	M14660.TG1001	60	23	17	+0 -0,058	10	50	20
●	M14660.TG1201	60	23	17	+0 -0,070	12	50	20
●	M14670.TG0801	70	25	19	+0 -0,058	08	50	32
●	M14670.TG1001	70	25	19	+0 -0,058	10	54	30
●	M14670.TG1201	70	25	19	+0 -0,070	12	54	28
●	M14680.TG1001	80	26	21	+0 -0,058	10	54	40
●	M14680.TG1201	80	26	21	+0 -0,070	12	54	38
●	M14680.TG1401	80	26	21	+0 -0,070	14	50	34
●	M14690.TG1201	91	27	22,5	+0 -0,070	12	54	46
●	M14690.TG1401	91	27	22,5	+0 -0,070	14	71	42

M246



“EUROMODEL” HANDLE WITH SELF-FIX HOLE

Material:

Reinforced polyamide. Oils and greases resistant.

Surface:

Satin.

Colour:

Black (RAL 9011).

Central Cap:

Grey polyamide (RAL 7035 cod. 13).

Alternative Cap Colour:

Orange (RAL 2004 cod. 02)

Blue (RAL 5015 cod. 07)

Yellow (RAL 1021 cod. 10)

Red (RAL 3000 cod. 16)

Green (RAL 6024 cod. 17)

Black (RAL 9011 cod. 01)

Hole:

Female smooth hole, with special deformable fixing ribs, obtained by moulding the plastic.

Fixing:

Push fit.



SPECIAL REQUEST:

- It is possible to supply colours as shown in the table at pag. M-27, on request and for quantities.

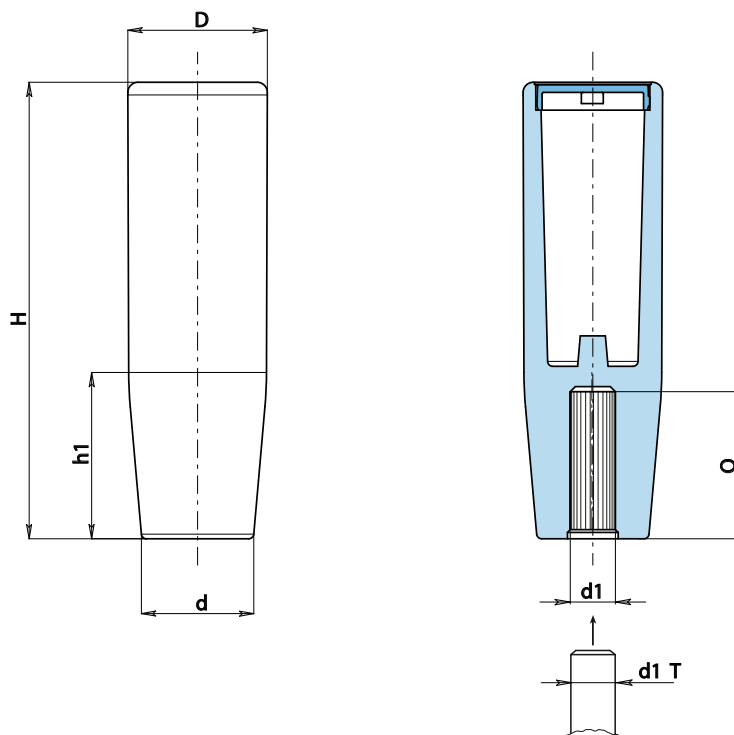

	art.	H	D	d	h1	d1 - T	d1	Q	g
●	M24690.TG080113	89,5	27	22	32	+0 -0,058	08	28	40
●	M24690.TG100113	89,5	27	22	32	+0 -0,058	10	28	39
●	M24690.TG120113	89,5	27	22	32	+0 -0,070	12	28	38
●	M24690.TG140113	89,5	27	22	32	+0 -0,070	14	28	37

M511



KNURLED HANDLE WITH SELF-FIX HOLE

Material:

Blend of polypropylene and thermoplastic rubber TPV.

Surface:

Glossy.

Colour:

Black (RAL 9011).

Hole:

Female smooth hole, obtained by moulding the plastic.

Fixing:

Push fit

SPECIAL REQUEST:

- None.

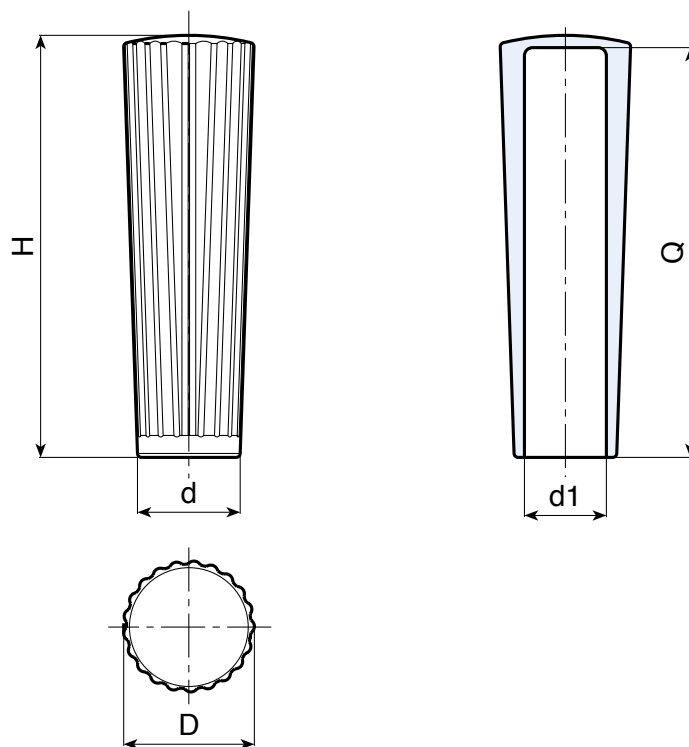

	art.	H	D	d	d1	Q	g
●	M511105.EG2001	104	32	25	20	100	32

M720



RECTANGULAR HANDLE WITH SELF-FIX HOLE

Material:

Blend of polypropylene and thermoplastic rubber TPV.

Surface:

Glossy.

Colour:

Black (RAL 9011).

Hole:

Female smooth hole, obtained by moulding the plastic.

Fixing:

Push fit.

SPECIAL REQUEST:

- None.

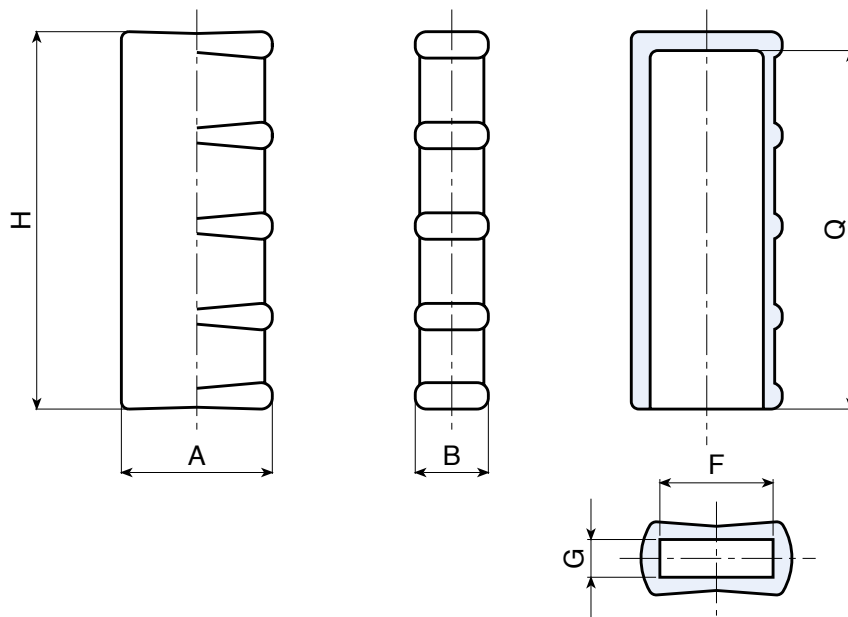

	art.	H	A	B	G ± 0,2	F ± 0,2	Q	Δ g
●	M720079.EG05X2001	79	32	17	5	20	76	29
●	M720079.EG06X2001	79	32	17	6	20	76	27
●	M720079.EG08X2001	79	32	17	8	20	76	24
●	M720079.EG08X2501	79	32	17	8	25	76	23
●	M720079.EG10X2001	77	32	17	10	20	76	22
●	M720100.EG05X2001	101	40	20	05	20	96	51
●	M720100.EG06X3001	101	40	20	06	30	96	48
●	M720100.EG08X2501	101	40	20	08	25	96	46
●	M720100.EG10X2801	101	40	20	10	28	96	43
●	M720100.EG10X3001	101	40	20	10	30	96	42

M137



HANDLE WITH LEVER ARM

Material:

Reinforced polyamide. Oils and greases resistant.

Surface:

Satin.

Colour:

Black (RAL 9011).

Insert:

Zinc plated steel stud partly threaded.
(thread tolerance 6g).

Fixing:

Push fit after moulding (high temperature).
(Not removable).



SPECIAL REQUEST:



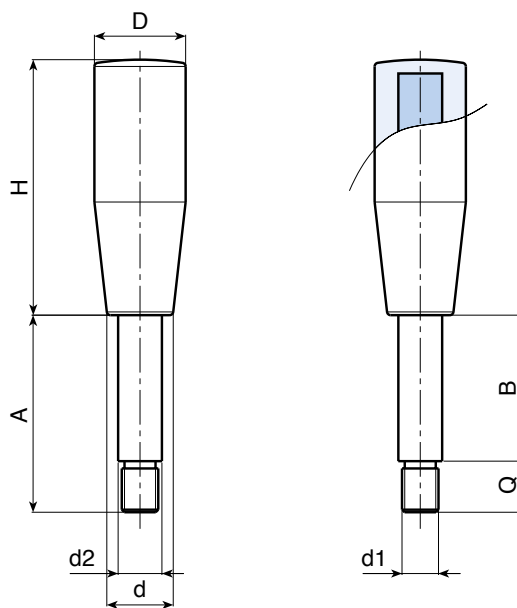







- It is possible to supply inserts with design dimension, on request and for quantities
- It is possible to supply inserts in different materials/treatments, on request and for quantities.
- It is possible to supply colours as shown in the table at pag. M-27, on request and for quantities.

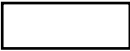

	art.	H	D	d	B	d2	A	d1 6g	Q	⚖ g
●	M13750.TI10X2501	50	20	15	15	10	25	M08	10	34
●	M13750.TI10X3001	50	20	15	21	10	30	M08	09	36
●	M13750.TI10X4001	50	20	15	30	10	40	M08	10	40
●	M13750.TI10X5501Z1	50	20	15	45	10	55	M08	10	46
●	M13750.TI10X8001	50	20	15	70	10	80	M08	10	61
●	M13760.TI12X5801	60	23	18	44	12	58	M10	14	71
●	M13760.TI12X6501	60	23	18	50	12	65	M10	15	77
●	M13760.TI12X9501	60	23	18	80	12	95	M10	15	104
●	M13770.TI14X6501	70	25	19	50	14	65	M12	15	106
●	M13770.TI14X10501	70	25	19	90	14	105	M12	15	154
●	M13780.TI14X6501	80	26	20	50	14	65	M12	15	112
●	M13780.TI14X10501	80	26	20	90	14	105	M12	15	164
●	M13790.TI16X6701	90	27	22	50	16	67	M14	17	115
●	M13790.TI16X9701	90	27	22	80	16	97	M14	17	193
●	M13790.TI16X11701	90	27	22	100	16	117	M14	17	224

COLOUR CHART

RAL COLOURS CODING

Colour		RAL	Cod.
Black		9011	01
Orange		2004	02
Orange		2011	03
White		9010	04
Blue		5015	07
Yellow		1007	09
Yellow		1021	10
Grey		7024	12
Grey		7035	13
Red		3000	16
Green		6024	17

M

AUTHORISED RESELLER

BOTECO Srl

www.boteco.it

36010 ZANE' (VI) - ITALY

Via L. Pettinà 16 (side street of Via Cuso)

Switchboard Tel.:+39-0445-316411 - Fax:+39-0445-316400

Sales Fax:+39-0445-316401 mail: commerciale@boteco.it

Administration Fax:+39-0445-316402 mail: amministrazione@boteco.it

Technical Fax:+39-0445-316404 mail: tecnico@boteco.it

Certified Mail Box: boteco@pec.botecopec.it

