

Concealed Adjustable Hinges

SKUs / Product Numbers

- 505-312109800: Concealed adjustable hinge (steel)
- 505-312109805: Concealed adjustable hinge (stainless steel)
- 505-312111800: with offset (steel)
- 505-312111805: with offset (stainless steel)

Benefits and Features

- Can be used universally for left or right hand applications.
- Maximum opening angle of 120 degrees.
- Removable pin for easy door removal.
- Mounting holes allow for 6mm of vertical adjustment.
- Primarily used on sheet metal enclosures.
- Available in stainless steel or zinc plated steel.

Learn More

To learn more about TCH please feel free to contact us Toll-Free at 1-800-465-6281 to speak to a qualified customer service representative.

Visit our website for a full listing of all TCH products at: www.tchweb.com

Please note: some of the products shown may be available by special order only.

Related Products



505-312111805

505-312111800

505-312109805



505-312109800

Spec Drawing

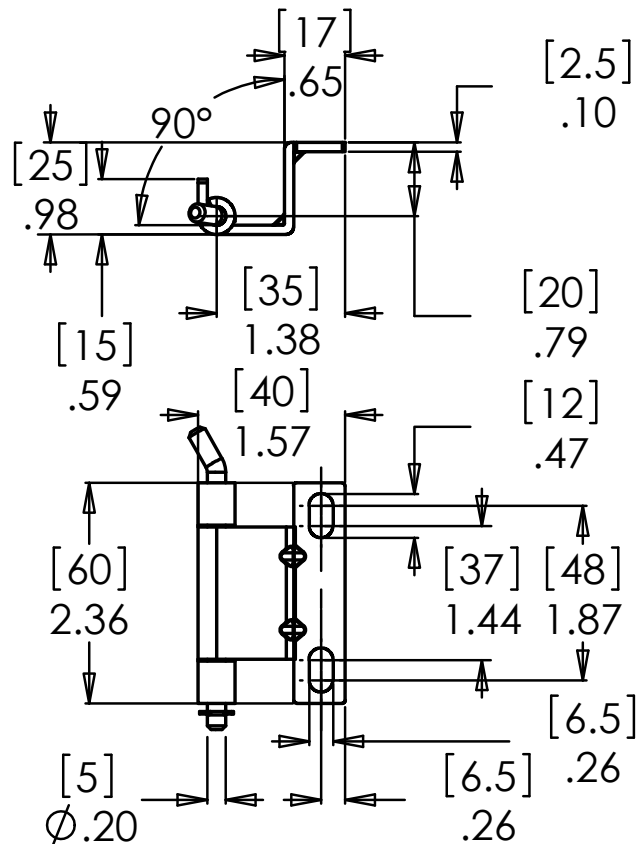

BUFFALO	CALGARY	DALLAS	MONTRÉAL	TORONTO
1370 William Street Buffalo, NY U.S.A. 14206	1135-45th avenue NE Calgary, AB, Canada T2E 2P2	10552 King William Dr. Dallas, TX U.S.A. 75220	16757 Boul. Hymus Kirkland, QC Canada H9H 3L4	40 Emblem Court Toronto, ON Canada M1S 1B1