

MANUAL

# HOME PLUG-IN DIFFUSER V2



LOVE AT FIRST SCENT

**PLEASE READ BEFORE USE**

Do not pour oil into bottom cup.  
Always keep upright.  
Tilting machine will cause damage.

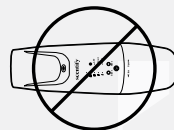

**GETTING SET UP**



①

Unscrew the bottom cover.



②

Unscrew bottle cap to fill with desired oil fragrance.



③

Guide tube into the bottle, and screw bottle into base of the diffuser unit.  
**NOTE:** There is a filter in the tube, do not remove.

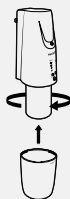

④

Screw bottom cover onto the base of the diffuser unit.

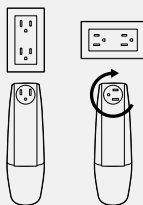

⑤

Plug in unit to outlet. Make sure that unit is always upright to avoid leakage. Rotate plug prongs if necessary.

## OPERATIONS

### APP ●



● APP



● Smart



● 24hrs



Grade



Mode



**APP** Custom app setting  
Preset to Spray time: 15 seconds  
Pause time: 10 minutes

» Spray time: 15 seconds  
Pause time: 1.5 minutes

» Spray time: 15 seconds  
Pause time: 3 minutes

» Spray time: 15 seconds  
Pause time: 4.5 minutes

» Spray time: 15 seconds  
Pause time: 6 minutes



Grade = Strength

**APP** Custom app setting  
Preset to 8:00am - 8:00pm

**Smart** Will not spray when room is dark.

**24hrs** Works 24 hours



Mode = Hours



**POWER ON/OFF**

Hold for 2 seconds

### WARNINGS



Always keep the diffuser upright. Tilted or angled will cause oil to overflow and damage the diffuser.

### EQUIPMENT CLEANING

1. Fill the bottle with water and vinegar or rubbing alcohol.
2. Let the diffuser run for about 5 minutes.
3. Drain the diffuser bottle completely.
4. Using a cotton swab dipped in vinegar, clean the tight spots and corners of the diffuser to make sure that no spots are left dirty.

### MAINTENANCE & STORAGE

- Always turn off or unplug the diffuser when not in use.
- Remove the bottle of oil when storing or transporting the diffuser.
- Store the diffuser in a dry and clean place.

### TROUBLESHOOTING

Problem	Solution
No Diffusion	<ul style="list-style-type: none"><li>- Check if the power is ON or OFF.</li><li>- Check oil level in bottle</li><li>- Check app settings or switch to button settings.</li><li>- Follow cleaning instructions above.</li></ul>
Oil Leaking	<ul style="list-style-type: none"><li>- Check if bottle is screwed in tightly.</li></ul>

### RESTORE TO FACTORY SETTINGS

Press and hold Mode button 3 seconds.

### RESET APP PASSWORD TO 8888

Press and hold Grade button for 3 seconds.

## S CONNECTING TO APP - BLUETOOTH

Open the “Google Play” store or “App Store” on your smartphone, search for the **Scentify** app and download.

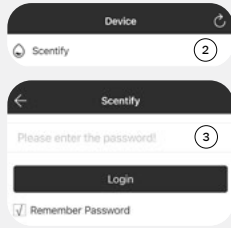
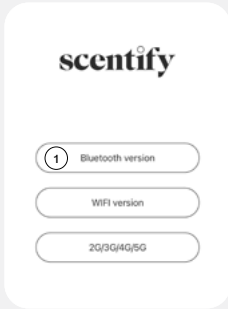

1. Open the Scentify app and select Bluetooth. (This device only connects via bluetooth)
2. Select your device.
3. Enter the default password **8888** and press Login.

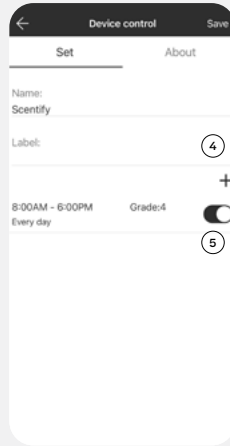

On the Device Control page;

4. You can change your device name and label information of your scent diffuser.  
**NOTE:** Press the “Save” button at the top right corner of the screen after each change.
5. Press the schedule you would like to edit.  
**NOTE:** You can set up to 5 different schedules by pressing the + button. To delete a schedule, swipe left. Press the toggle button to turn on/off any schedule.

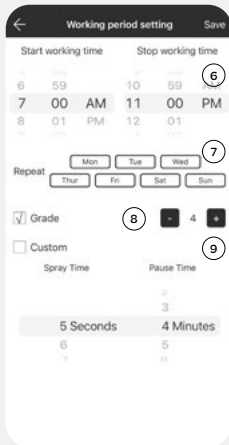

6. Set the hours of the day you want your diffuser to run by scrolling the “Start working time” and “Stop working time”.
7. Select the days of the week you want your diffuser to run (all days are pre-selected).
8. Press + or - to increase or decrease the preset intensity grades (1-4). See chart below for details.

9. Check (✓) the Custom box to create a custom intensity and scroll the “Spray Time” and “Pause Time”.  
**NOTE:** Press the “Save” button to update the settings.



10. You can change the default password by pressing on the “About” tab, in the “Device control” page.

## CONCENTRATION AND CONSUMPTION

Grade	G1	G2	G3	G4
Spray time (seconds)	15s	15s	15s	15s
Pause time (minutes)	6m	4.5m	3m	1.5m
Consumption (ml/hr)	0.07	0.15	0.23	0.3