



# LEEZE BOOM BOARD

## Delivery includes:

Leeze Boom Board Pro

**5x** Metal-rubber buffer

**4x** Screw nuts

**10x** Counter sunk screws (short)

**4x** Counter sunk screws (long)

**4x** Compression springs

**2x** Spring caps

**6x** Spread rivets

**10x** Buckles (to fix the straps)

**4x** Straps to fix your Smarttrainer

**1x** Strap to fix your front wheel

**14x** EPDM damper

**7x** Leeze Boom Dots

Required tool: Allen key (6mm)

Insert screw nuts in screw nut holder (top and bottom side)

### STEP 1

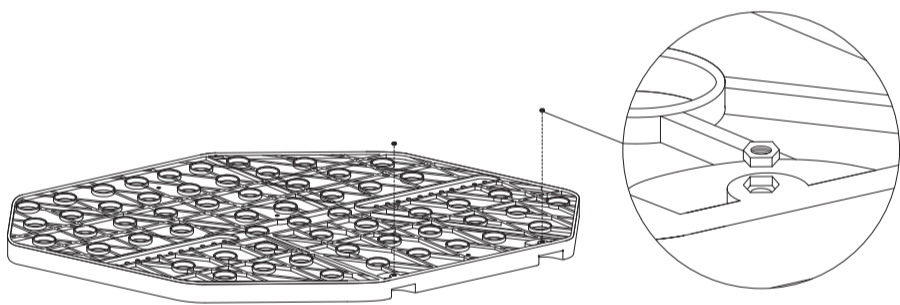

### STEP 2

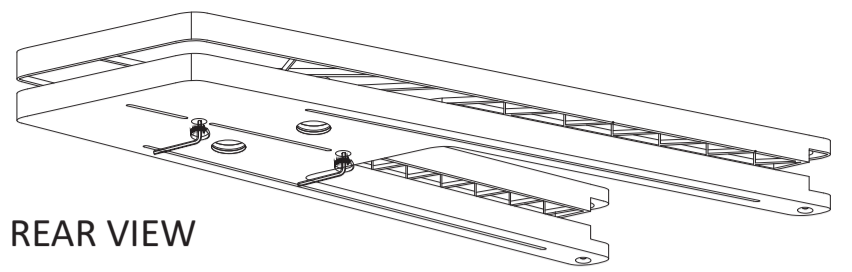
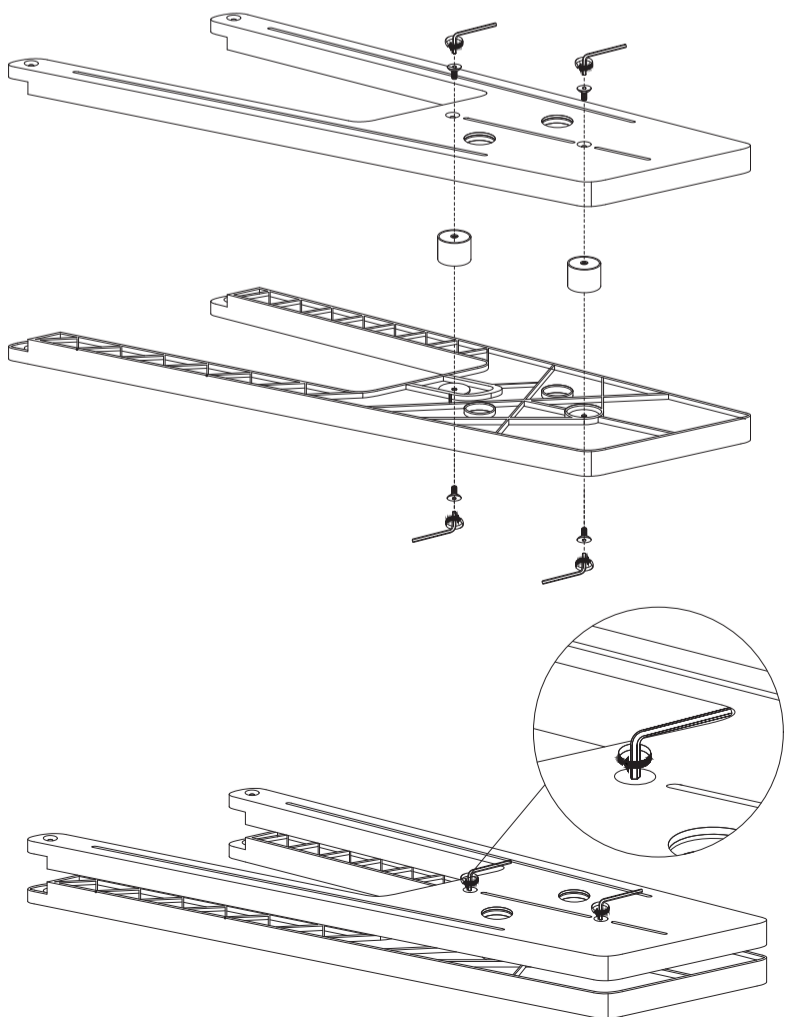

REAR VIEW

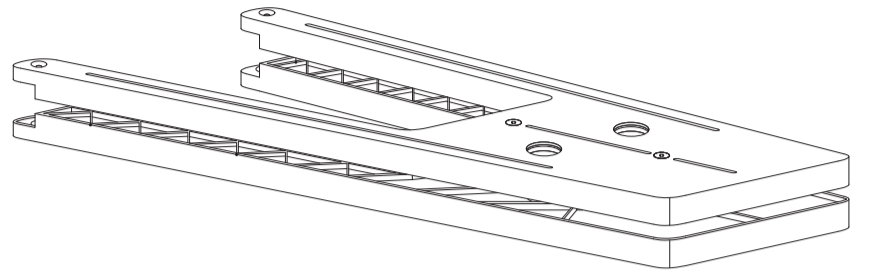

Front of Leeze Boom Board Pro is finished

### STEP 3

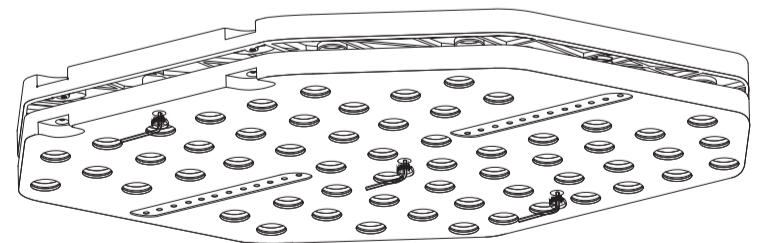
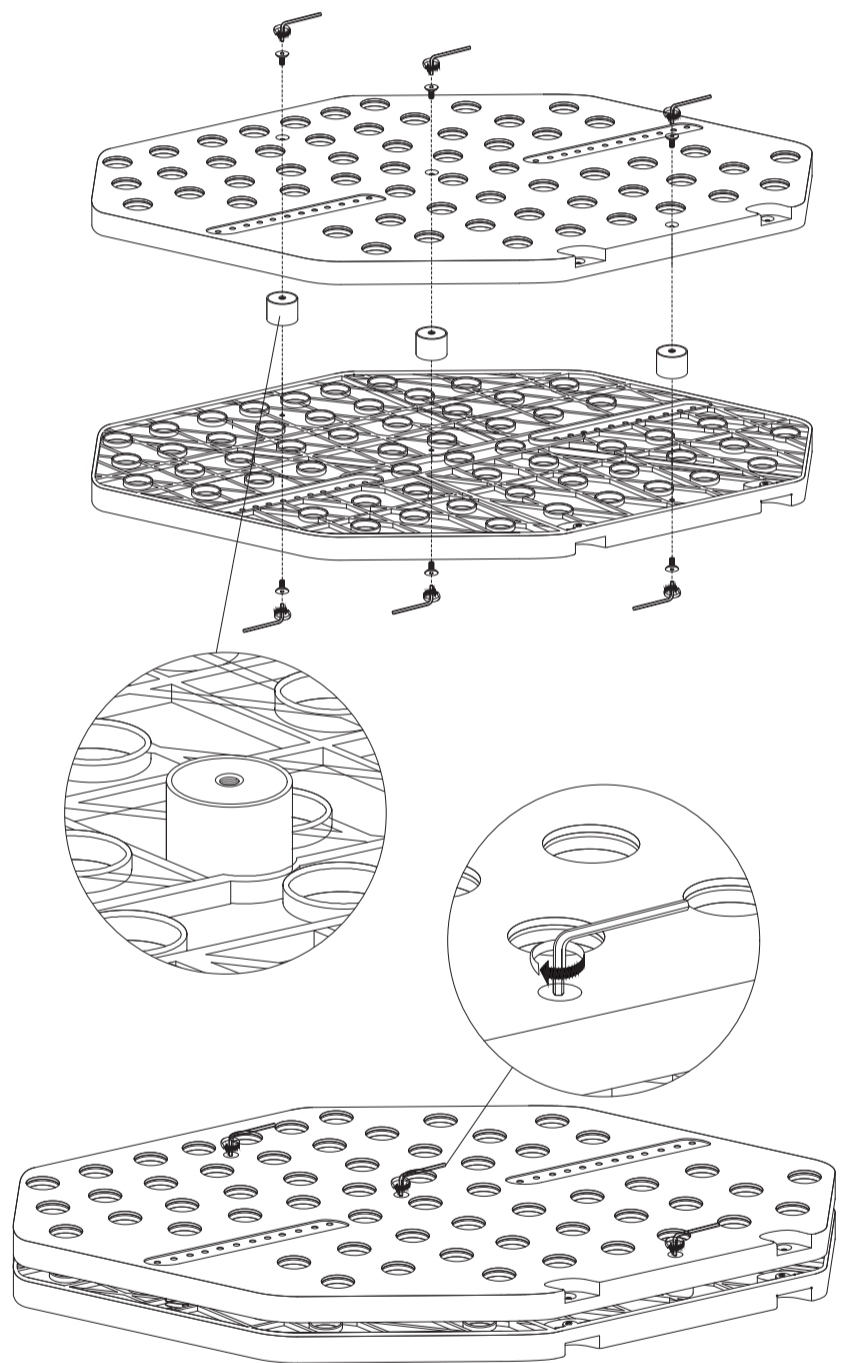

REAR VIEW

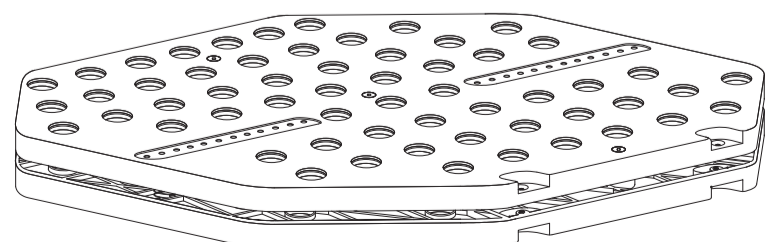

Back of Leeze Boom Board Pro is finished

**STEP 4**

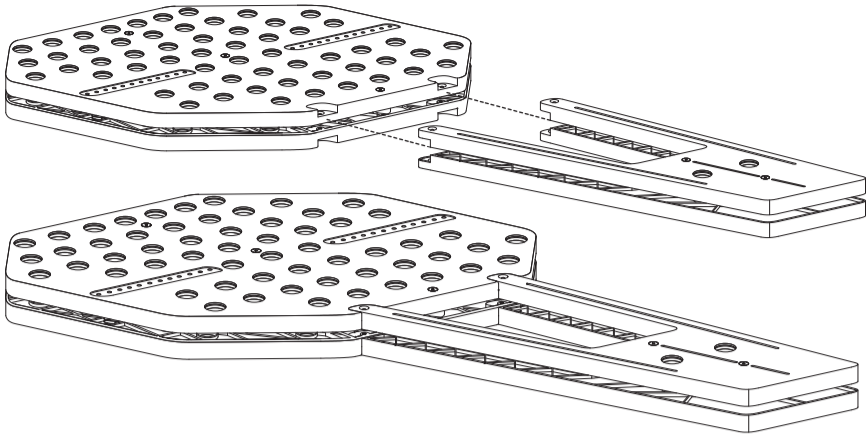

**STEP 5**

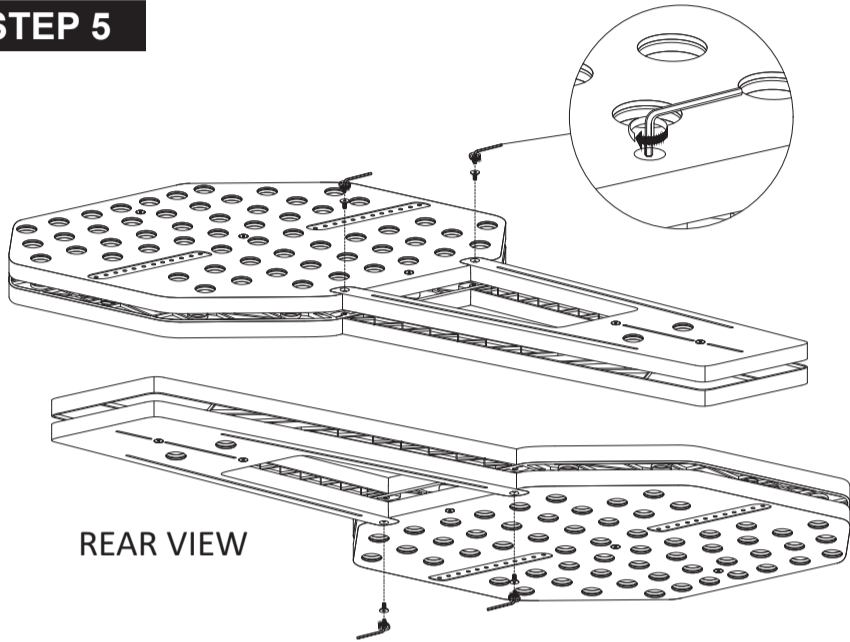

REAR VIEW

**STEP 6**

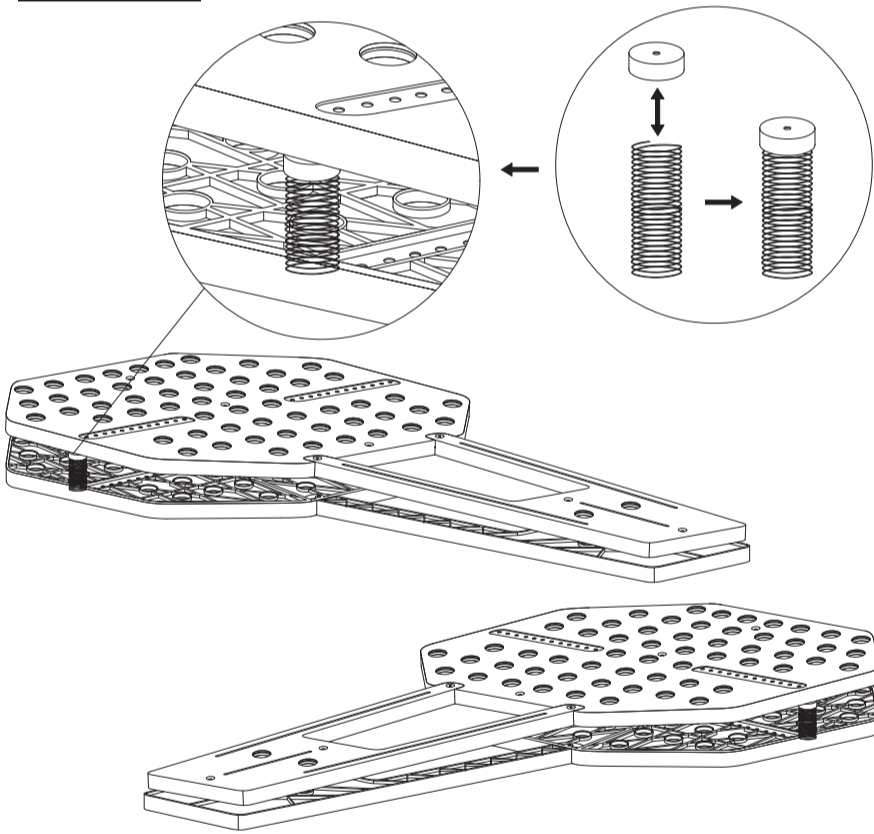

**STEP 7**

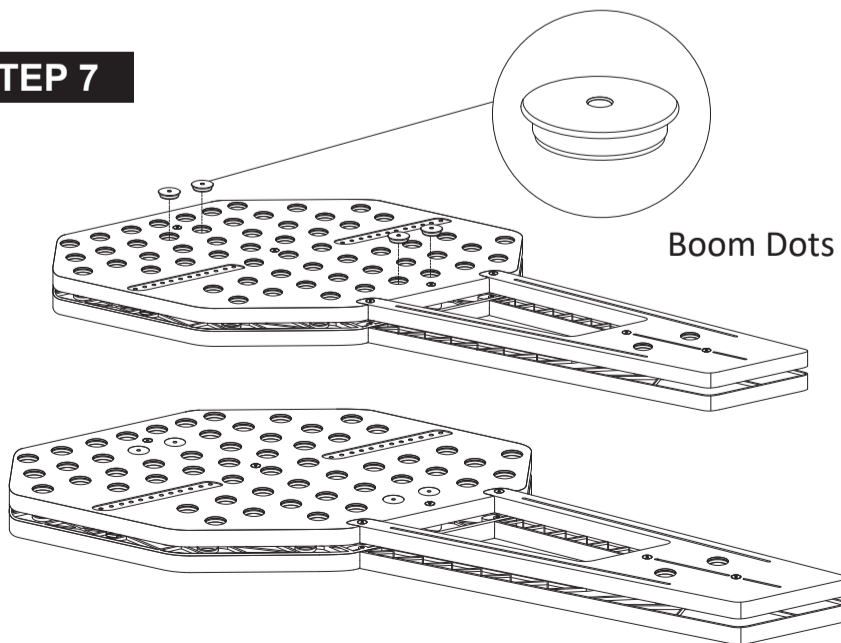

Boom Dots

Positioning of the Boom Dots depends on the standing area of the smarttrainer

**STEP 8**

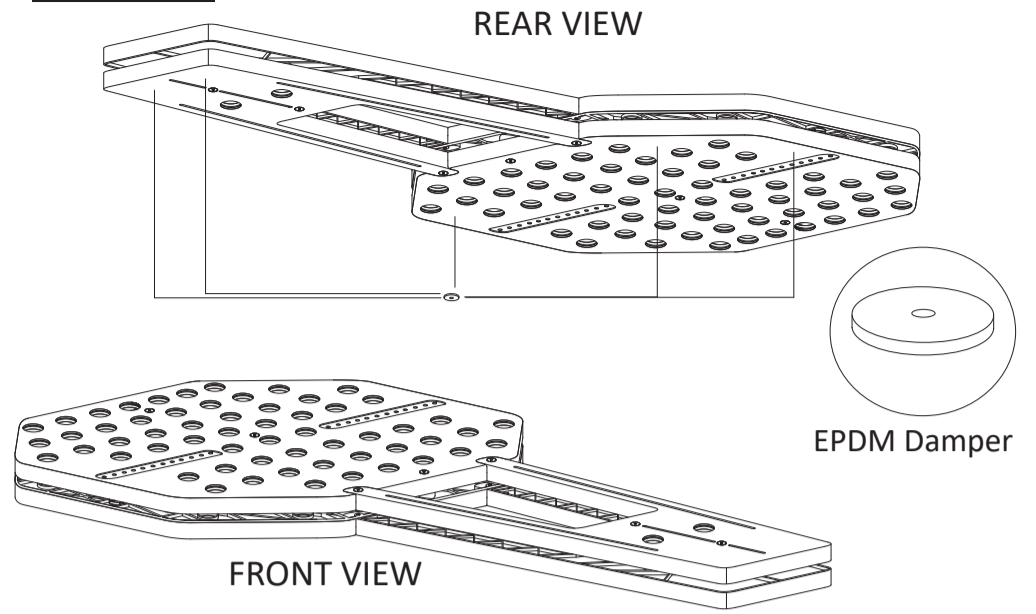

REAR VIEW

FRONT VIEW

EPDM Damper

**STEP 9**

Positioning of the straps depends on the smarttrainer

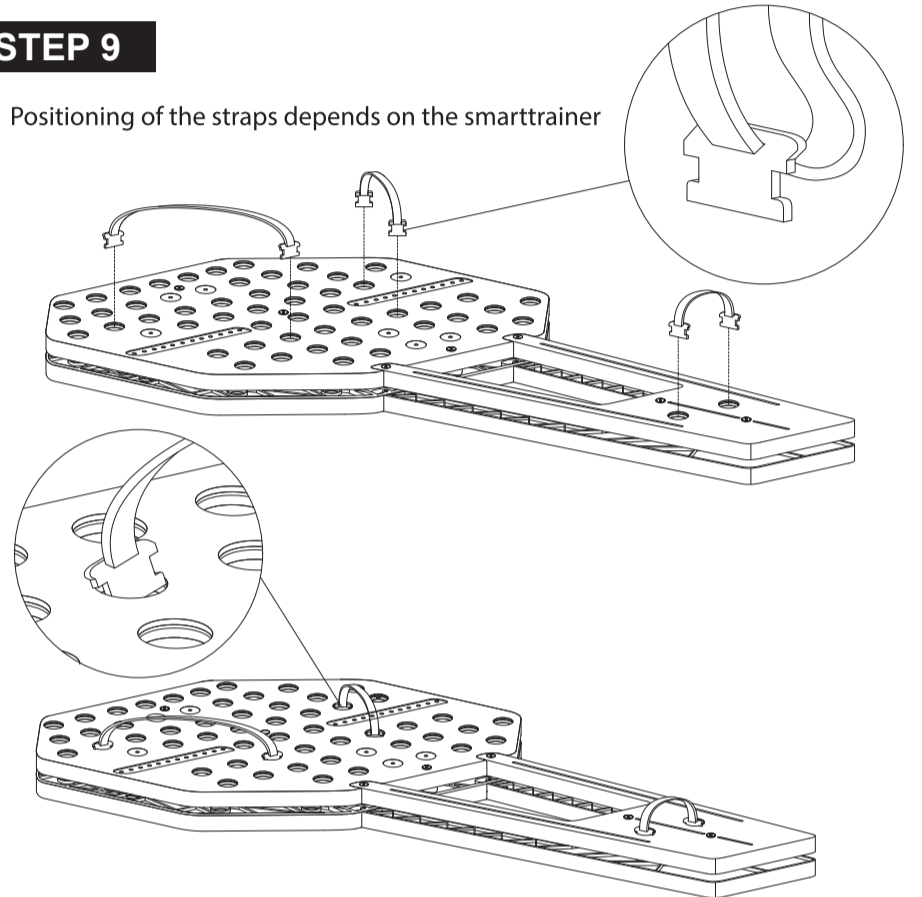

**STEP 10**

After you have found the right position of the compression springs insert 2 spread rivets to fix the springs

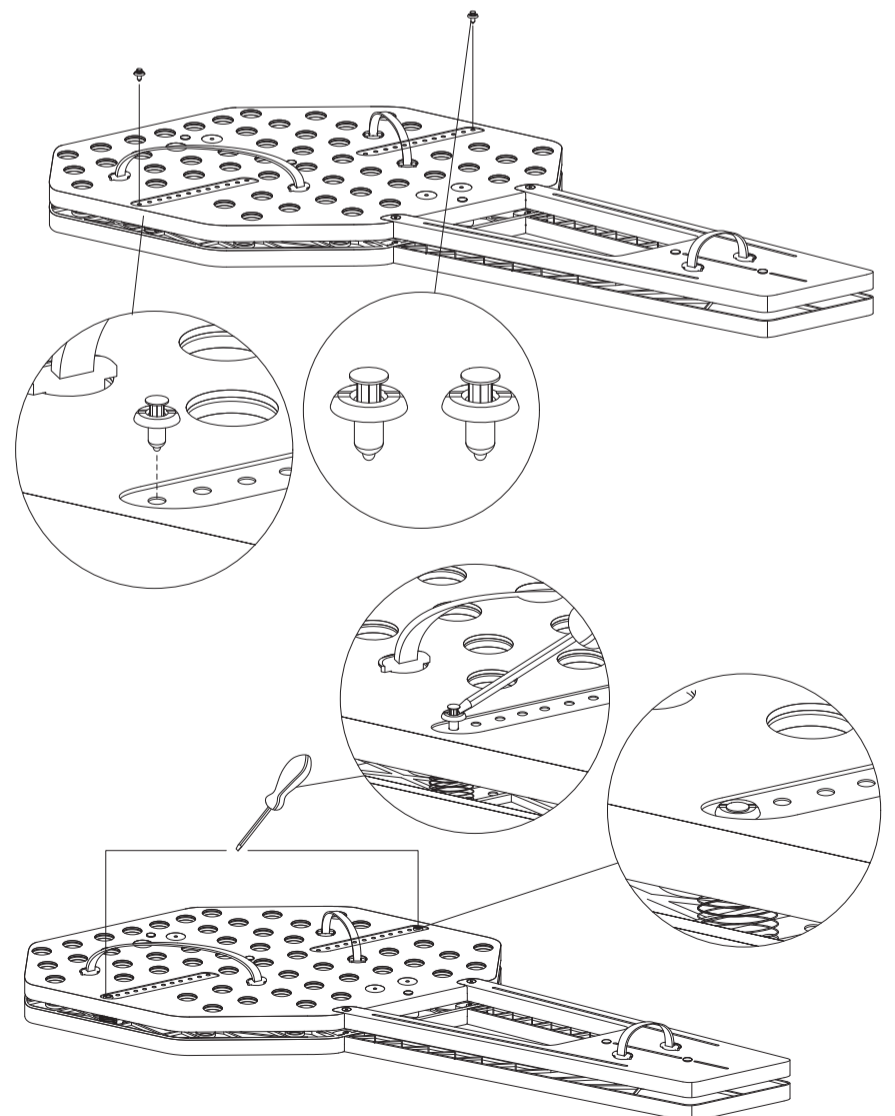

The additional two compression springs can be inserted into the markings (1-5) in the Leeze Boom Board Pro to increase the suspension effect.

**Final Leeze Boom Board Pro**