



Established 1958

Thermostatic Radiator Steam Traps Series EC

Operation

Tunstall Corporation produces a complete line of thermostatic radiator steam traps with ratings from vacuum to 25 psi. Each unit is tested and inspected before leaving the factory guaranteeing years of trouble free service. All units are “normally open” to expel air and water and will “close” at saturated steam temperature thereby preventing steam from entering into condensate return lines. Each Tunstall Steam Trap features the Tunstall Capsule[®] which has become the best steam trap replacement bellows available today.

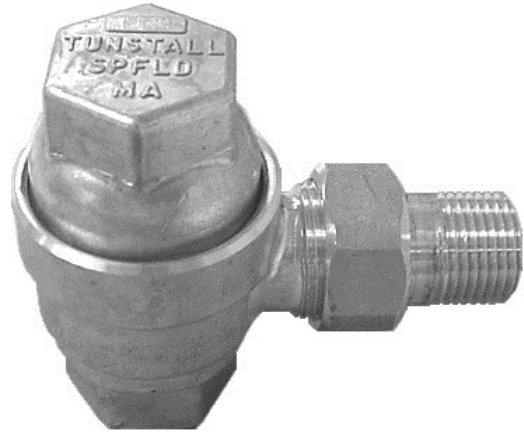

Thermal-Disc &
Thermostatic Traps

Features

- Forged brass body, cover, nut and tail piece
- TIG welded stainless steel Tunstall Capsule[®]
- Calibrated, inspected and tested
- Vacuum to 25 psi
- Available in 1/2” & 3/4” angle, 1/2” vertical and 1/2” straight patterns

Applications

- Cast Iron Radiators
- Finned Tube Radiation
- Convectors
- Air Coils
- Sterilizers
- Drips

Benefits

- Simple installation
- Corrosion resistant stainless steel internals
- Extended life on low pressure applications

Typical Specification

Furnish and install Tunstall Thermostatic Steam Traps Series EC as shown or as specified on plans and in accordance with manufacturer’s instructions, sizes 1/2” or 3/4”. The trap body and cover shall be forged brass and provided with an entirely stainless steel Tunstall Capsule[®]. Rating shall be _____ lbs/hr at _____ PSIG pressure differential. Each unit shall be guaranteed for 12 months from date of installation.

The Tunstall Capsule[®] professionally upgrades all thermostatic steam traps. Refer to catalog #795 or www.tunstall-inc.com for more detailed information.



Tunstall Corporation
118 Exchange Street · Chicopee, MA 01013

© August 2014

We reserve the right to alter designs, specifications and information without notice.

Phone (413) 594-8695 · Fax (413) 598-8109
www.maconbalancing.com

Bulletin-TA-Series-EC-0814
Thermal-Disc & Thermostatic Traps

Thermostatic Radiator Steam Traps - *Series EC*

Engineering Specifications

CAPACITIES*

Thermal-Disc & Thermostatic Traps

Model	Size NPT	PSIG Orifice	DIFFERENTIAL PRESSURE (PSI)								
			Square Feet EDR**								
			1/4	1/2	1	1-1/2	2	5	10	15	25
EC2-A	1/2"	5/16	90	120	165	200	230	320	500	625	825
EC3-A	3/4"	5/16	150	230	330	400	465	730	1040	1050	1700

* Ratings are in accordance with standards established by The Steam Heating Equipment Manufacturers Association (SHEMA). No safety factor required.

** To convert Square Feet EDR to pounds of condensate per hour: Divide the square foot ratings by 4.
 One Square Foot EDR is equivalent to net emission of 240 BTU per hour with 215°F steam in the radiator surrounded by 70°F air temperature.
 One pound of condensate is equivalent to approximately 1000 BTU; 1000 BTU is equivalent to approximately 4 square feet EDR.

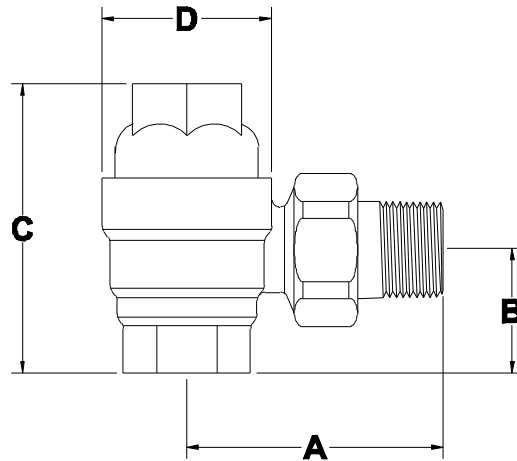

EC2-A, EC3-A

Model No.	Pipe Size	A	B	C	D	Weight	Capsule
EC2-A	1/2" Angle	2.60	1.35	3.00	1.82	1.15 lbs	TFTA-2901
EC3-A	3/4 Angle	2.60	1.35	3.00	1.82	1.25 lbs	TFTA-2901

