

### For Steam, Air and Non-Corrosive Gases

The GD-30 is a compact, high performance direct acting valve. Economical to buy and use, it's ideal for those low to moderate flow applications where accuracy of +/-10% is acceptable. The GD-30 is well suited for laundry and dry cleaning equipment, hospital equipment, tire molds, humidifiers, small heaters and applications in food processing. It provides tight shutoff for dead-end service on steam. Turndown ratio is 10:1 and ANSI Class IV Shutoff.

For a fully detailed certified drawing, refer to:

**GD-30 (bronze only) CDY #1038**

**GD-30S (stainless steel) CDY #1089**

#### GD-30/30S Specifications

Model Number	Inlet Pressure psig (bar)	Reduced Pressure psig (bar)	Spring Color	Minimum Differential psig (bar)	Application	Maximum Temp. °F (°C)	Materials		
							Body	Valve/Seat	Bellows
GD-30	15 - 250 (1 - 17)	3 - 15 (.21 - 1.0) 7 - 80 (.48 - 5.5)	Yellow Blue Green	7 (.48)	Steam, Air, Non- Corrosive Gases	410 (210)	Cast Bronze ASTM B584	Stainless Steel AISI 440/304	Phosphor Bronze ASTM B103*
GD-30S	15 - 300 (1 - 20)	50 - 140 (3.4 - 9.6)			Steam	430 (220)	Stainless Steel AISI 316		Stainless Steel AISI 316L

\*Stainless steel optional

#### GD-30/30S Dimensions and Weights

Symbol	Connection Size											
	in		mm		in		mm		in		mm	
	1/2	15	3/4	20	1	25	1-1/2*	40	2*	50		
L	3-1/8	80	3-3/8	85	3-3/4	95	5-1/2	140	5-7/8	150		
H <sub>1</sub>	2	47	2	47	2	47	3	77	3	77		
H	7-1/2	191	7-1/2	191	7-1/2	191	12-1/8	307.1	2-1/8	307		
Weight lb (kg)	4-1/4 (1.9)		4-1/4 (1.9)		4-1/2 (2.0)		21-3/8 (9.7)		22 (10)			
C <sub>v</sub>	1.3		1.5		2.5		5.6		8.5			

NOTE: GD-30 capacities cannot be determined with a formula—consult capacity tables. Reference note under formula key on page 275.

\*GD-30S available in 1/2", 3/4", and 1" only.

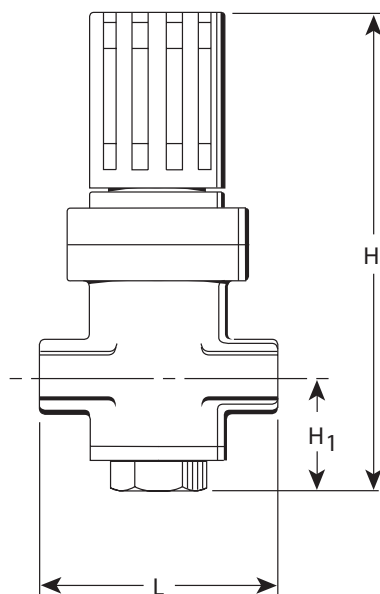

### GD-30 Capacities—Steam

		lb/hr							kg/hr				
Inlet	Outlet	Connection Size					Inlet	Outlet	Connection Size				
		in							mm				
psig		1/2	3/4	1	1-1/2	2	bar		15	20	25	40	50
C <sub>v</sub> Factor		1.3	1.5	2.5	5.6	8.5	C <sub>v</sub> Factor		1.3	1.5	2.5	5.6	8.5
15	7	49	56	92	198	297	1.0	.5	22	25	42	90	135
20	13	53	61	105	216	331	1.4	.9	24	28	48	98	150
	7	42	55	63	180	264		.5	19	25	35	82	120
30	23	62	71	112	242	408	2.0	1.6	28	32	51	110	185
	15	53	60	101	209	309		1.0	24	27	46	95	140
40	3	33	40	60	139	216	2.8	.2	15	18	27	63	98
	32	99	121	187	407	617		2.2	45	55	85	185	280
	20	79	97	159	330	517		1.4	36	44	72	150	235
50	4	40	55	77	159	264	3.4	.3	18	25	35	72	120
	40	130	143	242	539	837		2.8	59	65	110	245	380
	20	99	115	187	407	628		1.4	45	52	85	185	285
60	5	48	62	88	193	297	4.0	.3	22	28	40	88	135
	48	137	154	265	584	899		3.3	62	70	120	265	408
	40	150	165	289	617	969		2.8	68	75	131	280	440
80	18	90	104	170	374	584	5.5	1.2	41	47	77	170	265
	6	55	73	99	220	331		.4	25	33	45	100	150
	64	176	205	342	738	1,168		4.4	80	93	155	335	530
100	54	187	225	353	782	1,201	6.9	3.7	85	102	160	355	545
	23	121	137	220	489	749		1.6	55	62	100	222	340
	8	60	77	108	231	363		.5	27	35	49	105	165
120	80	203	242	397	863	1,355	8.3	5.5	92	110	180	392	615
	66	225	262	437	958	1,465		4.5	102	119	198	435	665
	40	198	231	375	837	1,278		2.8	90	105	170	380	580
150	10	68	79	132	297	473	10.3	.7	31	36	60	135	215
	96	231	276	452	991	1,520		6.6	105	125	205	450	690
	70	276	311	518	1,168	1,818		4.8	125	141	235	530	825
180	45	240	267	450	980	1,509	12.4	3.1	109	121	204	445	685
	12	110	121	198	462	705		.8	50	55	90	210	320
	140	408	485	794	1,719	2,677		8.3	130	151	250	550	845
200	85	364	421	705	1,531	2,369	13.8	5.9	165	191	320	695	1,075
	55	298	353	595	1,278	2,005		3.8	135	160	270	580	910
	15	132	165	254	562	848		1.0	60	75	115	255	385
225	140	408	485	794	1,719	2,677	15.5	9.7	185	220	360	780	1,215
	115	430	507	860	1,829	2,832		8.0	195	230	390	830	1,285
	70	386	430	739	1,619	2,501		4.8	175	195	335	735	1,135
250	18	165	187	309	683	1,035	17.2	1.2	75	85	140	310	470
	140	461	518	871	1,983	3,063		9.7	209	235	395	900	1,390
	115	474	540	904	2,005	3,085		8.0	215	245	410	910	1,400
275	80	430	496	827	1,818	2,810	18.9	5.5	195	225	375	825	1,275
	20	209	242	386	848	1,300		1.4	95	110	175	385	590
	140	485	573	948	2,060	3,195		9.7	220	260	430	935	1,450
300	115	496	584	961	2,071	3,207	20.0	8.0	225	265	436	940	1,455
	85	463	540	904	1,983	3,063		5.9	210	245	410	900	1,390
	23	254	298	496	1,079	1,675		1.6	115	135	225	490	760
GD-30S Only	140	525	606	1,014	2,226	3,438	18.9	9.7	238	275	460	1,010	1,560
	120	551	584	1,038	2,248	3,471		8.3	250	265	471	1,020	1,575
	70	463	529	893	1,939	2,997		4.8	210	240	405	880	1,360
GD-30S Only	25	276	320	529	1,146	1,796	20.0	1.7	125	145	240	520	815
	140	529	613	1,023	—	—		9.7	240	278	464	—	—
	120	529	613	1,023	—	—		8.3	240	278	464	—	—
GD-30S Only	70	470	542	902	—	—	20.0	4.8	213	246	409	—	—
	28	295	344	562	—	—		1.9	134	156	255	—	—
	140	529	613	1,023	—	—		9.7	240	278	464	—	—
GD-30S Only	100	529	613	1,023	—	—	20.0	6.9	240	278	464	—	—
	70	478	551	926	—	—		4.8	217	250	420	—	—
	30	309	359	595	—	—		2.7	140	163	270	—	—

NOTE: For air capacities scfm, multiply steam capacities (lb/hr) by 0.36. For air capacities m3/hr, multiply steam capacities (kg/hr) by 1.35. Maximum pressure reduction ratio 10:1.

Designs, materials, weights and performance ratings are approximate and subject to change without notice. Visit [armstronginternational.com](http://armstronginternational.com) for up-to-date information.