



# FLOORMATE DELUXE® HARD FLOOR CLEANER



## QUICK START GUIDE

### GETTING STARTED

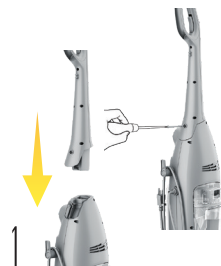

1 Attach the handle and insert the screw to the base of the neck.



2 Attach the Nozzle.

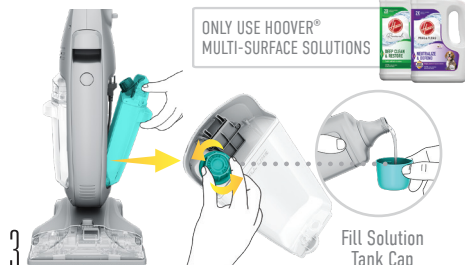

3 Remove the Solution tank. Fill solution tank with water. Fill solution tank cap with Hoover solution and pour into tank. Replace cap.

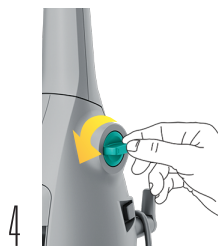

4 Change between wash and dry modes on the left side. Use wash mode to scrub and dry mode for suction only.

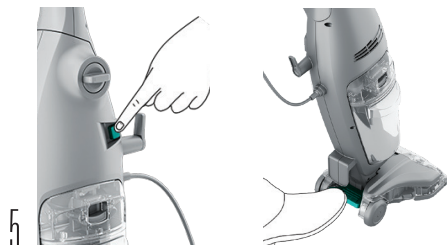
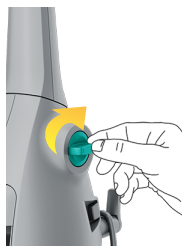

5 Turn on the machine and recline with the foot release pedal.

## CLEANING AND UNIT MAINTENANCE

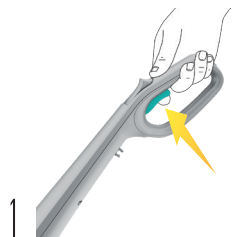

1 Squeeze the trigger to dispense solution on the forward pass.

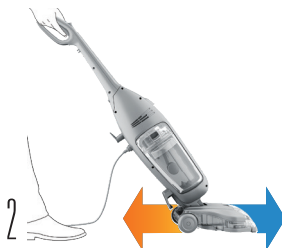

2 Release the trigger to recover dirty water on the backward pass.

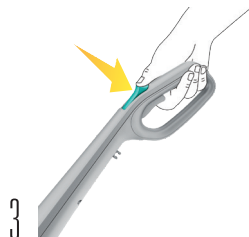

3 For additional solution press the clean boost button.

## SYSTEM CARE

**CAUTION:** To reduce the risk of injury from moving parts - Unplug before servicing.



1 After using your unit remove the nozzle, rinse, and let dry.

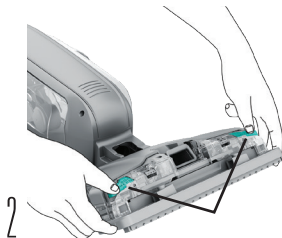

2 Press tabs to release brush block for easy cleaning.



3 Remove the dirty water tank & pour dirty water down the drain. Rinse tank and lid.

### PRO TIPS

**TO CLEAN FILTER:** Follow instructions labeled on the back of Dirty Water Tank.

**FOR BEST PERFORMANCE:** Complete system care after each use, clean filter monthly.



## SCAN HERE

For more information on FloorMate Deluxe®  
or to view this guide in other languages,  
scan the QR code.