

07

Quick Guide Manual



OKRATM

Blood Glucose
Monitoring System

07

Quick Guide Manual

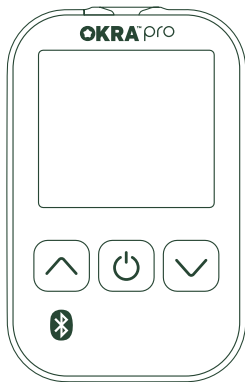

Blood Glucose
Monitoring System



Using your lancing device

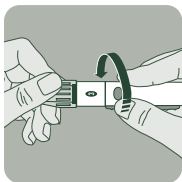

Twist the cap to the displayed arrow direction.

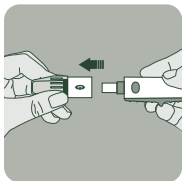

Gently pull the cap to remove.

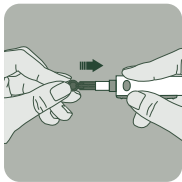

Insert the lancet into the lancet holder, push it all the way in.

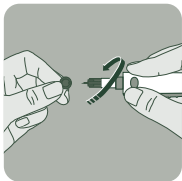

Twist and remove the protective cap from the lancet to expose the needle.

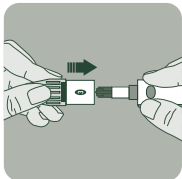

Place the cap back on your lancing device.

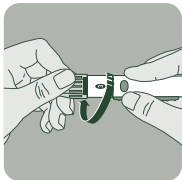

Twist the cap to the direction as shown in arrow.

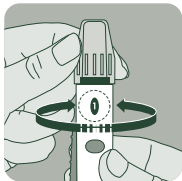

Select the depth of the lancet by dialing the lancing device.

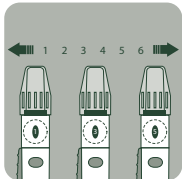

Setting of the lancing depth begin on one, for the shallowest setting. Increase the dial if more depth is needed.

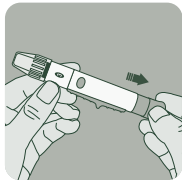

Pull the handle out until it clicks.

Performing your blood glucose test



Always wash and dry your hands before and after you perform a blood glucose test.



Remove a test strip from the test strip container.



Close the cap tightly



Insert the test strip into the meter in the direction of the arrows until the meter beeps.



Always check to see whether the code number on the meter display and the code number on the test strip container matches.

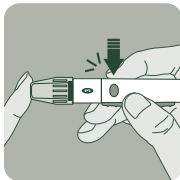

Hold the lancing device firmly against the edge of your fingertip and press the release button to prick your finger



Once you see the blood insert icon on your meter,
touch the end of the test strip to the blood drop
*Do not apply blood on top of the test strip



***Caution:**
Inserting blood at the end of the test strip



Do not put blood on TOP of the test strip



The test result appears on the display after 5 seconds

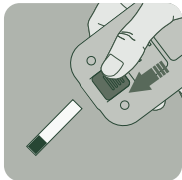

Dispose the used strip by pushing the ejector

How to change your battery

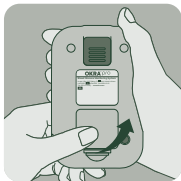

Open the battery door by pushing the tab toward the door and pull the door up and open

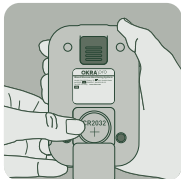

Release the old battery and replace with a new battery with the plus sign facing up

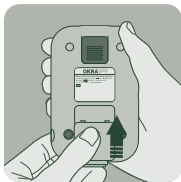

Replace the battery door

Trouble-Shooting

Blood Glucose
Monitoring System



When you see Er2 on the meter display, please check to see if the test strip has already been used.



To solve this issue, please take out a new test strip from the container and insert into the meter.



When blood insert icon appears, please apply blood sample at the end of the test strip

Error Code_Er3

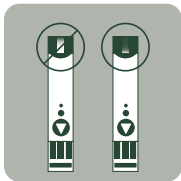

When you see Er3 on the meter display, please check whether enough blood has been inserted into the test strip.



To solve this issue, make sure to insert the blood at the end of the test strip, not on top of the test strip



Error Code_Er5



When you see Er5 on the meter display, please check whether the strip has been inserted after the blood insert icon has appeared.



To solve this issue, please take out a new test strip from the container and insert into the meter.



Make sure the blood insert icon has appeared before applying the blood sample.

Memo

Memo

DISTRIBUTED BY CGETC Inc.
CITY OF INDUSTRY, CALIFORNIA 91748
Quality Guarantee
www.okra.care

Customer service is available
Monday thru Friday, 9 to 5pm Eastern Time.
TEL: (833-977-1339)
E-MAIL: support@okra.care

REF INFM001LF
IMC01933 Rev. 2021-07-01