

Specification : Motor: 12 Volt DC / Battery: Requires 8 x 1.5V AA (Not included) / Operating temperature: 41°F to 104°F (+ 5°C to + 40°C)

WARNING!

- THIS IS NOT A TOY. KEEP CHILDREN OUT OF REACH OF THIS PRODUCT AND ITS ACCESSORIES.
- This appliance can be used by children aged from 8 years and above and persons with reduced physical sensory or mental capabilities or lack of experience and knowledge if they have been given supervision or instruction concerning use of the appliance in a safe way and understand the hazard involved.
- Children shall not play with the appliance.
- Cleaning and user maintenance shall not be made by children without supervision.
- This vacuum creates suction. Keep hair, loose clothing, fingers, and all body parts away from nozzle.
- Never use this pool vacuum if anyone is in water.
- Never attempt to unscrew and disassemble the unit for any reasons.

CAUTION

- This pool vacuum is designed for underwater use only. DO NOT attempt to use this pool vacuum to clean anything other than your pool or spa. It must be submerged in water over the water vent.
- DO NOT operate this pool vacuum out of water, otherwise the motor may be damaged.
- DO NOT scrape the canopy against acrylic spas, as this may damage the spa surface.
- DO NOT insert any object into the water vent of the pool vacuum.
- DO NOT leave the pool vacuum in pool or spa when it's not in use.
- NEVER use the pool vacuum without a filter bag in place.
- NEVER block the pool vacuum's water vent during operation.
- NEVER rotate the pole of the pool vacuum anticlockwise during operation, otherwise the battery cover could loosen and water might leak into the battery compartment.

Accessories

- A. Battery compartment cover / pole connector
- B. Battery holder
- C. Gasket / O-ring
- D. Battery compartment & handle
- E. ON/OFF button
- F. Impeller
- G. Impeller chamber
- H. Water vent
- I. Filter bag
- J. Canopy
- K. Nozzle flap
- L. Suction head
- M. Wheel
- N. Brush
- O. Pole

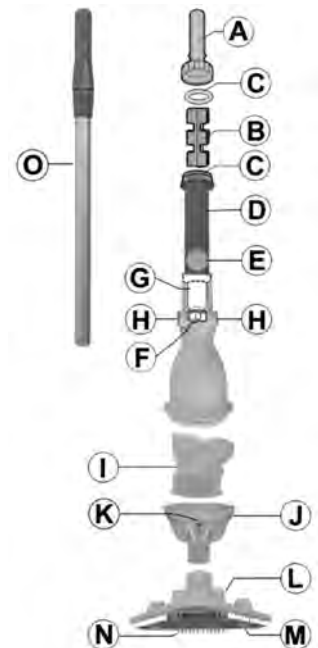

Set Up of Pool Vacuum

Suction head assembly



Note: For vinyl liner and fiberglass pools / spas, it is recommended to keep the suction head to avoid damaging the pool / spa.

Pole Assembly

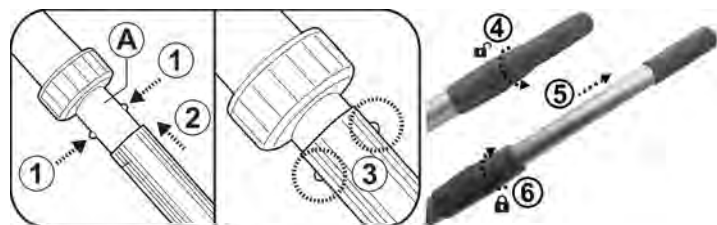

Battery Assembly

Unscrew the battery compartment cover and remove the battery holder. Place 8 AA batteries into the battery holder in accordance with the polarity markings. Align the rib and slide the battery holder into the compartment with the marking "TOP" facing outwards as shown. (Fig.1)
Securely screw the battery compartment cover back on. Make sure the O-ring is in place. (Avoid stripping threaded fitting)

CAUTION: DO NOT press the ON/OFF button to switch on the pool vacuum until it is submerged in water and the water level is above the water vent.

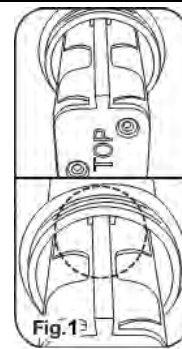

WARNING!

1. Ensure batteries are inserted properly and with the correct polarity
2. Do not mix new and used batteries or mix batteries of different types - ONLY use a complete set of new batteries of the same type
3. Do not recharge non-rechargeable batteries
4. Remove exhausted batteries from the product
5. The supply terminals are not to be short-circuited
6. Dispose of batteries safely

To Clean Your Pool or Spa

Place the pool vacuum in water and make sure the water level is above the water vent. Use a telescopic pole (not provided) if the total length of the assembled pole (included) is not sufficient. Press the ON/OFF button to start vacuuming.

CAUTION:

NEVER use the pool vacuum without a filter bag in place, as this could permanently damage the pool vacuum impeller and motor.

Cleaning the Filter Bag

WARNING! Turn off the pool vacuum before proceeding to following steps:

NOTE: Water will accumulate inside the suction head and the pole after use. To remove the water, lift the pool vacuum from the pool or spa with the suction head facing down to drain the water.

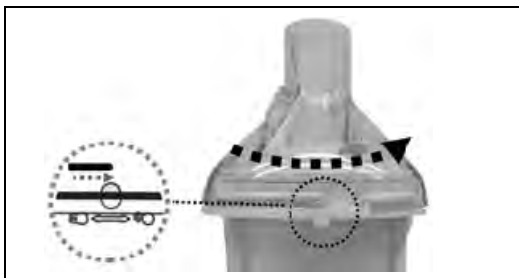

1. Hold the pool vacuum body and turn the canopy anticlockwise until the embossed marking on the canopy reaches the lock-unlock marking. Detach the canopy and remove the filter bag from the pool vacuum.
2. Remove the filter bag. Rid the bag of leaves and other debris, then rinse it. Rinse the canopy as well and make sure its suction hole is not clogged.
3. Replace the filter bag inside the pool vacuum. Reverse the steps to align and attach the canopy to pool vacuum and turn the canopy clockwise until it comes to a halt.

AFTER EACH USE, ALWAYS DRAIN WATER FROM THE UNIT BY REMOVING THE CANOPY, HOLD IT VERTICALLY, AND DRY IT BEFORE STORAGE. DO NOT LEAVE THE UNIT IN THE POOL OR SPA WHEN IT IS NOT IN USE. DO NOT STORE IT UNDER DIRECT SUNLIGHT. DO NOT STORE THE UNIT OUTDOORS OR IN A LOCATION WITH FREEZING TEMPERATURE OR BELOW. REMOVE THE BATTERIES AND THE CASE WHEN THE UNIT IS NOT TO BE USED FOR A LONG PERIOD. ALWAYS KEEP THE BATTERY CHAMBER AND COMPARTMENT DRY.

TROUBLESHOOTING

If the suction of the pool vacuum is weak or stops:

- Check and see if the power switch is "ON".
- Check and see if batteries are low. Replace with new battery.

WARNING! Turn off the pool vacuum before proceeding to the following:

- Check and see if the filter bag is full of debris. Clean as required.
- Check and see if the suction nozzle on the canopy is clogged. Turn off the power and clean it.
- If the impeller becomes clogged, be sure the pool vacuum is in the off position.
- Remove batteries from the compartment. Remove filter bag and check for holes or damage (Replace if necessary). Flush water vent H with water. Remove any visible debris. Replace filter bag, fittings, batteries, and battery cover. Submerge the water vent and switch the pool vacuum on.