

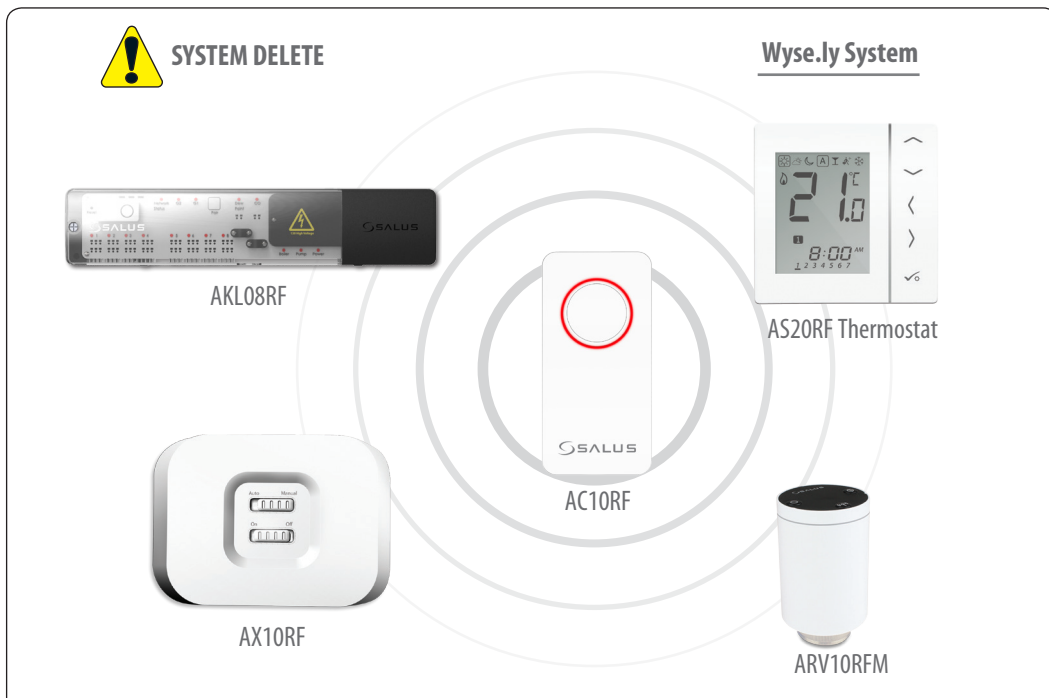

SYSTEM DELETE

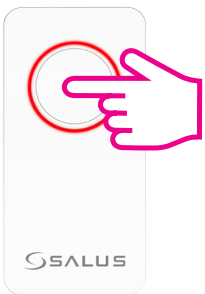

If at any time you need to delete all installed Wyse.ly devices from your Zigbee network follow the steps below. As this procedure can have a serious affect on your heating / cooling system it should only be carried out by your installer.



 Press for 10 seconds to delete the existing network.



 The button colour will change to AMBER to indicate system delete. At this point, the procedure cannot be cancelled.



After all devices have been deleted from the Zigbee network, they will need to be re-installed. Please refer to all relevant instruction manuals.

WARRANTY

SALUS North America warrants that this product will be free from any defect in materials or workmanship, and shall perform in accordance with its specification, for a period of five years from the date of installation. SALUS North America sole liability for breach of this warranty will be (at its option) to repair or replace the defective product.

Customer Name:

Customer Address:

Post Code:

Tel No: Email:

Engineers Company:

Tel No: Email:

Installation Date:

Engineers Name:

Engineers Signature:

TECHNICAL DETAIL

Model	AC10RF
Type	Zigbee Coordinator
Function	Zigbee network coordinator for Wyse.ly system
Control	Open - Close the Zigbee network
Indication	Tri Colour LED - RED - GREEN - AMBER
User Interface	Single push button
Operating Temperature	0 to 50 °C
Storage Temperature	-20°C to 60°C
Frequency	2.45 GHz
Power Source	24V 50Hz/60Hz via mains adaptor (supplied)
Approval	FCC and IC

SALUS
CONTROLS
Zigbee Coordinator
Models: AC10RF



INSTALLER / USER MANUAL

SALUS North America

850 Main Street
Redwood City
CA 94063

T: +1-650-360-1725
E: sales@salusna.com

www.salusna.com



SALUS North America is a member of the Comptime Group

Maintaining a policy of continuous product development SALUS Controls plc reserve the right to change specification, design and materials of products listed in this brochure without prior notice.

For PDF Installation guide please go to www.salusna.com

Box Contents



1 x Installer / User manual



1 x AC10RF



1 x Plug Adapter

For PDF Installation guide please go to www.salusna.com

Product Compliance & Safety Info

This equipment has been tested and found to comply with the limits for a Class B digital device, pursuant to Part 15 of the FCC Rules. These limits are designed to provide reasonable protection against harmful interference in a residential installation. This equipment generates uses and can radiate radio frequency energy and, if not installed and used in accordance with the instructions, may cause harmful interference to radio communications. However, there is no guarantee that interference will not occur in a particular installation. If this equipment does cause harmful interference to radio or television reception, which can be determined by turning the equipment off and on, the user is encouraged to try to correct the interference by one or more of the following measures:

- Reorient or relocate the receiving antenna.
- Increase the separation between the equipment and receiver.
- Connect the equipment into an outlet on a circuit different from that to which the receiver is connected.
- Consult the dealer or an experienced radio/TV technician for help.

Changes or modifications not expressly approved by the party responsible for compliance could void the user's authority to operate the equipment.

This device complies with part 15 of the FCC Rules. Operation is subject to the following two conditions: (1) This device may not cause harmful interference, and (2) this device must accept any interference received, including interference that may cause undesired operation.

This device complies with Industry Canada's licence-exempt RSSs. Operation is subject to the following two conditions: (1) This device may not cause interference; and (2) This device must accept any interference, including interference that may cause undesired operation of the device.

Le présent appareil est conforme aux CNR d'Industrie Canada applicables aux appareils radio exempts de licence. L'exploitation est autorisée aux deux conditions suivantes : (1) l'appareil ne doit pas produire de brouillage, et (2) l'utilisateur de l'appareil doit accepter tout brouillage radioélectrique subi, même si le brouillage est susceptible d'en compromettre le fonctionnement.



Warning

These instructions are applicable to the SALUS model stated on this instruction guide.

This product must be fitted by a competent person, and installation must comply with the guidance, standards and regulations applicable to the city, country or state where the product is installed. Failure to comply with the requirements of the relevant guidance, standards and regulations could lead to injury, death or prosecution.



Warning

Always isolate the AC Mains supply before installing or working on any components that require 120 V 60Hz supply.

We hope you enjoy this product...

SYSTEM OVERVIEW

INTRODUCTION

Thank you for purchasing the SALUS AC10RF Zigbee coordinator. The Zigbee coordinator controls the Zigbee communication of your Wyse.ly system.

i The Zigbee coordinator must be used with the Wyse.ly RF range of products below:

i Please refer to individual device manuals for more information.

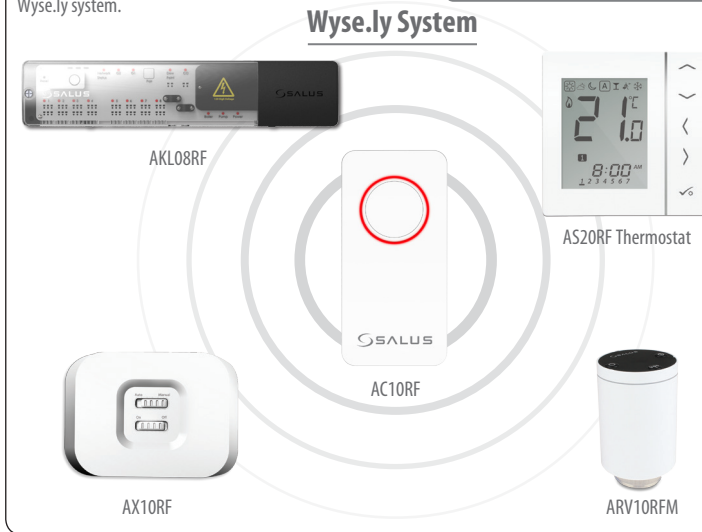

INSTALLATION



1 Plug



Coordinator



2 Attach Coordinator to USB adaptor.

INSTALLATION



3 Insert the adaptor into 24V mains outlet.



5 To commence system installation press and hold the button for 5 seconds until the button starts flashing red. This means the Zigbee network is ready to accept Wyse.ly devices.



7 When everything is paired press and hold the button for 5 seconds until the flashing stops.



4 Switch the 24V mains outlet on and ensure the button is illuminated (red) as shown above.

i Please refer to individual device manuals.

i **Maintenance**
If replacing or adding Wyse.ly devices please ensure you follow steps 6 to 8.

CHECKING SYSTEM CONFIGURATION

i To check that the complete system is communicating and has been configured correctly, you can use identify mode.

i Using identify from the coordinator will show all products that are connected to your system.

