

Inspiredwall™

I N T E R I O R S

Installation Guide **for InspiredWall Teakwood Panels**

Your Inspiration Realized.™

Introduction

Congratulations! You've acquired a work of art created by the artisans of InspiredWall. Simply put, you are about to install an accent wall with the most beautiful recycled teakwood the world has to offer.

The beauty of your new InspiredWall panels is not limited to their appearance. They have been thoughtfully designed so that a professional result can be obtained by almost anyone who's got a few common tools and is willing to follow instructions.

2 IMPORTANT TIPS TO KEEP IN MIND

The best results are achieved when you:

1. Paint the receiving wall a complementary dark color prior to installation.
2. Place the panels on the wall randomly, in such a way that the end seams do not align.

To get a better idea of the installation process, watch this helpful installation video on YouTube before you start. Click on the following link: <https://www.youtube.com/watch?v=m0DFt6bUaxo>

Please Inspect All Panels Before Beginning

InspiredWall panels are thoroughly inspected to ensure that they meet the highest quality standards. As with all-natural materials, some level of variation is observable. This is part

of the inherent beauty of the panels. However, in the unlikely event that panel defects are found, do not install them. Contact us immediately at Help@InspiredWall.us.

Please note that it is your responsibility to ensure that the project site is suitable for this product and that the panels are correctly installed per the instructions that follow. InspiredWall accepts no responsibility for failure due to incorrect or inappropriate installation of this product.

Is My Project Right for this Product?

1. The InspiredWall collection is suitable for indoor installations only. The project site should be fully protected from the elements and the receiving wall should be completely dry.
2. InspiredWall wall panels may be applied to a range of receiving surfaces. For the best results, we recommend affixing the panels to an even surface. Flat walls are ideal, but a small degree of unevenness is expected and should not adversely impact the installation.
3. In general, surfaces should be clean and free from any loose material or debris. The wall should also be structurally sound and capable of supporting the additional weight of the panels.

Checklist of Tools Needed

- Level and chalk line
- Handsaw
- Chop saw or miter box saw
- Tape measure
- Pencil
- Utility knife
- Ladder
- Personal protective equipment
- Caulking gun and a high strength construction adhesive. We recommend Loctite PL Fast Grab construction adhesive (#1417170) or equivalent, which is readily available in your local home improvement store. As a guide, you will need one 10 fl. oz. tube of adhesive per 20 sq. ft. of paneling.

Step 1 – Acclimatizing Your New Wood Panels

For the best results, store your panels in their new home for a few days prior to installation. Wood is a natural material which reacts to its environment. Therefore, a degree of shrinkage or expansion may be expected depending on local conditions. Acclimatizing the panels prior to installation allows the wood to stabilize, ensuring a better finished product.

Step 2 – Mounting the First Panel

For the most efficient coverage, cut the first panel exactly in half, widthwise.

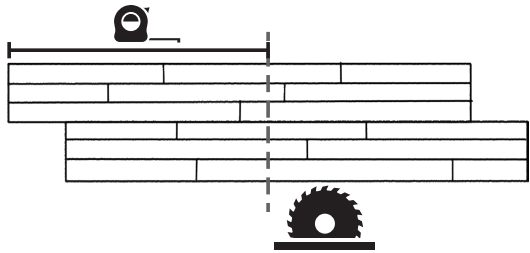

Take the first half panel and apply adhesive (see below). Working from the bottom of the wall, align the newly created straight edge with the left edge of the wall and fix in place.

The other newly created half panel can be used to start a new row, as described in Step 4.

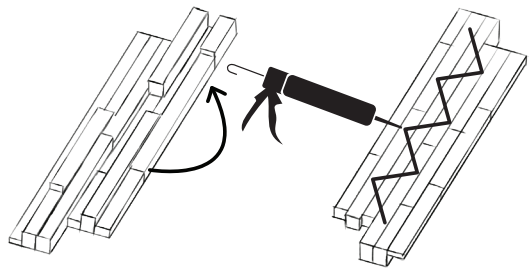

Step 3 – Mounting the First Row of Panels

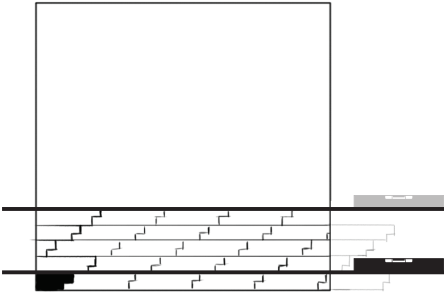

Position the first panels in a straight row on the wall.

We recommend using a level and chalk line to mark a straight line on the wall as a guide before positioning the panels. Starting at the bottom of the wall, place the first half panel on the left side (as described in Step 2) and follow the level line.

Continue with other panels until you reach the end of the row. Measure and cut the final panel to size. Save the leftover piece.

Step 4 – Continuing the Wall

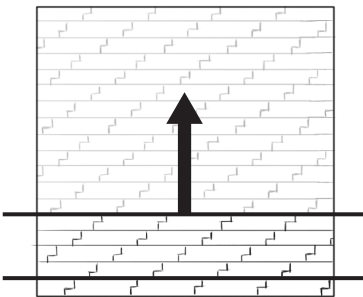

Continue to work bottom to top, left to right, as you add rows. After the installation of the first

five rows, using your level, check that straight lines have been maintained, correcting if necessary.

The remaining panel portion from the previous row can be used to start a new row. However, this is subject to its suitability at maintaining an irregular joint pattern between rows.

Step 5 – Handling Special Situations

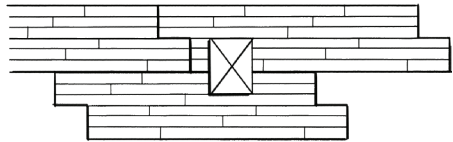

Plugs and Light Switches

OPTION 1: Light switches and plugs can be integrated by cutting the panels to follow the edge of the switch or plug plate. Always measure carefully before cutting.

OPTION 2: Trimming around the plug or switch plate is also an option. Watch the installation video for specifics on this solution (<https://www.youtube.com/watch?v=m0DFt6bUaxo>).

Inside Corner Solutions

Horizontal Panel Installation

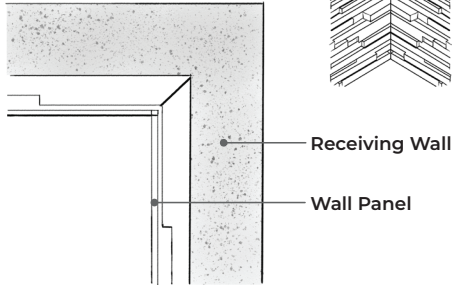

A seamless, inside corner can be achieved by joining panels using a miter joint.

Vertical Panel Installation

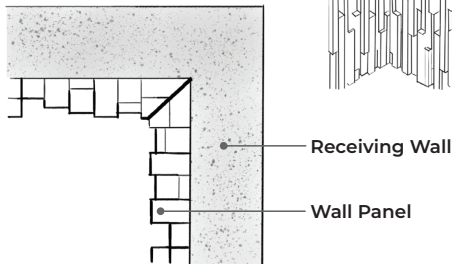

In the case of a vertical installation, a seamless internal corner is achieved by joining corresponding panels using a miter joint.

Outside Corner Solutions

Horizontal Panel Installation

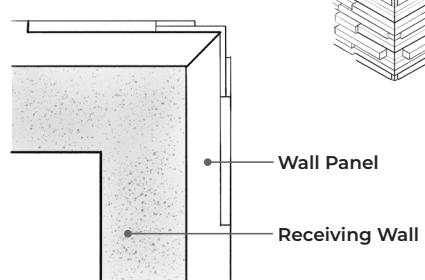

Option 1: A seamless outside corner can be achieved by joining panels using a 45° miter joint.

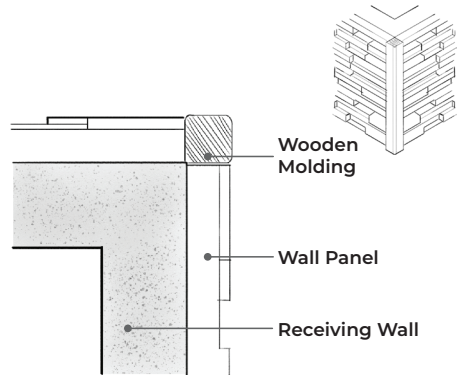

Option 2: Use a square piece of 1" molding, running vertically, to join wall panels and create an outside corner with a special emphasis on the corner itself. We recommend that you use a complementary wood type and color for this solution.

Vertical Panel Installation

If panels run vertically, we recommend using a butt joint to complete an outside corner.

NOTE FOR LARGE INSTALLATIONS

Expansion Joints in the Building Structure

When mounting panels over a large surface area, it is advisable to accommodate the building's expansion joints by allowing the same gap in the wall paneling. This gap may be filled with a flexible sealant, if desired.

Allowing for Additional Expansion of Large Installations

When the paneling installation exceeds 32 ft. in width (row upon row) and/or 100 ft. in length (interlocking panel to panel), allowances for expansion must be incorporated within the installation area, as well as at the perimeters and around obstructions. Contact us at Help@InspiredWall.us for more info.

Disclaimer

InspiredWall panels are made entirely of recycled teakwood from a variety of sources. Wood is a natural material that contains distinctive characteristics in grain, color, and texture. Each individual panel is unique. Photographs and physical samples should be viewed as illustrative of the products they represent but not an exact match.

Please note that no returns will be accepted unless the product is defective or received in error. If your InspiredWall panels were damaged in transit, please contact the carrier and file a claim. If you believe that you've received certain items in error or that your panels have a manufacturing defect, please contact us at Help@InspiredWall.us.

Thank you for choosing us to help you bring your vision to life!

Inspiredwall[™]
I N T E R I O R S

Part of the *MyInspiredHome* Family of Companies • InspiredWall.us • Help@InspiredWall.us