

## Sissy Bar Upright Installation Instruction

1. Unless already in place, install the docking hardware kit (either two-point or four-point) to the vehicle per the instructions in that kit. If necessary, please contact customer service to buy a docking hardware kit.
2. See Figure 3. Stand behind the motorcycle. Place the left side and right side front upright notches (with bushings in place) onto the docking points (A) inboard of the upper shock absorber mounts. Make sure the notch bushings (9) seat fully into the shock absorber docking points.
3. See Figure 3, arrows (D) and (E), and Figure 1. Position the rotary latches (4) over the rear docking points (3). Verify the upright sides (1) and latches fit into the neck of the rear docking points as shown. This may require some gentle squeezing or spreading of the sissy bar upright sides.
4. Push the rear of the sissy bar downward and close the latches by pressing the latch lever as far forward as it goes. You hear a click when the latch is in place. If the latch does not easily close, do not force. Check the sissy bar alignment again, as described in steps 2 and 3.
5. To remove the sissy bar upright, press the release button (G) on each side. Pull the latch levers back. Carefully lift the rear of the sissy bar up. Pull the upright out of the front docking points.

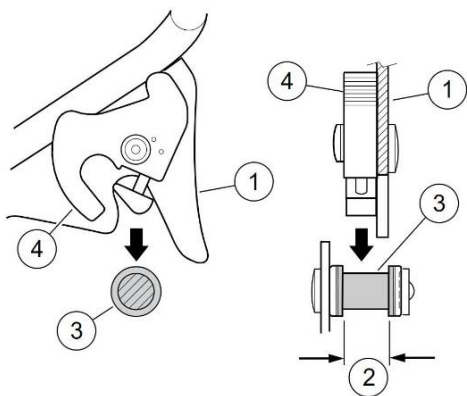

Figure 1.

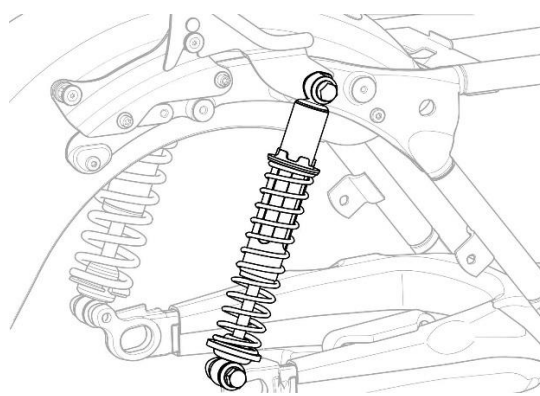

Figure 2.

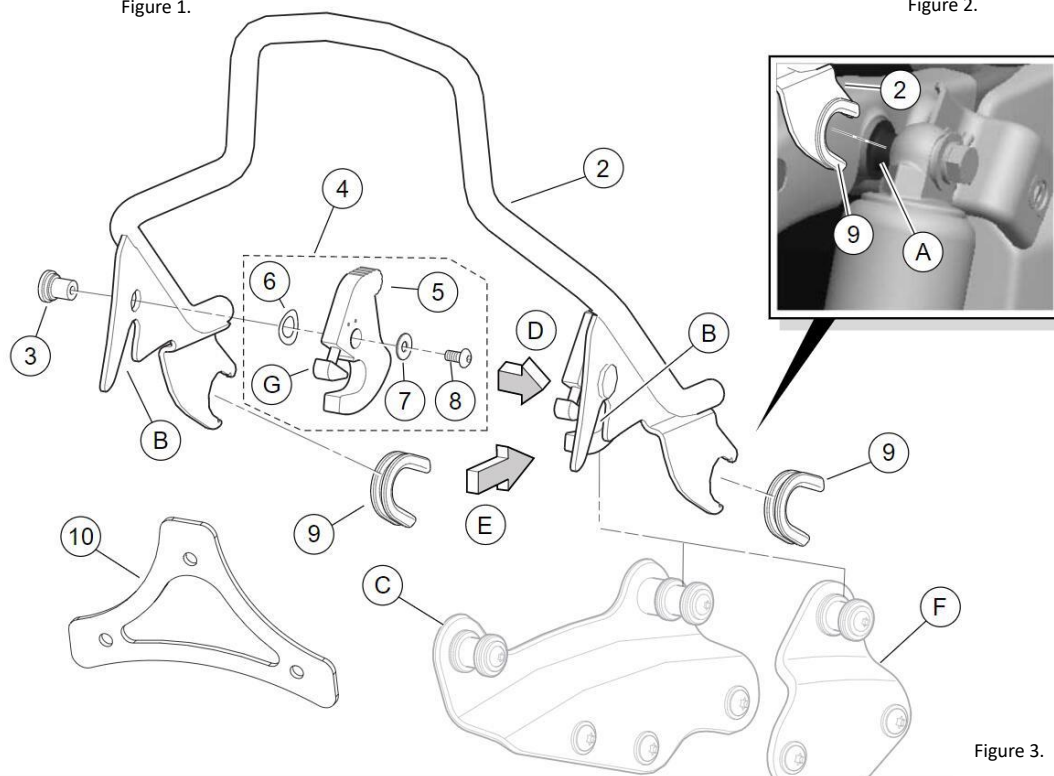

Figure 3.