

C.C.Rider Seat

Installation Instruction

Part Number: S09

WARNING

Rider and passenger safety depend upon the correct installation of this kit. Improper installation of this kit could result in death or serious injury.

Do not install these seat kits on motorcycles that are not equipped with an appropriate grab strap and passenger footpegs. If footpegs and grab straps are not installed, passengers could fall from moving the motorcycle or grab onto the operator, causing loss of control and death or serious injury.

NOTICE

Detach passenger seat strap before removing the seat. Failure to do so can result in damage to rear fender paint.

NOTE

If installing a solo seat with a sissy bar/backrest pad present, remove the backrest pad before seat installation. Install backrest pad after the seat is installed.

INSTALLATION

1. See Figure 1. Angle the front of the new seat into place so the tongue (4) engages the slot at the rear fuel tank mounting location.
2. Push the seat forward. Rotate the rear of the seat downward until the seat contacts the frame. Flex the seat slightly in the middle and slide the seat toward the rear until the keyhole slot (3) on the seat bottom engages with the center seat post on the frame.
3. Pull up on the center of the seat to verify that it is locked into place. (There is a small amount of play. The seat should only come up about half an inch. The seat is held firmly in place by the post on the underside of the seat.) If the seat is not firmly in place, repeat Step 2 until the seat is firmly in place.
4. See Figure 2. Install the seat mounting screw (A). Tighten.
5. Pull up on the front and rear of the seat again to verify that it is properly secured.

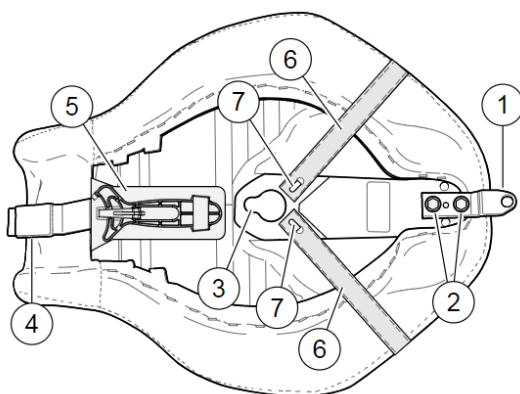

Figure 1.

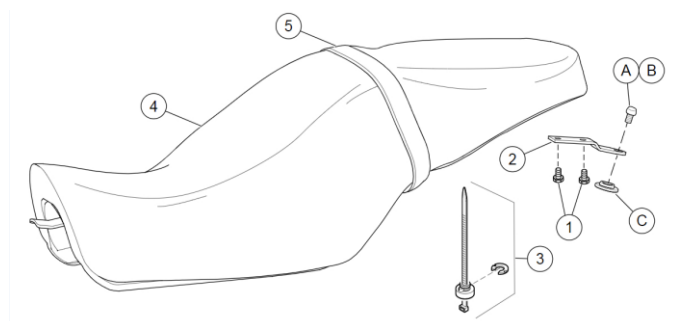

Figure 2.