



---

**EAC**

---

## Curved Lid Display Freezer

500 S. Falkenburg Road  
Suite 200 | Tampa, FL 33619  
800.441.4014 | 813.870.0340  
[www.excellenceindustries.com](http://www.excellenceindustries.com)

The company reserves the right to change the design and/or specifications of these products without notice. Printed in the USA.  
Current version 01.20

# KEY ASPECTS

## SPECIAL FEATURES:

- Four popular sizes
- Angled top with curved glass lid
- Low profile design for great visibility
- Standard casters front locking
- Heavy duty metal frame

## OPTIONS:

- Graphics
- Lid lock

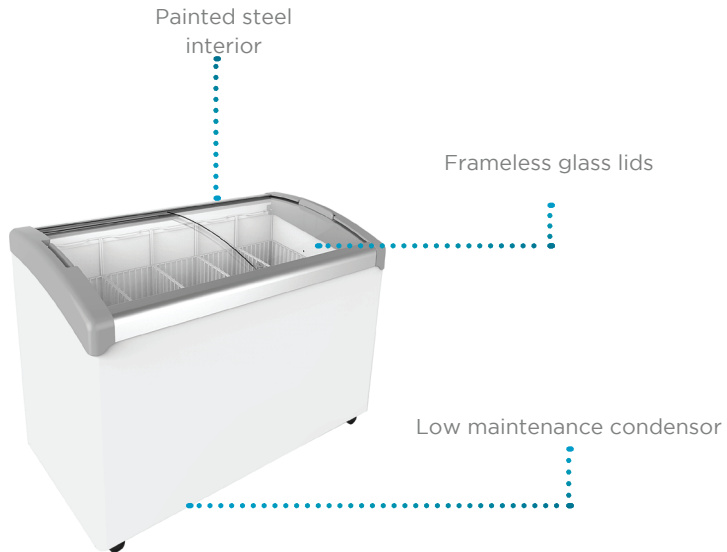

Complies with 2017 DOE standards for commercial freezer and ice cream freezer

## TECHNICAL SUMMARY

MODEL	SIZE				ELECTRICAL		REFRIGERATION			OTHER	
	Dimensions (inches)* Length x Depth x Height Front x Height/Back	Cubic Feet	Net Weight (lbs.)	Shipping Weight (lbs.)**	Voltage/Hz/Phase	Running Amps	Compressor HP	Refrigerant	Temperature	No. of Baskets	Container Quantity
EAC-33HC	33 1/2 x 25 1/8 x 28 3/8 x 34 1/4	7.0	121	139	115/60/1	2.0	1/5	R-290	-15°F to +25°F	3	128
EAC-39HC	39 7/8 x 25 1/8 x 28 3/8 x 34 1/4	9.1	136	154	115/60/1	2.1	1/5	R-290	-15°F to +25°F	4	99
EAC-47HC	47 3/4 x 25 1/8 x 28 3/8 x 34 1/4	11.9	150	187	115/60/1	1.3	1/3	R-290	-15°F to +25°F	5	81
EAC-59HC	59 1/2 x 25 1/8 x 28 3/8 x 34 1/4	14.8	194	211	115/60/1	1.5	1/3	R-290	-15°F to +25°F	6	66

\*Dimensions are all nominal lengths

\*\*Does not include weight of pallets when needed



TOP VIEW

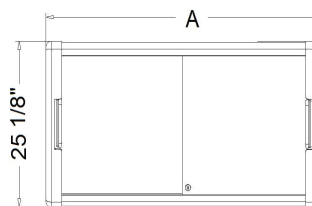

	A	B
EAC-33 HC	33 1/2"	28 1/8"
EAC-39 HC	39 7/8"	34 1/2"
EAC-47 HC	47 3/4"	42 3/8"
EAC-59 HC	59 1/2"	54 1/8"

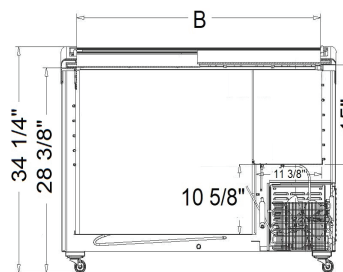

FRONT VIEW

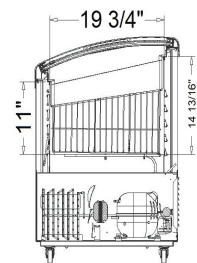

SIDE VIEW



500 S. Falkenburg Road  
Suite 200 | Tampa, FL 33619  
800.441.4014 | 813.870.0340  
www.excellenceindustries.com  
ver.01.20