



CTF

Countertop Freezer & Ice Cream Freezer

KEY ASPECTS

SPECIAL FEATURES

- 3 adjustable shelves (CTF-3HC)
- 2 adjustable shelves (CTF-2HC)
- Right hinge self closing door
- Environmentally friendly hydrocarbon refrigerant

OPTIONS

- Lighted door graphic
- Graphics
- Left hinge unit



Complies with 2017 DOE standards for commercial freezer and ice cream freezer



Interior LED Light

Fully insulated glass door

Standard door lock



Optional lighted door graphic



Double Combo-MCT-4HC with 2 optional CTF-3HC



Combo MCT-2HC with one optional CTF-3HC

TECHNICAL SUMMARY

MODEL	SIZE	ELECTRICAL			REFRIGERATION			OTHER			
	Dimensions (inches)* Width x Depth x Height	Cubic Feet	Net Weight (lbs.)	Shipping Weight (lbs.)**	Voltage/Hz/Phase	Running Amps	Compressor HP	Refrigerant	Temperature	No. of Optional Baskets	Container Quantity
CTF-2HC	22 1/2 x 20 7/8 x 20 7/8	1.9	76	84	115/60/1	2.1	1/4	R-290	-15°F to +15°F	2	304
CTF-3HC	24 x 21 1/8 x 27 5/8	3.4	95	103	115/60/1	3.6	2/5	R-290	-15°F to +15°F	3	171

*Dimensions are all nominal lengths

**Does not include weight of pallets when needed



CTF-2HC

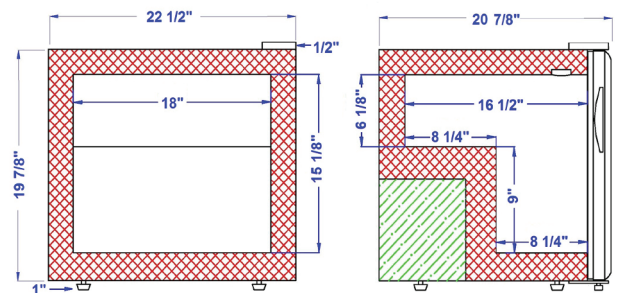

CTF-3HC

