

Date: \_\_\_\_\_ Type: \_\_\_\_\_

Client: \_\_\_\_\_

Project: \_\_\_\_\_



## LEDBATADAPT

### Universal Connector Pack

Turn your Mobile Power Center into a universal charging station, capable of charging cell phones, tablets, iPads and most other electronic devices that operate between 12 to 19 volts

- Universal Connector Pack Includes 11 of the most common connector tips
- Select a compatible tip for your device, slide the voltage selector on the Mobile Power Center to your device's required voltage and you are ready to charge - (See page 2 for complete Instructions)



- A: 6.0mm O.D. x 4.25mm I.D. (1.4mm pin) - Sony VAIO  
C: 5.5mm O.D. x 2.1mm I.D. x 11.0mm - Toshiba / Acer / IBM  
D: 4.73mm O.D. x 1.7mm I.D. x 11.0mm - Asus / HP / NEC / Compaq  
E: 5.5mm O.D. x 1.7mm I.D. x 11.0mm - Acer / Toshiba  
E2: 3.0mm O.D. x 1.1mm I.D. x 10.0mm - Samsung / Acer / Asus / Huawei  
G: 4.0mm O.D. x 1.7mm I.D. x 11.0mm - Acer / Benq  
H: 5.0mm O.D. x 3.25mm I.D. (1.0mm pin) - Samsung  
J: 7.4mm O.D. x 5.0mm I.D. (0.6mm pin) - Dell / HP / Compaq  
K: 7.9mm O.D. x 5.4mm I.D. (0.9mm pin) - IBM Thinkpad / Sony  
M: 11.0mm x 4.6mm rectangular connector - Lenovo / IBM

Please note the Output Cable connector tip may also be used when none of the interchangeable tips above are attached to it, giving you a total of 11 tip options. The Output Cable's tip size and related brands are listed below:

5.5mm O.D. x 2.5mm I.D. x 11.0mm - Lenovo / Acer / Asus



Display Supply & Lighting, Inc.

Display Supply & Lighting, Inc.  
1247 Norwood Avenue  
Itasca, IL 60143 USA  
TF 800.468.1488  
P 630.285.9660  
F 630.285.9670  
www.dslgroup.com

Date: \_\_\_\_\_ Type: \_\_\_\_\_

Client: \_\_\_\_\_

Project: \_\_\_\_\_

# LEDBATADAPT

## Universal Connector Pack

### INSTRUCTIONS FOR: Using the Universal Connector Pack

Step 1: Confirm the DC voltage required to operate your device. The DC voltage required to operate your device is typically listed on the label of the device's AC Adapter under the term "Output". You may also contact the manufacturer directly for this information.

(输入) INPUT: 100-240V ~  
(输出) OUTPUT: 18.5V == 3.5A



Step 2: Once you confirm the proper DC voltage required to operate your device, please slide the voltage selector on the Mobile Power Center ("MPC") to match your device's required voltage as closely as possible.\*



Step 3: Once the proper voltage has been selected on the MPC, select a compatible connector tip and attach it to either end of the enclosed output cable.



Display Supply & Lighting, Inc.

Display Supply & Lighting, Inc.  
1247 Norwood Avenue  
Itasca, IL 60143 USA  
TF 800.468.1488  
P 630.285.9660  
F 630.285.9670  
www.dslgroup.com

Date: \_\_\_\_\_ Type: \_\_\_\_\_

Client: \_\_\_\_\_

Project: \_\_\_\_\_

# LEDBATADAPT

## Universal Connector Pack

### INSTRUCTIONS FOR: Using the Universal Connector Pack

Step 4: Plug the modified end of the output cable (with the compatible tip attached) into your electronic device and the other "free end" of the output cable into the green colored port labeled "output" on the MPC.

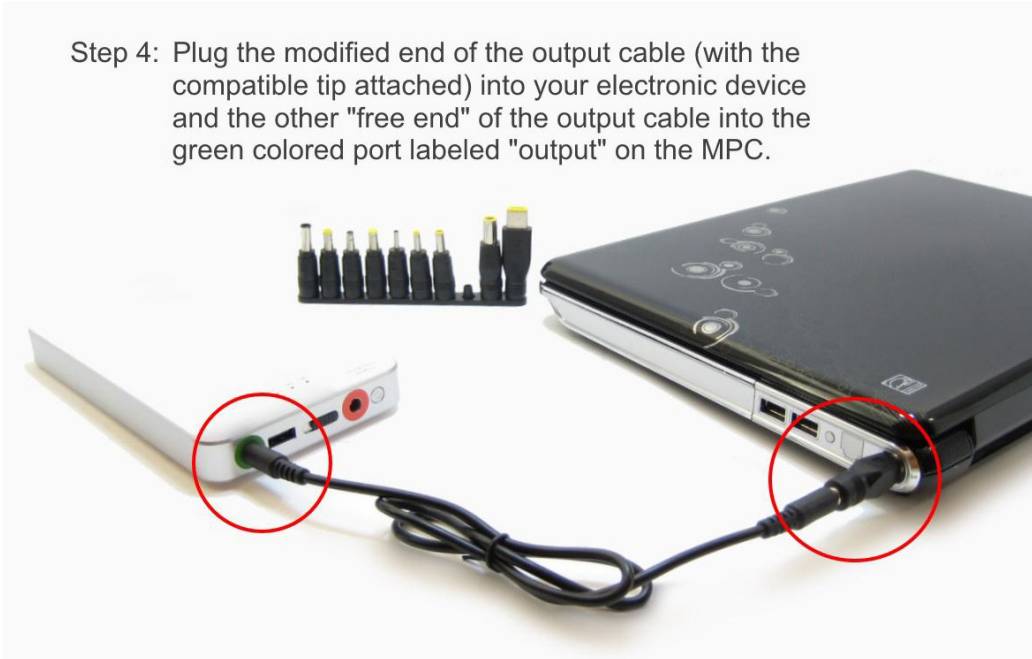

Step 5: Press & hold the power button on the MPC for roughly 3-5 seconds to engage power.



**\* Operating your device at an incorrect voltage may damage your device, so please proceed with caution!**



Display Supply & Lighting, Inc.

Display Supply & Lighting, Inc.  
1247 Norwood Avenue  
Itasca, IL 60143 USA  
TF 800.468.1488  
P 630.285.9660  
F 630.285.9670  
www.dslgroup.com