



8+

Pumpkin Stacking Kit Instructions

How to enjoy your Pumpkin Stacking Kit!

CARVING

STEP 1: Draw a circle on the top of your pumpkin between 4.5 to 6 inches in diameter.

STEP 2: Using the saw to carve along the line you drew to cut out your lid. Cut at a 45 degree angle so the lid does not fall into the pumpkin.

STEP 3: Use the scooper or your hands to remove all the seeds and loose material from inside the pumpkin.

STEP 4: Draw a design on the side of your pumpkin or use a stencil.

STEP 5: Cut out your design with the saw.

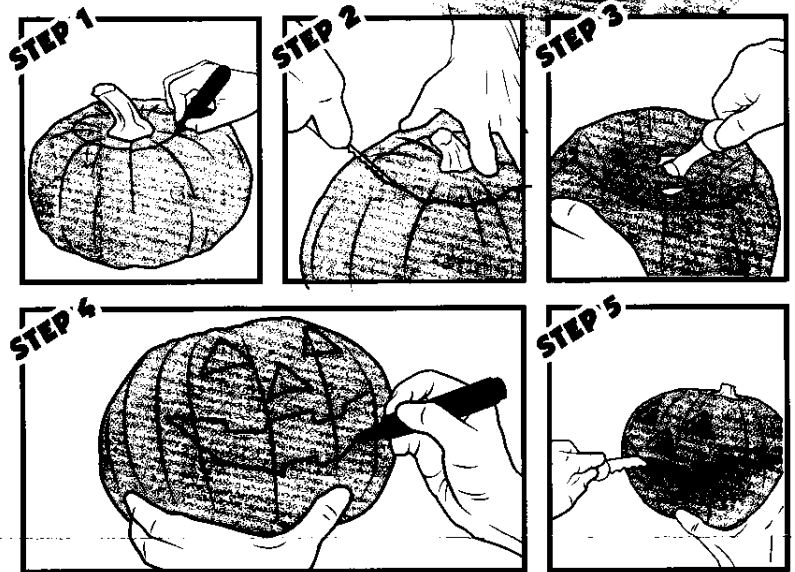

STACKING

STEP 1: After all the pumpkins have been carved, choose the largest pumpkin for your base.

STEP 2: Place a pumpkin stacker on top of the pumpkin, centered on the hole, with the text facing down.

STEP 3: Put your fingers next to each of the top spikes and carefully push down so the bottom spikes enter the pumpkin.

STEP 4: Once the stacker is secure, place the tea light, flame-side down, into the stacker. Push down until it snaps into place.

STEP 5: Place the next largest pumpkin directly above the base pumpkin and carefully push down so the top spikes puncture the bottom of the pumpkin.

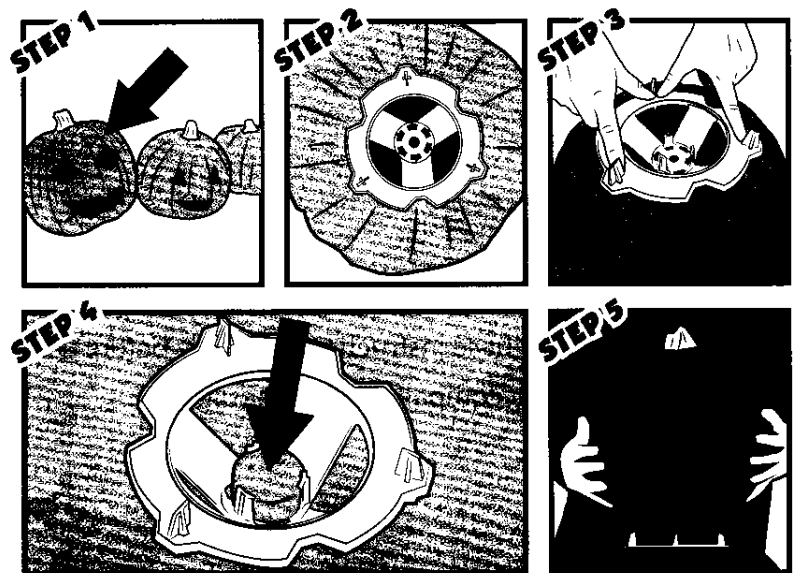

HELPFUL HINTS:

- Use a knife to poke a hole if you are having trouble inserting the saw or the spikes of the pumpkin stacker.
- When stacking pumpkins, put your hand inside the top pumpkin and push down from inside to help the spikes penetrate the bottom surface.