

21.

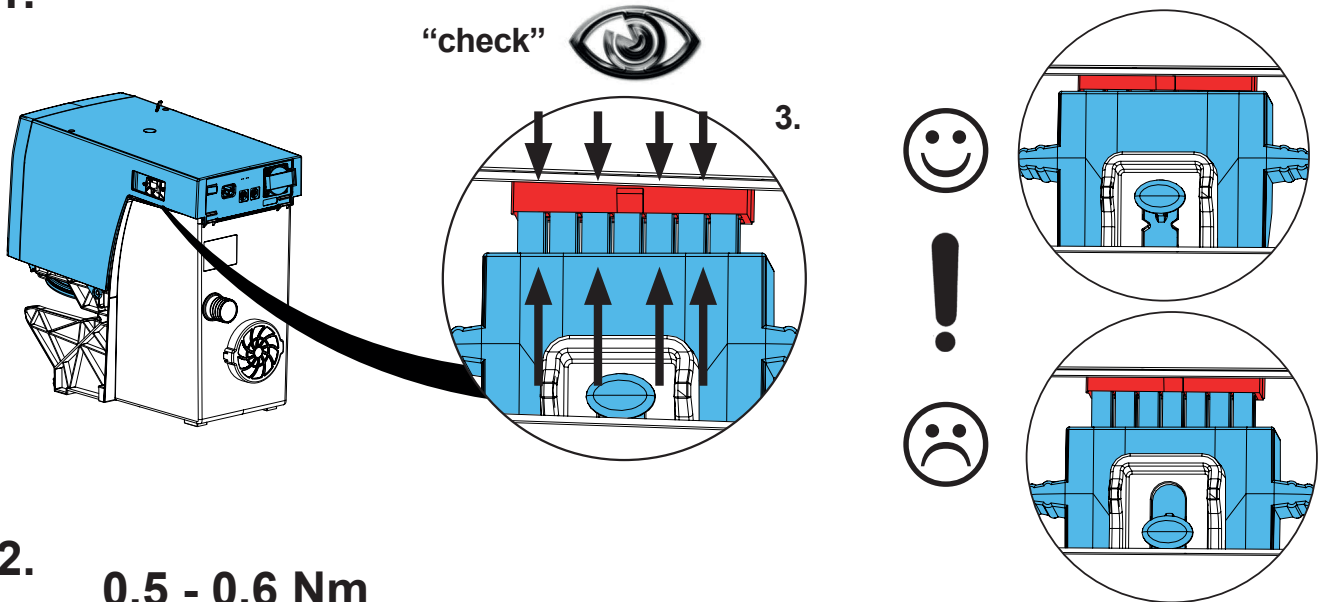

22.

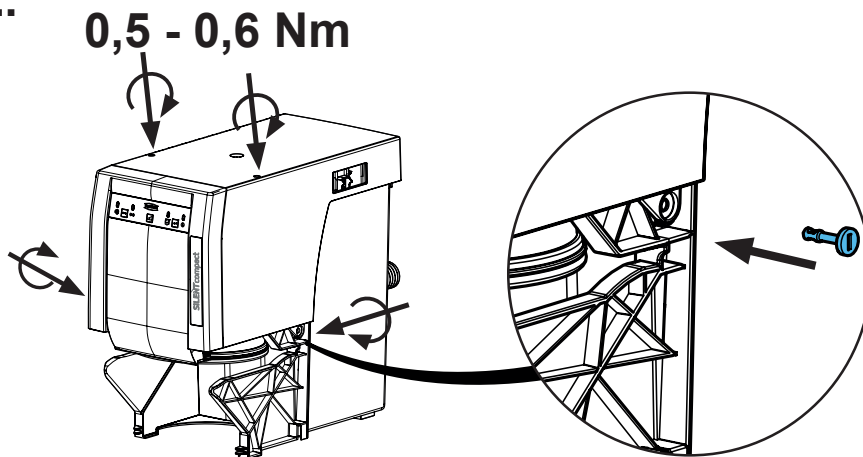

23.

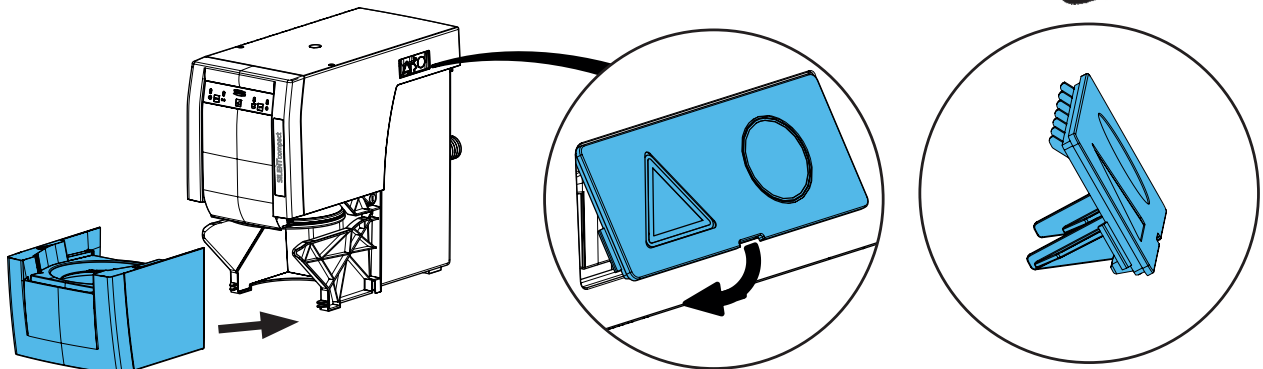

Schutzleiterprüfung durchführen: siehe am Ende der „Service Instructions“.
Performing the protective conductor test: see at the end of the “Service instructions”.
Pour vérifier le conducteur de protection: voir à la fin des “Instructions de service”.
Per la verifica del conduttore di terra: vedere alla fine delle “Istruzioni di servizio”.
Realizar la prueba del conductor de protección: véase al final de las “Instrucciones de servicio”.
Выполнить проверку защитного провода: см. в конце „Инструкции по обслуживанию“.





Montageanleitung • Assembly Instruction • Instruction d'installation
Istruzioni l'istallazione • Instrucciones de montaje • Руководство по монтажу

making work easy

90003 3514 / 90003 3515

Leiterkarte CAM • Printed board circuit CAM • Circuit imprimé CAM
Circuito stampato CAM • Circuito impresso CAM • Печатная плата CAM

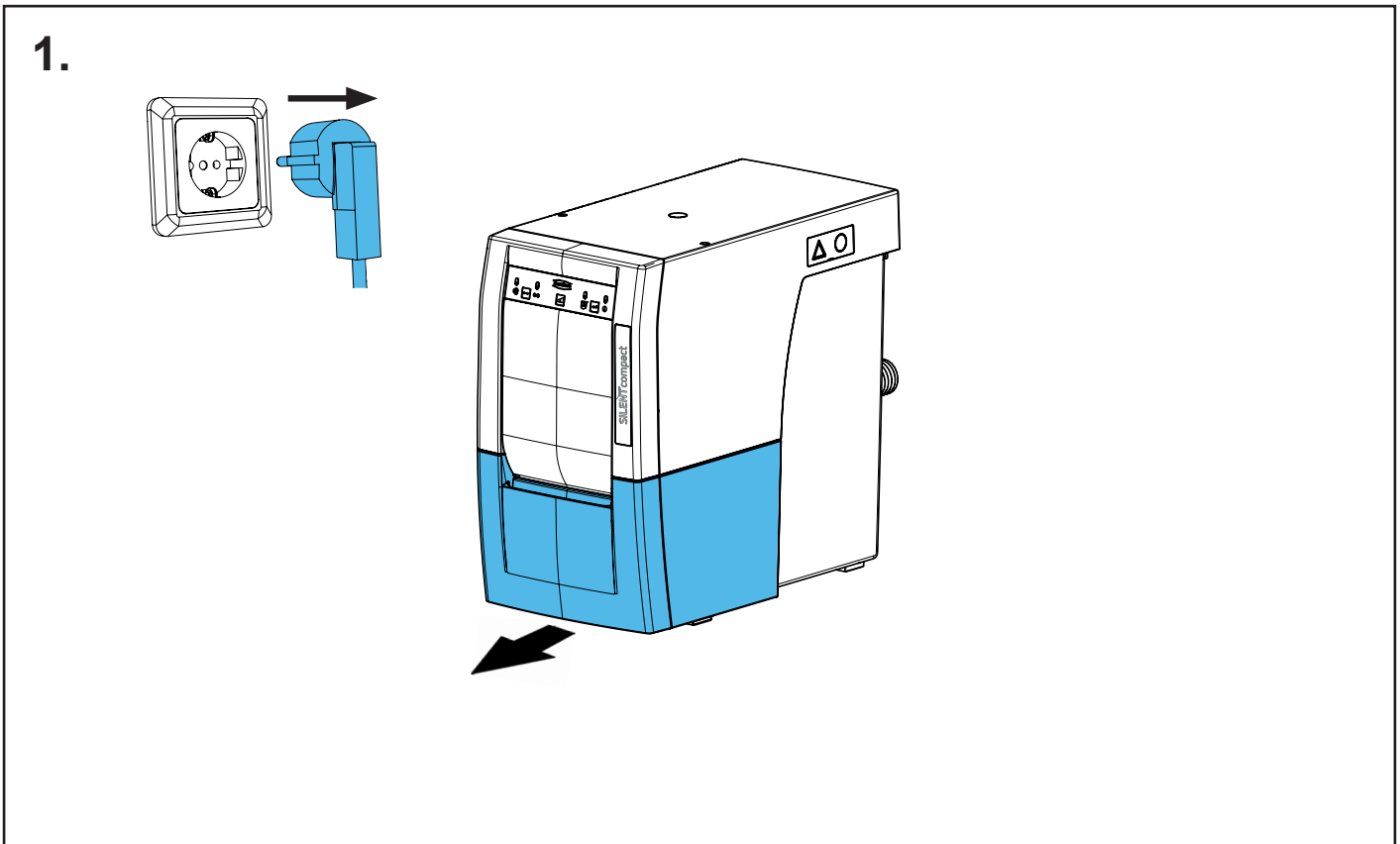
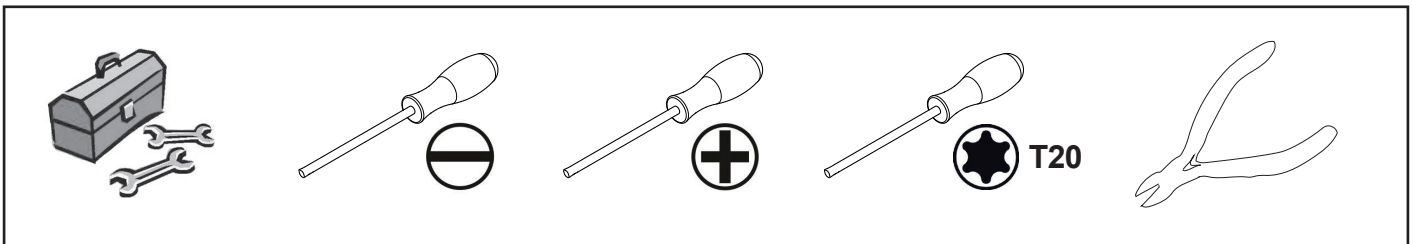
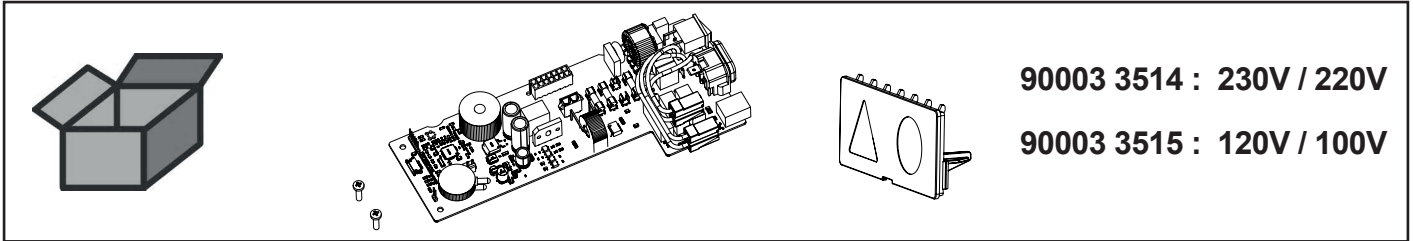

2.

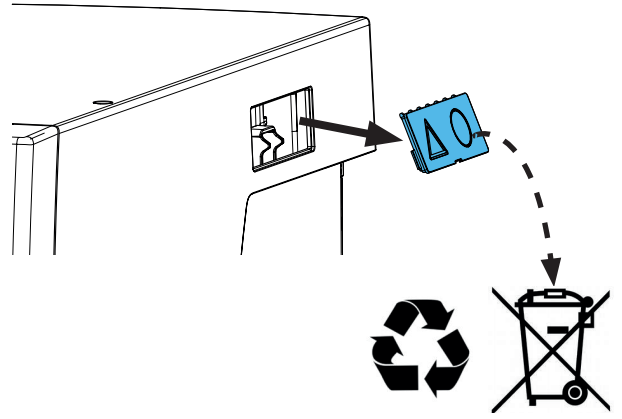
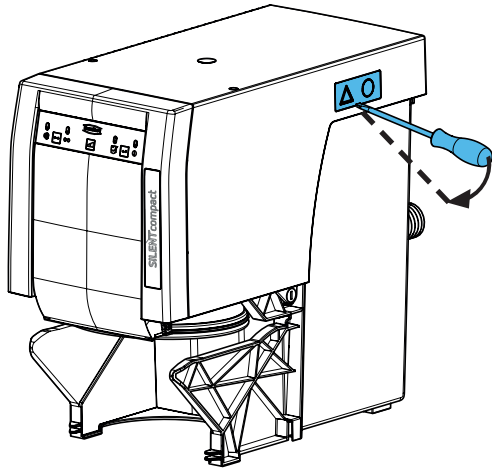

3.

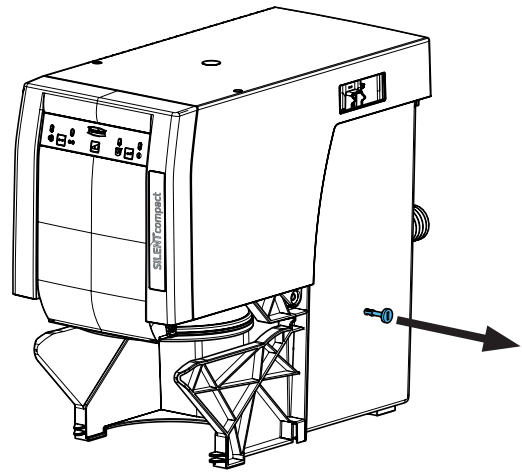
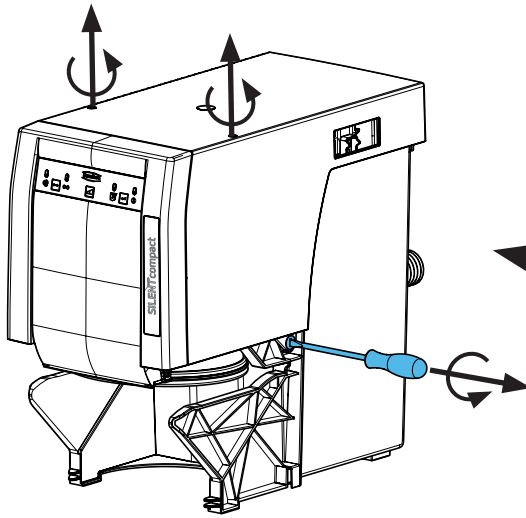

4.

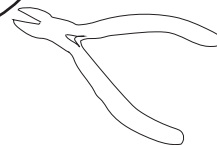
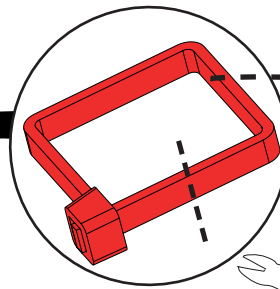
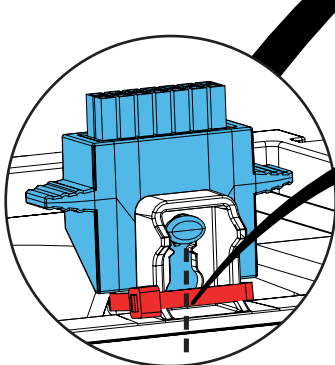
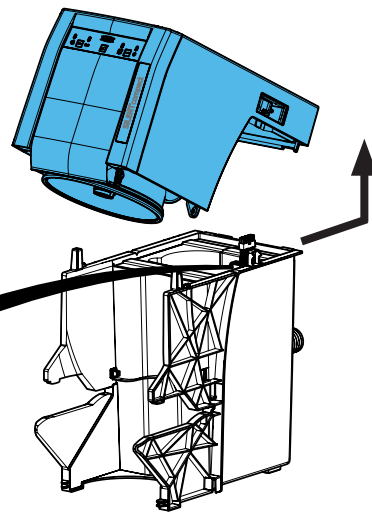
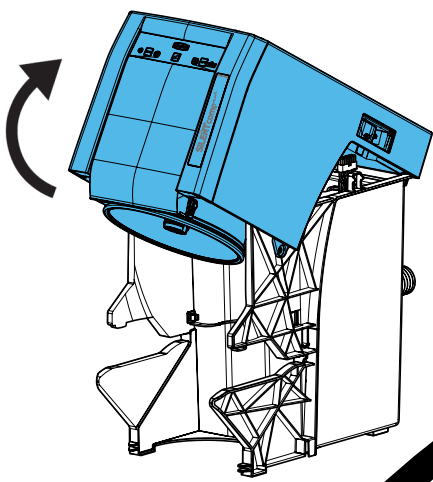

5.

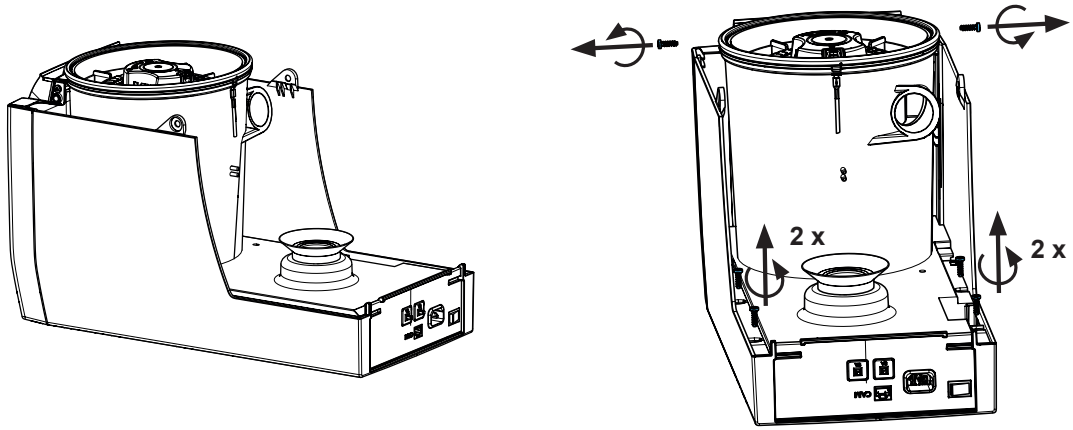

6.

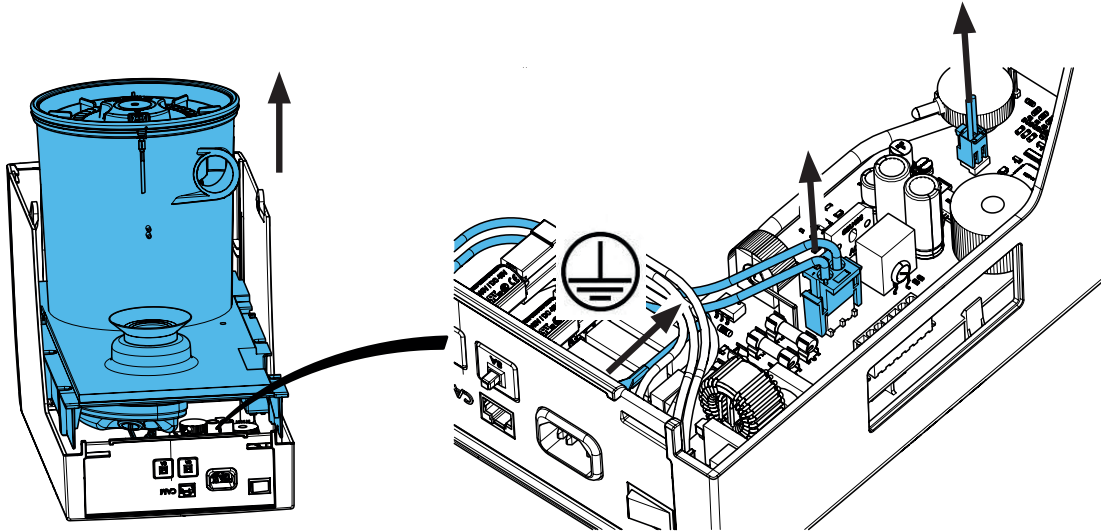

7.

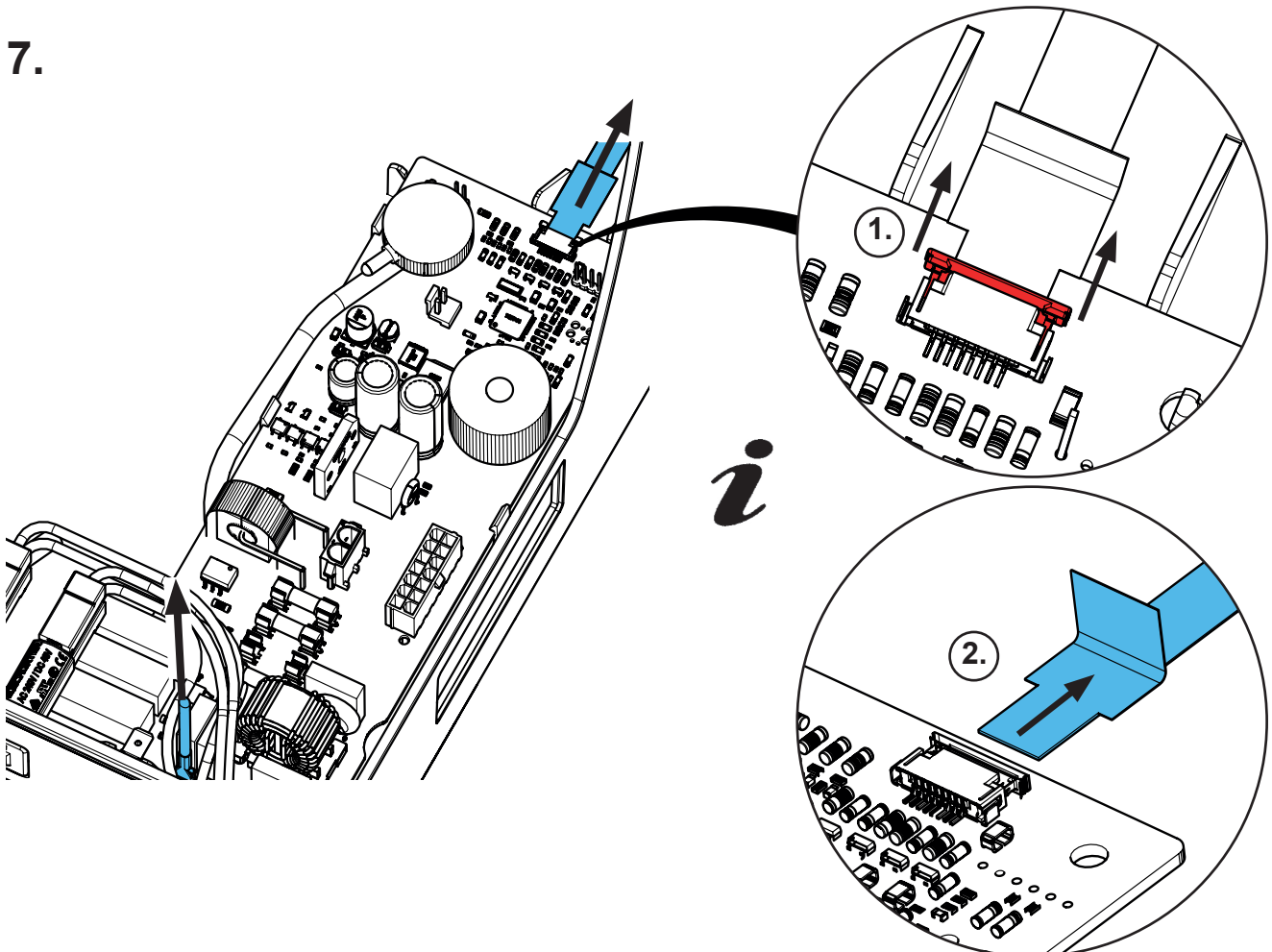

8.

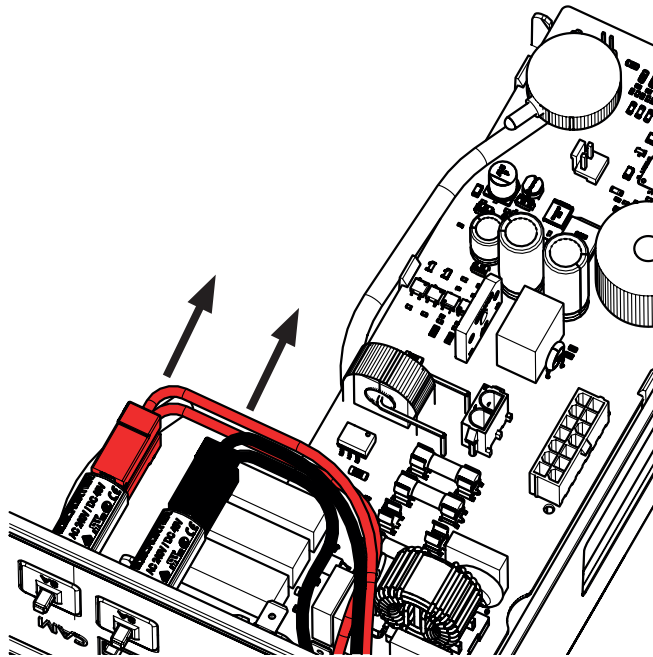

9.

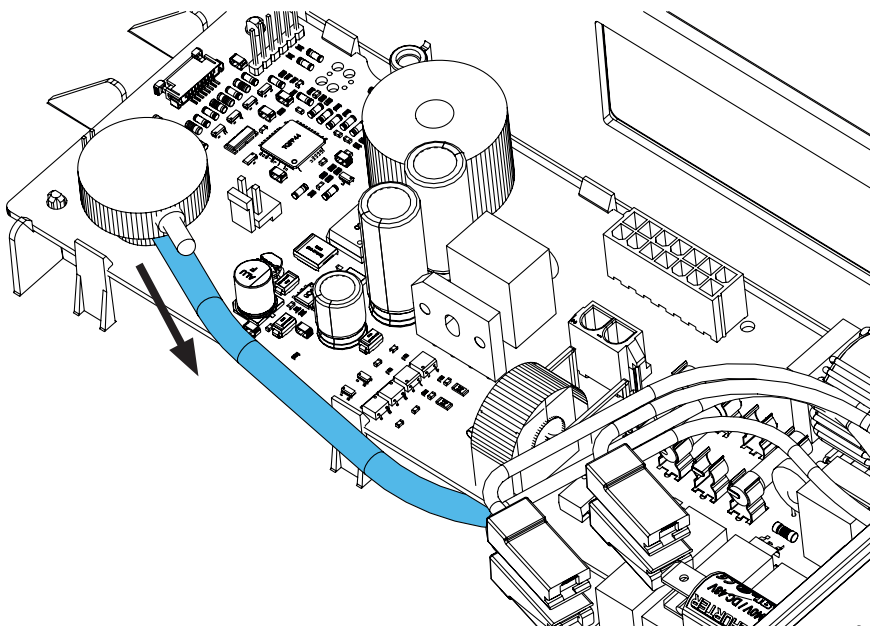

10.

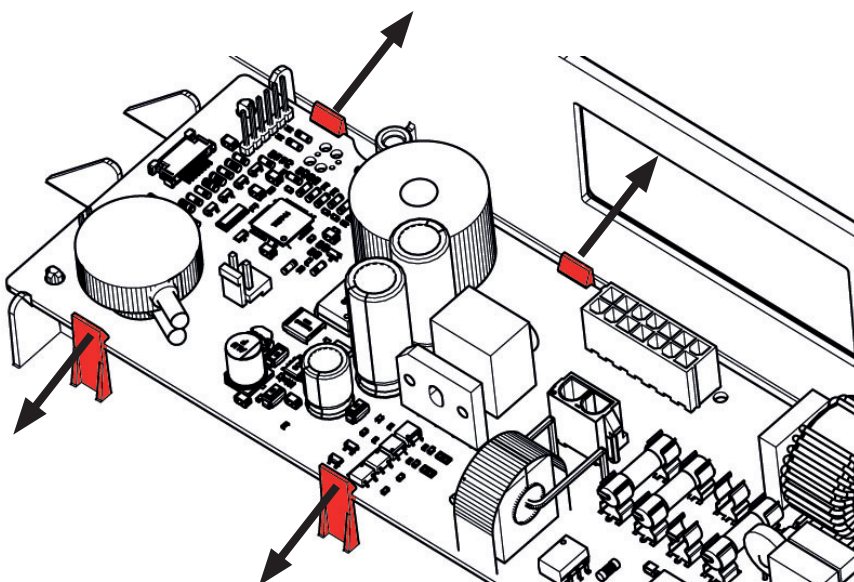

11.

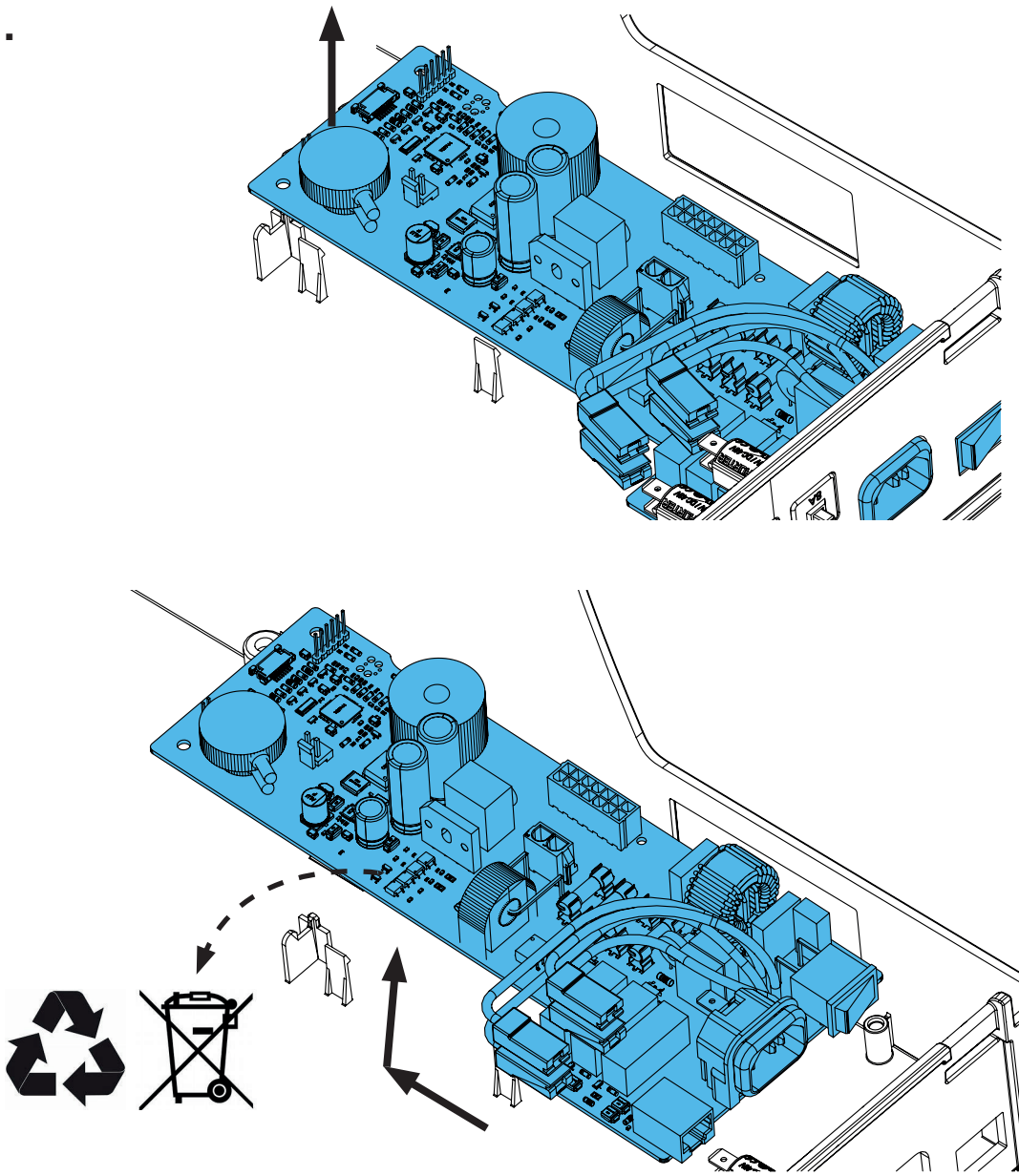

12.

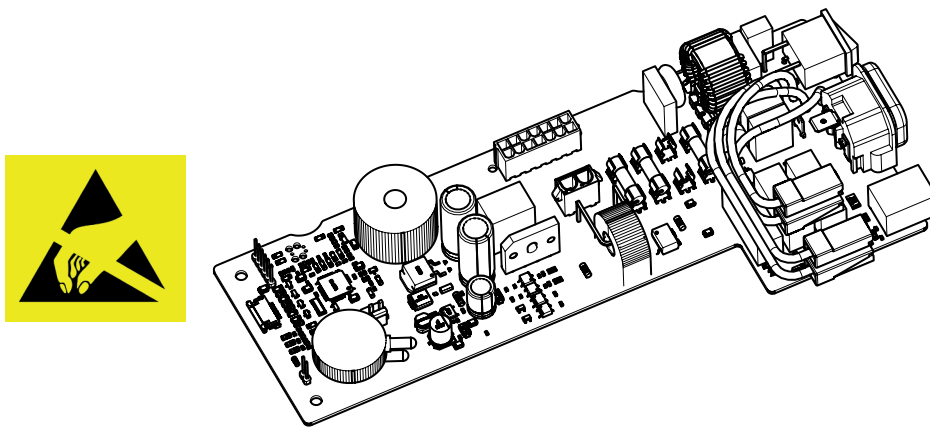

13.

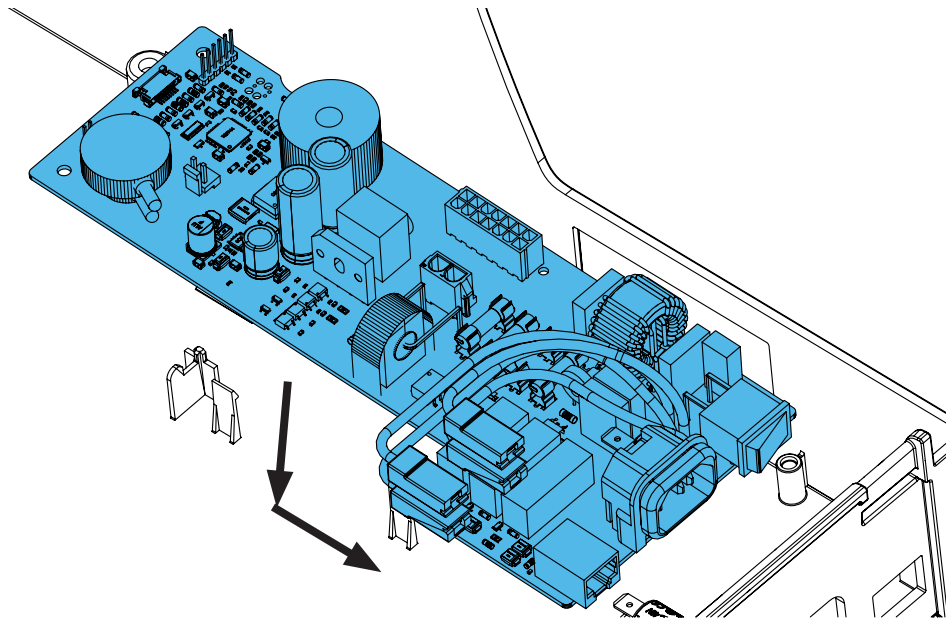

14.

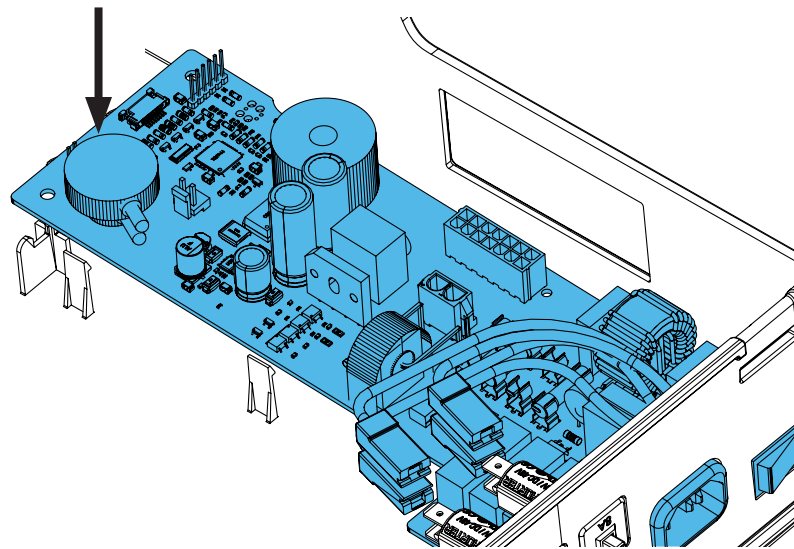

15.

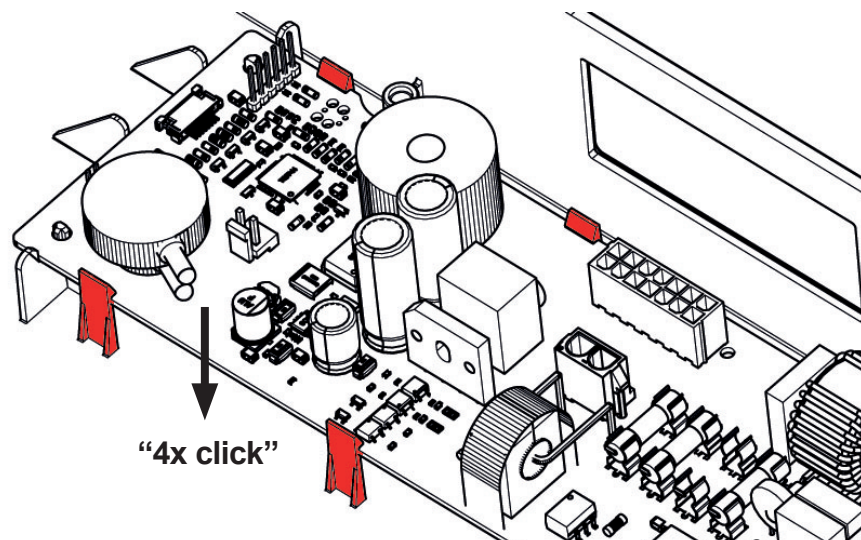

16.

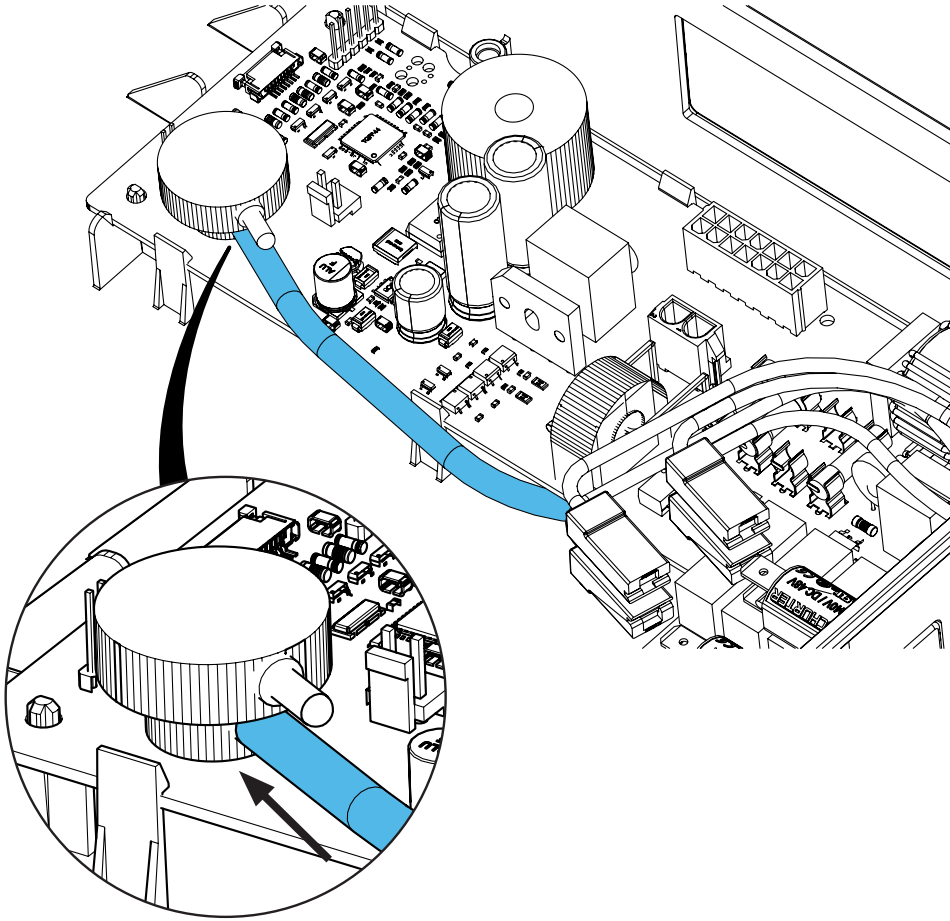

17.

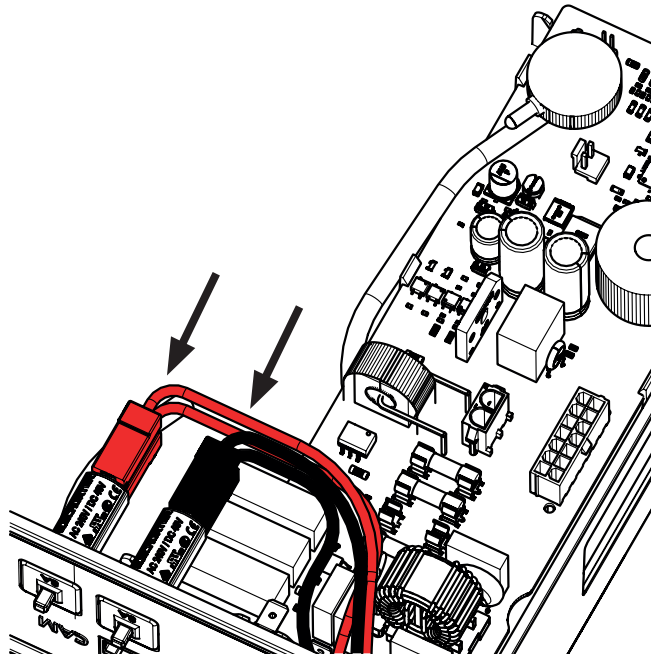

18.

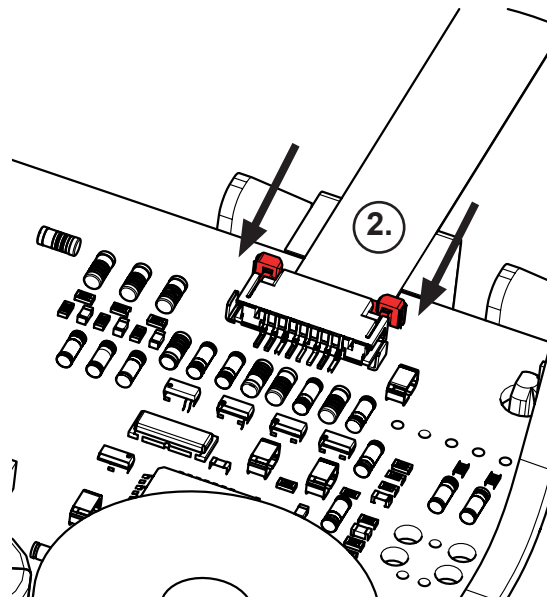
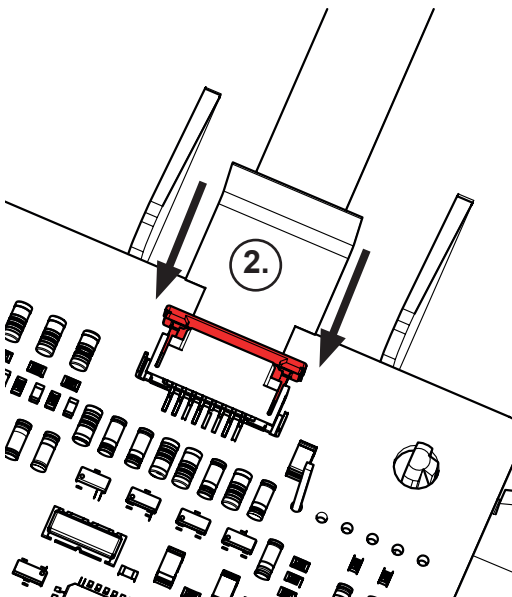
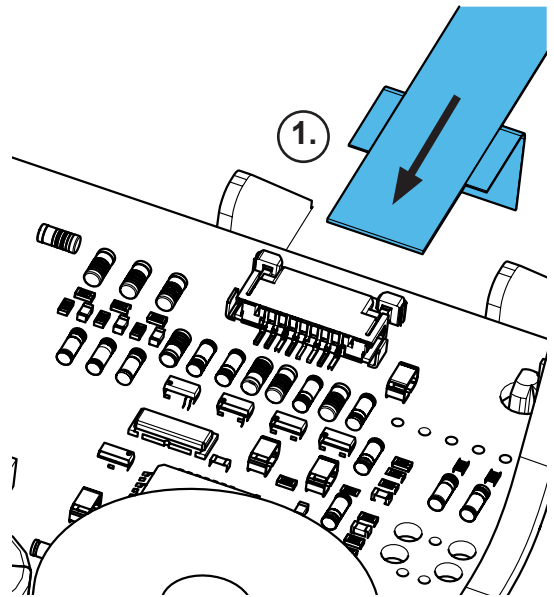
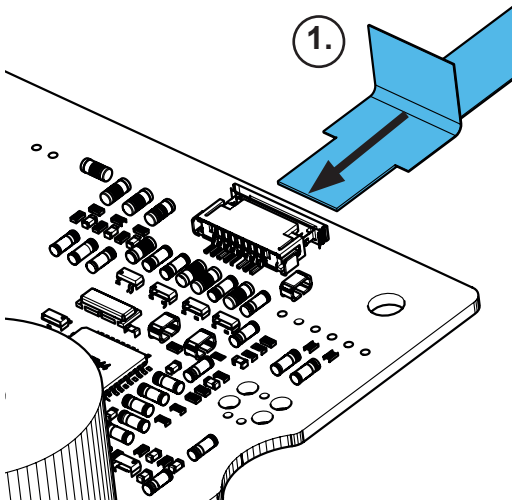
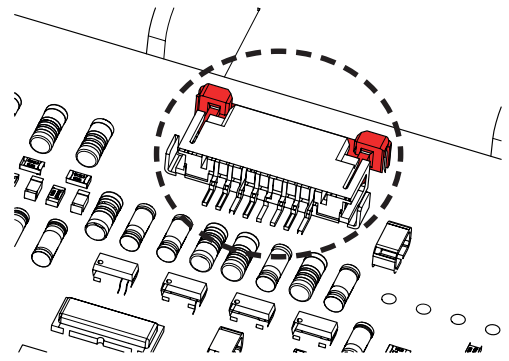
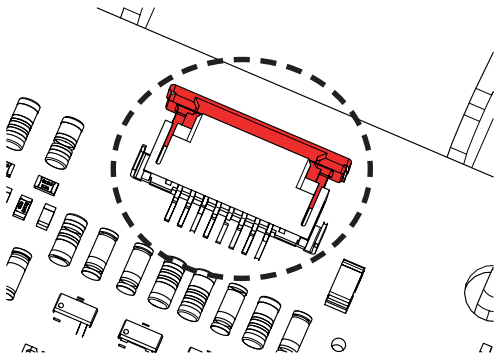

19.

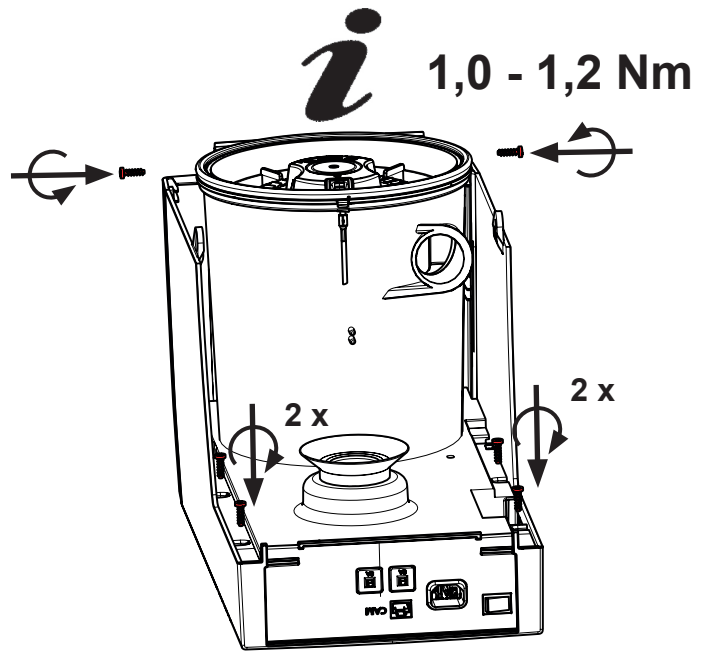
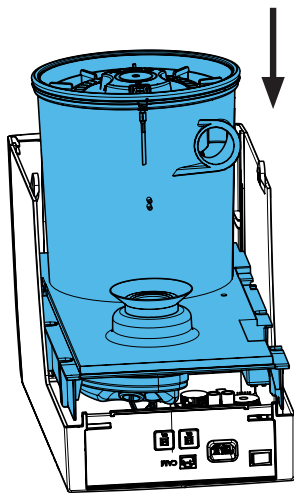

20.

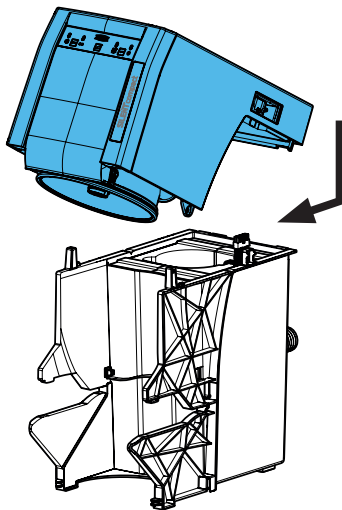

21.

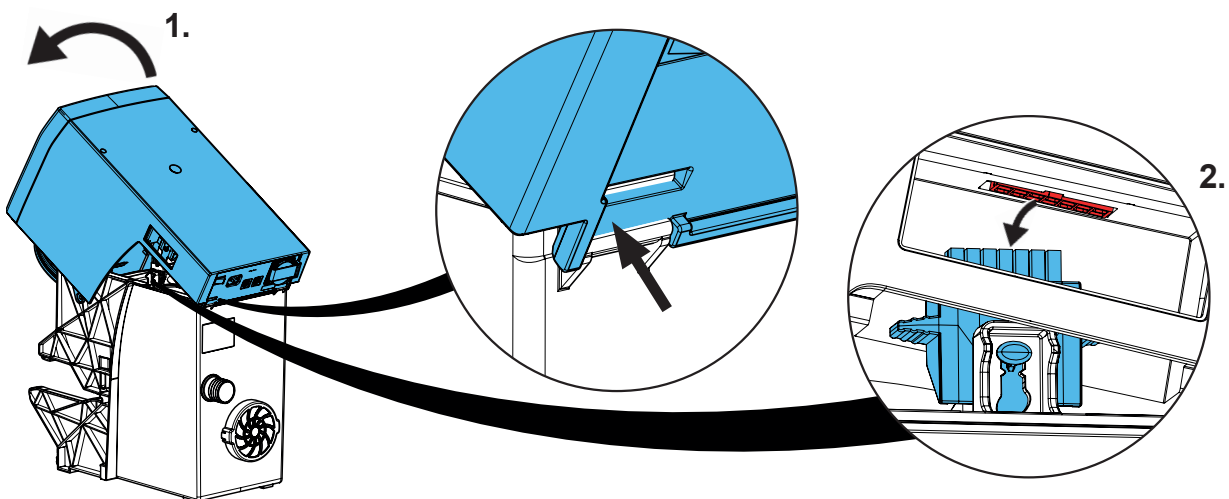

22.

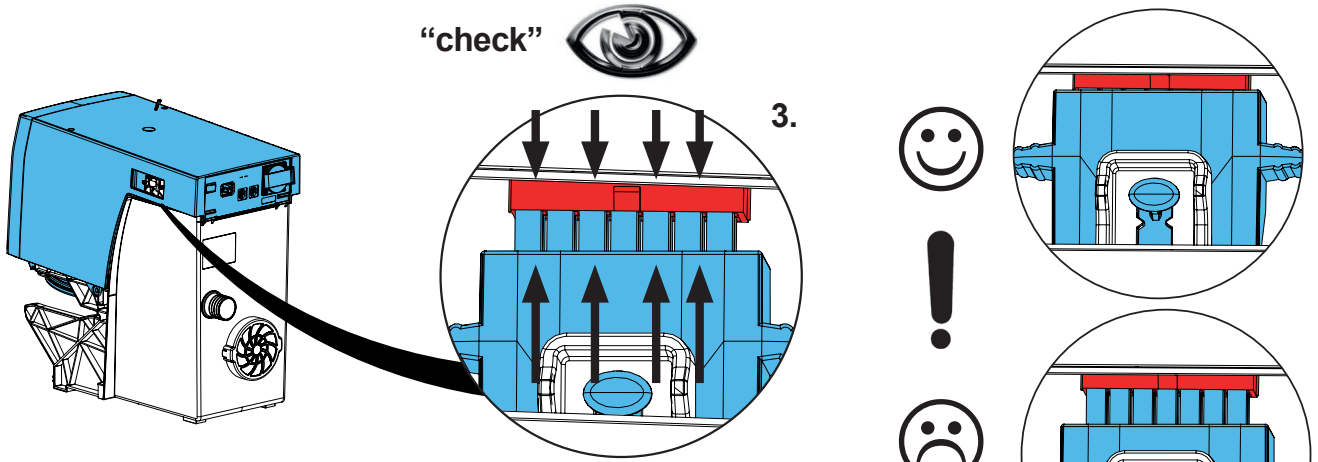

23.

0,5 - 0,6 Nm

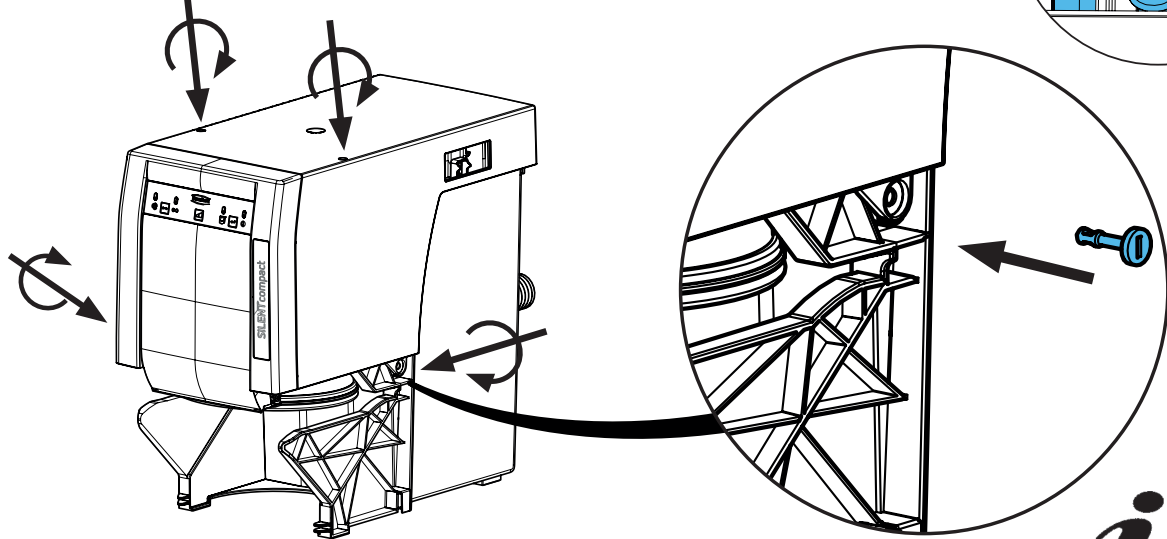

24.

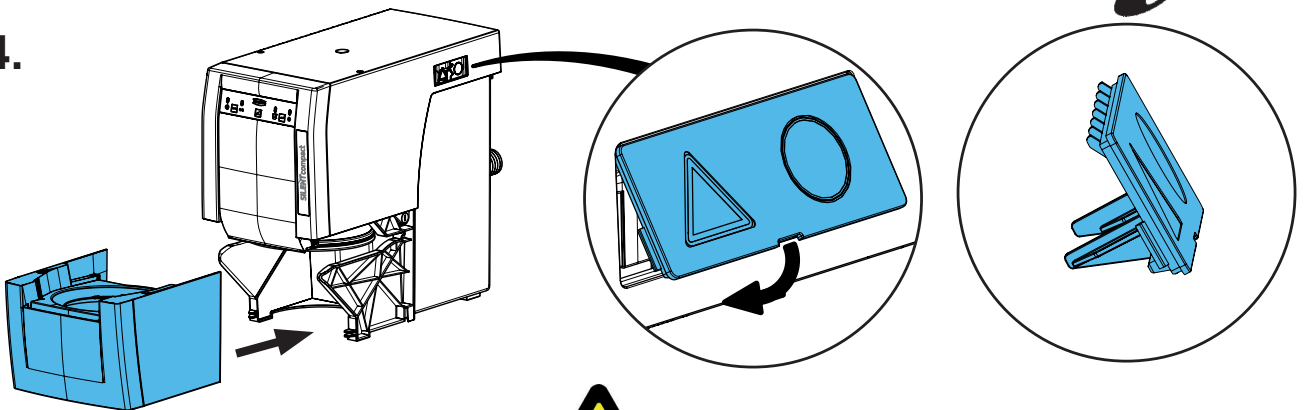

Schutzleiterprüfung durchführen: siehe am Ende der „Service Instructions“.
 Performing the protective conductor test: see at the end of the “Service instructions”.
 Pour vérifier le conducteur de protection: voir à la fin des “Instructions de service”.
 Per la verifica del conduttore di terra: vedere alla fine delle “Istruzioni di servizio”.
 Realizar la prueba del conductor de protección: véase al final de las “Instrucciones de servicio”.
 Выполнить проверку защитного провода: см. в конце „Инструкции по обслуживанию“.





Montageanleitung • Assembly Instruction • Instruction d'installation
Istruzioni l'istallazione • Instrucciones de montaje • Руководство по монтажу

making work easy

90003 7514

Leiterkarte CAM • Printed board circuit CAM • Circuit imprimé CAM
Circuito stampato CAM • Circuito impresso CAM • Печатная плата CAM

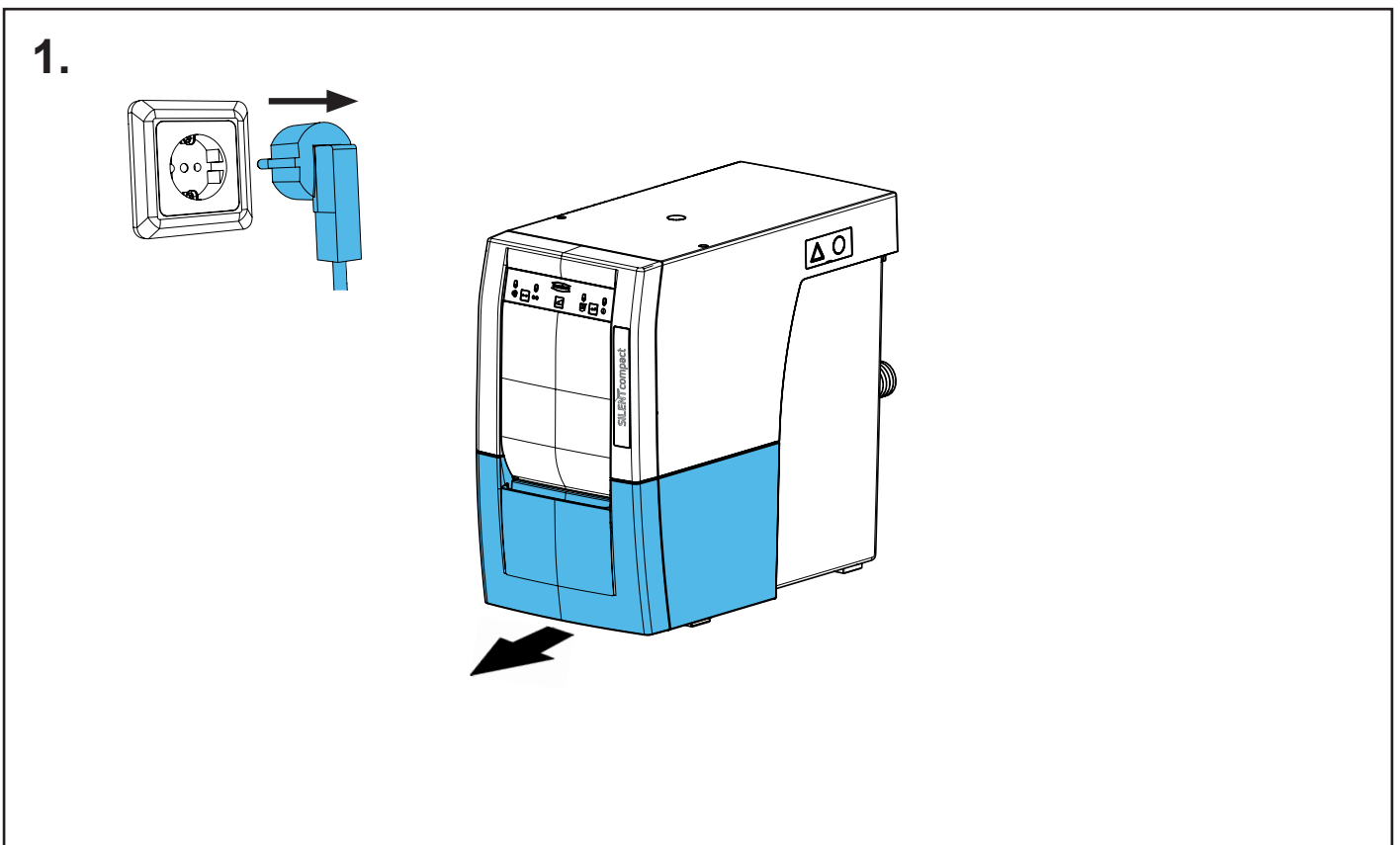
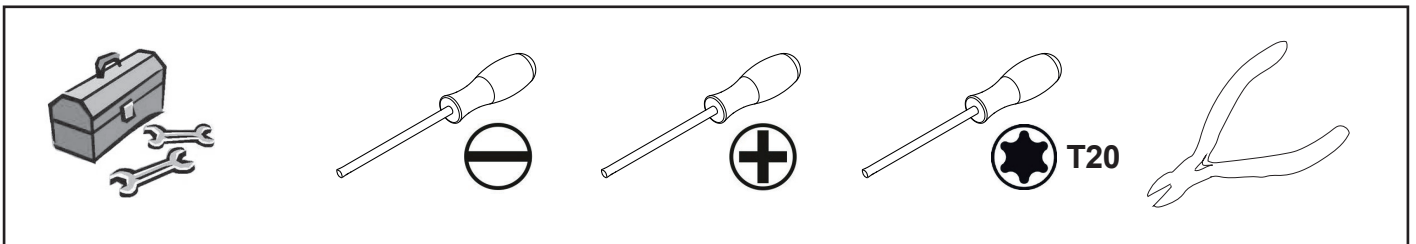
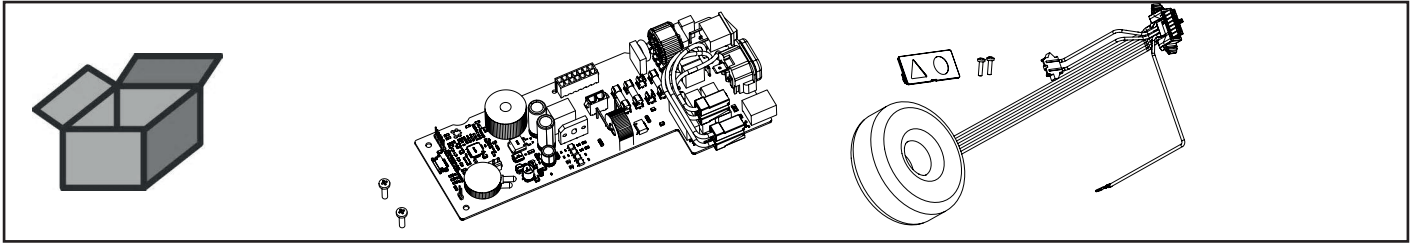

2.

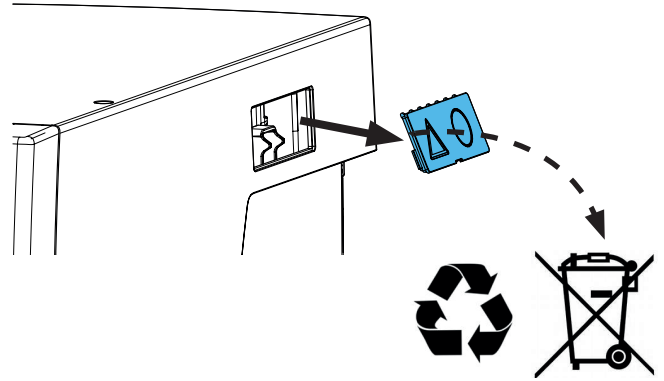
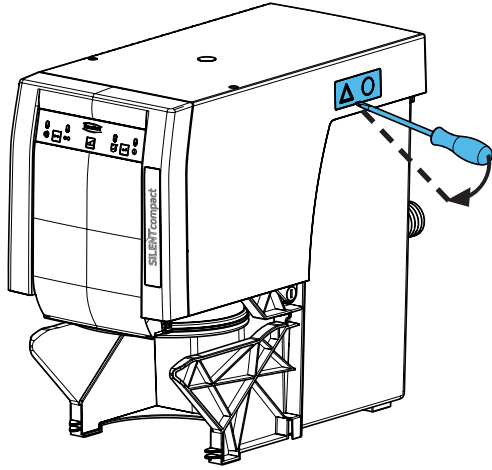

3.

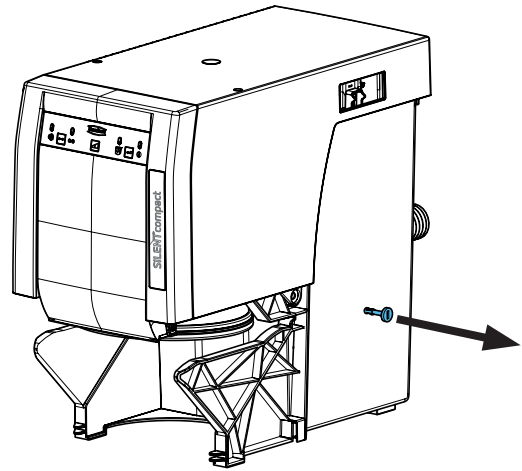
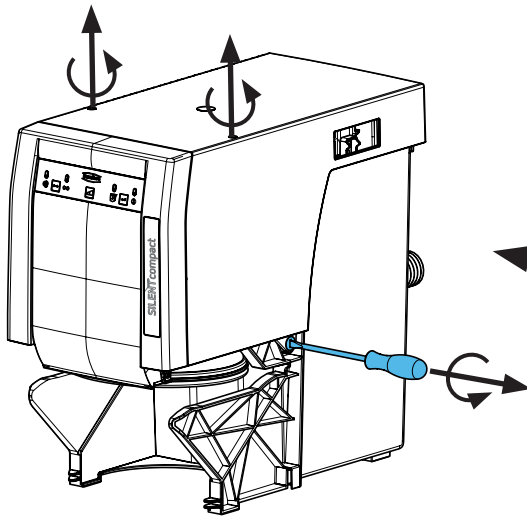

4.

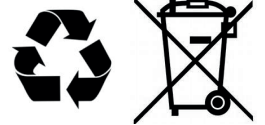
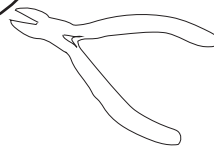
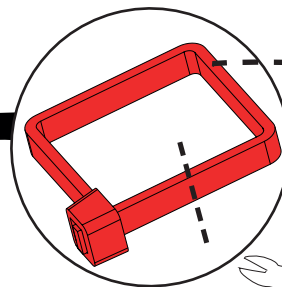
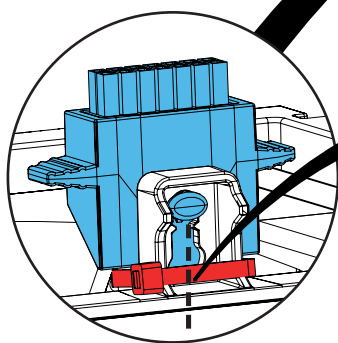
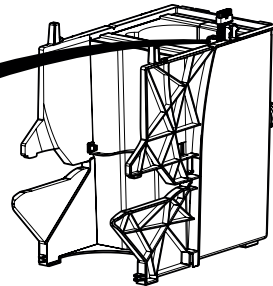
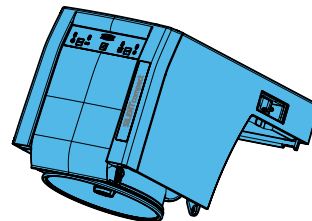
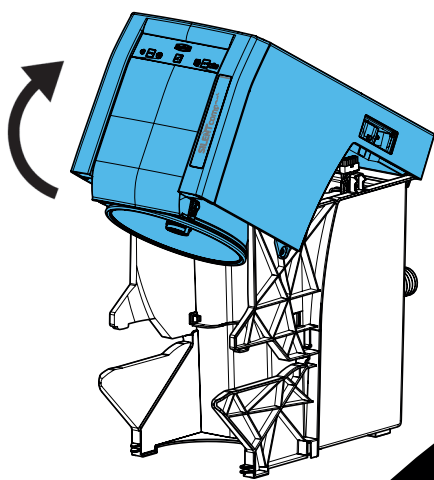

5.

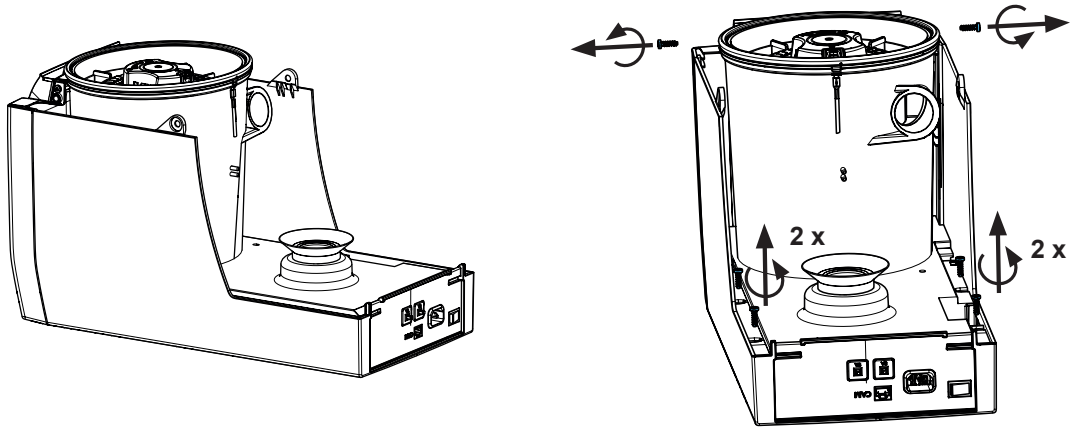

6.

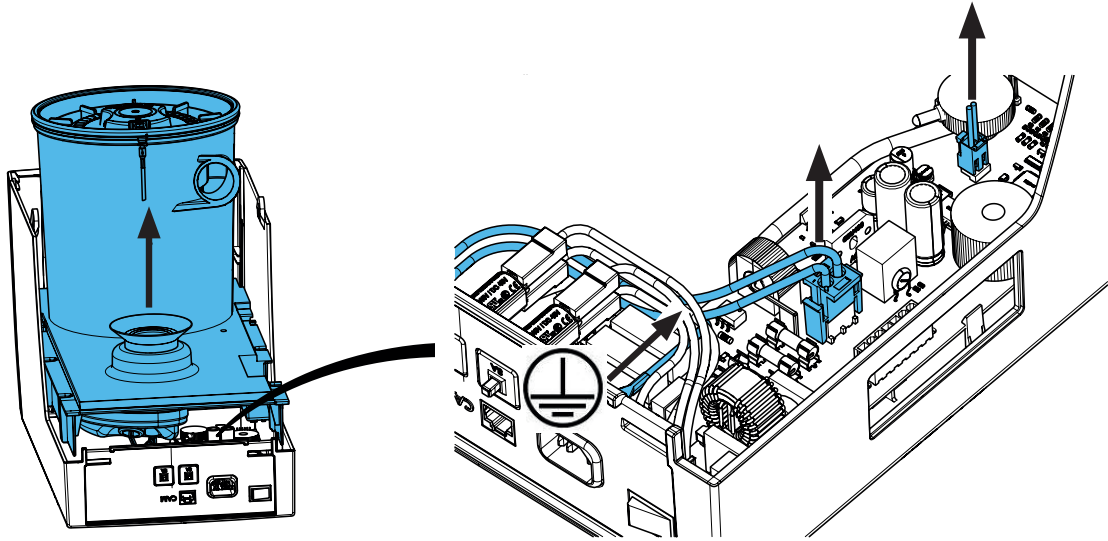

7.

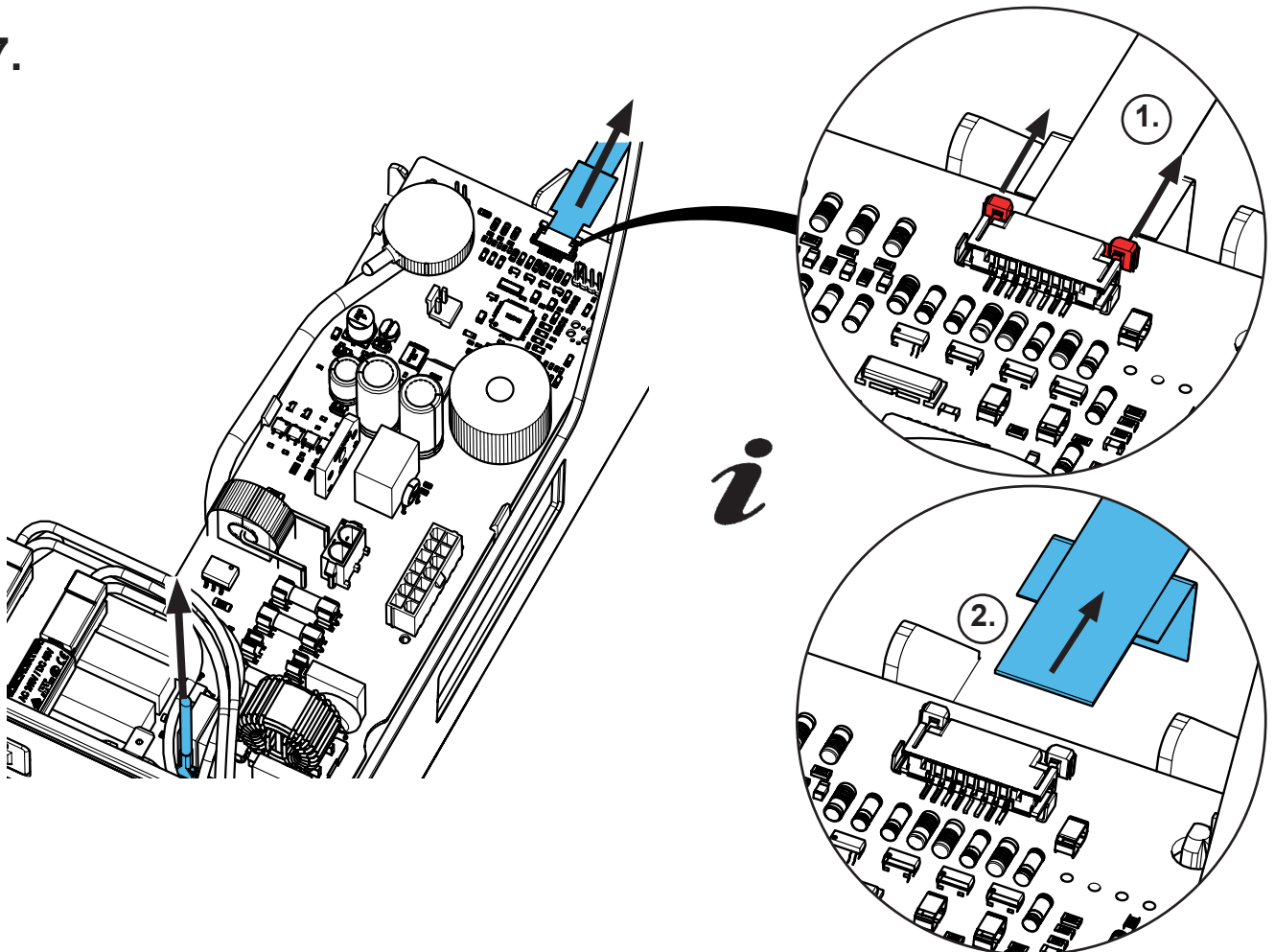

8.

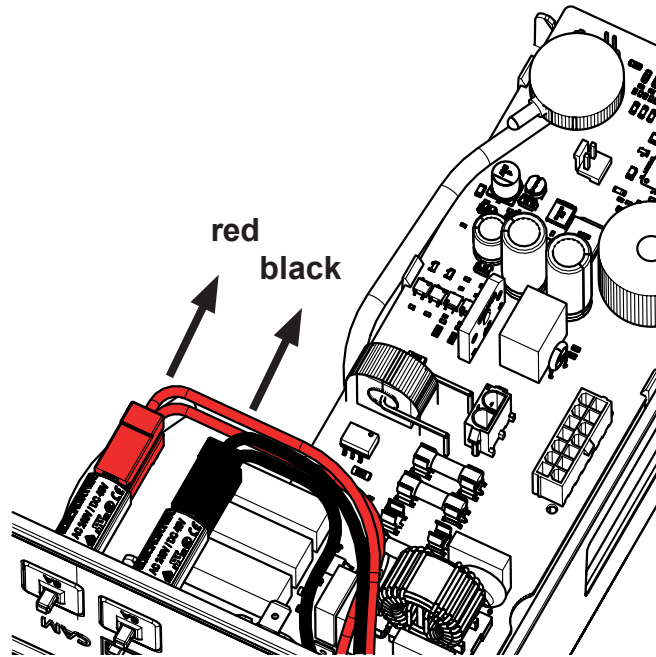

9.

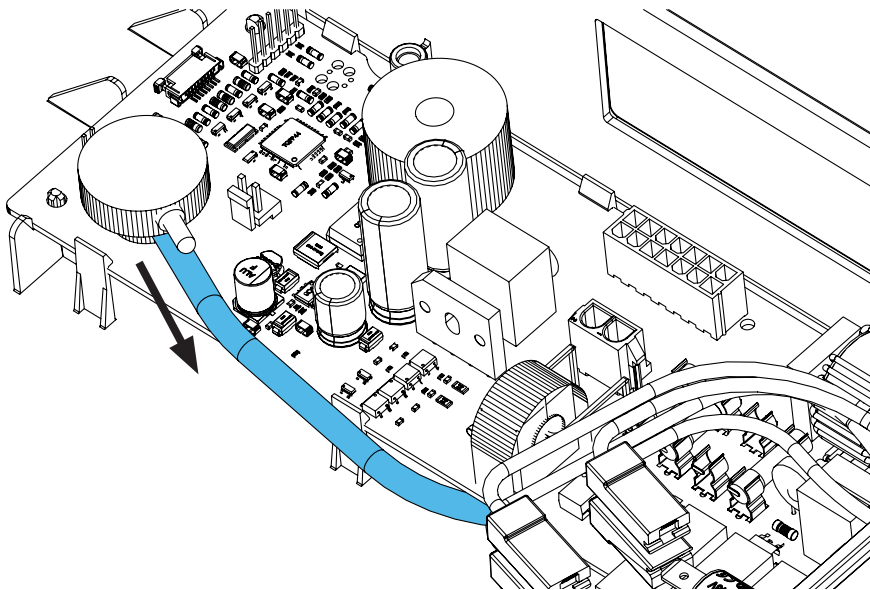

10.

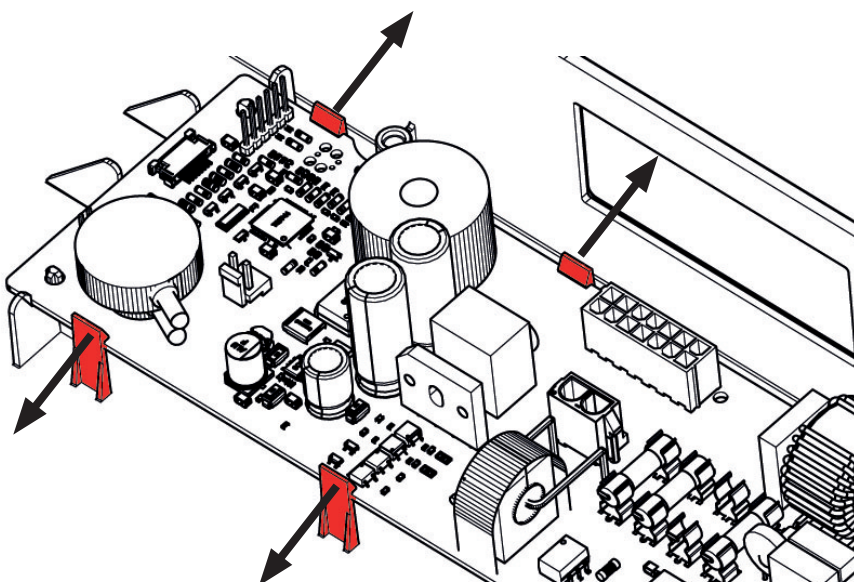

11.

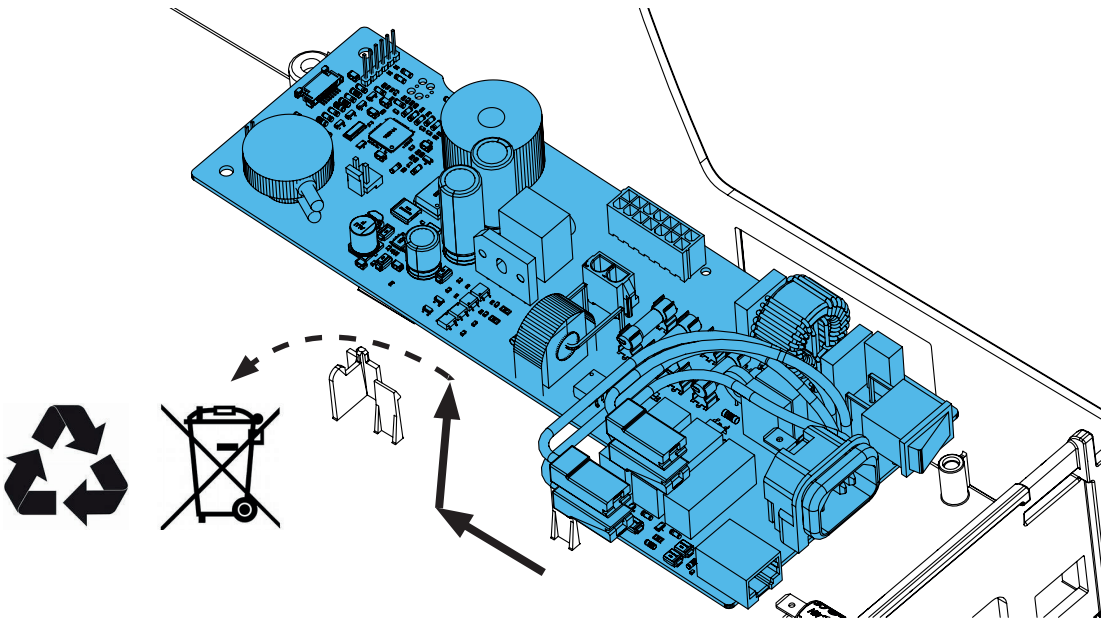
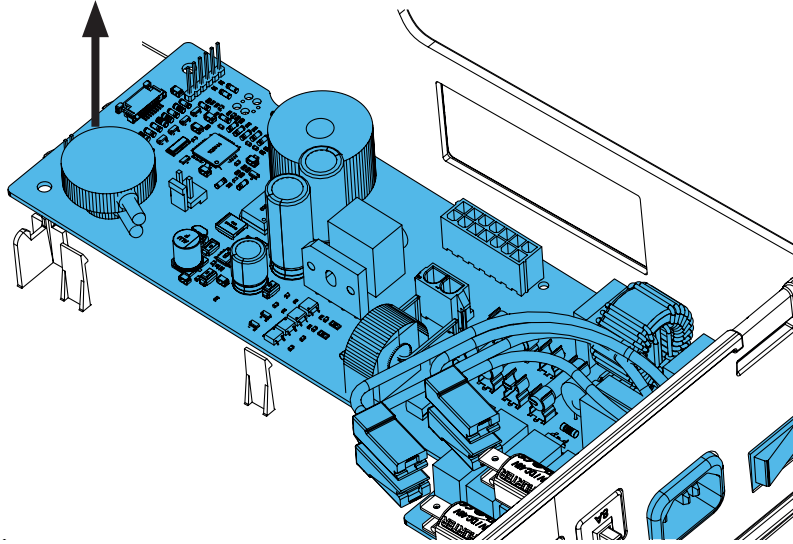

12.

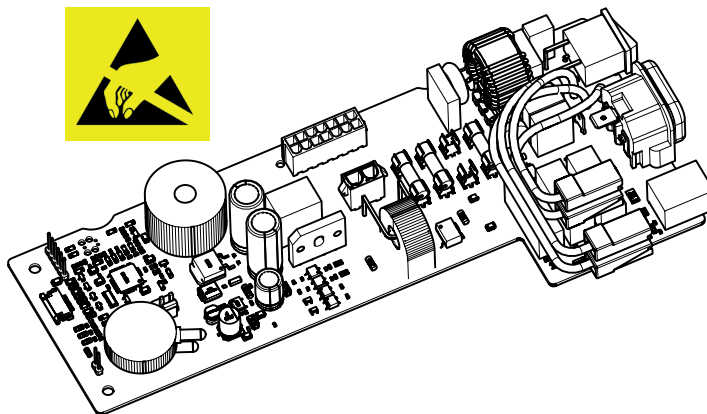

13.

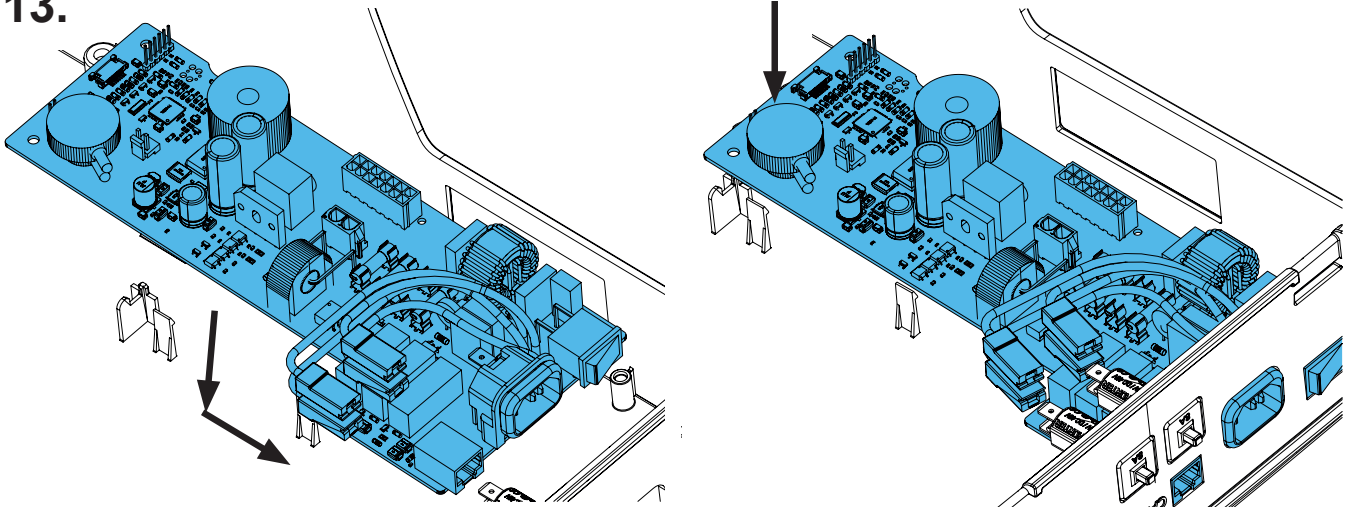

14.

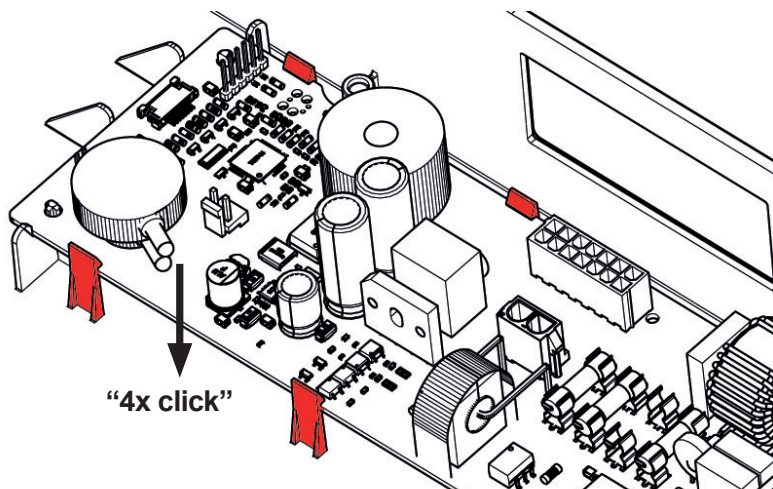

15.

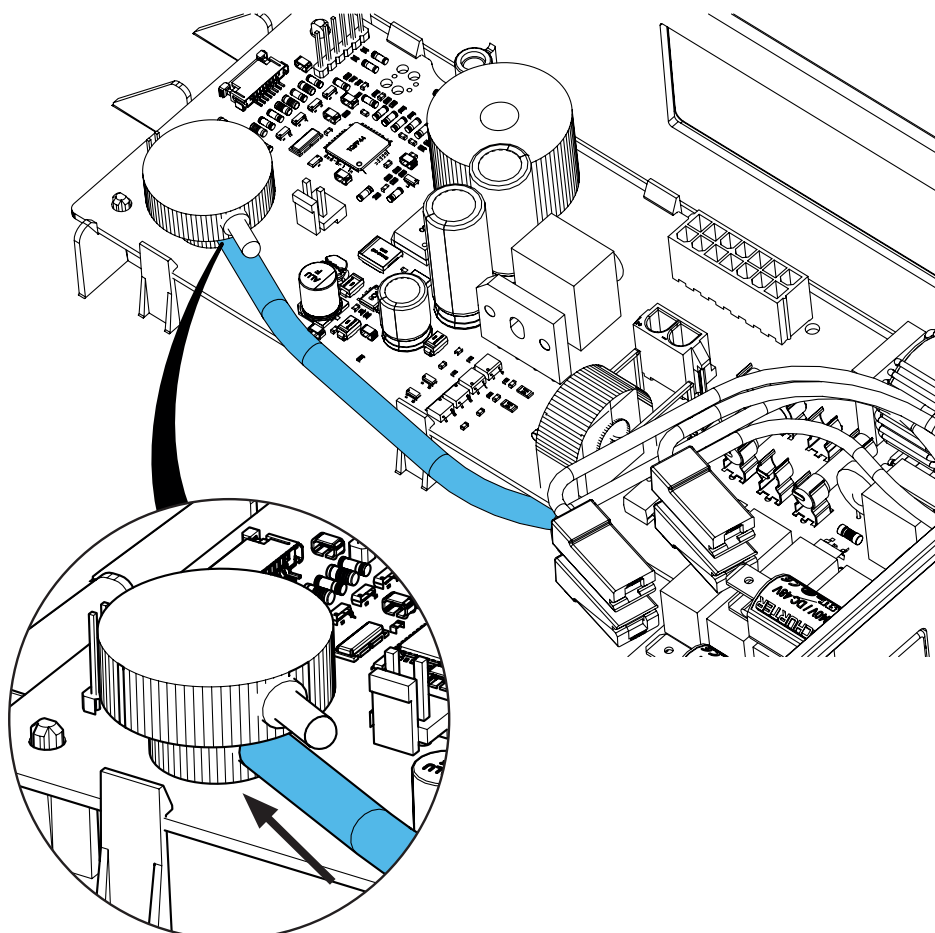

16.

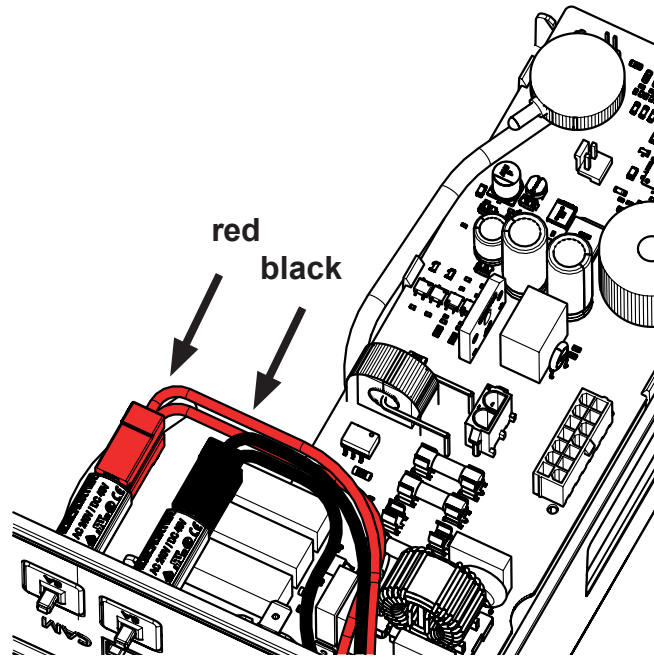

17.

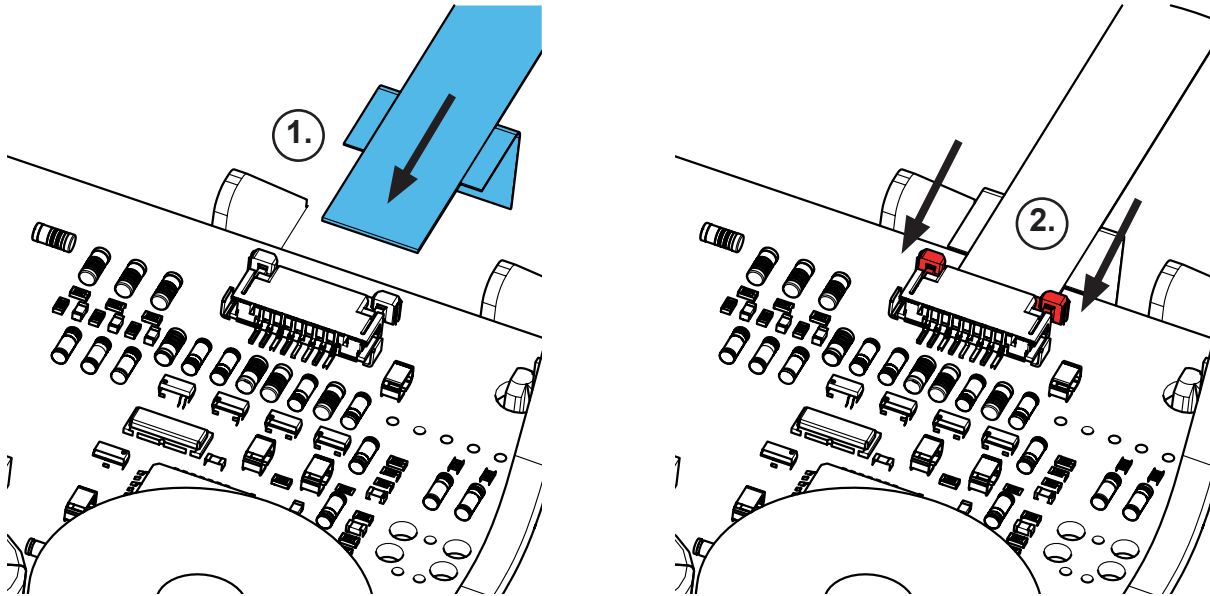

18.

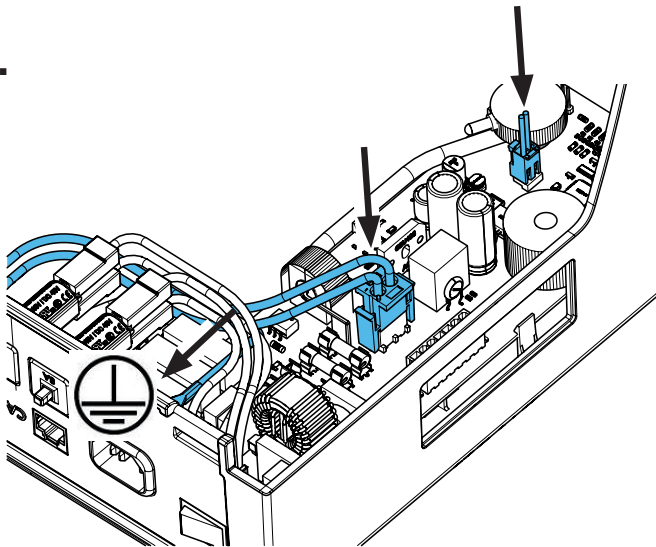

19.

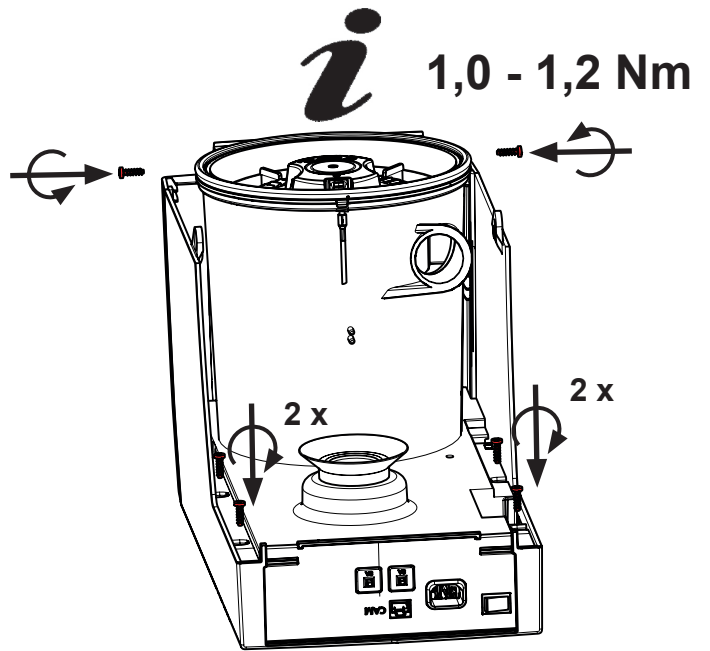
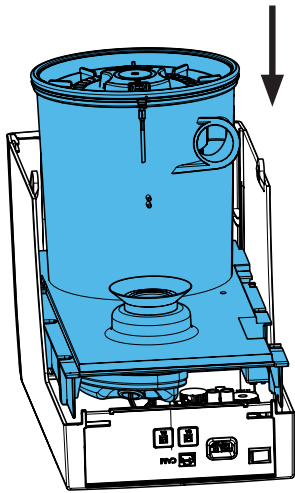

20.

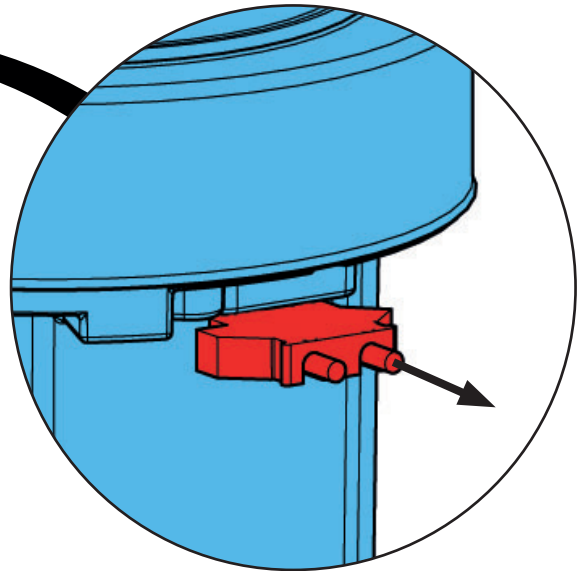
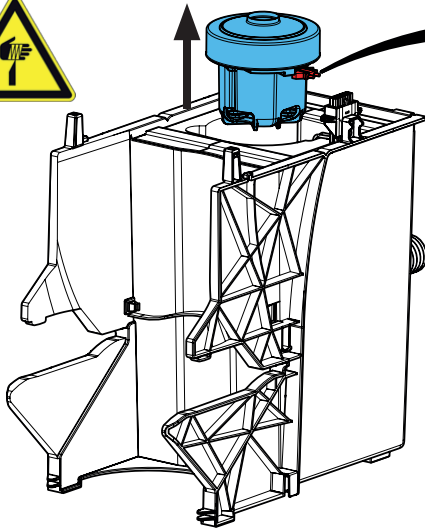

21.

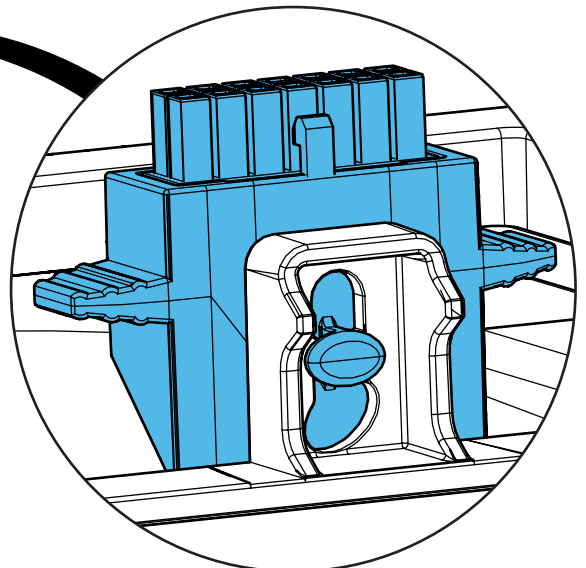
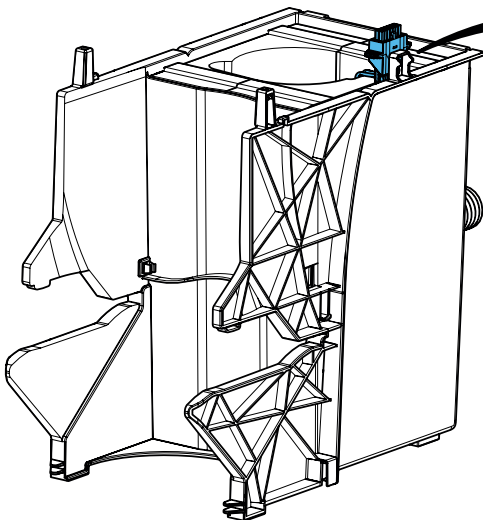

22.

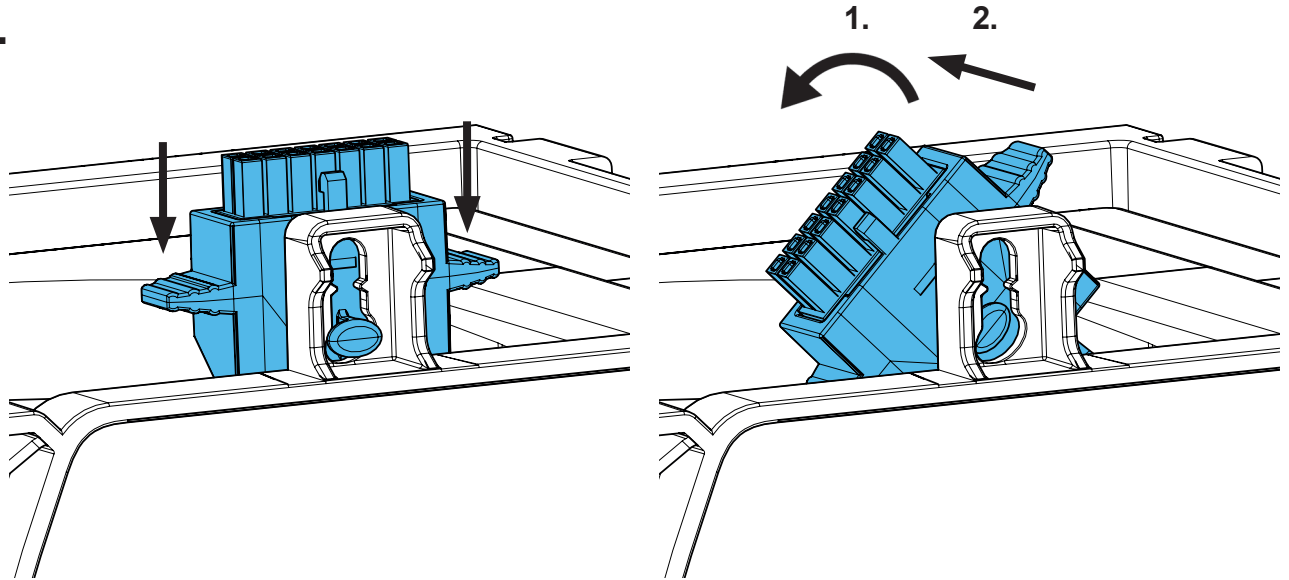

23.

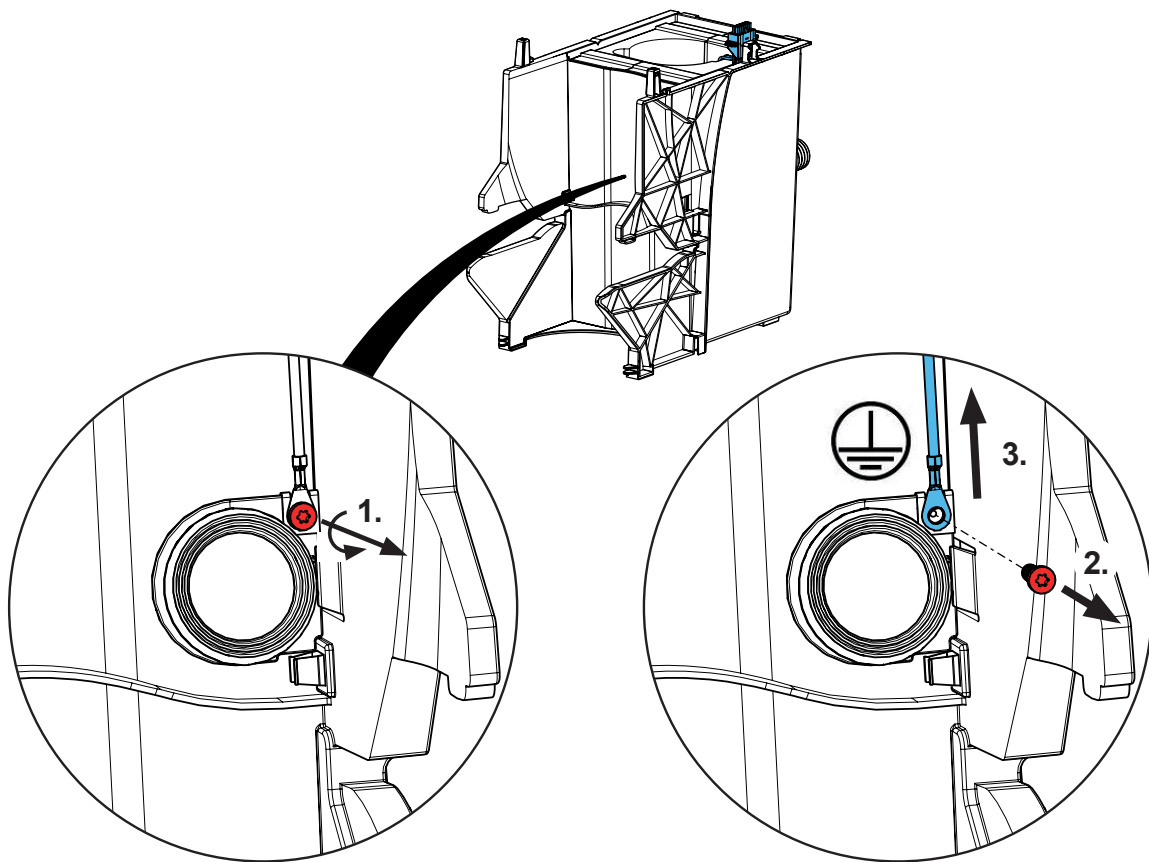

24.

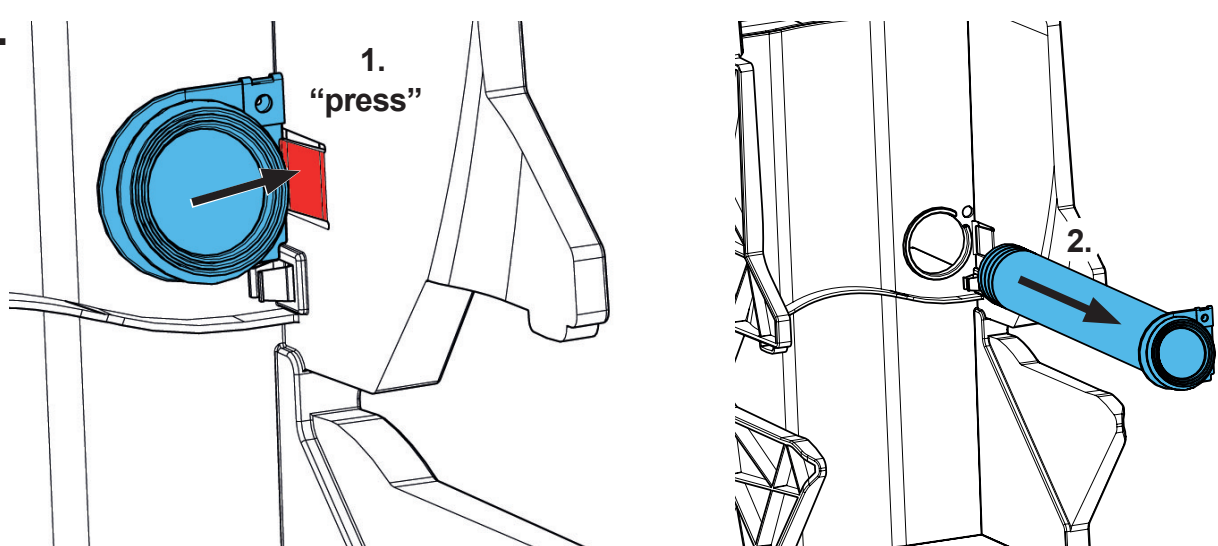

25.

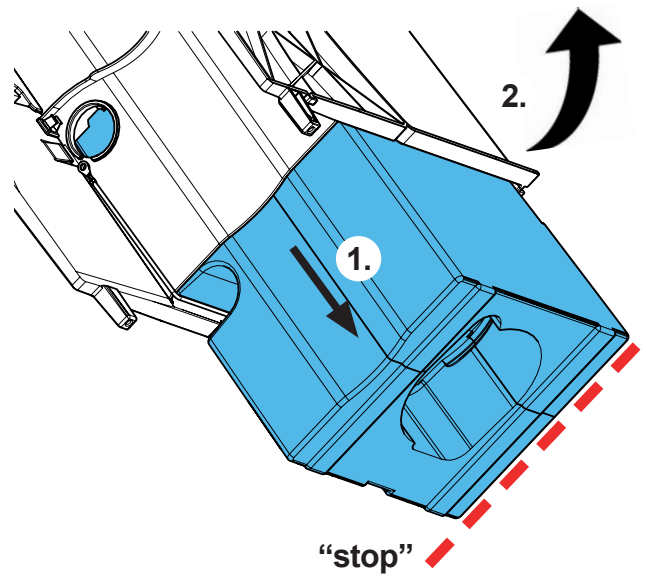
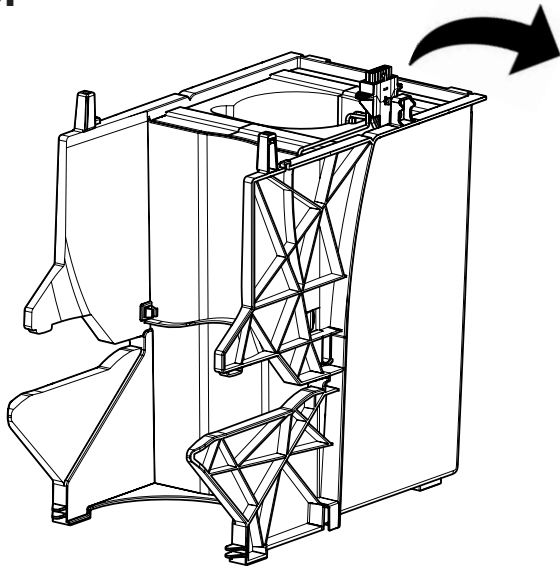

26.

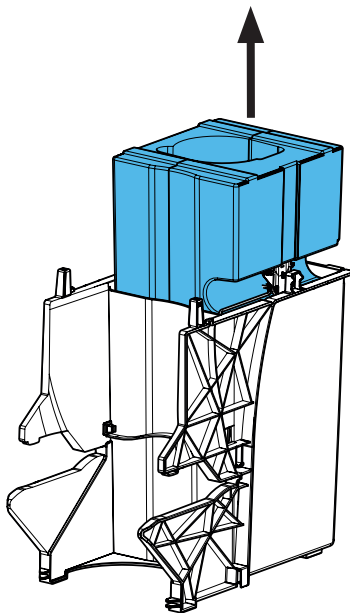

27.

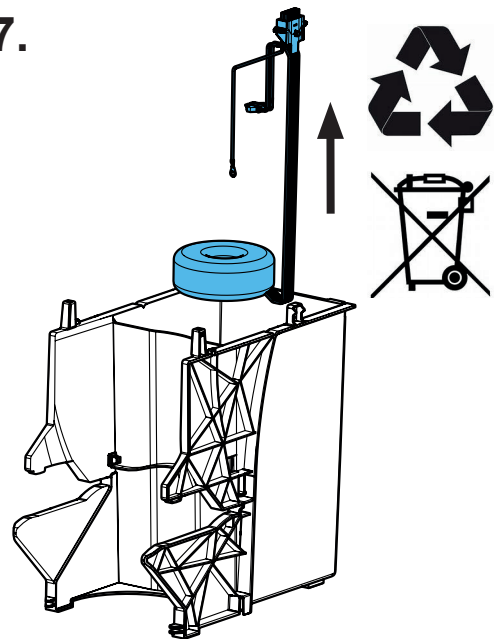

28.

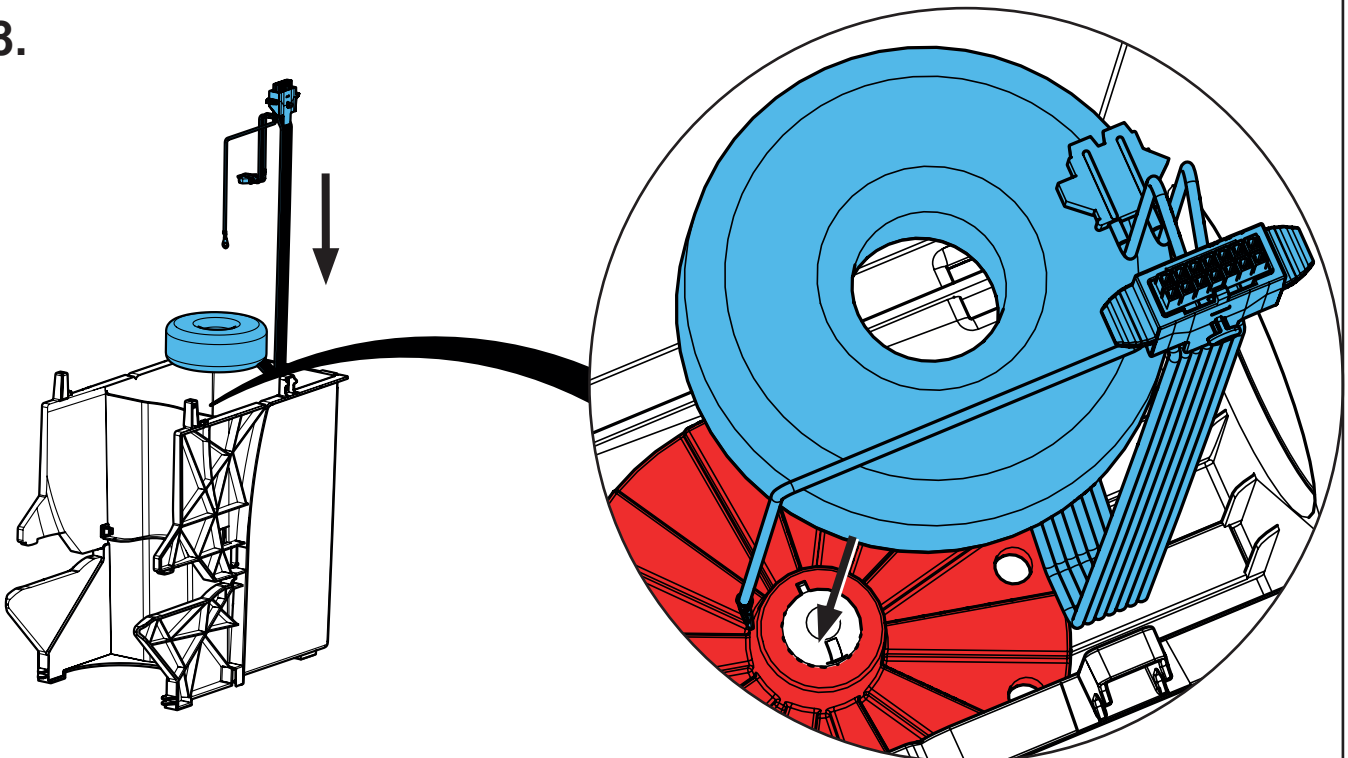

29.

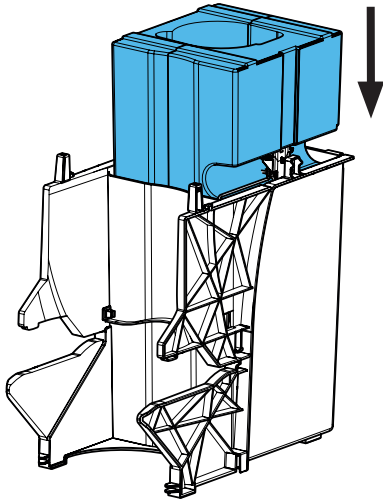

30.

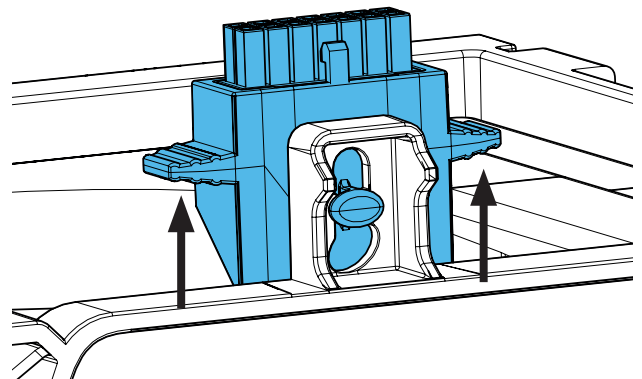
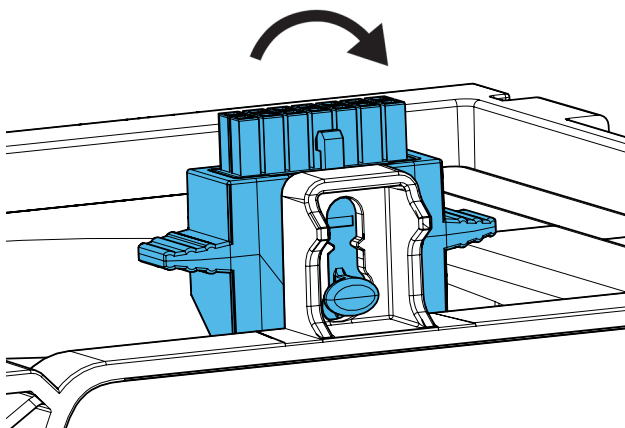
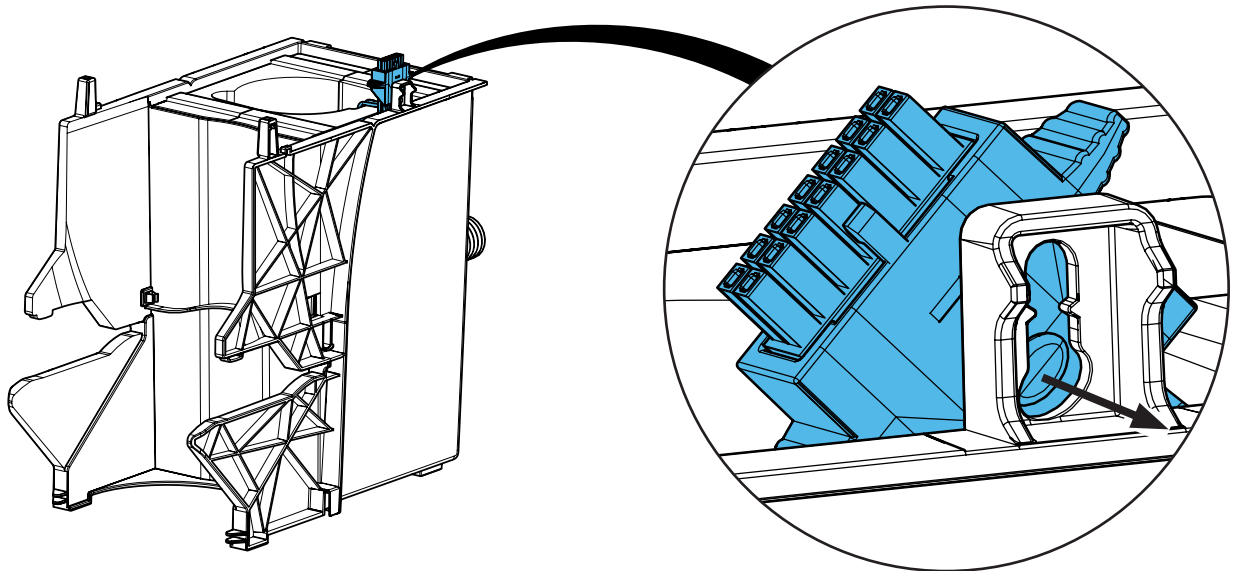

31.

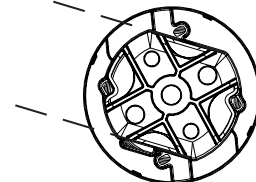
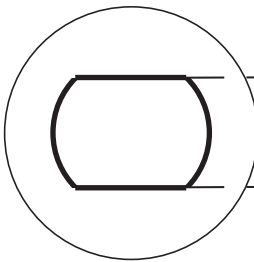
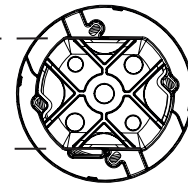
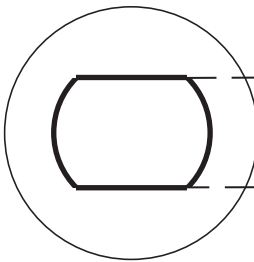
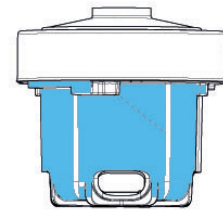
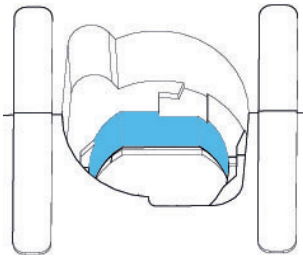
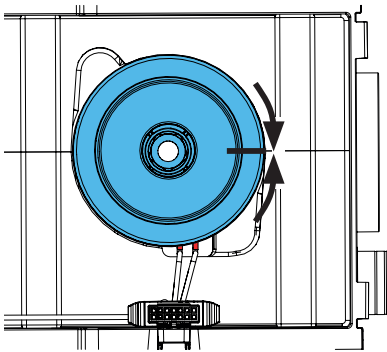
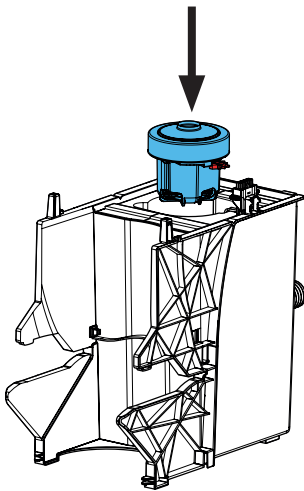
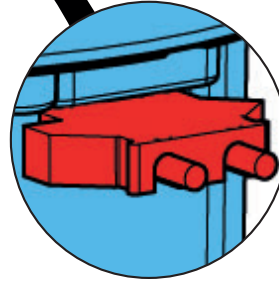
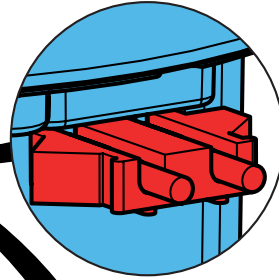
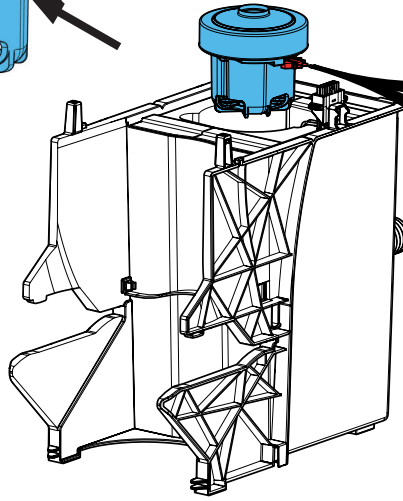
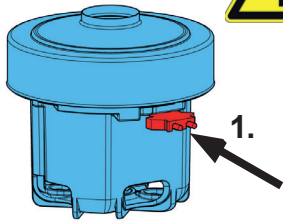

32.

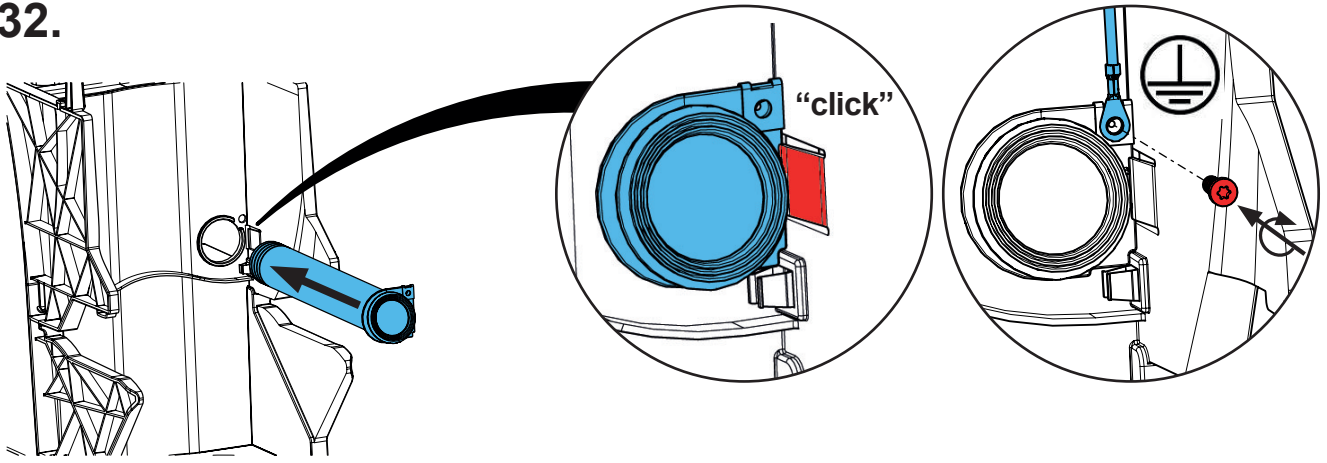

33.

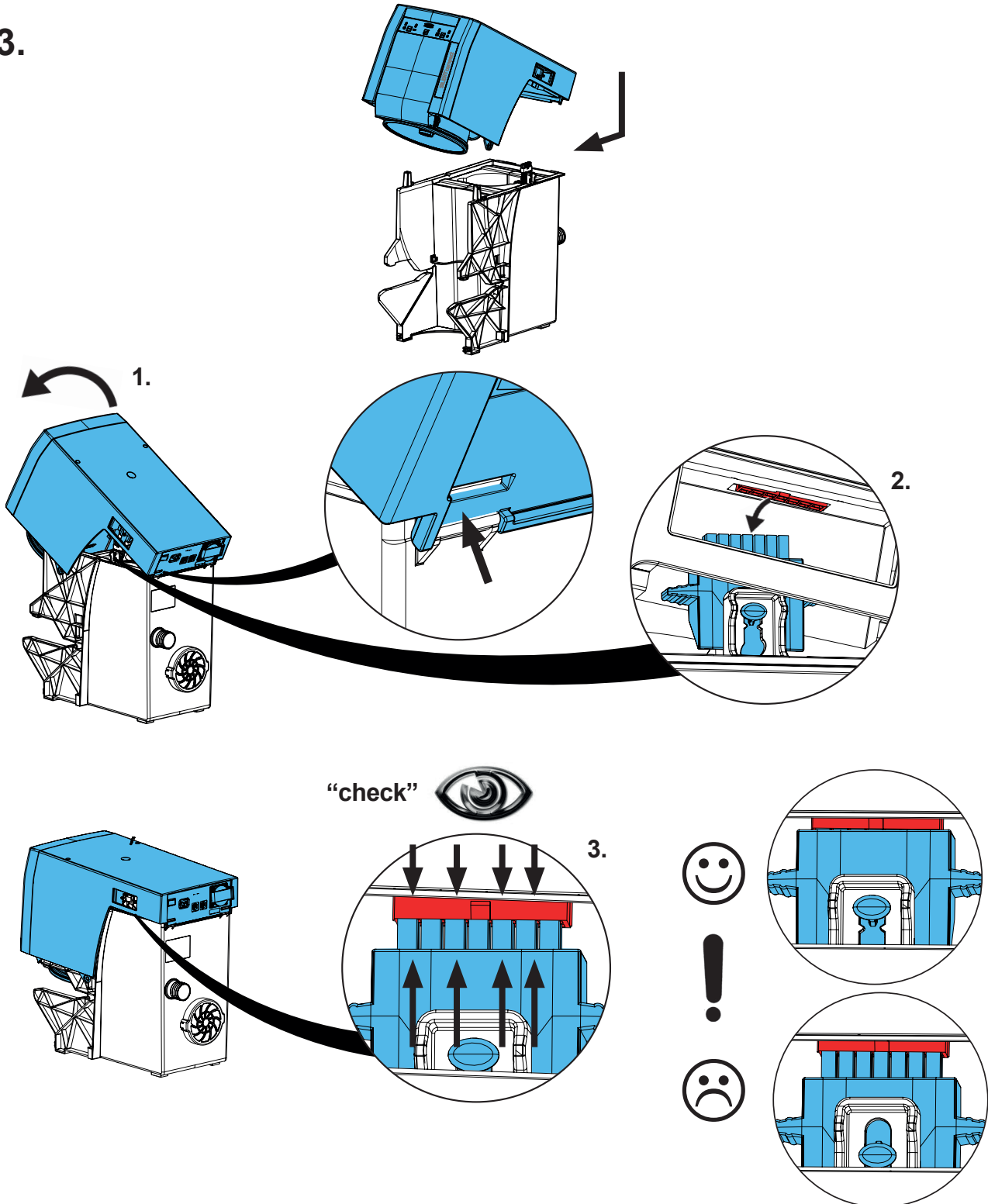

34.

0,5 - 0,6 Nm

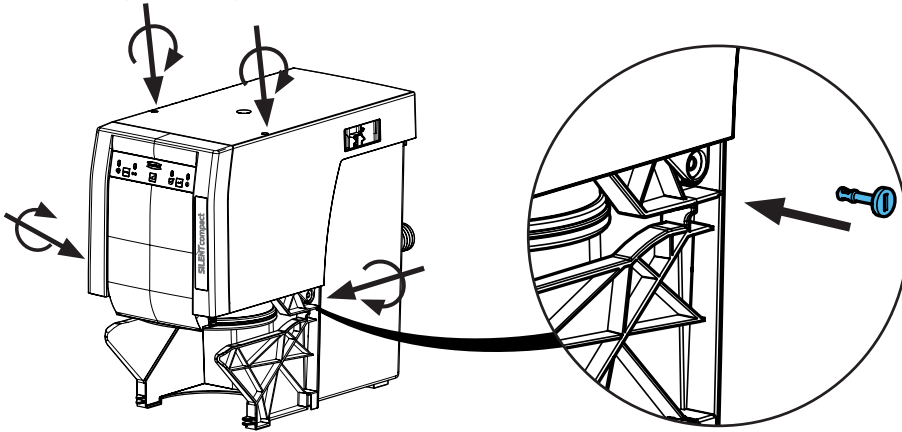

35.

i

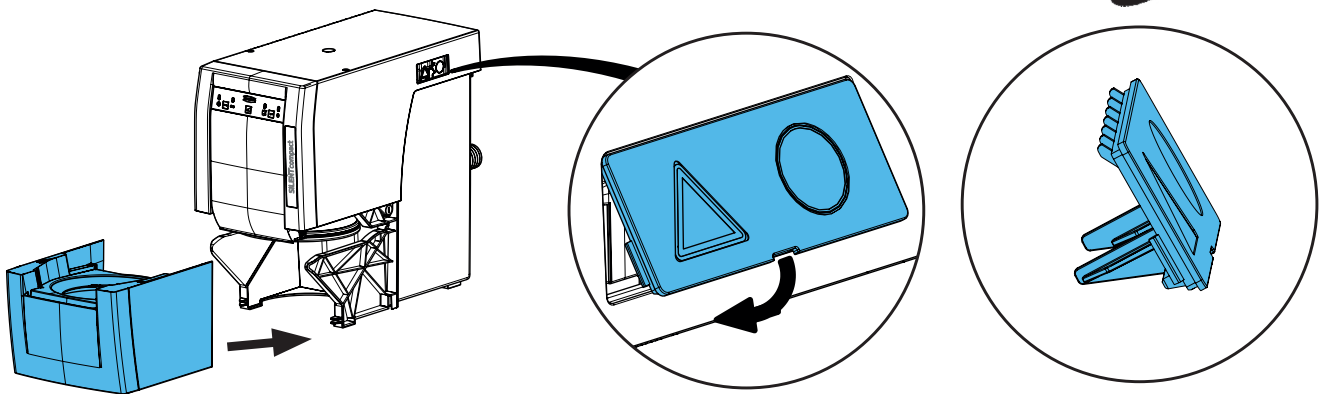

Schutzleiterprüfung durchführen: siehe am Ende der „Service Instructions“.

Performing the protective conductor test: see at the end of the “Service instructions”.

Pour vérifier le conducteur de protection: voir à la fin des “Instructions de service”.

Per la verifica del conduttore di terra: vedere alla fine delle “Istruzioni di servizio”.

Realizar la prueba del conductor de protección: véase al final de las “Instrucciones de servicio”.

Выполнить проверку защитного провода: см. в конце „Инструкции по обслуживанию“.





Montageanleitung • Assembly Instruction • Instruction d'installation
Istruzioni l'istallazione • Instrucciones de montaje • Руководство по монтажу

making work easy

90003 7234 / 90003 7462

Bedienfolie • Operating foil • Feuille de comande • Lamina di comando
Lámina de mando • Плёнка для панели управления

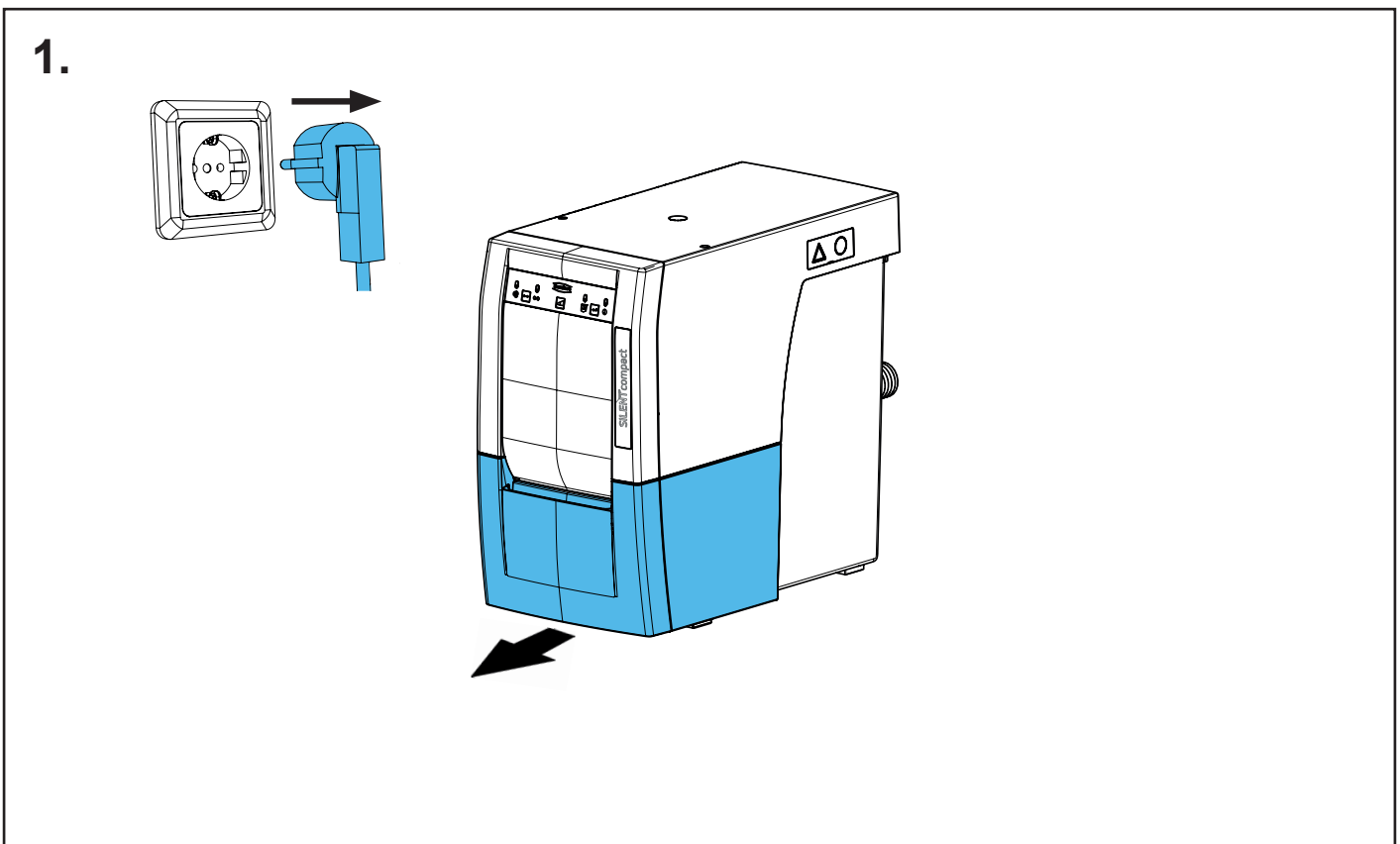
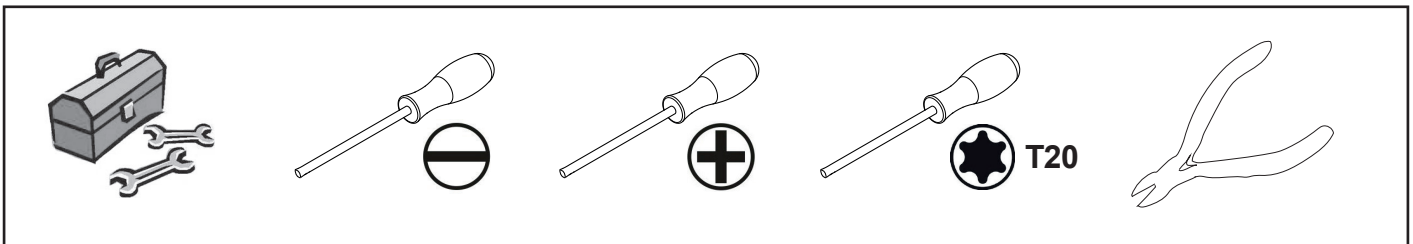
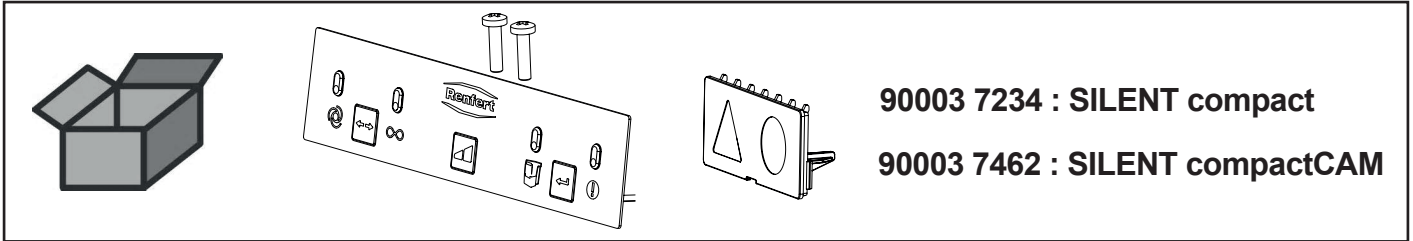

2.

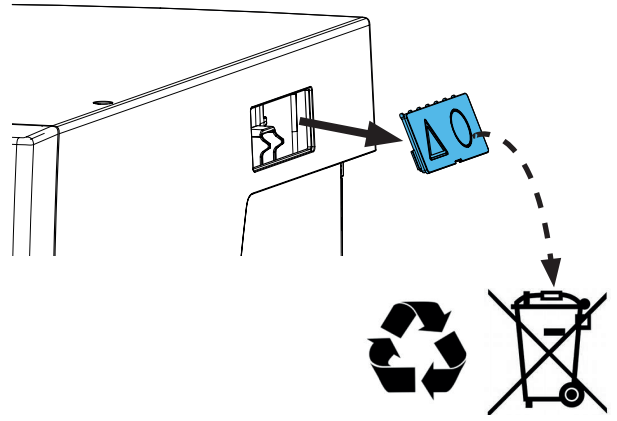
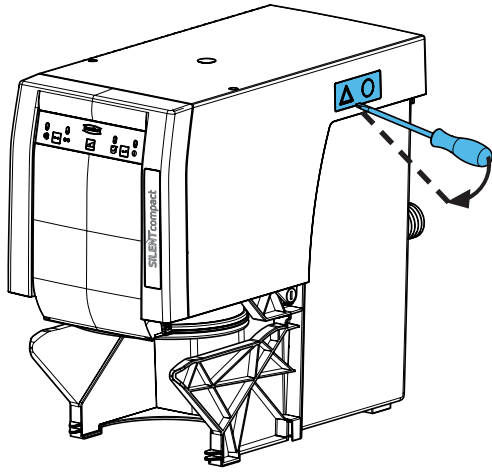

3.

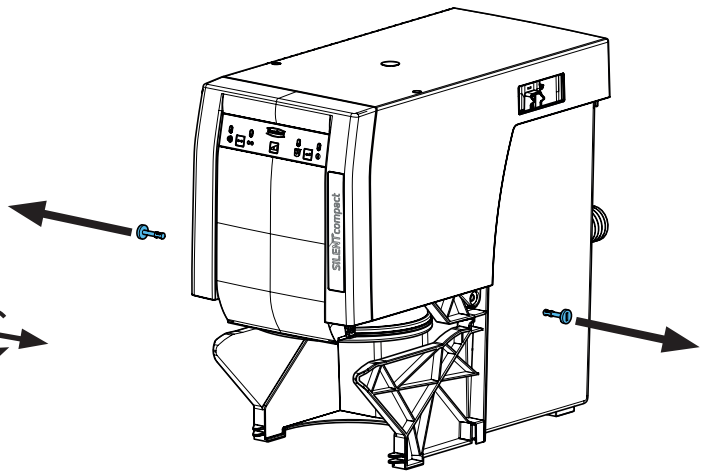
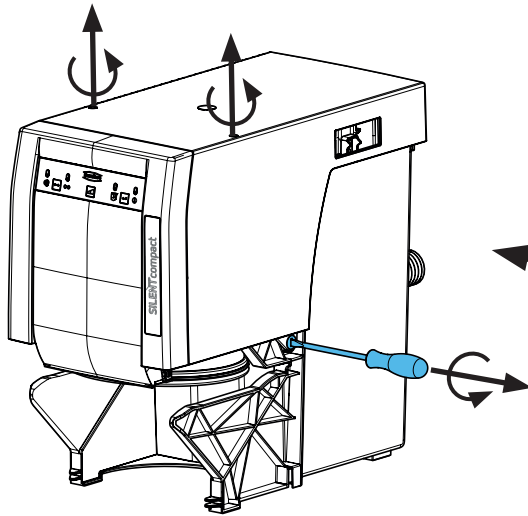

4.

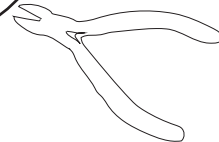
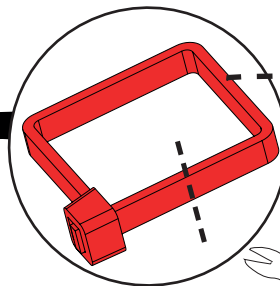
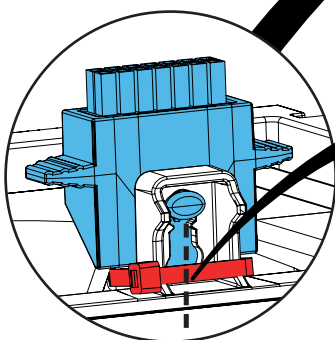
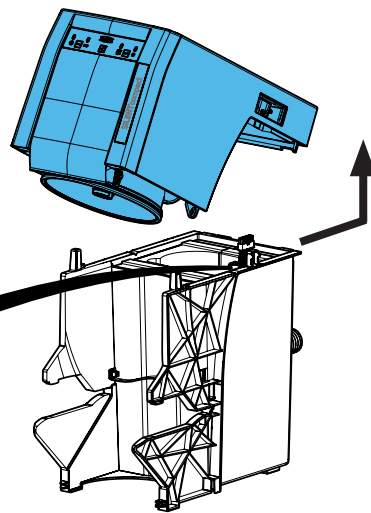
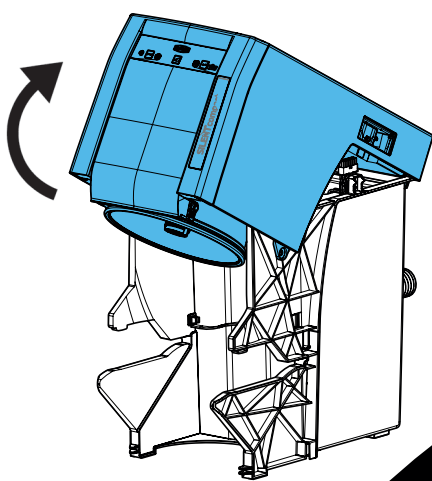

5.

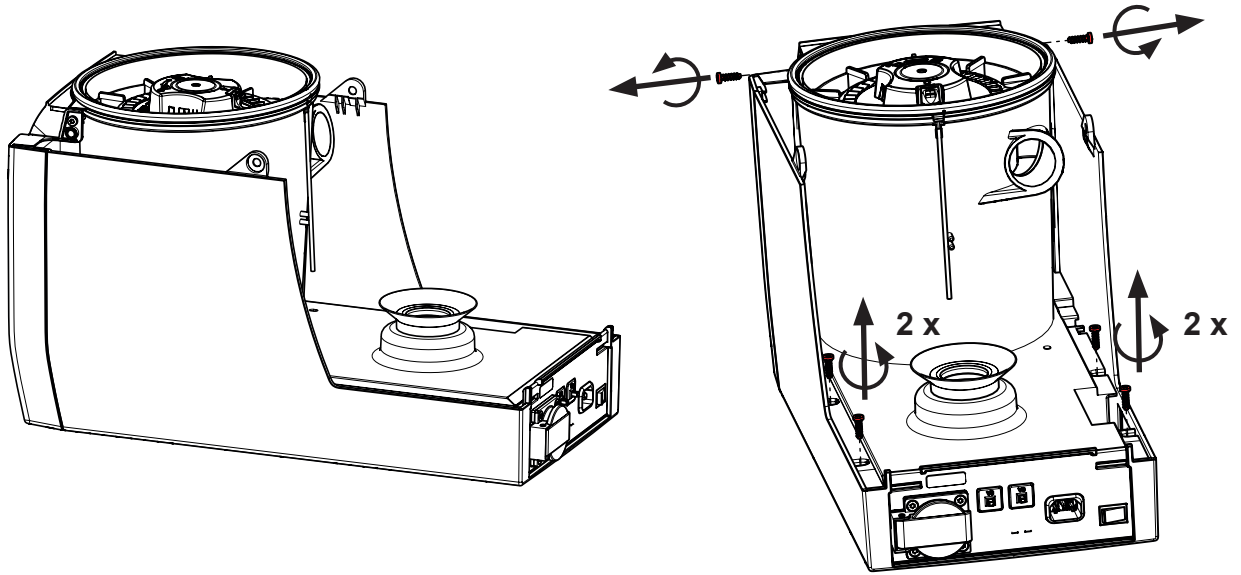

6.

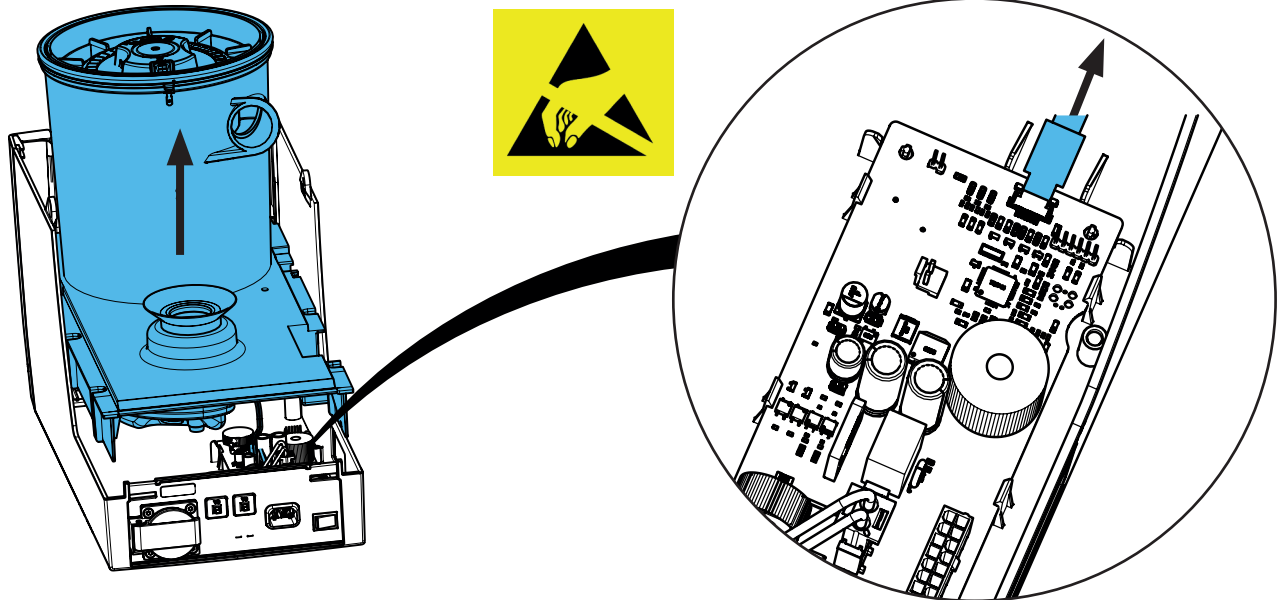

i

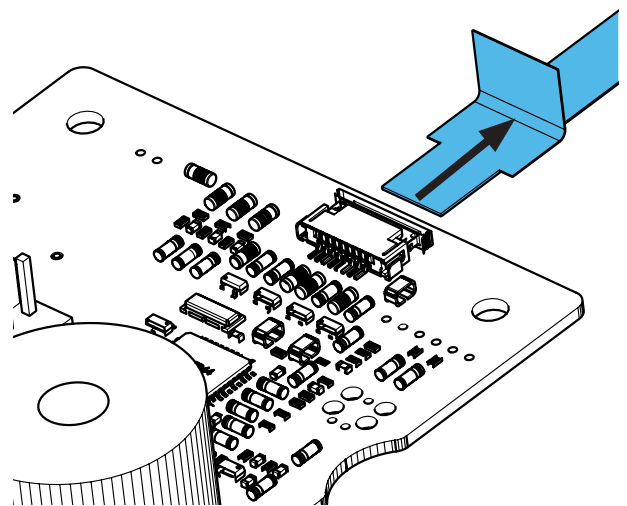
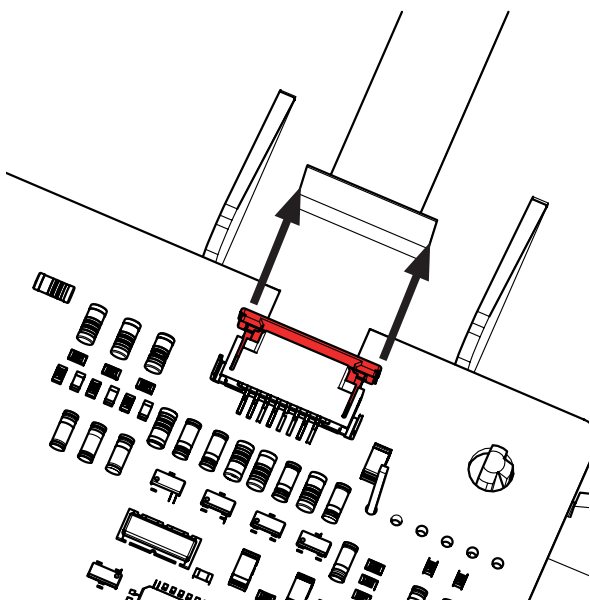

7.

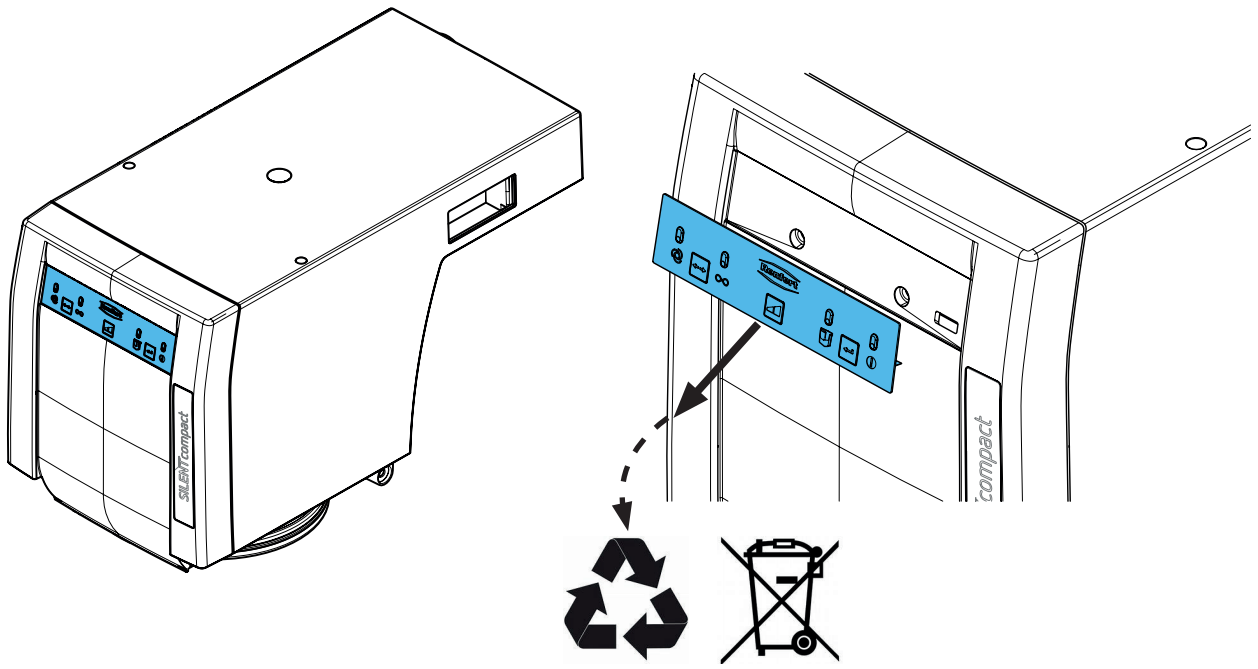

8.

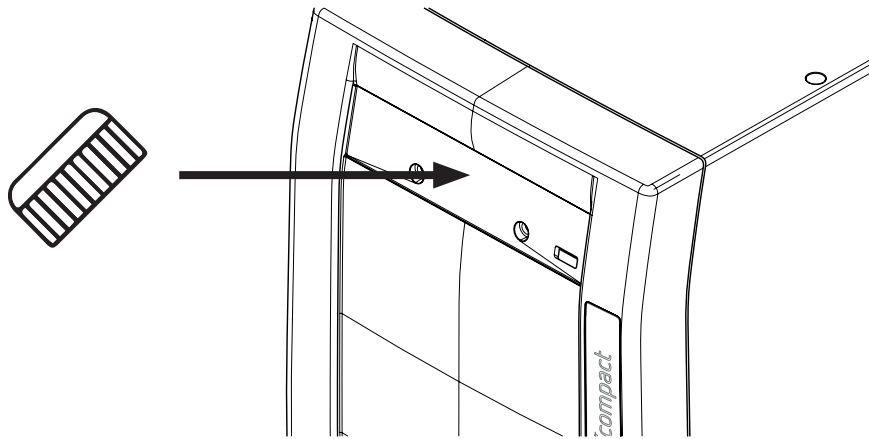

9.

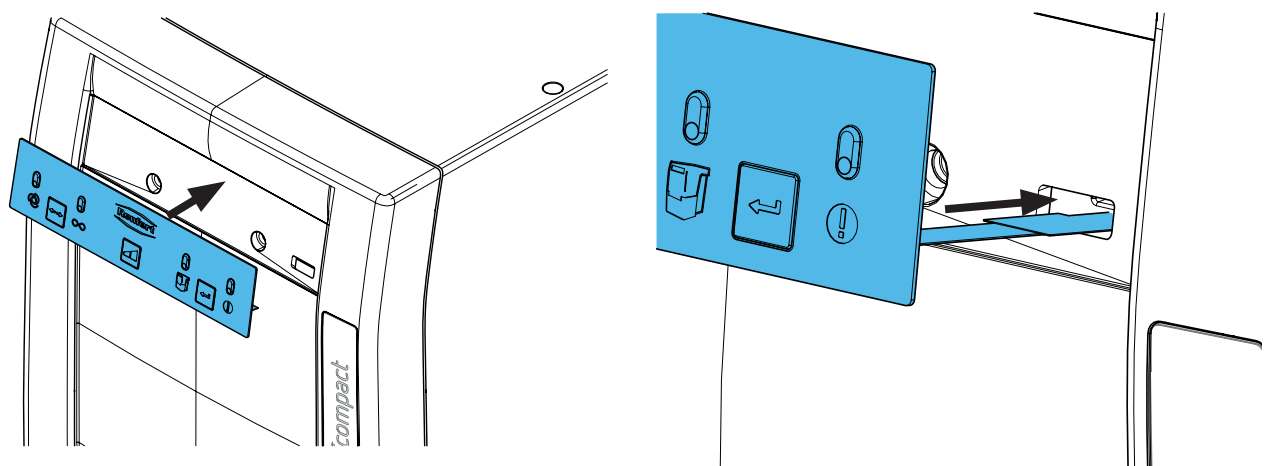

10.

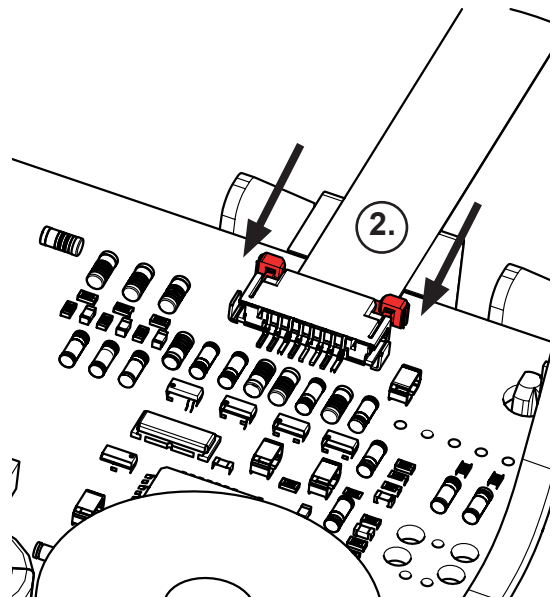
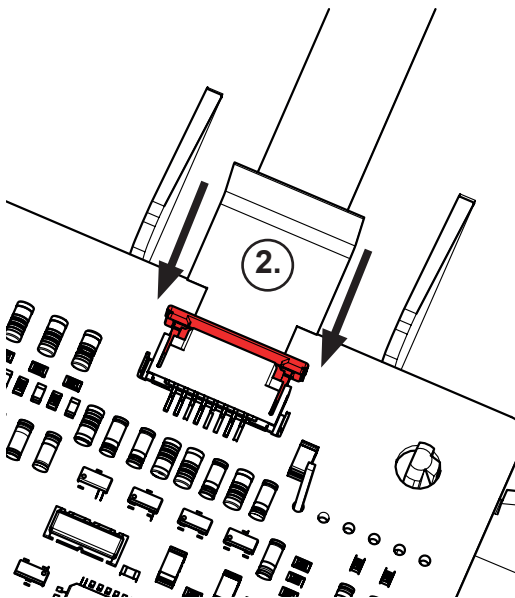
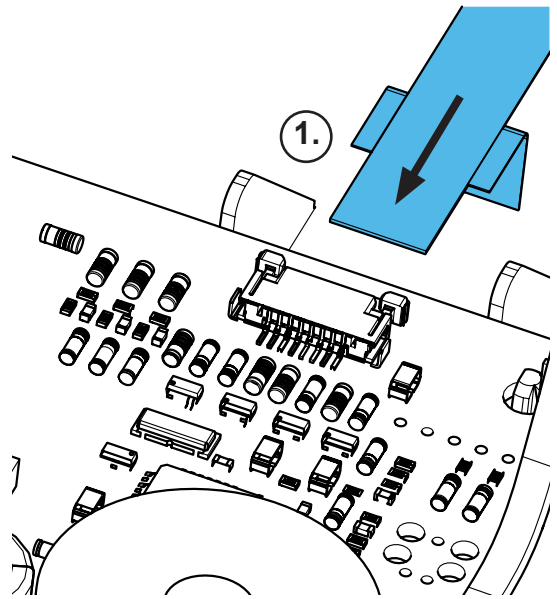
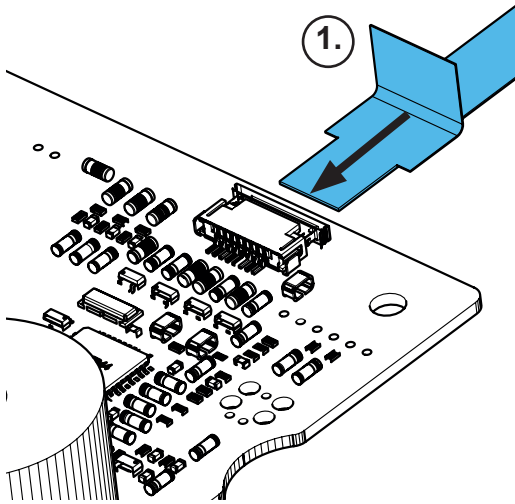
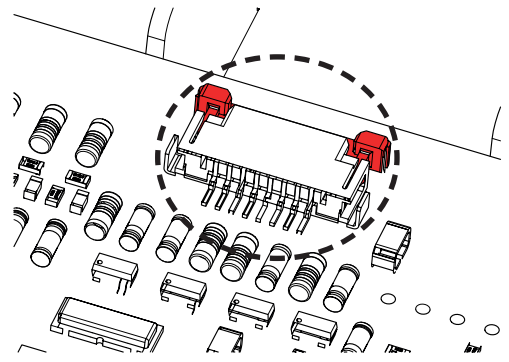
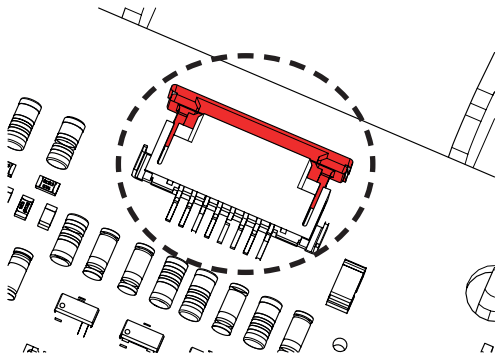

11.

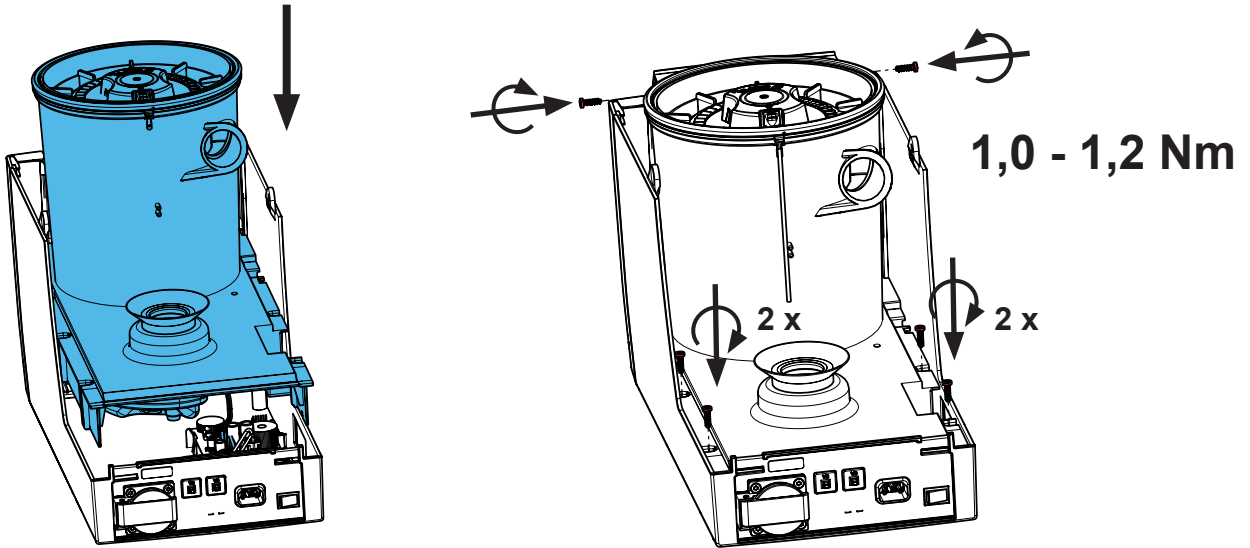

12.

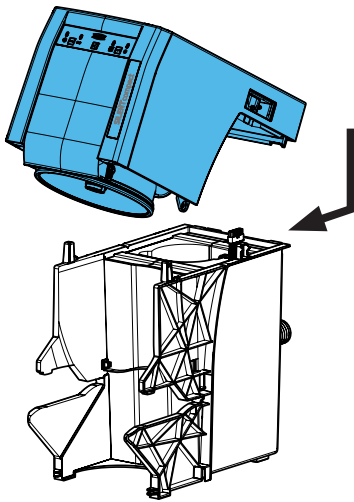

13.

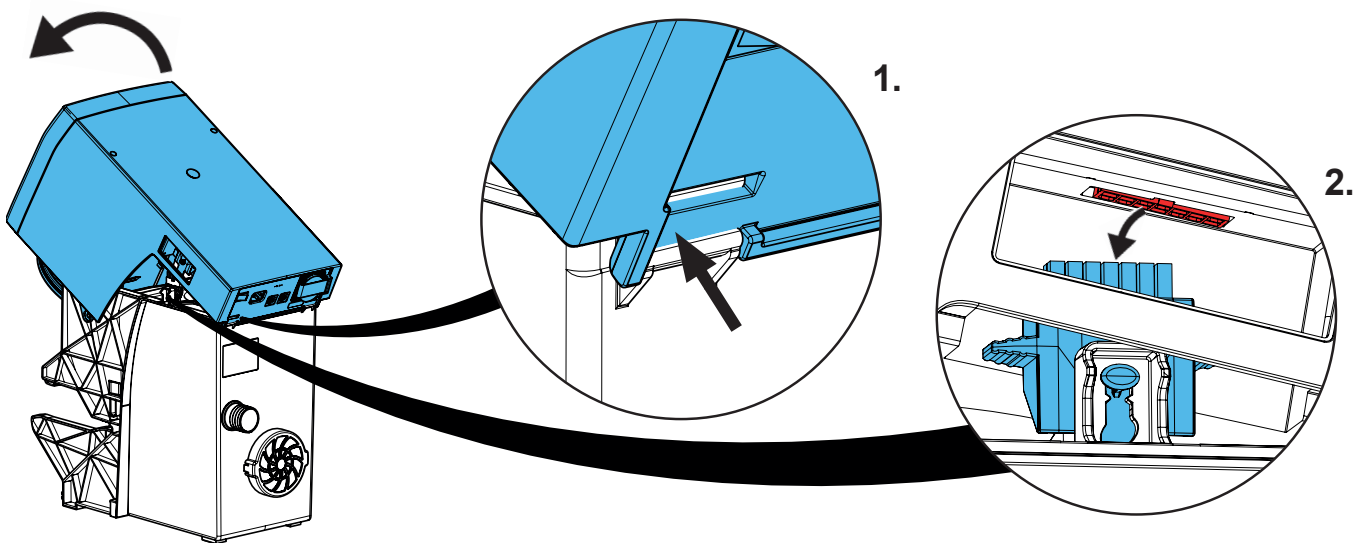

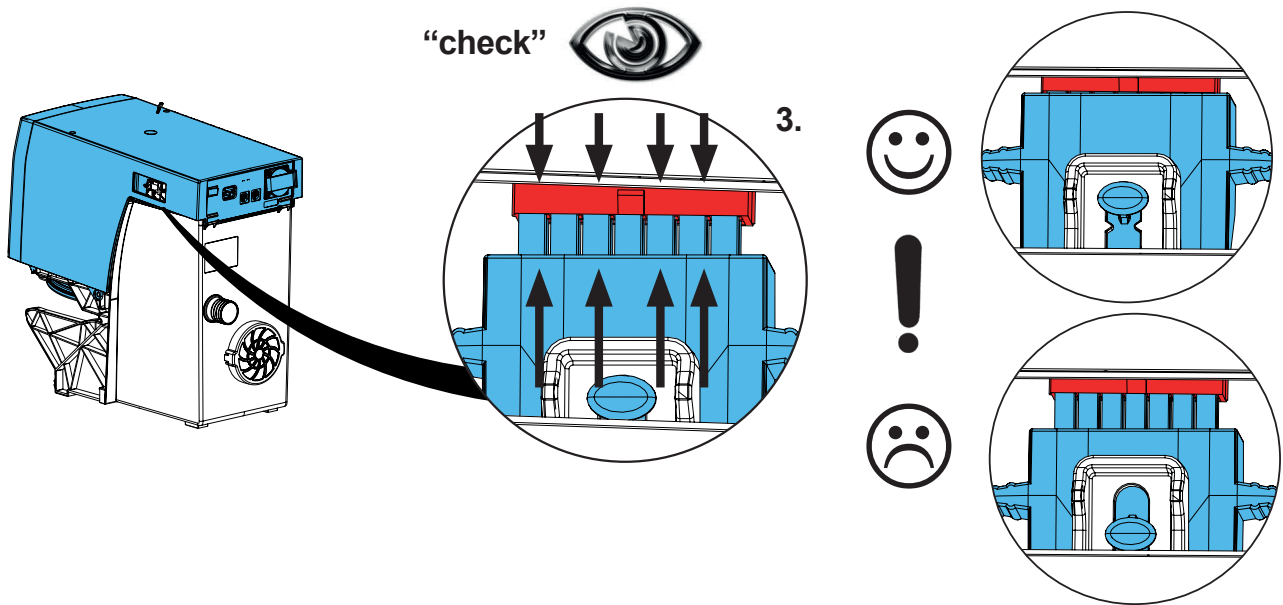

14.

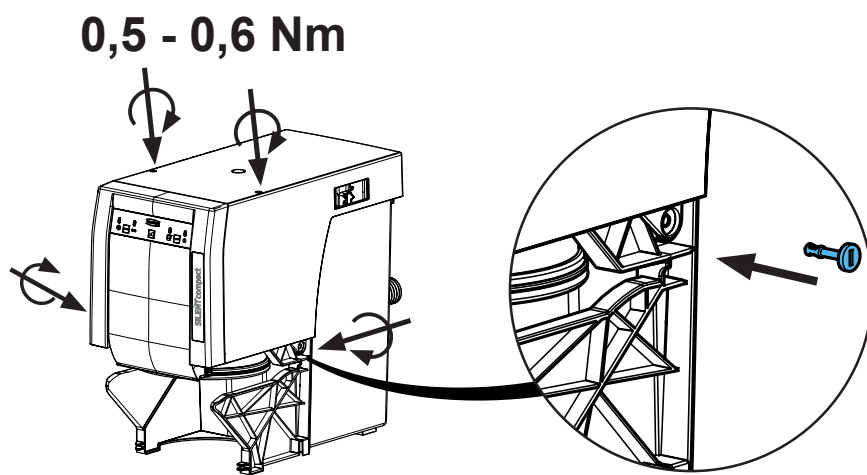

15.

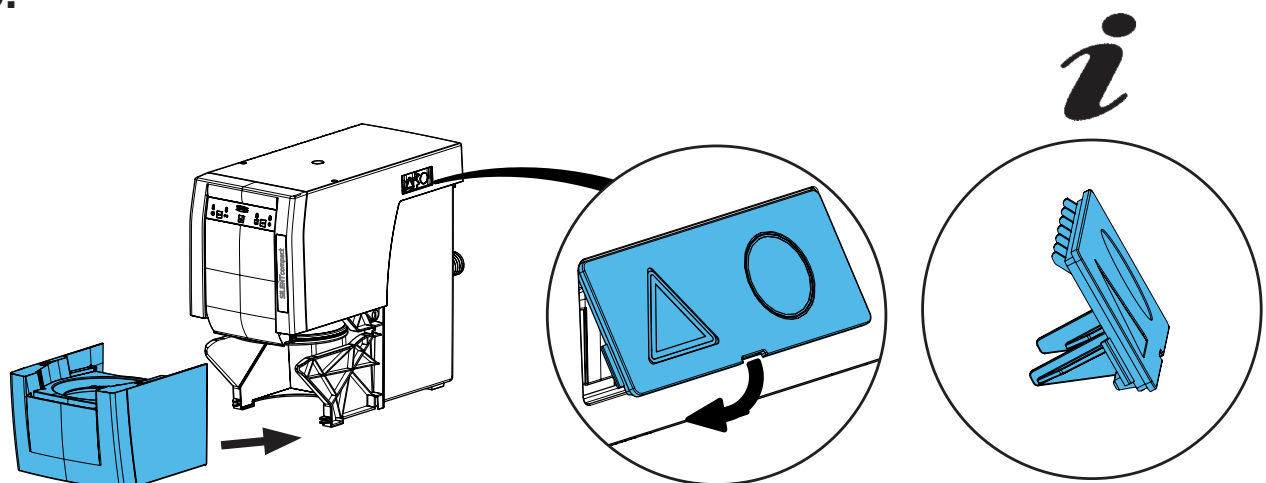



Schutzleiterprüfung durchführen: siehe am Ende der „Service Instructions“.

Performing the protective conductor test: see at the end of the “Service instructions”.

Pour vérifier le conducteur de protection: voir à la fin des “Instructions de service”.

Per la verifica del conduttore di terra: vedere alla fine delle “Istruzioni di servizio”.

Realizar la prueba del conductor de protección: véase al final de las “Instrucciones de servicio”.

Выполнить проверку защитного провода: см. в конце „Инструкции по обслуживанию“.

