

Megawise

5-IN-1 IMMERSION HAND BLENDER SET

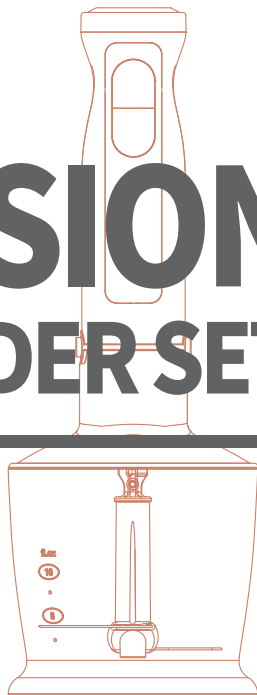

I N S P I R E B R I G H T E R L I V I N G

PARTS AND ACCESSORIES

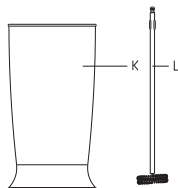
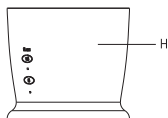
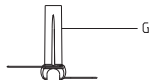
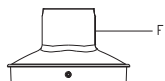
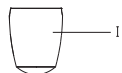
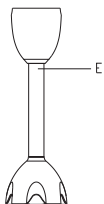
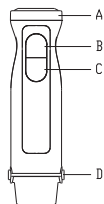

DESCRIPTION

| | |
|---|------------------------|
| A | VARIABLE SPEED CONTROL |
| B | SPEED SWITCH |
| C | TURBO SWITCH |
| D | RELEASE BUTTON |
| E | BLENDER STICK |
| F | CHOPPING BOWL LID |
| G | "S" BLADE |
| H | CHOPPING BOWL |
| I | WHISK HOLDER |
| J | WHISK |
| K | BEAKER |
| L | MILK FROTHER |

CAUTION

When using electrical appliance, basic safety precautions should always be followed to reduce the risk of fire, electric shock and/or injury to persons, including the following:

READ ALL INSTRUCTIONS.

1. Blades are very sharp. Handle carefully when removing, inserting or cleaning. Exercise the same care when removing, inserting the chopping blade for the food processor and chopper accessories. Always verify that the accessory enclosure is free of cracks or other damages.
2. Always disconnect the appliance from the supply if it is left unattended and before assembling, disassembling or cleaning.
3. This appliance shall not be used by children. Keep the appliance and its cord out of reach of children.
4. Children shall not play with the appliance.
5. Appliances can be used by persons with reduced physical, sensory or mental capabilities or lack of experience and knowledge if they have been given supervision or instruction concerning use of the appliance in a safe way and if they understand the hazards involved.
6. Do not use this appliance for anything other than its intended use.
7. Check the voltage of wall outlet correspond to the one shown on the rating plate before use.
8. Do not operate any appliance with a damaged cord or plug or after the appliance malfunctions, or is dropped or damaged in any manner. Return appliance to the nearest authorized service facility for examination, repair or electrical or mechanical adjustment.

CAUTION

9. Do not let any cord hang over the edge of the table or counter. Do not let cord contact hot surfaces, including stove top.
10. To reduce the risk of severe injury to person or damage to the blender, please keep hands and utensils out of container while blending. A scraper can't be used until blade has completely stopped.
11. To protect against electrical shock, do not put the motor body, cord or electrical plug of this hand blender in water or other liquids. Only the detachable blending shaft and other certain parts of this appliance have been designed for immersion into water or other liquids. Never submerge any other part of this unit. If hand blender falls into liquid, unplug first, then remove immediately. Do not reach into the liquid without unplugging the unit first.
12. Close supervision is necessary when your appliance is being used near children or infirm persons.
13. Ensure fingers are kept well away from moving parts.
14. Switch off the appliance and disconnect from supply before changing accessories or approaching parts that move in use.
15. When mixing liquids, especially hot liquids, use a tall container or make small quantities at a time to reduce spillage, splattering and possibility of injury from burning.
16. Neither the measuring beaker, nor the chopping bowl is microwave proof.
17. To reduce the risk of injury, never place cutting blade on base without putting bowl properly in place.
18. Be certain the food processor attachment cover is securely locked in place before operating appliance. Do not attempt to remove cover until blade has stopped rotating.

CAUTION

19. Care shall be taken when handling the sharp cutting blades, emptying the bowl and during cleaning.

20. The motor is equipped with a protective setting which will turn off automatically if overheat and will re-active after the motor cools down.

21. For repairs, accessories and power cord replacement, please contact MegaWise at

✉ support@megawise.com

💬 m.me/MegaWiseUSA

🌐 www.megawise.com

HOW TO USE THE HAND BLENDER

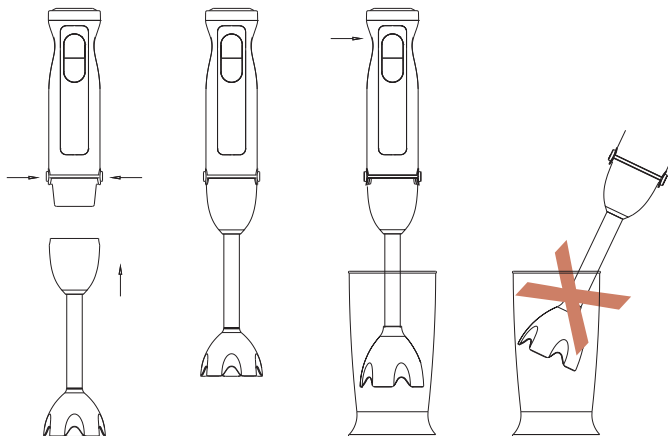

The hand blender is perfectly suited for preparing dips, sauces, soups, mayonnaise and baby food as well as for mixing and milkshakes.

1. Attach the blender stick to the motor part until it clicks.
2. Place the blender stick into the mixture to be blended. Then press the speed switch button to switch the appliance on.
3. Blend ingredients to the desired consistency using a gentle up-and-down motion. After use, unplug the hand blender and press the release button to detach the blender stick .
4. You can use the hand blender in the measuring cup and just as well in any other vessel.

Caution:

The blade is very sharp!

HOW TO USE YOUR CHOPPER

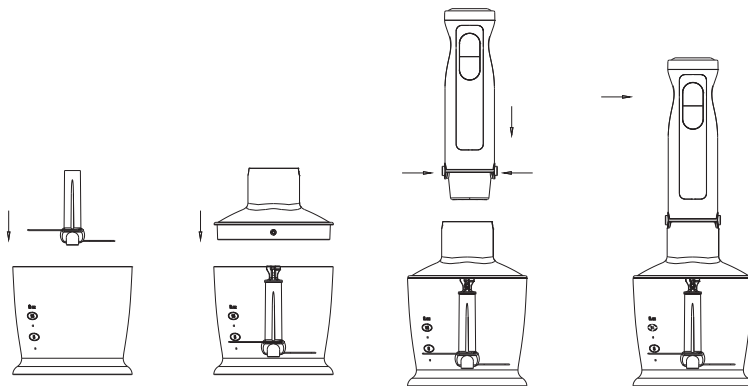

1. Carefully remove the plastic cover from the blade.
2. The blade is very sharp! Always hold it by the upper plastic part and handle it carefully.
3. Place the blade on the center pin of the chopper bowl. Press it down and lock into place.
4. Fill the chopper with food and put on the lid.
5. Align the chopper with the motor part and click together.
6. To operate the chopper, switch on the appliance. During processing, hold the motor part with one hand and the chopper bowl with the other.
7. Always chop harder foods at full speed.

HOW TO USE YOUR CHOPPER

8. When chopping is complete, unplug and press the release buttons to detach the motor part.
9. Lift the lid up. Carefully take out the blade before pouring out the contents of the bowl. To remove the blade, slightly turn it then pull it off.

Caution:

1. Chopper is perfectly suited for hard food, such as chopping meat, cheese, onion, herbs, garlic, carrots, walnuts, almonds, prunes etc.
2. Don't chop extremely hard food, such as ice cubes, nutmeg, coffee beans and grains.

HOW TO USE YOUR WHISK

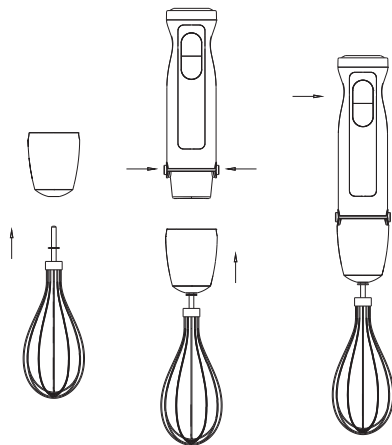

Use the whisk only for whipping cream, beating egg whites and mixing sponges and ready-mix desserts.

1. Attach the whisk to the whisk holder.
2. Align the motor part with the assembled whisk attachment and push the pieces together until they lock.
3. Press the speed switch to operate it.
4. After use, unplug and press the release buttons to detach the motor part.

HOW TO USE MILK FROTHER

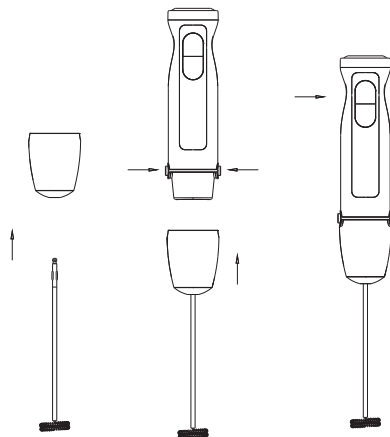

Use the milk frother only for blender milk.

1. Attach the milk frother to the whisk holder.
2. Align the motor part with the assembled attachment and push the pieces together until they lock.
3. Press the speed switch to operate it.
4. After use, unplug and press the release buttons to detach the motor part.

CLEANING

Care and Cleaning

1. Always clean the hand blender thoroughly after use.
2. Unplug hand blender before cleaning.
3. Do not immerse the motor part in water or any other liquid. Clean with a damp cloth only.
4. All other parts can be cleaned in a dishwasher. Do not use abrasive cleaners that could scratch the surface.
5. When processing foods with high pigment content (e.g. carrots), the accessories may become discolored. Wipe these parts with vegetable oil before cleaning them. Both the design specifications and these user instructions are subject to change without notice.

Processing Guide (for 500ml chopping bowl)

| Food | Maximum | Operation time |
|--------------|---------|----------------|
| meat | 250g | 15sec |
| herbs | 50g | 10sec |
| nut, almonds | 150g | 15sec |
| cheese | 100g | 10sec |
| bread | 80g | 10sec |
| onions | 200g | 10sec |
| biscuits | 150g | 10sec |
| soft fruit | 200g | 10sec |

HAND BLENDER

HE-2059 AC110-120V 50/60HZ 800W CLASS II

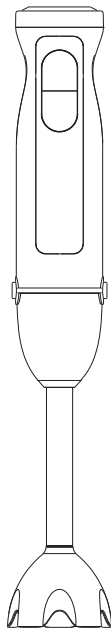

CUSTOMER SERVICE

Our customer service team is standing by to assist you
if you have any questions or concerns.



Scan the QR-code to start chatting (live chat):



Scan QR Code & Start Chatting



SCAN ME

Or visit:

m.me/MegaWiseUSA



m.me/MegaWiseUSA



support@megawise.com



megawise.com

MEGAWISE



Made in China