

## PROGRAMMING HAND HELD MIC CONT.

### 2. SETTING FREQUENCY

#### FREQUENCY DISPLAYED

Press "SET" for three seconds for the "MHZ" to show on the LCD. Press "UP" or "DOWN" to increase or decrease the frequency. Re-press "SET" again and the mic will store the frequency.

#### GROUP DISPLAYED

Press "SET" for three seconds for the Group digit to show. Then re-press "SET" and the frequency starts flashing. Press "SET" a third time until the "MHZ" show up. Press "UP" or "DOWN" to increase or decrease Group digit. Press "SET" again and the mic will store the frequency.

### 3. SETTING SENSITIVITY

#### FREQUENCY DISPLAYED

Press "SET" for three seconds for the "MHZ" to show on the LCD. Press "SET" again and the Group digit starts flashing. Press "SET" a third time and the frequency starts flashing. Press "SET" once more to display the sensitivity setting.

#### GROUP DISPLAYED

Press "SET" for three seconds for the Group digit display. Re-press "SET" and the frequency starts flashing. Press "SET" button again until "MHZ" shows. Press "SET" again until sensitivity displays. Press "UP" or "DOWN" button to increase or decrease sensitivity. There are 4 sensitivity could be adjusted : 0dB, -6dB, -12dB, -24dB

### 4. SETTING LOCK-ON

#### FREQUENCY DISPLAYED

Press "SET" for three seconds until "MHZ" shows on the LCD. Press "SET" again and the Group digit starts flashing. Press "SET" again until the frequency starts flashing. Push "SET" button again and the sensitivity displays. Hitting "SET" once more turns on the "LOCK-ON" setting. Press "UP" button for "LOCK-ON" mode and "DOWN" button for "LOCK-OFF" mode. Re-press

"SET" and the lock function will store.

#### GROUP DISPLAYED

Press "SET" for three seconds for the Group digit display. Re-press "SET" and the frequency starts flashing. Press "SET" button again until "MHZ" shows. Press "SET" again to display the sensitivity. Press "SET" until "LOCK OFF" starts flashing. Press "UP" for LOCK-ON mode and "DOWN" button for LOCK-OFF mode. Push "SET" to store the lock function.

### 5. RELIEVED LOCK-ON

Press "SET" for three seconds till "LOCK ON" displays, then press "DOWN" and "SET" at the same time to store LOCK-ON relieved.

6. Pressing any button will display "LOCK ON" during Lock On mode. This setting remains until it is disabled. Turning the unit off will not disable the Lock On mode.

### TIPS TO OBTAIN THE BEST WIRELESS RESULTS

1. Use only fresh alkaline batteries. Replace batteries with every 25 hours of use.
2. Position the receiver so that it has the fewest possible obstruction between it and the normal location of the transmitter. Line-of-sight is best.
3. The transmitter and receiver should be as close together as conveniently possible.
4. The receiver antenna should be in the open and away from any metal or cement walls. If in a rack, have the unit on top or angle antennas outward away from the metal rack.
5. Turn the transmitter off when not in use. Remove the battery if the transmitter is not used for a period of time.

### REGULATIONS AND SERVICING

This device complies with part 15 of the FCC Rules. Operation is subject to the condition that this device does not cause harmful interference. This device complies with INDUSTRY CANADA R.S.S. 210, en conformité avec IC: RSS-210/CNR210.

CAUTION! Electrical shock can result from removal of the receiver cover. Refer servicing to qualified service personnel. No user-serviceable parts inside. Do not expose to rain or moisture. The circuits inside the receiver and transmitter have been precisely adjusted for optimum performance and compliance with federal regulations. Do not attempt to open the receiver or transmitter. To do so will void the warranty, and may cause improper operation.

 This symbol is intended to alert the user to the presence of uninsulated "dangerous voltage" within the product's enclosure that may be of sufficient magnitude to constitute a risk of electric shock to persons.

### CAUTION

RISK OF ELECTRIC SHOCK  
DO NOT OPEN



 This symbol is intended to alert the user to the presence of important operating and maintenance (servicing) instructions in the literature accompanying the appliance.

### IMPORTANT! FOR YOUR PROTECTION, PLEASE READ THE FOLLOWING:

**WATER AND MOISTURE:** Appliance should not be used near water (near a bathtub, washbowl, kitchen sink, laundry tub, in a wet basement, or near a swimming pool, etc). Care should be taken so that objects do not fall and liquids are not spilled into the enclosure through openings.

**POWER SOURCES:** The appliance should be connected to a power supply only of the type described in the operating instructions or as marked on the appliance.

**GROUNDING OR POLARIZATION:** Precautions should be taken so that the grounding or polarization means of an appliance is not defeated.

**POWER CORD PROTECTION:** Power supply cords should be routed so that they are not likely to be walked on or pinched by items placed upon or against them, paying particular attention to cords at plugs, convenience receptacles, and the point where they exit from the appliance.

**SERVICING:** The user should not attempt to service the appliance beyond that described in the operating instructions. All other servicing should be referred to qualified service personnel. If your unit is equipped with a fuse receptacle, replace only with the same type fuse. Refer to replacement text on the unit for correct fuse type.

### SAFETY INSTRUCTIONS (EUROPEAN)

The conductors in the AC power cord are colored in accordance with the following code.

GREEN & YELLOW—Earth BLUE—Neutral BROWN—Live

U.K. MAIN PLUG WARNING: A molded main plug that has been cut off from the cord is unsafe. NEVER UNDER ANY CIRCUMSTANCES SHOULD YOU INSERT A DAMAGED OR CUT MAIN PLUG INTO A POWER SOCKET.

### LIMITED WARRANTY

90 days on all wireless electronic components. Does not cover cables, connectors, or broken parts caused by normal wear and tear or dropping. Shipping costs are the responsibility of the customer. CARVIN DOES NOT PAY FOR PARTS OR SERVICING OTHER THAN OUR OWN. A COPY OF THE ORIGINAL INVOICE IS REQUIRED TO VERIFY YOUR WARRANTY. Carvin assumes no responsibility for horn drivers or speakers damaged by this unit. This warranty does not cover, and no liability is assumed, for damage due to: natural disasters, accidents, abuse, loss of parts, lack of reasonable care, incorrect use, or failure to follow instructions. This warranty is in lieu of all other warranties, expressed or implied. No representative or person is authorized to represent or assume for Carvin any liability in connection with the sale or servicing of Carvin products. CARVIN SHALL NOT BE LIABLE FOR INCIDENTAL OR CONSEQUENTIAL DAMAGES.

When RETURNING merchandise to the factory, you may call for a return authorization number. Describe in writing each problem. If your unit is out of warranty, you will be charged the current FLAT RATE for parts and labor to bring your unit up to factory specifications.

### HELP SECTION

#### RF Interference

If you encounter receiving interference (from other than an operating TV station), often it can be eliminated by adjusting the receiver's antenna.

Please note that wireless frequencies are shared with other audio services. According to Federal Communications Commission regulations, "Wireless microphone operations are unprotected from interference from other licensed operations within the band. If any interference is received by any Government operation, the wireless microphone must cease operation..."



Congratulations on your purchase of the **UX1000 SERIES** Professional Wireless System.

These systems include a receiver along with a handheld mic with transmitter (**UMC1000**) or a belt-pack transmitter (**UBP1000**) depending on the model purchased. The headworn mic (**UX-HM2**), cable for instrument (**UXGT**) and lavalier mic (**UX-LP1**) are all available as additional options to the **UBP1000** belt-pack system.

The receiver features true UHF diversity reception. Two antennas feed two completely independent RF receivers on the same frequency. Automatic logic circuitry continuously compares and selects the superior signal to provide better sound quality and reduce the possibility of interference and dropouts. Both the transmitter and receiver have 960 user selectable channels, which can be grouped into four groups. The receiver can be mounted in a standard 19" rack (1U) with use of the optional UX-DR adapter.

The versatile **UBP1000** belt-pack transmitter is designed for use with condenser microphones as well as Hi-Z instrument pickups. Please note that in multiple-system applications there must be one transmitter per receiver.

**GETTING STARTED QUICKLY**

If you're like most new owners, you're probably in a hurry to plug your wireless system in and use it. Here are some brief instructions to get you going quickly. With the wireless system unplugged and the unit turned off, complete the following procedures:

- 1. CHANNEL CHECK** Check that both the transmitter and receiver are set to corresponding channel. If multiple systems are used, each system must be set to their own channel.
- 2. OUTPUT CONNECTIONS** There are two audio outputs on the back of the receiver: balanced XLR and unbalanced 1/4". Connect the appropriate cables for your system.
- 3. POWER CONNECTIONS** Connect the included AC adapter to the DC power input on the back of the receiver. Plug the adapter into a standard 120 volt 60 Hz AC power outlet.
- 4. RECEIVER POWER ON** Turn down the Volume control of the receiver as well as the mixer. Switch on the receiver only. Do not switch on the transmitter. The power indicator will light up even though the transmitter is not on.
- 5. BELT PACK SETTINGS** Connect the instrument cable or mic to the Belt-pack. Set the rear gain switch to -20 for mic or 0 for instrument use. Set the fine gain control to 12 o'clock. Reduce if distortion occurs.

For your records, record the following information.

Serial No. \_\_\_\_\_ Invoice Date \_\_\_\_\_

rev A

**6. BATTERY** Insert fresh AA alkaline batteries into the transmitter.

**7. TRANSMITTER POWER ON** Switch the transmitter mic to the "on" position.

**8. SOUND CHECK** To do a sound check, gradually raise the level while watching the AF level indicator. Increase the level until the AF level indicator peaks. This indicates that maximum level without distortion has been reached. On the belt pack adjust the AF level of the transmitter using the included screwdriver.

**RECEIVING INSPECTION—read before getting started**

**INSPECT YOUR WIRELESS SYSTEM FOR ANY DAMAGE** which may have occurred during shipping. If any damage is found, please notify the shipping company and CARVIN immediately.

**SAVE THE CARTON & ALL PACKING MATERIALS.** In the event you have to re-ship your unit, always use the original carton and packing material. This will provide the best possible protection during shipment. CARVIN and the shipping company are not liable for any damage cause by improper packing.

**SAVE YOUR INVOICE.** It will be required for warranty service if needed in the future.

**SHIPMENT SHORTAGE.** If you find items missing, they may have been shipped separately. Please allow several days for the rest of your order to arrive before inquiring.

**RECORD THE SERIAL NUMBER** on the enclosed warranty card or below on this manual for your records. Keep your portion of the card and return the portion with your name and comments to us.

**UX1000/UMC1000/UBM1000 SPECIFICATIONS:**

**RECEIVER UX1000**

|                            |  |
|----------------------------|--|
| Receiving System Stability | Diversity- PLL Synthesized<br>± 0.005%                   |
| Signal-to-noise            | >100 dB  |
| Image Rejection            | >60 dB   |
| THD                        | ≤1% @ 1kHz   |
| RF Sensitivity             | -107dBμ for 12 dB S/N AD                                 |
| Audio Output               | -12 dBμ / 800 ohm -unbalanced                            |
| Output Conn.               | Unbalanced 1/4" phone jack<br>Balanced XLR M-type        |
| Power Supply               | 12-18V DC, 500 mA, with provided AC adapter              |
| Dimensions                 | 8.307" (211 mm) W x 1.575" (40 mm) H x 5.394" (137 mm) D |
| Net Weight                 | 2.3 lbs (1.05 kgs)                                       |
| Accessories                | Rack mount adapters, AC adapter                          |
| Warranty                   | 90 days  |

**HANDHELD MIC TRANSMITTER UMC1000**

|                     |                           |
|---------------------|---------------------------|
| Polar Pattern       | Unidirectional            |
| RF Power Output     | 3 mW                      |
| Spurious Emissions  | Under federal regulations |
| Dynamic Range       | ≥100 dB                   |
| Battery             | AA 1.5v alkaline qty 2    |
| Current Consumption | 30 mA typical             |
| Battery Life        | Approx. 25 hours          |
| Dimensions          | 9.65" long, 2.10" dia.    |
| Net Wt (no battery) | 12.7 oz (360 grams)       |
| Accessory Included  | mic clip                  |
| Warranty            | 90 days                   |

**BELT PACK TRANSMITTER UBM1000**

|                     |                        |
|---------------------|------------------------|
| Spurious Rejection  | < -60 dBc              |
| Stability           | ± 0.005%               |
| Frequency Deviation | ± 48kHz                |
| Battery             | AA 1.5v alkaline qty 2 |
| S/N Ratio           | >100dB (1kHz-A)        |
| Current Consumption | 100mA typical          |
| Dimensions          | 2.56" W x 4" H x 1" D  |
| Net Wt (no battery) | 2.8 oz (78 grams)      |
| Warranty            | 90 days                |

**CARVIN**

12340 World Trade Drive, San Diego, CA 92128

## UX1000 FRONT AND REAR RECEIVER PANEL CONTROLS

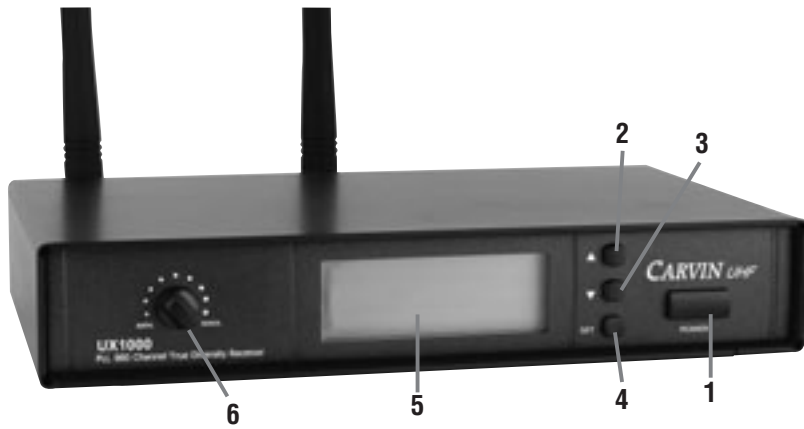

### UX1000 RECEIVER FRONT PANEL FEATURES

- 1. POWER SWITCH**  
Depress to power the receiver.
- 2. UP BUTTON**  
Depress to increase the number and set the operation mode.
- 3. DOWN BUTTON**  
Depress to decrease the number and set the operation mode.
- 4. SET BUTTON**  
Depress to set up the operation mode.
- 5. LCD PANEL**  
Clearly displays the operation mode
- 6. VOLUME CONTROL**  
Adjusts the output audio level to your amp or mixer. If distortion occurs, reduce the level.

### REAR PANEL FEATURES

- 7. DC POWER INPUT**  
Use AC power adapter, which supplies 12V DC.
- 8. UNBALANCED 1/4" AUDIO OUTPUT JACK**  
1/4" phone jack can be connected to an unbalanced input of a mixer.
- 9. BALANCED XLR AUDIO OUTPUT JACK**  
A standard XLR microphone cable can be used to connect the receiver output to a balanced input on a mixer.
- 10. ANTENNA**  
Dual antenna for Diversity signal reception.



**UX-DR DUAL RACKMOUNT ADAPTER** With the optional UX-DR adapter, you can mount one or two receivers. Remove the front panel of the mounting adapter to mount the second receiver.

## LCD PANEL DISPLAY

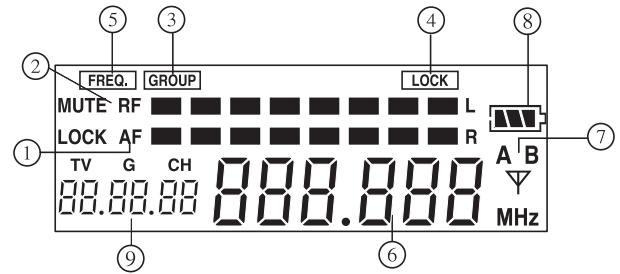

1. AF signal
2. RF signal
3. Display for GROUP mode
4. Display for LOCK mode
5. Display for set FREQ. mode
6. Frequency display
7. Diversity display (A or B receiver)
8. Battery display for the transmitter
9. Group channel display

### 1. SETTING GROUP CHANNEL

#### **[FREQ]** DISPLAYED

##### **A. GROUP NUMBER SET UP**

Press the "SET" button for three seconds until "FREQ" shows up in the LCD display. Press the "SET" button a 2nd time to display the frequency number. Press "UP" or "DOWN" to increase or decrease the group number.

##### **B. CHANNEL SET UP**

After step A, press "SET" a 3rd time to display "CH", press "UP" or "DOWN" to change the CH number. Press "SET" again and the receiver will store the channel.

#### **[GROUP]** DISPLAYED

##### **GROUP NUMBER SET UP**

Press the "SET" button for three seconds until the "G" group number shows in the LCD. Press the "SET" button a 2nd time to display the frequency number. Press "UP" or "DOWN" to increase or decrease the group number.

##### **CHANNEL SET UP**

After the group set up press "SET" a 3rd time to display "CH", press "UP" or "DOWN" to change the "CH" number. Press "SET" again and the receiver will store the channel.

### 2. SETTING FREQUENCY

#### **[FREQ]** DISPL

Press the "SET" button for three seconds until "FREQ" shows up in the LCD display. Press "UP" or "DOWN" to increase or decrease the frequency number. Press "SET" again and the receiver will store the frequency.

#### **[GROUP]** DISPLAYED

Press the "SET" button for three seconds until the "G" group number shows in the LCD. Press "SET" again and the frequency starts flashing. Press "SET" until the "FREQ" shows use the "UP" or "DOWN" buttons to change the group digit. Press "SET" again the receiver will store the channel.

### 3. SETTING LOCK-ON

#### **[FREQ]** DISPLAYED

Press "SET" button for three seconds until "FREQ" shows in the LCD. Press "SET" again and the Group number starts flashing. Press "SET" again until the frequency starts flashing then press "SET" to start the lock-on setting.

Press "UP" button for lock-on mode and "DOWN" button for lock-off mode. Re-press "SET" and the lock function will store.

#### **[GROUP]** DISPLAYED

Press "SET" button for three seconds until the Group number shows. Re-press "SET" and the frequency starts flashing. Press "SET" again till "FREQ" show up, re-press "SET" button till "LOCK OFF" starts flashing then you can proceed the lock-on setting.

(2) Press "UP" button for lock-on mode and "DOWN" button for lock-off mode. Re-press "SET" button the lock function will store.

### 4. RELIEVED LOCK-ON

Press "SET" button three seconds till "LOCK ON" show up, then press "DOWN" button plus "SET" button to store the lock-on relieved.

5. Pressing any button will display "LOCK ON" during Lock On mode. This setting remains until it is disabled. Turning the unit off will not disable the Lock On mode.

FIG. A

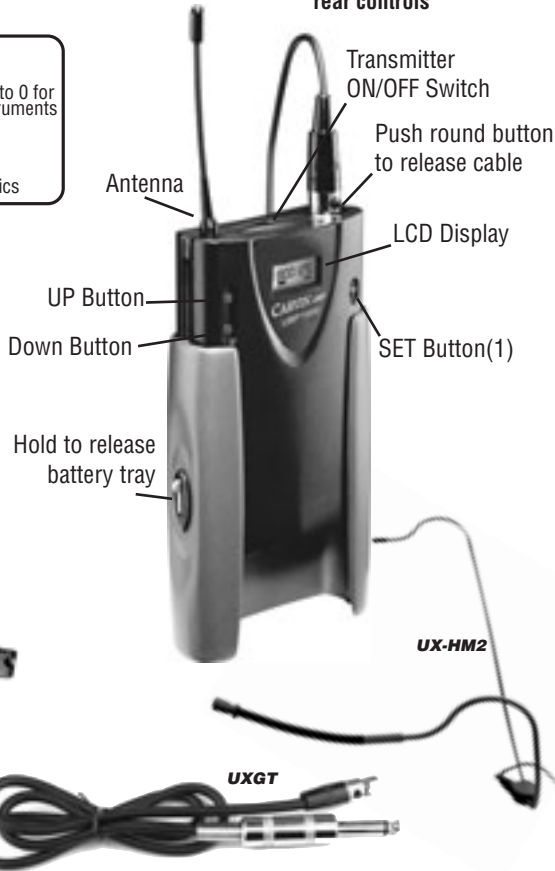
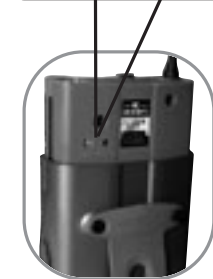
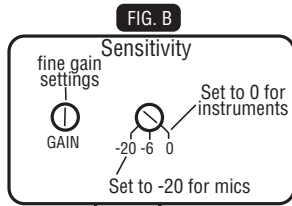
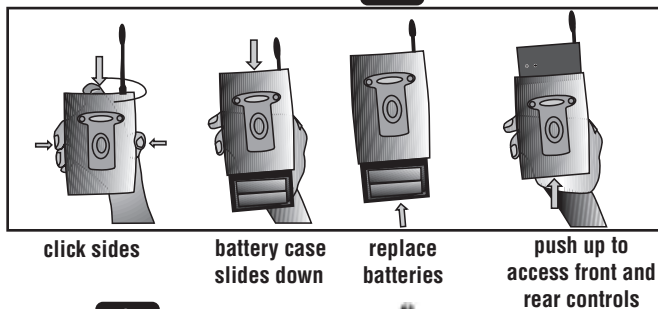

## UBP1000 BELT-PACK TRANSMITTER

### 1. BATTERY INSTALLATION FIG. A

Alkaline AA batteries are recommended. Hold on to the belt clip buttons to release battery tray. Insert fresh AA alkaline batteries. Slide the belt clip back until it locks.

### BELT PACK SET-UP FIG. A

#### 1. METAL CASE & BELT CLIP

The metal case provides extra protection for the transmitter and the plastic belt clip keeps it safe and at your side. Hold on to the belt clip buttons and slide the transmitter up to access the front and rear controls.

#### 2. SENSITIVITY FIG. B

The transmitter's sensitivity controls are located on the rear. Use the mini screwdriver to first set the Sensitivity switch to 0 for instruments or -20 for microphones. Use the mini screwdriver to make fine gain adjustments to the Sensitivity AF Gain for optimal transmitter volume. Decrease the gain if distortion is heard.

#### 3. INPUT CONNECTOR

The mini XLR input jack will connect a lavalier mic, headset mic, or instrument cable to the transmitter. Line up the notches on the side of the jack and plug. Push in until cable locks into the jack. To unplug the mini XLR cable, press the round release button on the cable to unlock it from the jack.

#### 4. TRANSMITTER ON SWITCH

Turn the receiver volume down before turning the transmitter power ON. The transmitter ON-OFF switch is located at the top of the unit.

#### 5. FREQUENCY ADJUSTING

Hold "SET" button for 3 seconds to activate frequency. Once you see "MHZ" blinking, you are ready to select your desired frequency by using "UP" and "DOWN" buttons. Press the "SET" button again to store your changes.

#### 6. TO ACTIVATE "LOCK MODE"

Hold on to "UP" button for 3 seconds to activate "LOCK MODE", press again to unlock.

### UX-HM2 HEADSET MIC

Connect the mic cable to the transmitter's mini XLR input jack. Place the mic on vocalist head with the headband resting comfortably on the rear of the neck. Keep the mic a minimum of 2 inches from the mouth. Adjust the mic position to minimize air from hitting the mic.

### UX-LP1 LAVALIERE MIC

Connect the Lavalier mic cable to the transmitter's mini XLR input jack. Clip the mic to a shirt. For optimum sound, position the mic as close to the mouth with the top of the mic facing up. Test out various positions along the center of the chest to determine the ideal mic placement. This may vary from person to person as each voice projects uniquely.

**UXGT INSTRUMENT CABLE** Connect the cable to the belt-pack transmitter's mini XLR input jack. Plug the 1/4" connector into a guitar. Turn the receiver volume down before turning the transmitter power ON.

FIG. F



FIG. D



FIG. C

unscrew the handle to replace batteries

## UMC1000 HAND HELD MIC

### 1. BATTERY INSTALLATION FIG. C

While holding the higher part of the transmitter body, unscrew the handle. Install fresh AA alkaline batteries. Replace the handle and turn clockwise until tight.

### 2. POWER ON FIG. D

Switch to POWER ON position.

### 3. MUTE SWITCH FIG. D

Used to mute audio without losing RF connection.

### 4. UMC1000-ID 7 COLOR CODED RINGS FIG. E

Use the UMC1000-ID 7 color coded rings to identify multiple microphones in use. Each color can correspond to a different wireless channel.

### PROGRAMMING HAND HELD MIC FIG. F

#### 1. SETTING GROUP CHANNEL

##### GROUP SET UP

Press "SET" button for three seconds until the "MHZ" shows and then re-press "SET" until the group digit shows. Now you can press "UP" or "DOWN" button one sec. to increase or decrease group number

##### CHANNEL SET UP

Follow the GROUP SET UP procedures, then press "SET" again and the frequency displays, press "UP" or "DOWN" to increase or decrease the frequency.

Press "SET" to store the mic frequency.

##### GROUP DISPLAYED

Press "SET" for three seconds until the Group digit shows. Then re-press "UP" or "DOWN" button to increase or decrease the group number.

Press "SET" again and the frequency displays. Press "UP" or "DOWN" to increase or decrease the frequency. Press "SET" again and the mic will store the frequency.

FIG. E UMC1000-ID color coded rings

