

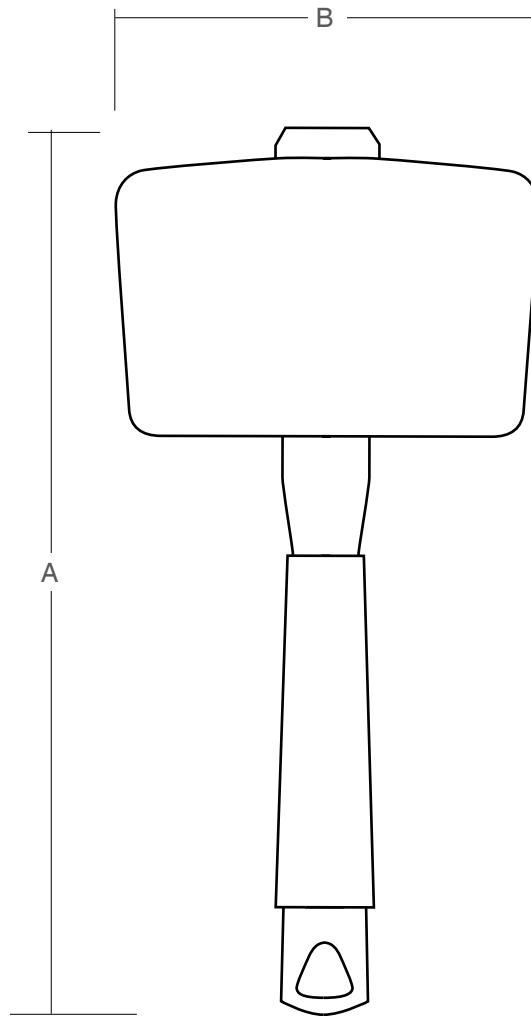

Features & Benefits

- Includes wrist lanyard
- Leather comfort grip
- Constructed of sturdy timber

[illegible]

Ananas Anatomy

Washing & Caring

1

- A. Hammer
- B. Leather Grip
- C. Cord Lanyard

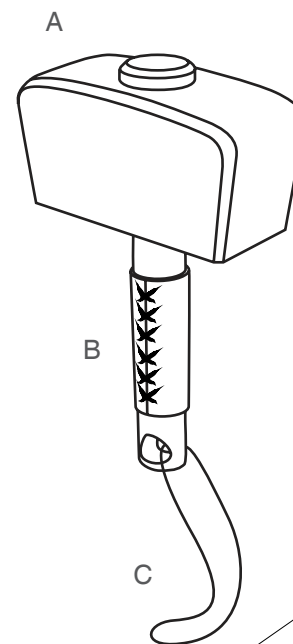

2

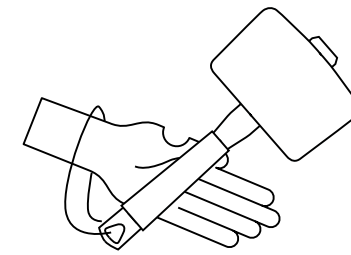

1.Place hand through
Lanyard cord and place
hand on grip to hold hammer

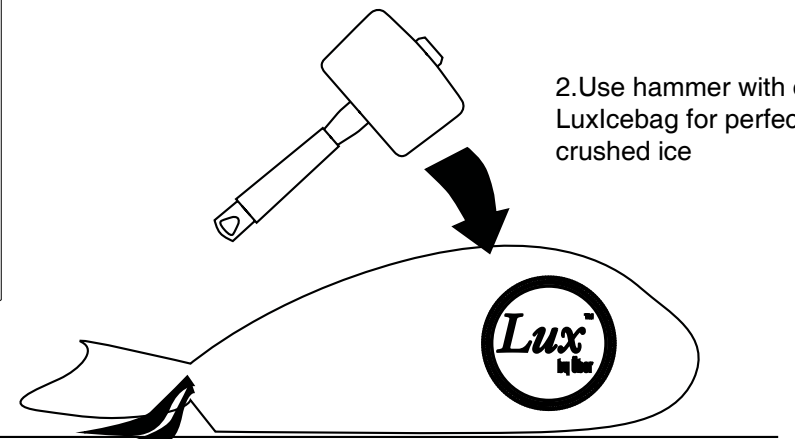

Caution: Do not use on/near breakable surfaces. Take extra care when using, Überbartools™ takes no responsibility for personal injury and/or property damages as a result of improper use.

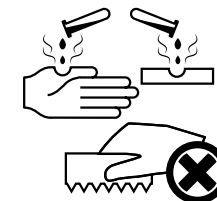

Never clean
with abrasive
materials or
corrosive
chemicals



Hand wash ONLY
soapy water



Clean with warm/
soapy water
Dry the tools
completely
after each use