

über bar TOOLS™
Innovation in your hands.

Tool Catalogue for Bar Professionals

2022 - 23



Call Us : +61 (0) 2 9417 6977
Email: sales@uberbartools.com.au
Address: Unit 12U, 175 Gibbes St,
Chatswood NSW 2067
Copyright © Überbartools™ 2022.

Über bar TOOLS™

Innovation in your hands.

It's probably worth starting by explaining our name, Über, is a German word. It made the jump into the English language capturing the concept of being "beyond expectation" and the "best of the best" in one neat package.

From a brand perspective – it's much more than a word. Über is our intent in everything we do and it's evident in the product we supply and the way we do business.

We're also rather fond of the little dots that garnish the u as well. Ü

All Über products share the same key characteristics. They all begin with a real-life problem and deliver an innovative solution that solves it. All are crafted from quality inputs and finished to exacting standards that come to life in feel, function, and use. We set out to deliver the best tool for the job, and we believe that from the first touch, and through sustained use, you will agree with us.

Hospitality is an industry that we at Über are fond of. Delivering great food and drink is an act that changes people on a molecular level. Folks who work in the industry are a special breed, driven by love of delivering an experience through both product and service that is the best they can fashion. We are happy to be the brand in their hands as they do this.

Über bar tools are designed to make the perfect drink. The quality of the design solution and finish on the products allows a bartender the best control in producing a drink that is memorable, balanced and profitably made to the last drop. The perfect drink is both memorable and remarkable; the exact attributes that drive word of mouth recommendation for a venue and brings footsteps to your door. The drink is also profitable, we like great bars to stay open and stay serving drinks. Über bar tools drives profitability and delivery return on investment early.

We're committed to long term partnerships. We'll work with our clients to deliver custom solutions from a product, branding or distribution perspective. We stand by the quality of what we provide, now and for its lifetime. This spirit of partnership is reflected in the relationship between Michael and Sam, the founding partnership that delivers Über to the world.

The great thing about having an Über intention as a brand; it's never achieved, we're constantly searching for new solutions to bring to our customers. Our innovations will always look beyond the expectations of what is available to deliver what is possible. Think of it as a dream turned into reality.

*Michael
Silvers*

CEO, Über Bar Tools



über bar tools



Innovation in your hands.



CONTENTS

- 7 Pouring
- 9 Pouring Accessories
- 11 Measuring
- 14 Pour Testing
- 17 Straining
- 21 Shaking
- 25 Stirring
- 31 Swizzle Sticks
- 35 Muddling
- 37 Bottle Opening
- 39 Ice Tools
- 43 Ritual Vessels
- 45 Bitter Bottles
- 47 Accessories
- 53 Cocktail Sets
- 59 Bartender Kits
- 63 Cocktail Chimney
- 65 Cocktail Chimney Wood Chips

NEW
ARRIVAL



Cocktail Chimney

Introducing the Uber Bar Tools™ Cocktail Chimney. Ultimate cocktail and dessert smoker, taking entertaining to the next level.

INTRODUCTION

New Era of Bartending.

Innovation without compromise on quality. The finish on our tools is second to none and with appropriate care they'll outlast any of our competitors' generic products. Should you own a bar, then experience how quality tools with inspired design is not a cost but a worthy investment in long life outcomes.

With excellence as our banner, we can proudly stand by "We're Out There" in the bars, pubs, hotels and restaurants supporting the people of hospitality.

Our passion and inspiration comes from the innovation seen behind bars around the globe.

For ordering information, pricing and additional products, please visit our website at www.uberbartools.com
To sign up for our mailing list, contact sales@uberbartools.com
Copyright © Überbartools™ 2020.



Pouring

Gain Pouring Precision through Flow Control.

Über's patented pour designs provide greater liquid flow control to ensuring increased drinks consistency, accuracy and flavour balance.



BarFlow™

Fast fits Flawless



NAME	ITEM NUMBER	CDU QTY	INNER CARTON	OUTER CARTON
A BARFLOW™	46/BF006	12	48	288
B BARFLOW™ + SNAP ON	46/BFSM	12	48	288

	SIZE	MATERIAL	WEIGHT
BARFLOW™	95 X 33 X 33 mm	ABS	10 gm
BARFLOW™ + SNAP ON	95 X 33 X 33 mm	ABS	22 gm

3 SECOND POUR FLOW

BarFlow™

Fast fits Flawless



NAME	ITEM NUMBER	CDU QTY	INNER CARTON	OUTER CARTON
C BARFLOW™ FASHION ENERGY (ORANGE)	46/BFF-900	12	48	288
D BARFLOW™ FASHION VITALITY (PURPLE)	46/BFF-901	12	48	288
E BARFLOW™ FASHION LIFE FORCE (BLUE)	46/BFF-902	12	48	288

	SIZE	MATERIAL	WEIGHT
BARFLOW™	95 X 33 X 33 mm	ABS	10 gm

3 SECOND POUR FLOW

BarFlow™

Fast fits Flawless



NAME	ITEM NUMBER	CDU QTY	INNER CARTON	OUTER CARTON
F BARFLOW™ FASHION ENERGY + SNAP ON	46/BFFSM-900	12	48	
G BARFLOW™ FASHION VITALITY + SNAP ON	46/BFFSM-901	12	48	
H BARFLOW™ FASHION LIFE FORCE + SNAP	46/BFFSM-902	12	48	

	SIZE	MATERIAL	WEIGHT
BARFLOW™ + SNAP ON	95 X 33 X 33 mm	ABS	10 gm

3 SECOND POUR FLOW

ProFlow™

Perfect pour Everytime



NAME	ITEM NUMBER	CDU QTY	INNER CARTON	OUTER CARTON
I PROFLOW™ BLACK	46/PF006	12	12	48
J PROFLOW™ CHROME	46/PF001	12	12	48
K PROFLOW™ GOLD	46/PF003	12	12	48
L PROFLOW™ COPPER	46/PF005	12	12	48
M PROFLOW™ BLUE	46/PF018	12	12	48
N PROFLOW™ RED	46/PF017	12	12	48

	SIZE	MATERIAL	WEIGHT
PRO FLOW™	95 X 33 X 33 mm	ABS	16 gm

4 SECOND POUR FLOW

THE INNOVATION



REPLACEABLE BREATHER TUBE



MODULAR PARTS

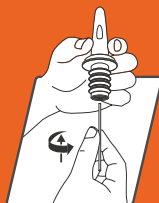
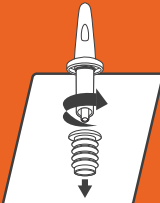

REPLACEABLE BREATHER TUBE

A close-up photograph of a bartender with a beard and a dark shirt pouring a liquid from a clear plastic pitcher into a large, rounded glass filled with ice cubes. The background is softly blurred, showing the bartender's face and hands. A white, teardrop-shaped graphic overlay is positioned in the lower-left quadrant, containing the text 'Pouring ACCESSORIES'.

Pouring

ACCESSORIES



ProFlow™

Perfect pour Everytime



4 SECOND POUR FLOW

NAME	ITEM NUMBER	CDU QTY	INNER CARTON	OUTER CARTON
A PROFLOW™ + SNAP-ON BLACK	46/PF006/002	NA	24	288
B PROFLOW™ + SNAP-ON CHROME	46/PF001/002	NA	24	288
C PROFLOW™ + SNAP-ON GOLD	46/PF003/002	NA	24	288
D PROFLOW™ + SNAP-ON COPPER	46/PF005/002	NA	24	288
E PROFLOW™ + SNAP-ON BLUE	46/PF018/002	NA	24	288
F PROFLOW™ + SNAP-ON RED	46/PF017/002	NA	24	288

PROFLOW™ + SNAP ON	SIZE	MATERIAL	WEIGHT
	102 X 33 X 33 mm	ABS	28 gm

ProFlow™

Perfect pour Everytime

Protectors



NAME	ITEM NUMBER	CHIP PACK QTY	INNER CARTON	OUTER CARTON
G DUST COVER	46/PFDC-BK	12	24	288
H SNAP-ON PROTECTOR	46/PF002-30C	6	24	288
I NMI SNAP-ON MEASURE	46/PF002-30	6	24	288

	SIZE	MATERIAL	WEIGHT
DUST COVER	7.7 x 36 x 36 mm	TPE	2.5 gm
SNAP-ON PROTECTOR	63 X 33 X 33 mm	TPE	12 gm
NMI SNAP-ON MEASURE	63 X 33 X 33 mm	TPE	12 gm



ProFlow™

Perfect pour Everytime

Screw On Collar/Corks

- 1 Designed to fit most standard bottle sizes similar to Southern Comfort™ 750 mL, Grand Marnier™ 350 mL & Johnnie Walker Black™ 700 mL
- 2 Designed to fit most larger bottle sizes similar to Absolute Vodka™ 1 L, Havana Club™ 1 L & Beefeater Gin™ 1 L
- 3 Designed to fit slightly larger bottle sizes similar to Don Julio™ 750 mL, Pyrat Rum™ 750 mL & Glennfiddich™ 750 mL
- 4 Designed to fit oversized bottles similar to Partida Tequila™ 750 mL.

NAME	ITEM NUMBER	PACK QTY	INNER CARTON	OUTER CARTON
J UNIVERSAL CORK	46/UVC	4	48	288
K LARGE CORK	46/LC	4	48	288
L XL CORK	46/XL-CORK	4	48	288
M EXTREME CORK	46/EXC	4	48	288

	SIZE	MATERIAL	WEIGHT
UNIVERSAL CORK	37 x 32 x 32 mm	TPE	10 gm
LARGE CORK	37 x 32 x 32 mm	TPE	7 gm
XL CORK	41 x 32 x 32 mm	TPE	7 gm
EXTREME CORK	31 x 38 x 38 mm	TPE	7 gm

*PROFLOW™ FEATURE ONLY

##BARFLOW™ FEATURE ONLY

#PROFLOW™ FEATURES A 2 YEAR WARRANTY AGAINST BREAKAGE AND RUST. SEE TERMS & CONDITIONS AT WWW.UBERBARTOOLS.COM

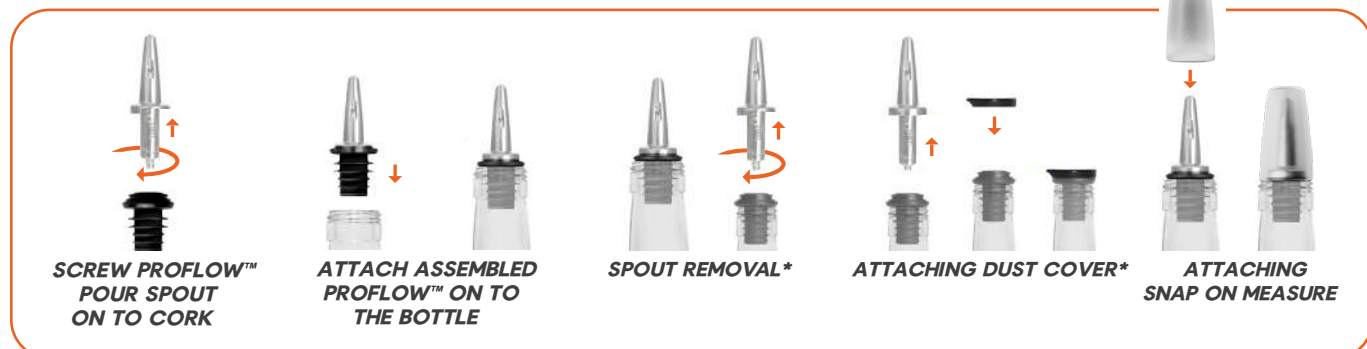

A close-up photograph of a bartender's hands pouring a golden liquid from a jigger into a tall, clear glass shaker. The scene is lit with warm, low-key lighting, creating a moody atmosphere. In the foreground, a white, teardrop-shaped graphic contains text. To the right, a small glass bottle is visible on the bar counter.

Measuring

Taste, flavour and balance are the key elements when making a successful cocktail, never spilling, over-pouring or wasting a drop are equally as important.

ProMegJig™

Metal, Easy, Grip

Regular
15/30 mL - 0.33/1 Oz volume



NAME	ITEM NUMBER	INDV QTY	INNER CARTON	OUTER CARTON
A PROMEGJIG™ REGULAR PLAT BLK	46/PROMEGJIG-RPB-UNI	1	12	48
B PROMEGJIG™ REGULAR CHROME	46/PROMEGJIG-R-UNI	1	12	48
C PROMEGJIG™ REGULAR GOLD	46/PROMEGJIG-RG-UNI	1	12	48
D PROMEGJIG™ REGULAR COPPER	46/PROMEGJIG-RC-UNI	1	12	48

SIZE	MATERIAL	WEIGHT
67 X 55 X 55 mm	STAINLESS STEEL	69 gm

ProMegJig™

Metal, Easy, Grip

Medium
30/45 mL - 0.5/1.5 Oz volume



NAME	ITEM NUMBER	INDV QTY	INNER CARTON	OUTER CARTON
E PROMEGJIG™ MEDIUM PLAT BLK	46/PROMEGJIG-MPB-UNI	1	12	48
F PROMEGJIG™ MEDIUM CHROME	46/PROMEGJIG-M-UNI	1	12	48
G PROMEGJIG™ MEDIUM GOLD	46/PROMEGJIG-MG-UNI	1	12	48
H PROMEGJIG™ MEDIUM COPPER	46/PROMEGJIG-MC-UNI	1	12	48

SIZE	MATERIAL	WEIGHT
90 X 55 X 55 mm	STAINLESS STEEL	76 gm

ProMegJig™

Metal, Easy, Grip

Large
30/60 mL - 1/2 Oz volume



NAME	ITEM NUMBER	INDV QTY	INNER CARTON	OUTER CARTON
I PROMEGJIG™ LARGE PLAT BLK	46/PROMEGJIG-LPB-UNI	1	12	48
J PROMEGJIG™ LARGE CHROME	46/PROMEGJIG-L-UNI	1	12	48
K PROMEGJIG™ LARGE GOLD	46/PROMEGJIG-LG-UNI	1	12	48
L PROMEGJIG™ LARGE COPPER	46/PROMEGJIG-LC-UNI	1	12	48

SIZE	MATERIAL	WEIGHT
101 X 55 X 55 mm	STAINLESS STEEL	93 gm

ProMegJig™

Metal, Easy, Grip

Regular NMI
15/30 mL volume



NAME	ITEM NUMBER	INDV QTY	INNER CARTON	OUTER CARTON
M PROMEGJIG™ REGULAR CHROME NMI	46/PROMEGJIG-R-NMI	1	12	48

SIZE	MATERIAL	WEIGHT
67 X 55 X 55 mm	STAINLESS STEEL	69 gm

ProMegJig™

Metal, Easy, Grip

Large NMI
30/60 mL volume



NAME	ITEM NUMBER	INDV QTY	INNER CARTON	OUTER CARTON
N PROMEGJIG™ LARGE CHROME NMI	46/PROMEGJIG-L-NMI	1	12	48

SIZE	MATERIAL	WEIGHT
101 X 55 X 55 mm	STAINLESS STEEL	93 gm



BarJigX™ | 15/30 mL volume



NAME	ITEM NUMBER	INDV QTY	INNER CARTON	OUTER CARTON
A BARJIGX™ PLATINUM BLACK	46/BARJIGX-RPB-WORLD	1	12	48
B BARJIGX™ CHROME	46/BARJIGX-R-WORLD	1	12	48
C BARJIGX™ GOLD	46/BARJIGX-RG-WORLD	1	12	48
D BARJIGX™ COPPER	46/BARJIGX-RC-WORLD	1	12	48

SIZE	MATERIAL	WEIGHT
68 X 52 X 52 mm	PLATED ABS	69 gm

ProBarJig™ | 15/30 mL volume

The world's dual measure



NAME	ITEM NUMBER	CHIP PACK QTY	INNER CARTON	OUTER CARTON
E PROBARJIG™	46/PROBARJIG-AU	1	12	72

SIZE	MATERIAL	WEIGHT
78 X 72 X 72 mm	POLYCARBONATE	42 gm

ProJig™ | 5/10/15/30 mL - 0.17/0.33/0.5/1 Oz volume

The world's multi measure

US 1/4Oz | 1/2Oz | 3/4Oz | 11/4Oz
CAN 1/4Oz (7.10mL) | 1/2Oz (14.20mL) | 3/4Oz

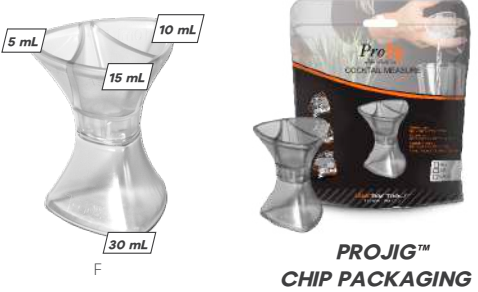

NAME	ITEM NUMBER	INDV QTY	INNER CARTON	OUTER CARTON
F PROJIG™	46/PROJIG-04 AU	1	12	72
G PROJIG™ US	46/PROJIG-04 US	1	12	72
H PROJIG™ CAN(21.30ML) 11/4OZ	46/PROJIG-04 US	1	12	72

SIZE	MATERIAL	WEIGHT
78 X 60 X 60 mm	POLYCARBONATE	22 gm

ProBarBone™ | 15/30 mL - 0.33/1 Oz volume



NAME	ITEM NUMBER	CHIP PACK QTY	INNER CARTON	OUTER CARTON
I PROBARBONE™	BARBONE-CHM CAN	1	12	72

SIZE	MATERIAL	WEIGHT
78 X 72 X 72 mm	POLYCARBONATE	42 gm

THE INNOVATION



REDUCES HAND-SHAKE
*LUX.JIG FEATURE ONLY



EASY



MULTIPLE MEASURE*



MODULAR PARTS*



FLAT POUR



ROUND JIGGER WITH MENISCUS



Pour Testing

Achieve accuracy & speed when pouring alcohol.

Designed as a practice tool to improve bartender pouring accuracy, speed and consistency.



BarCheck™

The Test Pour Kit



A

NAME	ITEM NUMBER	INDV QTY	INNER CARTON	OUTER CARTON
A BARCHECK™	46/BARCHK	1	1	4

SIZE	MATERIAL	WEIGHT
297 X 125 X 70 mm	POLYCARBONATE	350 gm

BarCheck™

The Test Pour Kit

Replacement tube 88 mL - 3 oz volume



B

NAME	ITEM NUMBER	INDV QTY	INNER CARTON	OUTER CARTON
B BARCHECK™ TUBE	46/X-BCHK-T	1	TBA	TBA

SIZE	MATERIAL	WEIGHT
297 X 125 X 70 mm	POLYCARBONATE	350 gm



EACH TUBE'S CAPACITY IS 90 ML OR 3 OZ , IN INCREMENTS OF 1 ML / 0.3 OZ

THE INNOVATION

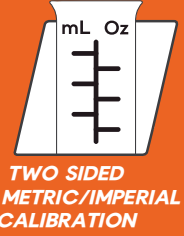

A close-up photograph of a bartender with a beard and glasses, wearing a dark blue shirt, pouring a golden liquid from a faceted glass pitcher through a metal strainer into a matching faceted glass. The background is softly blurred, showing a bar counter and another glass.

Straining

Strainers designed for precision and control.

Beautiful cocktails are enhanced when pips, peels, spices, and ice shards are kept out of the drink. Usually a single strain will suffice, however, sometimes a double strain is required.

BarRay™

Sting-Free Straining

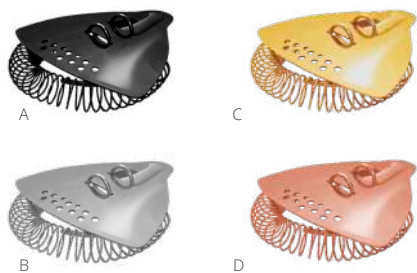

NAME	ITEM NUMBER	INDV QTY	INNER CARTON	OUTER CARTON
A BARRAY™ PLATINUM BLACK	46/BARRAY-PB	1	12	48
B BARRAY™ CHROME	46/BARRAY	1	12	48
C BARRAY™ GOLD	46/BARRAY-G	1	12	48
D BARRAY™ COPPER	46/BARRAY-C	1	12	48

SIZE	MATERIAL	WEIGHT
106 X 106 X 30 mm	STAINLESS STEEL	88 gm

StrainRay™

Sting-free Straining



NAME	ITEM NUMBER	INDV QTY	INNER CARTON	OUTER CARTON
E STRAINRAY™ PLATINUM BLACK	46/SRAY-PB	1	6	24
F STRAINRAY™ CHROME	46/SRAY	1	6	24
G STRAYRAY™ GOLD	46/SRAY-G	1	6	24
H STRAINRAY™ COPPER	46/SRAY-C	1	6	24

SIZE	MATERIAL	WEIGHT
203 X 106 X 30 mm	STAINLESS STEEL	240 gm

Julie™

Dual purpose strainer



NAME	ITEM NUMBER	INDV QTY	INNER CARTON	OUTER CARTON
I JULIE™ PLATINUM BLACK	46/JULEP-PB	1	6	48
J JULIE™ CHROME	46/JULEP	1	6	48
K JULIE™ GOLD	46/JULEP-G	1	6	48
L JULIE™ COPPER	46/JULEP-C	1	6	48

SIZE	MATERIAL	WEIGHT
165 X 69 X 20 mm	STAINLESS STEEL	300 gm

BarRay™

Sting-Free Straining

Replacement Spring

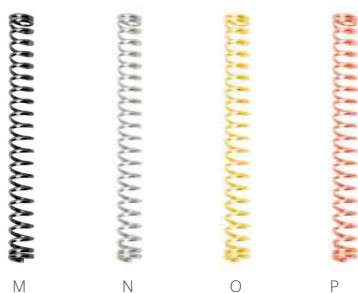

NAME	ITEM NUMBER	INDV QTY	INNER CARTON	OUTER CARTON
M BARRAY™ PLATINUM BLACK SPRING	46/SRAY-004	TBA	TBA	TBA
N BARRAY™ CHROME SPRING	46/SRAY-001	TBA	TBA	TBA
O BARRAY™ GOLD SPRING	46/SRAY-003	TBA	TBA	TBA
P BARRAY™ COPPER SPRING	46/SRAY-002	TBA	TBA	TBA

SIZE	MATERIAL	WEIGHT
150 mm	STAINLESS STEEL	70 gm

StrainRay™

Sting-free Straining

Replacement Spring

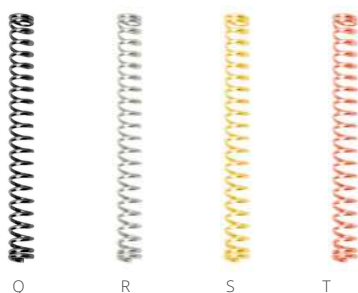

NAME	ITEM NUMBER	INDV QTY	INNER CARTON	OUTER CARTON
Q STRAINRAY™ PLATINUM BLACK SPRING	46/BARRAY-004	TBA	TBA	TBA
R STRAINRAY™ CHROME SPRING	46/BARRAY-001	TBA	TBA	TBA
S STRAINRAY™ GOLD SPRING	46/BARRAY-003	TBA	TBA	TBA
T STRAINRAY™ COPPER SPRING	46/BARRAY-002	TBA	TBA	TBA

SIZE	MATERIAL	WEIGHT
170 mm	STAINLESS STEEL	85 gm



Snub Nose Fine Strainer



NAME	ITEM NUMBER	INDV QTY	INNER CARTON	OUTER CARTON
A SNUB NOSE STRAINER BLACK	46/X-000.1-PB	1	12	48
B SNUB NOSE STRAINER CHROME	46/X-000.1	1	12	48
C SNUB NOSE STRAINER GOLD	46/X-000.1-G	1	12	48
D SNUB NOSE STRAINER COPPER	46/X-000.1-C	1	12	48

SIZE	MATERIAL	WEIGHT
170 X 70 X 70 mm	STAINLESS STEEL	159 gm

A close-up photograph of a bartender's hand holding a silver cocktail shaker. The shaker is cylindrical with a textured surface and a lid. To the left, a green glass with a textured, leaf-like pattern is partially visible. The background is dark and out of focus.

Shaking

The shaker is at the heart of cocktail creation.

Shaking and agitating liquids allowing for aeration, dilution and rapid chill down requires a lot of force! The cocktail shaker is the vessel where the cocktail comes together in the hands of a bartender.





M Shaker™

	NAME	ITEM NUMBER	INDV QTY	INNER CARTON	OUTER CARTON
A	M SHAKER PLATINUM BLACK	46/MSHAKER-PB	1	12	12
B	M SHAKER CHROME	46/MSHAKER	1	12	12
C	M SHAKER GOLD	46/MSHAKER-G	1	12	12
D	M SHAKER COPPER	46/MSHAKER-C	1	12	12

SIZE	MATERIAL	WEIGHT
178 X 80 X 80 mm	STAINLESS STEEL	215 gm



**A Lifetime Guarantee on
Überbartools™ Boston &
Toby Tins!**

Our Boston & Toby Tins are made of heavy gauge stainless steel and have laser-welded bases, GUARANTEED to Never Ever Fall Off!

If a base comes off, we'll replace the whole tin for free, you only pay for postage (applies to goods manufactured from 2022 which are production date stamped on the base).





A

B

C

D

Boston Tin | 830 mL - 27.7 oz volume

	NAME	ITEM NUMBER	INDV QTY	INNER CARTON	OUTER CARTON
A	BOSTON TIN PLATINUM BLACK	46/X-005-PB	1	12	24
B	BOSTON TIN CHROME	46/X-005	1	12	24
C	BOSTON TIN GOLD	46/X-005-G	1	12	24
D	BOSTON TIN COPPER	46/X-005-C	1	12	24

SIZE	MATERIAL	WEIGHT
178 X 80 X 80 mm	STAINLESS STEEL	215 gm



E

F

G

H

Boston Tin & Glass | 830 mL - 27.7 oz, 480 mL - 16 oz volume

	NAME	ITEM NUMBER	INDV QTY	INNER CARTON	OUTER CARTON
E	BOSTON TIN & GLASS PLATINUM BLACK	46/X-005/6-PB	1	12	24
F	BOSTON TIN & GLASS CHROME	46/X-005/6	1	12	24
G	BOSTON TIN & GLASS GOLD	46/X-005/6-G	1	12	24
H	BOSTON TIN & GLASS COPPER	46/X-005/6-C	1	12	24

SIZE	MATERIAL	WEIGHT
165 X 69 X 20 mm	STAINLESS STEEL	300 gm



I

J

K

L

Boston Tin & Toby Tin | 830 mL - 27.7, 585 mL - 19.5 oz volume

	NAME	ITEM NUMBER	INDV QTY	INNER CARTON	OUTER CARTON
I	BOSTON & TOBY TIN PLATINUM BACK	46/X-017-PB	1	12	24
J	BOSTON & TOBY TIN CHROME	46/X-017	1	12	24
K	BOSTON & TOBY TIN GOLD	46/X-017-G	1	12	24
L	BOSTON & TOBY TIN COPPER	46/X-017-C	1	12	24

SIZE	MATERIAL	WEIGHT
178 x 80 x 80 mm	STAINLESS STEEL	153 gm

Toby Tin | 585 mL - 19.5 oz volume



M

N

O

P

	NAME	ITEM NUMBER	INDV QTY	INNER CARTON	OUTER CARTON
M	TOBY TIN PLATINUM BLACK	46/X-034-PB	1	12	48
N	TOBY TIN CHROME	46/X-034	1	12	48
O	TOBY TIN GOLD	46/X-034-G	1	12	48
P	TOBY TIN COPPER	46/X-034-C	1	12	48

SIZE	MATERIAL	WEIGHT
115 X 80 X 80 mm	STAINLESS STEEL	153 gm



Q

Boston Glass | 480 mL - 16 oz volume

	NAME	ITEM NUMBER	INDV QTY	INNER CARTON	OUTER CARTON
Q	BOSTON GLASS	46/X-006	1	12	24

SIZE	MATERIAL	WEIGHT
225 X 80 X 80 mm	TEMPERED GLASS	150 gm



Stirring

There is an art to the stirred cocktail.

Stirring is the gentle technique of combining spirits and mixers into something greater. Integrating the ingredients by stirring the delicate flavours together is an essential element when making Martinis.





ProTrident™

Stirring, layering, garnishing

NAME	ITEM NUMBER	INDV QTY	INNER CARTON	OUTER CARTON
A PROTRIDENT™ PLATINUM BLACK	46/TRIDENT-PB	1	12	48
B PROTRIDENT™ CHROME	46/TRIDENT	1	12	48
C PROTRIDENT™ GOLD	46/TRIDENT-G	1	12	48
D PROTRIDENT™ COPPER	46/TRIDENT-C	1	12	48

SIZE	MATERIAL	WEIGHT
347 X 27 X 29 mm	STAINLESS STEEL	40 gm



ProTeardrop™

Stirring & mixing

NAME	ITEM NUMBER	INDV QTY	INNER CARTON	OUTER CARTON
E PROTEARDROP™ PLATINUM BLACK	46/TEARDROP-PB	1	12	48
F PROTEARDROP™ CHROME	46/TEARDROP-G	1	12	48
G PROTEARDROP™ GOLD	46/TEARDROP-G	1	12	48
H PROTEARDROP™ COPPER	46/TEARDROP-C	1	12	48

SIZE	MATERIAL	WEIGHT
300 X 27 X 27 mm	STAINLESS STEEL	40 gm



ProPaddle™

Stirring & mixing

NAME	ITEM NUMBER	INDV QTY	INNER CARTON	OUTER CARTON
I PROPADDLE™ PLATINUM BLACK	46/PROPADDLE-PB	1	12	48
J PROPADDLE™ CHROME	46/PROPADDLE	1	12	48
K PROPADDLE™ GOLD	46/PROPADDLE--G	1	12	48
L PROPADDLE™ COPPER	46/PROPADDLE-C	1	12	48

SIZE	MATERIAL	WEIGHT
335 X 27 X 27 mm	STAINLESS STEEL	40 gm

*PROSTIRRER™ FEATURE ONLY
 *PROTRIDENT™ FEATURE ONLY

THE INNOVATION



STIRRING



MUDDLING*



GARNISHING*



REDUCING CHAMPAGNE BUBBLES*





ProTrident™ XL

Stirring, layering, garnishing

 Available in Australia only.

	NAME	ITEM NUMBER	INDV QTY	INNER CARTON	OUTER CARTON
A	PROTRIDENT™ CHROME	46/TRIDENT-XL	1	12	48
B	PROTRIDENT™ GOLD	46/TRIDENT-XL-G	1	12	48
C	PROTRIDENT™ COPPER	46/TRIDENT-XL-C	1	12	48

SIZE	MATERIAL	WEIGHT
500 X 27 X 29 mm	STAINLESS STEEL	66 gm

ProTeardrop™ XL

Stirring & mixing

 Available in Australia only.

	NAME	ITEM NUMBER	INDV QTY	INNER CARTON	OUTER CARTON
D	PROTEARDROP™ CHROME	46/TEARDROP-XLG	1	12	48
E	PROTEARDROP™ GOLD	46/TEARDROP-XL-G	1	12	48
F	PROTEARDROP™ COPPER	46/TEARDROP-XL-C	1	12	48

SIZE	MATERIAL	WEIGHT
500 X 27 X 27 mm	STAINLESS STEEL	60 gm

ProPaddle™ XL

Stirring & mixing

 Available in Australia only.

	NAME	ITEM NUMBER	INDV QTY	INNER CARTON	OUTER CARTON
G	PROPADDLE™ CHROME	46/PROPADDLE-XL	1	12	48
H	PROPADDLE™ GOLD	46/PROPADDLE-XL-G	1	12	48
I	PROPADDLE™ COPPER	46/PROPADDLE-XL-C	1	12	48

SIZE	MATERIAL	WEIGHT
335 X 27 X 27 mm	STAINLESS STEEL	60 gm

*PROSTIRRER™ FEATURE ONLY
*PROTRIDENT™ FEATURE ONLY

THE INNOVATION



STIRRING



MUDDLING*



GARNISHING*



REDUCING CHAMPAGNE BUBBLES*





ProStirrer™

Stirring, Muddling & Layering

NAME	ITEM NUMBER	INDV QTY	INNER CARTON	OUTER CARTON
A PROSTIRRER™ PLATINUM BLACK	46/PRSTR-PB	1	12	48
B PROSTIRRER™ CHROME	46/PRSTR	1	12	48
C PROSTIRRER™ GOLD	46/PRSTR-G	1	12	48
D PROSTIRRER™ COPPER	46/PRSTR-C	1	12	48

SIZE	MATERIAL	WEIGHT
297 x 27 x 27 mm	STAINLESS STEEL	70 gm



BarSpoon

NAME	ITEM NUMBER	INDV QTY	INNER CARTON	OUTER CARTON
E BARSPOON PLATINUM BLACK	46/BARSPOON-PB	1	12	48
F BARSPOON CHROME	46/BARSPOON	1	12	48
G BARSPOON GOLD	46/BARSPOON-G	1	12	48
H BARSPOON COPPER	46/BARSPOON-C	1	12	48

SIZE	MATERIAL	WEIGHT
260 X 25 X 25 mm	STAINLESS STEEL	45 gm



Antonio Lai



QUINARY



Swizzle Stick

There is an art to the stirred cocktail.

Antonio Lai: noted bartender, entrepreneur and innovator started his journey as a bar-back in the early 90's.

Antonio Lai



Propels mixed Drinks

NAME	ITEM NUMBER	INDV QTY	INNER CARTON	OUTER CARTON
A ASWIZZ™	46-ASWIZZ-G	1	12	48

SIZE	MATERIAL	WEIGHT
297 x 27 x 27 mm	STAINLESS STEEL	70 gm



Fast forward to today where Antonio runs a bar empire whose jewel is the much loved and critically acclaimed Quinary (World's 50 Best Bars), famed for its Earl Grey Caviar Martini!

In the true spirit of collaboration Antonio and Überbartools™ have re-imagined the traditional swizzle stick, creating the A-Swizz™.

Featuring an inspired lotus leaf design reminiscent of an aeroplane propeller, the A-Swizz™ churns and mixes liquids with minimal effort and maximum joy.

THE INNOVATION

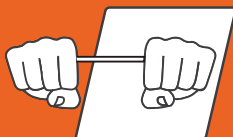

CAST METAL TOUGHNESS



BEVEL EDGE GRIP



PROPELLER MAXIMISES CIRCULATION





LogoSwizz™

Propels Mixed Drinks

NAME	ITEM NUMBER	INDV QTY	INNER CARTON	OUTER CARTON
A LOGOSWIZZ™	46/LOGOSWIZZ	NA	NA	48

SIZE	MATERIAL	WEIGHT
400 X 35 X 35 mm	CAST ALLOY	278 gm



LuxSwizz™

Propels mixed Drinks

NAME	ITEM NUMBER	INDV QTY	INNER CARTON	OUTER CARTON
B LUXSWIZZ™ PLATINUM BLACK	46/LUXSWIZZ-PB	1	12	48
C LUXSWIZZ™ CHROME	46/LUXSWIZZ	1	12	48
D LUXSWIZZ™ GOLD	46/LUXSWIZZ-G	1	12	48
E LUXSWIZZ™ COPPER	46/LUXSWIZZ-C	1	12	48

SIZE	MATERIAL	WEIGHT
400 X 35 X 35 mm	CAST ALLOY	278 gm

THE INNOVATION

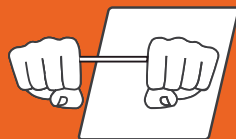

CAST METAL TOUGHNESS



BEVEL EDGE GRIP



PROPELLER MAXIMISES CIRCULATION



Muddling

Extracting maximum flavour with minimum effort.

Fruits and vegetables contain hidden flavours and oils only released through the rigorous action of muddling, adding flavour and complexity to a cocktail.





BarStik™

All-purpose Muddler

NAME	ITEM NUMBER	INDV QTY	INNER CARTON	OUTER CARTON
A BARSTIK™ PLATINUM BLACK	46/BARSTIK-PB	1	12	48
B BARSTIK™ CHROME	46/BARSTIK	1	12	48
C BARSTIK™ GOLD	46/BARSTIK-G	1	12	48
D BARSTIK™ COPPER	46/BARSTIK-C	1	12	48

SIZE	MATERIAL	WEIGHT
225 X 32 X 32 mm	STAINLESS STEEL	271 gm



ProStik™

All purpose Muddler

NAME	ITEM NUMBER	INDV QTY	INNER CARTON	OUTER CARTON
E PROSTIK™	46/PSTIK	1	6	48

SIZE	MATERIAL	WEIGHT
274 X 40 X 40 mm	STAINLESS STEEL	271 gm



ProCrush™

Muddler & Crusher

NAME	ITEM NUMBER	INDV QTY	INNER CARTON	OUTER CARTON
F PROCRUSH™	46/PCRUSH	1	1	24

SIZE	MATERIAL	WEIGHT
320 X 40 X 40 mm	STAINLESS STEEL	543 gm



Spare ProCrush™ & ProStik™ Heads

NAME	ITEM NUMBER	INDV QTY	INNER CARTON	OUTER CARTON
G PROCRUSH™ HEAD		1	50	250

SIZE	MATERIAL	WEIGHT
44 X 44 X 44 mm	ABS/TPE/STAINLESS	40 gm

THE INNOVATION

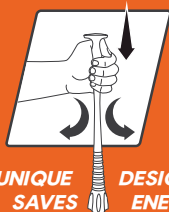

UNIQUE DESIGN SAVES ENERGY



PATENTED ERGONOMIC



REPLACEABLE HEAD*

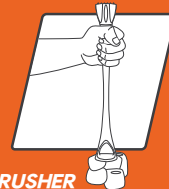

ICE CRUSHER WHEN INVERTED*

*PROSTIK® & PROCRUSH® FEATURE ONLY
#PROCRUSH® FEATURE ONLY

Bottle Opener

Sleek elegant and fast.

The Endoblade™ is sleek, elegant and über fast. It makes popping bottles and cans effortless.



EndoBlade™

The Cutting Edge Blade



A

NAME	ITEM NUMBER	INDV QTY	INNER CARTON	OUTER CARTON
A ENDOBLADE™	46/ENDOBLADE	1	12	48

SIZE	MATERIAL	WEIGHT
148 X 48 X 48 mm	STAINLESS STEEL	78 gm



TAPERED BLADE FRONT TO EASE THE OPENING OF RING-PULL CANS



PERFECTLY BALANCED



REVOLUTIONARY CURVED BLADE FOR EASE OF USE



Ice Tools

Elegance and artistry of carving ice.

Ice carving rituals started in Japan to create theatre and refinement to single serve spirits. The Über™ ice picks provide enhanced safety, comfort and control.





LuxPik™

The Ergonomic Icepick

NAME	ITEM NUMBER	INDV QTY	INNER CARTON	OUTER CARTON
A LUXPIK™	46/LUXPIK	1	4	24

SIZE	MATERIAL	WEIGHT
148 X 48 X 48 mm	STAINLESS STEEL	78 gm



LuxFork™

The Ergonomic Fork

NAME	ITEM NUMBER	INDV QTY	INNER CARTON	OUTER CARTON
B LUXFORK™	46/LUXFORK	1	4	24

SIZE	MATERIAL	WEIGHT
148 X 48 X 48 mm	STAINLESS STEEL	78 gm

Replacment Parts

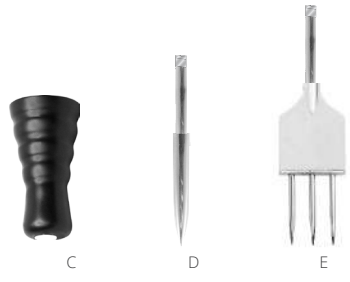

NAME	ITEM NUMBER	INDV QTY	INNER CARTON	OUTER CARTON
C REPLACEMENT GRIP	46/LUXGRIP	1	TBA	TBA
D LUXPIK™ REPLACEMENT PICK	46/LUXPIKNEEDLE	1	TBA	TBA
E LUXFORK™ REPLACEMENT FORK	46/LUXFORKTOP	1	TBA	TBA

SIZE	MATERIAL	WEIGHT
148 X 48 X 48 mm	STAINLESS STEEL	78 gm

THE INNOVATION

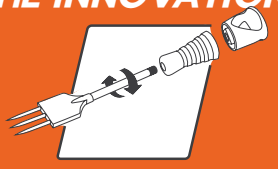

MODULAR DESIGN

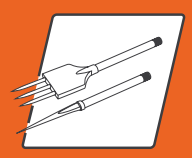

REPLACEABLE PICK ENDS



PATENTED ERGONOMIC PROGRIP

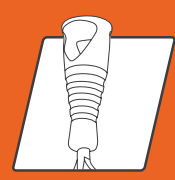

RUBBERISED COMFORT GRIP





A

Lux Hammer™

NAME	ITEM NUMBER	INDV QTY	INNER CARTON	OUTER CARTON
A LUXHAMMER™	46/LUXHAMMER	1	1	6

SIZE	MATERIAL	WEIGHT
170 X 45 X 45 mm	TIMBER	700 gm



B

Lux Hammer™ Lux Icebag™ Set

NAME	ITEM NUMBER	INDV QTY	INNER CARTON	OUTER CARTON
B LUX HAMMER AND LUXICEBAG SET™	46/LBLH	1	1	6

SIZE	MATERIAL	WEIGHT
300 X 200 X 10 mm	COTTON/TIMBER	730 gm



C

Lux Icebag™

NAME	ITEM NUMBER	INDV QTY	INNER CARTON	OUTER CARTON
C LUXICEBAG™	46/LUXICEBAG	1	6	36

SIZE	MATERIAL	WEIGHT
300 X 200 X 10 mm	COTTON	30 gm



D

Ice Mould

NAME	ITEM NUMBER	INDV QTY	INNER CARTON	OUTER CARTON
D ICE MOULD	46/X-022	1	1	24

SIZE	MATERIAL	WEIGHT
170 X 45 X 45 mm	SILICON	50 gm



Ritual Vessels

The Mint Julep cup and Moscow Mule mug have become synonymous with the authentic serve of those cocktails.





Julep Cup | 400 mL - 13.5 oz volume

NAME	ITEM NUMBER	INDV QTY	INNER CARTON	OUTER CARTON
A JULEP CUP CHROME	46/X-021	1	6	48
B JULEP CUP COPPER	46/X-021-C	1	6	48

SIZE	MATERIAL	WEIGHT
105 X 85 X 85 mm	STAINLESS STEEL	159 gm



Mule Mug | 500 mL - 17 oz volume

NAME	ITEM NUMBER	INDV QTY	INNER CARTON	OUTER CARTON
C MULE MUG	46/X-040	1	6	48

SIZE	MATERIAL	WEIGHT
90 X 90 X 90 mm	STAINLESS STEEL	205 gm



Bitter Bottles



Bitters Bottle

30 mL - 1 Oz volume



A B C D

	NAME	ITEM NUMBER	INDV QTY	INNER CARTON	OUTER CARTON
A	BITTERS BOTTLE 30 ML CHROME	46/X-042	1	6	48
B	BITTERS BOTTLE 30 ML GOLD	46/X-042-G	1	6	48
C	BITTERS BOTTLE 30 ML COPPER	46/X-042-C	1	6	48
D	BITTERS BOTTLE 30 ML BLACK	46/X-042-B	1	6	48

SIZE	MATERIAL	WEIGHT
105 x 50 x 50 mm	GLASS	87 gm

Bitters Bottle

50 mL - 1.7 Oz volume



E F G H

	NAME	ITEM NUMBER	INDV QTY	INNER CARTON	OUTER CARTON
E	BITTERS BOTTLE 50 ML CHROME	46/X-043	1	6	48
F	BITTERS BOTTLE 50 ML GOLD	46/X-043-G	1	6	48
G	BITTERS BOTTLE 50 ML COPPER	46/X-043-C	1	6	48
H	BITTERS BOTTLE 50 ML BLACK	46/X-043-B	1	6	48

SIZE	MATERIAL	WEIGHT
125 X 60 X 69 mm	GLASS	120 gm

Bitters Bottle

90 mL - 3 Oz volume



I J K L

	NAME	ITEM NUMBER	INDV QTY	INNER CARTON	OUTER CARTON
I	BITTERS BOTTLE 90 ML CHROME	46/X-047	1	6	48
J	BITTERS BOTTLE 90 ML GOLD	46/X-047-G	1	6	48
K	BITTERS BOTTLE 90 ML COPPER	46/X-047-C	1	6	48
L	BITTERS BOTTLE 90 ML BLACK	46/X-047-B	1	6	48

SIZE	MATERIAL	WEIGHT
150 X 80 X 80 mm	GLASS	225 gm

Bitters Bottle

Replacement Spout



M N O P

	NAME	ITEM NUMBER	INDV QTY	INNER CARTON	OUTER CARTON
M	BITTERS BOTTLE CHROME	46/X-BBT-001	1	TBA	TBA
N	BITTERS BOTTLE GOLD	46/X-BBT-003	1	TBA	TBA
O	BITTERS BOTTLE COPPER	46/X-BBT-002	1	TBA	TBA
P	BITTERS BOTTLE BLACK	46/X-BBT-004	1	TBA	TBA

SIZE	MATERIAL	WEIGHT
25 X 25 X 30 mm	ALUMINIUM	30 gm



Cocktail Accessories

Additional tools provide the finishing touches to your cocktails.





Pro Tweezers™

Garnish Tweezers

NAME	ITEM NUMBER	INDV QTY	INNER CARTON	OUTER CARTON
E PROTWEEZER™ PLATINUM BLACK	46/X-076-PB	1	12	48
F PROTWEEZER™ CHROME	46/X-076	1	12	48
G PROTWEEZER™ GOLD	46/X-076-G	1	12	48
H PROTWEEZER™ COPPER	46/X-076-C	1	12	48

SIZE	MATERIAL	WEIGHT
270 X 40 mm	STAINLESS STEEL	88 gm



Tweezers

NAME	ITEM NUMBER	INDV QTY	INNER CARTON	OUTER CARTON
I TWEEZER PLATINUM BLACK	46/X-003-PB	1	12	48
J TWEEZER CHROME	46/X-003	1	12	48
K TWEEZER GOLD	46/X-003-G	1	12	48
L TWEEZER COPPER	46/X-003-C	1	12	48

SIZE	MATERIAL	WEIGHT
304 X 20 X 20 mm	STAINLESS STEEL	88 gm



Jet Mister

NAME	ITEM NUMBER	INDV QTY	INNER CARTON	OUTER CARTON
M JET MISTER CHROME	46/X-019	1	12	48
N JET MISTER GOLD	446/X-019-G	1	12	48

SIZE	MATERIAL	WEIGHT
145 X 45 X 45 mm	GLASS	99 gm



Jet Mister

NAME	ITEM NUMBER	INDV QTY	INNER CARTON	OUTER CARTON
O JET MISTER CHROME SPRAY WITH LID	46/X-019-001	1	TBA	TBA
P JET MISTER GOLD SPRAY WITH LID	46/X-019-003	1	TBA	TBA

SIZE	MATERIAL	WEIGHT
145 X 45 X 45 mm	ABS	99 gm



Bar Picks™

Garnishes on a stick

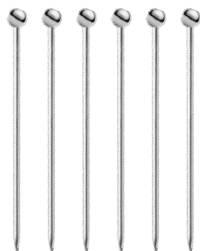

A

NAME	ITEM NUMBER	INDV QTY	INNER CARTON	OUTER CARTON
A BAPICK BALL (6PCS)	46/X-073	1	12	48

SIZE	MATERIAL	WEIGHT
110 X 6 mm	STAINLESS STEEL	170 gm

Bar Picks™

Garnishes on a stick

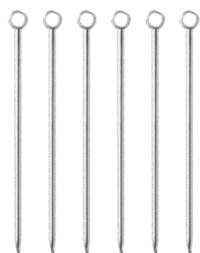

B

NAME	ITEM NUMBER	INDV QTY	INNER CARTON	OUTER CARTON
B BARPICK RING (6PCS)	46/X-074	1	12	48

SIZE	MATERIAL	WEIGHT
110 X 6 mm	STAINLESS STEEL	170 gm

C-Press™



C

NAME	ITEM NUMBER	INDV QTY	INNER CARTON	OUTER CARTON
C CPRESS™	46/CPRESS	1	12	48

SIZE	MATERIAL	WEIGHT
228 X 68 X 68 mm	ALUMINIUM	260 gm

Flair Bottle (includes BarFlow™)



D

NAME	ITEM NUMBER	INDV QTY	INNER CARTON	OUTER CARTON
D FLAIR BOTTLE	46/FLAIR-BOTTLE	1	12	48

SIZE	MATERIAL	WEIGHT
340 X 80 mm	ABS	300 gm





A

Bar Straws™

Stainless steel straws

	NAME	ITEM NUMBER	INDV QTY	INNER CARTON	OUTER CARTON
A	BARSTRAWS (4PCS + 1BRUSH)	46/X-075	1	12	48

	SIZE	MATERIAL	WEIGHT
	210 X 6 mm	STAINLESS STEEL	170 gm



B

Bar Straws™

Stainless steel straws

Bulk

	NAME	ITEM NUMBER	INDV QTY	INNER CARTON	OUTER CARTON
B	BARSTRAWS REPLACEMENT STRAW	46/X-075-B	1	TBA	TBA

	SIZE	MATERIAL	WEIGHT
	210 X 6 mm	STAINLESS STEEL	20 gm



C

Bar Straws™

Stainless steel straws

Cocktail Straw Bulk

	NAME	ITEM NUMBER	INDV QTY	INNER CARTON	OUTER CARTON
C	BARSTRAWS REPLACEMENT STRAW	46/X-075-S	1	TBA	TBA

	SIZE	MATERIAL	WEIGHT
	125 X 6 mm	STAINLESS STEEL	12 gm



D

Bar Straws™

Stainless steel straws

Replacement Brush

	NAME	ITEM NUMBER	INDV QTY	INNER CARTON	OUTER CARTON
D	BARSTRAWS REPLACEMENT BRUSH	46/X-075-001	1	TBA	TBA

	SIZE	MATERIAL	WEIGHT
	210 X 20 mm	STAINLESS STEEL	20 gm



Cocktail Sets

Impress with our ready to rock sets.

We've curated a fine range of cocktail sets to provide inspiration for a pro or home enthusiast. They also make a perfect gift.





ProShakerSet™

NAME	ITEM NUMBER	INDV QTY	INNER CARTON	OUTER CARTON
A PRO SHAKER KIT™ PLATINUM BLACK	46/PSS-PB-WORLD	1	1	6
B PRO SHAKER KIT™ CHROME	46/PSS-WORLD	1	1	6
C PRO SHAKER KIT™ GOLD	46/PSS-G-WORLD	1	1	6
D PRO SHAKER KIT™ COPPER	46/PSS-C-WORLD	1	1	6

SIZE	MATERIAL	WEIGHT
370 X 130 X 130 mm	STAINLESS STEEL	501 mm



Shaker, Measure & Strainer Set

incl. M Shaker™, ProMegJig™ & BarRay™

NAME	ITEM NUMBER	INDV QTY	INNER CARTON	OUTER CARTON
E SHAKER, MEASURE & STRAINER KIT PLATINUM BLACK	46/GS-004-PB-WORLD	1	1	6
F SHAKER, MEASURE & STRAINER KIT GOLD	46/GS-004-G-WORLD	1	1	6
G SHAKER, MEASURE & STRAINER KIT CHROME	46/GS-004-WORLD	1	1	6
H SHAKER, MEASURE & STRAINER KIT COPPER	46/GS-004-C-WORLD	1	1	6

SIZE	MATERIAL	WEIGHT
370 X 130 X 130 mm	STAINLESS STEEL	501 mm



Shaker & Jigger Set

incl. M Shaker™ & ProMegJig™

NAME	ITEM NUMBER	INDV QTY	INNER CARTON	OUTER CARTON
I SHAKER & JIGGER SET PLATINUM BLACK	46/GS-005-PB-WORLD	1	1	6
J SHAKER & JIGGER SET GOLD	46/GS-005-G-WORLD	1	1	6
K SHAKER & JIGGER SET CHROME	46/GS-005-WORLD	1	1	6
L SHAKER & JIGGER SET COPPER	46/GS-005-C-WORLD	1	1	6

SIZE	MATERIAL	WEIGHT
370 X 130 X 130 mm	STAINLESS STEEL	501 mm



NEW ARRIVAL

M Shaker™ + BarJigX™

15/30 mL - 0.33/1 Oz volume

NAME	ITEM NUMBER	INDV QTY	INNER CARTON	OUTER CARTON
M M SHAKER + BARJIG X PLATINUM BLACK	46/MSHAKER/X-PB	1	12	12
N M SHAKER + BARJIG X CHROME	46/MSHAKER/X	1	12	12
O M SHAKER + BARJIG X GOLD	46/MSHAKER/X-G	1	12	12
P M SHAKER + BARJIG X COPPER	46/MSHAKER/X-C	1	12	12

SIZE	MATERIAL	WEIGHT
178 X 80 X 80 mm	STAINLESS STEEL	215 gm





Stir, Mix, Strain Set | incl. Mixing Glass, BarRay™ & BarSpoon™

NAME	ITEM NUMBER	INDV QTY	INNER CARTON	OUTER CARTON
E STIR, MIX, STRAIN SET PLATINUM BLACK	46/GS-006-PB	1	1	6
F STIR, MIX, STRAIN SET GOLD	46/GS-006-G	1	1	6
G STIR, MIX, STRAIN SET CHROME	46/GS-006	1	1	6
H STIR, MIX, STRAIN SET COPPER	46/GS-006-C	1	1	6

SIZE	MATERIAL	WEIGHT
370 X 130 X 130 mm	STAINLESS STEEL	501 mm



Bartender Cocktail Set | incl. Mixing Glass & BarRay™

NAME	ITEM NUMBER	INDV QTY	INNER CARTON	OUTER CARTON
I BARTENDER COCKTAIL SET PLATINUM BLACK	46/GS-008-PB	1	1	6
J BARTENDER COCKTAIL SET GOLD	46/GS-008-G	1	1	6
K BARTENDER COCKTAIL SET CHROME	46/GS-008	1	1	6
L BARTENDER COCKTAIL SET COPPER	46/GS-008-C	1	1	6

SIZE	MATERIAL	WEIGHT
370 X 130 X 130 mm	STAINLESS STEEL	501 mm





B



D



Bartender Classic Set | incl. Toby Tin, Boston Tin, ProMegJig™ & BarRay™

NAME	ITEM NUMBER	INDV QTY	INNER CARTON	OUTER CARTON
A BARTENDER CLASSIC SET PLATINUM BLACK	46/GS-011-PB-WORLD	1	1	6
B BARTENDER CLASSIC SET GOLD	46/GS-011-G-WORLD	1	1	6
C BARTENDER CLASSIC SET CHROME	46/GS-011-WORLD	1	1	6
D BARTENDER CLASSIC SET COPPER	46/GS-011-G-WORLD	1	1	6

SIZE	MATERIAL	WEIGHT
370 X 130 X 130 mm	STAINLESS STEEL	501 mm



E

Bartender Essentials Set

NAME	ITEM NUMBER	INDV QTY	INNER CARTON	OUTER CARTON
E BARTENDER ESSENTIALS SET	46/GS-003	1	1	6

SIZE	MATERIAL	WEIGHT
370 X 130 X 130 mm	STAINLESS STEEL	501 mm



Bartender Kits

Cocktails on the go.

With the LuxRoll™ you are ready to make cocktails anywhere with your comprehensive set of bar tools in a convenient roll case.



ProBostonRoll™ v4

The total bartender kit



A

NAME	ITEM NUMBER	INDV QTY	INNER CARTON	OUTER CARTON	
A	PROBOSTONROLL™ V4	46/BBR-UNI	1	1	2

SIZE	MATERIAL	WEIGHT
445 X 180 X 180	PVC	3370 gm

ProBostonRoll™ DL v3

The total bartender kit



B

NAME	ITEM NUMBER	INDV QTY	INNER CARTON	OUTER CARTON	
B	PROBOSTONROLL™ V3	46/BBR-DELUX	1	1	2

SIZE	MATERIAL	WEIGHT
445 X 180 X 180 mm	PVC	3370 gm

LuxRoll™

The total bartender kit



C

NAME	ITEM NUMBER	INDV QTY	INNER CARTON	OUTER CARTON	
C	LUXROLL™	46/LUXROLL	1	1	2

SIZE	MATERIAL	WEIGHT
240 X 180 X 165 mm	LEATHERETTE	1960 gm



Überbentool™
Innovation in Your hands



LuxPorterBag™

The craft bartender kit



A

NAME	ITEM NUMBER	INDV QTY	INNER CARTON	OUTER CARTON
A LUXPORTERBAG™	46/LUXPORTER	1	TBA	TBA

SIZE	MATERIAL	WEIGHT
240 X 180 X 165 mm	LEATHERETTE	1960 gm

ProBostonRoll™

The total bartender kit



B

NAME	ITEM NUMBER	INDV QTY	INNER CARTON	OUTER CARTON
B PROBOSTONROLL™ BAG ONLY	46/BBR-CASE	1	1	2

SIZE	MATERIAL	WEIGHT
240 X 180 X 165 mm	LEATHERETTE	1960 gm

LuxRoll™

The total bartender kit



C

NAME	ITEM NUMBER	INDV QTY	INNER CARTON	OUTER CARTON
C PROBOSTONROLL™ DELUXE	46LUX-CASE	1	1	2

SIZE	MATERIAL	WEIGHT
240 X 180 X 165 mm	LEATHERETTE	1960 gm



Cocktail Chimney

The ultimate cocktail and dessert smoker, taking entertaining to the next level.





A

Cocktail Chimney

	NAME	ITEM NUMBER	INDV QTY	INNER CARTON	OUTER CARTON
A	COCKTAIL CHIMNEY	46/X-090-01	1	6	48



B

Cocktail Chimney | Lid Only

	NAME	ITEM NUMBER	INDV QTY	INNER CARTON	OUTER CARTON
B	COCKTAIL CHIMNEY	46/X-090-02	1	?	?



C

Cocktail Chimney 6-Piece Smoking Set

	NAME	ITEM NUMBER	INDV QTY	INNER CARTON	OUTER CARTON
C	COCKTAIL CHIMNEY 6-PIECE SMOKING SET	46/X-090	1	?	?



D

Zeo Lighter Black (without gas)

	NAME	ITEM NUMBER	INDV QTY	INNER CARTON	OUTER CARTON
D	LIGHTER BLACK (WITHOUT GAS)	46/Z-055-PB	1	TBA	TBA



E

Lighter Fluid, 250mL

	NAME	ITEM NUMBER	INDV QTY	INNER CARTON	OUTER CARTON
E	LIGHTER FLUID, 250ML	46/Z-091-LF	1	TBA	TBA



über bar TOOLS™

OLD FASHIONED

SMOKIN'

WOOD CHIPS





OLD FASHIONED
SMOKIN'
WOOD CHIPS

NAME	ITEM NUMBER	INDV QTY	INNER CARTON	OUTER CARTON
A OLD FASHIONED SMOKIN' WOOD CHIPS TIN - APPLE, 10G		1	TBA	TBA



OLD FASHIONED
SMOKIN'
WOOD CHIPS

NAME	ITEM NUMBER	INDV QTY	INNER CARTON	OUTER CARTON
B OLD FASHIONED SMOKIN' WOOD CHIPS TIN - CHERRY, 10G		1	TBA	TBA



OLD FASHIONED
SMOKIN'
WOOD CHIPS

NAME	ITEM NUMBER	INDV QTY	INNER CARTON	OUTER CARTON
C OLD FASHIONED SMOKIN' WOOD CHIPS TIN - OAK, 10G		1	TBA	TBA



OLD FASHIONED
SMOKIN'
WOOD CHIPS

NAME	ITEM NUMBER	INDV QTY	INNER CARTON	OUTER CARTON
D OLD FASHIONED SMOKIN' WOOD CHIPS - OAK, 200G		1	TBA	TBA



OLD FASHIONED
SMOKIN'
WOOD CHIPS

NAME	ITEM NUMBER	INDV QTY	INNER CARTON	OUTER CARTON
E OLD FASHIONED SMOKIN' WOOD CHIPS - APPLE, 200G		1	TBA	TBA



OLD FASHIONED
SMOKIN'
WOOD CHIPS

NAME	ITEM NUMBER	INDV QTY	INNER CARTON	OUTER CARTON
F OLD FASHIONED SMOKIN' WOOD CHIPS - OAK, 200G		1	TBA	TBA

A photograph of a bar interior. The background is filled with shelves of various liquor bottles. Several Edison-style light bulbs are hanging from the ceiling, casting a warm, yellowish glow. In the foreground, a white, rounded, teardrop-shaped graphic is overlaid on the left side of the image.

Bar Station



BAR STATION IN A BOX



Bar Station In A Box

- Contains:
- 12 x Barflow™ Pourers
 - 12 x Snap On Protector
 - 2 x ProBarjig™ Jigger NMI Polycarbonate
 - 2 x Cocktail Shaker Chrome
 - 2 x BarRay™ Strainer Chrome
 - 2 x Snub Nose Strainer
 - 1 x Stirrer Spoon Chrome
 - 1 x Barstik™ Muddler Chrome
 - 1 x Cpress™ Citrus Squeezer
 - 1 x Zester
 - 1 x Peeler

NAME	ITEM NUMBER	INDV QTY	INNER CARTON	OUTER CARTON
A BAR STATION IN A BOX	46/UBT-BSB-WORLD	1	1	4

SIZE	MATERIAL	WEIGHT
350 X 350 X 350 mm	STAINLESS STEEL	5000 gm

Containing 37 essential Überbartools™ used by bartenders in over 34 countries.

Bar Station in a Box is a cost effective solution for the new bar or the existing bar wanting to change to the brand that reduces liquor wastage to increase profits.



STRAIGHT UP

Storytelling for Bartenders



STRAIGHT UP

Storytelling for Bartenders

EPISODES OUT NOW

STARIGHTUPSTORYTELLING.COM.AU

FEATURING...

**Innovation.
Community.
Storytelling.**



6 HEAD
1788



EPISODE ONE WITH SARAH PROIETTI

Episode one kicks with a World's Top 50 Best Bars 2022, Maybe Sammy and venue manager Sarah Proietti.

Maybe Sammy is a cocktail bar that takes inspiration from the roaring fifties, the rebirth of cool, the era where fashion and fun prevailed; we head to the best bar in Australia.

When "The Rat Pack" and Hollywood glamour were revered and admired. Their signature drinks are named after some of the most favourite haunts on the Vegas strip and a local influence. Take a look through the Mini Martinis list, and you will instantly recognise the nod to the most iconic cocktails of all time. Each drink on this menu will take you through an eye-opening and different experience.

Sarah Proietti, the venue manager, joined the bartending scene in high school and, like many, stayed.

She says that "I felt working in the bar industry made me happy and excited me being surrounded by people. Being in the industry is not just about creating cocktails."

"It's the whole package that comes with that because every guest is different. In hospitality, it's essential to take care of our guests from the time they come through the door—the importance of creating a fantastic experience through the atmosphere, music, and even temperature."

Proietti praises her Maybe Sammy team for the opportunity and the passion they display to customers. She says "everyone has their amazing personality, and altogether we create a great synergy, and it's just very special."

Having the Maybe Sammy experience is a Sydney must. The cocktails are all of a calibre you'd expect from a bar on the World's 50 Best Bars, the service attentive, the interior – a palette of pastels and rich greens, but what makes this Art Deco venue unique is the cultivated energy of the team.

Sip your cocktails to the swinging sounds of the '50s, enjoy the bold presence of this venue, and most importantly, have fun.



for Bartenders. 2022



Straight Up Storytelling interviews Australia's best bartenders, restaurateurs, distilleries, breweries, industry leaders and change-makers.

Our goal is to share the secrets, inspirations, struggles and tools they use to make their business flow.

Go to www.straightupstorytelling.com to enjoy our web series, cocktail recipes, articles and purchase premium bar equipment.

PRESENTED BY
über bar TOOLS™

Über bar TOOLS™

Innovation in your hands.

Global Headquarters
Synergy Merchandising Pty.Ltd.
ABN 76 095 230 112
Unit 12U No.175 Gibbes Street
Chatswood NSW, AUSTRALIA 2067

Tel: +61 29417 6977
Fax: +61 29417 6155
Email: sales@uberbartools.com
Web | www.uberbartools.com

Bottle brands shown are for illustrative purposes only and does not imply that brand's endorsement of Überbartools™.

The products and content in this catalogue may not be reproduced without prior written permission from Überbartools™.

Products depicted in this catalogue are protected by intellectual property rights including patents, design registrations and copyrights. Überbartools™ will take vigorous action against counterfeiters and infringers.

© Überbartools™ 2022.