

Surprise Popping Cake Stand

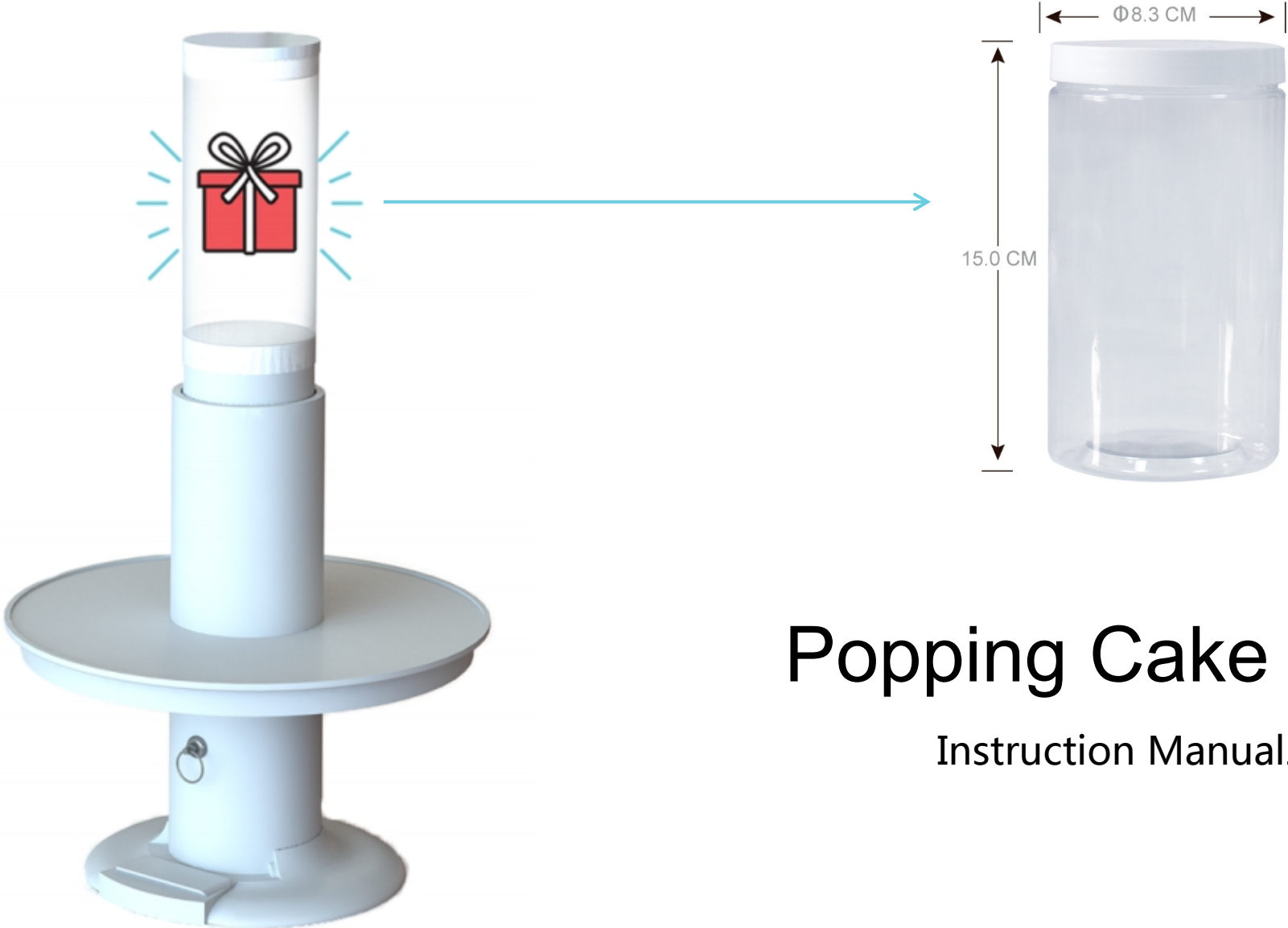

Popping Cake Stand

Instruction Manual 2.0

Table of Contents

Parts	1
Popping Stand Assembly	2-3
Cake Prep Guide	4-5

Parts

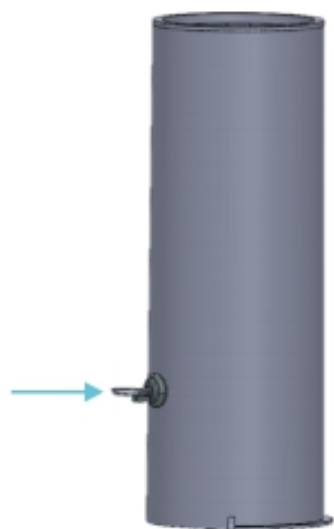

1. Tube with Release Ring

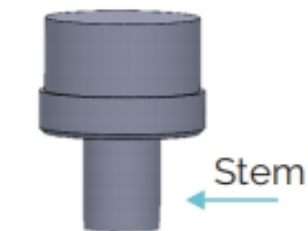

2. Shuttle



3. Spring



4. Base

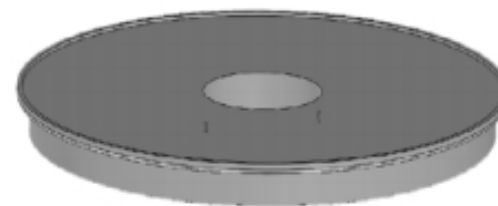

5. Surprise Plate



6. Gift Pod

All parts are hand washable.

WARNING: The Popping Stand is NOT a toy! Excessive pulling on the Release Ring may cause damage. Adult supervision required.

Popping Stand Assembly

Step 1 - Insert Shuttle and Spring

1

Position Tube with lip facing upwards.

Insert wide end of Shuttle into lip end of Tube. *Gently pull* Release Ring to let Shuttle slide through.

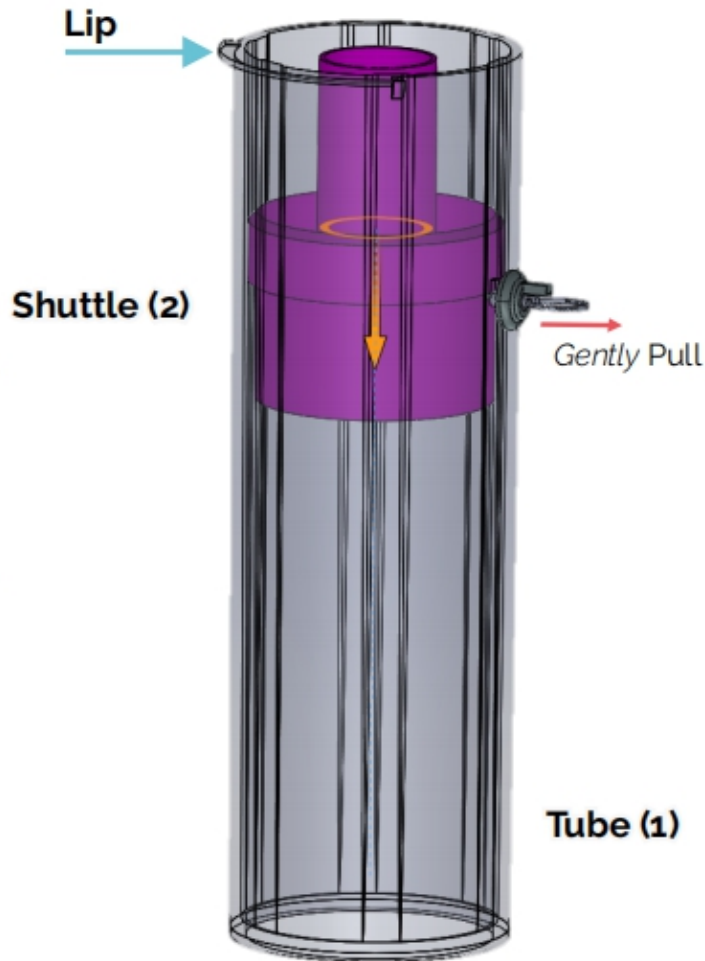

2

Insert small end of Spring into lip end of Tube.

Position Spring around stem of Shuttle.

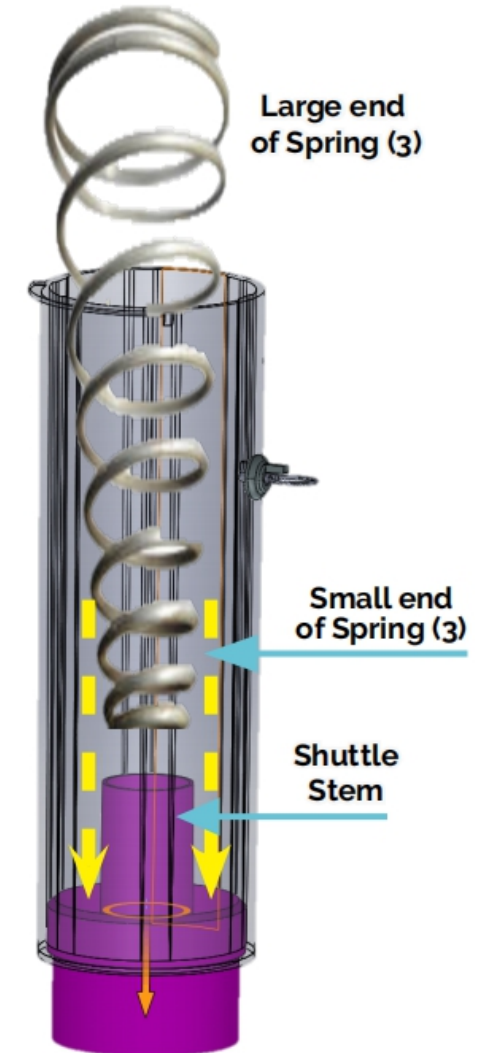

Popping Stand Assembly

Step 2 - Lock Tube to Base

1

Set Base on a flat surface.

2

Flip Tube, Spring and Shuttle upright while holding Spring in Tube.

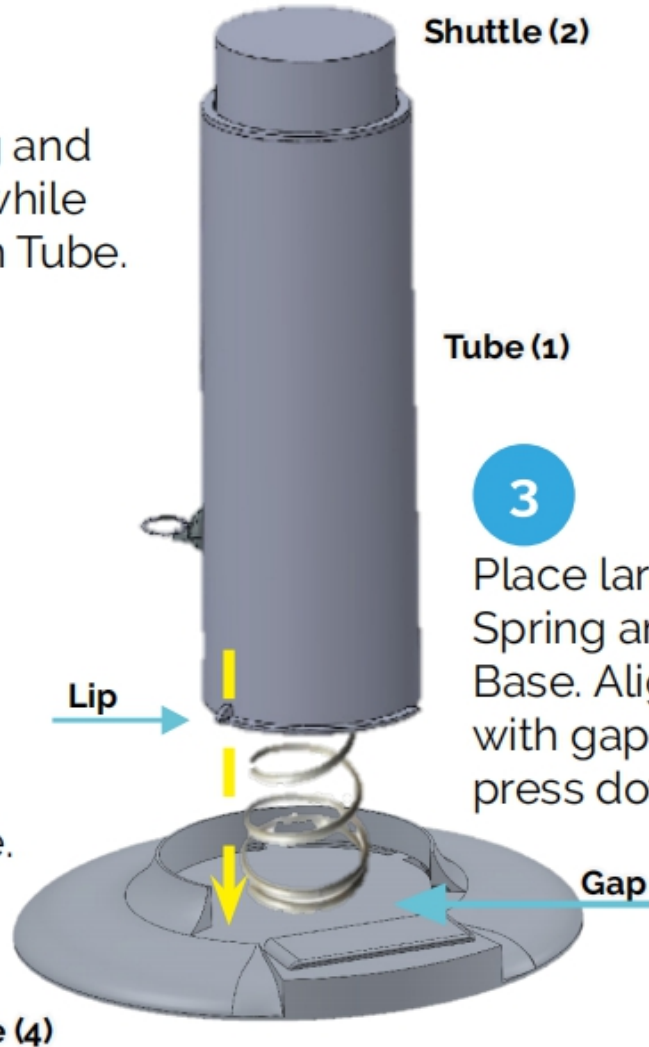

3

Place large end of Spring around ring on Base. Align lip of Tube with gap on Base and press down.

4

While pressing down, turn Tube counter-clockwise until you feel lip **lock** into Base.

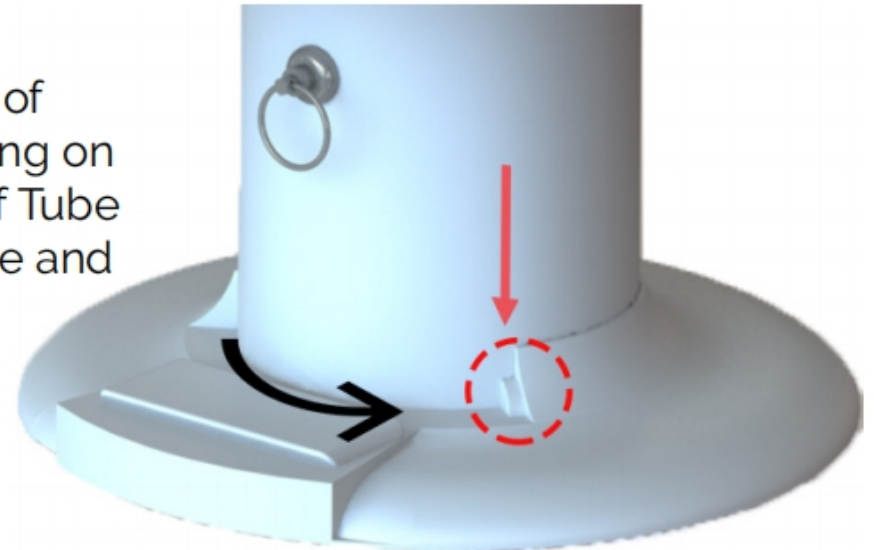

Cake Preparation Guide

1

Place your gift into Gift Pod and cover. Max. gift weight **1lb (.5kg)**.

Do not deform Gift Pod by overstuffing.

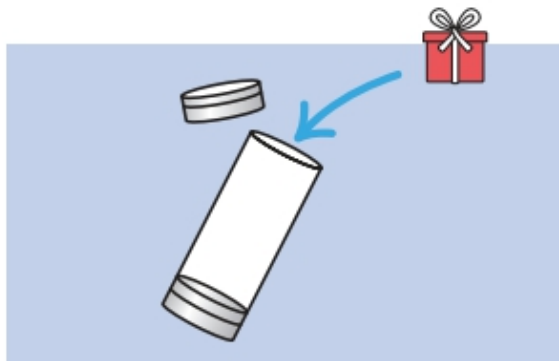

! Remove plastic wrap from Gift Pod.



2

While gently pulling Release Ring, push Gift Pod *completely* into Tube. Let go of Release Ring to lock Gift Pod in Tube.

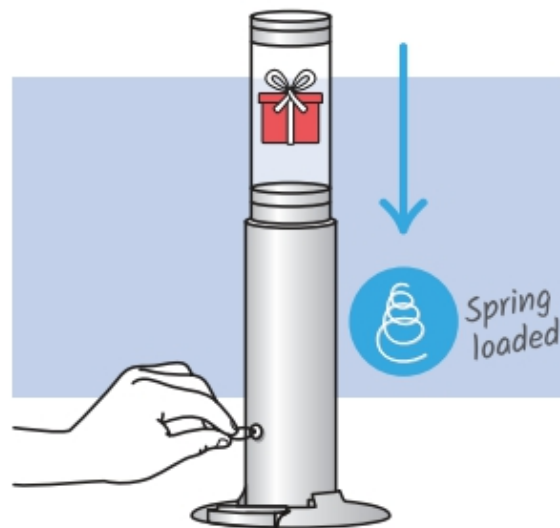

3

Position cake onto center of Surprise Plate.

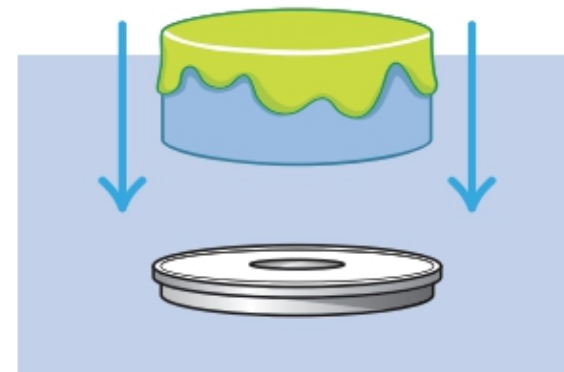

- ✓ Cake may be store-bought or homemade
- ✓ Max. cake dimensions:
Diameter: 10.25" (26 cm)
Height: 6" (15.24 cm)

Cake Preparation Guide

4

Use Cake Corer to remove cake center.

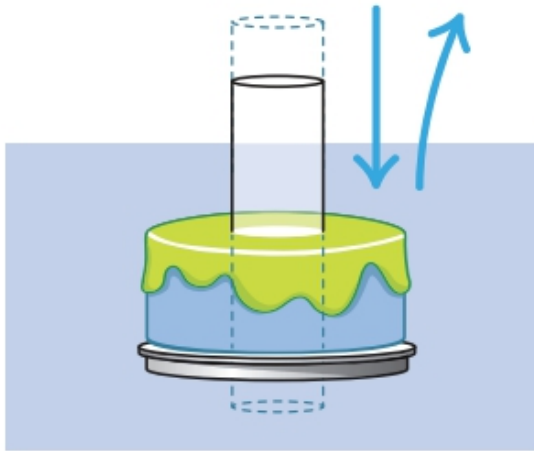

😊 Keep cake center for a mini-cake!

5

Place Surprise Plate with cored cake onto Tube. Level top of cake with top of Tube. Tighten Thumb Screws under Surprise Plate.

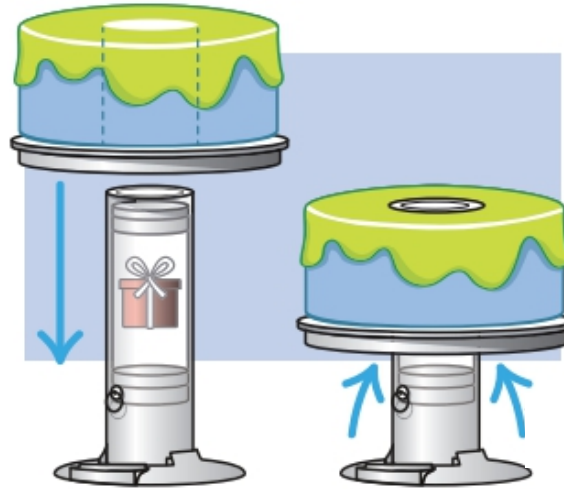

6

Lightly cover cake center with skim coat of frosting [1/4 inch (6mm) or less], sprinkles, or other lightweight toppings or decoration.



- Do NOT cover center with fondant. Gift Pod will NOT break through.
- Cake should be at or close to **room temperature** before trigger is activated. Gift Pod cannot break through cold or frozen frosting/cake.
- Do not use sanding sugar or any other small objects to cover center. These may jam Gift Pod.
- Stand should not be used as a turntable. Rotating stand may cause it to malfunction.