

Lansinoh®

SMARTPUMP 2.0

Double Electric Breast Pump



INSTRUCTIONS FOR USE

Indication for Use

The Lansinoh® Smartpump 2.0 Double Electric Breast Pump is intended to express and collect the breastmilk of a breastfeeding woman for the purpose of feeding collected breastmilk to their baby. The Smartpump 2.0 is intended for a single user.

Important Safeguards

Read All Instructions Before Using

Before first use, sterilise all parts that will come into contact with milk according to instruction on pg 10, section 3.1. Before each use, visually inspect the individual components for cracks, chips, tears, discolouration or deterioration. In the event that damage to the device is observed, please discontinue use until the parts have been replaced.

Danger To reduce the risk of electrocution:

- Always unplug this product immediately after using.
- Do not use while bathing.
- Do not place or store this product where it can fall or be pulled into a bath or sink.
- Do not place or drop pump into water or other liquid.
- Do not reach for an electrical product that has fallen into water. Unplug immediately.

Warning:

The Lansinoh® Smartpump 2.0 Double Electric Breast Pump is a personal care item. To prevent cross contamination/infection, the Smartpump 2.0 tubing and breastmilk expression set should never be shared between mothers or re-sold from one mother to another. Each user should use her own Smartpump 2.0.

If you are a mother who is infected with Hepatitis B, Hepatitis C or Human Immunodeficiency Virus (HIV), pumping breastmilk using the Lansinoh® Smartpump 2.0 Double Electric Breast Pump will not reduce or remove the risk of transmitting the virus to your baby through your breastmilk.

When using electrical products, especially when children are present, basic safety precautions should always be maintained.

To reduce the risk of burns, electrocution, fire, or injury to persons:

- This product should never be left unattended when plugged in.
- Close supervision is necessary when this product is used near children.
- Use this product only for its intended use as described in this manual. Do not use attachments not recommended by the manufacturer.
- Repairs must be performed only by an authorised service agency. Do not repair yourself! No modifications to the device are permitted.
- Never operate this product if it has a damaged cord or plug, if it is not working properly, if it has been dropped or damaged, or dropped into water.
- Keep the cord away from heated surfaces.
- Never use while sleeping or drowsy.
- Never drop or insert any object into any opening or tubing.
- Do not use this product if it is broken or any parts are missing.
- Do not allow small children or pets to play with the pump unit, AC adapter, etc.
- Do not use outdoors with the AC adapter or operate where aerosol spray products are being used or where oxygen is being administered.

Caution:

If you feel pain in your breast or nipple during operation, turn the pump off or slide a finger between the cushion and your breast to immediately break the suction. If irritation or discomfort occurs, discontinue use and see a doctor.

Save These Instructions along with your receipt for future reference.

Congratulations!

Your decision to provide your baby with breastmilk, even if you need to be apart, is one of the most precious gifts you can give your baby. The Lansinoh® Smartpump 2.0 is a safe, efficient, and effective choice for mums who need to pump regularly.

Contents Page

1. Quick Start Guide	5-6
2. Pump Diagram	7-9
2.1 Basic Controls, Display and Features	
2.2 Lansinoh® Smartpump 2.0 Breast Pump Parts	
3. Cleaning Instructions	10-11
3.1 Before First Use	
3.2 Cleaning and Sterilisation After Each Use	
3.3 Before Each Use	
4. Assembly	12-14
4.1 Assembling the Breastmilk Expression Set	
4.2 Connecting the Breastmilk Expression Set	
4.3 Connecting for Single Pumping	
5. Using the Lansinoh® Smartpump 2.0	15-18
5.1 Power Options	
5.2 Getting Started	
5.3 2-Phase Technology with Automatic Memory Function	
5.4 Customisation for Comfort and Efficiency	
5.5 Completing your Pumping Session	
6. Pumping Tips	19
7. Troubleshooting	20
8. Breastmilk Storage Guidelines	21
9. Lansinoh® Bottle With NaturalWave™ Teat	22
10. Technical Data	23
11. Warranty	24-27

PLEASE DO NOT RETURN THIS PUMP TO THE RETAILER.

Lansinoh's dedicated Customer Service team is here to help.

If you experience any issues with your Lansinoh® Smartpump 2.0 breast pump please call **0113 259 1425** or email **customerservice@lansinoh.co.uk**, Monday - Friday 10am - 3pm EST.

1. QUICK START GUIDE

Do NOT wash or sterilise tubing

Before first use, sterilise all parts that will come into contact with milk according to instruction on pg 10, section 3.1.

Please carefully read all instructions prior to use

Assembly

See detailed instruction on pgs 12-14. Proper assembly is essential to ensure proper function and suction.

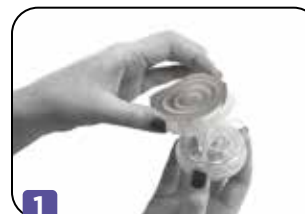

1
Insert purple diaphragm with arrows pointing forward



2
Attach clear cover and twist so tubing connector faces back



3
Attach cushion



4
Insert valve



5
Attach bottle



6
Attach tubing

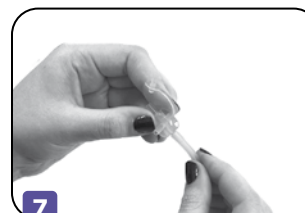

7
Secure Y connector

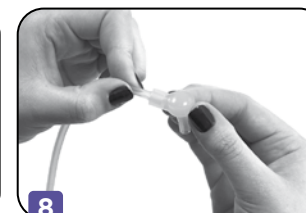

8
Secure pump connector



9
Attach to pump base

Connect pump to power using AC Adapter or six AA Alkaline Batteries (not included)

Getting Started

Hold breastmilk expression set to your breasts so that the nipple is aligned to extend straight toward the nipple tunnel of the breast cushion, ensuring there are no gaps for air to enter. Make sure set is tilted slightly downward to allow milk to flow into bottles.

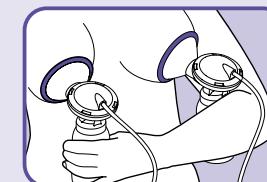

2-Phase Technology Using Let-Down and Expression Phases

Press the power button  to start the pump in let-down phase. 

Let-down phase will run automatically for two minutes.

To begin expression phase sooner, press the let-down/expression toggle button  to move to the expression phase. Press the let-down/expression toggle button again at any point to switch back to let-down phase.

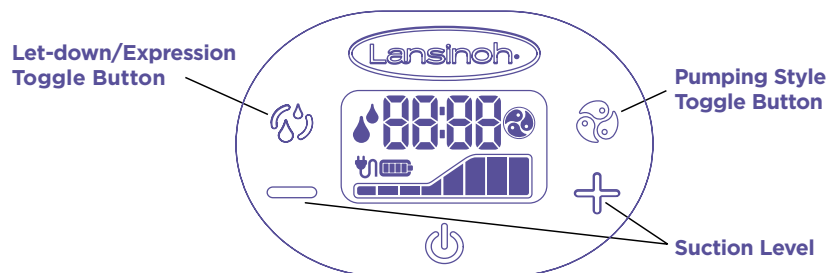

Customisation for Comfort and Efficiency



Pumping Style Selection

Every baby feeds differently. The Smartpump 2.0 offers three different pumping styles to choose from, allowing you to choose the option that is most like your baby's feeding pattern. Change the pumping style using the style mode toggle button  to find the pumping style that works best for you.



NOTE: When you turn the pump on for the very first time it starts in let-down mode, suction level 5. When you switch to the expression mode the pump will start in style 2, suction level 3.

Adjusting Suction Levels

Increase or decrease the suction to the maximum level that you find comfortable. Increase suction by pressing the  button. Decrease suction by pressing the  button.

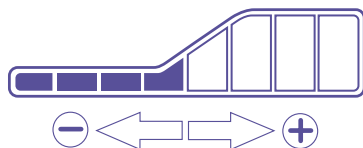







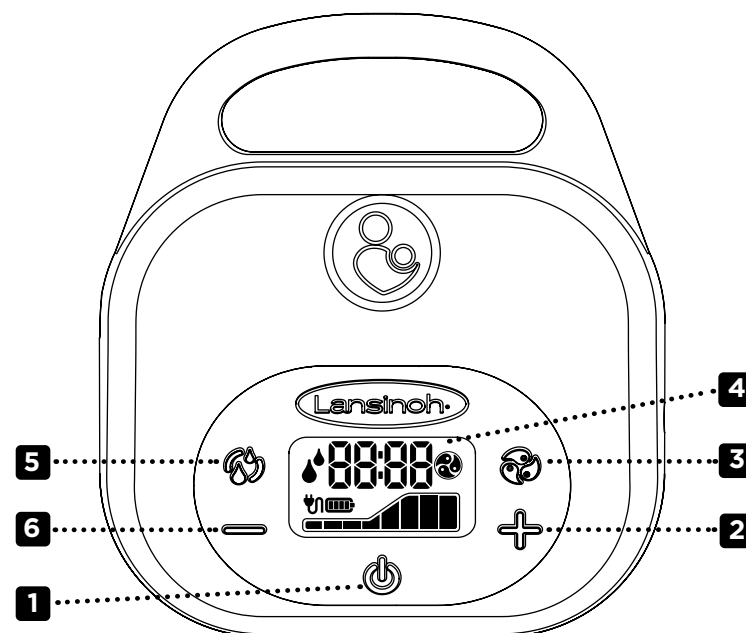

NOTE: When increasing suction, the target suction level will flash, and the pump will slowly increase suction. The flashing will stop once the target level has been reached.

Lansinoh® is here to support you. If you have questions, please do not hesitate to **contact us at 0113 259 1425.**

2. PUMP DIAGRAM

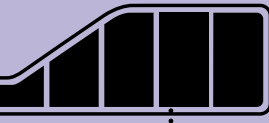

2.1 Basic Controls, Display and Features

- | | |
|--|--|
| 1. Power, On/Off button  | 7. Let-Down/Expression Phase Indicator  |
| 2. Suction Level Increase Control Button  | 8. Time Display |
| 3. Pumping Style Toggle Button  | 9. Pumping Style Indicator  |
| 4. LCD Display | 10. AC Power Indicator  |
| 5. Let-Down/Expression Toggle Button  | 11. Battery Power Indicator  |
| 6. Suction Level Decrease Control Button  | 12. Suction Level Indicator  |

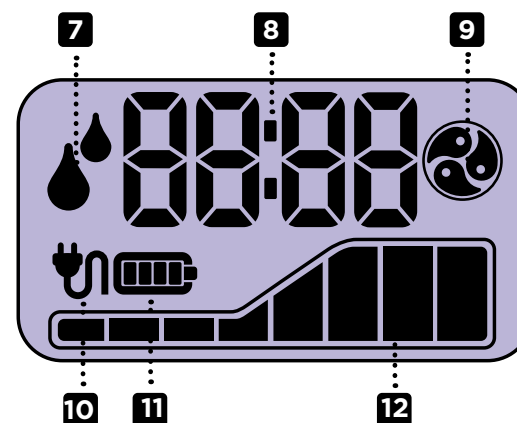

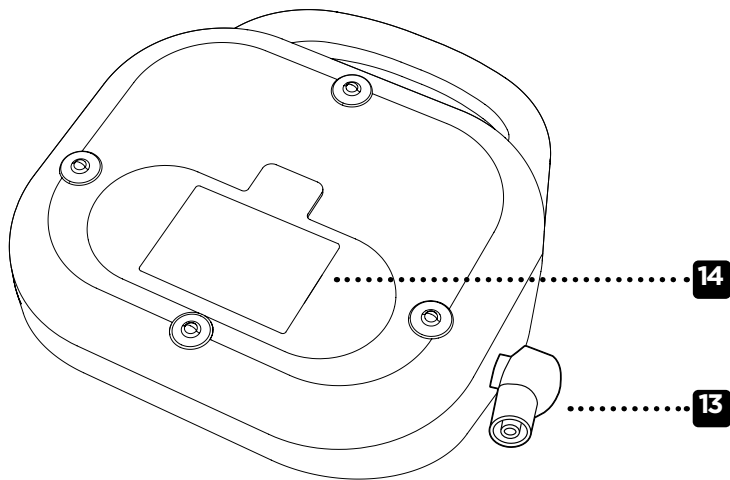

13. Tubing input

14. Battery compartment for 6 AA batteries (not included)

15. AC adapter input

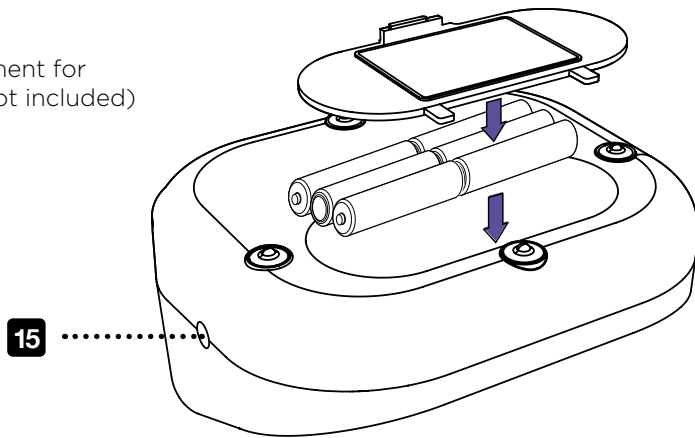

AA Battery Compartment
(underneath pump)

AC Adapter

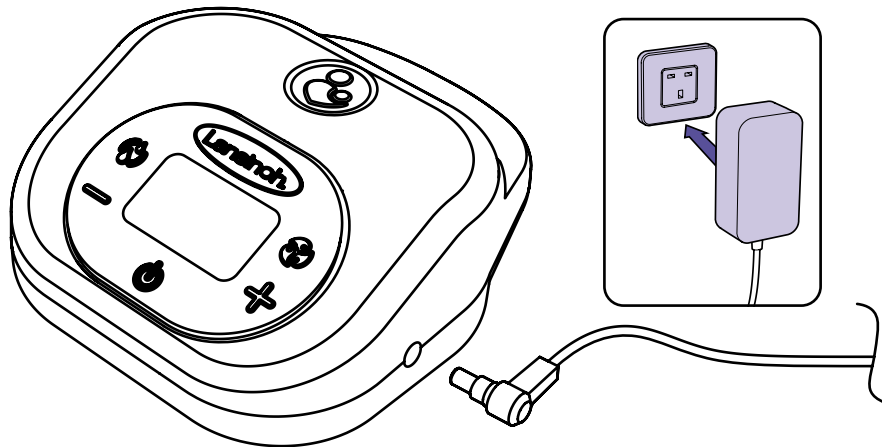

2.2 Lansinoh® Smartpump 2.0 Breast Pump Parts

Item	Item Number
A. Smartpump 2.0 Tubing	#53403
A1 Silicone Tubes 300mm (2)	
A2 Silicone Tube 600mm	
A3 Smartpump 2.0 Tubing Y Connector.....	#53405
A4 Smartpump 2.0 Pump Connector	#53453
B. Breastmilk Expression Set Includes:	
B1 ComfortFit™ Breast Cushion 25mm (2)	#53408
B2 ComfortFit™ Breast Cushion 30.5mm (2)	#50419
B3 Smartpump 2.0 Breast Cushion Body (2)	#53454
B4 Smartpump 2.0 Diaphragm (2)	#53402
B5 Smartpump 2.0 Diaphragm Cap (2)	#53410
B6 White Valve (2 + 2 extra)	#53401
B7 5oz (160ml) Bottle (2).....	#53451
B8 NaturalWave™ Slow Flow Teat (1)	#75900
C. Storage Lids (2).....	#53461
D. Smartpump 2.0 AC Adapter/power cord	#53470
E. Wide Neck Bottle Holder (2)	#53452

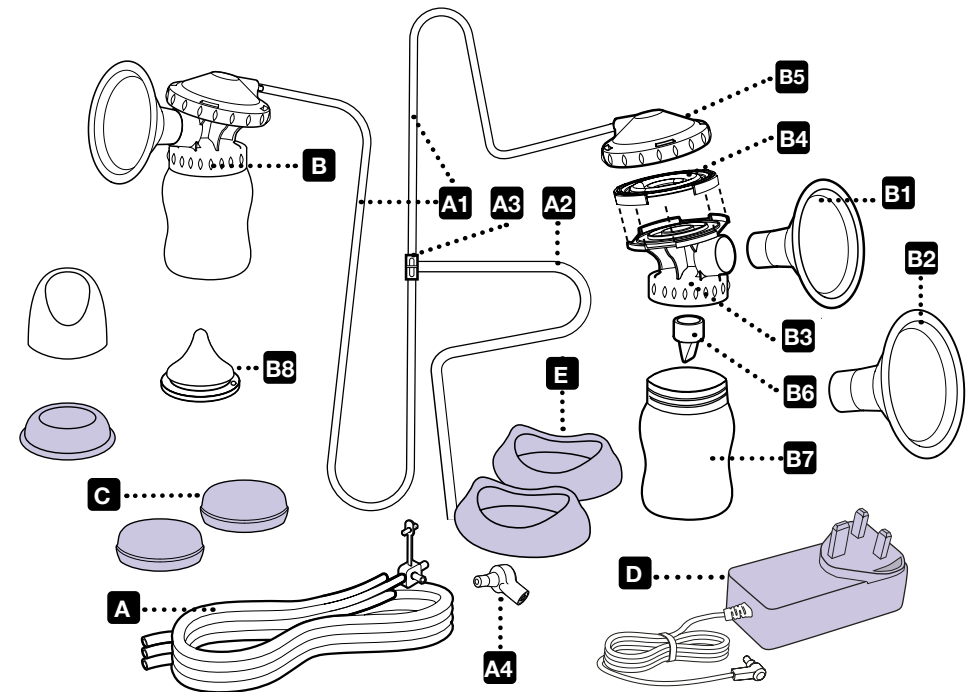

Two extra white valves are included.
To order replacement parts please visit lansinoh.co.uk/parts

WARNING: To prevent cross contamination/infection, the Smartpump 2.0 tubing and breastmilk expression set should never be shared between mothers or re-sold from one mother to another. Each user should use her own Smartpump 2.0 tubing and breastmilk expression set.

3. CLEANING INSTRUCTIONS

Unless otherwise instructed by your healthcare provider, follow these sterilising and cleaning instructions.

WARNING: To prevent cross contamination/infection, the Smartpump 2.0 tubing and breastmilk expression set should never be shared between mothers or re-sold from one mother to another. Each user should use her own Smartpump 2.0.

Do not boil or wash tubing or connectors!

When sterilising parts, use enough water to keep parts afloat!

3.1 Before First Use

1. Always wash and dry hands thoroughly with soap and water before handling the breastmilk expression set.
2. Disassemble the breastmilk expression set and place parts in a large pot.
3. Cover the parts in water making sure there is room for all of the parts to float freely in the pot.
4. Bring the water to a boil and allow the parts to boil for 5 minutes.
5. After boiling remove the parts from the pot with tongs and place on a clean towel to dry, covering the parts with a second towel.
6. Allow the parts to dry completely before assembly and use. Partially dried parts may affect the operation of the pump.
7. Once parts are dry they can be stored in a clean plastic container with a lid or in a clean plastic sealed bag.

3.2 Cleaning after Each Use

1. Disassemble the breastmilk expression set, setting aside the tubing and connectors.
2. Rinse all parts with cold water immediately after each use. Place pump parts in a clean washing up bowl used only for washing infant feeding equipment. Do not place pump parts directly in the sink, because germs in sinks or drains could contaminate the pump.
3. Hand wash all parts of the breastmilk expression set using warm soapy water. A bottle brush may be used to scrub the hard plastic pieces of the breastmilk expression set, but should not be used on the soft silicone valve or diaphragm.
4. Rinse parts with running clean, warm water, or by submerging in fresh water in a separate basin that is used only for cleaning infant feeding items.
5. Place pump parts on a clean, unused tea towel or paper towel in an area protected from dirt and dust. Do not use a tea towel to rub or pat items dry. Allow the parts to dry completely before assembly and use. Partially dried parts may affect the operation of the pump.

6. Once parts are dry they can be stored in a clean plastic container with a lid or in a clean plastic sealed bag.
7. Clean washing up bowl and bottle brush. Rinse them well and allow them to air-dry after each use. Wash them by hand or in a dishwasher at least every few days.

For daily sterilisation:

1. Place clean parts in a pot and cover with water making sure there is room for all of the parts to float freely in the pot.
2. Bring the water to a boil and allow the parts to boil for 5 minutes.
3. After boiling remove the parts from the pot with tongs and place on a clean towel to dry, covering the parts with a second clean towel. Place washing up bowl and bottle brush on a clean, unused tea towel or paper towel in an area protected from dirt and dust. Do not use a tea towel to rub or pat items dry because doing so may transfer germs to the items.
4. Allow the parts to dry completely before assembly and use. Partially dried parts may affect the operation of the pump.

3.3 Before Each Use

1. Always wash and dry hands thoroughly with soap and water before handling the breastmilk expression set.
2. Before assembling the breastmilk expression set, be sure that all of the parts are completely dry.
3. Visually inspect the individual components for cracks, chips, tears, discolouration or deterioration. These may affect the functionality of the pump.
4. Inspect the tubing. If you find condensation in the air tube, wash and dry it immediately or replace the tubing. If you see breastmilk inside the tubing or tubing connectors do not attempt to wash, clean or sterilise the tubing or tubing connectors. Instead contact the manufacturer.
5. Should you have any questions or concerns about your parts please contact Lansinoh® at **0113 259 1425** for further guidance.
6. To purchase replacement parts for your pump please visit lansinoh.co.uk/parts

4. ASSEMBLY

4.1 Assembling the Breastmilk Expression Set

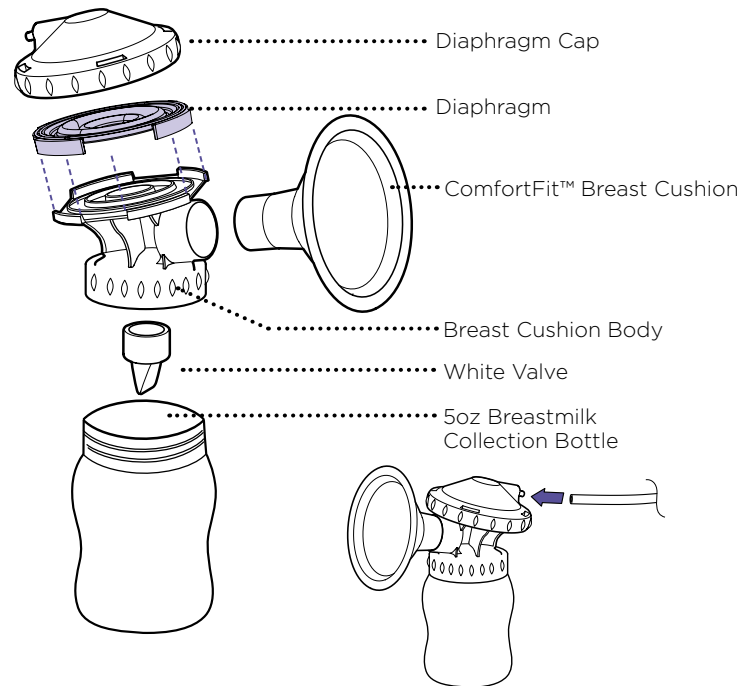

1. Place purple silicone diaphragm, arrow side up, on top of breast cushion body. Ensure diaphragm fits securely between rims of breast cushion body and arrows point toward breast cushion.



2. Place clear diaphragm cap over breast cushion body and twist to secure so that the tubing portal is facing the back of the pump.

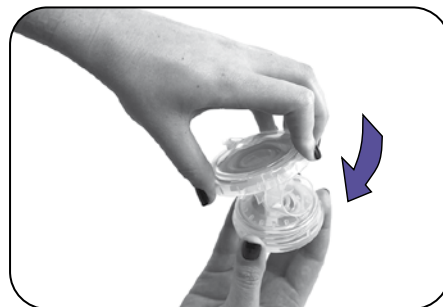

3. Firmly push ComfortFit™ Cushion into breast cushion body.



4. Holding the base of the white valve, gently secure the valve into the bottom of the breast cushion body.

NOTE: Use care when handling and cleaning the small white valve.



5. Screw collection bottle onto breast cushion body.



6. Attach end of 300mm tubing to back of diaphragm cap. Ensure that tubing is pushed all the way to the base of the attachment port and completely covers it.



7. Attach other end of 300mm tubing to tubing Y connector.



8. Repeat assembly process for second breast cushion body.

4.2 Connecting the Breastmilk Expression Set

Once Breastmilk Expression Set is assembled, connect to pump base:

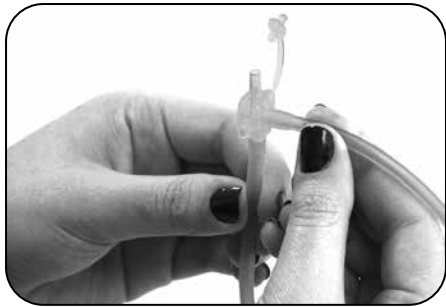

1. Secure one end of 600mm tubing to tubing Y connector.



2. Secure other end of 600mm tubing firmly to the pump connector.



3. Insert pump connector into opening on left side of pump.

4.3 Connecting for Single Pumping



1. Remove one of the 300mm tubing from the tubing Y connector.



2. Secure plug into open outlet of tubing Y connector.

5. USING THE LANSINOH® SMARTPUMP 2.0 DOUBLE ELECTRIC BREAST PUMP

5.1 Power Options

The pump may be operated using the following power supply modes:

AC Adapter

1. Connect the AC adapter to the power receptacle located on the right side of the pump. Plug the AC adapter into an available electrical outlet.
2. Electrical safety can only be achieved when the breast pump is connected to the AC power adapter supplied with the product. (See "Technical Data" section, page 23)

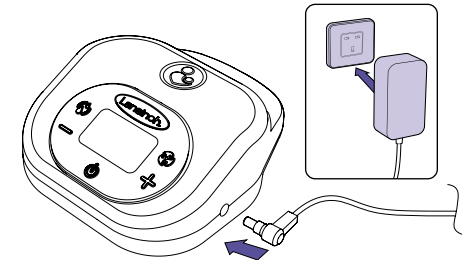

AA Alkaline Batteries (not included)

1. Make sure the batteries are inserted correctly according to the polarity (+) and (-) as indicated.
2. Close the compartment by gently pressing the cover until it snaps into place.
 - Remove batteries if pump is not in use for a long period of time.
 - Dispose of batteries according to regulations for environmental protection and recycling.
 - Replace batteries as a simultaneous set. Do not mix old and new batteries.
 - Do not mix alkaline and standard (carbon-zinc) batteries.
 - If batteries are in the pump, but AC adapter is in use, the pump will use the adapter to power the pump, not the batteries.

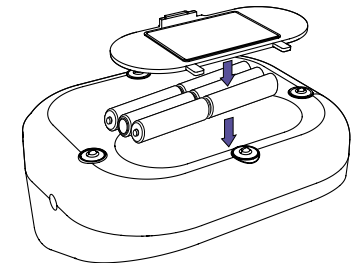

For the most economical use, we recommend using your pump with the AC adapter provided. Your AC adapter is a universal AC plug adapter type and can be used with 100 Vac to 240 Vac systems with 50Hz and 60Hz mains.

5.2 Getting Started

If possible, wait until your breastmilk supply and breastfeeding are well established. This is normally at least 4-6 weeks after birth, unless otherwise advised by your healthcare provider.

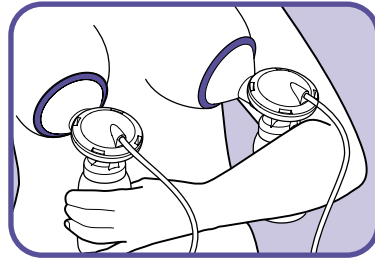

1. Hold the breastmilk expression set to your breasts so that the nipple is aligned to extend straight toward the nipple tunnel of the breast cushion.
2. Make sure the breast completely fills the breast cushion so that a vacuum is formed and no air escapes.
3. The breastmilk expression set and nipple tunnel should tilt slightly downward to allow milk to flow naturally toward the bottle.

If you experience friction or discomfort on your nipples, you may need a different size cushion. Larger size cushions are available. For more details, please call 0113 259 1425 or visit lansinoh.co.uk

5.3 2-Phase Technology with Automatic Memory Function

Using Let-Down and Expression Phases

1. Press and hold the on/off button to turn the pump on. The Lansinoh® Smartpump 2.0 will always start in the let-down phase.
NOTE: When you turn the pump on for the very first time it starts in let-down phase, suction level 5.
2. After two minutes, the let-down phase will automatically change to the expression phase.
NOTE: When you switch to the expression mode for the very first time the pump will start in pumping style 2, suction level 3.
3. If you prefer to bypass the pre-set two minute let-down phase or your milk lets down sooner than two minutes, press the let-down/expression toggle button to move to the expression phase.
4. Automatic memory function will save the last pumping style and suction level for each phase. However, the suction level will gradually build to the last used setting for a more comfortable pumping experience.



The style mode indicator will appear in the display to signify that you are in the expression phase.

5.4 Customisation for Comfort and Efficiency

Using Customisable Pumping Styles

Choose Your Pumping Style

Each baby is unique – right down to the way he or she feeds. The Lansinoh® Smartpump 2.0 offers three different pumping styles to choose from – so you can select the one that most closely matches your baby's feeding pattern.

	Pumping Style 1	
	Pumping Style 2	
	Pumping Style 3	



1. With the pump in expression mode, select the pumping style that is most comfortable and efficient for you by pressing the pumping style toggle button .
2. Pressing the button again will select the next pumping style.
NOTE: The pumping style toggle button only functions when the pump is in expression mode.
3. The mode will be indicated on the LCD display by the pumping style mode indicator.

As your baby grows, you may find that their feeding pattern changes. The customisation features of the Smartpump 2.0 allow you to make adjustments so you're always getting the best results.

5.4 Customisation for Comfort and Efficiency (cont.)

Tailor for comfort

Within each pumping style, there are eight levels of suction to choose from:

1. Adjust for stronger suction by pressing the suction level increase control button. 
Whenever the pump is switching to higher suction levels (within a mode or when switching modes) the targeted level will flash. The pump will slowly transition to the higher suction level. The flashing will stop once the target level is reached.
2. Adjust for lower suction by pressing the suction level decrease control button. 
3. The current suction level will be indicated by the number of dark bars on suction level indicator.

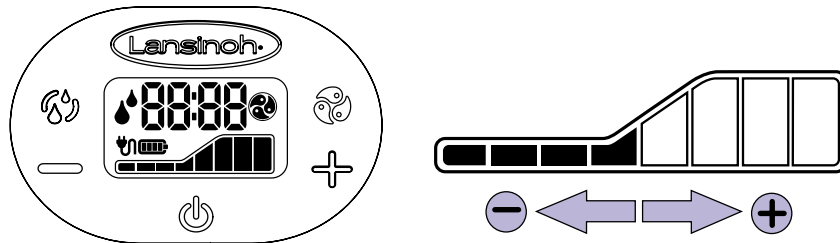

NOTE: If at any time the suction on your breast reaches uncomfortable levels, reduce the suction level by pressing the  button on the left side of the LCD screen or disconnect the tubing from its receptacle on the electric pump.

5.5 Completing Your Pumping Session

1. When a pumping session is finished, turn the pump off with the on/off button. 
2. After turning the pump off, the display will remain on for a few seconds.
3. Make sure there is no suction on the nipple(s) before removing the breast cushion from the breast. If necessary, break the suction by inserting a finger between the breast cushion and the breast. Once the suction is broken, the cushion can be removed safely.

PLEASE NOTE: The LCD display light will automatically switch off if no control buttons are pressed for 20 seconds in order to save power. If the pump unit is left on and unattended for more than 60 minutes, the control system will automatically power off. To turn unit back on, hold the power-on button for several seconds.

6. PUMPING TIPS

Pumping Tips

The most important part of successful pumping is the ability to trigger the let-down reflex. This is when your milk begins to flow freely. Warm, wet compresses applied to the breasts and gentle, circular massaging of the breasts prior to and/or during a pumping session can help encourage this natural reflex. Thinking of or looking at your baby, or a photo of your baby if you are apart, can also be helpful. Some mums can achieve more than one let-down during a pumping session. You may be able to achieve a second by returning to the let-down phase by pressing the Let-down/Expression Toggle Button.

How Long To Pump

Double pumping, compared to single pumping, will reduce the time you spend expressing your milk. Breastmilk is produced on a supply and demand basis. Expressing your breastmilk regularly will stimulate your body and help you maintain your milk supply. Just like with breastfeeding, it is not necessary to time your pumping sessions. As you get more experienced with pumping, you will get a better sense of the time it takes for your body to express your milk using a breast pump. If you have any breastfeeding or breast pump related questions, consult with your healthcare professional.

Pumping and Feeding Tips

- You may pump one breast while nursing the baby on the other. This allows you to maximise pumping effectiveness using the let-down reflex stimulated by your baby's sucking.
- Always test the temperature of any liquid before feeding your baby.
- Do not let a child take a bottle to bed or self-feed for long periods.
- To prevent possible choking hazard, test strength of the feeding bottle teat by pulling on the bulb portion. Discontinue use if any tear or crack appears.

7. TROUBLESHOOTING

Troubleshooting the Lansinoh® Smartpump 2.0 Double Electric Breast Pump

Interruption of Electrical Service

The Smartpump 2.0 will shut off during a pumping session if the power source is changed while pumping.

This includes unplugging the power adapter or inserting the power adapter while pumping using batteries.

This safety feature is designed to prevent sudden changes in suction levels. If you lose power during a pumping session because you switched power sources mid-pumping session, simply press down on the power button to turn the pump back on.

If you experience an interruption in the normal operation of the electrical and/or mechanical function of the pump, simply do the following:

- Verify the power cord is still plugged in to the pump or the wall. If using batteries, verify all six batteries are fully inserted and none have come loose.
- If either the power cord or batteries became disconnected, fix the connection, and then press and hold the power button for two seconds to turn the pump back on.
- If the pump is shutting off and the adapter or batteries were firmly in place when this occurred, please Lansinoh Customer Service at **0113 259 1425** or email customerservice@lansinoh.co.uk.

Discomfort While Pumping

If you feel any discomfort, you may need a different size cushion. Visit lansinoh.co.uk/parts or call **0113 259 1425**.

Decreased Suction

If it feels like the suction has decreased, try the following:

- Remove the tubing from pump and place a finger over the tubing connector.
- If you feel suction, the pump is operating properly, but the breastmilk expression set may not be correctly assembled or the white valve may be damaged.
- Make sure the breastmilk expression set has been properly assembled. Check the assembly information in the section “Assembling the Breastmilk Expression Set,” page 12-14.
- Inspect the white valve for a tear or pinhole. This component is critical to achieving proper suction. Replace the white valve with one of the spare valves provided with the product.

- If no suction is felt on your finger, try unplugging the adapter from the electrical outlet, wait a few seconds, and plug it back into the electrical outlet.
- When single pumping, check the tubing connector on the front of the pump to make sure it is closed for single pumping. If open, close the connector.
- If double pumping, ensure that the breastmilk expression set is securely connected on both breasts before starting the pump.

Increased Suction Level for Single Pumping

If it feels like the suction is higher than usual when single pumping, check that the plug for the pipe is clean and that the airway in the plug is not blocked.

8. BREASTMILK STORAGE GUIDELINES

Breastmilk Storage and Thawing Guidelines for Healthy Term Babies

Check with your healthcare professional or an International Board Certified Lactation Consultant for specific storage instructions. When freezing breastmilk, store in the back of the freezer. Do not store breastmilk in the freezer door as the temperature can fluctuate when the door is opened and closed. Before storing, date all breastmilk and use the oldest breastmilk first.

Milk Storage Guidelines, Full term infant

WHERE	TEMPERATURE	TIME	ACTION
At Room Temperature	60-85°F (16°-29°C)	4 hours (ideal) up to 6 hours (acceptable)	Contents should be covered and kept as cool as possible; covering the container with a damp towel may keep milk cooler
Insulated Cooler Bag	5-39°F (-15° to 4°C)	24 hours	Keep ice packs in constant contact with milk containers; limit opening cooler bag
In a Refrigerator	39°F (4°C)	4 days (ideal) up to 5 days (acceptable)	Store milk in the back of the main body of the refrigerator
Freezer (compartment of refrigerator with separate doors)	0°F (-18°C)	3 months (ideal) up to 6 months (acceptable)	Store milk away from sides and toward the back of the freezer where temperature is most constant
Deep Freezer	-4°F (-20°C)	6 months (ideal) up to 12 months (acceptable)	

Source: *La Leche League International 2017*

These breastmilk storage guidelines are a recommendation. Contact your health professional or consult your country’s national guidelines for further information.

Thawing

Thaw frozen milk in the refrigerator or place the containers under cool running water, gradually warming the water until the milk is thawed. Thawed milk can be kept in a refrigerator for up to 24 hours.

NOTE: DO NOT refreeze milk once it is thawed.

Breastmilk is not homogenised and you may notice that it separates as it sits. Gently swirl thawed milk before feeding to baby to mix the layers that have separated. Breastmilk can vary in colour and consistency depending upon the time of the day that the milk was expressed, what you have eaten, and the age of the baby at the time of pumping. For further advice, please contact your healthcare professional.

NOTE: DO NOT MICROWAVE BREASTMILK! Microwaving alters the composition of the milk. Microwaving also may create “hot spots” in the milk that could burn the infant.

NOTE: DO NOT thaw breastmilk in hot or boiling water.

9. LANSINOH® BOTTLE WITH NATURALWAVE™ TEAT

Clinically Proven to Reduce Nipple Confusion in Breastfed Babies

The patented NaturalWave™ Teat enables baby to replicate natural sucking actions learned at the breast.

Exclusive breastfeeding is recommended for at least 4-6 weeks if possible before introducing a bottle and teat.

Storage & Use

Prior to use, always inspect and pull the teat in all directions to check the product. Throw away at the first signs of damage or weakness. For safety and hygiene reasons, replace the teat every 7 weeks.

Cleaning

Before first use, boil all parts for 5 minutes to sanitise. Ensure all parts are completely covered in water and free floating. Always wash all components of the product immediately after each use. The teat can be washed in hot soapy water and rinsed in clean water. Dishwasher safe on top rack only. Do not clean with solvents or harsh chemicals.

Assembly

Once thoroughly dry, insert teat through the top of the screw cap collar. Attach the screw cap collar securely onto the bottle neck. When carrying a full bottle, make sure it is closed with the collar in place, taking care to position the teat in the center of the collar to activate the “spill-proof” function of the product.



Latching on
Baby's lips open outward and latch onto the areola



Peristaltic “wave-like” tongue movement
Baby's tongue moves in “wave-like” motion to compress nipple and extract milk



Swallowing
Back of baby's tongue rises, channeling the milk into the esophagus

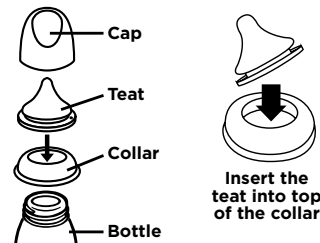

Precautions

Do not leave bottle in direct sunlight, heat or disinfectant (sterilising solution), as this may weaken the teat. Do not clean with or allow teat to come into contact with solvents or harsh chemicals. Damage could result. Fill with the required amount of liquid and tighten the screw cap before using. Do NOT overfill. Heating in a microwave is NOT recommended as it may produce uneven heating and high localised temperatures. If you choose to heat liquid this way, DO NOT SEAL BOTTLES. Swirl well before use, and always check the temperature before feeding baby. Hot or unevenly heated liquid may burn baby's mouth. Do not warm liquid by placing the bottle directly onto gas or electric rings, warming plates, in electric ovens, etc. Wash after every use. Some liquids and sterile solutions may make the silicone turn opaque. This does not alter any of its properties.

WARNING!

DO NOT MICROWAVE BREASTMILK! Microwaving alters the composition of the milk and may also create “hotspots” in the milk that could burn the infant. Allowing your child to use this product for prolonged periods separate from regular mealtimes or to go to sleep while drinking liquids, other than water, from this bottle may cause or contribute to early childhood tooth decay. Always use this product with adult supervision. Keep all components not in use out of the reach of children. Do not leave baby alone with drinking equipment due to the risk of choking. Never use teat as a soother. Always check liquid temperatures before feeding.

10. TECHNICAL DATA

1. Power Supply

Battery operation: 6 AA size alkaline batteries, all connected in series

Operating time: Minimum 30 minutes. Maximum 2 hours. Results are dependent on battery freshness and pump settings.

AC Adapter operation: 100-240 Vac wall plug type AC adapter, galvanically isolated with 9Vdc output voltage

Pump power dissipation: 10.0 Watts maximum

Voltage regulation: Linear voltage regulator with low dropout voltage and short circuit protection

2. Control System

Control unit: Microcontroller with integral program memory

Program memory: 32K flash ROM, 2K RAM memory

HMI: LCD display with LED backlight, soft keypad

Single/double control: Single or double breast pumping possible

Selectable pumping style mode: 3 pumping style modes are selectable and controlled from keypad

Adjustable suction level: 8 suction levels are selectable and controlled from keypad

Suction vacuum level: Minimum 80 mmHg, maximum 250 mmHg

Technical Data

Bluetooth version 4.1

Range up to 10m

Power Requirements

AC Adapter (included)

100-240 VAC wall plug type

AC adapter, galvanically isolated adapter with 9Vdc output voltage.

Batteries (not included) 6 AA batteries, 1.5V alkaline

The expected use life of the pump is 500 hours.

To maintain your power adapter follow these instructions:



DO NOT use power adapter if damaged.

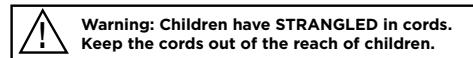

11. WARRANTY

Limited Consumer Product Warranty

While we take great care and pride in ensuring that our products are of the highest quality, we recognise that very occasionally things may go wrong.

Our guarantee covers any faults which affect the performance of the pump mechanism for 1 year and other product components of our breast pump for 90 days.

This guarantee does not apply to cosmetic, accidental damage, improper use, incorrect voltage use, everyday wear and tear, faults or damage that are a result of your misuse of the pump, and pumps which have been modified or multiple-person use.

This guarantee applies to customers in the UK. For health and hygiene reasons our breast pumps should not be re-sold, and our guarantee does not apply to any subsequent owners.

Where your breast pump develops a fault that is covered by our guarantee we will repair or replace the breast pump or the affected parts. This may mean we provide one or more replacement parts to you. We may ask you to return the pump and/or faulty components for testing or repair.

To make a claim under this guarantee, you should tell us about the fault by contacting us at lansinoh.co.uk/contact-us/. You will need to provide us with proof of purchase of the breast pump or parts. We will then notify you of next steps.

YOUR STATUTORY RIGHTS ARE NOT AFFECTED.

For more information on your rights contact your local consumer advice centre or go online.

This guarantee is provided by Lansinoh Laboratories Inc, Ground Floor, West Mayesbrook House, Lawnswood Business Park, Leeds, LS16 6QY.

SYMBOLS ON THE PACKAGING	MEANING OF THE SYMBOLS
	Follow instructions for use
	Identifies the manufacturer
	Type BF applied part
	Class II equipment
	Keep the device dry
	Keep the device away from sunlight
	Indicates the temperature limitation for operation, transport and storage.
	Indicates the humidity limitation for operation, transport and storage.
	Indicates the protection against ingress of solid foreign objects and against harmful effects due to the ingress of water
	Do not dispose of electric/electronic devices together with unsorted municipal waste

Declaration for Electromagnetic Compatibility (EMC)

For information use only

FCC Statement: This device complies with part 15 of the FCC rules. Operation is subject to the following two conditions: (1) This device may not cause harmful interference, and (2) this device must accept any interference received, including interference that may cause undesired operation.

This equipment has been tested and found to comply with the limits for a Class B digital device, pursuant to part 15 of the FCC Rules. These limits are designed to provide reasonable protection against harmful interference in a residential installation. This equipment generates, uses and can radiate radio frequency energy, and if not installed and used in accordance with the instructions, may cause harmful interference to radio communications. However, there is no guarantee that interference will not occur in a particular installation. If this equipment does cause harmful interference to radio or television reception, which can be determined by turning the equipment off and on, the user is encouraged to try to correct the interference by one or more of the following measures:

- Reorient or relocate the receiving antenna.
- Increase the separation between the equipment and receiver.
- Connect the equipment into an outlet on a circuit different from that to which the receiver is connected.
- Consult the dealer or an experienced radio/TV technician for help.

Stacking: This device should not be used adjacent to or stacked with other equipment. And if adjacent or stacked use is necessary, this device should be observed to verify normal operation in the configuration in which it will be used.

Disposal: The symbol which can be found on the product or on the package surface indicates that the product shall not be disposed with other household wastes. It is the users responsibility to properly dispose of the product, or facilitate recycling activities. For further information about the recycling collection points, please contact your local authority or Lansinoh Customer Service.

TS EN 60601-1-2 STANDARD TEST REQUIREMENTS

Immunity Test Levels for ENCLOSURE PORT

Phenomenon	Basic EMC standard or test method	IMMUNITY TEST LEVELS	
		Professional healthcare facility environment	HOME HEALTHCARE ENVIRONMENT
ELECTROSTATIC DISCHARGE	IEC 61000-4-2	± 8 kV contact ± 2 kV, ± 4 kV, ± 8 kV, ± 15 kV air	
Radiated RF EM fields ^{a)}	IEC 61000-4-3	3 V/m ^{b)} 80 MHz – 2,7 GHz ^{b)} 80 % AM at 1 kHz ^{c)}	10 V/m ^{b)} 80 MHz – 2,7 GHz ^{b)} 80 % AM at 1 kHz ^{c)}
Proximity fields from RF wireless communications equipment	IEC 61000-4-3	See 8.10	
RATED power frequency magnetic fields ^{a) e)}	IEC 61000-4-8	30 A/m ^{a)} 50 Hz or 60 Hz	

Immunity Test Level for Input A.C. Power PORT

Phenomenon	Basic EMC standard or test method	IMMUNITY TEST LEVELS	
		Professional healthcare facility environment	HOME HEALTHCARE ENVIRONMENT
Electrical fast transients/bursts ^{a) b) c) d)}	IEC 61000-4-4	± 2 kV 100 kHz repetition frequency	
Surges ^{a) b) c) d)} Line-to-line	IEC 61000-4-5	± 0,5 kV, ± 1 kV	
Surges ^{a) b) c) d) e)} Line-to-ground	IEC 61000-4-5	± 0,5 kV, ± 1 kV, ± 2 kV	
Conducted disturbances induced by RF fields ^{c) d) e)}	IEC 61000-4-6	3 V ^{m)} 0, 15 MHz - 80 MHz 6 V ^{m)} in ISM bands between 0,15 MHz and 80 MHz ⁿ⁾ 80 % AM at 1 kHz ^{e)}	3 V ^{m)} 0, 15 MHz - 80 MHz 6 V ^{m)} in ISM and amateur radio bands between 0,15 MHz and 80 MHz ⁿ⁾ 80 % AM at 1 kHz ^{e)}
Voltage dips ^{f) g) h)}	IEC 61000-4-11	0 % UT ; 0,5 cycle ^{g)} At 0°, 45°, 90°, 135°, 180°, 225°, 270° and 315° ^{h)}	
		0 % UT ; 1 cycle and 70 % UT ; 25/30 cycles ^{h)} Single phase: at 0°	
Voltage Interruptions ^{f) g) h) i)}	IEC 61000-4-11	0 % UT ; 250/300 cycles ^{h)}	

Conducted Emission Test Level

Frequency range MHz	Quasi-peak dB(µV/m)	Average dB(µV/m)
0,15 - 0,50	66 Decreasing linearly with logarithm of frequency to 56	56 Decreasing linearly with logarithm of frequency to 46
0,50 - 5	56	46
5 - 30	60	50
At the transition frequency, the more stringent limit shall apply.		

Radiated Emission Test Level

Frequency range	Quasi-peak dB(µV/m)
30 - 230	40
230 - 1 000	47

Harmonic Emission Test Level Parameters

Table 1 - Limits for Class A Equipment

Harmonic order n	Maximum permissible harmonic current A
Odd Harmonics	
3	2,30
5	1,14
7	0,77
9	0,40
11	0,33
13	0,21
$15 \leq n \leq 39$	$0,15 \frac{15}{n}$
Even Harmonics	
2	1,08
4	0,43
6	0,30
$8 \leq n \leq 40$	$0,23 \frac{8}{n}$

Flicker emission test level parameters

(Short-term Flicker) : ■ 1.00

(Relative steady-state voltage change) : ■ 3.30 %

(Maximum relative voltage change) : ■ 4.00 %

©2020 Lansinoh® Laboratories, Inc. Alexandria, VA. USA

DE53260IF0820