



User's Manual for Depository Safe DX Series

Read all instructions before using this safe.

WARNING

- For security purposes, change the factory default code as soon as possible.
First factory default code is: 168
Second factory default code is: 12345678
- Test registered pin code a few times before closing the door.
- Avoid leaving the safe door open and unattended; it will allow unauthorized individuals to reprogram the safe gaining full access to the safe and its contents.
- Store emergency keys in a secure place; NOT inside of the safe.
- Be careful when opening and closing the depository slot.
- Keep children away from safe; they should not play with or around the safe at anytime.
- Note: Barska is not responsible for any installation damages and any lost or stolen contents.

PARTS OF THE SAFE

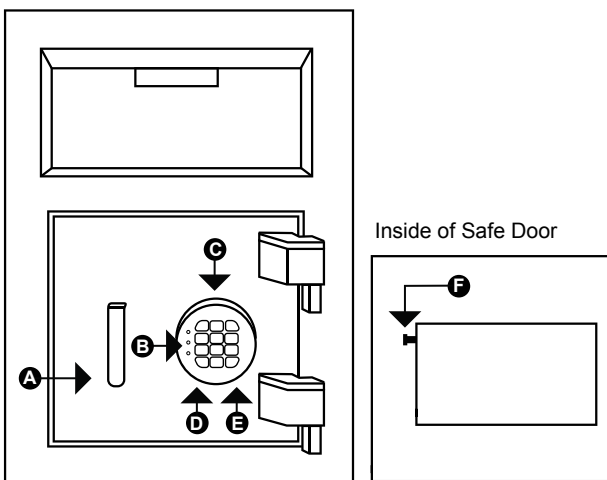

Actual model may vary

- A. Handle
- B. Indicator Lights
- C. Key Pad
- D. Battery Compartment (Located behind key pad)
- E. Emergency Key Access (Located behind key pad)
- F. Initialization Button

BATTERY & KEY ACCESS

Push down on button located under the key pad and turn keypad cover counter clockwise.

DO NOT pull on the wires or touch the electronic components.

Install Battery

Insert one new 9V alkaline battery into the battery compartment and restore keypad cover.

Key Access

Insert access key into key slot and turn clockwise to open safe.

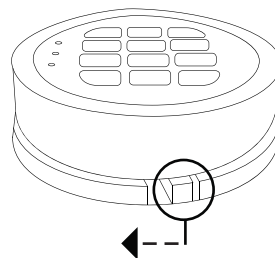

PIN CODE REGISTRATION

Safe retains 2 pin codes

- First factory default code is: 168
- Second factory default code is: 12345678

Changing First Pin Code

1. Open Safe with either Pin Code or Emergency Key.
2. Press initialization button located inside of the safe, lock will beep twice and yellow indicator light will be lit.
3. Enter desired Pin Code (1-8 Digits) then press “ * ” button. 2 short beeps will be heard and yellow indicator light will disappear.
4. Use the handle to extend the safe bolts and enter registered pin code then press “ # ” button.

If safe can be opened registration was successful, if safe doesn't open registration was unsuccessful, please follow steps in [Pin Code Registration](#) to register Pin Code.

Changing Second Pin Code

1. Open Safe with either Pin Code or Emergency Key.
2. Press “ 00 ” on the keypad, then press the initialization button located on the inside of the safe, lock will beep twice and yellow indicator light will be lit.
3. Enter second desired Pin Code (1-8 Digits) then press “ * ” button. 2 short beeps will be heard and yellow indicator light will disappear.
4. Use the handle to extend the safe bolts and enter registered pin code then press “ # ” button.

If safe can be opened registration was successful, if safe doesn't open registration was unsuccessful, please follow steps in [Pin Code Registration](#) to register Pin Code.

OPENING AND CLOSING SAFE WITH PIN CODE

Safe can only be opened with emergency keys.

Open

1. On the key pad enter in either of the registered Pin Codes and press and release “ # ” to confirm.
2. Turn the handle to the unlocked position and pull safe door open.

Close

Close the safe door and turn the handle to the locked position.

DUAL PIN CODE ACCESS

This feature will require entering both Pin Codes to access the safe.

Enabling Dual Pin Code Access

Enter “ * # 00 # ” followed by Pin Code & “ # ” button.

Disable Dual Pin Code Access

To disable Dual Pin Code Access enter “ * # 11 # ” followed by Pin Code 1 & “ # ” button, then enter Pin Code 2 & “ # ” button.

LOCK OUT MODE

- If wrong code is entered 3 times safe will be in lock out mode.

Lock Out Mode: Cannot use any functions on the safe for 15 min, please leave batteries plugged into safe and wait 15 min for insert key to unlock safe.

LOW BATTERY WARNING

If red indicator light is constantly lit while accessing and using the safe, this indicates that the batteries are low, please replace battery as soon as possible.

Note: Safe may still be opened in low battery state depending on the voltage. If safe cannot be opened please use emergency key. All registered Pin Codes remains saved.

CARE AND MAINTENANCE

- Keep liquids away from the control panel. Spills on the control panel will cause damage and possibly electric shock.
- Secure safe in a proper area to prevent from falling and causing damage or injury.
- DO NOT disassemble the product. For all repairs, contact BARSKA Customer Service.
- DO NOT use chemicals or cleaning agents to clean the safe.

MOUNTING INSTRUCTIONS

The safe may be mounted down to the floor. Be aware of the load bearing. Failure to do so can result in personal injury and/or damage to property. Use appropriate tools when performing work and always use eye protection.

Floor Mounting

- Use proper drill tools depending on the type of floor you are mounting the safe (wood, tile, or concrete).
- Measure the location of the pre-set drill holes; mark their exact position onto the floor.
- Drill the appropriate size holes for the anchors you are using.
- Carefully press the anchor into the holes at this time.
- Mount the safe by running screws from inside of the safe and securing to anchors; ensure the safe is mounted securely.



1 YEAR LIMITED WARRANTY

SAFE/LOCK BOX

BARSKA warrants this new safe/lock box to be free of defects in material and/ or workmanship under normal use for a period of twelve (12) months from the date product is purchased. This limited warranty is delimited to repair or replacement only. This warranty does not cover damage caused by improper installation or maintenance. BARSKA disclaims all liability for incidental or consequential damages resulting from misuse, abuse, accident (such as dropping), fire, flood, service or repairs other than those performed by BARSKA, acts of nature, or arising out of any breach of this warranty. Altering the product under any circumstances will automatically void the warranty.

For service under this limited warranty, please have available the proof of purchase and the purchase date and location as well as a detailed description of the problem. This warranty is not transferable and only applies to the original purchaser with a proof of purchase from BARSKA or from an authorized dealer. This warranty applies only to products purchased within the United States, excluding Alaska, the Hawaiian Islands and all U.S. territories in the Caribbean and the Pacific.

BARSKA will examine and go through troubleshooting procedures, product repair or replacement of defective part(s) or units with new part(s) or provide a new unit, if necessary, during the warranty period. Reasonable shipping/handling charges may apply and are based on Barska sole discretion. Purchaser shall be required to prepay Shipping/handling charges with a check or money order to BARSKA at time product is returned. The Return Merchandise Authorization Number (RMA#) and shipping/handling charge MUST be obtained from BARSKA in advance of return. BARSKA shall not be liable for damages or loss occurring during shipping. Please visit via www.barska.com or call 909.445.8168 to obtain the RMA#, Shipping/handling amount, and for more information.

BARSKA reserves the right to modify or discontinue, without prior notice to the purchaser, any model or style of the product. BARSKA will determine, at its sole discretion, whether a product will be repaired or replaced. BARSKA reserves the right to discontinue or change any feature of its products at any time. If an exact replacement or product is not available, BARSKA reserves the right to provide a part or product that matches as closely as possible.

LIMITATION OF REMEDIES

BARSKA disclaims any warranties, express or implied, whether of merchantability or fitness for a particular use, except as expressly set forth herein. The sole obligation of BARSKA under this limited warranty shall be to repair or replace the covered product, in accordance with the terms set forth herein. BARSKA expressly disclaims any lost profits, general, special, indirect or consequential damages which may result from breach of any warranty, or arising out of the use or inability to use any BARSKA product. Any warranties which are implied and which cannot be disclaimed shall be limited in duration to a term of one year from the date of original retail purchase.

Some states do not allow the exclusion or limitation of incidental or consequential damages or limitation on how long an implied warranty lasts, so the above limitations and exclusions may not apply to you.

BARSKA
855 Towne Center Drive, Pomona, CA 91767