

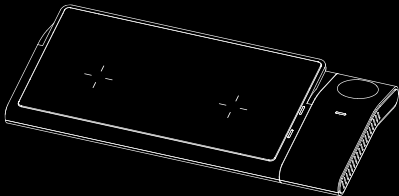

CHARGit
INTELLIGENT WIRELESS CHARGING

FAST WIRELESS MULTI-CHARGER POWER PAD



Please read these instructions carefully before use

www.chargitstore.com info@chargitstore.com 0333 700 8889

CHARGEit Power Pad

Please read this user manual before using and keep it for future reference.

1. Wireless Charging Zone 1
2. Wireless Charging Zone 2
3. Wireless Charging Zone 3
4. Indicator Light (Wireless Charging Zone 1)
5. Indicator Light (Wireless Charging Zone 2)
6. Indicator Light (Wireless Charging Zone 3)
7. Type-C USB

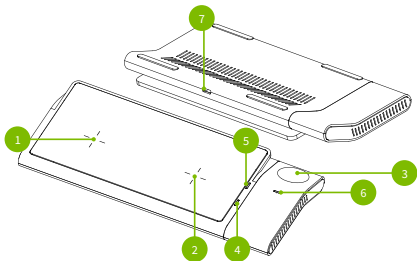

Wireless Charging Instructions

1. Connect the USB-C cable to a QC/PD USB adaptor.
2. Place your devices onto the charging zones.

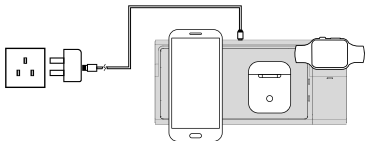

Power Indicator Lights

(Wireless Charging Zones 1 and 2)

1. On initial power up all lights will flash green then blue.
2. A solid blue light will indicate when a device is charging.
3. If a foreign object is detected in the charging zones, a flashing blue light will activate.

iWatch Indicator Instruction

(Wireless Charging Zone 3)

1. On initial power up all lights will flash green then blue.
2. A solid blue light will indicate when your iWatch is charging.

Notice

1. Please use QC compatible power adapter to achieve fast charge.
2. It is normal during charging for your device to become warm.
3. To fully use dual phone charging please ensure you are using 9V-3A (a QC 3/4/5 or PD3 charger).



Warning: When charging Dual phones simultaneously, the input must not be less than 9V-3A It must be used with PD3.0 or QC4+ adapter.

Product and Safety info

1. Do not use in high temperatures or in high humidity.
2. Do not store or use near strong magnetic fields
3. Keep out of reach of children

Package Contents

1 x Product 1 x User Manual 1 x USB-C Charging Cable (1m)

Warnings

1. Do not tamper with the device
2. Do not use the device in extremely hot, humid or in a corrosive environment
3. Do not use near magnetic cards
4. Please keep a minimum of 20cm between medical devices such as pacemakers, hearing aids etc, to avoid any potential interference

Please ensure your USB wall plug is using a minimum of 3A/5V PD Q3+ to ensure fast charge.

The images in this manual are for illustration purposes only, the actual product may vary.

- In accordance with the FCC rules, this equipment has been tested and found to comply with the limits for a Class B digital device. This equipment may cause interference to other equipment if not installed and used in accordance with these instructions.

Warranty

Your purchase includes 12 months warranty.

Please visit www.chargitstore.com for more information.

Black CIPPB23 WHITE CIPPW23

Product Specification

Input	5V/3A 9V/2A 12V/1.5A
Output 1	10W Max (Compatible Device) 5W Max (Earbuds)
Output 2	10W Max (Compatible Device) 5W Max (Earbuds)
Output 3	3.5W Max (iWatch)

Troubleshooting

qi device not charging	Re-align device onto charging station
	Make sure no magnet/metal is between device and charging station
	Remove device case
	Make sure device is compatible



RoHS
compliant



Made In China