

TANK

Assembly Guide

ITEM	PART NUMBER	DESCRIPTION	QTY
1	5620901-C	ASSY, ONE BRAKE FRAME	1
2	5553001	WHEEL, 12" DIA X 3.5 WIDE	4
3	2011201	WASHER, STEEL 12.7 ID-40 OD-4 THK CLEAR ZINC	4
4	2010901	WASHER, LOCK M12 SAE ST ZN	12
5	2011301	SCREW, M12-1.75 X 30L SOC HD GR 12.9 CLEAR ZINC	4
6	5536101	ASSY, PUSH HANDLE - RH	2
7	5536001	ASSY, PUSH HANDLE - LH	2
8	2010801	WASHER, STEEL 12.7 ID-25 OD-2 THK CLEAR ZINC	8
9	2010701	SCREW, M12-1.75 X 85L SOC HD GR 12.9 CLEAR ZINC	8
10	56024PA	PTD ASSY, TANK WEIGHT HORN	2
11	2010501	WASHER, STEEL 10.5 ID-20 OD-2 THK CLEAR ZINC	20
12	2010601	SCREW, M10-1.5 60L SOC HD GR 12.9 CLEAR ZINC	8
13	2012301	NUT, HEX LOCKING M10-1.5 GR 10 CLEAR ZINC	8
14	55724PA	PTD ASSY, LEFT PUSH HANDLE	2
15	55726PA	PTD ASSY, RIGHT PUSH HANDLE	2
16	5572101	WLDMT, HOR PUSH HANDLE	2
17	2012801	SCREW, M10-1.5 X 25L SOC HD GR 12.9 CLEAR ZINC	4
18	5602701	BUMPER, TANK (OPTIONAL)	4
19	5433701	SPACER, FLANGE (OPTIONAL)	8

TABLE OF CONTENTS:

- **TANK ASSEMBLY: PAGES 3 - 5**
- **TANK CHAIN ADJUSTMENT: PAGES 6 - 9 & 11 - 13**
- **TANK BELT ADJUSTMENT: PAGES 6 - 8 & 10 - 13**
- **PERFORMANCE HANDLE KIT (OPTIONAL): PAGES 14 - 15**
- **TANK BUMPER KIT (OPTIONAL): PAGES 16 - 17**
- **INSPECTION & LUBRICATION: PAGE 18**
- **NOTICES: PAGE 19**

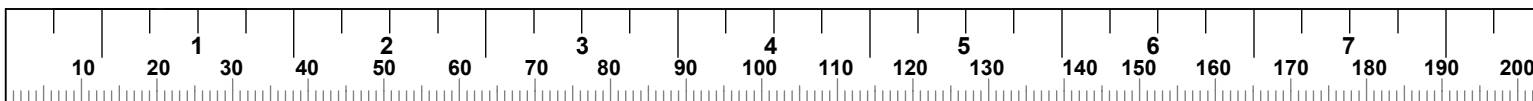

STEP 1

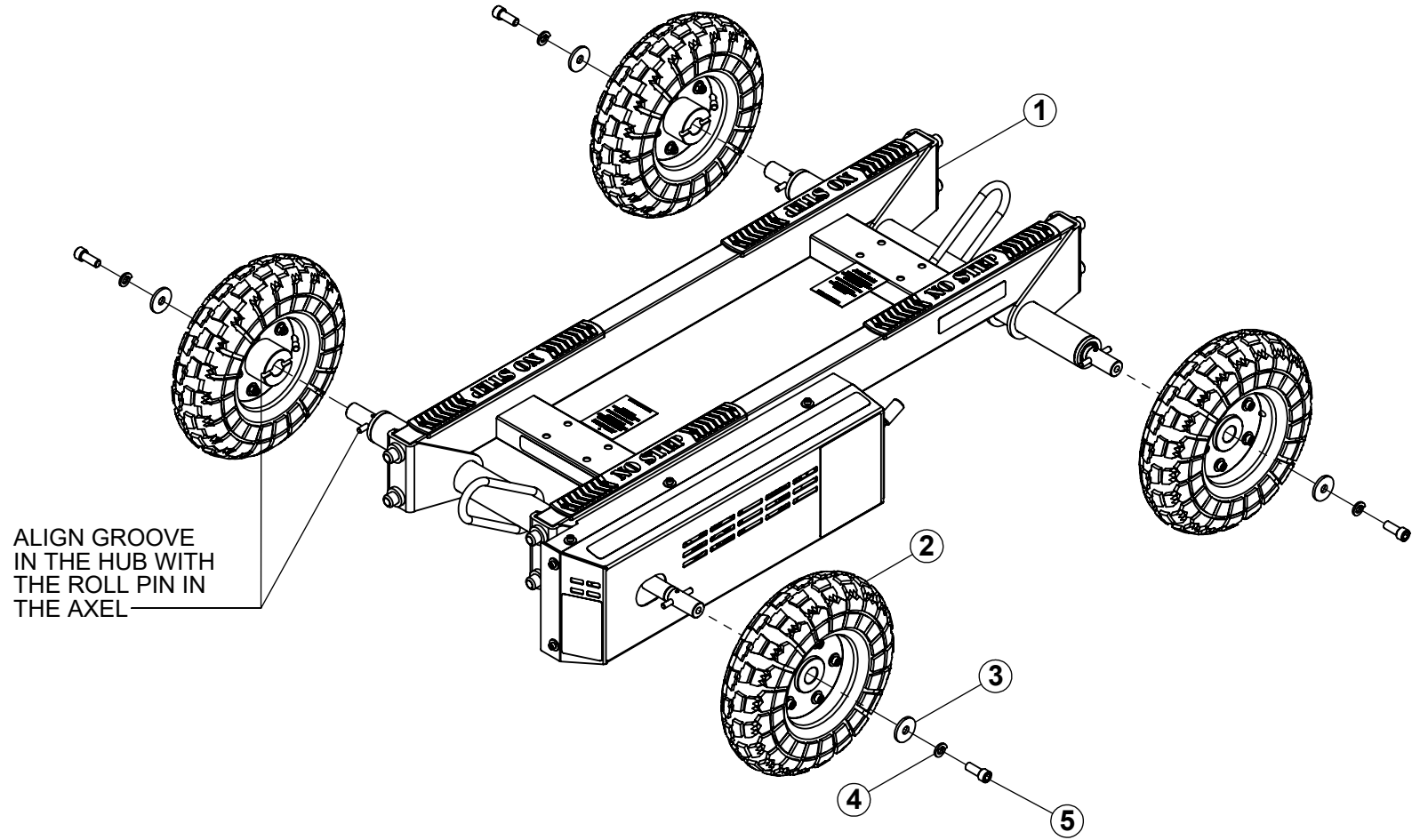

NOTE:

SECURELY tighten all bolt connections in this step.

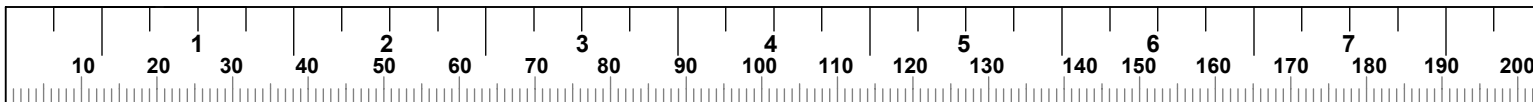

STEP 2

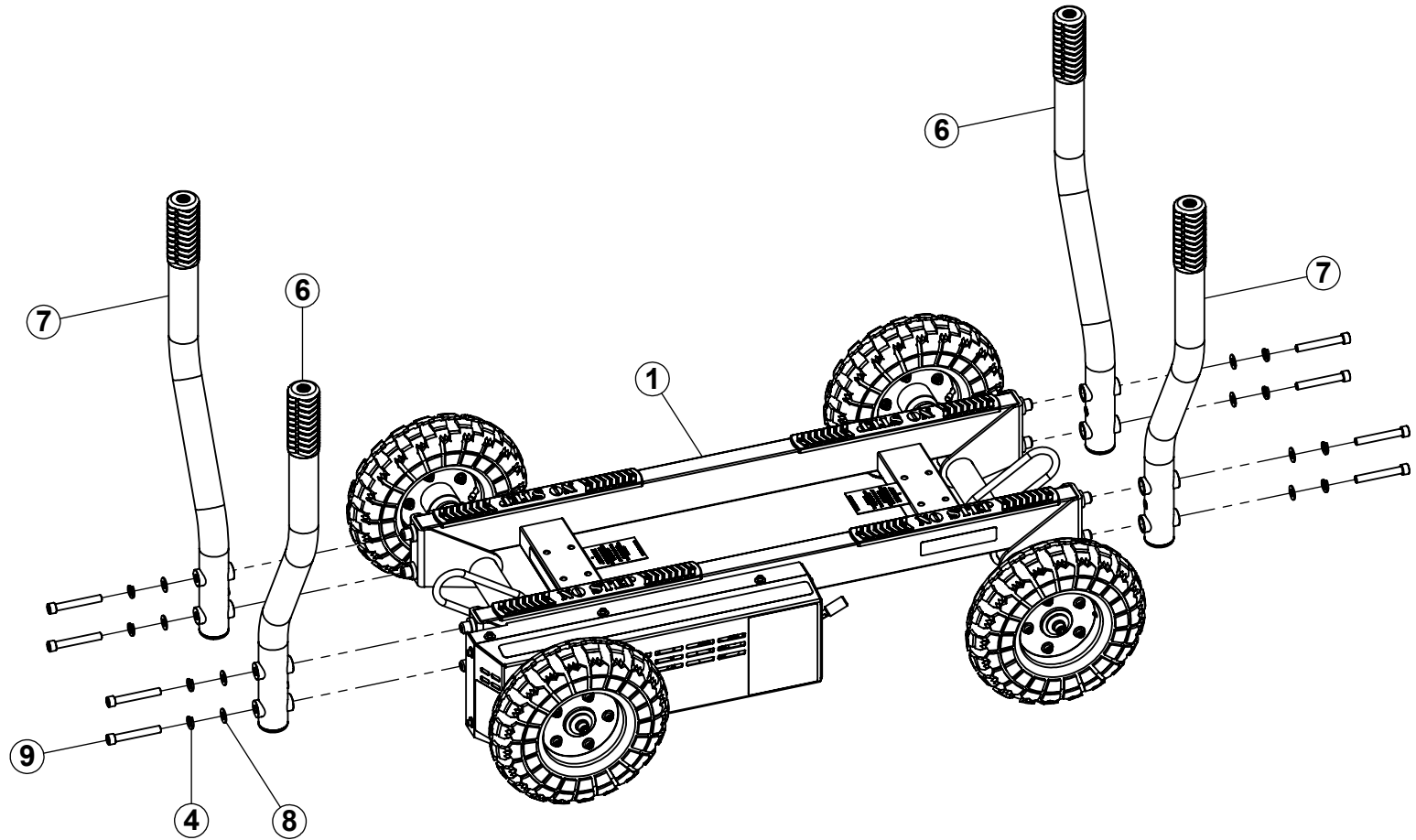

NOTE:

SECURELY tighten all bolt connections in this step.

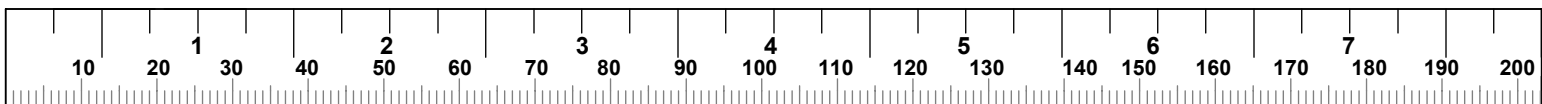

STEP 3

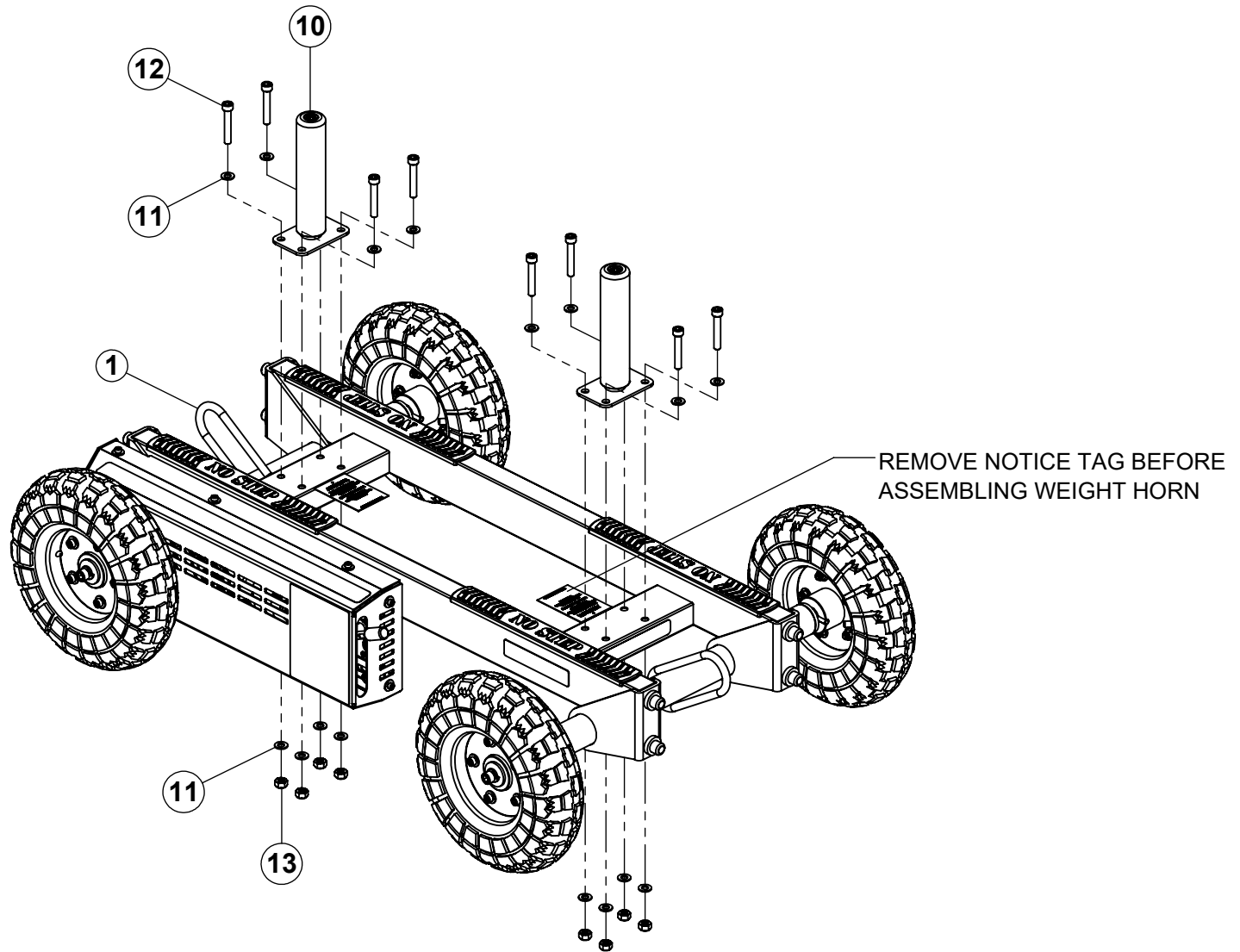

NOTE:

SECURELY tighten all bolt connections in this step.

Handles have been hidden for assembly clarity.

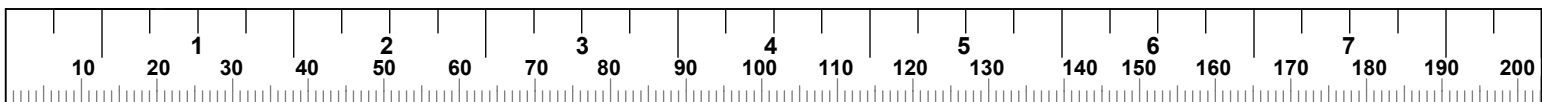

CHAIN AND BELT ADJUSTMENT

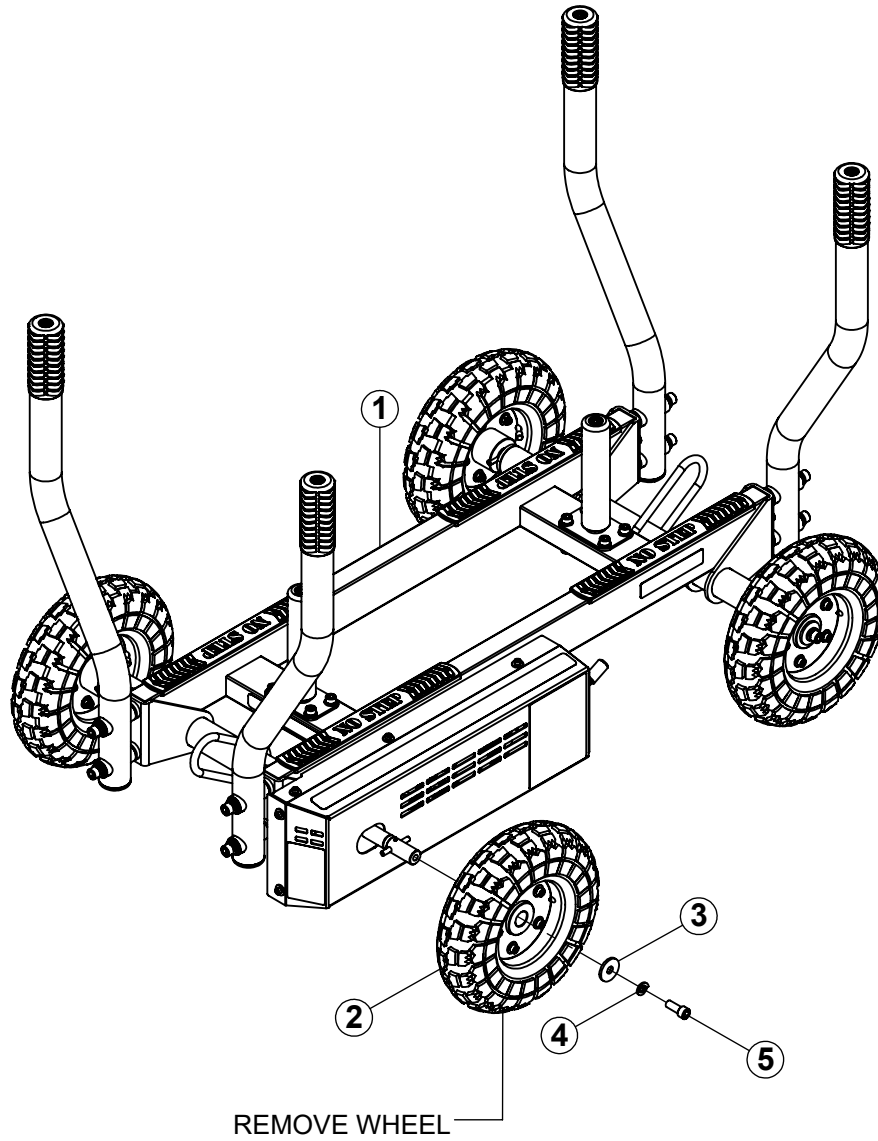

CHAIN AND BELT ADJUSTMENT

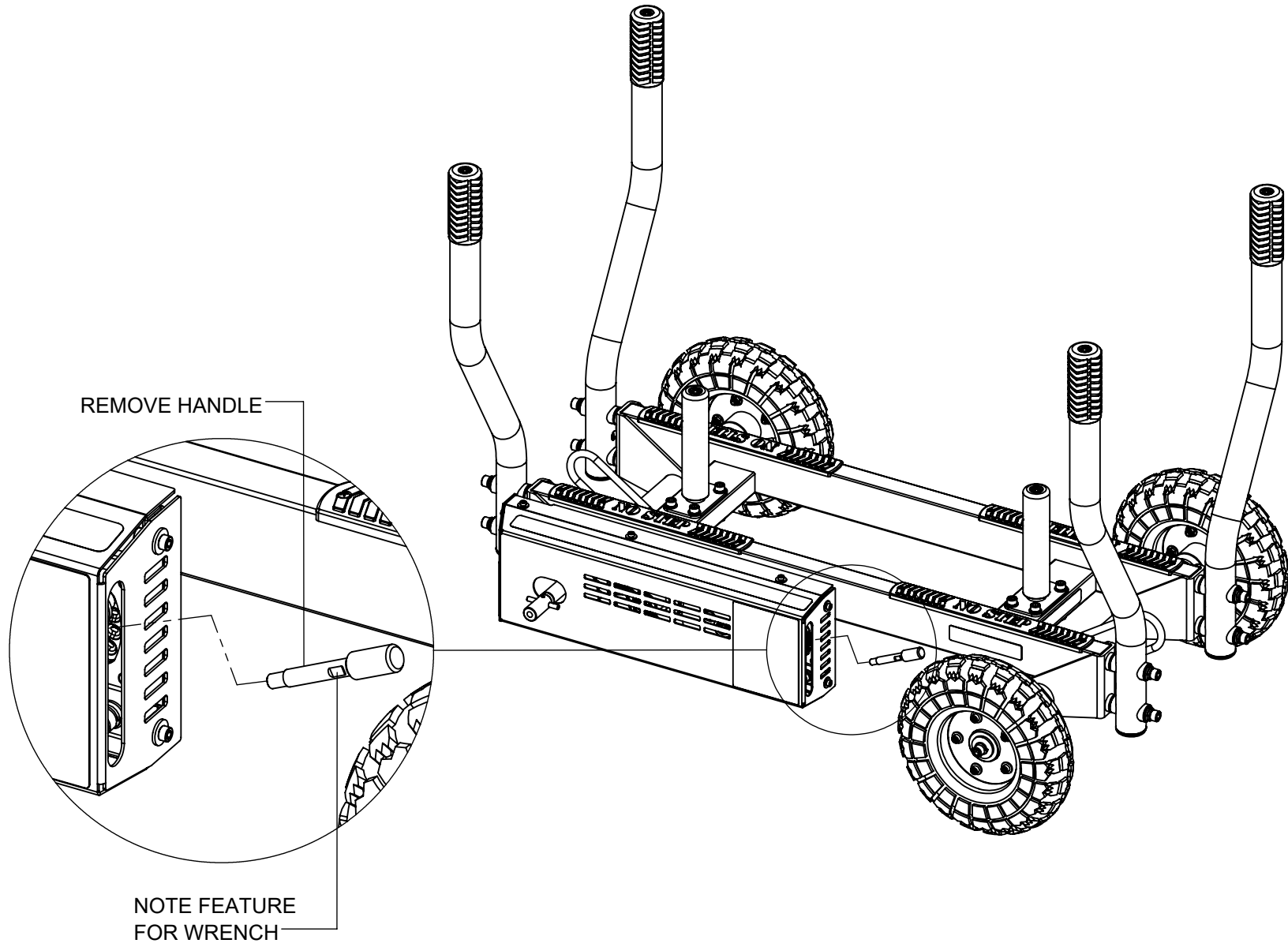

CHAIN AND BELT ADJUSTMENT

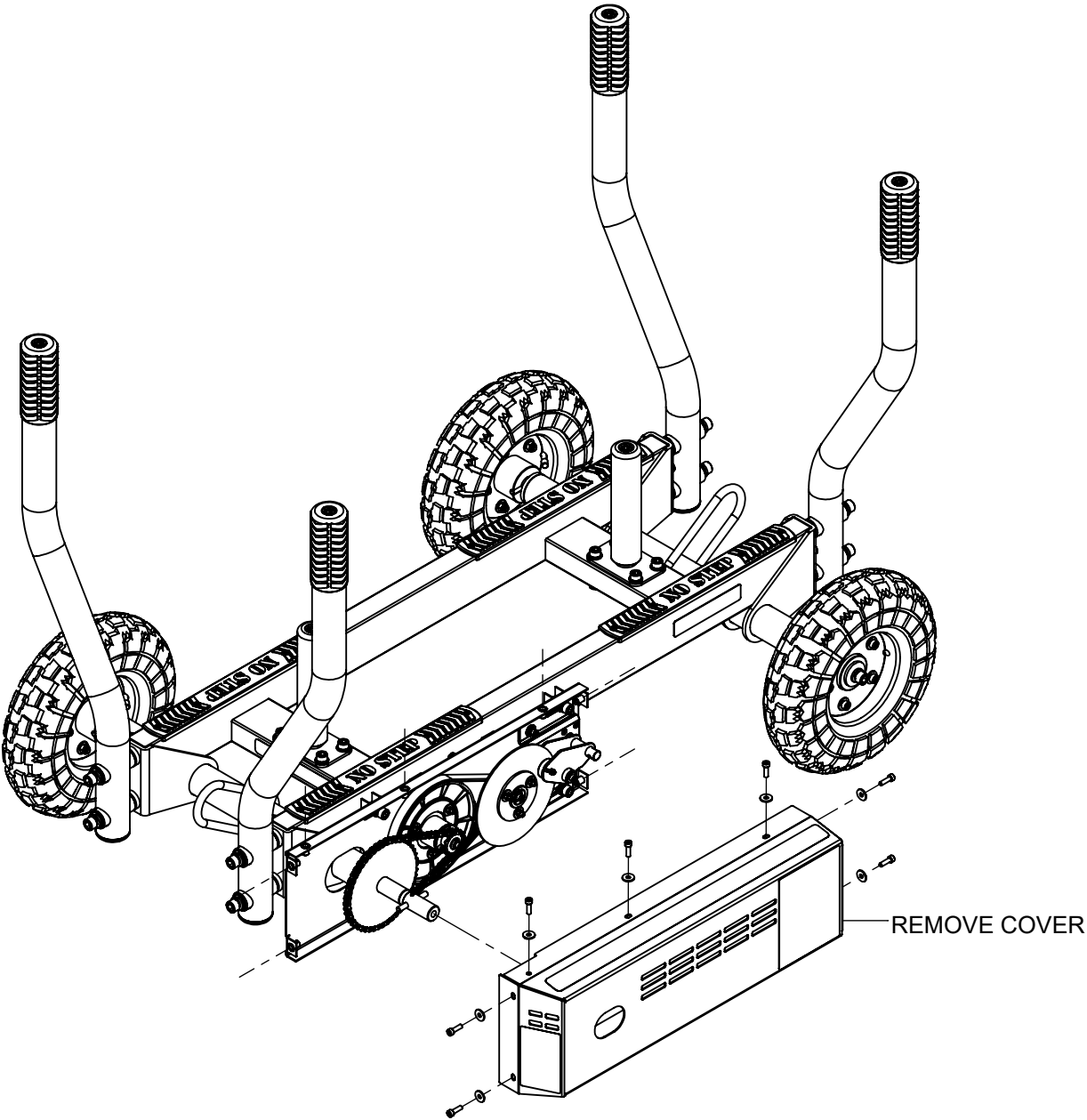

CHAIN ADJUSTMENT

1. LOOSEN FOUR BOLTS (CIRCLED)

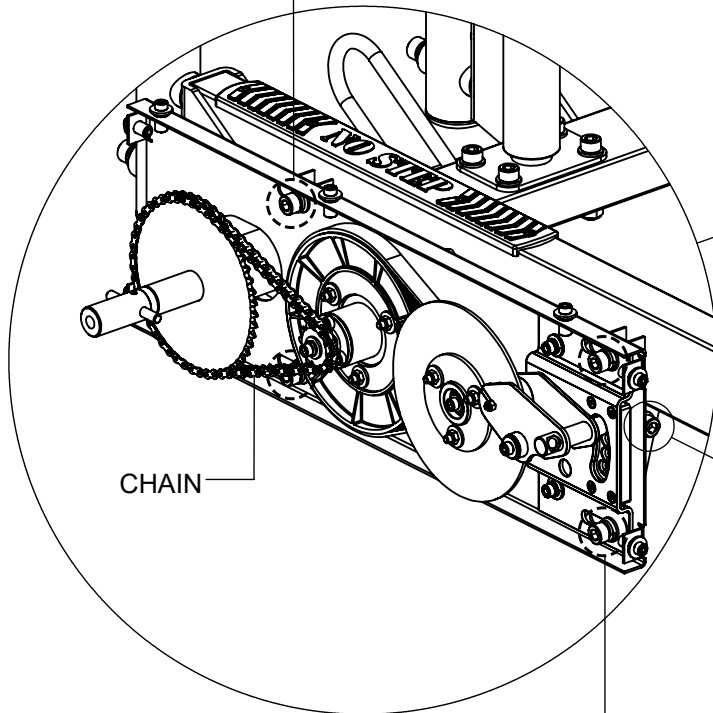

3. RETIGHTEN FOUR BOLTS (CIRCLED)

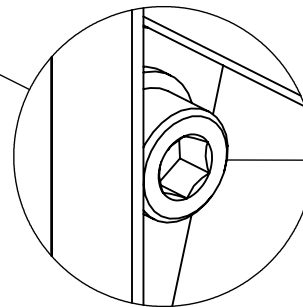
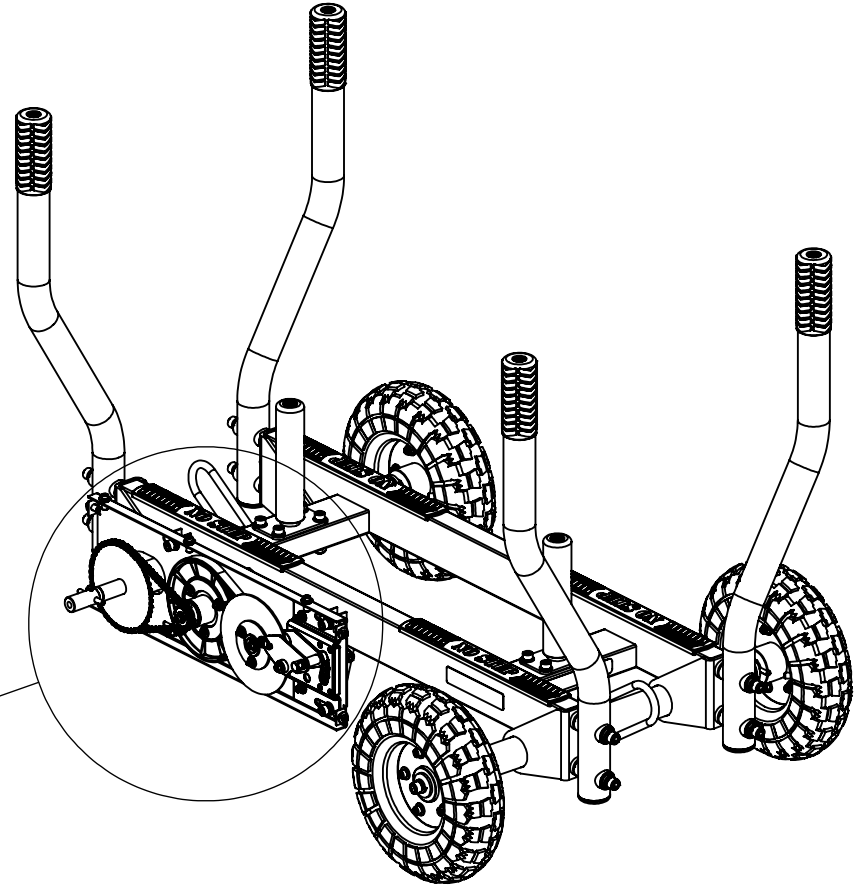

2. TURN BOLT CLOCKWISE TO TIGHTEN CHAIN.
TURN BOLT COUNTER CLOCKWISE TO LOOSEN CHAIN.

NOTE:

The chain tension on TANK is pre-set at the factory. However, if the chain becomes too loose or is too tight, then please follow the steps in numbered order to adjust.

BELT ADJUSTMENT

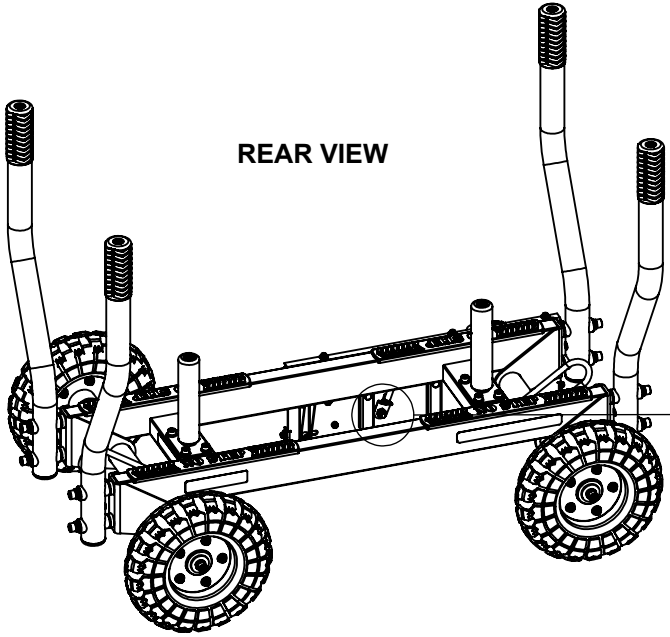

TO TENSION BELT, LOOSEN NUT **SLIGHTLY** AND PULL UP ON TENSIONER BRACKET. RETIGHTEN NUT SECURELY.

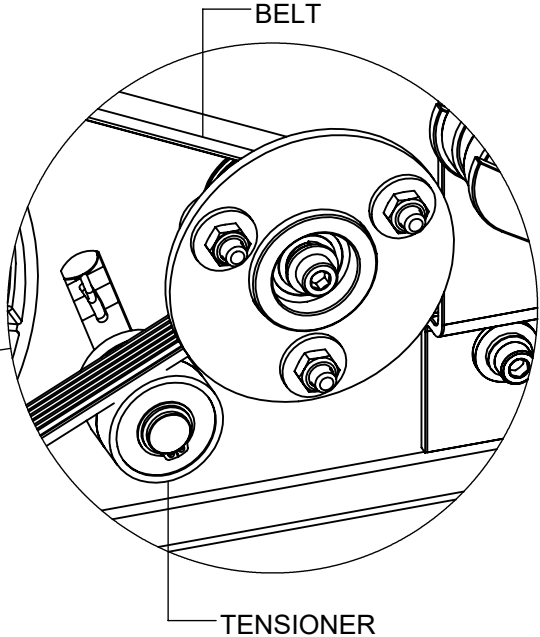
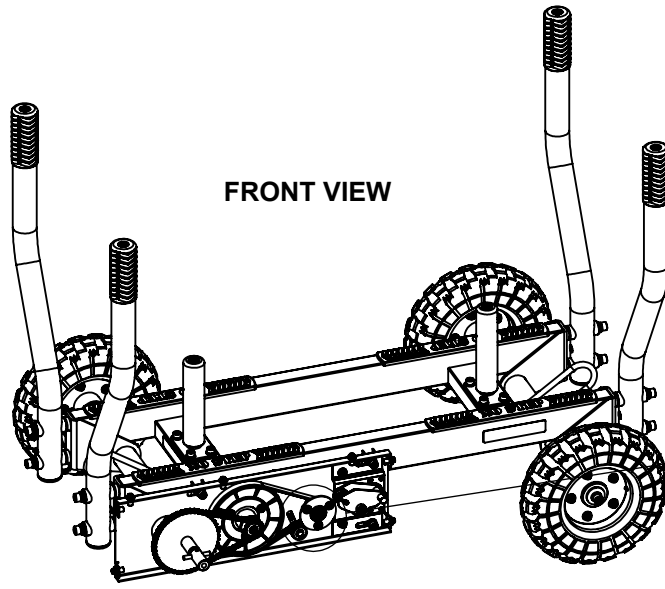
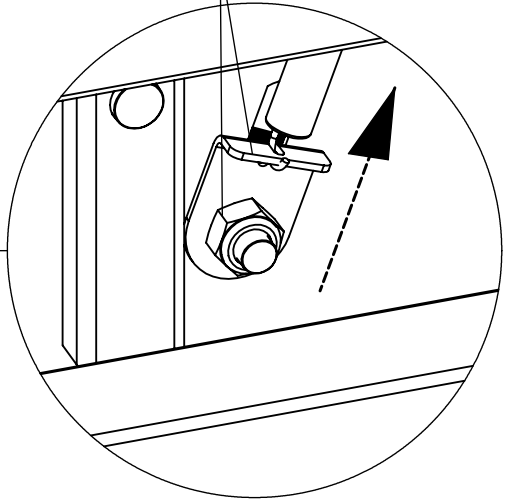

NOTE:

The belt tension on TANK is pre-set at the factory. However if belt is too loose or starts to slip, then please follow this step.

CHAIN AND BELT ADJUSTMENT

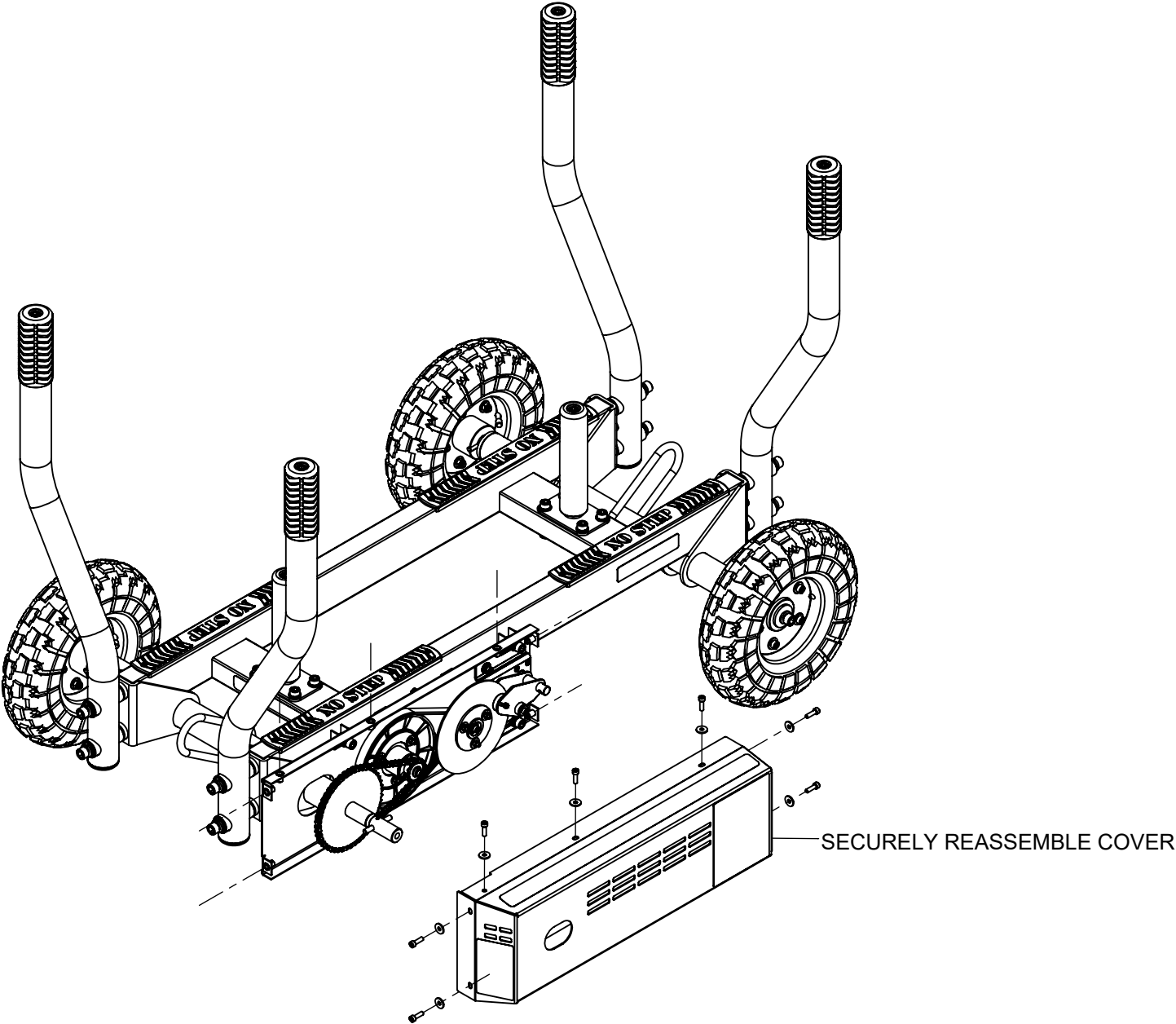

CHAIN AND BELT ADJUSTMENT

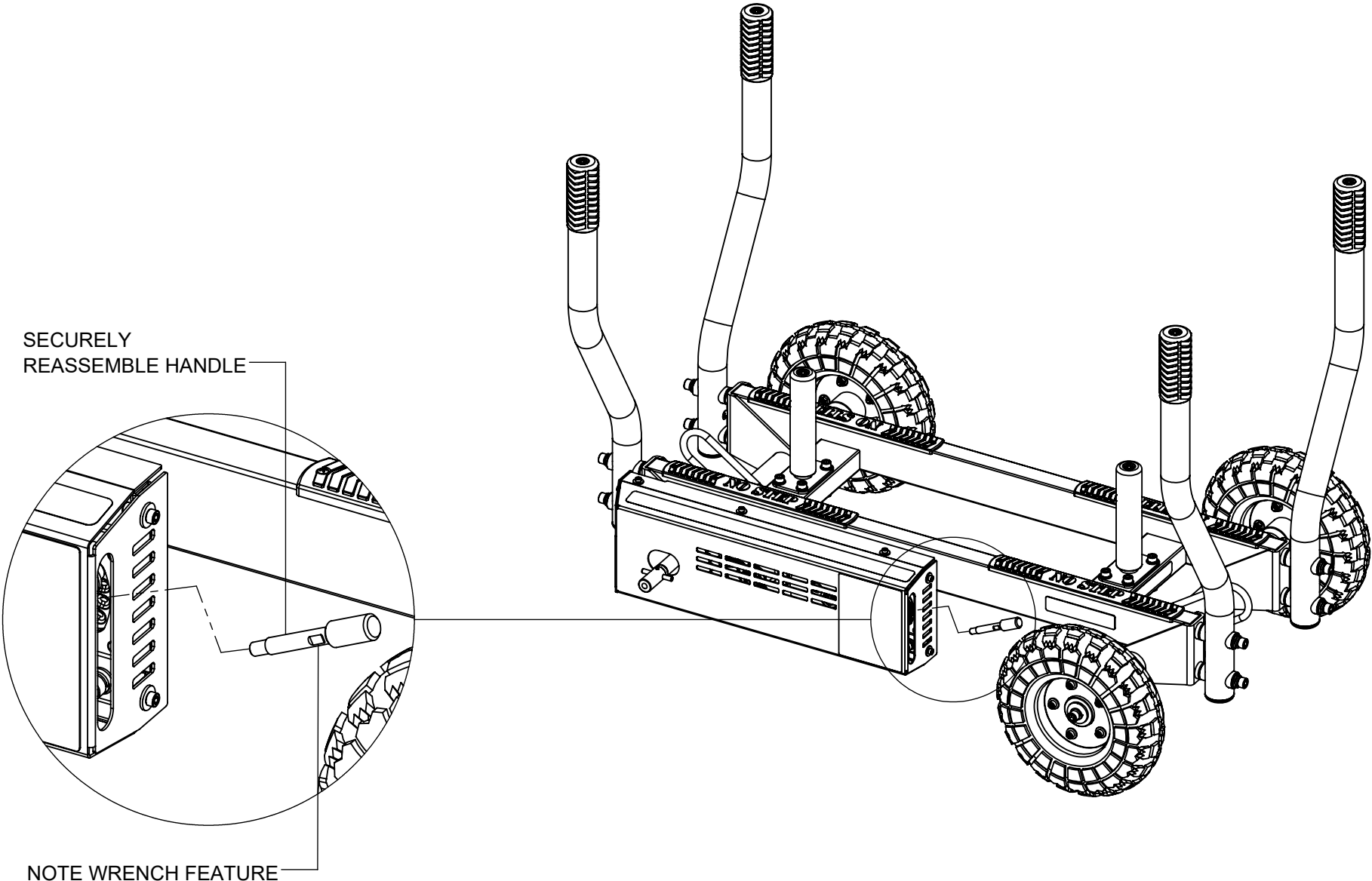

SECURELY
REASSEMBLE HANDLE

NOTE WRENCH FEATURE

CHAIN AND BELT ADJUSTMENT

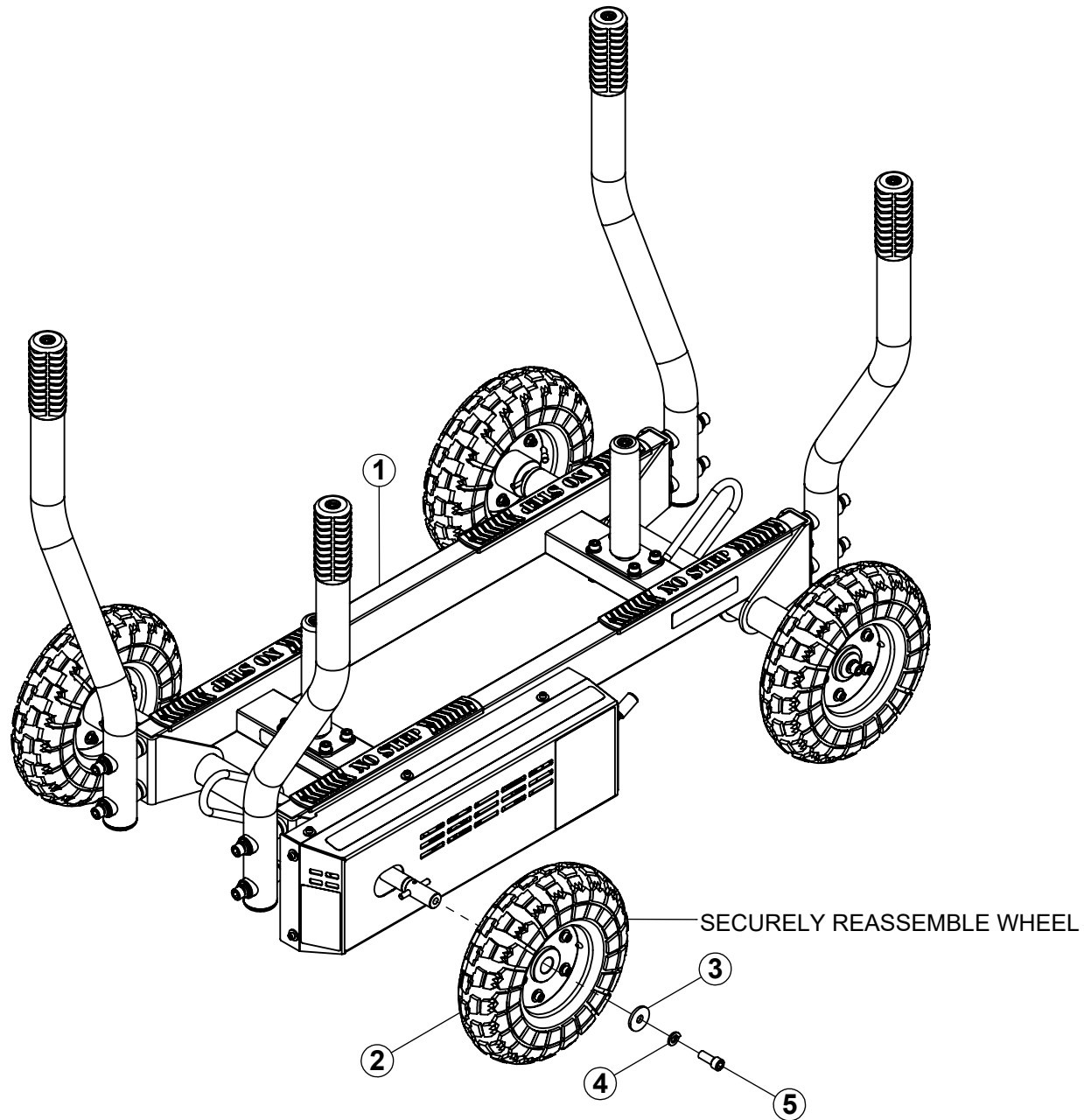

XTPHK
PERFORMANCE HANDLE KIT (OPTIONAL)

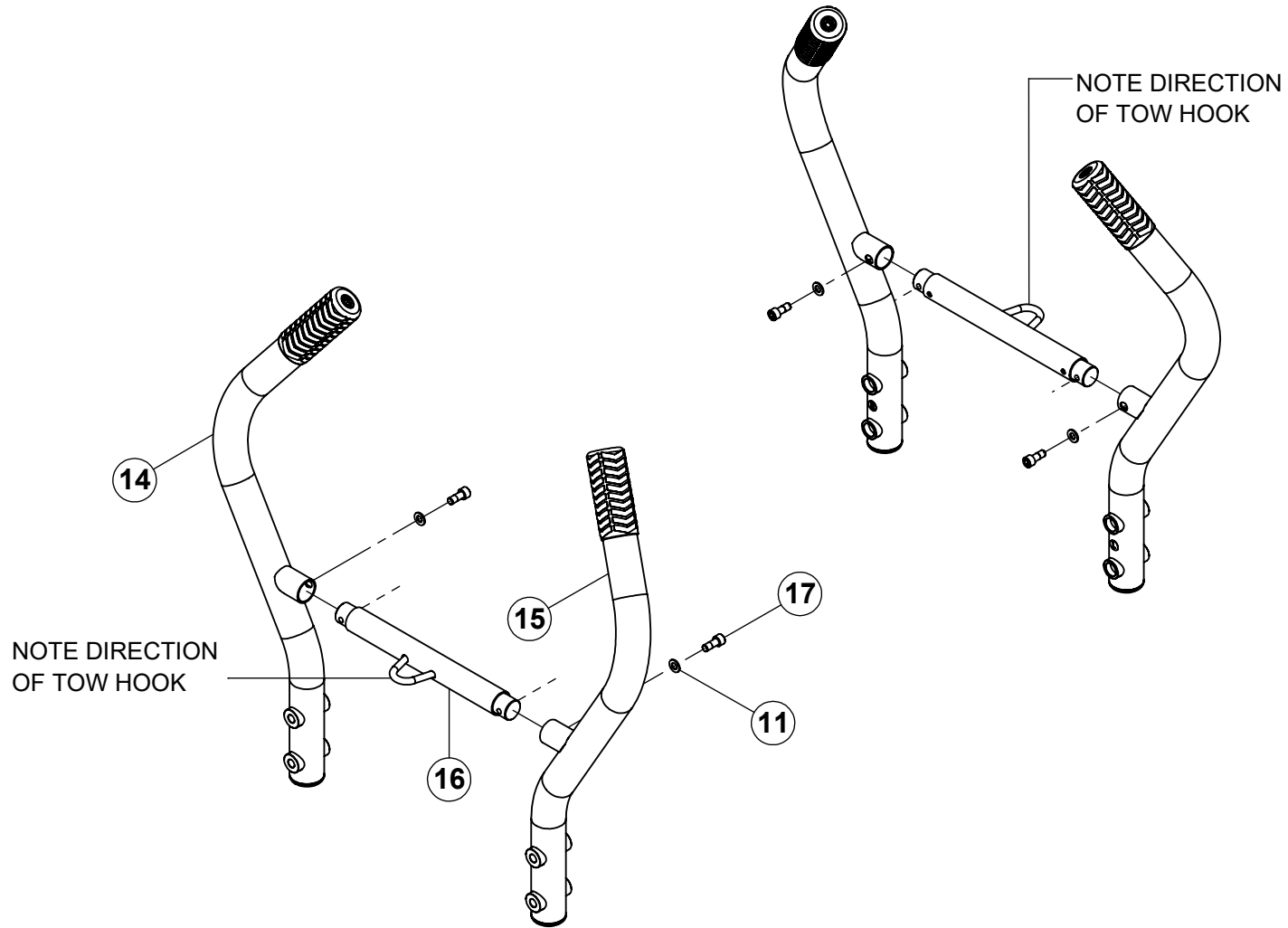

NOTE:

LOOSELY tighten bolt connections in this step.

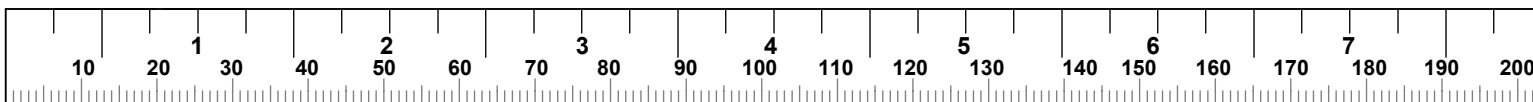

XTPHK
PERFORMANCE HANDLE KIT (OPTIONAL)

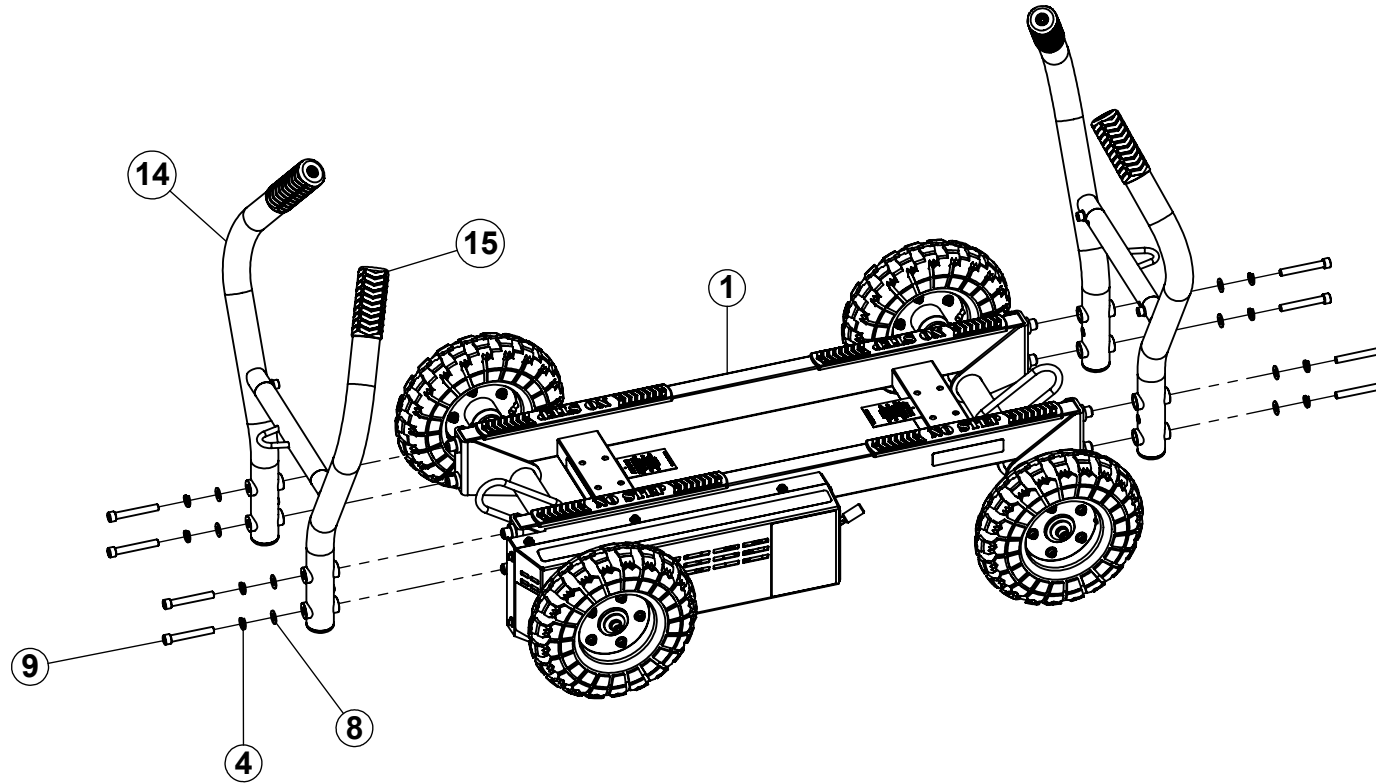

NOTE:

After this step has been completed, **SECURELY** tighten all bolt connections in this step and previous step.

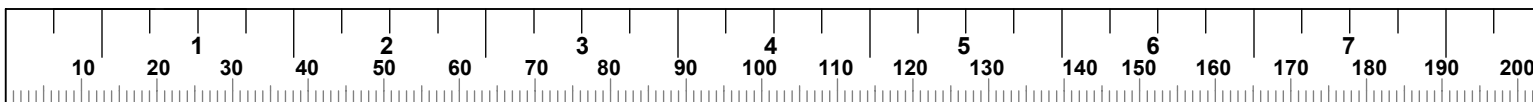

**XTBK
TANK BUMPER KIT (OPTIONAL)**

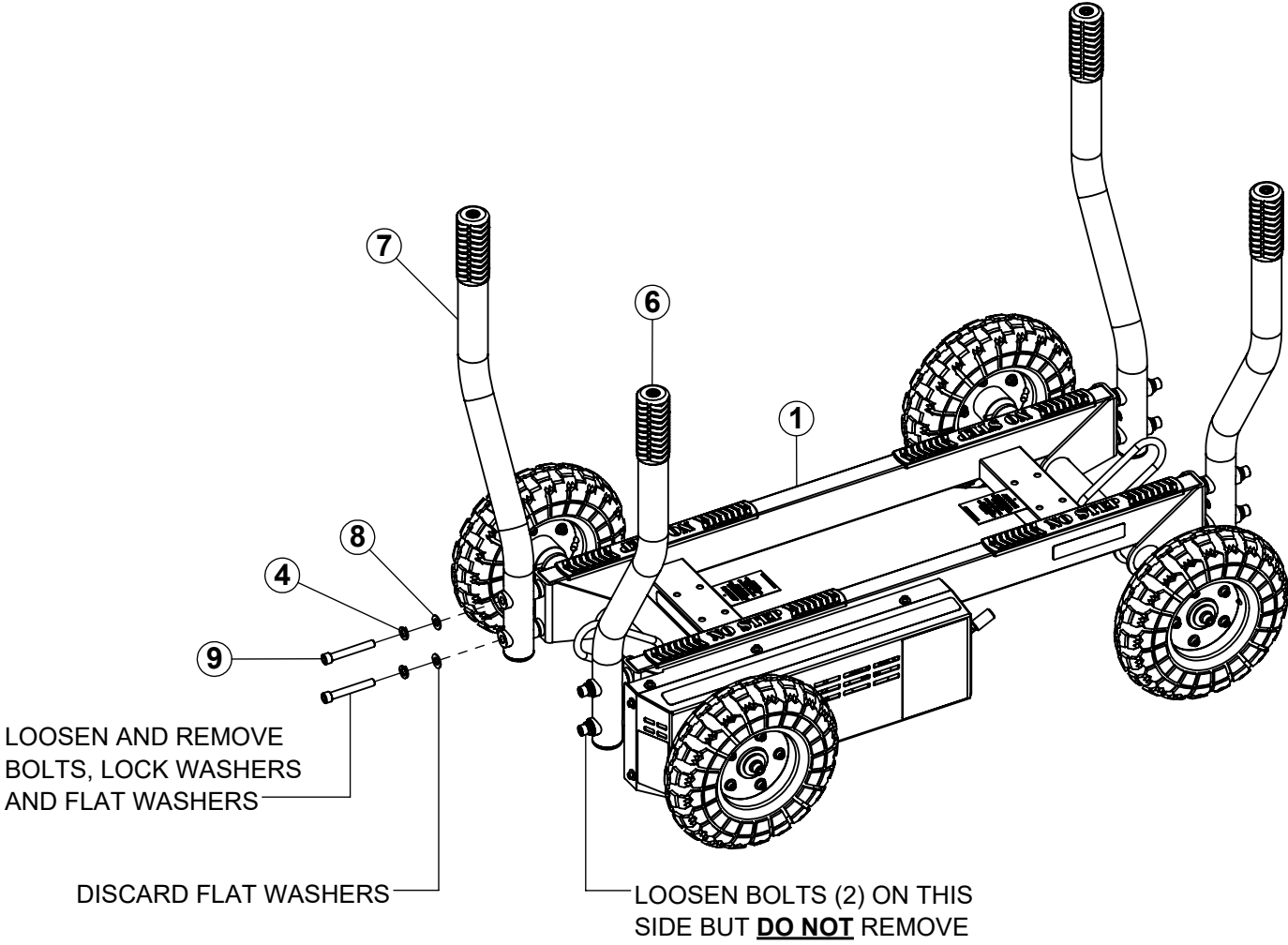

**XTBK
TANK BUMPER KIT (OPTIONAL)**

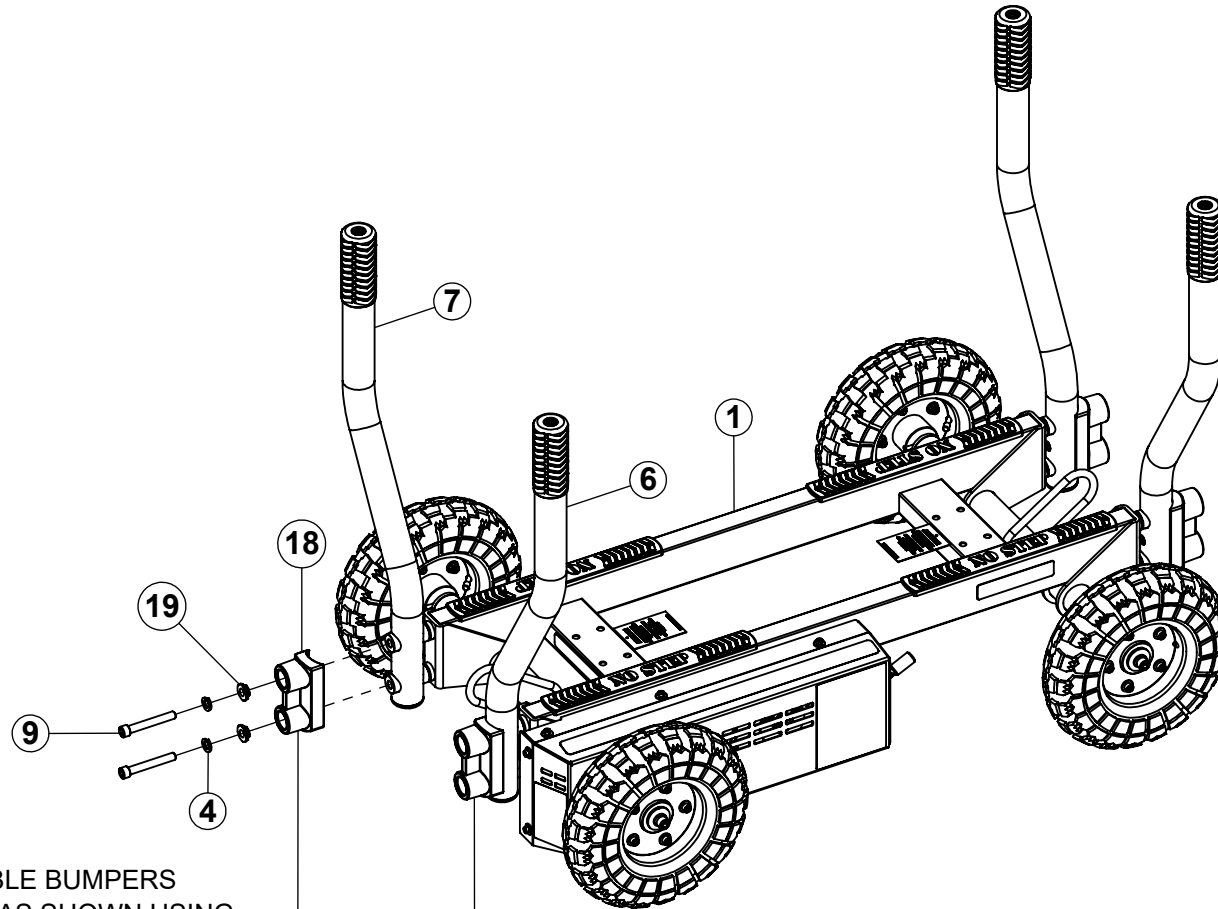

LOOSELY ASSEMBLE BUMPERS TO THE HANDLES AS SHOWN USING FLANGE SPACERS, BOLTS AND LOCK WASHERS FROM PREVIOUS STEP

REPEAT THIS STEP, ONE AT A TIME FOR REMAINING 3 BUMPERS. KEEP BOLTS LOOSE UNTIL ALL BUMPERS ARE ASSEMBLED.

NOTE:

Once all bumpers have been assembled, **SECURELY** tighten all bolt connections.

INSPECTION & LUBRICATION

INSPECTION:

Recommended tire inflation: 30 PSI

Once a month, check for loose bolts on handles, wheels and weight horns as indicated. Tighten if necessary.

Once a month, check that the chain and sprocket are clean, free of rust, dust and grime. Make sure that the chain is properly lubricated. If chain is loose, retighten chain as outlined on page 9.

Once a month, inspect belt. Make sure the belt is not worn, frayed or loose. Replace belt if worn or frayed. If belt is loose, re-tension belt as outlined on page 10.

LUBRICATION:

Once a month the sprocket should be cleaned and the chain should be lubricated.

RECOMMENDED LUBRICATION: Use a Dry lubrication for indoor use, and wet lubrication for outdoor use. Most bicycle shops carry a variety of different lubricants and can recommend a lubricant based on the conditions where the TANK will be used.

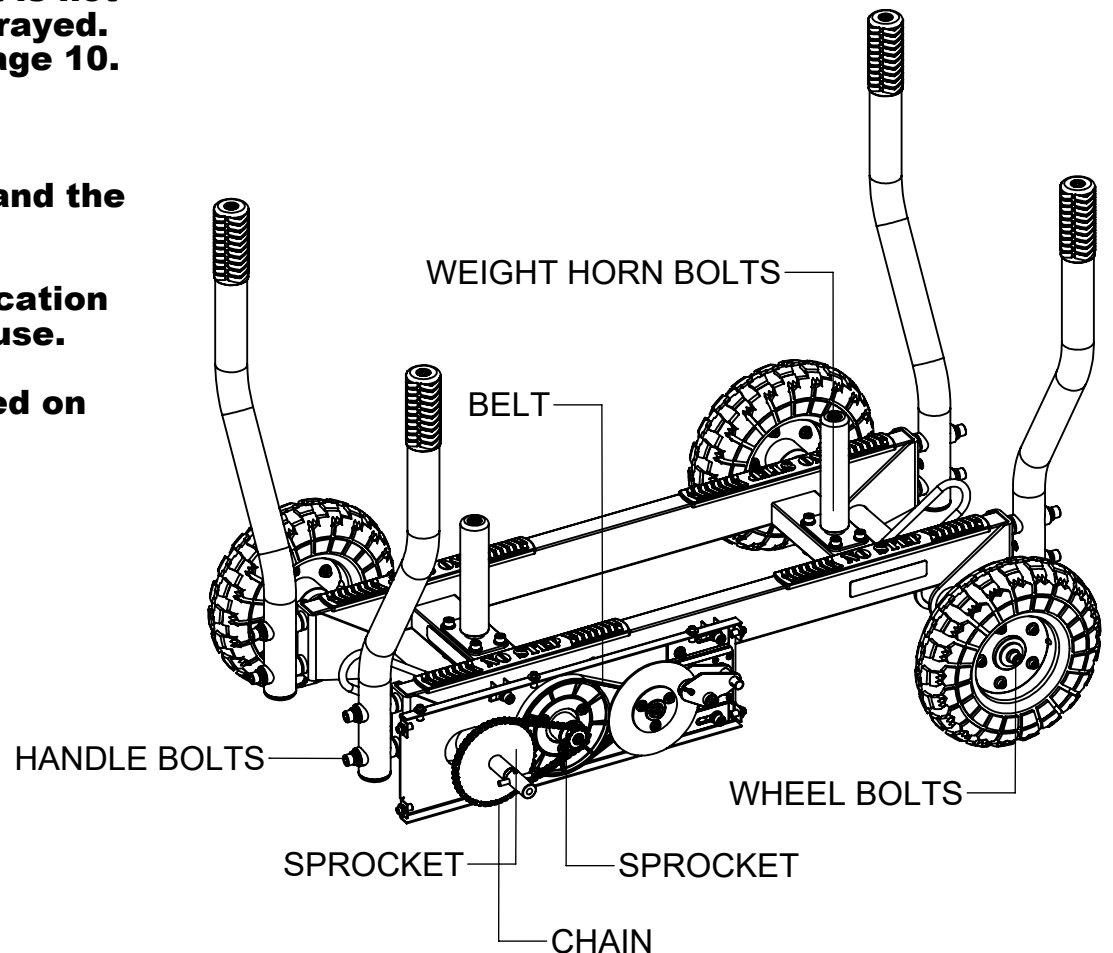

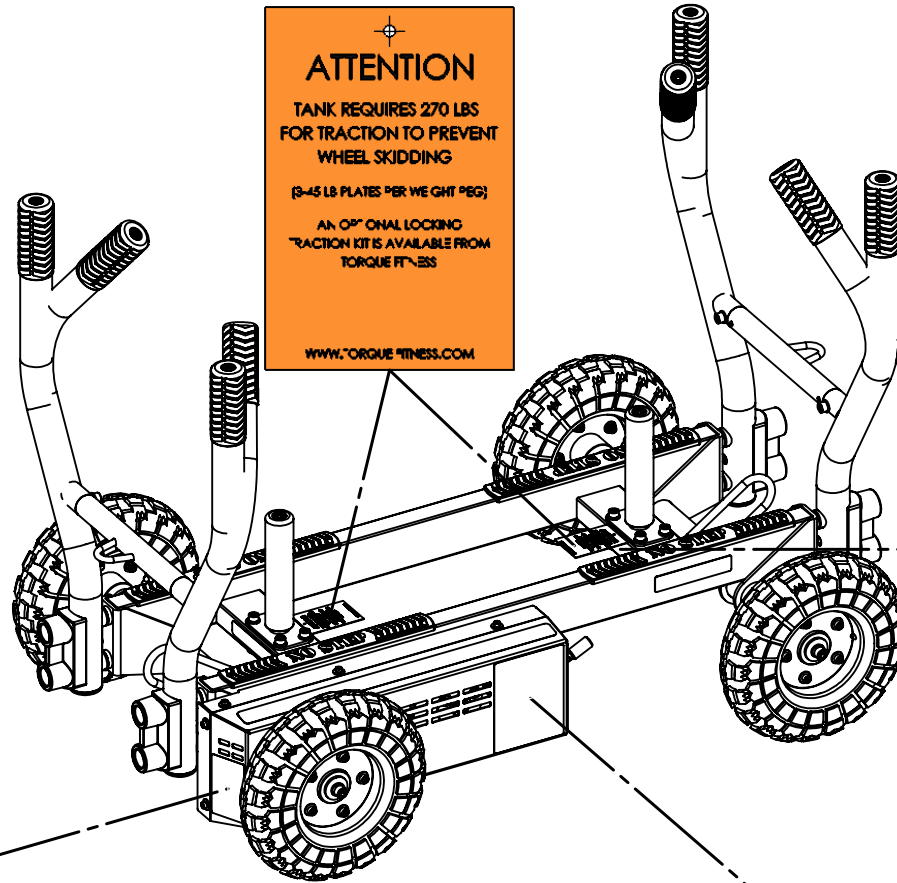

ATTENTION
 TANK REQUIRES 270 LBS
 FOR TRACTION TO PREVENT
 WHEEL SKIDDING
 (3-45 LB PLATES PER WEIGHT PEG)
 AN O² ONAL LOCKING
 TRACTION KIT IS AVAILABLE FROM
 TORQUE FITNESS
 WWW.TORQUEFITNESS.COM



 TORQUE FITNESS
 5500 Holly Street NW
 Coon Rapids, MN 55433

 **WARNING**
 Before working on or with any gun, check your physical condition and the gun. To add safety, keep the gun and gun barrel always pointed in a safe direction and never aim at people. Read and follow all warnings and instructions in the user manual and publications. Report all label damage to the manufacturer.

 **WARNING**
 Before working on or with any gun, check your physical condition and the gun. To add safety, keep the gun and gun barrel always pointed in a safe direction and never aim at people. Read and follow all warnings and instructions in the user manual and publications. Report all label damage to the manufacturer.

 **AVERTISSEMENT**
 Avant de travailler sur ou avec une arme à feu, vérifiez votre condition physique et l'arme. Pour ajouter de la sécurité, gardez toujours l'arme et le canon de l'arme dirigés dans une direction sûre et ne visez jamais les personnes. Lisez et suivez toutes les avertissements et les instructions dans le manuel de l'utilisateur et les publications. Signalez toute détérioration de l'étiquette au fabricant.

 **ADVERTÊNCIA!**
 Antes de trabalhar com qualquer arma de fogo, verifique sua condição física e a arma. Para adicionar segurança, mantenha sempre a arma e o cano da arma apontados em uma direção segura e nunca vise as pessoas. Leia e siga todos os avisos e instruções no manual do usuário e nas publicações. Reporte qualquer dano na etiqueta ao fabricante.

 **WARNING**
DO NOT PULL machine in position
 (N or 1)

FORCE LEVEL



NOTICE
 To prevent wheel skidding, 270 lbs (Six 45 lb plates) must be used.