

Installation Guide | Maxhit BB86/92 Bottom Bracket Kit

Maxhit

1 Confirm Specifications BB86/92 bottom bracket standards

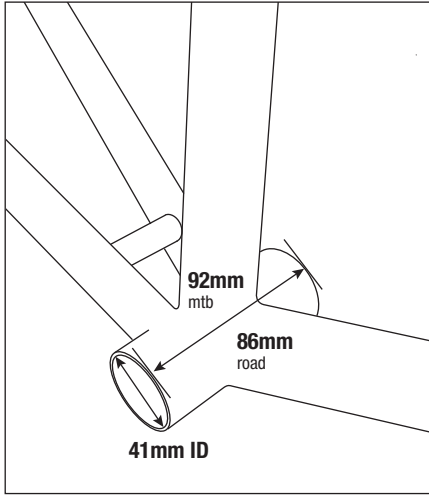

2 Prep BB Shell with facing tools, if necessary

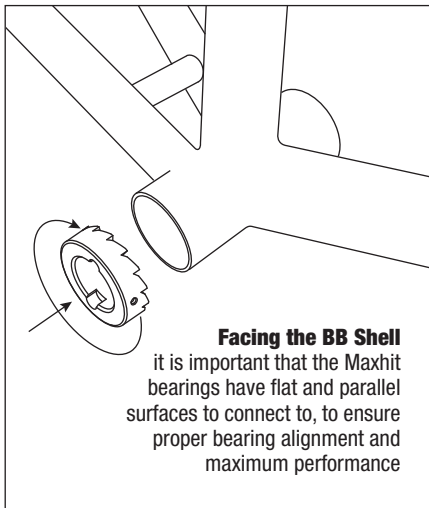

3 Grease and Install Bearings with appropriate tools

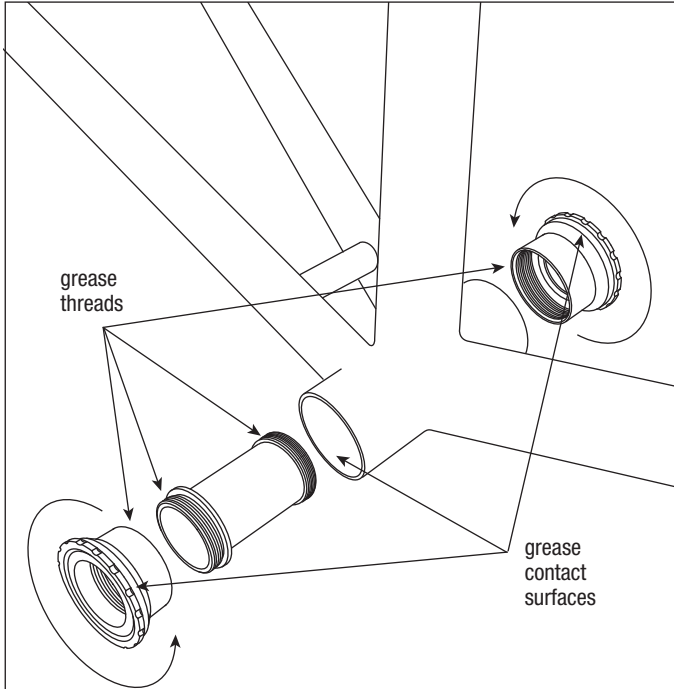

1. Apply a light coating of grease onto the threaded surfaces of the Maxhit Bearings and the Torqite sleeve
2. Thread the drive-side Maxhit bearing by hand onto the Torqite sleeve until it bottoms out on the bearing stop
3. Apply a thin film of grease onto the contact areas of the bearings and bottom bracket shell (the widest part of the bearings next to the tool flange and the outermost cm of the inside of the BB shell)
3. Slide drive-side bearing with Torqite sleeve through the BB shell and fully thread the system together with non-drive Maxhit bearing by hand
4. Torque Maxhit bearings together with spined BB tool to 35-50Nm. Spine tool specification is Shimano FC-32 - Enduro tools BBT-015 & BBT-010 both fit this standard

4 Install Seals and Crankset and set bearing pre-load

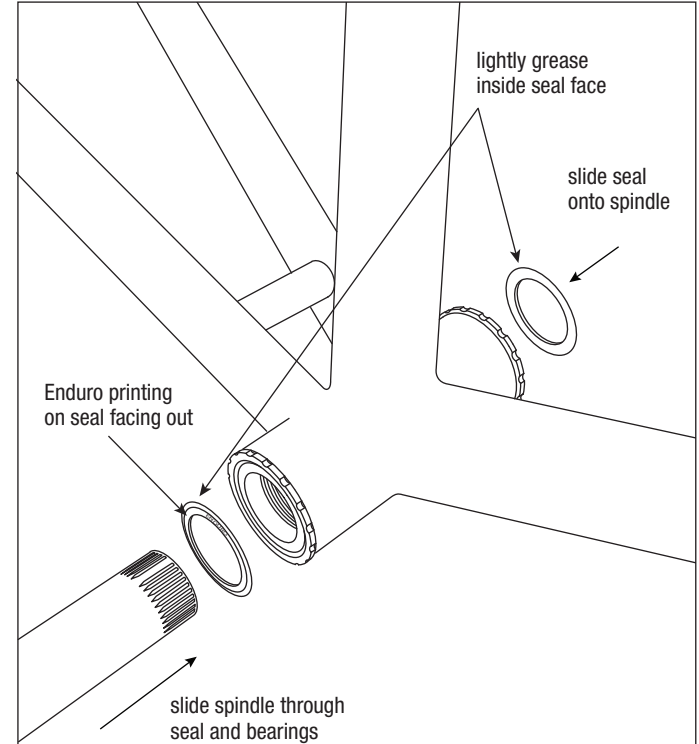

5. Apply a thin film of grease onto the flat face of both seals and the BB spindle. Slide the first seal onto the BB spindle, flat face facing the bearing
6. Slide the BB spindle through the bearings, contacting the inner bearing seals. Slide the other seal onto the spindle, flat face facing the bearing
7. Install crankarms as recommended by the crankset manufacturer
8. Check the chainline and adjust with spacers (included) if necessary
9. Use crankset preload device or light wave washer to remove any side to side movement in the system and to add a light axial load onto the bearings
10. Confirm that crankarms are torqued to manufacturer specifications