



# USER MANUAL FPSD-FR SERIES

go to our web  
[www.tigerkingsafe-us.com](http://www.tigerkingsafe-us.com)  
click [chat with us](#) to have live  
chat

Email: [Support@tigerkingsafe.com](mailto:Support@tigerkingsafe.com)

Facebook: [@TIGERKINGSAFES](#)

Messenger: [m.me/TIGERKINGSAFES](https://m.me/TIGERKINGSAFES)

Version: V202304



FIREPROOF SAFE

# MANUAL

## 01 STRUCTURE

## 02 FIRST OPENING INSTALL BATTERIES

## 03 SET UP THE CODE

## 04 FINGERPRINT SETTING

## 05 OPEN THE DOOR DUAL AUTHENTICATION SETTING CLOSE THE SAFE

## 06 DUAL ALARM SYSTEM SILENCE MODE LOW BATTERY

## 07 CUSTOMER SUPPORT & WARRANTY

### ⚠ WARNING

PLEASE DO NOT MOVE THE SAFE WHILE THE DOOR IS OPEN.  
PLEASE DO CLOSE THE DOOR BEFORE MOVING THE SAFE.

Tigerking safe recommends that you do not store loaded guns in this unit.  
If you experience any problems or challenges with your safe, please feel free to contact us for quick response. Many issues can be resolved promptly without the product needing to be returned.

Our customer support team is always available to answer any questions and help to resolve all concerns you may have.

Email: [Support@tigerkingsafe.com](mailto:Support@tigerkingsafe.com)  
Facebook: [@TIGERKINGSAFES](https://www.facebook.com/TIGERKINGSAFES)  
Messenger: [m.me/TIGERKINGSAFES](https://www.m.me/TIGERKINGSAFES)

If you send email but don't get reply , please check the Spam.

## STRUCTURE

### EXTERIOR ASSEMBLY

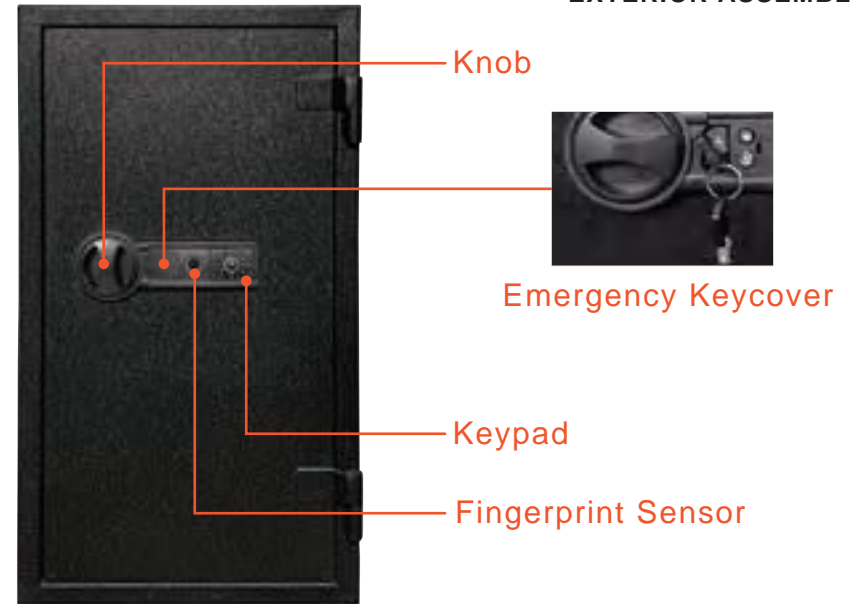

### INTERIOR ASSEMBLY

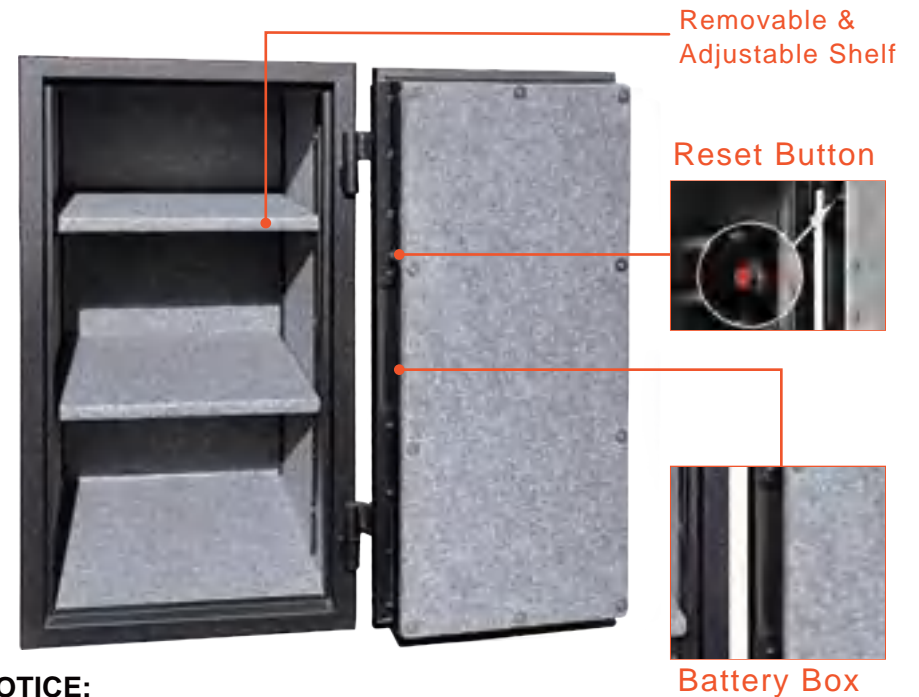

**NOTICE:**  
Different modes have different numbers of shelf .

## FIRST OPENING



**STEP 1:** Locate the 2 emergency keys (the black key) in the same bag as the instruction booklet.

**STEP 2:** Locate the emergency key hole by pushing the left side of the emergency lock cover;

**STEP 3:** Align the emergency key with the key hole and fully insert, turn the key counter clockwise to the limit, and hold on it.

**STEP 4:** At the same time, rotate the knob clockwise to open the safe.

### NOTICE:

1. When you rotate the knob clockwise, you must have the key fully inserted and turned counter clockwise to the limit, keeping the key until the safe unlocked and opened.
2. Please keep the keys in a secure place, do not lock the keys inside the safe.

## SET UP THE CODE

◆ The default code is "1234". The safe can be set with two codes.

### SET UP FIRST CODE

**STEP 1:** Open the safe, keep the safe opening;

**STEP 2:** Press "33" and then press the reset button (a red button in the hinge side of the door), the safe beeps three times, meanwhile blue indicate light flashes three times then keep lighting.

**STEP 3:** Input a new code, 4-8 digits and press "OK", the new code will be confirmed by long beep and the green light will turn on.



### SET UP SECOND CODE

**STEP 1:** Open the safe, keep the safe opening;

**STEP 2:** Press the reset button (a red button in the hinge side of the door), the safe beeps twice, meanwhile blue indicate light flashes twice then keep lighting.

**STEP 3:** Input a new code, 4-8 digits and press "OK", the new code will be confirmed by long beep and the green light will turn on.



⚠ Testing the code before you close the safe.  
By the door opening, enter the new code and press "OK", if the code is correct, the green light will turn on with two beeps, Rotating the knob to see if can get the bolts out and in.

### NOTICE:

- 1 .8 seconds without any operation after pressing the reset button, it will go back to standby mode, you need to retry from "STEP1";
- 2 .Please set up both of two codes immediately after receiving the safe.

## INSTALL BATTERIES

**STEP 1:** After first opening, keep the safe open and locate the battery compartment on the hinge.

**STEP 2:** Prepare 4 brand-new AA batteries (not included) and insert into the battery compartment by matching the + & - electrode;



### NOTICE:

- 1 .Please use brand-new batteries , do not mix used batteries with new batteries;
- 2 .Replace the batteries when the red indicate light turns on, it means the batteries are running out of power.

## FINGERPRINT SETTING

The fingerprint database is empty, no fingerprint could be read initially.

**STEP 1:** Open the safe with emergency key or programmed code;

**STEP 2:** Press reset button shortly and quickly, do not hold down the button, the keypad light will turn on with two beeps;

**STEP 3:** Swipe the first finger across the fingerprint scanner multiple times. The indicator will beep for each valid scan;

**STEP 4:** When enough valid scans have been recorded ( usually 3 scans), the green light will turn on with long beep



**⚠** Test the fingerprint before you closed the safe, By the door opening, enter the recorded fingerprint, if the fingerprint is correct, the green light will turn on with two beeps, Rotating the knob to see if can get the bolts out and in.

### Notice:

- 1.Up to 29 fingerprint could be register;
- 2.Please do not hold down the reset button when you set up the fingerprint, if you hold down the button over 5 seconds, the fingerprint will be erased;
- 3.8s without any operation, the system will go back to standby mode with light turns off, and you need to retry from STEP 1.

.4.

## OPEN THE DOOR

### Open the safe with key.

Please refer to the step "FIRST OPENING".

### Open the safe with code.

Enter the new code and press "OK", if the code is correct, the green light will turn on with two beeps, Rotating the knob clockwise to open the safe.

### Open the safe with fingerprint.

Enter the recorded fingerprint, if the fingerprint is correct, the green light will turn on with two beeps, Rotating the knob clockwise to open the safe.

### NOTICE:

The inner LED light will only turn on when you use the second way to open the safe;

## DUAL AUTHENTICATION SETTING

Dual Authentication must be password + fingerprint or fingerprint + password (can open the safe )

Only the password / fingerprint can not open the safe .

Enable Dual authentication---- press "1" and then press reset button---- with two beeps and blue light flashing---- set up successfully

Disable Dual authentication ---press "1" again and then press reset button --- with one beep and blue light flashing -----set up successfully

## CLOSE THE SAFE

Close the door and rotate the knob counter clockwise.

.5.

## DUAL ALARM SYSTEM

### Dual Alarm System

#### 1st Alarm:

Continuously inputting wrong code with three times/ wrong fingerprint with five times will activate the alarm,

The alarm will last around 20 seconds until the correct code/fingerprint entered .

#### 2nd Vibrate Alarm :

This alarm only activate after manual setting.

Press “ OK “ with long beep , the alarm set up .

The warning alarm will go off once the safe be punched or shocked. Enter the code/fingerprint can disable the alarm.

#### NOTICE

1: The vibrate alarm will be disable after code/fingerprint entered, you need set up again for the next time.

2: 8 seconds without any operation , the keypad will go back to standby status , all the operations are invalid .

## SILENCE MODE

By hold down the button “2” , you can switch tone on /tone off .

## LOW BATTERY

If with low battery, the red light will turn on , please replace with brand new 4X AA batteries immediately .

## CUSTOMER SUPPORT & WARRANTY

### Where could I find the instruction video? To see the tutorial video:

1. Go to our Facebook: **@TIGERKINGSAFES**

2. Go to our Youtube channel:

**<https://www.youtube.com/channel/UC7II4xZAK3s-cGA3Jgml9VA>**

3. contact us to get the videos (24/7):

Messenger: **m.me/TIGERKINGSAFES**

Email : **Support@tigerkingsafe.com**

If you send email but don't get reply ,  
please check the Spam.

go to our web  
**[www.tigerkingsafe-us.com](http://www.tigerkingsafe-us.com)**  
click **chat with us** to have live  
chat

### What should I do if losing the keys?

If lost emergency key ---

The numbers on the emergency key or the number in the emergency key hole.

### Customer Support /Warranty

The possible problem you might meet:

1. Cargo damaged
2. Missing accessories
3. Unsatisfied with the safe
4. Or any other setting problem

We encourage you to contact us (24/7):

Messenger: **m.me/TIGERKINGSAFES**

Email : **Support@tigerkingsafe.com**

If you send email but don't get reply , please check the Spam.

We offer 1 Year Warranty for our client and we shall find solution for you.

For details,please refer to our warranty card or contact us at

“ support@tigerkingsafe.com”.

Register your safe : [www.tigerkingsafe-rg.com](http://www.tigerkingsafe-rg.com)

Thank you for your time to read