

Window Film

❗ Please read thoroughly **BEFORE** unpacking or handling the film.

- **Window film** is very thin material that requires handling with great care. Creases and folding must be avoided and applications need to be carried out in a draught and dust free situation. Surface of application must be smooth. The temperature outside must be above +0°C during application.
- **Preparation & Pre-cleaning** : Care must be taken to flush any dirt particles out of the window frame. Some airborne dust may get under the film, but this is difficult to avoid completely and it's presence will not affect the performance of installation.
- **During drying out** some haziness will be evident and this will disappear & dry out over a 2-4 week period.
- **To avoid scratching the film with the squeegee** we recommend you wrap a piece of cloth around it first.

You will need...



Dry cloth



Ruler



Plastic Card or Squeegee



Craft Cutter or Scissors



Spray Bottle : about 2 drops of washing up liquid to 1 pint of cold water

How to apply Window Film

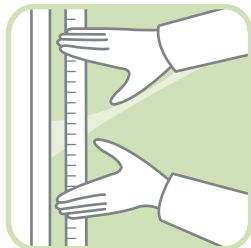

STEP 1)
Measure the glass width and length which window film will be put on.

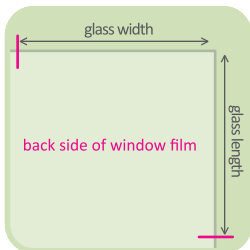

STEP 2)
On the back side of the film, mark the measurements.



STEP 3)
Cut the window film to the size using the craft cutter or scissors.



STEP 4)
Clean the glass thoroughly.



STEP 5)
Spray the window with the soapy water.

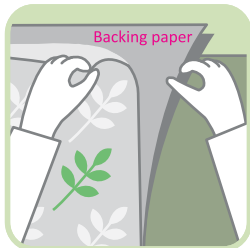

STEP 6)
Peel the backing paper of the film and apply to the wet window.



STEP 7)
Use the side of your hand to squeeze out of any large bubbles.



STEP 8)
Spray more soapy water on the surface of the film and then squeeze out small bubble starting in the centre and working to the edges.