

# **PARTS CATALOG**

## **model 418**

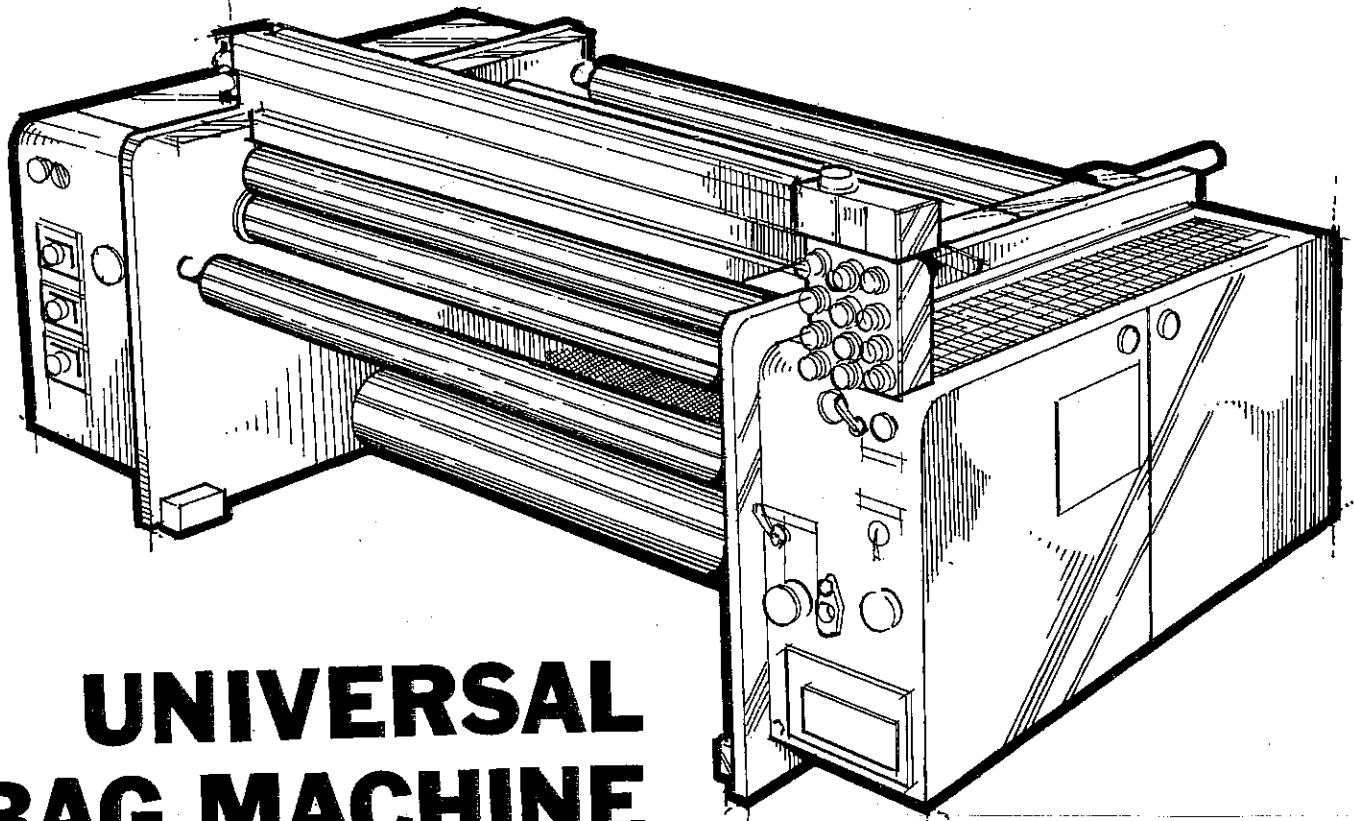

### **UNIVERSAL BAG MACHINE**

# **GLOUCESTER ENGINEERING** CO., INC.

**WARNING: POWER SHOULD BE  
DISCONNECTED BEFORE  
REMOVING ORANGE COLORED  
GUARDS.**

**NOTE: REPLACE ALL GUARDS, COVERS, AND SAFETY MARKINGS**

**SEE LAST PAGE FOR SAFETY INSTRUCTIONS**

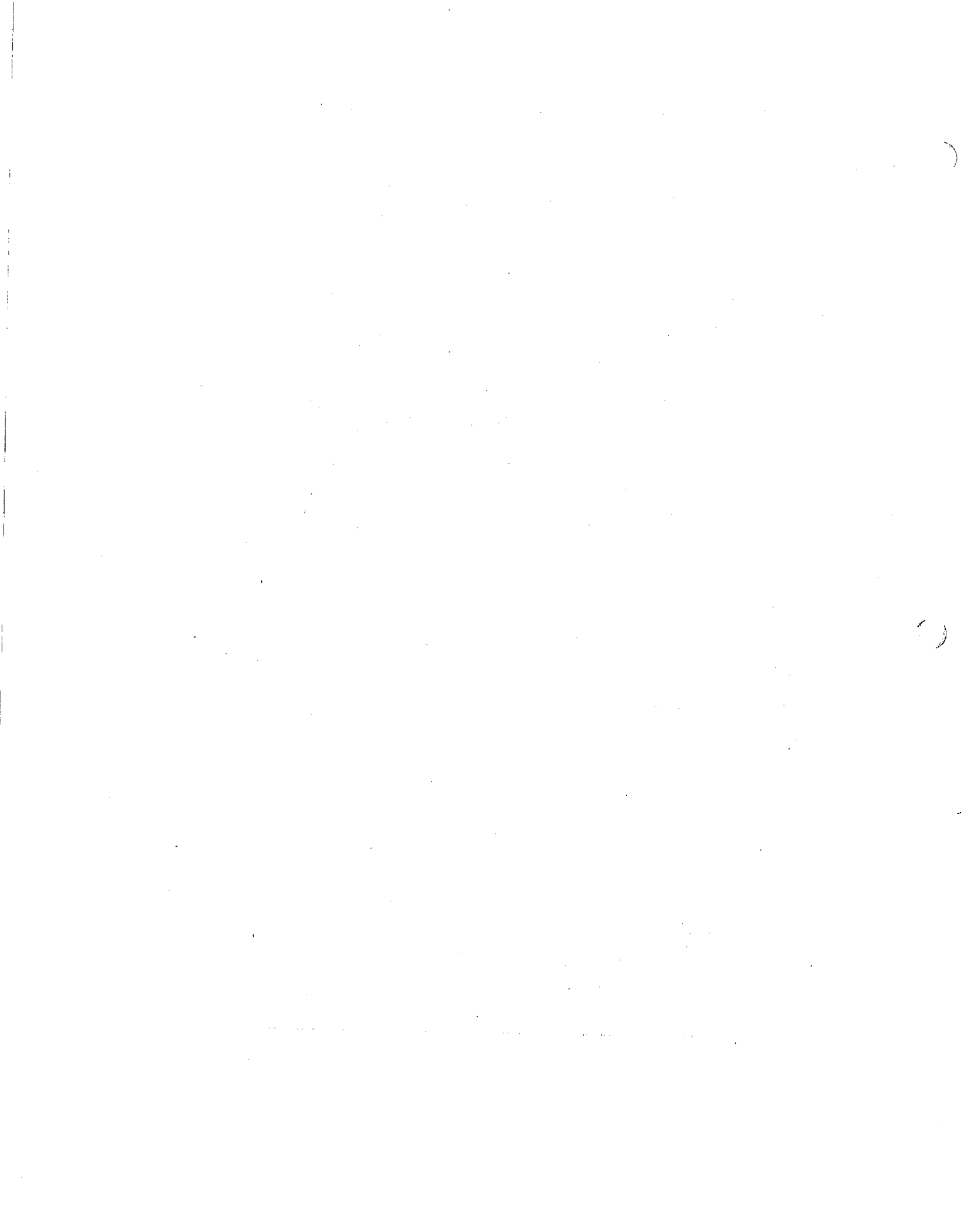

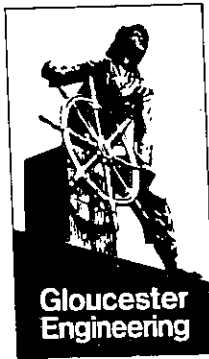

# GLOUCESTER ENGINEERING CO., INC.

18 Sargent Street, Gloucester, Massachusetts 01930 USA  
Telephone 281-1800 Area Code 617  
**TELEX 94-6524**

*European Subsidiary*  
**Gloenco Limited**  
Berry Hill Industrial Estate  
Droitwich, Worcestershire, England  
Telephone 0905-5611 / Telex 338-484

## ORDERING INSTRUCTIONS

TO ORDER GIVE PLATE NUMBER, PART NUMBER, QUANTITY, DESCRIPTION AND SERIAL NUMBER OF MACHINE.  
FOR PARTS NOT SHOWN GIVE DESCRIPTION USING CLOSEST IDENTIFIED ITEM.

EXAMPLE: DECAL ATTACHED TO TANK COVER NUMBER 145.

## SERIAL NO. \_\_\_\_\_

WRITE IN YOUR SERIAL NUMBER

The parts are positioned in the same basic areas as in the machines. Stripping and assembling are made more accessible, and recognition of parts is also easier.

The parts are illustrated individually to allow the fabrication of the machines to be comprehensive and to present individual parts more advantageously. When a part is ordered, another part may be sent with it. This is to insure competent repair, which in our opinion, would not be possible without the additional part.

Adjustments will be required for some parts in order that the part fit properly to your particular specifications, i.e., machining, drilling, grinding.

Gloucester Engineering Co., Inc. is constantly updating its machinery. Therefore, there may be instances where parts may vary.

## NOTE:

**DO NOT OPERATE THIS MACHINE WITH-OUT SAFETY DEVICES INCLUDING GUARDS AND COVERS IN THEIR PROPER POSITION.**

## 418-1 CONTROLS AND GUARDS - RIGHT SIDE

<u>KEY NO.</u>	<u>DESCRIPTION</u>	<u>PART NUMBER</u>
1	Frame, R.H.	E418-022
2	3" Bell (120 V - 60 Cycle)	#346 - Faraday
3	Enclosure, Counter	C418-608
4	Hecon Counter FAD-43 or DURANT 2000	#FAD-43
5	Die Cast, Enclosure	#800T-12TZ
6	Pressure Regulator, 60 Lbs.	Fairchild Hiller
7	Name Plate	Nip, Close, Open
8	Gauge, 2", 60 Lbs.	U. S. Gauge
9	3-Way Republic Valves	8421 + 1/4" D2P
10	Name Plate	Nip Pressure
11	Name Plate	Bag Length Setting
12	Name Plate	Head, Up, Down
13	Name Plate	Sealing Pressure
14	Seal Pressure Control	
15	Name Plate, Sealing Time	C418-230-03
16	Handle, Cam Shifter	A418-292
17	Knob, Threaded	DK31 3/8 x 16
18	3-Way Republic Valve	8421 1/4" D2P
19	Rework, Variator Remote Speed Control	
20	Name Plate	B418-132
21	Cover	C100-257
22	Enclosure	B418-195
23	Bulk Head Connector	D418-103
24	Plate, Mounting	A418-706
25	Cover, #3 Shuttle, Right	B418-449
26	Cover, #2 Shuttle, Right	A418-312
27	Cover, #1 Shuttle, Right	A418-311
28	Perforated Sheet Steel	B418-310
29	Door, Top Right	
30	Door, Front Right	
31	Bracket, Top Enclosure, Front	C418-117
32	Cover Hinge Plate	A418-136
33	Piano Hinge	B418-118
34	Cover Hinge Plate	1-16.38 Long
35	Piano Hinge	1-30.50 Long
36	Pointer	A418-364
37	Nut, Dial Gear Shaft	A418-366
38	800T-PAG-16 14	
38a	Name Plate	Drive Start
38b	Name Plate	Head Start
39	800T-B602	
39a	Name Plate	Drive Stop
40	800T-B602	
40a	Name Plate	Head Stop
41	800T-H2A	
41a	Name Plate	Run, Stop, Start
42	R651-1031 Pot	
43	800T-H2A	
43a	Name Plate	Rear Seal
44	800T-H2A	
45	800T-H2A	
45a	Name Plate	Front Seal
46	1 - Beckman Turn Model RB/Beckman AP.300K-L 25	
47	800T-H2A	
47a	Name Plate	Platen
48	800T-N1-Closing Button	
48	Spacer	A10000034
49	Knob, B-3	Reid
50	Button Head Screw	.250-20 x .750
51	Washer, Special	B005-001-49
52	Knob	DK-13
53	Control Unit	EMP-102
54	Timer (Not Shown)	1010-1F43
55	Button Head Screw	.250-20 x .50



# PLATE 418-1

## CONTROLS & GUARDS - RIGHT SIDE

FOR MACHINES WITH A ONE PIECE COVER ORDER 25,26,27 (ONE PIECE)

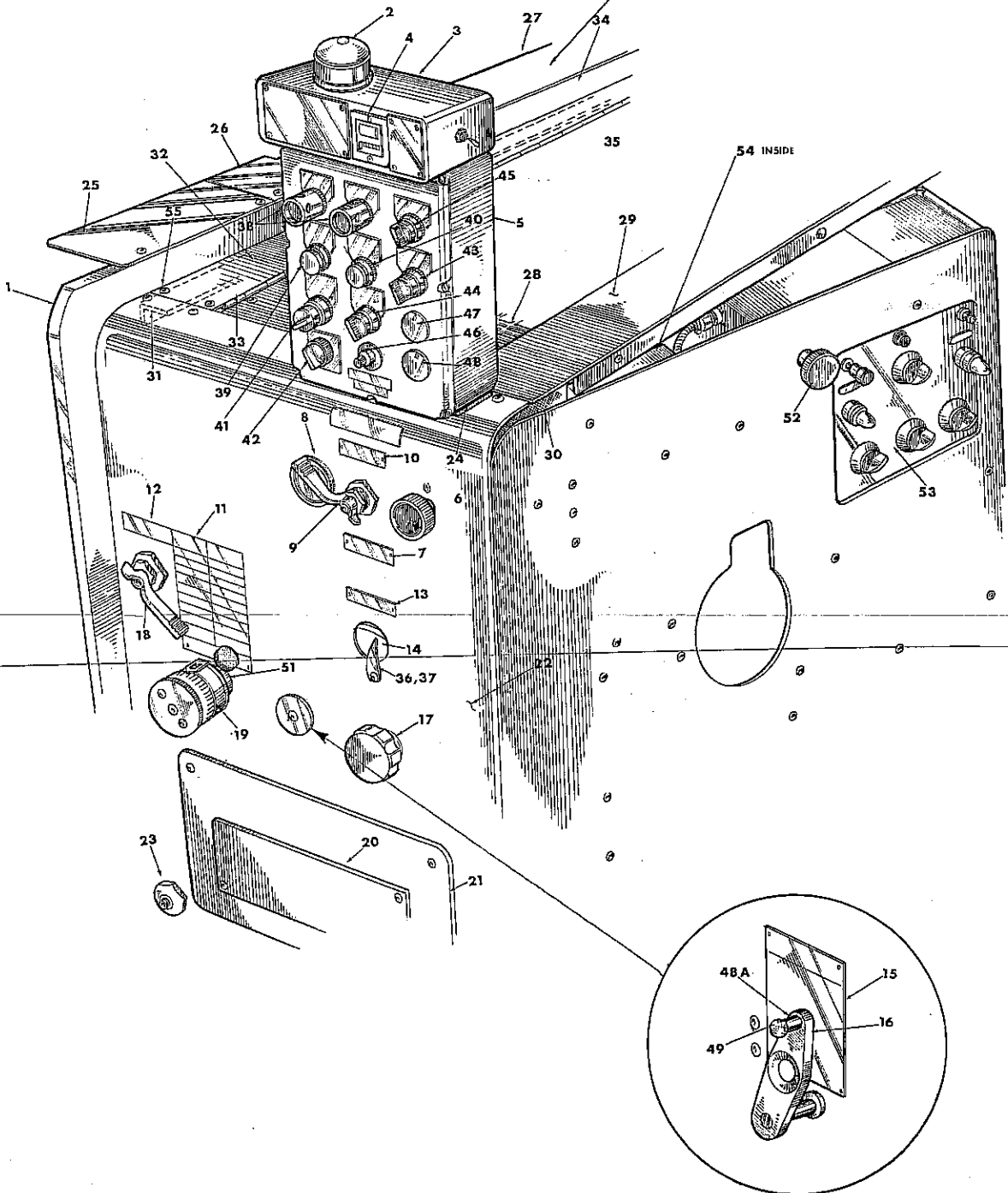

## 418-2 DRIVE ASS'Y.- RIGHT SIDE (FRONT)

<u>KEY NO.</u>	<u>NAME &amp; DESCRIPTION</u>	<u>PART NUMBER</u>
1	Bracket, Micro Switch Mounting	A10000210
2	Burgess Micro Switch	C-6-CT OR-MS
3	Hand Shaft	A418-387
4	Dynamatic Motor	1 1/2 HP
5	Pulley	16H100
6	Bushing	JA 7/8"
7	Motor Base	D418-017
8	Pulley	84H100
9	Bushing	B418-371
10	Pulley (Rework)	60LO50-B1003088
11	Bushing	SDS-3/4
12	Belt	750H100
13	Belt	480L050
14	Idler	A10000109
15	Idler Bracket	B400-083-6
16	Hydraulic Gauge	9115-W
17	Manatrol Valve	MU-400-5
18	Relief Valve, Vickers	2378
19	Gear	A418-423
20	Shaft, Head Pressure Control	A418-290
21	Nut	A418-794
22	Bushing Control Handle	A418-291-1
23	Shaft, Dial Gear	A418-363
24	Collar	3/8"
25	Gear, Globe	C2072
26	Name Plate	B418-720
27	Pump, Vickers	A10021212
28	Collar	SC-62
29	Nut, Hex.	1-14
30	Nut, Hex Jam (Cadmium Plate)	1-14
31	Coupling	A418-419
32	Socket Cap Screw	1/4-20 x 1/4
33	Cable, Flex #10929 M.H.	A418-420-4
34	Cover, Conduit Box	A418-307
35	Button Head Screw	10-32 x .375
36	Box, Conduit	G418-240
37	Hex. Cap Screw	.375-16 x 1.00
38	Sprocket	22100
39	Bushing	SDS .625 / A1005994
40	Sprocket	48L050
41	Bushing	SDS .750
42	Bearing	ER-16
43	Cap Screw	.500-13 x 1.00
44	Bracket, Idler Pulley	B10000224
45	Socket Head Cap Screw	.375-16 x 1.00
46	Hex. Cap Screw	.375-16 x 1.50
47	Arm	B400-080
48	Rod, Threaded	1/4 x 7"
49	Nut	1/4
50	Sub Plate, Relief Valve	G418-030
50A.	Plug, Sub Plate	A418-547-2
50B.	Plug, Sub Plate w/ Hole	A418-547-1
51	Screw, Sub Plate	A418-029
52	Fittings	731
53	Tubing	1" x 8"
54	Fittings	1610-6
55	Tubing	1" x 4"
56	Fittings	1610-3
57	Tubing	1" x 24"
58	Elbow	4ME
59	Socket Head Cap Screw	1/4-20 x 1"
60	Socket Head Cap Screw	1/4-20 x 5/8
61	Nut	1/4-20
62	Variator	A109 or 165A



# PLATE 418-2

DRIVE ASS'Y.-RIGHT SIDE (FRONT)

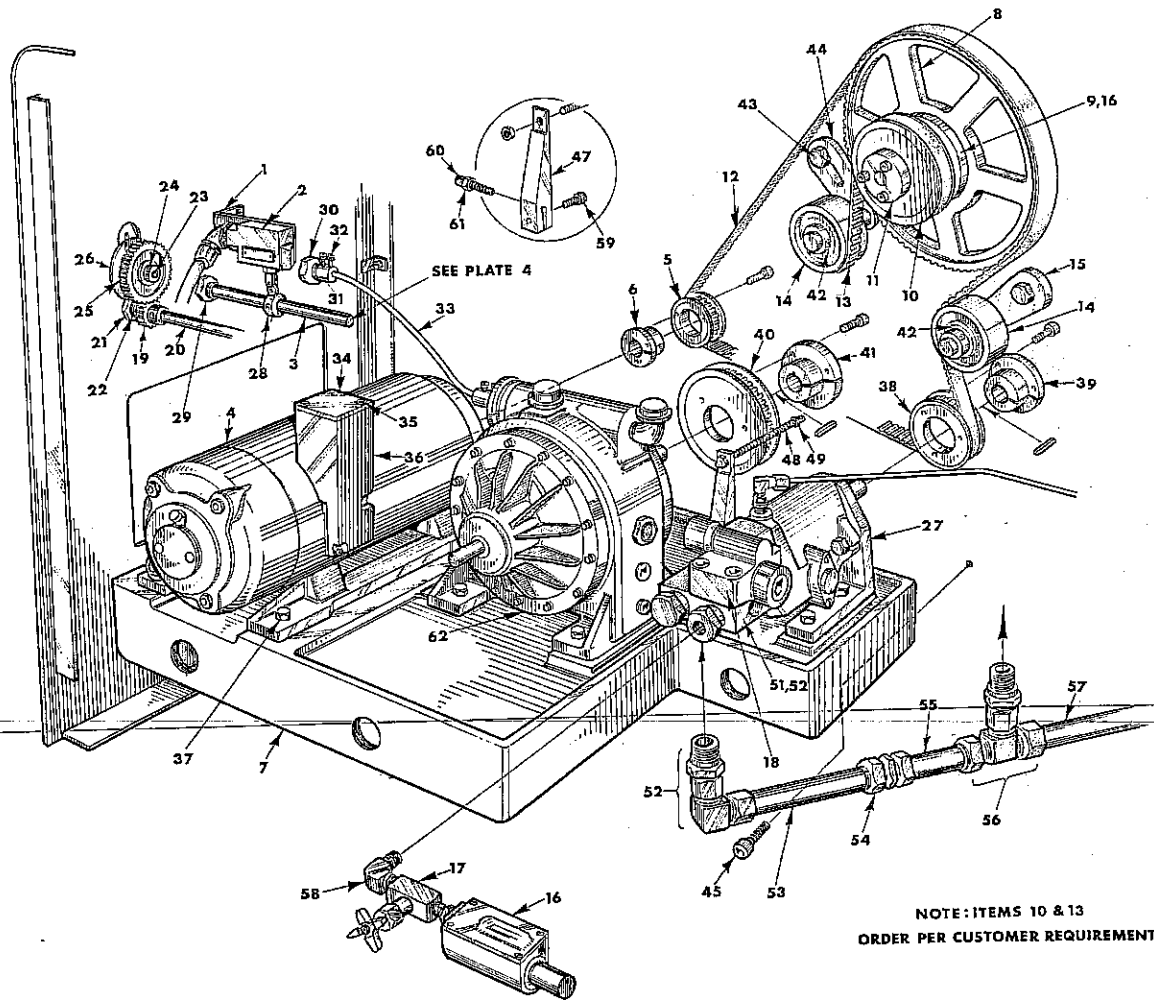

NOT SHOWN:

Solid Fitting Attached to No. 51 - A418-547-2

Tapped Fitting Attached to No. 51 - A418-547-1

"O" Rings Used with No. 18 - 154005-1 & 96550-2 (See Instruction Manual)

Washer Used with Elec. Eye Assem. on Variator - A100000360-001

## 418-3 HEAD LIFT CYLINDER-RIGHT SIDE (FRONT)

<u>KEY NO.</u>	<u>NAME &amp; DESCRIPTION</u>	<u>PART NUMBER</u>
1	Arm, Head Shaft Pivot, L.H.	B418-056
2	Bearing, Spherical	SBG-8
3	Hex. Cap Screw	.375-13 x 2.75
4	Bearing	A418-268
5	Socket Head Cap Screw	.437-14 x 1.75
6	Nut, Hex	.437-14
7	Roll Pin	.188 x .625
8	Bearing	TR-7-N
9	Nut, Hex. (Elastic)	.437-20
10	Rod, Connecting	A418-090
11	Nut, Hex. Jam (Cadium Plate)	1-14
12	Coupling	A418-419
13	Socket Head Cap Screw	1/4-20 x 1/4
14	Cable, Flex #10929 M.S.	A418-420-4
15	Coupling, Hose	BU02-03NT
16	Hydro Tubing	A10026174
17	Button Head Screw	#8-32 x 3/8
18	Nut	#8-32
19	#8 (Cadmium Plate Steel Sash)	#8
20	Sway Lock	810-1-OR
21	Elbow	4ME
22	Republic Valve	453-1/4D2-10
23	Republic Valve	8421-1/4-D2P
24	Fitting	7205-5-4





# PLATE 418-3

## HEAD LIFT CYLINDER - RIGHT SIDE (FRONT)

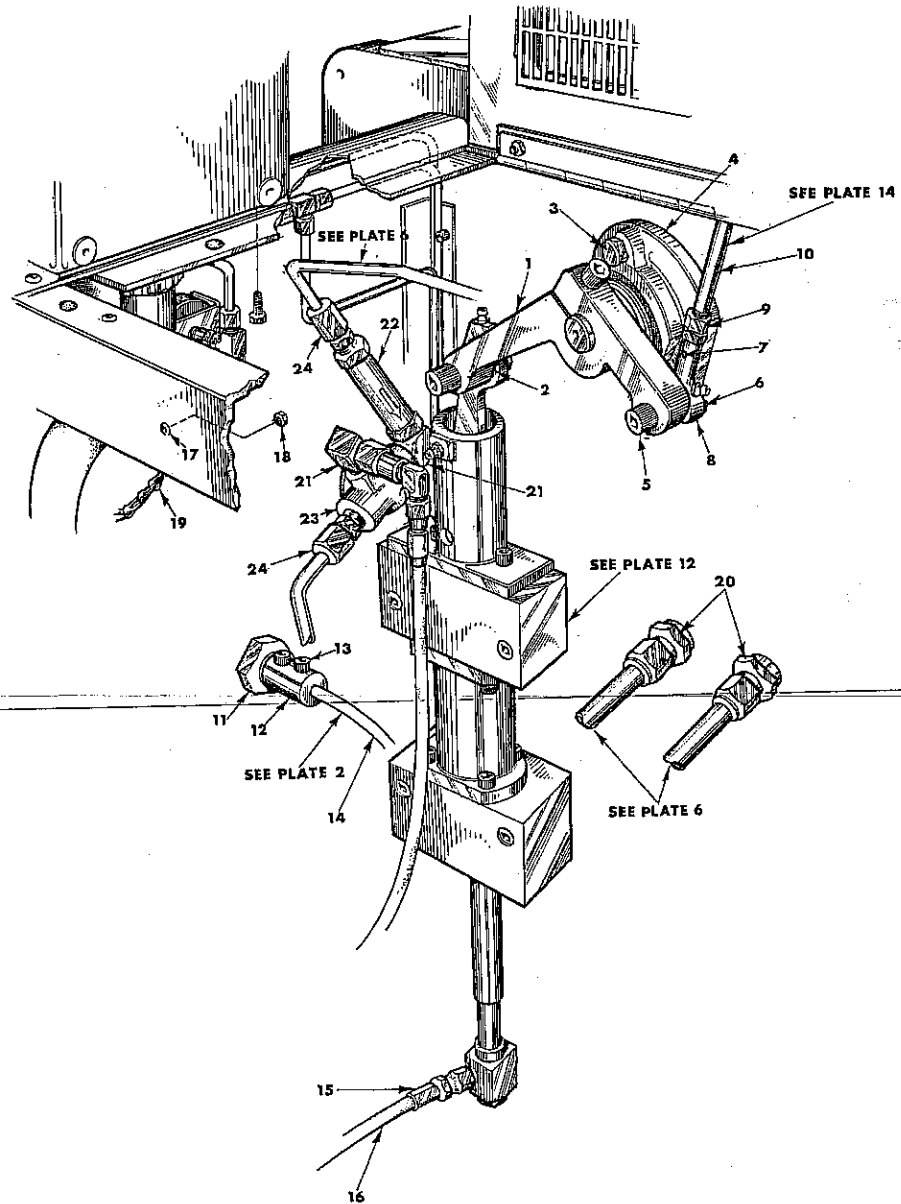

418-4 VALVE CAMSHAFT DRIVE ASS'Y. WITH REGISTER CONTROL - RIGHT SIDE

KEY NO.	NAME & DESCRIPTION	PART NUMBER	KEY NO.	NAME & DESCRIPTION	PART NUMBER
1	Knob, Shuttle Cam, Adjustable	A418-081	71	Button Head Socket Set Screw	.250-20 x .500
2	Lifter, Plunger	A418-408	72	Socket Set Screw	8-32 x 1.00
3	Pinion	A418-410	73	Bearing, Needle	B-88
4	Shaft, Skip Cycle Cam	A418-413	74	Cam Roll	CF-5/8-S
5	Shaft, Cam Shuttle	A418-554	75	Nut, Elastic Stop	52NTE-48
6	Plunger, Head Cam	A418-556	76	Socket Set Screw	.375-16 x .375
7	Plunger, Shuttle Cam	A418-557	77	Ball, Plunger	W7-N
8	Pin, Plunger, Adjustable	A418-558	78	Socket Head Cap Screw	.250-20 x .750
9	Bracket, Skip Cycle Slide	A418-559	79	Dowel Pin	.375 x 2.00
10	Slide, Skip Cycle	A418-560	80	B l a n k	
11	Block, Cam Shifter	A418-561	81	Socket Head Cap Screw	10-32 x .875
12	Clamp, Slide	A418-565	82	Socket Head Cap Screw	.250-20 x .875
13	B l a n k		83	Socket Head Cap Screw	.375-16 x 1.00
14	B l a n k		84	Socket Head Cap Screw	.250-20 x 2.75
15	Rod, Cam Shifter	A418-617	85	Socket Head Cap Screw	.312-18 x 1.50
16	Gear, Skip Cycle	B418-409	86	B l a n k	
17	Plate, Quadrant	B418-455	87	Button Head Socket Screw	.250-20 x .500
18	Bushing, Cam	B418-553	88	B l a n k	
19	B l a n k		89	B l a n k	
20	Retainer Bearing	B418-562	90	B l a n k	
21	Hub, Gear or Pulley	B418-563	91	B l a n k	
22	Slide, Head Lifter	B418-564	92	B l a n k	
23	Washer	B005-001-27	93	B l a n k	
24	Washer	B005-001-28	94	B l a n k	
25	B l a n k		95	B l a n k	
26	B l a n k		96	B l a n k	
27	B l a n k		97	B l a n k	
28	Cam, Shuttle	C418-008	98	B l a n k	
29	Cam, Head	C418-086-1	99	B l a n k	
30	Cam, Head	C418-086-2	100	Pulley	A418-183
31	Cam, Head	C418-086-3	101	Sleeve	A418-184
32	Cam, Head	C418-086-4	102	Sleeve	A418-185
33	Cam, Head	C418-086-5	103	Gear, Phenolic	A418-186
34	Cam, Skip Cycle	C418-418	104	Pinion	A418-784
35	Shaft, Head Cam	C418-552	105	Gear	A418-188
36	B l a n k		106	B l a n k	
37	B l a n k		107	Plate, Mounting	A418-209
38	B l a n k		108	B l a n k	
39	Spool, Directional Valve	A400-065 (Not Shown)	109	B l a n k	
40	Cam Shaft Housing Cover	D418-454	110	Gear	B418-189
41	Dual, Sub Plate	A418-021	111	Gear	B418-786
42	B l a n k		112	Gear	B418-192
43	B l a n k		113	Gear	B418-191
44	B l a n k		114	Washer	B005-001-14
45	Cam Shaft Housing	E418-495	115	B l a n k	
46	B l a n k		116	B l a n k	
47	B l a n k		117	B l a n k	
48	B l a n k		118	Bearing, Ball	MRC-105-KSZZ
49	Key	3/4 x 1/4	119	Snap Ring (Truarc)	5002-185
50	Key	5/8 x 1/4	120	Dowel Pin	.500 x 1.25
51	B l a n k		121	Socket Head Cap Screw	.250-20 x 1.50
52	B l a n k		122	B l a n k	
53	B l a n k		123	B l a n k	
54	B l a n k		124	Socket Head Cap Screw	.250-20 x .750
55	B l a n k		125	B l a n k	
56	B l a n k		126	Socket Head Cap Screw	10-32 x .750
57	B l a n k		127	Socket Head Cap Screw	.312-18 x .750
58	Directional Valve	A10022779	128	B l a n k	
59	Grease Fitting	.250-28	129	Socket Set Screw	.250-20 x .500
60	Socket Set Screw	.250-20 x .500	130	Belt	187L050
61	Roll Pin	.250 x 2.00	131	Flat Head Socket Cap Screw	10-32 x .375
62	B l a n k		132	Register Control Unit	EMP-Model 102
63	B l a n k		133	Bushing	JA-1.125
64	Nut, Hex. Jam	1.250-12	134	Pulley	22L050
65	"O" Ring (Parker)	2-14	135	Motor	34439
66	B l a n k				
67	Roll Pin	.125 x .750			
68	Bearing, Ball	R-20 ZZ			
69	Snap Ring (Heavy Duty)	5160-125			
70	Snap Ring	5100-125			



# PLATE 418-4

## VALVE CAMSHAFT DRIVE ASS'Y. WITH REGISTER CONTROL—RIGHT SIDE

NOT SHOWN:

"O" Ring Used with No. 58 - 2-014

Cover for No. 58 - C10015558

"O" Ring Used with No. 58 Bottom Section - 2-125

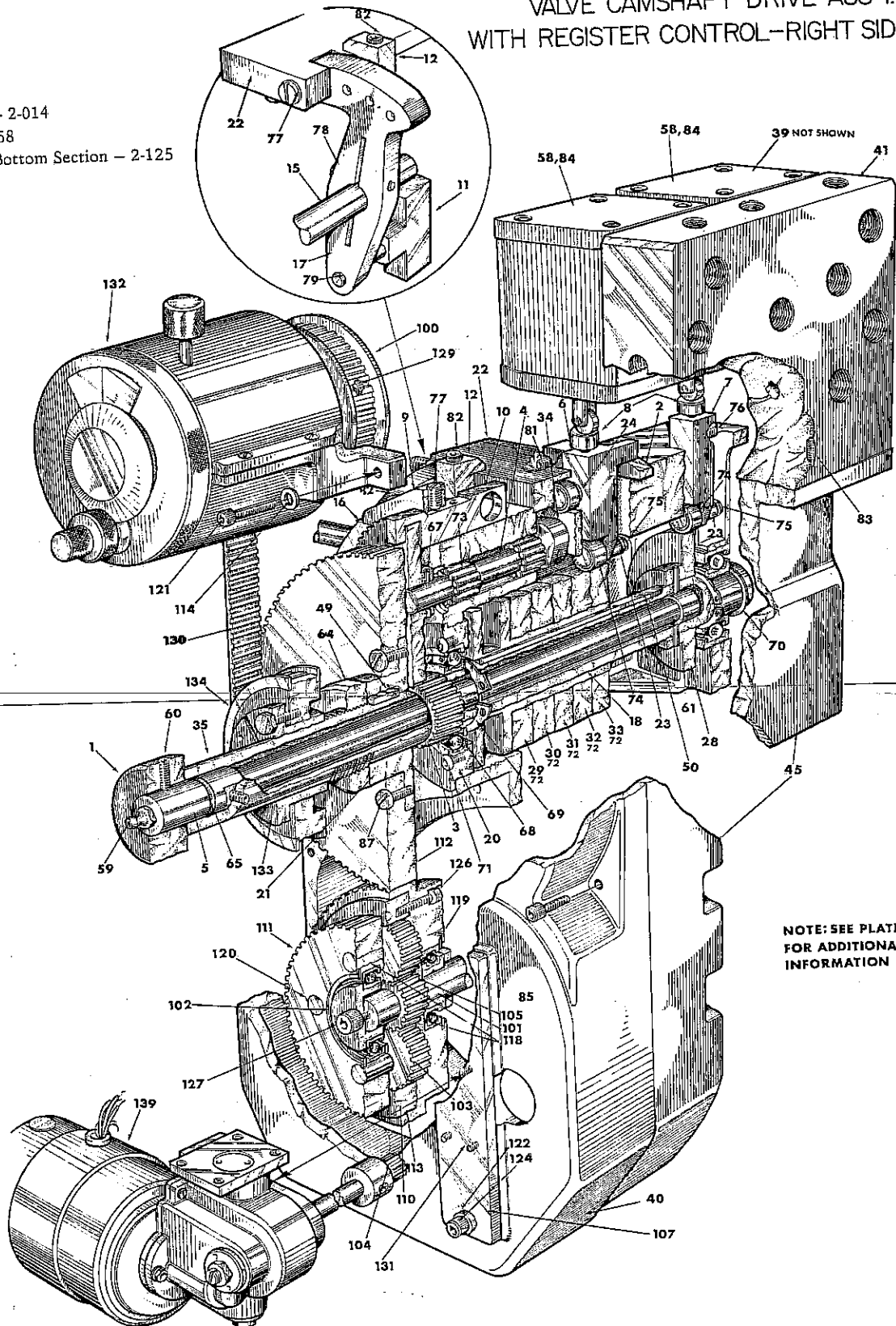

418-5 VALVE CAMSHAFT DRIVE ASS'Y. ELECTRIC HEAD SWITCHING ASS'Y.

KEY NO.	NAME & DESCRIPTION	PART NUMBER		
1	Grease Fitting	.250-28		
2	Knob, Shuttle Cam Adjustment	A418-081		
3	Socket Set Screw	.250-20 x .500		
4	Bushing	JA-1.125		
5	Pulley	22L050		
6	Cover, Cam Shuttle Housing	D418-454		
7	Socket Head Cap Screw	.312-18 x 1.50		
8	Washer	.250 Std.		
9	Nut, Hex.	.250-20		
10	Nut, Hex. Jam	1.250-12		
11	Gear	B418-192		
12	Hub, Gear or Pulley	B418-563		
13	Pinion	A418-410		
14	Bearing, Ball	MRC R-20ZZ		
15	Bearing, Retainer	B418-562		
16	Button Head Socket Cap Screw	.250-20 x .500		
17	Button Head Socket Cap Screw	.250-20 x .500		
18	Snap Ring	5160-125		
19	Bushing, Cam	B418-553		
20	Cam, Head	C418-086-1		
21	Cam, Head	C418-086-2		
22	Cam, Head	C418-086-3		
23	Cam, Head	C418-086-4		
24	Cam, Head	C418-086-5		
25	Gear, Skip Cycle	B418-409		
26	Cam, Shuttle	C418-008		
27	Bearing, Needle (Torrington)	B-88		
28	Roll Pin	.125 x .750		
29	Roll Pin	.250 x 2.00		
30	Shaft, Skip Cycle	A418-413		
31	Shaft, Cam Shuttle	A418-554		
32	"O" Ring (Parker)	2-14		
33	Shaft, Head Cam	C418-552		
34	Key	3/4 x 1/4		
35	Key	5 3/8 x 1/4		
		36	Socket Head Cap Screw	.312-18 x .75
		37	Sleeve	A418-185
		38	Snap Ring (Truarc)	5002-185
		39	Dowel Pin	.500 x 1.25
		40	Bearing, Ball (MRC)	105-KSZZ
		41	Gear	B418-786
		42	Gear, Phenolic	A418-186
		43	Gear	A418-188
		44	Gear, Internal	B418-189
		45	Gear	B418-191
		46	Socket Head Cap Screw	10-32 x 1"
		47	Bearing, Ball (MRC)	105-KSZZ
		48	Sleeve	A418-184
		49	Snap Ring (Truarc)	5002-185
		50	B l a n k	
		51	Cam Shaft Housing	E418-495
		52	Snap Ring	5100-125
		53	Bearing, Ball	R-20-ZZ
		54	Block, Cam Shifter	A418-561
		55	Slide, Skip Cycle	A418-560
		56	Plate, Quadrant	B418-455
		57	Rod, Cam Shifter	A418-617
		58	Clamp, Slide	A418-565
		59	Socket Head Cap Screw	.250-20 x .875
		60	Ball, Plunger	W7-N
		61	Socket Head Cap Screw	.250-20 x .875
		62	Bracket, Skip Cycle Slide	A418-559
		63	Plunger, Head Cam	A418-556
		64	Plunger, Shuttle Cam	A418-557
		65	Pin, Plunger Adjustment	A418-558
		66	Lifter, Plunger	A418-408
		67	Socket Head Cap Screw	10-32 x .875
		68	Slide Head, Lifter	B418-564
		69	Cam Roll	CF-5/8-S
		70	Cam, Skip Cycle	C418-418
		71	Roll Pin	.125 x .750

ELECTRIC HEAD SWITCHING ---- SOL. VALVE ---- ASS'Y. WITH OUT REGISTER CONTROL

KEY NO.	NAME & DESCRIPTION	PART NUMBER
1	Pulley, Cam Shaft	B418-555
2	Belt	240L-075
3	Pulley	A418-659-3
4	Variator, Speed	2K4-109
5	Socket Shoulder Screw	5/16 x 1/4
6	Socket Head Cap Screw	1/4-28 x 1
7	Micro Switch	BZLN-RH
8	Brass Plug	.281 x .250
9	Cam, Head	B418-616
10	Bracket, Micro Switch	B418-607
11	Socket Set Screw	.375-16X.750 - A10003758
12	Plunger, Shuttle Cam	A418-557
13	Cam, Skip Cycle	A418-614
14	Plate, Micro Switch Mounting	B418-718
15	Block, Height Adjustment	A418-719
16	Valve, Directional	A10022778
17	Belville Washer	.625 x .032
18.	Plunger, Micro Switch	A418-615 (see A418557 for location)

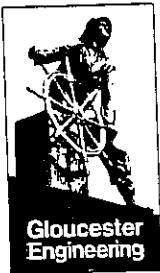

# PLATE 418-5

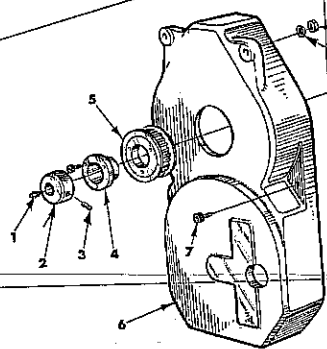
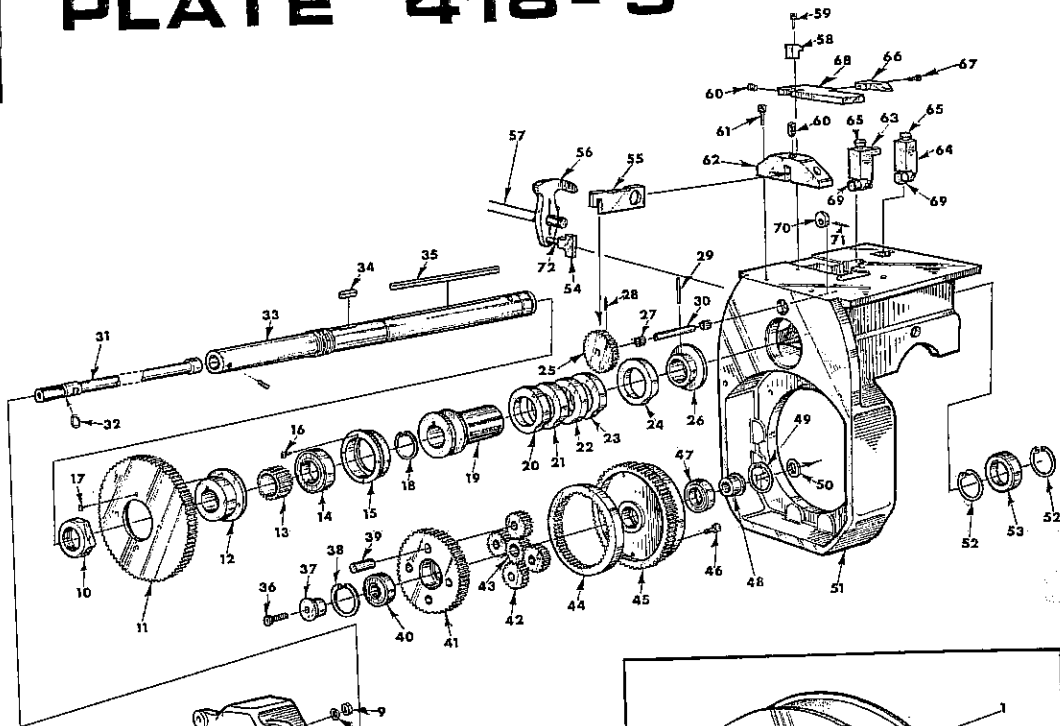

ELECTRIC HEAD SWITCHING ASS'Y.

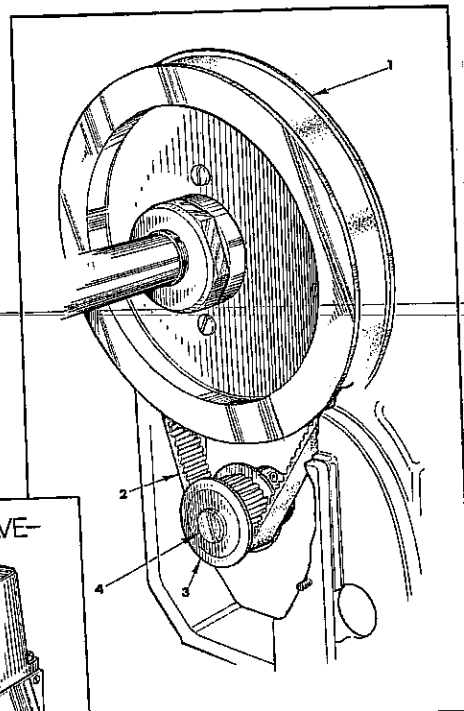

WITH OUT REGISTER CONTROL

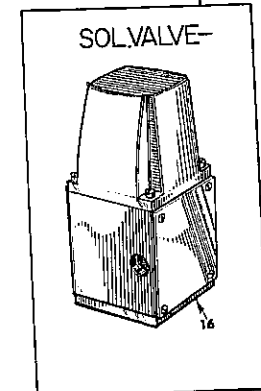
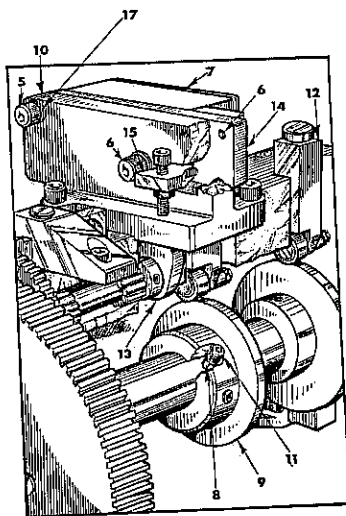

USED WITH ELEC. HEAD

418-6 HYDRAULIC LINES - RIGHT SIDE

<u>KEY NO.</u>	<u>NAME &amp; DESCRIPTION</u>	<u>PART NUMBER</u>
1	Elbow, Double Tank	A418-154
2	Swaylock	811-A-OR
3	"T"	810-3

①	D10000022	}
②	D10000021	
③	D10000024	
④	B10000024	
⑤	D100000020	
⑥	C10000021	
⑦	C10000020	
⑧	C10000024	
⑨	C10000023	
⑩	C10000022	

4	Coupling	A418-289
5	Tubing	1/2
6	Tubing Holder	A418-339
7	Swaylock Fitting	810-1-OR
8	Swawlock Fitting	500-1-OR
9	Plug	B418-424
10	Tubing	A418-290
11	Tubing	5/16
12	Gear	S2024
13	Fitting	7205-5-4
14	Nipple	12CN
15	"T"	7715-6

○ ORDER OF ASSEMBLY



# PLATE 418-6

## HYDRAULIC LINES - RIGHT SIDE

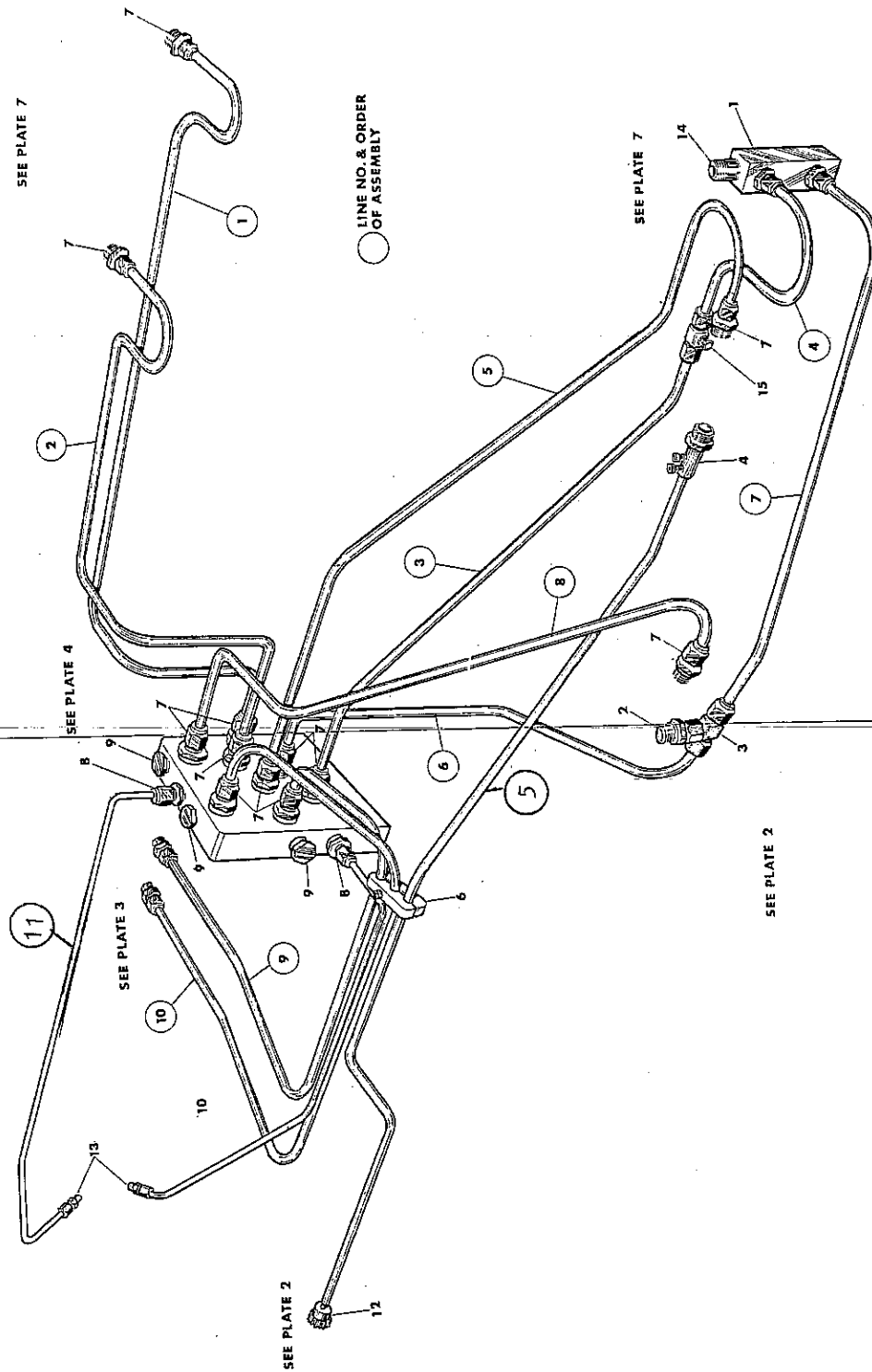

418-7 HYDRAULIC TANK ASS'Y.- RIGHT SIDE

<u>KEY NO.</u>	<u>NAME &amp; DESCRIPTION</u>	<u>PART NUMBER</u>
1	Tank, Hydraulic Oil	D400-126
1A.	Bushing (inside tank - not shown)	A418-153
2	Filler, 321550-SP-113C	Vickers
3	Cover	B400-135
3A.	Gasket (not shown)	B10006285
4	Electrical Box	
5	Rosaen Telltail Filter	650-S-20-M-3-EE-1.46
6	Dollinger Sump Filter	M33H-1-10-215239
7	Coupling, Reducer	A418-153
8	Reliance Motor	1 1/2 HP
9	Sub Plate Relief Valve	C418-030
10	Screw, Sub Plate	A418-029
11	Pump, Vickers	A10021111
12	Right Rear Door	C418-117
14	Enclosure, Right Rear Side	C418-104
15	Plate, Top Door Support	A418-122
16	Angle	B418-123
17	Relief Valve, Vickers	2378
18	Fitting	1610-3
19	Fitting to Filter	1610-1-16
20	Chain (Cadmium Plate St. Sash)	#8
21	Button Head Screw	8-32 x 3/8
22	Nut	8-32
23	Tubing	
24	Tubing A10000189	
24A.	"T" Fitting	7715-6
25	Socket Head Cap Screw	1/4-20 x 1/2

Note: Use Delvac Special Oil 10-20-30 Oil





# PLATE 418-7

HYDRAULIC TANK ASS'Y.—RIGHT SIDE

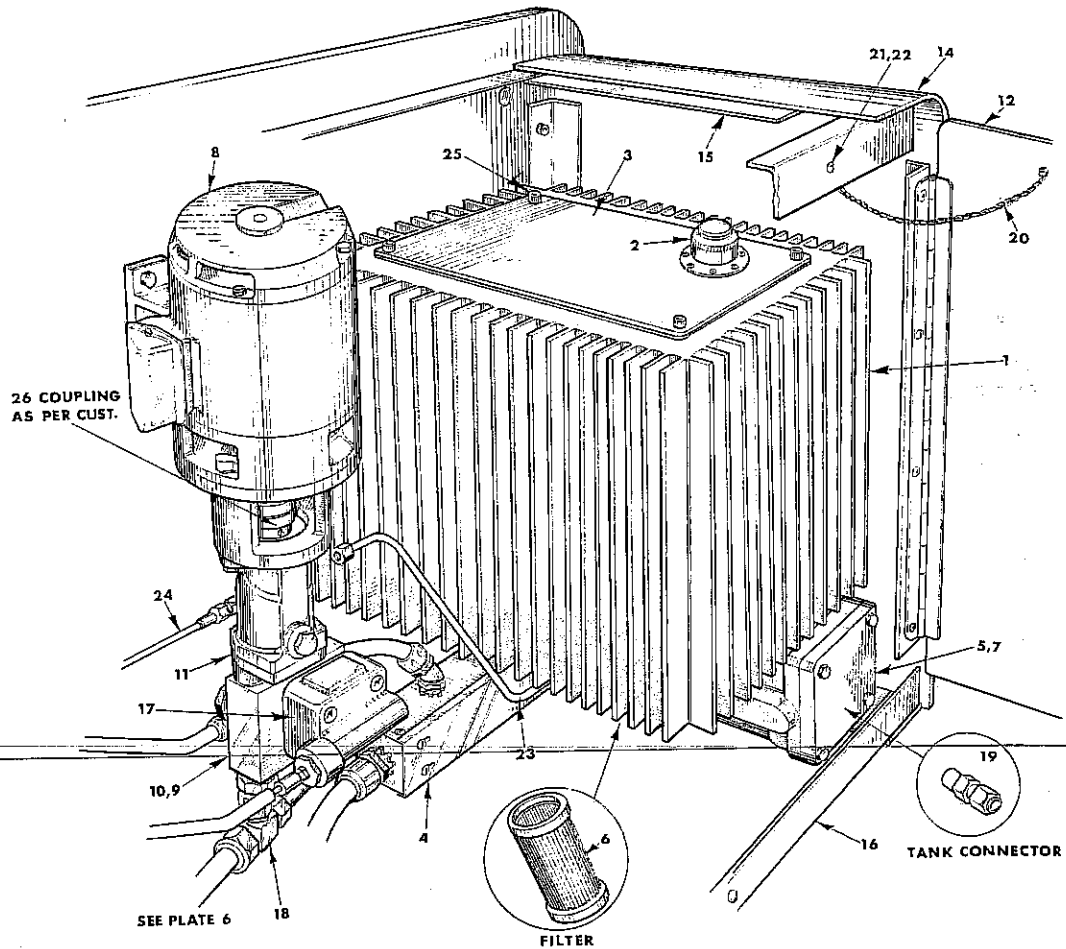

**NOT SHOWN:**

Tank Bushing — A418-153

Tank Block — A418-154 ( See 418-6)

Fitting Assembly Used with No. 17 — A418-289 & A418-419

Washer Used with No. 17 — B005-001-116-2

Pipe Filter to Pump — B1000023

## 418-8 DANCER AND IDLER ROLL ASS'Y.

<u>KEY NO.</u>	<u>NAME &amp; DESCRIPTION</u>	<u>PART NUMBER</u>
1	Guard, Piston Rod	B418-127
2	Arm, Pivot, Shuttle Drive	B418-055
3	Shuttle Drive	A418-155
4	Idler	C100-394-1
5	Stub, Shaft	A100-175-3
6	Arms, Double Dancer	B100-113-1
7	Dancer Shaft	A418-168
8	Counter Weight Dancer	A418-333
9	Support	A418-313.
10	Socket Cap Screw	.375-16 x 1.50
11	Bearing	R24ZZ
12	Collar	SC150
13	Bearing	R-24FF
14	Socket Head Cap Screw	.375-16 x 1.25
15	Shaft (Girt)	B418-169
16	Nut, Hex.	.375-16
17	Socket Head Cap Screw	.375-16 x 1.50
18	Stop, Head	A418-176
19	Socket Cap Screw	.250-20 x 1.75
20	Bumper, Rubber	1108
21	Button Head Socket Cap Screw	.250-20 x .50
22	Socket Head Cap Screw	.500-13 x 2.75
23	Bearing	MRC-16
24	Bulkhead, Connector	A418-706
25	Cover #1	B418-310
26	Cover #2	A418-311
27	Cover #3	A418-312
28	Leveling Block	B400-154
29	Socket Head Cap Screw	.500-13 x 2.25
30	Leveling Screw	A400-120
31	Shaft	A418-396
32	Order as Unit (Electric Eye)	
33.	Spacer (Used next to hinged plate)	A10008680
34.	Support, for Shaft No. 31	A418-395
1A.	Piston Guard - Used w/ Winding Attach.	B418-174



# PLATE 418-8

DANCER AND IDLER ROLL ASS'Y.

TO ORDER ONE PIECE COVER SEE PLATE 1

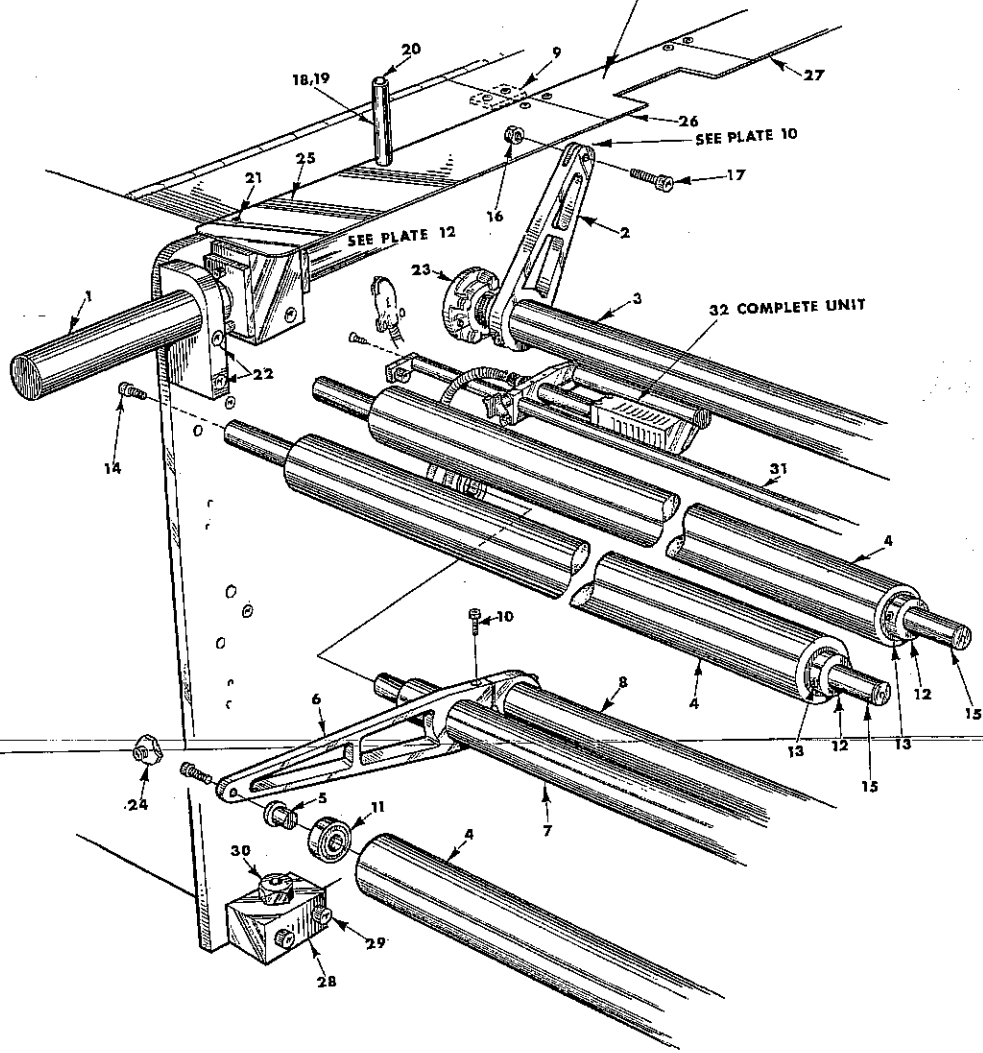

418-9 NIP ASS'Y. WITH REAR LOCKDOWN ASS'Y.

<u>KEY NO.</u>	<u>NAME &amp; DESCRIPTION</u>	<u>PART NUMBER</u>
1	Cylinder (Miller)	362905
2	Arm, Double Nip Roll	A418-147
3	Shaft (Indicate L.S. or R.S)	A418-C96
4	Block, Connector	A418-146
5	Rubber Roll	C10002960
6	Bearing	207
7	Bushing	A418-062
8	Bearing	10SS B.G.
9	Link, Nip Roll	B418-385
10	Hand Shaft	A418-387
11	Eccentric Shaft	A418-386
12	Spacer Mounting	A418-125
13	Socket Cap Screw	.375-18 x 1.25
14	Roll Pin	.500 x 1.50
15	Socket Shoulder Screw	.650 x 1.00, Shoulder .500-
16	Socket Shoulder Screw	.500 x .750
17	Socket Shoulder Screw	.375 x .375
18	Stub, Shaft	A418-096-1
19	"T"	3700-4
20	Elbow	4 ME

FOR 100 INCH MACHINE ONLY

5	Rubber Roll	C10030164
5	Chrome Roll	C10030165
9	Link	B10032537
11	Rod	B10032538



# PLATE 418-9

NIP ASS'Y. WITH REAR LOCK DOWN ASS'Y.

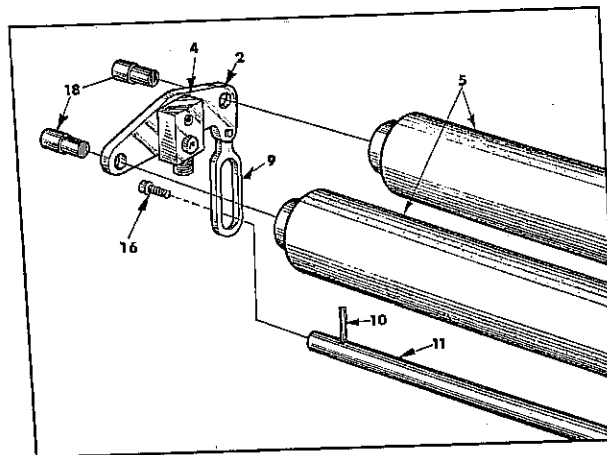
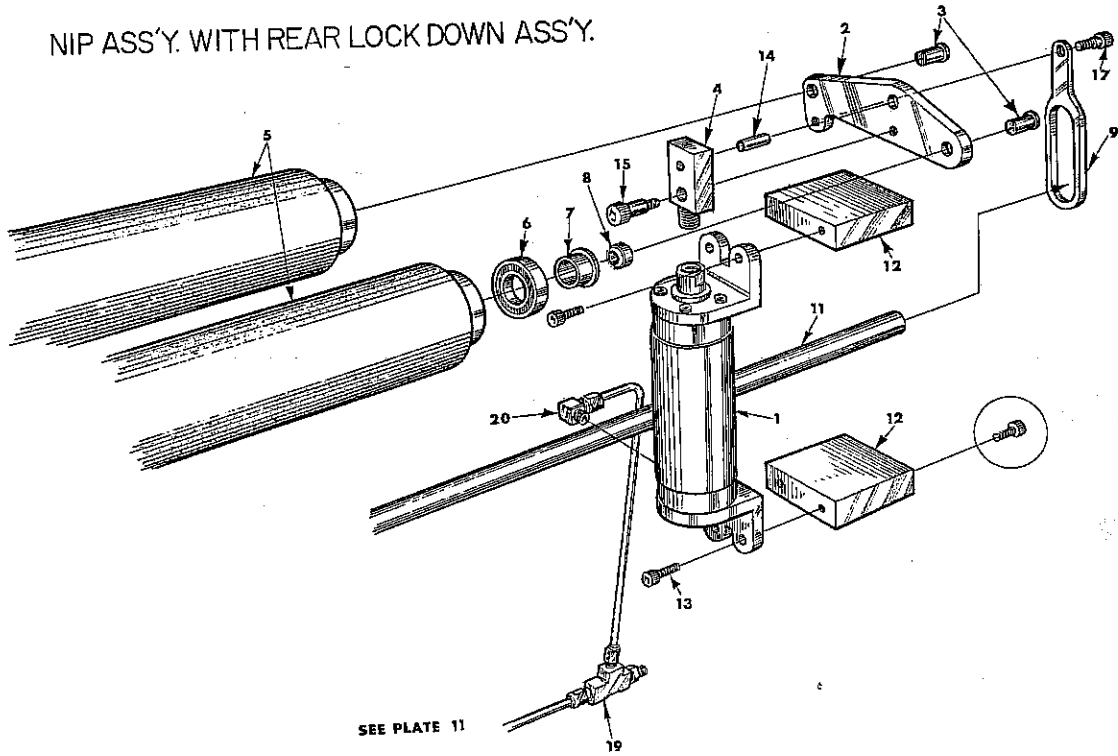

<u>KEY NO.</u>	<u>NAME &amp; DESCRIPTION</u>	<u>PART NUMBER</u>
1	Pad Wear (L.S. Pt. 2)	A418-004-1 R.S.
2	Bracket Platen	B418-053
3	Head Arm	D418-064
4	Way, Shuttle	A418-076-1
5	Shuttle Frame	C418-019
6	Shuttle Roll	D418-001
6A.	Sprocket (see no. 6)	A418-005
7	Link; Connecting	A400-053
8	Bearing	SBG-7S
9	Guide, Shuttle Cylinder	A418-271
10	Bracket, Shuttle Idler	B418-087
11	Pulley	B10001338
12	Rework Bearing	A1000406
13	Chrome Roll	C418-025
14	Idler Shaft	A418-089-1
15	Idler	A418-061
16	Bearing	ER19
17	Idler	C100-394-1
18	Bearing	R22-FF
19	Shaft, Girt	B418-168
20	Bearing	A418-362
21	Hex. Cap Screw	.312-18 x 1.50
22	Coupling, Shuttle Half	A418-131
23	Coupling, Piston Rod Half	A418-130
24	Socket Head Cap Screw	.250-20 x 1.25
25	Socket Head Cap Screw	.437-14 x 2.25
26	Spacer	B006-001-6
27	Frame, R.H.	E418-022
28	Washer	B005-001-2
29	Hex. Cap Screw	.375-16 x 1.50
30	Bearing	ER-19
31	Socket Head Cap Screw	.312-18 x 1.25
32	Grease Fitting	.250-28
33	Belt	800-200
34	Sprocket	18H200
35	Bushing	1.25 SH
36		
37	Roll Pin	.250 x 1.00
38	Grease Fitting	.250-28
39	Bushing	A418-102
40	Socket Shoulder Screw	.625 x 1.00
41	Washer, Thrust	.625 x 1.0 x 1.25 x .094
42	Collar	SC150
43	Flat Head Screw	A10021493
44	Roller	CF-1-S
45	Nut	7/16-20
46	Spacer, Cam Roll	A400-014
47	Grease Fitting	3005
48	Roll Pin	.125 x .625
49	Bearing	206
50	Bearing	304
51	Snap Ring	5002-244
52	Snap Ring	5100-78
53	Shuttle Stud	B418-002
54	Spacer	A418-003-1
55	Socket Head Cap Screw	.375-16 x 1.25
56	Swaylock Fitting	810-1-OR
57	Tubing	½" A10000027
58	Tubing	½" A10000026
59	Dowel Pin	.500 x 2.50



# PLATE 418-10

## SHUTTLE ASS'Y.

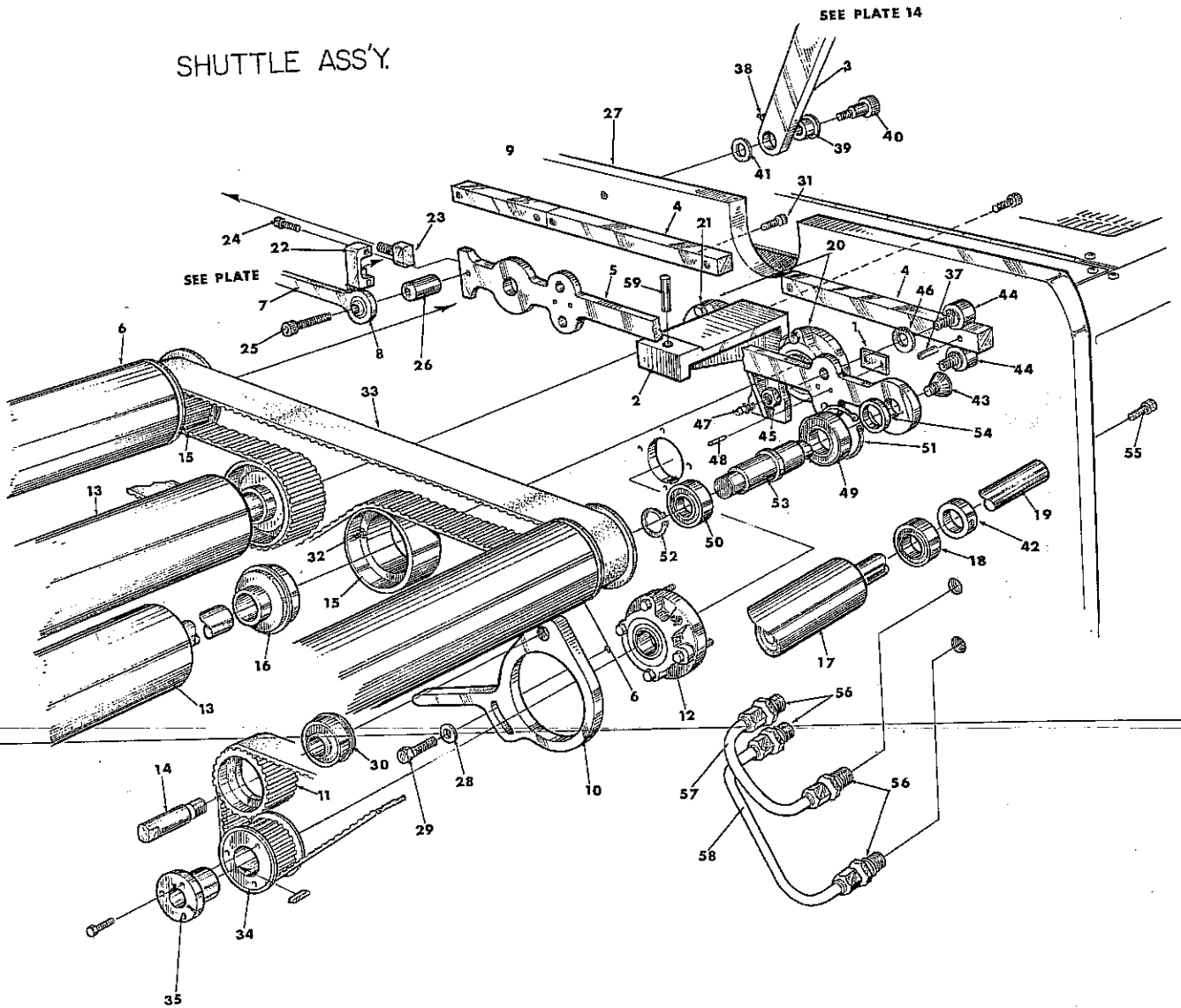

NOT CALLED OUT: PULLEY ATTACHED TO NO. 6 - A418-005

## 418-11 SHUTTLE ASS'Y. AND METERS

<u>KEY NO.</u>	<u>NAME &amp; DESCRIPTION</u>	<u>PART NUMBER</u>
1	Bracket Platen	B418-054
2	Shuttle Frame	C418-020
3	Rod, Platen Support	A418-149
4	Bracket Mounting	A418-261
5	Girt, 6"	C100-115
6	Leveling Screw	A400-120
7	Leveling Block	B400-154
8	Name Plate - Sealing Draw-Increase-Decrease	
9	Enclosure	C418-381
10	Pressure Regulator (Fairchild-Hiller)	11848
11	Gauge (30 Lbs. 2" U.S.)	
12	Name Plate - Input Tension	
13	Frame, L.H.	E418-022
14	Barber Colman Meter	272P
15	Idler	C100-394-1
16	Bearing	A418-268
17	Hex. Cap Screw	.375-16 x 1.50
18	Socket Head Cap Screw	.500-13 x 2.25
19	Nut, Hex.	.500-20
20	Spacer	B006-001-7
21	Socket Head Cap Screw	.475-14 x 1.00
22	Bearing	SBG-7S
23	Link, Connecting	A400-053-1
24	Shuttle, Drive	A418-155
25* to 32*	Order by Key No. Only	
33	Barber Colman Meter	72G
34	Rod, Connecting Head	A418-090
35	Bearing	TRE7-N
36	Nut, Hex. Elastic	.437-20
37	Elbow	4ME





# PLATE 418-11

SHUTTLE ASS'Y. & METERS

\*ORDER BY KEY NO. ONLY

- \*31-2-48" WIRE-39" G.F.
- \*32-36" G.F. PLATEN
- \*26-2-48" WIRE-39" G.F.
- \*25-36" G.F. PLATEN

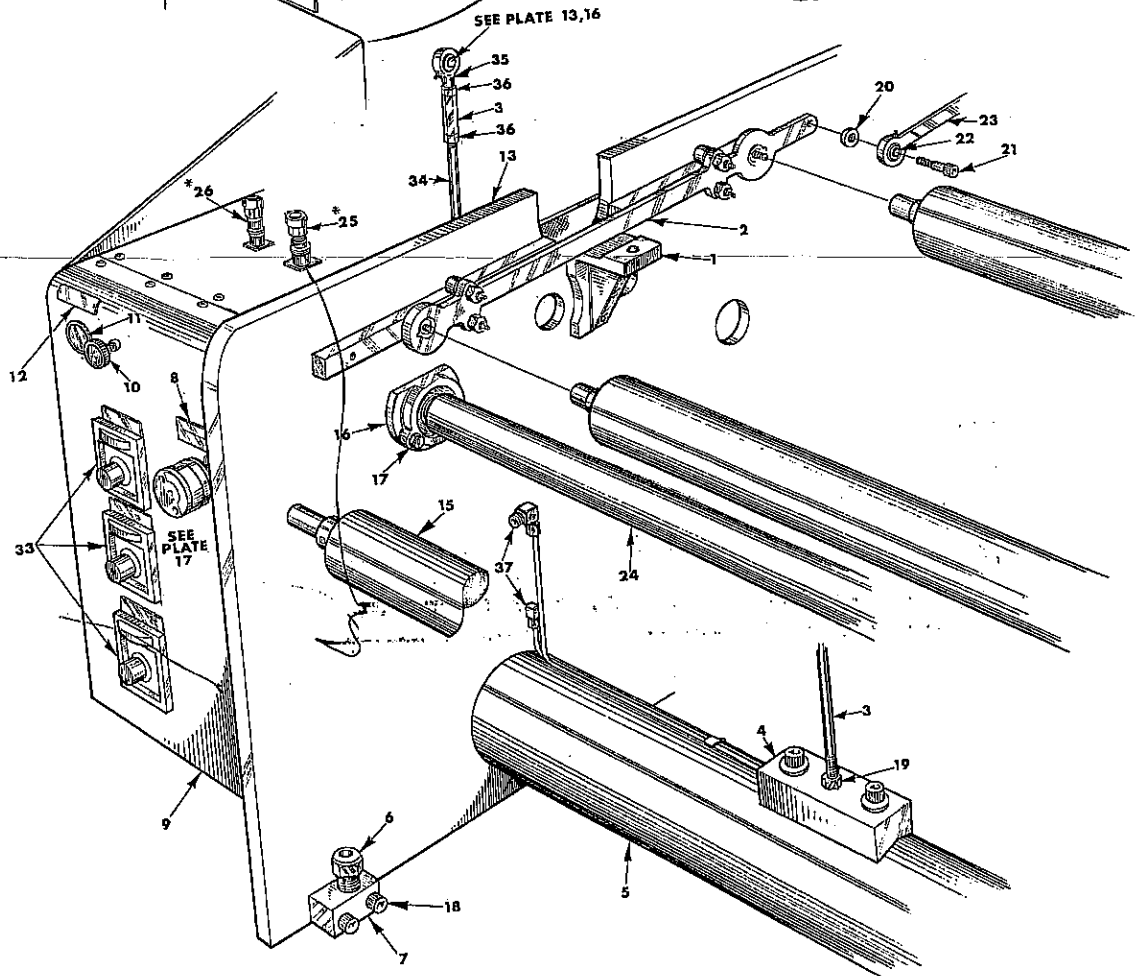
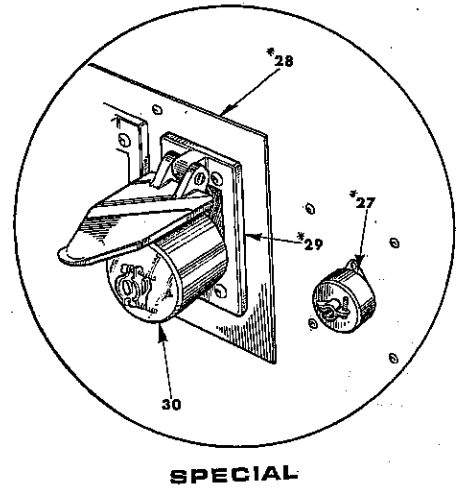
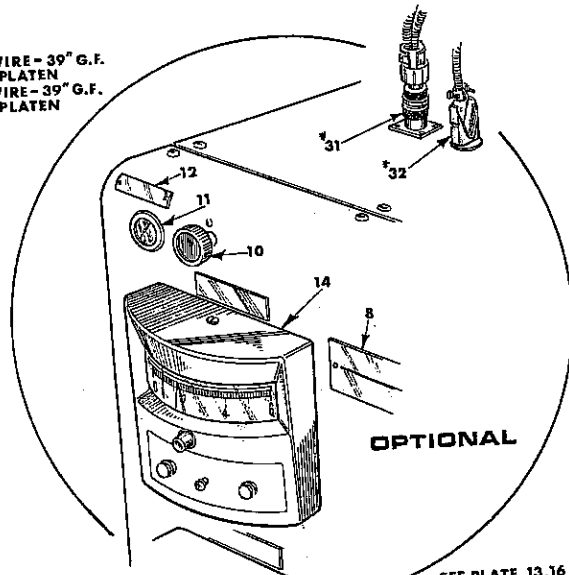

## 418-12 SHUTTLE CYLINDER ASS'Y.

<u>KEY NO.</u>	<u>NAME &amp; DESCRIPTION</u>	<u>PART NUMBER</u>
1	Plate Cylinder Bushing Retainer	A418-035
2	Piston, Shuttle	A418-050
3	Rod (Piston) Shuttle, Plain End	A418-051-1
4	Rod (Piston) Shuttle (Con. End)	A418-052
5	Tube, Cylinder	B418-034-2
6	End Cap, Cylinder (Left)	C418-033-2
7	End Cap, Cylinder (Right)	C418-033-1
8	"O" Ring	2-114
9	"O" Ring	2-111
10	"O" Ring	2-123
11	Rod Type Seal	C6706
12	Cartridge Assembly	B418-421
13	Poppet	A10041833
14	Spring .25 Pitch	
15	Stud	C140-205
16	Socket Cap Screw (1960 Series)	.250-20 x .75
17	Socket Cap Screw (1960 Series)	.312-18 x 2.25
18	Retaining Comp.	AAV(15-10)
20	Key, Cylinder Positioning	A418-129
21	Roll Pin	.250 x .50

## 418-12 HEAD LIFT CYLINDER ASS'Y.

<u>KEY NO.</u>	<u>NAME &amp; DESCRIPTION</u>	<u>PART NUMBER</u>
1	Plate, Cylinder Bushing Retainer	A418-035
2	Piston, Movable Sealing Head	A418-049
3	Connector Hose	A418-088
4	Tube, Cylinder	B418-034-1
5	Piston	B418-037
6	End Cap, Cylinder (Left)	C418-033-4
7	End Cap, Cylinder (Right)	C418-033-3
8	Slide	A418-198
9	Clevis	A418-197
10	Support, Slide	B418-199
11	Spacer, Stop	A10000133
12	"O" Ring (Parker)	2-114
13	"O" Ring (Parker)	2-111
14	"O" Ring (Parker)	2-123
15	Rod Type Seal (Hydro)	C-6706
16	Cartridge Assembly (Hydrcline)	A418-735
17	Poppet (Vickers)	A10041833
18	Spring (A.S.C.)	C420-020-2000
19	Socket Cap Screw	.250-20 x .75
20	Socket Cap Screw	.312-18 x 2.25
21	Socket Cap Screw	.250-20 x .50
22	Pin, Dowel	.375 x 1.00
23	Rod, Connecting	B418-196
24	Bearing, Spherco	COM-6
25	Fitting, Grease, Straight	.250-28
26	"O" Ring (Parker)	2-013
27	Key, Cylinder Positioning	A418-129
28	Roll Pin	.250 x .50



# PLATE 418-12

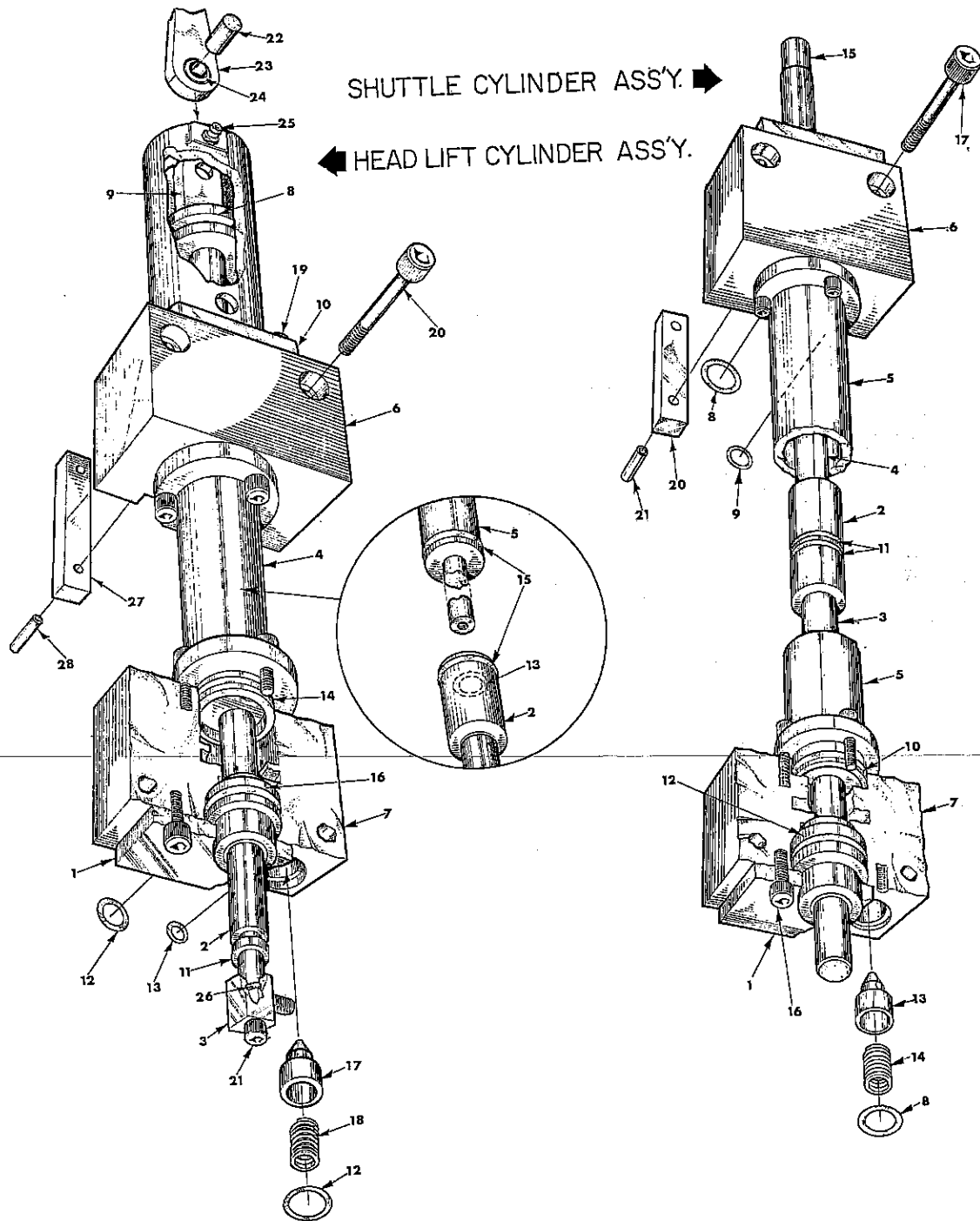

## 418-13 HEAD ASS'Y. MANUAL AND AUTOMATIC

<u>KEY NO.</u>	<u>NAME &amp; DESCRIPTION</u>	<u>PART NUMBER</u>
1	Bushing Head Arm Pivot	A418-102
2	Stud Head Engagement	A400-075-1
3	Spherco Bearing	TRE-7-N
4	Turnbuckle Head Connector	A418-149
5	Shoulder Screw	2 5/8 x 1 x 1/4
6	Thrust Washer	#18842
7	Flange Nuts	FNC-4
8	Tape Drive Cover	C418-031
9	Nut, Hex.	437-14
10	Sprocket	B418-098
11	Shoulder Head Set Screw	.312-18 x .500
12	Socket Shoulder Screw	.500 x 1.50
13	Belt	260 x L037
14	Sprocket	12 x L037
15	Socket Head Cap Screw	10-32 x .750
16	Spring	
17	Plunger	A418-286
18	Knob	PB-25
19	Fork	A418-099
20	Grease Fitting	.250-28
21	Socket Head Set Screw	10-32 x .375
22	Housing, Clutch	A418-065
23	Button Head Screw	10-32 x .750
24	Washer	#10
25	Connector	C-15-L
26	Plate, Detent	A418-285
27	Lever	C418-069
28	Stud, Head Pivot	A418-110
29	Washer	B005-001-1
30	Socket Head Cap Screw	
31	Socket Head Shoulder Screw	.375 x .500
32	Pinion	A418-072
33	Arm, Head L.H.	D418-063
34	Turnbuckle Head	A418-149
35	Nut, Hex. Elastic	.437-20
36	Pinion	A418-070
37	Shaft	A418-075
38	Roll Pin	.125 x .562
39	Shaft	A418-074
40	Shaft	A418-108
41	Clutch, L.H.	FS02
42	Clutch, R.H.	FS02
43	Spacer	A418-288
44	Ring, Retainer	5100-40
45	Socket Head Cap Screw	.250-20 x .75
46	Washer, Belleville	.505 I.D. - 1.00 O.D. x .035
47	Pinion	A418-071
48	Sleeve	A418-212
49	Washer	A418-143
50	Bearing, Nylinger	8L8-F
51	Shaft	A418-211
52	"O" Ring	2-113
53	Pin, Roll	.125 x .562
54	Stop, Head	A418-176
55	Socket Head Screw	.250-20 x 1.75
56	Bumper, Rubber	1108
57	Knob	A418-210
58	Arm, Head L.H.	D418-161
59	Knob	A418-388
60	Socket Set Screw	8-32 x 3/8



# PLATE 418-13

HEAD ASS'Y.

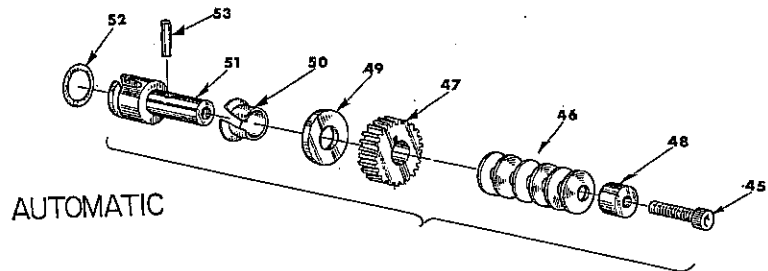

AUTOMATIC

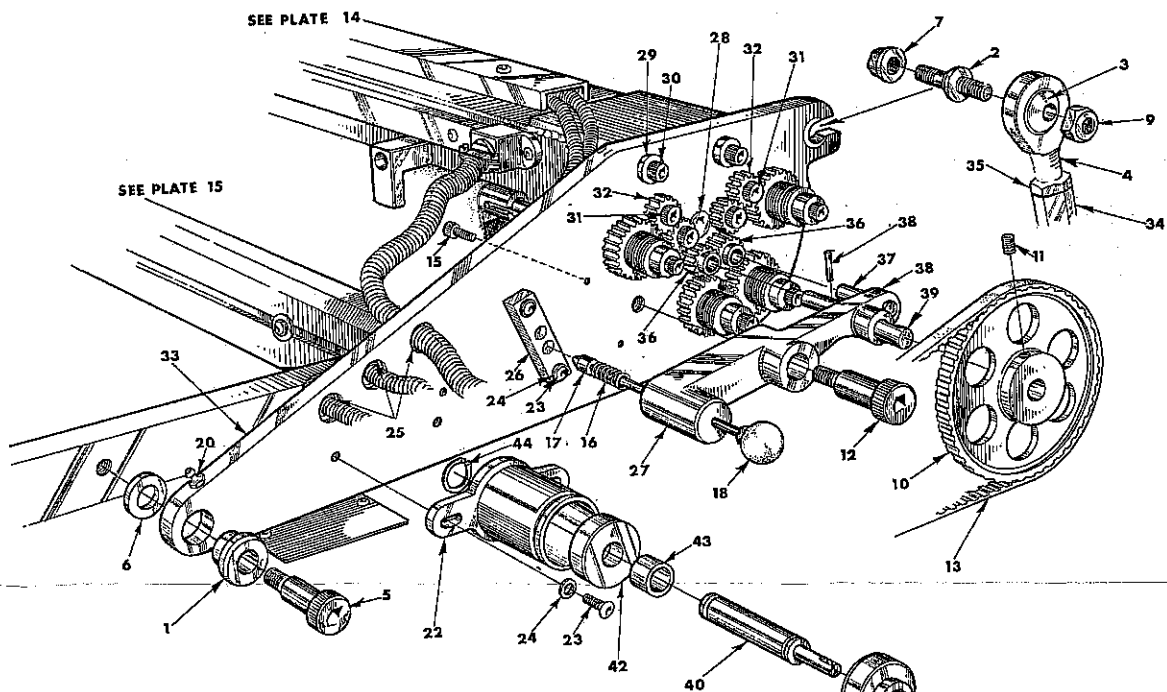

SEE PLATE 14

SEE PLATE 15

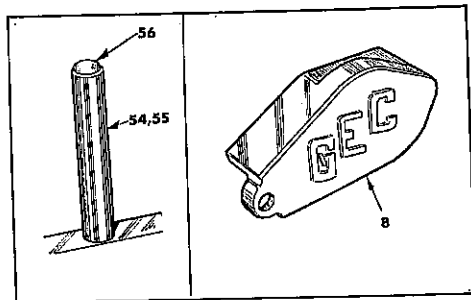

MANUAL

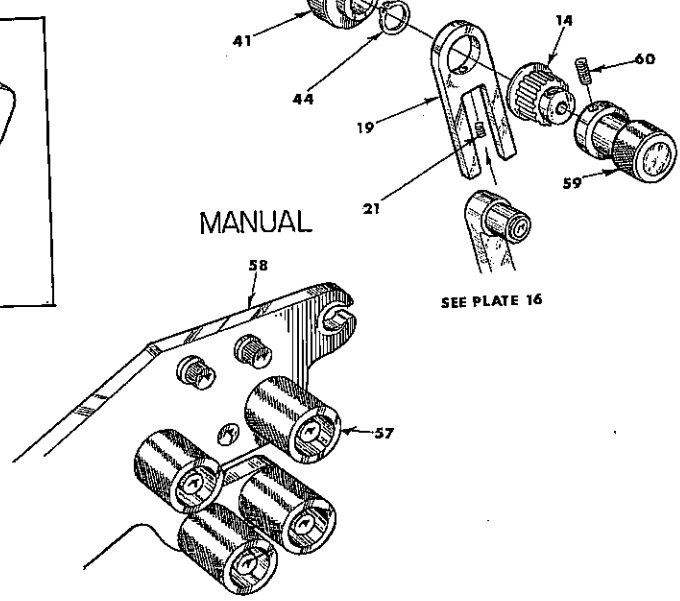

SEE PLATE 16

## 418-14 HEAD ASS'Y.

<u>KEY NO.</u>	<u>NAME &amp; DESCRIPTION</u>	<u>PART NUMBER</u>
1	Head Arm	D418-063
2	Cover, Wire (Top)	B418-294
3	Stop, Tap	A418-260
4	Head	D418-018
5	Blade	B418-721-1
6	Copper Connector	A418-148
7	Boot	A418-109
8	Stop, Bobbin	A418-247
9	Bracket, Stop	A418-246
10	Bracket, Sealing Arm	B418-144
11	Belleville Washer	#625-032
12	Block, Tapped	A418-015
13	Block, "C" Bored	A418-014-1
14	Heater Bar	A418-255
15	Heat Seal Bar	C418-007
16	Heat Seal Bar	C418-006
17	Plate, Stripper	A400-049
18	Spring, Compression	1 1/2 Lg. x 3/8-D .047 Wir
19	Pin, Roll	.188 x .750
20	Button Head Screw	8-32 x .250
21	Box Junction	A418-036
22	Shaft	A418-067
23	Bobbin Tape (State Machine Size)	A418-066
24	Socket Head Cap Screw	10-32 x .500
25	Socket Head Cap Screw	.250-20 x .625
26	Cover, Wire Side	B418-293
27	Roll, End	A418-016-2
28	Roll, Middle	A418-016-1
29	Pin, Roll	.125 x .750
30	Button Head Socket Screw	.250-20 x .875
31	Socket Head Cap Screw	8-32 x .875
32	Button Head Screw	8-32 x .750
33	Socket Head Cap Screw	8-32 x .375
34	Washer	B005-001-1
35	Socket Head Cap Screw	.312-18 x 1.25
36	Socket Head Cap Screw	8-32 x .500
37	Socket Shoulder Screw	.312 x .375
38	Washer, Spring	.317 x .625 x .032
39	Tape	36" x (Machine Size)
40	Button Head Screw	8-32 x .750
41	Connector	C-15-L
42	Block, Stripper, Spacer	A400-072
43	Socket Head Cap Screw	6-32 x 3/8
44	Nut	6-32
45	Socket Shoulder Screw	.375 x .375
46	Temperature Senser	TS109Z
47	Thermo Coupling	1500-1
48	Thermo Coupling Block	A10011859
49	Thermo Coupling Block, R.H.	A400-143
50	Thermo Coupling Block, L.H.	A400-143
51	Socket Set Screw	1/4-20 x 1/8
52	Thermo Senser	#3012



# PLATE 418-14

## HEAD ASS'Y.

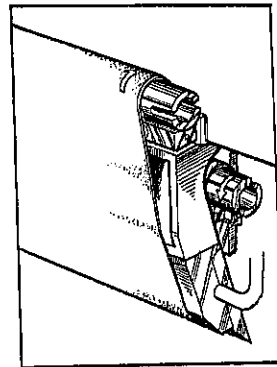
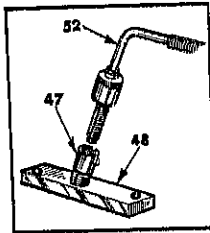
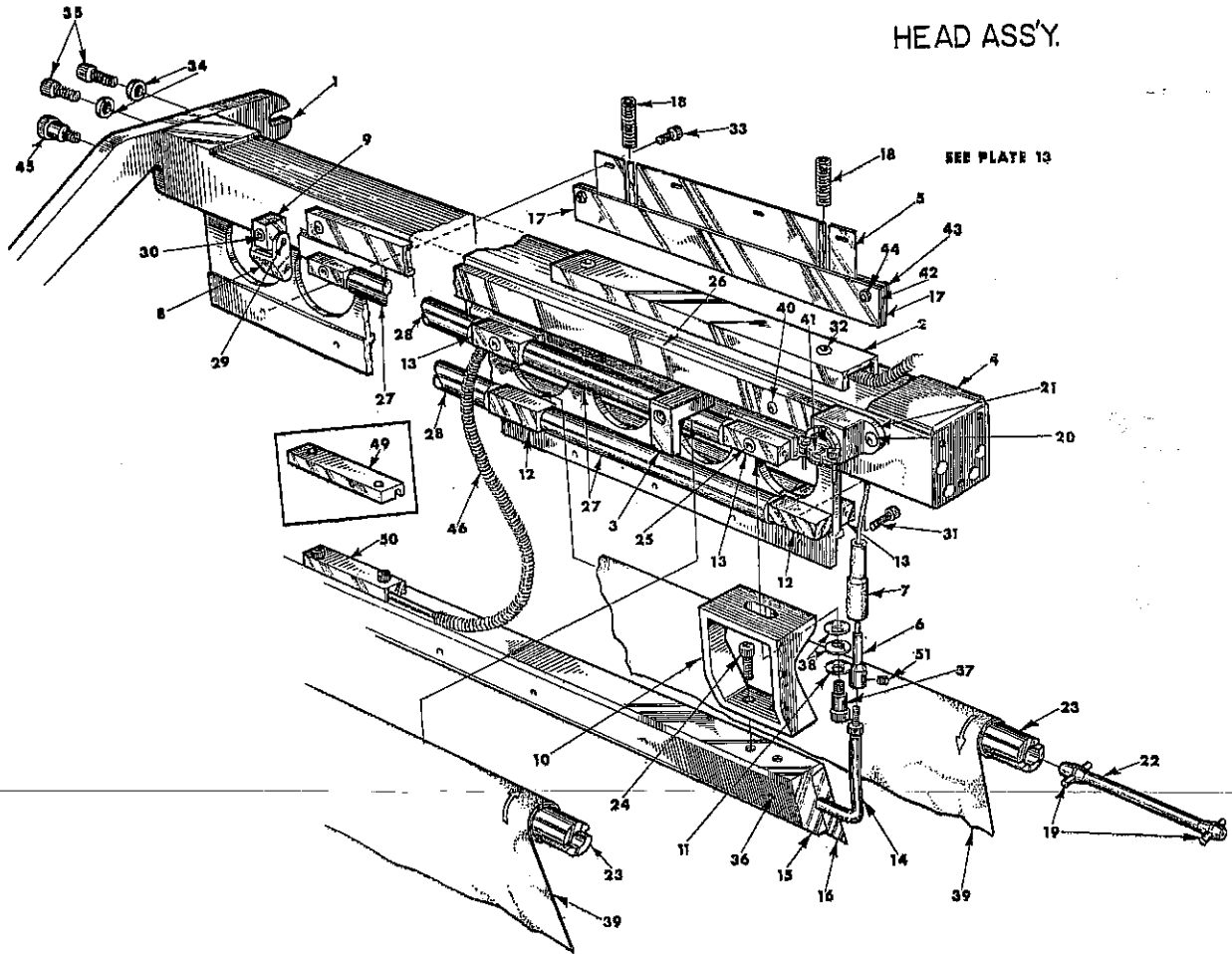

Key No.	Description	Part Number
1.	Screw	A418-094
2.	Washer	A418-097
3.	Washer	A418-100
4.	Pin	A418-093
5.	Key Square	A10018694
6.	Heating Element	A418-256 x Machine Size
7.	Platen	D418-077 x Machine Size
8.	Washer	No. 6
9.	Button Head Screw	10-32 x .500
10.	Set Screw	A418-160
11.	Socket Set Screw	.250-20 x .500
12.	Brass Plug	A10024544
13.	Insert, Platen	C418-158 - Machine Size
14.	Knob	DK - 10
15.	Collar, Adj. Rod Lock	A20011258
16.	Socket Head Cap Screw	.250 - 20 x .75
17.	Bracket (Universal Bag Machine)	B10003551
18.	Adjusting Rod	B10003550
19.	Washer	1/4
20.	Soft Rubber	1/2 x 1/4
21.	Hard Rubber	1/2 x 1/4 Die 519
22.	Tape, Teflon	M281
23.	Roll Pin	1/8 Dia. x 1" Lg.
24.	Bearing, Sealmaster	SBG-7SS
25.	Snap Ring	3000-87
26.	Bearing Sleeve	A10003541
27.	Adjusting Rod, Platen	A10003544





# PLATE 418-15

## PLATEN ASS'Y.

SEE PLATE 13

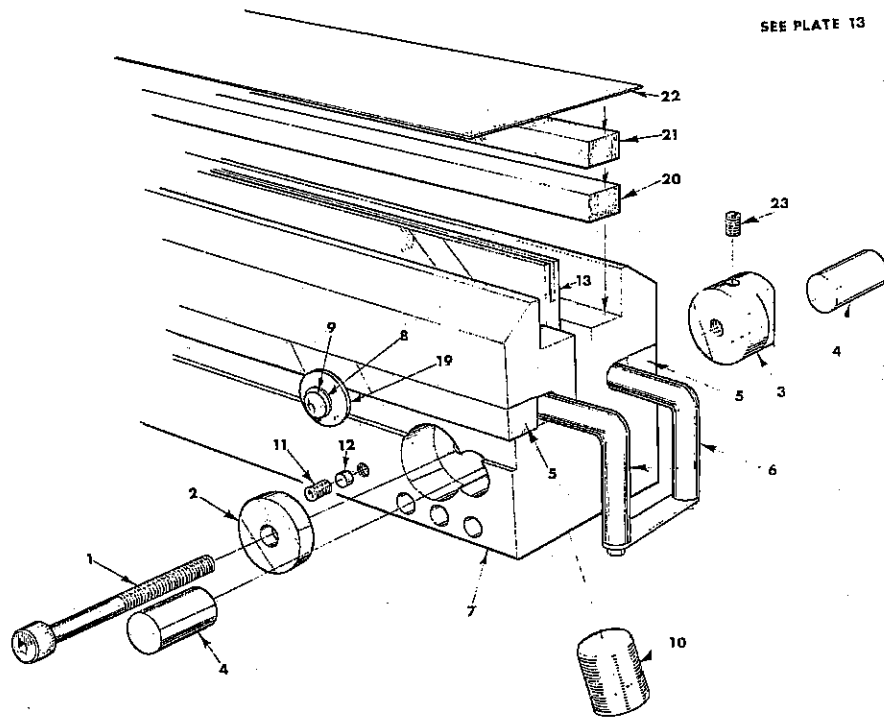

NOT SHOWN:

Hold Down - B10019855

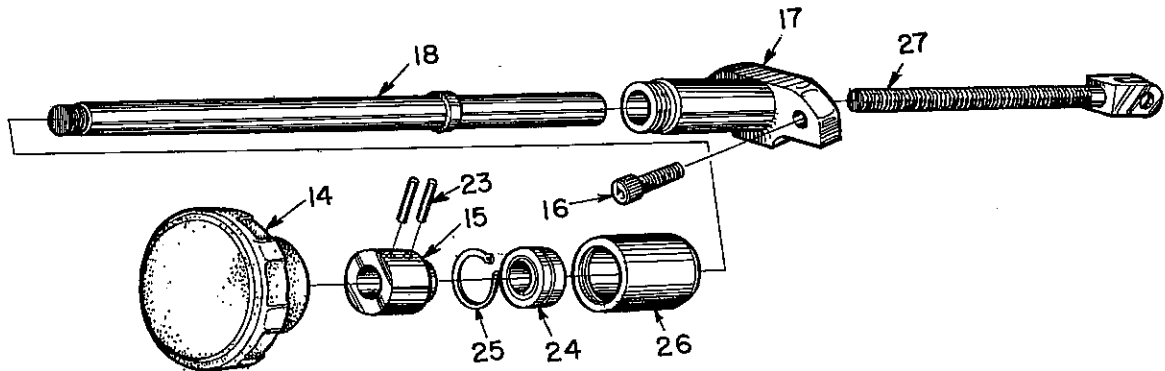

418-16 HEAD SPRING ASS'Y.

418-16 AUTOMATIC TAPE INDEXING ASS'Y.

<u>KEY NO.</u>	<u>NAME &amp; DESCRIPTION</u>	<u>PART NUMBER</u>
1	Bracket Head Spring	B418-152
2	Head, Spring	B418-360
3	Cap, Head Spring	A418-151
4	Activator, Limit Switch	A10000103
5	Rod Head Spring	A418-150
6	Spherco Bearing	TR-7N
7	Arm, Head Drive Shaft Pivot	B418-056
8	Spherco Bearing	TR-7N
9	Rod, Connecting Head	A418-090
10	Limit Switch	801-ASC17
10A.	Mounting Bracket for Counter	A1004066
10B.	Switch - Numeric	MC-1
11	Cam Roll, McGill	CYR-3/4
12	Knob, Threaded	DK-3-3/8 x 16
13	Tape Indexing Control Lever	C418-114
14	Shaft, Pivot	A100-206-1
15	Stem, Tape Indexing Control	A418-115
16	Shaft, Head Drive	A418-157
17	Socket Head Cap Screw	.475-14 x 1.75
18	Socket Head Cap Screw	.375-16 x 1.50
19	Nut, Hex.	.437-14
20	Nut, Hex.	.375-16
21	Name Plate	A418-234
22	Button Head Screw	10-32 x .375
23	Collar	SC-62
24	Socket Head Cap Screw	.375-16 x 1.00
25	Roll Pin	.188 x 1.00
26	Washer	.500
27	Spring, Compression	1 x 4 x .125 w
28	Button Head Socket Screw	.250-20 x 1.00
29	Cover	B10000897
30	Button Head Screw	8-32 x 1/2
31	Socket Head Cap Screw	1/4-20 x 3 1/2
32	Guard	B10000899
33	Guard	B10000898
34	Socket Head Cap Screw	3/8-13 x 1"
35	Chain, Cadmium Plate St. Sash	#8
36	Button Head Screw	8-32 x 3/8
37	Nut	8-32
38	Harrel Meter	TC116AZ



# PLATE 418-16

## HEAD SPRING ASS'Y.

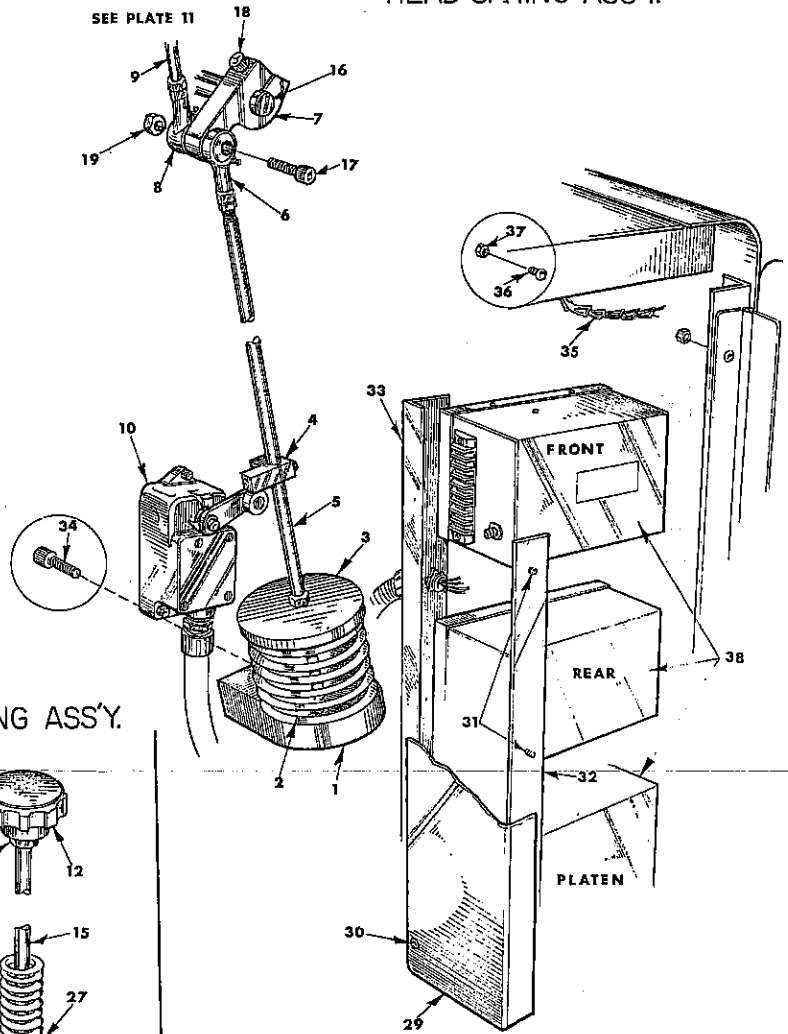

## SEE PLATE 13 AUTOMATIC TAPE INDEXING ASS'Y.

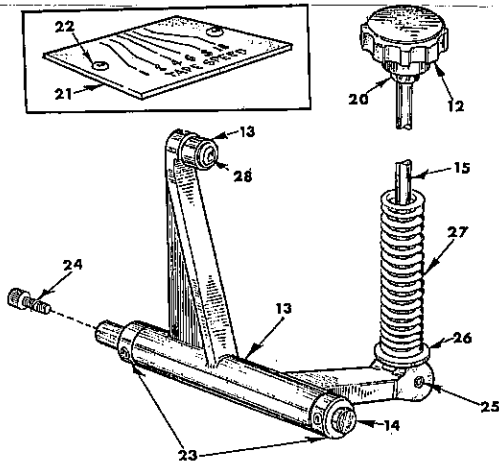

## 418-17 DRIVE ASS'Y. - LEFT SIDE

<u>KEY NO.</u>	<u>NAME &amp; DESCRIPTION</u>	<u>PART NUMBER</u>
1	Variator	117A
2	Pulley	20L075
3	Bushing	3/4-JA
4	Mounting Bracket	C418-167
5	Pulley	60L075
6	Bushing	S.D. 1"
7	Pulley	18H100
8	Bushing	7/8
9	Belt	330H100
10	Belt	420L075
11	Pulley	26-H100
12	Shaft, Main Drive	A418-156
13	Washer	B005-001-13
14	Socket Head Cap Screw	.375-16 x 1.00
15	Bearing	MFC-20
16	Screw, Hex. Cap	.375-16 x 1.50
17	Bushing	A418-443
18	Bushing	SDS.875
19	Universal Joint	A1000050601
20	Shaft	3/8 x 7 1/2 CRS
21	Universal Joint (Not Shown)	A1000049401



# PLATE 418-17

DRIVE ASS'Y.-LEFT SIDE

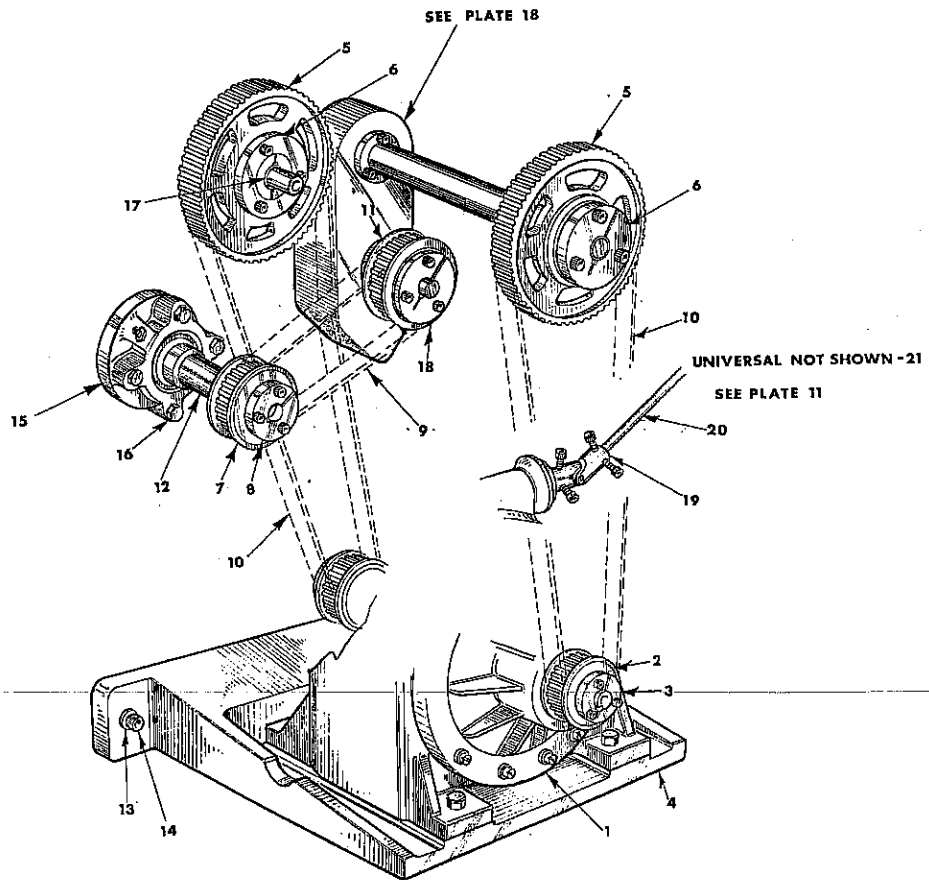

## 418-18 NIP ROLL REVERSING TRANSMISSION

<u>KEY NO.</u>	<u>NAME &amp; DESCRIPTION</u>	<u>PART NUMBER</u>
1	Pulley	60L075
2	Bushing	S.D. 1"
3	Pulley	26-H100
4	Bushing, Pivot	A418-126
5	Spacer, Bearing	A400-140-1
6	Key	.250 x .50
7	Nut, Hex.	1.000-14
8	Box, Reverse Gear	C418-012
9	Shaft, Stub	A418-028
10	Nut, Hex	1.000-14
11	Spacer	A400-140-1
12	Spacer	A400-140-2
13	Gear, Reverse	A418-027
14	Bearing	1205RR
15	Ring, Retaining	NS000-206
16	Socket Head Cap Screw	.250-20 x .625
17	Shaft, Extension	B418-171
18	Key	.250 x 1.25
19	Support, Bearing	B418-170
20	Socket Set Screw	.250-20 x .1875
21	Grease Fitting	.250-28
22	Bearing	ER-16
23	Bushing	SDS-.875
24	Socket Head Cap Screw	1/4-20 x 2 3/4
25	Washer	1/4 x 3/4

## 418-18 BAG LENGTH CORRECTION MOTOR-USED WITH ELECTRIC HEAD

<u>KEY NO.</u>	<u>NAME &amp; DESCRIPTION</u>	<u>PART NUMBER</u>
1	Socket Head Cap Screw	10-32 x 1"
2	Slo-Syn Driving Motor	Type SS-50P2
3	Socket Set Screw	10-32 x 1/4
4	Gear	A418-715
5	Bushing	A418-714
6	Key	1/8 x 1/8 x 3/4
7	Housing	C418-707
8	"O" Ring (Parker)	2-20
9	Socket Set Screw	1/4-20 x 1/4
10	Socket Head Cap Screw	
11	Klosure (Garlock Seal)	63 x 13
12	Tapered Pin	#1 Taper, 3/4 Long
13	Socket Set Screw	1/4-20 x 1/4
14	Extension Shaft	B418-711
15	Gear	A418-713
16	Plate, Pressure	A418-716
17	Spring, Compression (ASPC)	C36-032-1500
18	Spring Retainer	A418-717
19	Sleeve	A418-712
20	Cover, Housing	B418-708
21	Dowel Pin	1/8 x 1"

NOT CALLED OUT - SHAFT - 10508 (See No. 7)



# PLATE 418-18

## NIP ROLL REVERSING TRANSMISSION

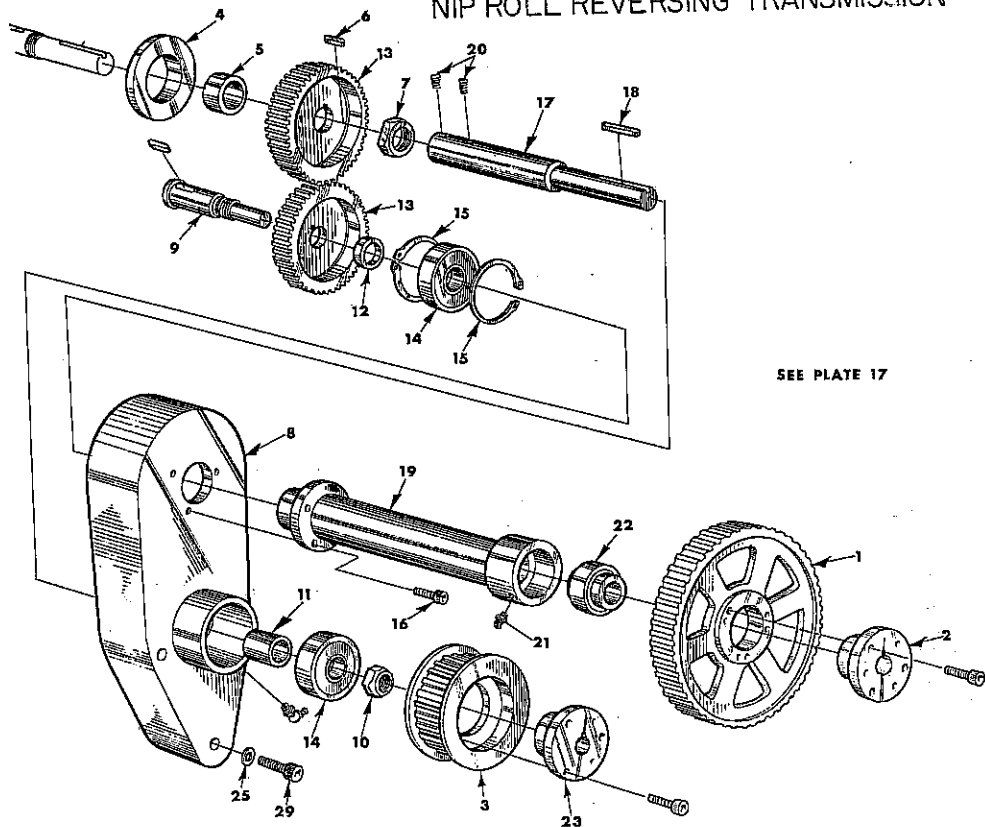

## BAG LENGTH CORRECTION MOTOR - USED WITH ELECTRIC HEAD

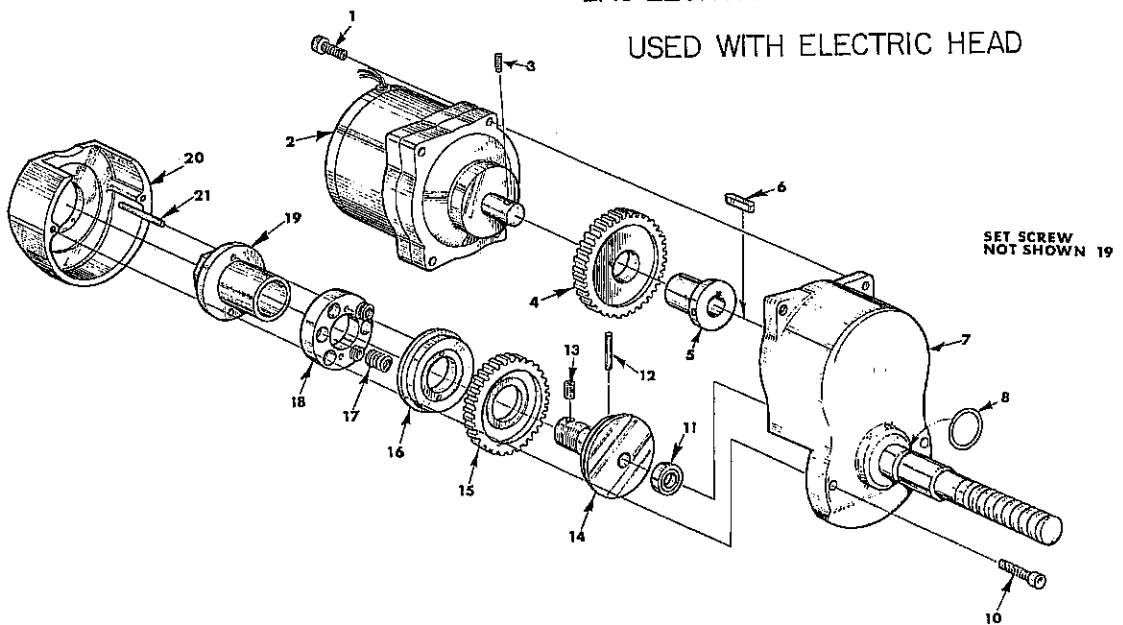

## 418-19 GUARDS, COVERS AND ELECTRIC ASS'Y.

<u>KEY NO.</u>	<u>NAME &amp; DESCRIPTION</u>	<u>PART NUMBER</u>
1	Door, Left Rear	C418-117
1A.	Latch	A004.001-01
2	Holder (Folder)	A10000145
3	Enclosure, Left Rear	C418-381
4	Cover, Shuttle	B418-175
5	Wire Way	A418-177
6	N. F. Box	352
7	Transformer	KVA.500
8	Fractional Controller for	1 1/2 Dynamatic Motor
9	Electrical Box (McKinstry)	3016126
10	Electrical Box	C418-382
11	Cover	C10000431
12	Name Plate	A418-234
13	Button Head Screw	10-32 x .375
14	Chain Cadmium Plate St. Sash	#8
15	Button Head Screw	8-32 x 3/8
16	Nut	8-32
17* to 21*	Use Key No. Only	





# PLATE 418-19

GUARDS, COVERS & ELECTRIC ASSY.

ORDER BY KEY NO. ONLY

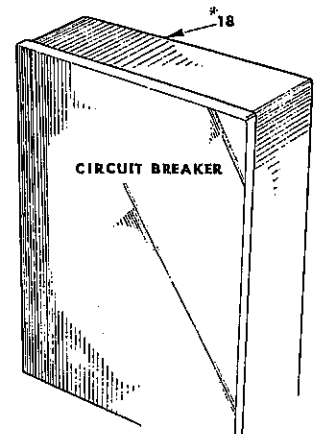
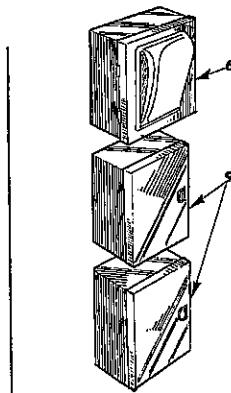
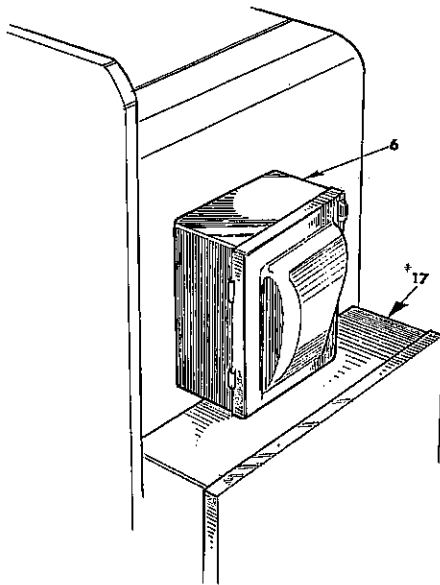
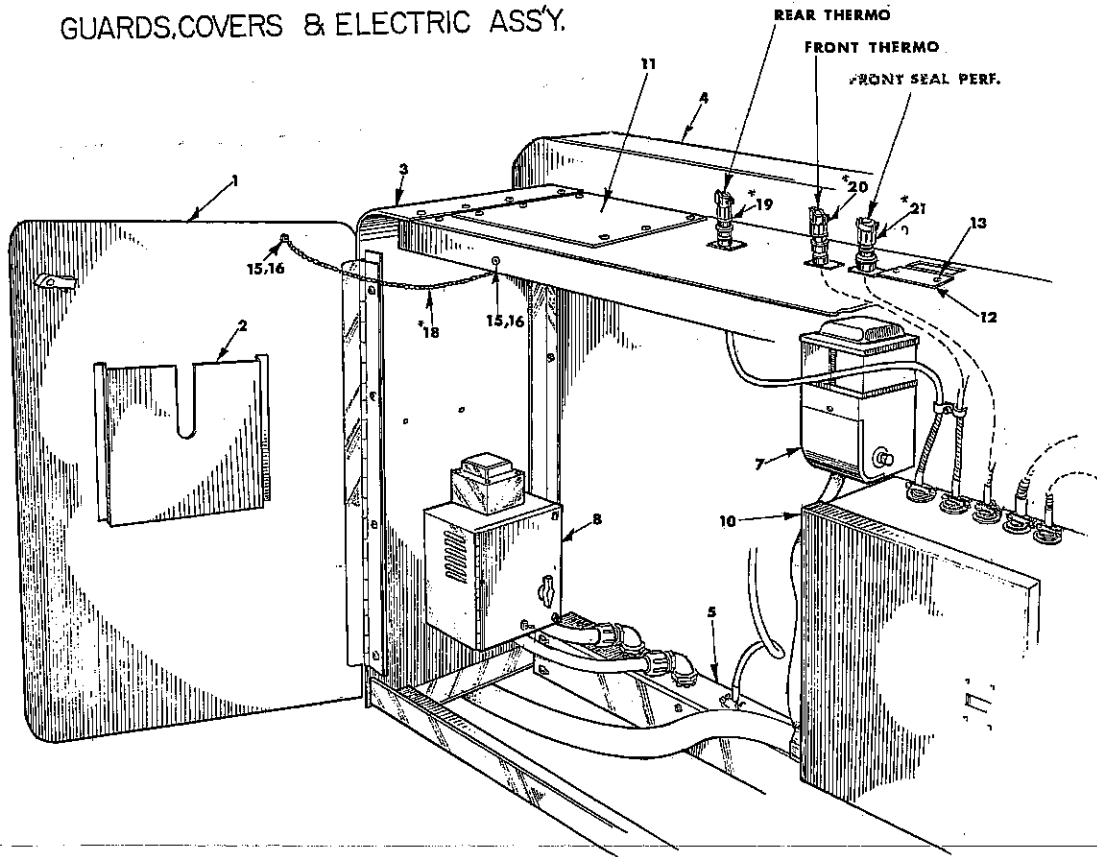

## 418-20 BELLOFRAM AND POTENTIOMETER ASS'Y. - LEFT SIDE

<u>KEY NO.</u>	<u>NAME &amp; DESCRIPTION</u>	<u>PART NUMBER</u>
1	Cylinder, Rod End	C100-468-1
1A.	Bushing (in top of cylinder)	10DU14
2	Rod, Piston	A100-478-1
3	Piston	B100-476-1
4	Seal, Bellofram	B100-477-1
5	Cap, Piston	A100-479
6	Cylinder, Pivot End	C100-469-1
7	Socket Head Cap Screw	1/4-20 x 3/4
8	Button Head Socket Cap Screw	10-32 x 3/8
9	Spacer	B006-001-38
10	Housing, Pot	A10004704
11	Socket Head Cap Screw	3/8 x 2 3/4
12	Wire	
13	Cover, Wire	
14	Set Screw	6-32 x 1/8
15	Gear, Pinion	A100-224
16	See 49	
17	See 49	
18	Spring, Looped Ends	1.00 x .375 O.D. x .047 Wire
19	Socket Head Cap Screw	3/8 x 2 1/2
20	Socket Head Cap Screw	10-32 x 3/8
21	Collar	SC-37
22	Gear	A100-226
23	Washer, Special	B-005-001-10
24	Block, Stop	A100-222
25	Set Screw	1/4 x 1/4
26	Collar	A100-225
27	Socket Head Cap Screw	1/2 x 3 1/4
28	Bracket, Dancer Stop Spring	A100-171
29	Spacer, Dancer Stop Bracket	B006-001-II-5
30	Spring	1" O.D. x 3/16 W. x 2" Lg.
31	Arm Dancer Tension	B100-058
32	Socket Head Cap Screw	3/8-16 x 1 3/8
33	Nut	1/2
34	Socket Head Cap Screw	1/2 x 2 1/2
35	Rubber Hose	12" x 1/4 I.D.
36	Stud, Tension Cylinder	B100-169-1
37	Elbow, 90°	90°-1/4-4M
38	Adapter (See 39)	
39	Compression Nut	1/4 x 1/4
40	Tubing	1/4 Copper
41	Nut, Hex. Jam	3/8-16
42	Spherco, Rod Eye	FRE-6-N
43	Bearing	SFC-2OR- 1 1/2
44	Cap Screw	5/16 x 1 1/2
45	Roll Pin	.187 x 1.50
46	Cover	A10004719
47	Button Head Socket Cap Screw	10-32 x 3/8
48	Roll Pin	.125 x 1.00
49	Potentiometer	

As Unit



# PLATE 418-20

BELLOFRAM AND POTENTIOMETER ASS'Y. - LEFT SIDE

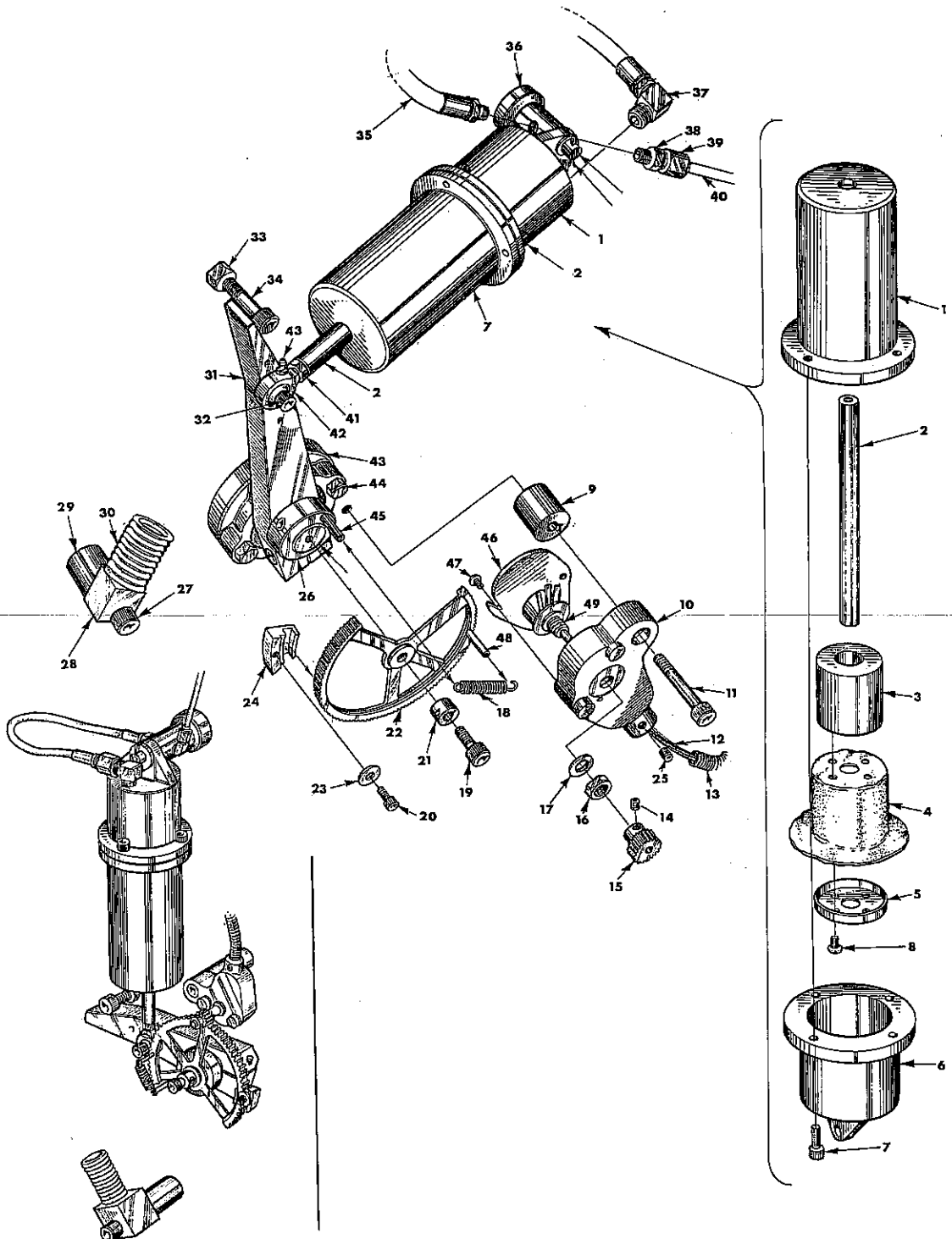

# DANCER TENSION CYLINDER-ASSEMBLY DRAWING

TYPICAL DRAWING-NOT FOR REORDERING PARTS

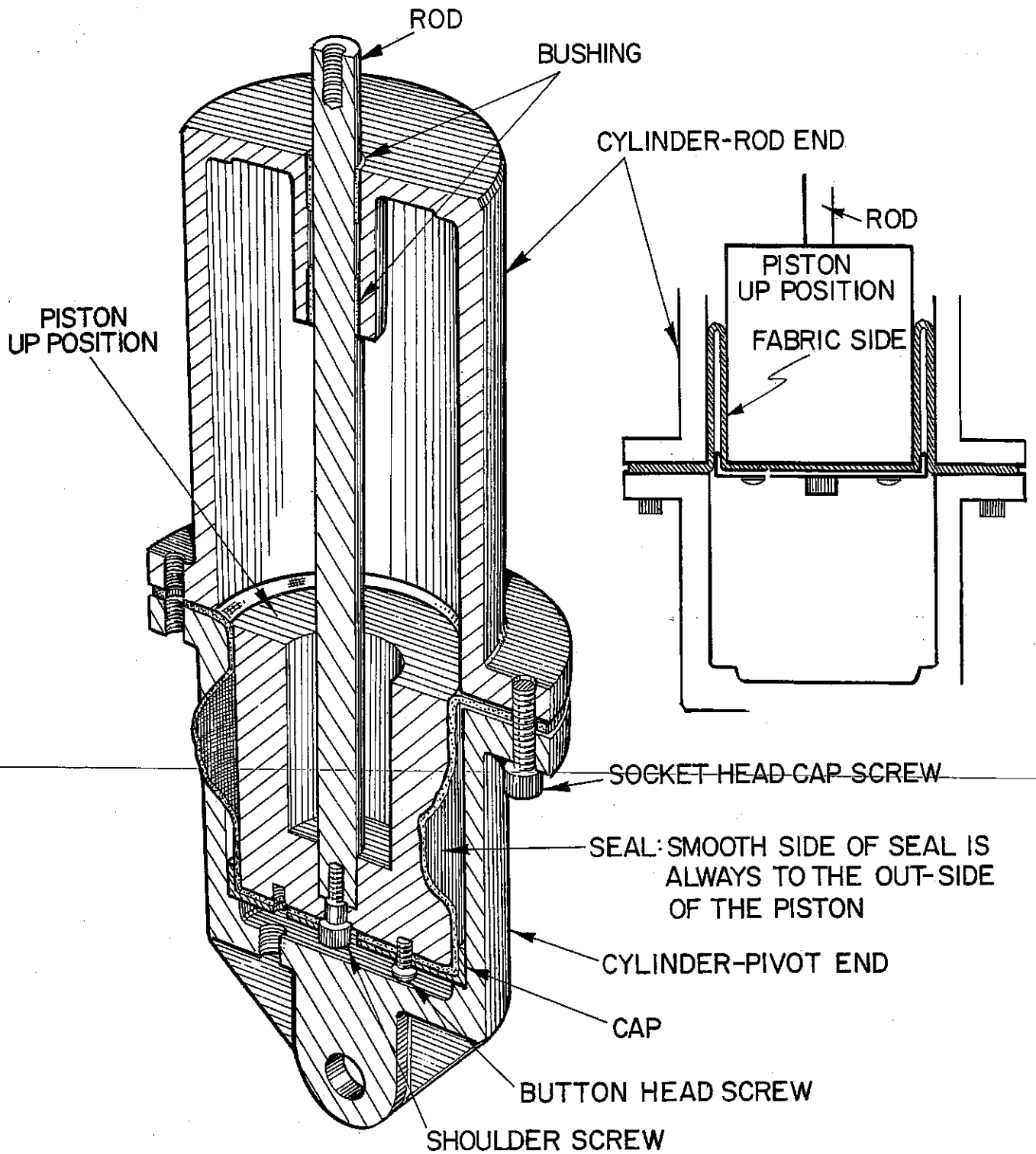

# DANCER TENSION CYLINDER PARTS CATALOG & ASSEMBLY SHEET

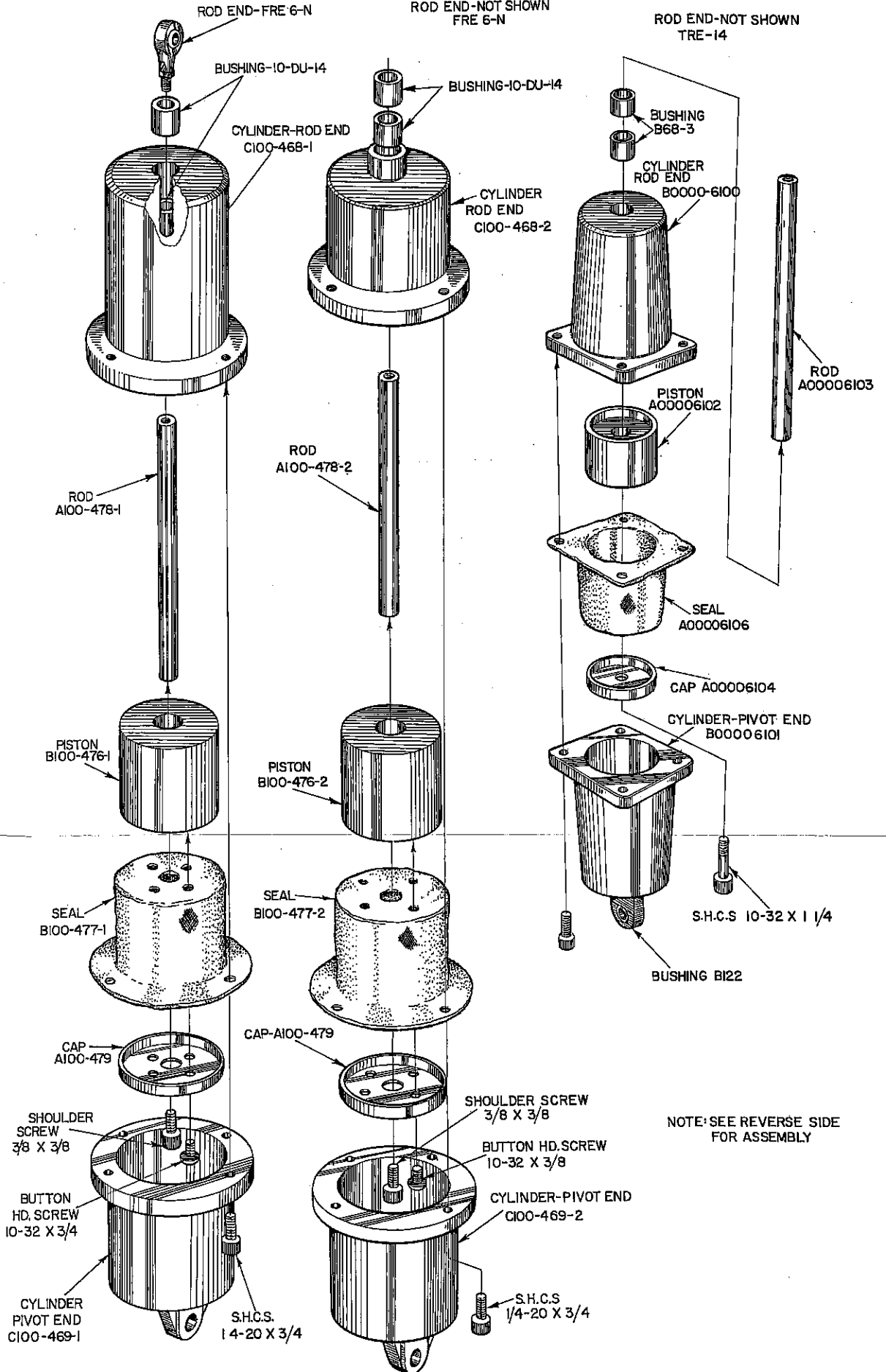

## SAFETY INSTRUCTIONS

We, as a manufacturer, and you, as an owner or operator, share a common responsibility to exert every effort to insure that our equipment be installed, operated, and maintained with a maximum degree of safety to personnel and property.

The safety instructions provided with this equipment should be given to the individuals responsible for plant safety - design - installation - operation and maintenance. Additional copies are available upon request.

In addition it is advisable that all other equipment supplied by Gloucester undergo a periodic safety inspection to determine that guards, safety markings and safety cables are installed and in working order.

WARNING-POWER SHOULD BE DISCONNECTED BEFORE REMOVING ORANGE COLORED GUARDS

A

CAUTION-READ SAFE OPERATING PROCEDURE MANUAL BEFORE RUNNING THIS EQUIPMENT

B

WARNING-CONTACT MANUFACTURER BEFORE ALTERING THIS EQUIPMENT

C

CAUTION-MAY BE HOT

D

CAUTION

E

CAUTION-KEEP HANDS CLEAR

F

### ORANGE MARKINGS

2 Electrical Boxes at rear of R.S. Enclosure (See 418-19)

1 Electrical Box on Top of R.S. Enclosure

Inside Edge of R.H. Doors

Safety Labels R.H. Rear Door Labels A & B

Inside Edge of L. H. Doors

Safety Labels R.H. Rear Door Labels A, B & C  
Head Assembly

Labels E & F on both sides of Head.

### YELLOW & BLACK MARKING

On Shuttle Drive Shaft Safety Marking F

# SAFETY ASSEMBLIE

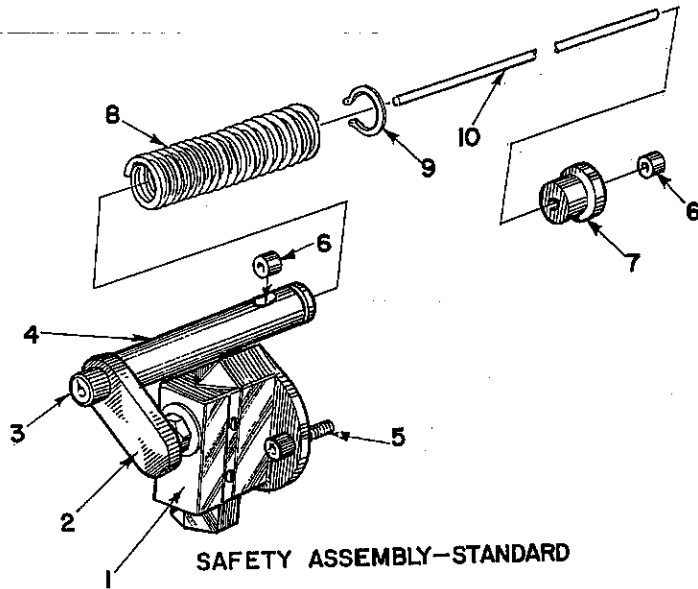

KEY NO.	NAME AND DESCRIPTION	PART NUMBER
1.	Limit Switch	2945
2.	Pad	A2224
3.	Socket Head Cap Screw	3/8-16 X 1"
4.	Rod for 3/4 & 1" Frames	A2223
5.	Socket Head Cap Screw	10-32 X 7/8
6.	Stop Sleeve, Copper	8002
7.	Bushing	A2222
8.	Spring	4546
9.	Ring, Retaining	225
10.	Wire Rope	8221

(1)

1