

# BOTTLE LABELLER

MODEL: LB-7



USER'S MANUAL  
OPERATION, MAINTENANCE AND TROUBLESHOOTING

# Table of Contents

External view-----	3
Specification-----	3
Label setting-----	4
Operation-----	5
Trouble shooting-----	6
Parts list-----	7,8
Electric component-----	9

## External view



## Specifications

Power -----AC 110/220 DUAL POWER  
Machine length-----20 "  
Machine width-----12 "  
Machine height-----15 "  
Net weight-----12kgs

Label Size: Max: 8 " X 11 "  
Min: 0.8 " X 0.8 "

Label Roll Max:  $\varnothing$  8.5 "

Bottle Diameter: MAX: 6 "  
MIN: 0.7 "

## Label setting

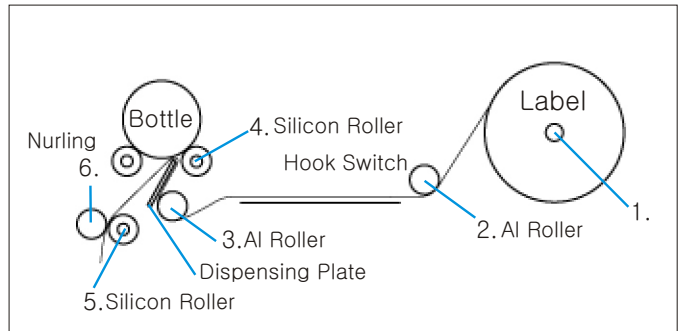

- ① Set Label Roll on hanger shaft 2. AI Roll Hook Switch 3. AI Roll  
 Dispensing Plate 4. Silicon Roller 5.6. Between Silicon Roll and AI nurling Roll.

You can pull nurling Roller when you insert label between Silicon Roller to nurling Roller.

- Label have to be setted same distance from left wall bracket.

- To set label 1~2mm strip from backing paper on dispensing plate  
 = at same time = To set Hook Switch just locate on the Label gap.

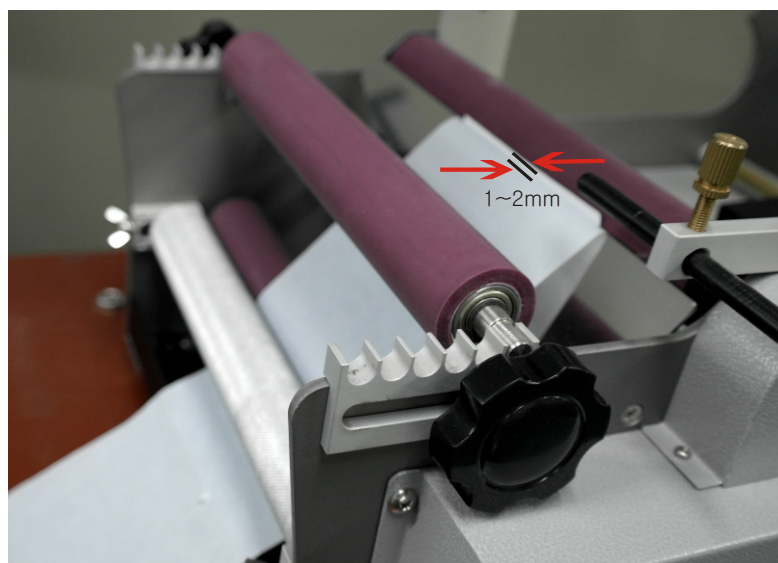

## Operation

1. Confirm Power Ac100Volt or Ac220Volt..
2. To set label.
3. To adjust Front Silicon Roller with moving front and back just after Putting your bottle.

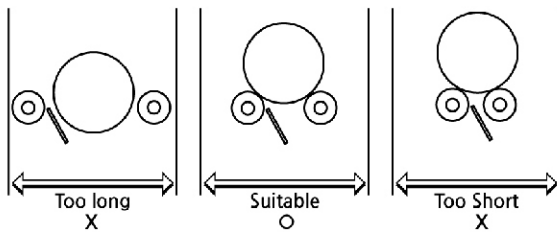

. Adjusting not to bottle contact dispensing plate with Front Silicon Roller..

4. Adjust bottle position with Guid Bar (12)
5. Confirm label comes out 1~2mm from dispensing Plate and hook Switch locate on label gap.
6. Power on.
7. Pull wooden grip that mean start.
  - \* Don't pull too excessively.

Adjust hook Switch tension properly.

## Trouble shooting

TROUBLE	CAUTION	SHOOTING
Label comes out continuously	Hook Switch don't catch Label gap.	Adjust Hook Switch tension.
Label fold over the bottle	You pulled wooden grip too much.	Pull wooden grip smoothly.
Bottle can not be picked out after labelling. Because next Label attached some on the Bottle	Label stripped too much like 5mm stripped on dispensing plate.	Adjusting Hook Switch position until label strip 1~2mm on dispensing plate.
Label fold over first part	Front Silicon Roller is too near to dispensing plate.	Adjust Front silicon Roller back.

# Parts list

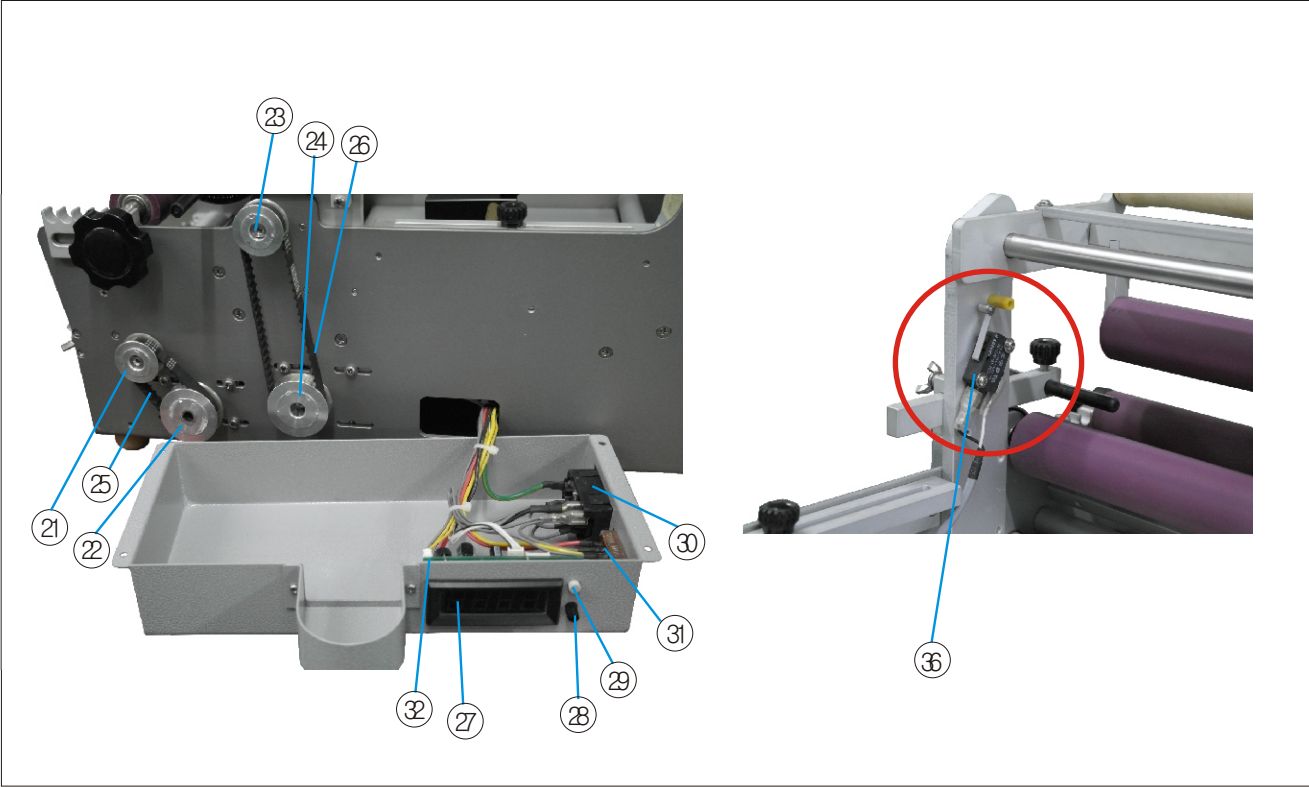
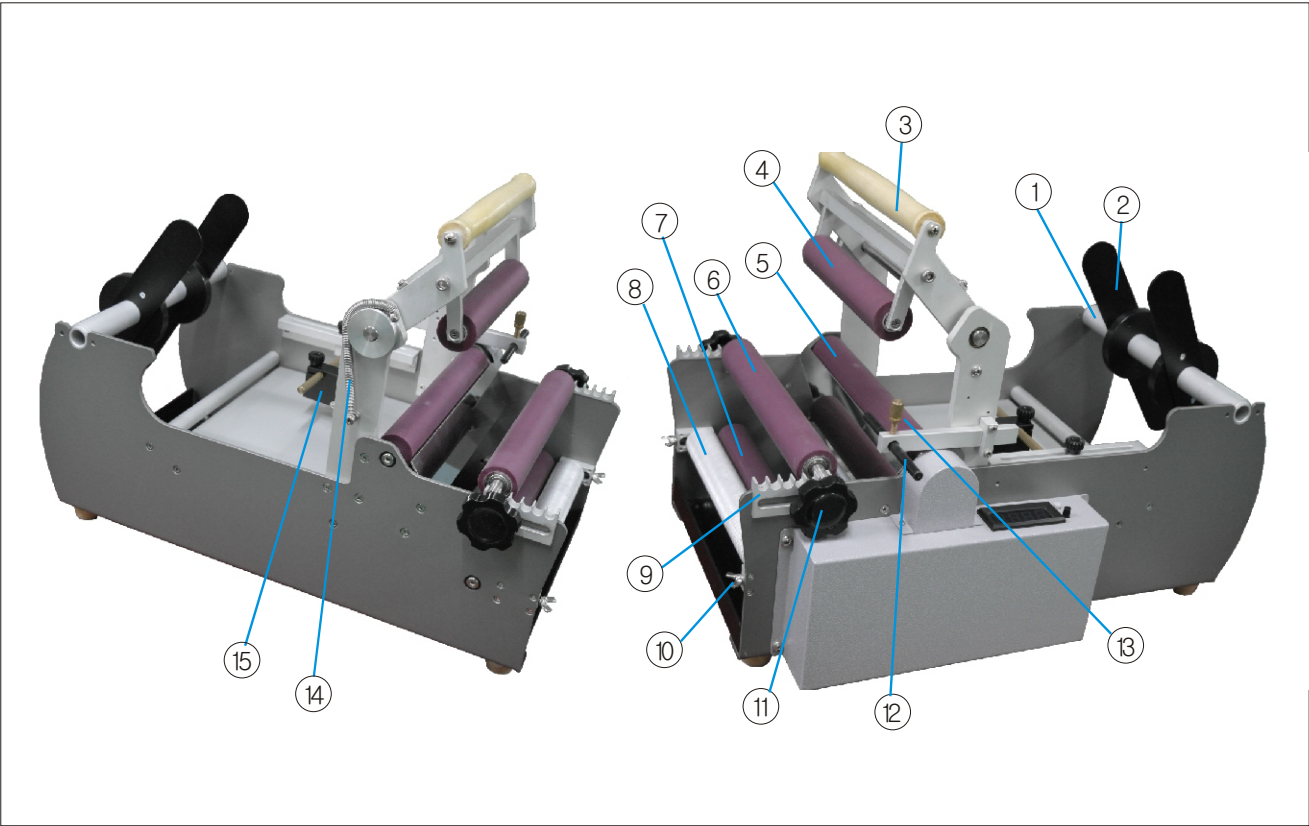

## Parts list

No.	Part Name	Spec
1	Hanger Shaft	Ø25mm
2	Hanger Guide	(L)Ø250mm
3	Wooden Grip	
4	Silicon Roller	(L)175
5	Silicon Roller	Ø33 X (L)230
6	Front Silicon Roller	(L)230
7	Silicon Roller	(L)230
8	Nurling Roller	(L)226
9	Breadth Adj Bracket	
10	Butterfly Belt	Ø4mm X (L)30mm
11	Knob	
12	Guide Bar	
13	Bolt	
14	Spring	
15	Hook Switch & Bracket	
21	Timing Gear	15XL
22	Timing Gear	20XL
23	Timing Gear	15XL
24	Timing Gear	20XL
25	Timing Belt	74XL
26	Timing Belt	128XL
27	Counter	FMD 4digit
28	Delay	
29	Reset botton	
30	Inlet	
31	Transfer Switch	
32	PCB Board	
33	Motor	BLDC
34	SMPC	
35	Transforma	
36	Limit Switch	



# Electric Component

1. BLDC MOTOR-----2pcs
2. Hook Switch-----1pc
3. PC Board-----1pc
4. Counter-----FMD 4digit
5. SMPC-----1
6. Transformer-----1
7. Time delay-----1
8. Count Reset-----1