

# D700.RSX Curve LED downlight

## Datasheet



**TRU-COLOUR®**

### Product codes

<b>Unit:</b> D700.RSX	<b>Series:</b> CR	<b>Colour temp.:</b> 2.7K (2700K) 3K (3000K) 4K (4000K)	<b>Beam angle (°):</b> 36 (36°)	<b>Colour:</b> W (White) B (Black)	<b>Driver:</b> PHASE (PHASE)	<b>Version:</b> 1.0
--------------------------	----------------------	--	------------------------------------	--	---------------------------------	------------------------

### Dimensions (mm)

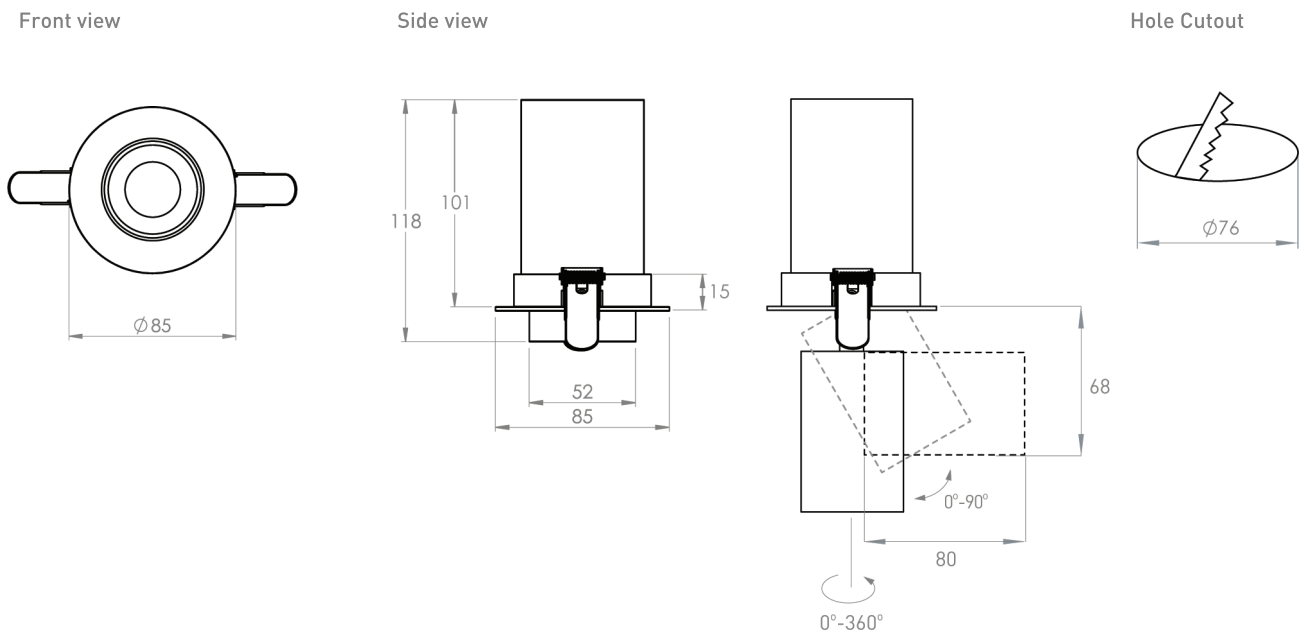

### Photometrics

**Source lumen output:** 930lm  
**Delivered lumen:** 745lm  
**Efficacy:** 74lm/W  
**Colour temp.:** 2700K  
**Beam angle:** 36°  
**CRI:** >98  
**Standard deviation of colour matching (SDCM):** 3 Macadam steps

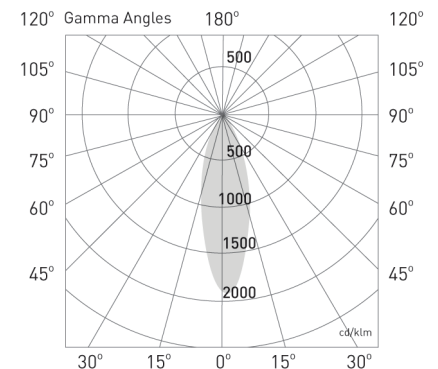

**Source lumen output:** 945lm  
**Delivered lumen:** 760lm  
**Efficacy:** 76lm/W  
**Colour temp.:** 3000K  
**Beam angle:** 36°  
**CRI:** >98  
**Standard deviation of colour matching (SDCM):** 3 Macadam steps

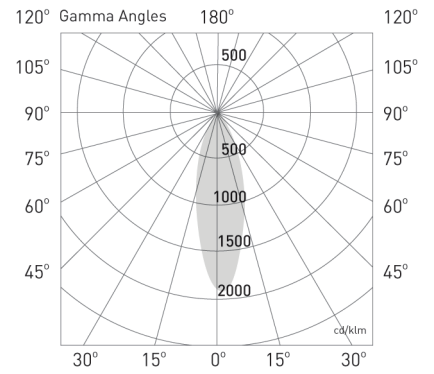

**Source lumen output:** 965lm  
**Delivered lumen:** 775lm  
**Efficacy:** 77lm/W  
**Colour temp.:** 4000K  
**Beam angle:** 36°  
**CRI:** >98  
**Standard deviation of colour matching (SDCM):** 3 Macadam steps

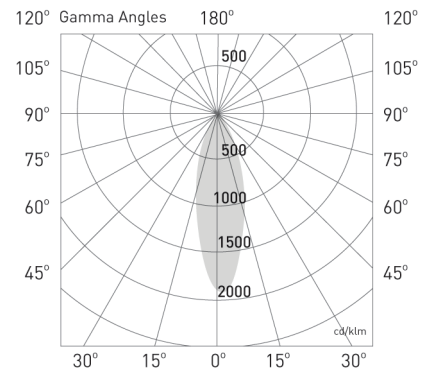

## Electrical

<b>Input voltage:</b> 240V	<b>Power usage:</b> 10W	<b>Driver power factor:</b> >0.9	<b>IP rating:</b> IP44	<b>Surge protection:</b> 3100V	<b>Dimmable:</b> Yes
-------------------------------	----------------------------	-------------------------------------	---------------------------	-----------------------------------	-------------------------

## Operational

<b>Lifetime L70, B10:</b> 50,000 hrs (@TA25)	<b>Thermal rating:</b> IC-4	<b>SDCM:</b> 3MacAdam Steps
---	--------------------------------	--------------------------------

## Physical

<b>Warranty:</b> 7 years	<b>Mounting type:</b> Recessed
-----------------------------	-----------------------------------

## Installation

---

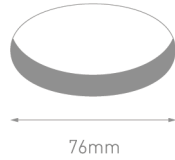

### Step 1

Using a 76mm hole saw, cut a hole in the ceiling at the desired location.

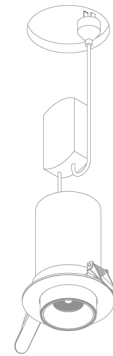

### Step 2

Plug the driver into a mounted general power outlet (GPO) in the ceiling.

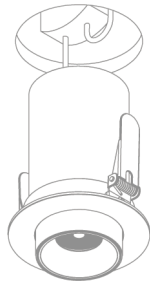

### Step 3

Pull back the springs and insert the luminaire into the ceiling cavity. This luminaire can be covered and abutted with insulation.

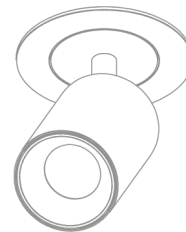

### Step 4

Once the light is installed, pull down on the light to slide it out of the housing in order to orient the light to the correct position.