

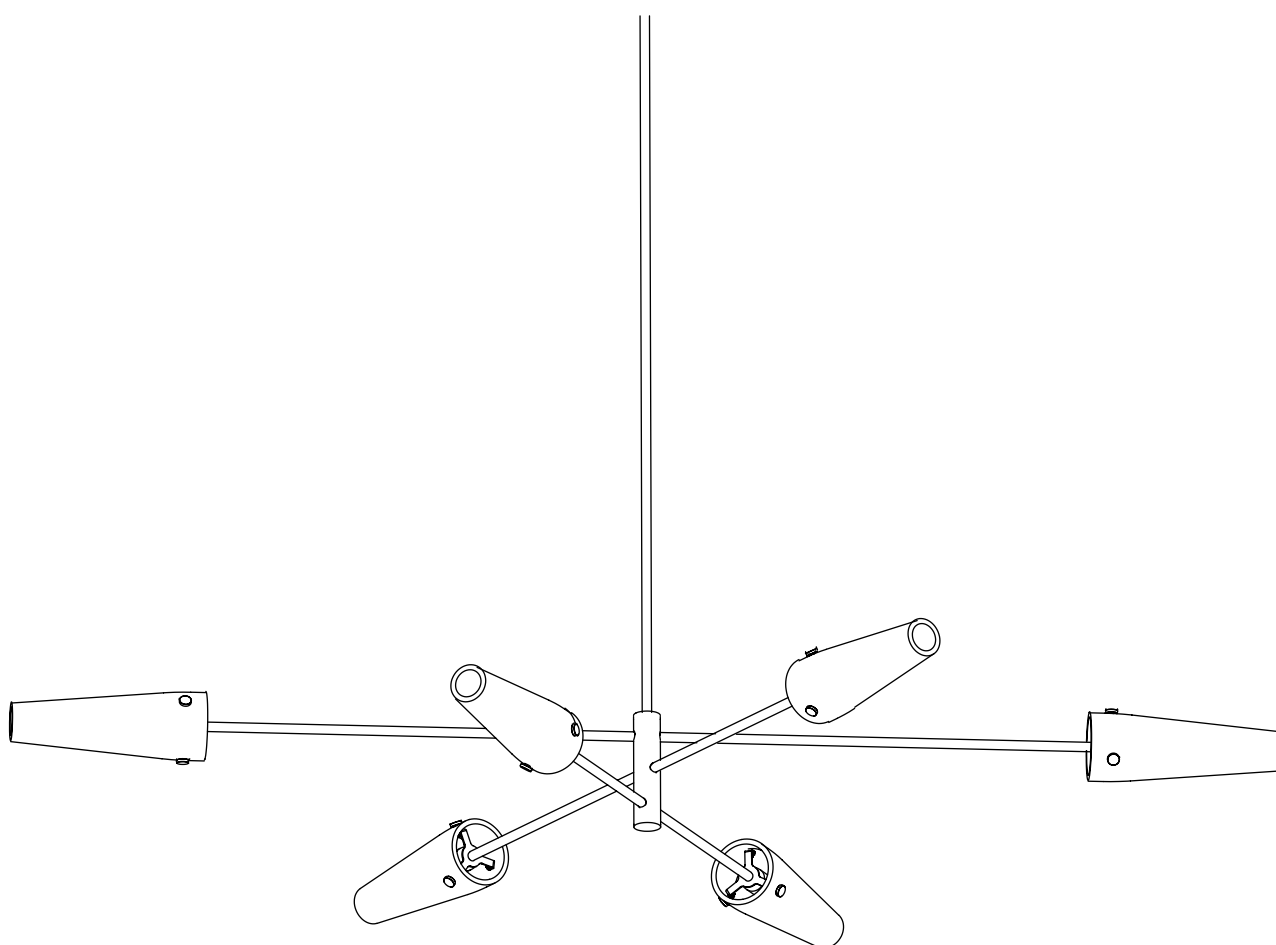

AXIS SIX PENDANT



! Please handle with care and wear gloves at all times during assembly and installation to avoid damaging or marking components.

TECHNICAL

finish options	satin brass with matt opal glass shades CTO-01-044-0101
	bronze with matt opal glass shades CTO-01-044-0102
bulb holder	240v - 6 x E14, 25w max 120v - 6 x E12, 25w max
weight	6kg (13lbs)
cleaning	dust using a dry lint-free cloth as required
replacement/ repairs	please contact CTO Lighting
warranty	1 year from date of delivery
certification	

COMPONENTS

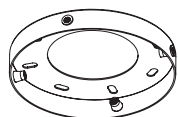

1 x ceiling plate



4 x M4x12 screws



18 x brass screws



18 x Rubber grommets



1 x ceiling plate

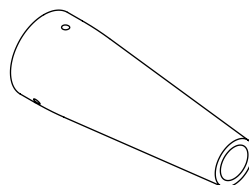

6 x smoked cone glass

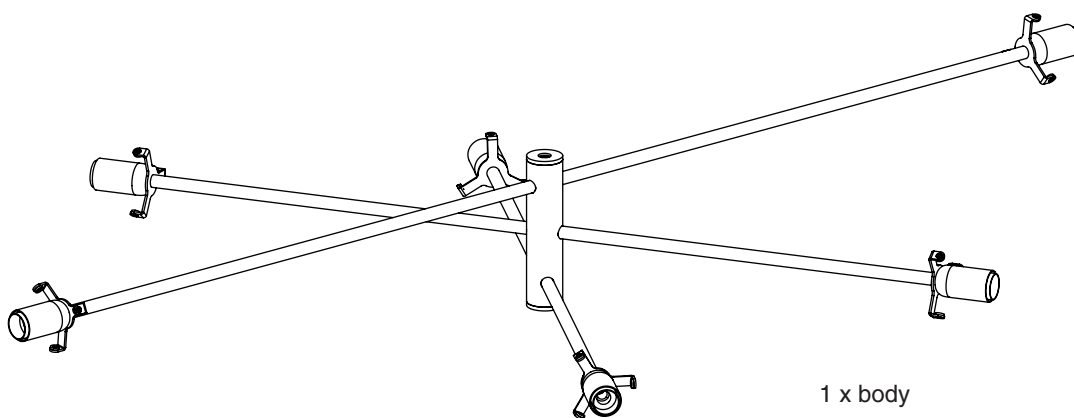

1 x body

BEFORE INSTALLATION

- Installation **must** be carried out by a qualified electrician.
- A minimum of **two people** is required to install this pendant.
- Check that the ceiling fixing and components are suitable and strong enough to support the weight of the pendant.

INSTALLATION SUMMARY

1. Remove contents from the box.
2. Make wiring connections
3. Fit drop rod
4. Hang pendant
5. Fit Lightbulbs and then glass shades

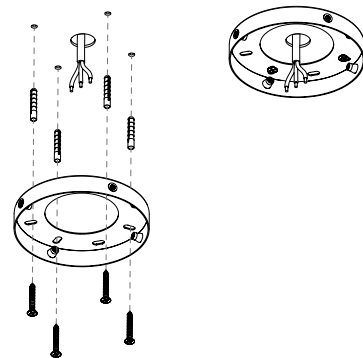

-
1. Fix the ceiling plate to the ceiling.
Ensure that suitable screws are being used
for the surface you are mounting to.

-
2. Feed the power cable from the drop-rod into the ceiling box.
Screw the drop rod to the central hub of the pendant.

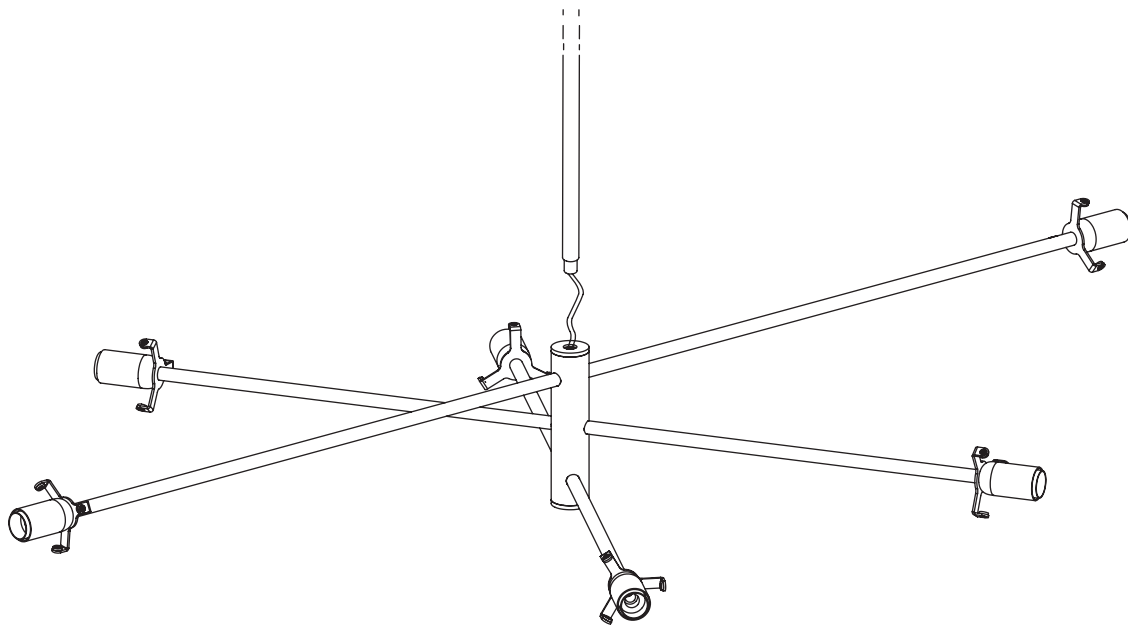

4. Raise the pendant towards the ceiling and make the electrical connections.
Further raise the pendant, closing the ceiling box to the ceiling plate and secure with the provided screws.

NOTE: Ensure that the weight of the pendant is fully supported during the electrical installation.

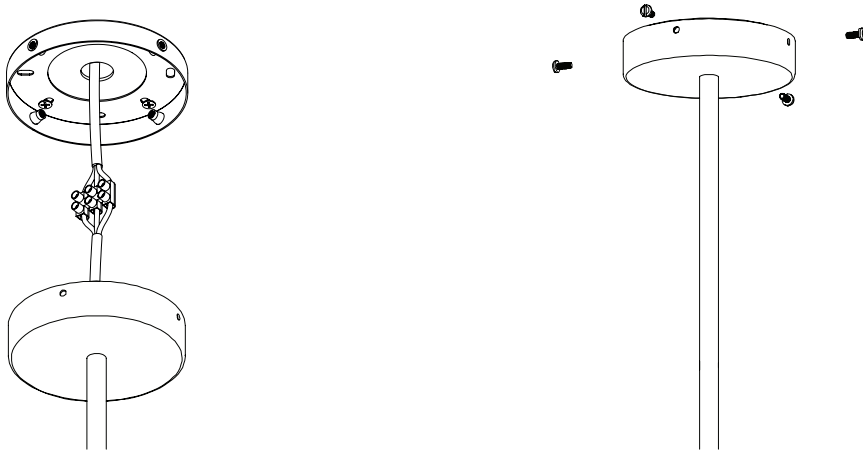

5. Fit the bulbs (not supplied) to the lamp-holder.

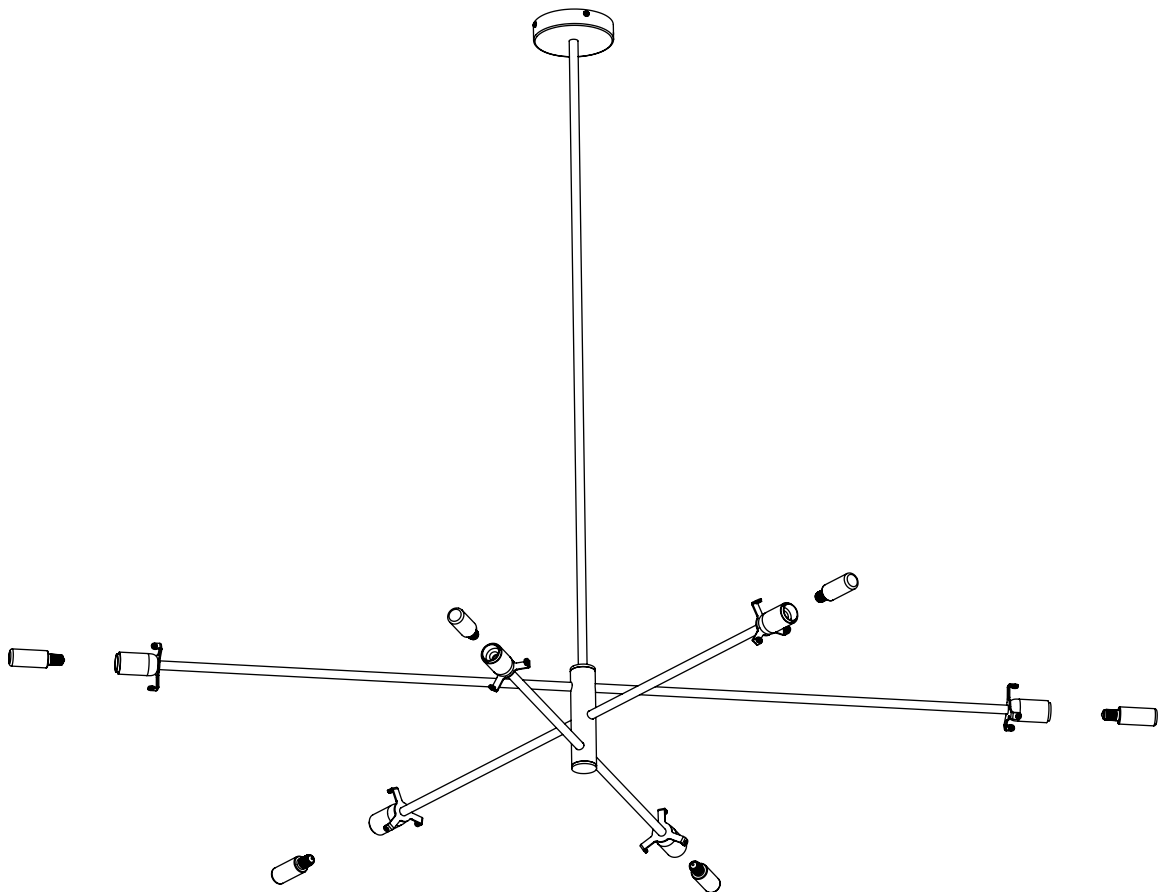

6. Fit the glass cones to the pendant body by using the provided screws.
Do not forget to add the protective rubber grommet between the metal screws and glass shades.

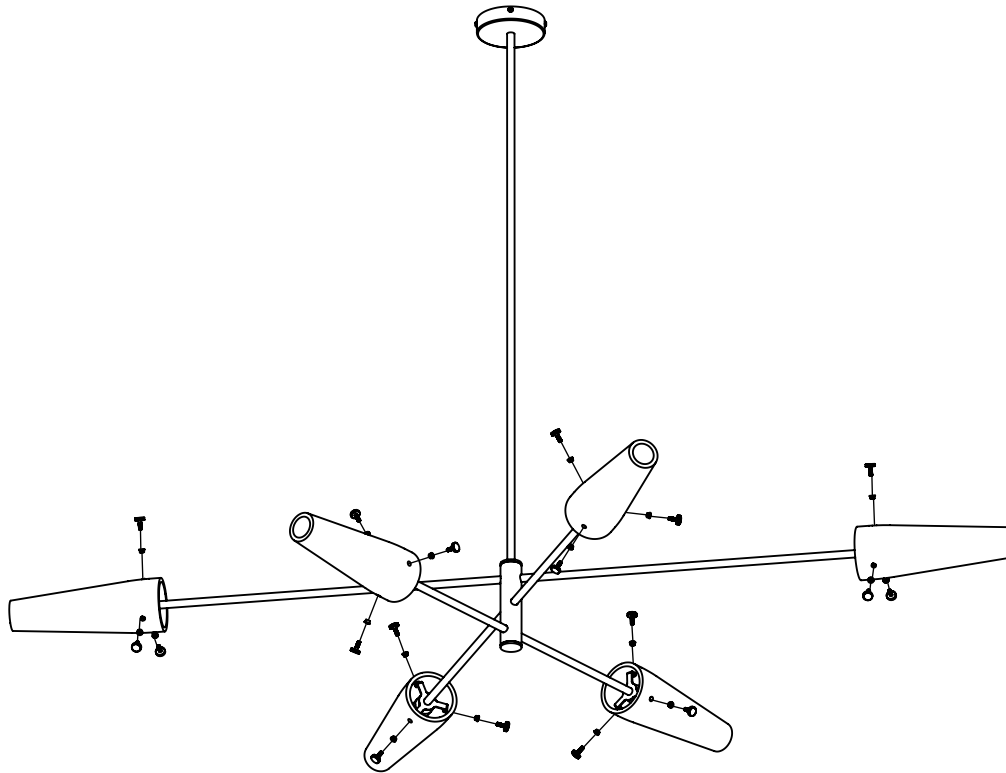

CTO Lighting
9 Cloudesley Road
London
N1 0FH

tel: +44 (0)20 7686 8700
fax: +44 (0)20 7686 8701

info@ctolighting.co.uk
www.ctolighting.co.uk