

13



13-AMA-B

TOOLS REQUIRED











PH2
DRIVER



ALLEN
KEY

FLUSH ADJUSTABLE MOUNTING ASSEMBLY

COMPATIBLE PRODUCT INDEX

	PRODUCT	SKU
	FLUSH DOUBLE OUTLET	13-O
	MOVABLE DOUBLE OUTLET	13-OM
	FLUSH DOUBLE OUTLET USB - A	13-O-USB
	MOVABLE DOUBLE OUTLET USB-A	13-OM-USB
	FLUSH 1 GANG SWITCH GRID	13-1F
	FLUSH 2 GANG SWITCH GRID	13-2F
	FLUSH 3 GANG SWITCH GRID	13-3F
	FLUSH 4 GANG SWITCH GRID	13-4F
	FLUSH 5 GANG SWITCH GRID	13-5F

ⓘ ATTENTION

THE SAFETY OF THE DEVICE IS GUARANTEED WHEN THE INSTRUCTIONS AND USE ARE IN-LINE WITH THOSE OUTLINED. IT IS RECOMMENDED THAT THIS MANUAL IS STORED SAFELY AND REFERRED TO THROUGHOUT THE LIFE OF THE DEVICE.

⚠ DANGER

ELECTRIC SHOCK, EXPLOSION OR ARC FLASH HAZARD

Hazardous voltage and electrical current may be present at the wire leads of this product even when the device is switched off.

⚠ WARNING

WHEN CARRYING OUT INSTALLATION OR MAINTENANCE, IT IS ESSENTIAL TO ISOLATE SUPPLY AND FOLLOW THE CORRECT LOCK OUT AND TAG PROCEDURE AT THE POINT OF SUPPLY BEFORE ACCESSING THE DEVICE.

- The device must be installed according to the instructions outlined in this document.
- The device must be installed with care, by a licensed electrician/tradesman
- Installation must comply with Australian and New Zealand standards ASNZ3000.
- Pay attention to the wiring diagrams and specifications related to the installation.
- Do not use this product for any other purpose than specified in this manual.
- If any part of the device is damaged prior to installation it must be replaced/repared by the manufacturer or licensed service agent prior to installation
- The device must not be modified, or force fit. Any modification or non-compliant installation will jeopardise system safety and/ or result in equipment damage or malfunction.
- ZETR forfeits any liability and warranty for any modified product and/or installation

INSTALLATION GUIDE

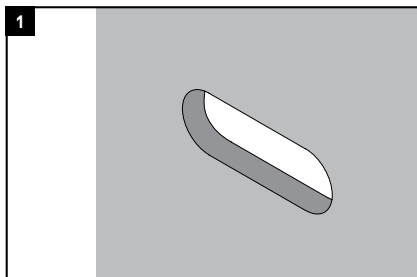

1 **ⓘ ATTENTION** We recommend that the hole cut-out in your substrate is laser, waterjet or CNC cut. Hand cutting may produce undesired results. Consult your substrate fabricator for best results.

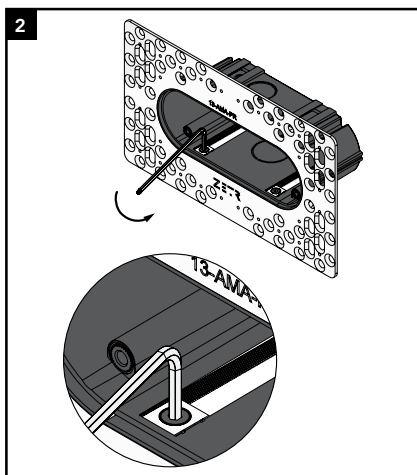

Using the allen key provided loosen the 4x dovetail washers contained in the mounting assembly.

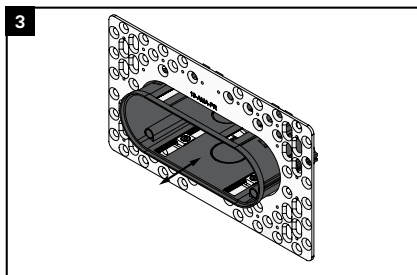

The inner shroud should freely move back and forth within the mesh frame.

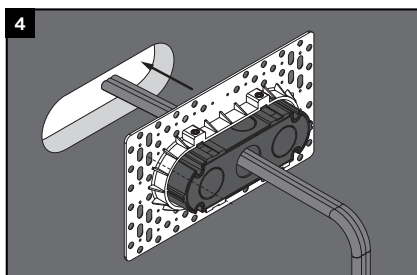

Pull the cable through the mounting assembly and thread through the hole cut-out.

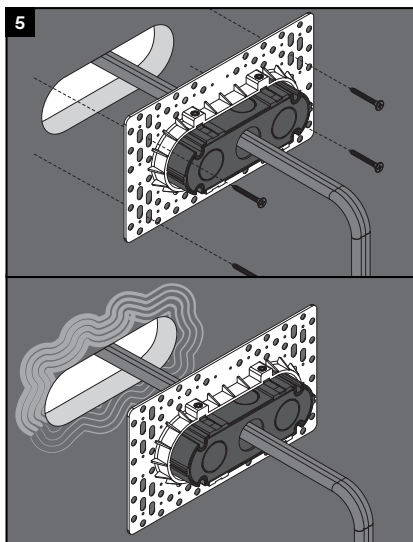

Using self-tapping screws or adhesive fasten the mesh to the back side of your substrate, then push the inner shroud through the cut-out.
N.B. Consult your substrate fabricator or contractor for best fastening method.

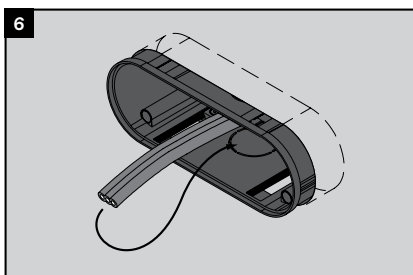

Tuck the cable into the inner shroud.

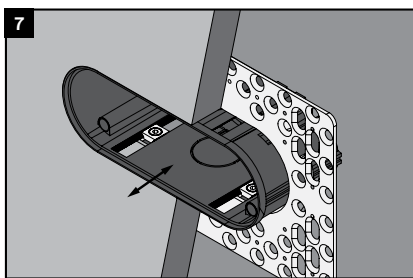

Adjust the inner shroud so it is flush to the front-side of your substrate.

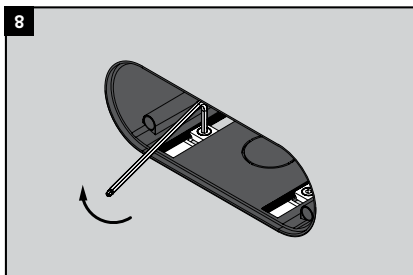

Using the allen key provided tighten the 4x dovetail washers to set the inner shroud.

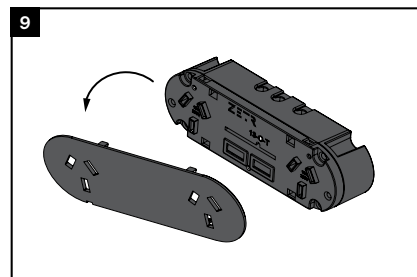

Remove the faceplate from the outlet/switchgrid and safely store until required.

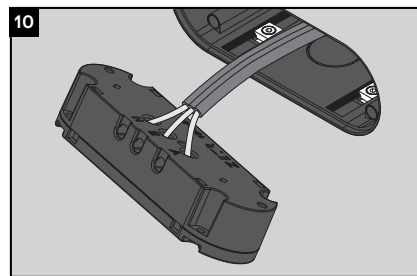

Terminate wiring or desired service.
N.B. If installing a switchgrid, insert your mechanisms prior to termination.

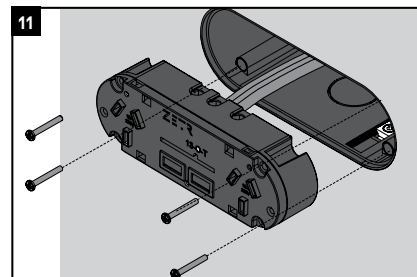

Screw the device to the mounting accessory using the M3 x 25mm Pan Head Screws provided.
N.B. A minimum of 4 x fixings for outlets and switch grids are required.

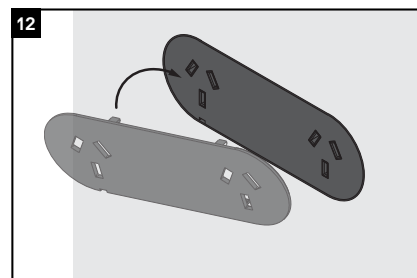

Snap fit the faceplate to the device. Wipe the device with a soft damp cloth or detergent-impregnated wipes to complete installation.

13



13-FMA

TOOLS REQUIRED



35MM
HOLE SAW











DRYWALL
SAW



PH2
DRIVER

FLUSH FIXED MOUNTING ASSEMBLY

COMPATIBLE PRODUCT INDEX

	PRODUCT	SKU
	FLUSH DOUBLE OUTLET	13-O
	MOVABLE DOUBLE OUTLET	13-OM
	FLUSH DOUBLE OUTLET USB - A	13-O-USB
	MOVABLE DOUBLE OUTLET USB-A	13-OM-USB
	FLUSH 1 GANG SWITCH GRID	13-1F
	FLUSH 2 GANG SWITCH GRID	13-2F
	FLUSH 3 GANG SWITCH GRID	13-3F
	FLUSH 4 GANG SWITCH GRID	13-4F
	FLUSH 5 GANG SWITCH GRID	13-5F

ⓘ ATTENTION

THE SAFETY OF THE DEVICE IS GUARANTEED WHEN THE INSTRUCTIONS AND USE ARE IN-LINE WITH THOSE OUTLINED. IT IS RECOMMENDED THAT THIS MANUAL IS STORED SAFELY AND REFERRED TO THROUGHOUT THE LIFE OF THE DEVICE.

⚠ DANGER

ELECTRIC SHOCK, EXPLOSION OR ARC FLASH HAZARD

Hazardous voltage and electrical current may be present at the wire leads of this product even when the device is switched off.

⚠ WARNING

WHEN CARRYING OUT INSTALLATION OR MAINTENANCE, IT IS ESSENTIAL TO ISOLATE SUPPLY AND FOLLOW THE CORRECT LOCK OUT AND TAG PROCEDURE AT THE POINT OF SUPPLY BEFORE ACCESSING THE DEVICE.

- The device must be installed according to the instructions outlined in this document.
- The device must be installed with care, by a licensed electrician/tradesman
- Installation must comply with Australian and New Zealand standards ASNZ3000.
- Pay attention to the wiring diagrams and specifications related to the installation.
- Do not use this product for any other purpose than specified in this manual.
- If any part of the device is damaged prior to installation it must be replaced/repared by the manufacturer or licensed service agent prior to installation
- The device must not be modified, or force fit. Any modification or non-compliant installation will jeopardise system safety and/or result in equipment damage or malfunction.
- ZETR forfeits any liability and warranty for any modified product and/or installation

INSTALLATION GUIDE

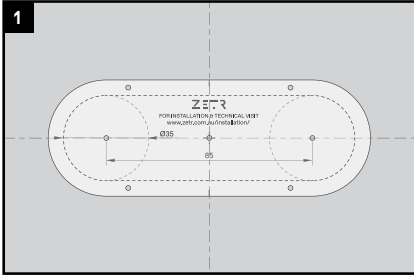

Align the centre of the template provided to the centre of where you'd like to install your outlet/switchgrid. Once aligned, mark both left and right hole centres.

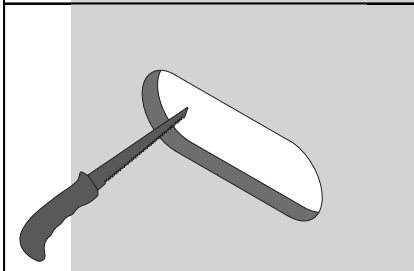
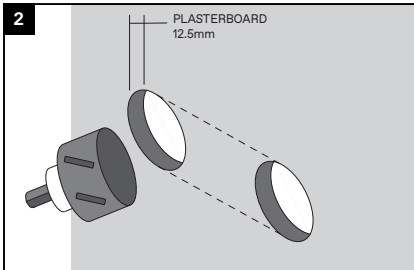

A. Cut 2 x holes using your markings as the centre point.
B. Make 2 straight cuts connecting the 2 holes. Ensure these are tangential with the top and bottom of these holes.

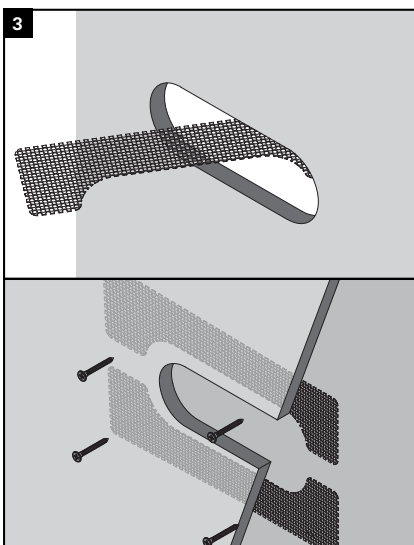

A. Insert the mesh panel into the hole. Once inserted, hold flat against the back of the wall.
B. Drive self-tapping screws from the front of the wall through the plasterboard and mesh to fasten.

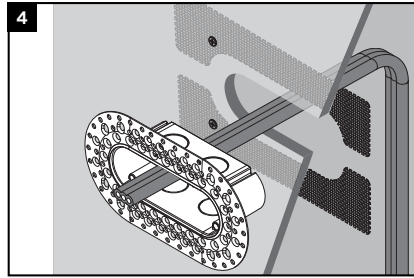

Pull the cable through the hole cut-out and thread through the mounting accessory.

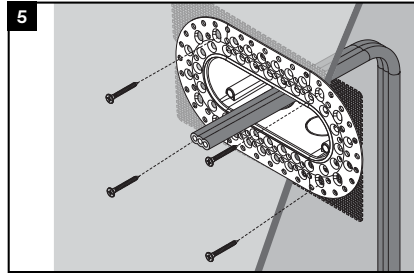

Insert 13-FMA into the hole cut-out, drive self-tapping screws through the mounting accessory, plasterboard and mesh to fasten.

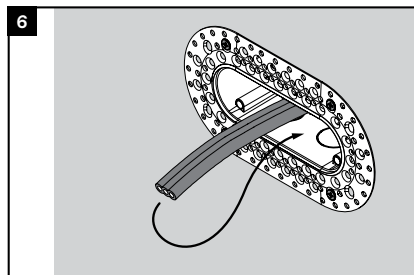

Tuck the cable into the body of the mounting accessory and prepare to plaster.

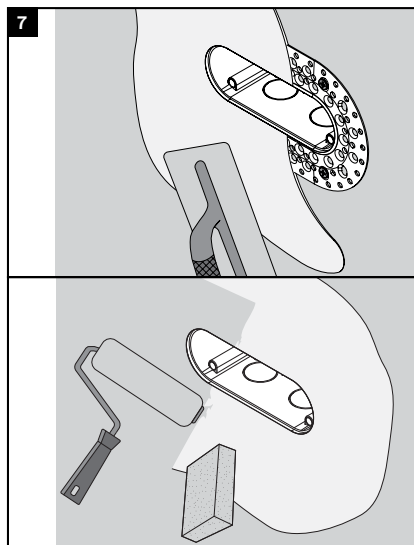

A. Apply wall plaster using spatula or trowel ensuring that the edges are tapered.
B. Sand the plaster ensuring that the edges are feathered and the transition between wall and mounting assembly is smooth.
C. Paint over the top. For best results and uniformity, we recommend the entire wall/panel is painted.

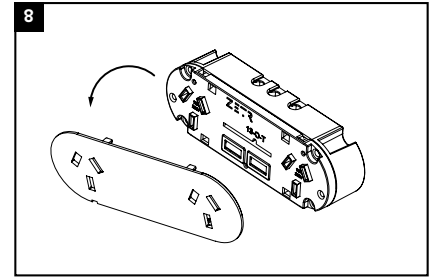

Remove the faceplate from the outlet/switchgrid and safely store until required.

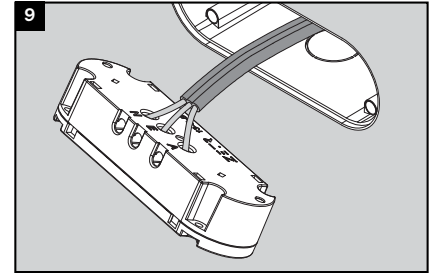

Terminate wiring or desired service.
N.B. If installing a switchgrid, insert your mechanisms prior to termination.

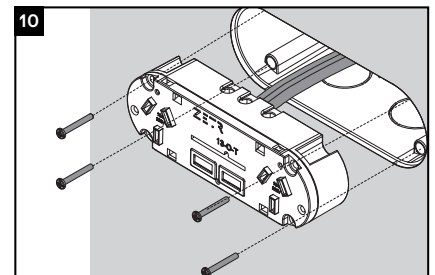

Screw the device to the mounting assembly using the M3 x 25mm Pan Head Screws provided.
N.B. A minimum of 4 x fixings for outlets and switch grids are required.

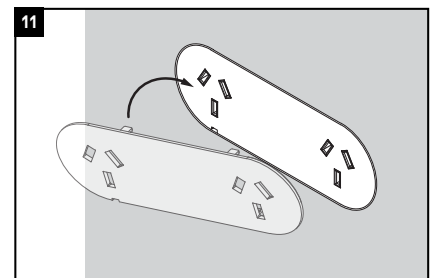

Snap fit the faceplate to the device. Wipe the device with a soft damp cloth or detergent-impregnated wipes to complete installation.