

12-RB

TOOLS REQUIRED



35MM
HOLE SAW



DRYWALL
SAW



PH2
DRIVER

SURFACE RENDER BRACKET

COMPATIBLE PRODUCT INDEX

	PRODUCT	SKU
	SURFACE DOUBLE OUTLET	12-O
	SURFACE SINGLE GANG SWITCH GRID	12-1S
	SURFACE TWO GANG SWITCH GRID	12-2S
	SURFACE THREE GANG SWITCH GRID	12-3S
	SURFACE FOUR GANG SWITCH GRID	12-4S

ⓘ ATTENTION

THE SAFETY OF THE DEVICE IS GUARANTEED WHEN THE INSTRUCTIONS AND USE ARE IN-LINE WITH THOSE OUTLINED. IT IS RECOMMENDED THAT THIS MANUAL IS STORED SAFELY AND REFERRED TO THROUGHOUT THE LIFE OF THE DEVICE.

⚠ DANGER

ELECTRIC SHOCK, EXPLOSION OR ARC FLASH HAZARD

Hazardous voltage and electrical current may be present at the wire leads of this product even when the device is switched off.

⚠ WARNING

WHEN CARRYING OUT INSTALLATION OR MAINTENANCE, IT IS ESSENTIAL TO ISOLATE SUPPLY AND FOLLOW THE CORRECT LOCK OUT AND TAG PROCEDURE AT THE POINT OF SUPPLY BEFORE ACCESSING THE DEVICE.

- The device must be installed according to the instructions outlined in this document.
- The device must be installed with care, by a licensed electrician/tradesman
- Installation must comply with Australian and New Zealand standards AS/NZS3000.
- Pay attention to the wiring diagrams and specifications related to the installation.
- Do not use this product for any other purpose than specified in this manual.
- If any part of the device is damaged prior to installation it must be replaced/repared by the manufacturer or licensed service agent prior to installation
- The device must not be modified, or force fit. Any modification or non-compliant installation will jeopardise system safety and/or result in equipment damage or malfunction.
- ZETR forfeits any liability and warranty for any modified product and/or installation

INSTALLATION GUIDE

This is a guide only. Installation must comply with Australian and New Zealand standards ASNZ3000.

12 SURFACE RENDER BRACKET / 12-RB

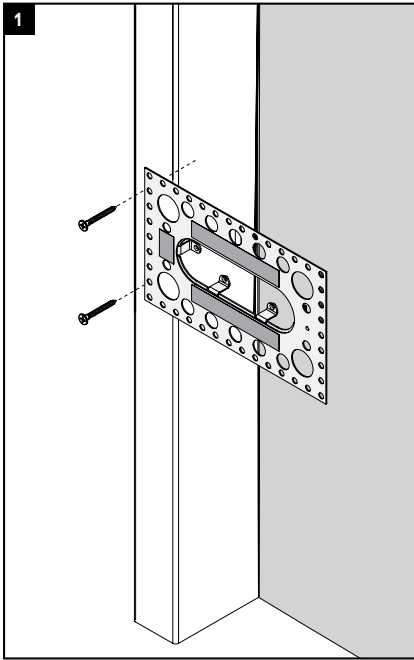

Prior to sheeting walls, screw the 12-RB accessory to the wall stud at the desired location of your device.

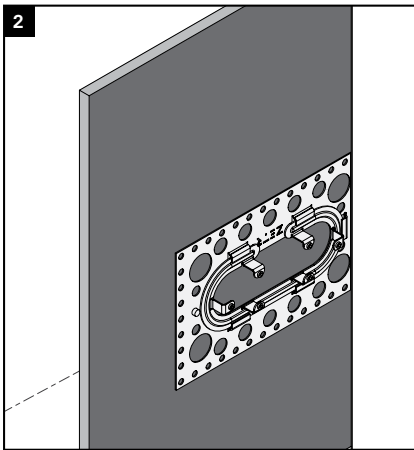

Sheet the wall, ensuring the centre point of the 12-RB is recorded.

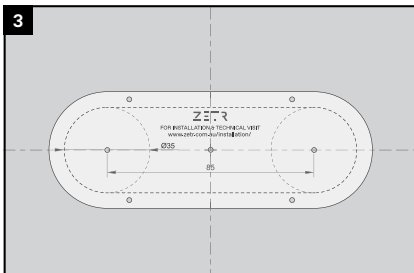

Align the template centre to your marked centre. Mark both left and right hole centres.

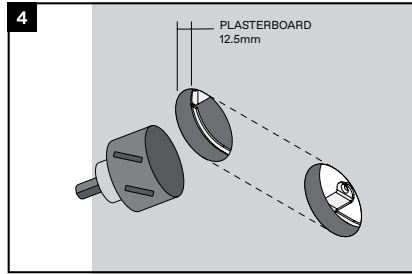

Cut 2 x 35mm holes using the centre point markings.

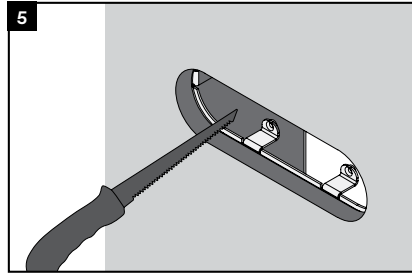

Make 2 straight cuts that are tangential with the top and bottom of these holes.

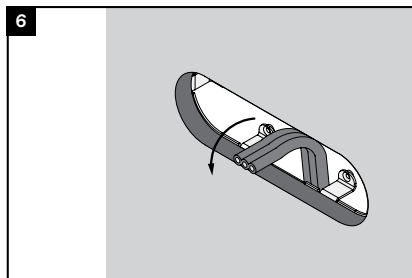

Pull cable through the hole cut out.

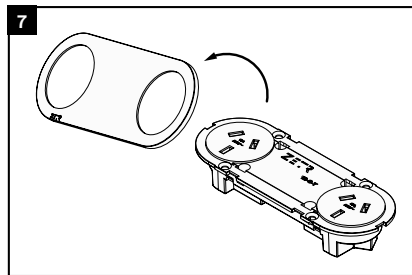

Remove the faceplate from the outlet/switchgrid and safely store until required.

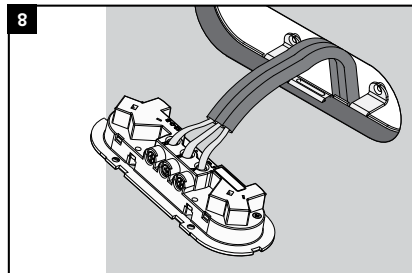

Terminate wiring or desired service.
Note If installing a switchgrid, insert your mechanisms prior to termination.

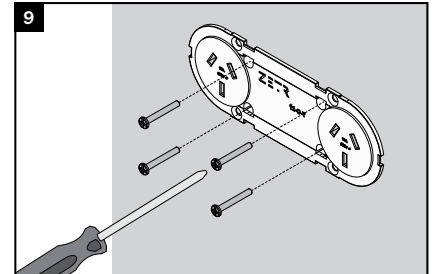

Screw the device to the bracket using the M3 x 35mm Pan Head Screws provided
N.B. A minimum of 4 x fixings for outlets and 2 x fixings for switch grids are required

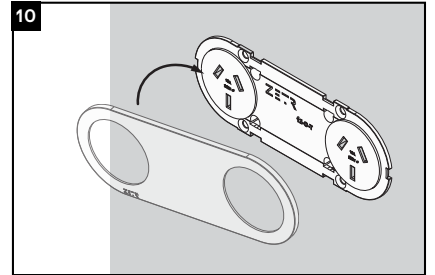

Snap fit the faceplate to the device.

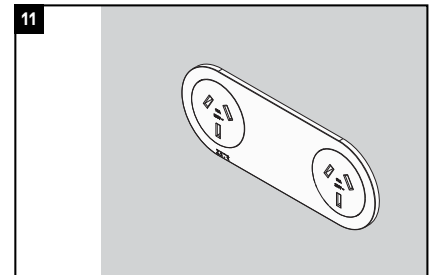

Wipe the device with a soft damp cloth or detergent-impregnated wipes to complete installation.



12-ZC

TOOLS REQUIRED



35MM
HOLE SAW



DRYWALL
SAW



PH2
DRIVER

SURFACE Z CLIP

COMPATIBLE PRODUCT INDEX

	PRODUCT	SKU
	SURFACE DOUBLE OUTLET	12-O
	SURFACE SINGLE GANG SWITCH GRID	12-1S
	SURFACE TWO GANG SWITCH GRID	12-2S
	SURFACE THREE GANG SWITCH GRID	12-3S
	SURFACE FOUR GANG SWITCH GRID	12-4S

ⓘ ATTENTION

THE SAFETY OF THE DEVICE IS GUARANTEED WHEN THE INSTRUCTIONS AND USE ARE IN-LINE WITH THOSE OUTLINED. IT IS RECOMMENDED THAT THIS MANUAL IS STORED SAFELY AND REFERRED TO THROUGHOUT THE LIFE OF THE DEVICE.

⚠ DANGER

ELECTRIC SHOCK, EXPLOSION OR ARC FLASH HAZARD

Hazardous voltage and electrical current may be present at the wire leads of this product even when the device is switched off.

⚠ WARNING

WHEN CARRYING OUT INSTALLATION OR MAINTENANCE, IT IS ESSENTIAL TO ISOLATE SUPPLY AND FOLLOW THE CORRECT LOCK OUT AND TAG PROCEDURE AT THE POINT OF SUPPLY BEFORE ACCESSING THE DEVICE.

- The device must be installed according to the instructions outlined in this document.
- The device must be installed with care, by a licensed electrician/ tradesman
- Installation must comply with Australian and New Zealand standards AS/NZS 3000.
- Pay attention to the wiring diagrams and specifications related to the installation.
- Do not use this product for any other purpose than specified in this manual.
- If any part of the device is damaged prior to installation it must be replaced/ repaired by the manufacturer or licensed service agent prior to installation
- The device must not be modified, or force fit. Any modification or non-compliant installation will jeopardise system safety and/ or result in equipment damage or malfunction.
- ZETR forfeits any liability and warranty for any modified product and/ or installation

INSTALLATION GUIDE

This is a guide only. Installation must comply with Australian and New Zealand standards ASNZ3000.

12 SURFACE Z CLIP / 12-ZC

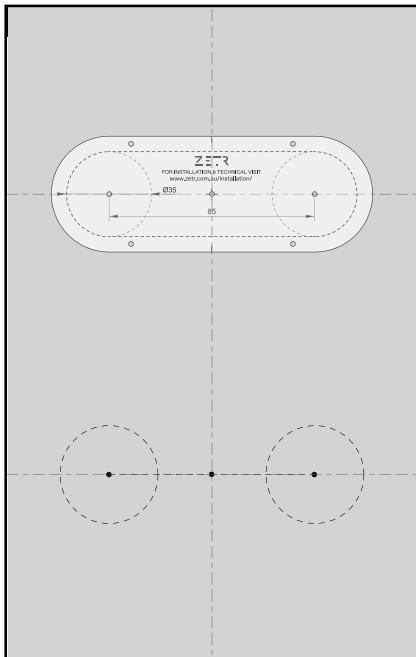

Align the centre of the template provided to the centre of where you'd like to install your outlet/switchgrid. Once aligned, mark both left and right hole centres.

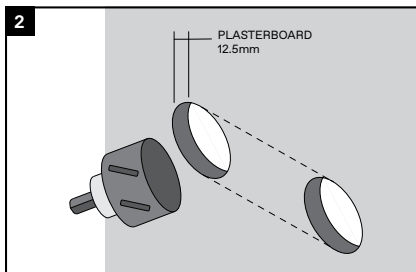

Cut 2 x 35mm holes using the centre point markings.

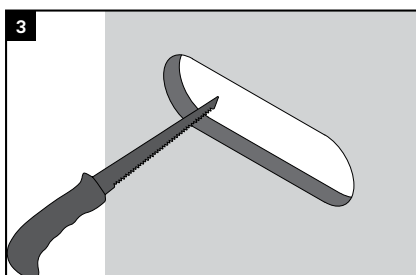

Make two straight cuts connecting the 2 holes. Ensure that these are tangential with the top and bottom of these holes.

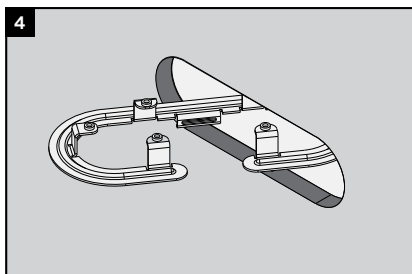

Insert the 12-ZC into the hole.

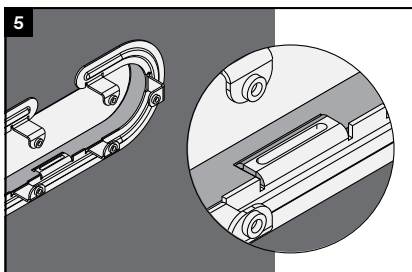

Butt the flat face to the back of the wall and insert the tongue into the edge of the plasterboard.

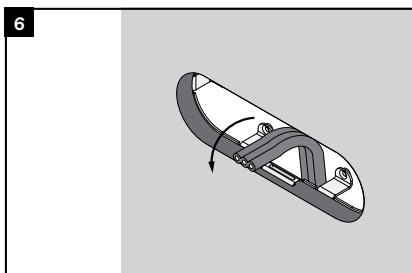

Pull cable through the hole cut out.

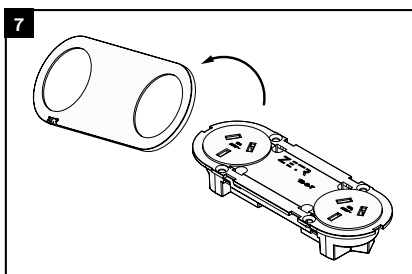

Remove the faceplate from the outlet/switchgrid and safely store until required.

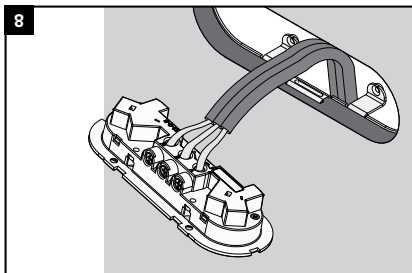

Terminate wiring or desired service.
N.B. If installing a switchgrid, insert your mechanisms prior to termination.

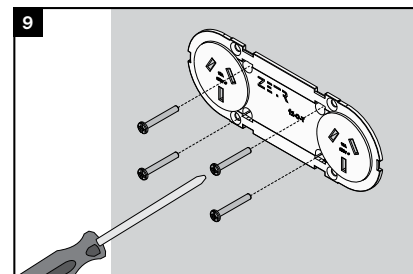

Screw the device to the bracket using the M3 x 35mm Pan Head Screws provided
N.B. A minimum of 4 x fixings for outlets and 2 x fixings for switch grids are required

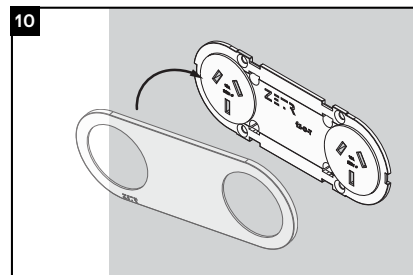

Snap fit the faceplate to the device.

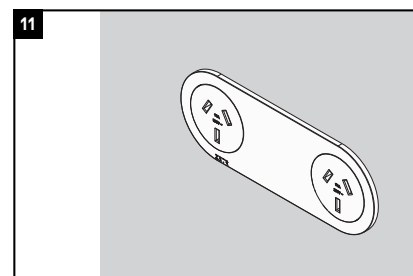

Wipe the device with a soft damp cloth or detergent-impregnated wipes to complete installation.