

Instruction Manual



C o r t e b e r t



To ensure correct care, please take some time to review the enclosed instructions to review how to operate your watch.

Vol.1.07 EN

Cortebert

ELEVATION WORLD TIMER

For the jetsetter on the go, the Elevation World Time edition reads off the planet's 24 hour time zone with ease thanks to the inner turning world city time zone bezel. Efficiently organized, the watch is a bold masculine piece of wrist worn equipment for any occasion.

For more details on operating this timepiece please refer to the enclosed booklet or visit :

IM.CORTEBERT1790.COM

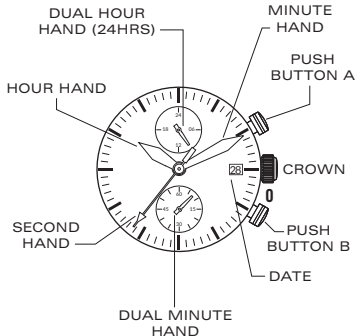

CROWN FOR INNER
WORLD CITIES
TURNING BEZEL



Remarks:
The measurement time indicated by the stopwatch hands move independently of the center hands.

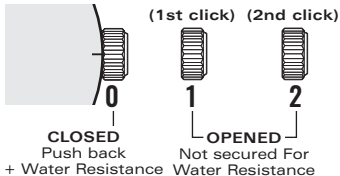

HOW TO SET THE TIME

1. Pull the crown out to position [2]-(2nd click).
2. Turn the crown clockwise to set the correct time.
3. Push the crown in.

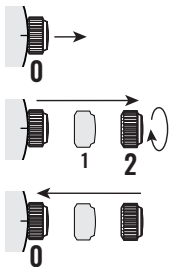

* Take a.m./p.m. into consideration when setting the hour and minute hands to the desired time.

HOW TO SET THE DATE

1. Pull the crown out to position [1]-(1st click).
2. Turn the crown clockwise to set the correct date.
3. Push the crown in.

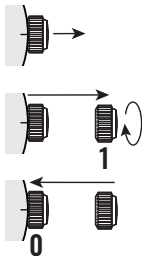

* Do not set the date between 9:00 P.M. and 1:00 A.M.

DUAL TIME SETTING

While staying in a place in a different time zone from where you usually use this watch, you can set the dual time hour hand to indicate the local time of the place where you are staying.

QUICK SETTING OF THE DUAL TIME

1. Keep the crown at position [0].
2. Press Push Button A or B to set the dual time hour hand to indicate the local time of the place where you are staying.
 - Button A : - 1 hour / push
 - Button B : +1 hour / push

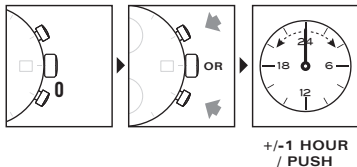

PRECISE ADJUSTMENT OF THE DUAL TIME

1. Pull the crown at position **[2]**-(2nd click) when the second hand is at 12 o'clock.
2. Press Push Button A or B to set the dual time hour hand to indicate the local time of the place where you are staying.
 - Button A : -1 minute / push
 - Button B : +1 minute / push
3. Push the crown back to position **[0]**.

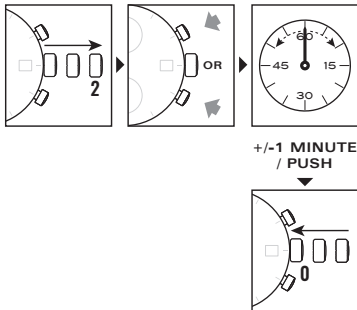

Note:

The dual minute hand rotates one revolution at every quarter (15 minutes). There is no problem as it is typical function of the movement.

ADJUSTING DUAL TIME HANDS POSITION

* After setting or changing the battery, before setting the time, check if the dual hour hand and dual minute hand are at the "0" (12 o'clock) position. If it is not, please follow the procedures below.

1. Pull out the crown to position **[2]**-(2nd click).

2. Press and hold buttons A & B simultaneously for 2 seconds or longer.

* Dual minute hand moves and returns to where it was.

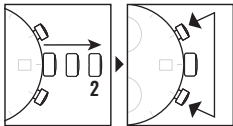

3. Press button A or B to reset the dual time hands to "0" position.

- Button A : dual hour hand moves clockwise
- Button B : dual minute hand moves clockwise

* The dual time hands move quickly if the respective buttons are kept pressed.

4. Push the crown back to position **[0]**.

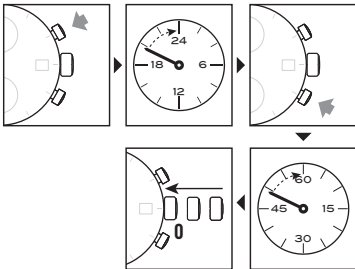

Example: Perhaps you want to know the time of Paris while in Tokyo.

[The main time display is set according to the time in Tokyo.]

1. Read and change the present time [hour] into 24-hour format.
[10 o'clock p.m. → 22:00]
2. Adjust the city name [Tokyo = TYO] above the rotating bezel to 22:00 of 24-hour-scale.
3. You can determine the time of Paris [= PAR] is 14:00 [2:00 p.m.] by reading the 24-hour scale corresponding to the position of the city name displayed above the rotating bezel.

The time difference between major cities is in hours only, the minutes remain the same.

You can find out the time of other cities in the same way, however be sure to account for daylight savings time as this cannot be calculated using the bezel ring or dial ring.

WATER RESISTANCE

The water resistance indicated on your timepiece serves only as a guide. Actual water resistance may vary depending on a number of important factors including temperature, water salinity, and actual use under water.

The water resistance of your timepiece may eventually be compromised over time with general wear and tear and the use of your watch under adverse conditions.

Always remember to employ the screw down crown (if available) to maintain the water resistance of your timepiece. Warranty may be voided if the screw down crown has not been properly employed.

Note that you should **NEVER** wear your watch in a jacuzzi, hot shower or steam room where steam may enter the case despite the watertight seals used to protect your watch.

The steam may cause condensation inside your watch, which may affect and damage the inner workings of your watch – which would also not be covered by the warranty.