

turbo twister

by **TANNING
essentials**™



**PROFESSIONAL & PORTABLE
SPRAY TANNING FILTER SYSTEM**

**TANNING
essentials**
SIMPLY UNCOMPLICATED TANNING SYSTEMS

Australia • China • United Kingdom • USA

turbo twister

by **TANNING**
essentials™

SET UP GUIDE

Setting up your filter is easy:



1. Unpack System from packaging



2. Connect the power cord

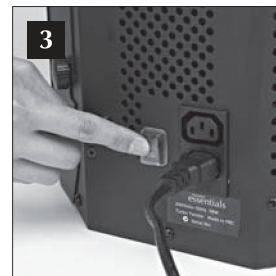

3. Turn on just prior to the application

IMPORTANT NOTE: For best performance, position the unit in a vertical position directly behind where the spraying will occur.

HOW TO CHANGE FILTERS

The filters must be changed not washed. Filters need to be changed immediately when the spray solution starts to become visible on the backside of the filter. This is normal at between 80-120 sprays depending on use. Always keep spare filters handy (item number TE301019F).



1. Unscrew screws on both sides of the cover

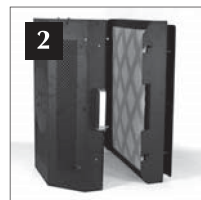

2. Remove the cover



3. Detach and remove the old filter from inside the cover



4. Insert the new filter, re-position cover and tighten screws