

HOW TO IDENTIFY THE UNIT

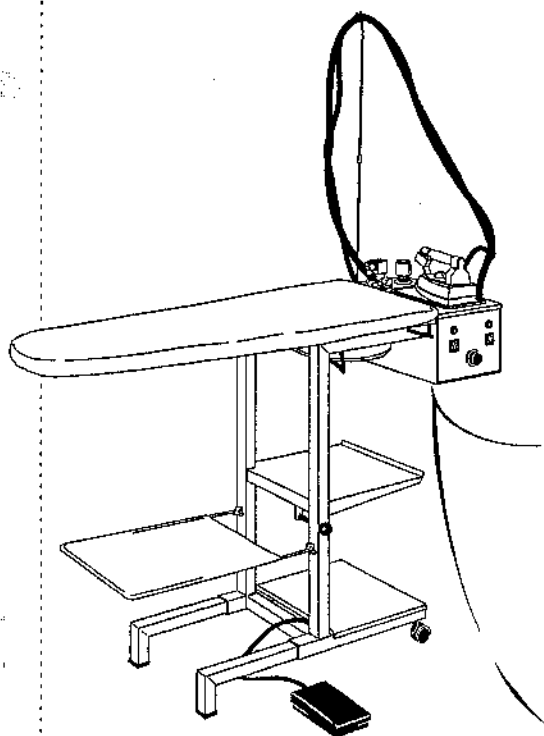

DATA COSTRUTTORE: Comel S.p.A. - PERGOLA (PS) - ITALY MODELLO: Tavolo da stiro NUMERO DI SERIE: 220 - 240 V - 50 Hz A	
POTENZA ELETTRICA RESISTENZA CALDAIA	W
POTENZA ELETTRICA RESISTENZA FERRO	W
POTENZA ELETTRICA RESISTENZA PIANO	W
POTENZA ELETTRICA MOTORE ASPIRATORE	W
CAPACITA' CALDAIA	IL
PRESSIONE ESERCIZIO	MP
PESO NETTO	Kg
DIMENSIONI INGOMBRO	L.....X.....X.....cm.

SERIAL NUMBER.....

100010

Data, descriptions and drawings in this manual are not binding.
The company reserves the right to make any change if necessary.

CO.M.E.L. SRL

COSTR. ELETTROMECCANICHE MACCHINE DA STIRO

61045 PERGOLA (PS) - ITALIA
VIA DELL' INDUSTRIA, 40
ZONA INDUSTRIALE SUD

TEL. 0721/735110 - 735111
FAX 0721/735114
P.O. Box 62 P.IVA 0045639 041 8

PLEASE READ CAREFULLY

modello
COMELUXC

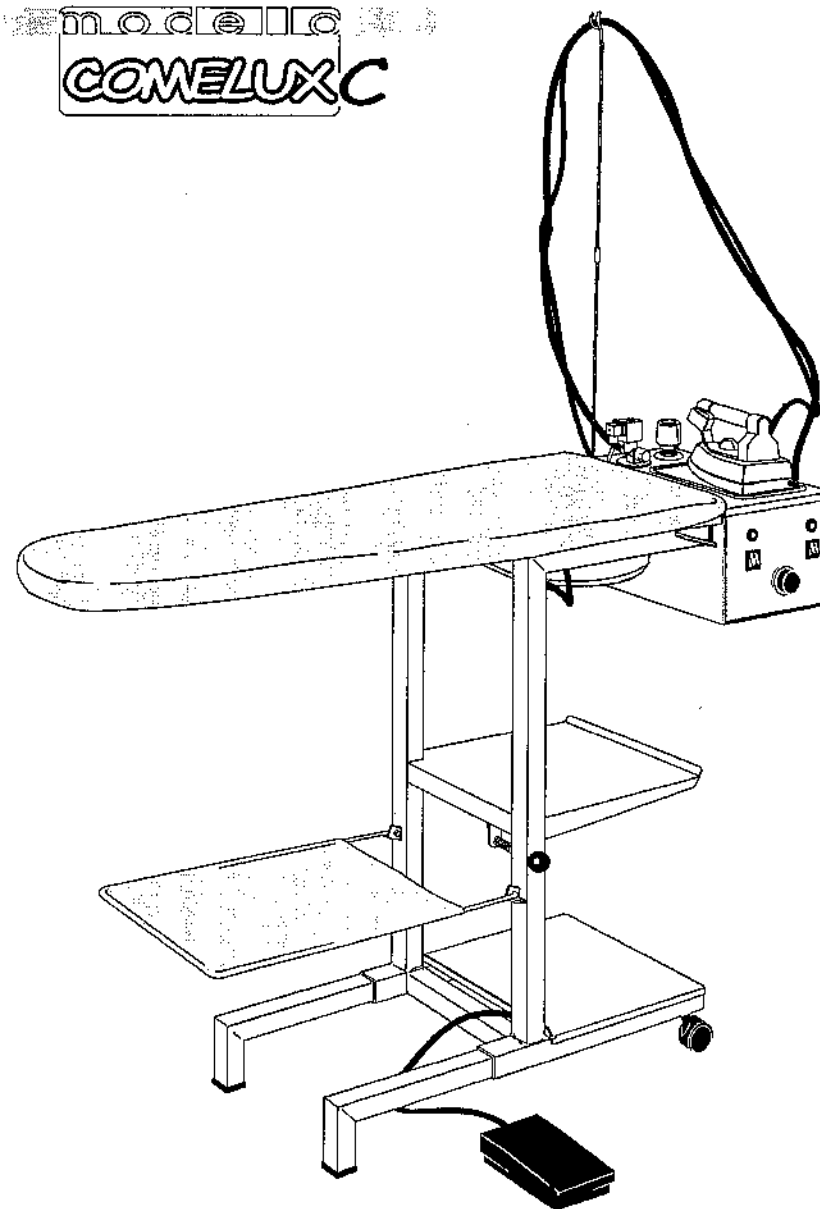

SERVICE AND USE INSTRUCTION MANUAL





cod. - A00049

MADE IN ITALY
Comel

INSTRUCTION MANUAL

ATTENTION

Please read carefully the overall instruction manual before carrying out any operation on the unit, in order to protect the operator and avoid any damage.

LABELS ON THE UNIT		ATTENTION- HEAT SOURCE-THERE MAY BE HIGH TEMPERATURES
		STOP TENSION BEFORE CARRYING OUT ANY OPERATION ON THE UNIT
		EARTH
WARNING SIGNS		DO NOT REMOVE ANY SAFETY DEVICE
		DO NOT CARRY OUT ANY OPERATION ON THE UNIT WHEN IT IS ON

SAFETY WARNINGS:

*Before using the unit, please verify that the mains voltage matches what is indicated on the unit plate. The unit must be plugged into mains and sockets duly earthed. * If the unit plug and the socket do not match, please have the plug replaced with a right one by qualified technicians. *The unit is electrically safe under the condition that it is duly earthed, as provided for by the current electrical safety rules. The manufacturer cannot be held responsible for any damage arising from the mains

being badly earthed. If in doubt, please contact a qualified technician. * After unpacking the unit, please make sure that it is untouched. If in doubt, do not operate the unit in any case and contact a qualified technician. *Please make sure that all packaging of the unit (plastic bags, expanded polystyrene,...) is away from children and carefully disposed of, since it may be dangerous. * Please do not use adaptors and/or extensions. If needed, only simple adaptors and extensions complying with the current safety rules must be used. However, please be careful and do not exceed the power limits marked on the adaptor. * The manufacturer cannot be held responsible for any damage arising from improper, wrong and unreasonable use of the unit and from careless service carried out by unqualified technicians. * Do not touch the unit with damp, wet hands or feet. Do not immerse the unit into water. * Do not operate the unit in bathrooms or any damp environment. * Do not pull the electric flex or the whole unit with damp, wet hands or feet. * Do not let children or the incompetent use the unit, unless under adults' control. * Do not leave the unit unattended when it is on, since it may turn dangerous. * Please make sure that the unit is turned off and disconnected from the power point before cleaning it out or carrying out any service on it. *Should the unit fail or work badly, please switch it off and never break it open. If service is needed, please contact service centres authorised by the manufacturer and ask for original spare parts to be used. Whether these warnings are disregarded, the safety of the unit may be undermined. * The user is kindly requested never to replace the electric flex of the unit. When it is damaged or needs being replaced, please contact service centres authorised by the manufacturer. *Please always disconnect the unit from the power point when it is not used.

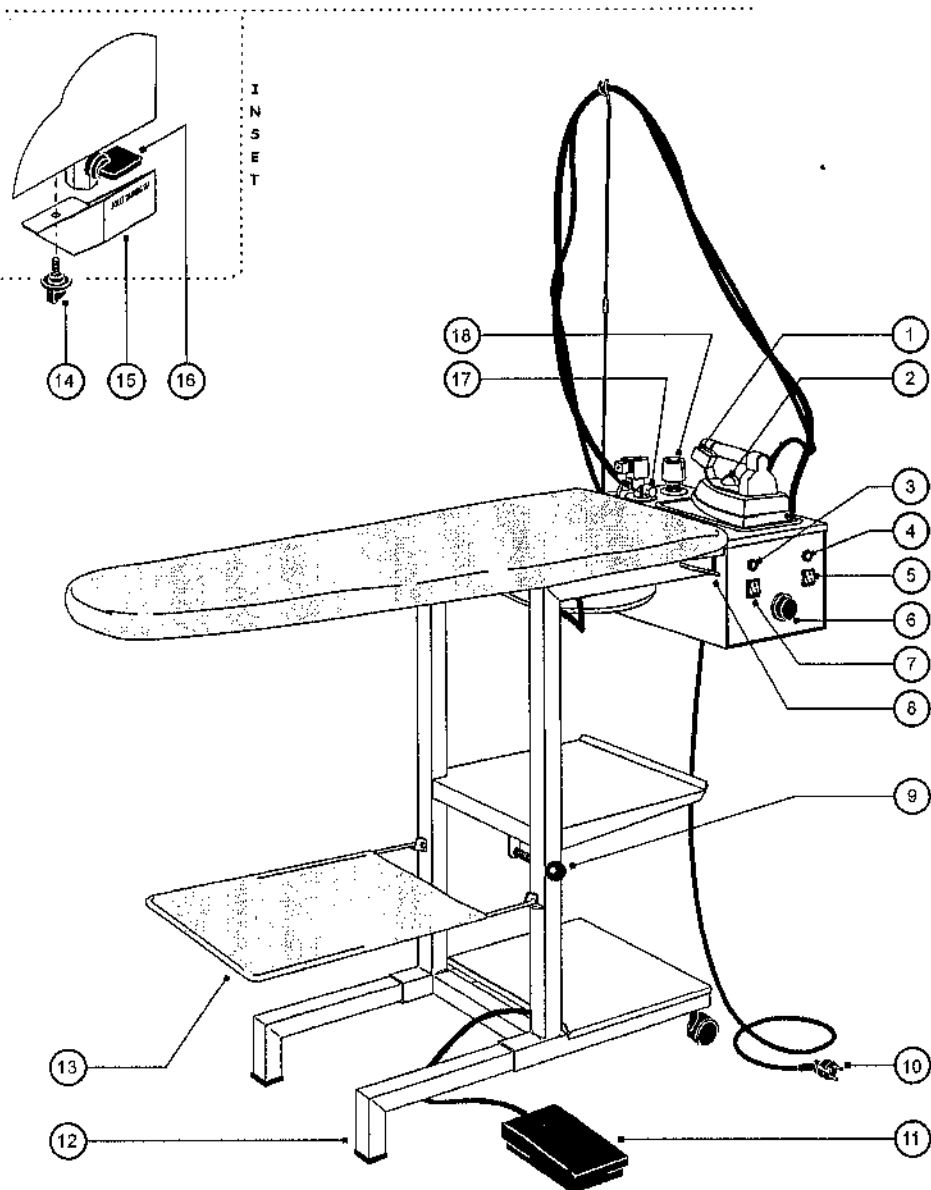

REFERENCES

1__STEAM SWITCH
2__IRON THERMOSTAT
3__WATER WARNING LIGHT
4__STEAM WARNING LIGHT
5__BOILER ON/OFF SWITCH
6__BOARD THERMOSTAT

7__IRON ON/OFF SWITCH
8__HOOK TO BLOCK THE BOARD HORIZONTALLY
9__HOOK TO BLOCK THE BOARD UPRIGHT
10__PLUG
11__VACUUM PEDAL
12__SLIDING FOOT

13__UNDER COVER TRAY
14__KNOB
15__PROTECTION CASE
16__BOILER DRAINING TAP
17__STEAM FLOW KNOB
18__FILLING TOP

HOW TO OPERATE THE UNIT:

"This ironing board has been designed to iron any kind of fabric in a professional way by means of a steady steam system"

INSTRUCTIONS

- Screw off the filling top (18) and fill the boiler with standard water. Screw the top on again mildly.
- Connect the plug (10) to a 220V, earthed power point.
- Press the boiler on/off switch (5) to start the boiler, press the iron on/off switch (7) to start the iron.
- Adjust the iron thermostat (2) between linen and cotton position (linen position is recommended when dry steam is needed, whereas cotton position is when damp steam is needed)
- Before any ironing, please wait for the steam warning light(4) to be lit. Should this warning light go off while you are ironing, please go on with your work. The warning light will come on automatically as soon as the steam has been available again.
- Use the board thermostat (6) to adjust the board temperature according to the fabric type pressed. Recommended temperature: 90°C.
- Press the iron micro switch (red push-button)(1) to have the steam coming out from the iron. When you have finished to iron, please operate shortly the vacuum pedal (11).
- Use the knob (17) to adjust the steam flow from the iron.
- How to close up and fold the ironing table:
please put the under cover tray (13) upright; catch the table by the handle below the boiler case and unblock the hook (8); let the table fold and stay upright; block the table in this position by means of the hook (9); let the feet (12) slide back to save space.

WARNINGS AND SUGGESTIONS:

- Never fill up the boiler.
- Never screw off the filling top (18) when the boiler is under pressure.
- Before screwing off the filling top (18) or draining the boiler by means of the tap (16), please be sure that no steam is still inside the boiler. (Take the protection (15) away to drain the boiler and please put it again in its original position once the boiler is drained just to prevent the protection from opening casually).
- Never let the unit unattended for long, when it is on.
- Once the steam is over, pull out the plug, let the unit rest for 20 minutes, then screw off the top (18) very slowly and refill the water inside the boiler. Now repeat the steps described above.

MANUFACTURER'S
SPARE PARTS

If service is needed, please contact service centres authorized

by the manufacturer and ask for original spare parts to be used.

Whether this warning is disregarded, the safety of the unit

may be undermined.



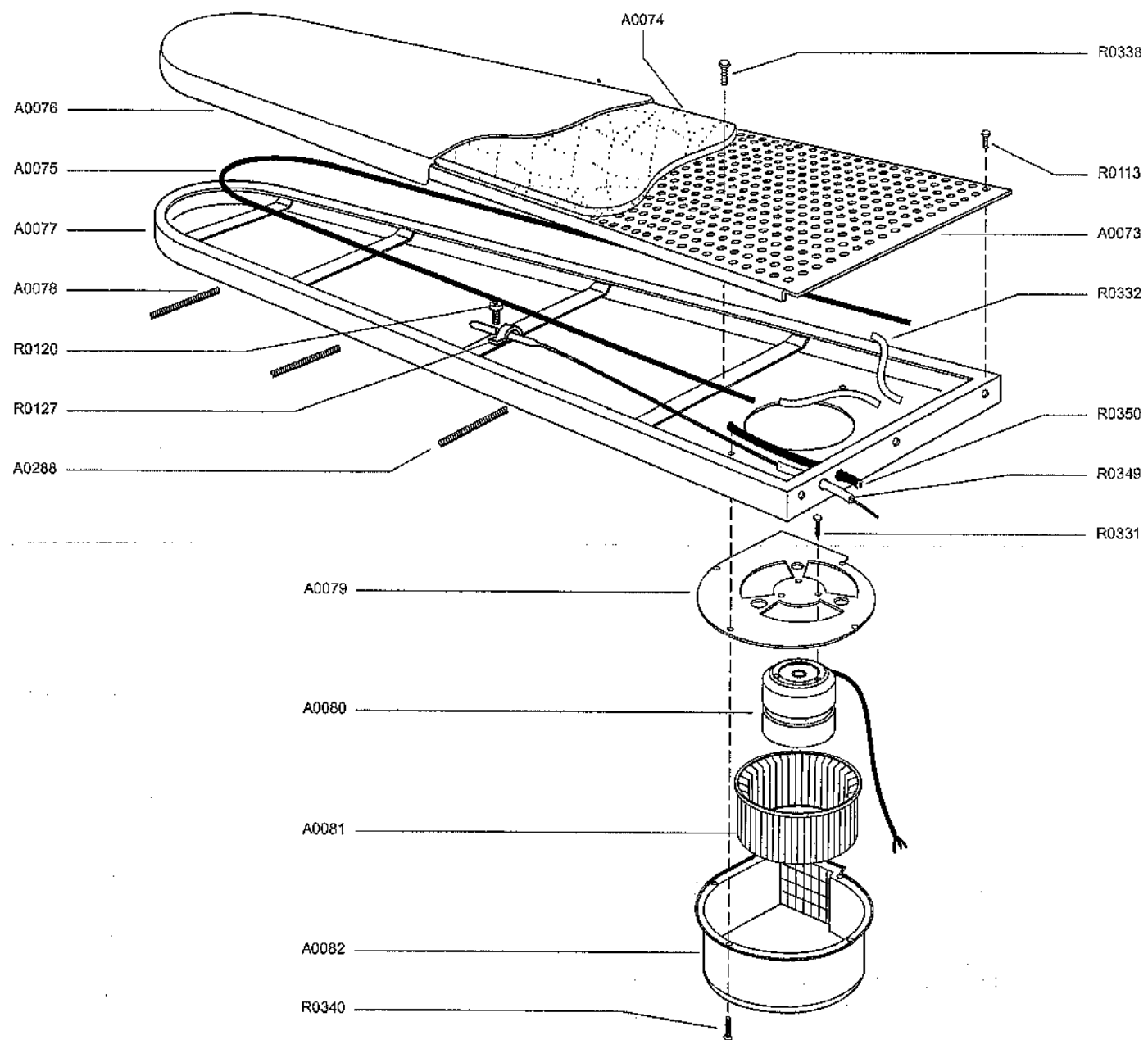

REF.	DESCRIPTION	Q*
A0073	HOLED PLATE	1
A0074	FELT	1
A0075	HEATING ELEMENT	1
A0076	COVER	1
A0077	BOARD	1
A0078	COVER-STRETCHING SPRING	2
A0079	FLANGE	1
A0080	SUCTIONING MOTOR	1
A0081	FAN	1
A0082	FAN CASE	1
A0288	SPRING	1
R0113	SCREW	12
R0120	SCREW	1
R0127	CABLE FASTNER	1
R0331	SCREW	3
R0332	SHEATH	2
R0338	SCREW	3
R0340	SCREW	4
R0349	SHEATH	1
R0350	SHEATH	1

*PIECES PER UNIT (IN THIS VIEW)

N.B. The above view is intended as a pure indication. It serves to show all the component parts of the unit to make any service easier.

ComelRICAMBI

SUCTIONING BOARD VIEW

(STANDARD) COMELUX

15/06/2001

ITAV-0538

DESCRIPTION

TYPE

LAST CHANGE DATE

VIEW REF.

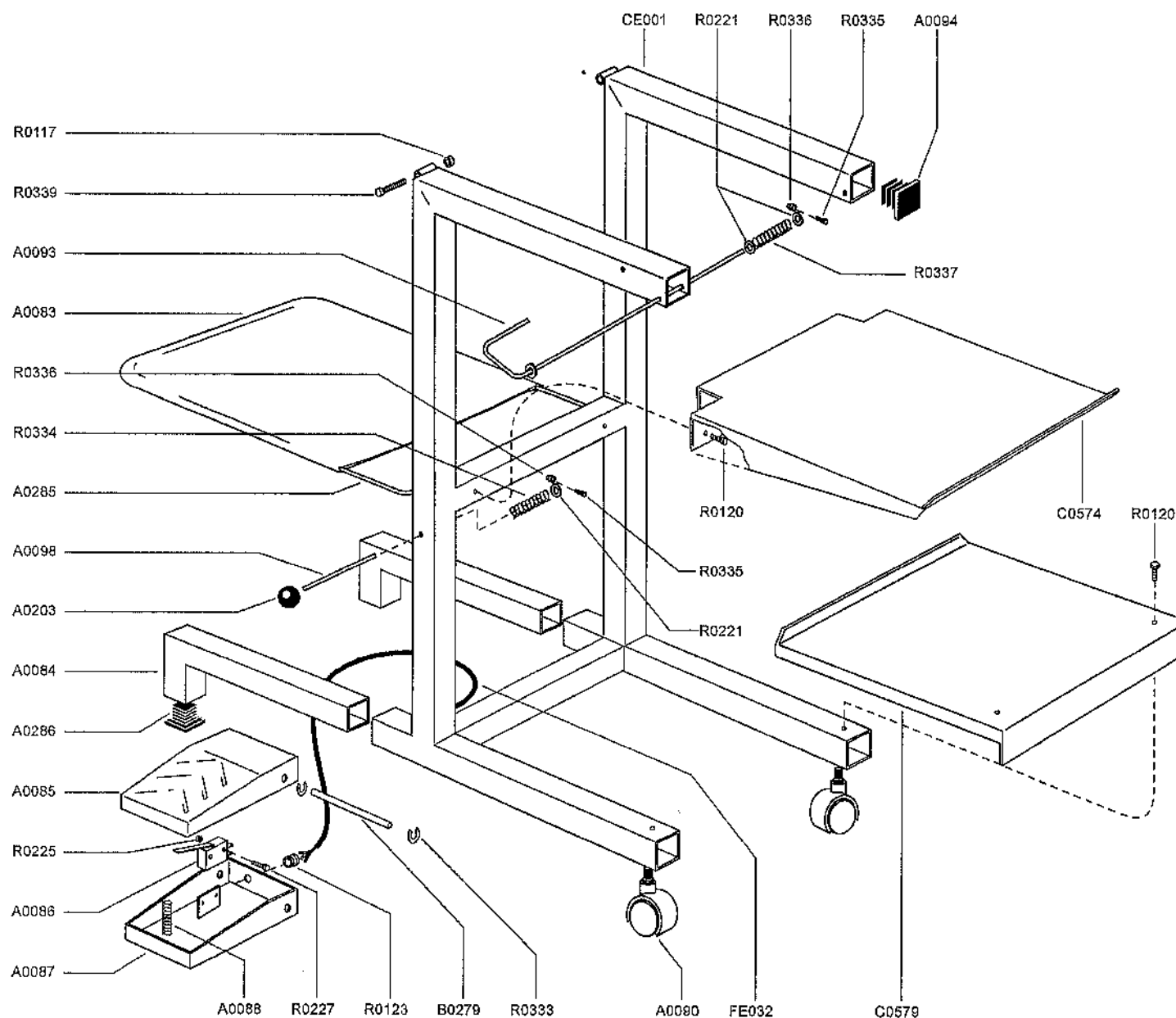

REF.	DESCRIPTION	Q*
A0083	UNDERCOVER TRAY	1
A0084	SLIDING FOOT	2
A0085	PEDAL UPPER PART	1
A0086	MICRO SWITCH	1
A0087	PEDAL LOWER PART	1
A0088	SPRING	1
A0090	CASTOR	2
A0093	HORIZONTAL BLOCKING ROD	1
A0094	BLANKING CAP	2
A0098	UPRIGHT BLOCKING ROD	1
A0203	KNOB	1
A0285	FRAME FOR UNDERCOVER TRAY	1
A0286	BLANKING CAP	2
B0279	PEDAL ROD	1
CE001	BOARD FRAME	1
C0574	UPPER TRAY	1
C0579	LOWER TRAY	1
F0032	FLEX	1
R0117	NUT	2
R0120	SCREW	4
R0123	FLEX TIGHTENING RING	1
R0221	WASHER	3
R0225	NUT	2
R0227	SCREW	2
R0333	SEIGER	2
R0334	SPRING	1
R0336	SCREW	2
R0336	NUT	2
R0337	SPRING	1
R0339	SCREW	2

*PIECES PER UNIT (IN THIS VIEW)

N.B.The above view is intended as a pure indication. It serves to show all the component parts of the unit to make any service easier.

Cornel R I C A M B I

BOARD FRAME DETAILED VIEW

(STANDARD) COMELUX

26/10/1999

ITAV-0191

DESCRIPTION

TYPE

LAST CHANGE DATE

VIEW REF.

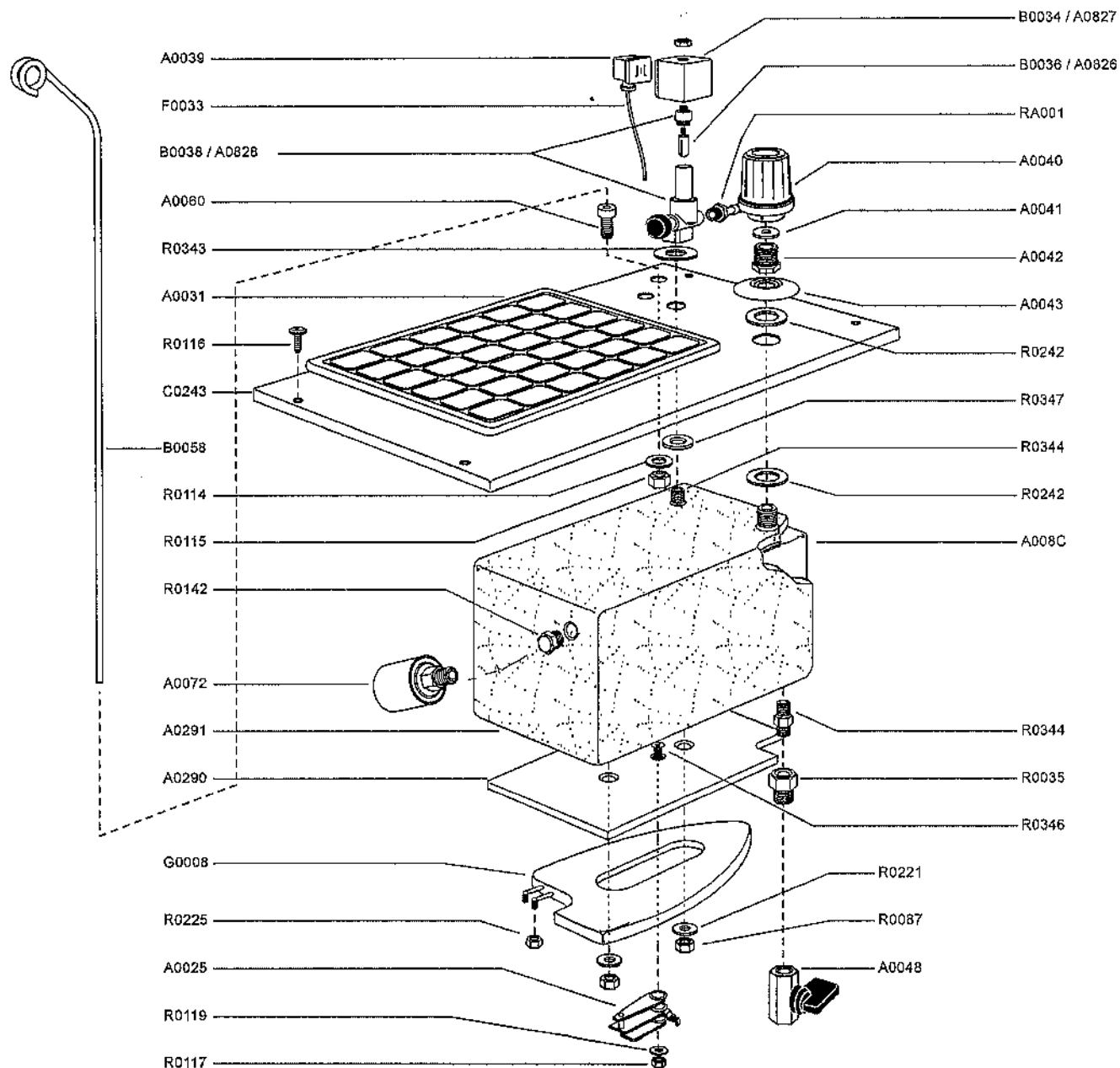

REF.	DESCRIPTION	Q**
A008C	INOX BOILER	1
A0025	THERMOSTAT	1
A0031	IRON MAT	1
A0039	CONNECTOR	1
A0040	FILLING TOP	1
A0041	WASHER	1
A0042	FITTING	1
A0043	WASHER	1
A0048	TAP	1
A0080	HOSE STAND SUPPORT	1
A0072	PRESSURE SWITCH	1
A0290	ALUMINIUM PLATE	1
A0291	BOILER INSULATION	1
A0395*	COMPLETE STEAM VALVE	1
A0825*	COMPLETE STEAM VALVE	1
A0826*	PLUNGER	1
A0827*	STEAM VALVE COIL	1
A0828*	STEAM VALVE CORE	1
B0034*	STEAM VALVE COIL	1
B0036*	PLUNGER	1
B0038*	STEAM VALVE CORE	1
B0058	HOSE STAND	1
C0243	PANEL	1
F0033	FLEX	1
G0008	HEATING ELEMENT	1
RA001	FITTING	1
R0035	FITTING	1
R0087	NUT	2
R0114	WASHER	1
R0115	NUT	1
R0116	SCREW	4
R0117	NUT	1
R0119	WASHER	1
R0142	FITTING	1
R0221	WASHER	2
R0225	NUT	2
R0242	WASHER	2
R0343	WASHER	1
R0344	FITTING	2
R0346	SCREW	1
R0347	WASHER	1

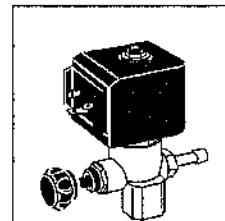

Ref. A0395
COMPLETE STEAM VALVE WITH BLUE COIL

It includes the following component part: B0034, B0036, B0038

*N.B. Please check which type of steam valve your unit is fitted with, before ordering its component parts

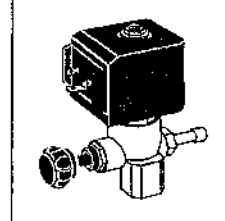

Ref. A0825
COMPLETE STEAM VALVE WITH BLACK COIL

It includes the following component part: A0826, A0827, A0828

*N.B. Please check which type of steam valve your unit is fitted with, before ordering its component parts

**PIECES PER UNIT (IN THIS VIEW)

N.B. The above view is intended as a pure indication. It serves to show all the component parts of the unit to make any service easier.

Cornel R I C A M B I

2LT BOILER

C BOILER

15/01/2010

ITAV-0196B

DESCRIPTION

TYPE

LAST CHANGE DATE

VIEW REF.

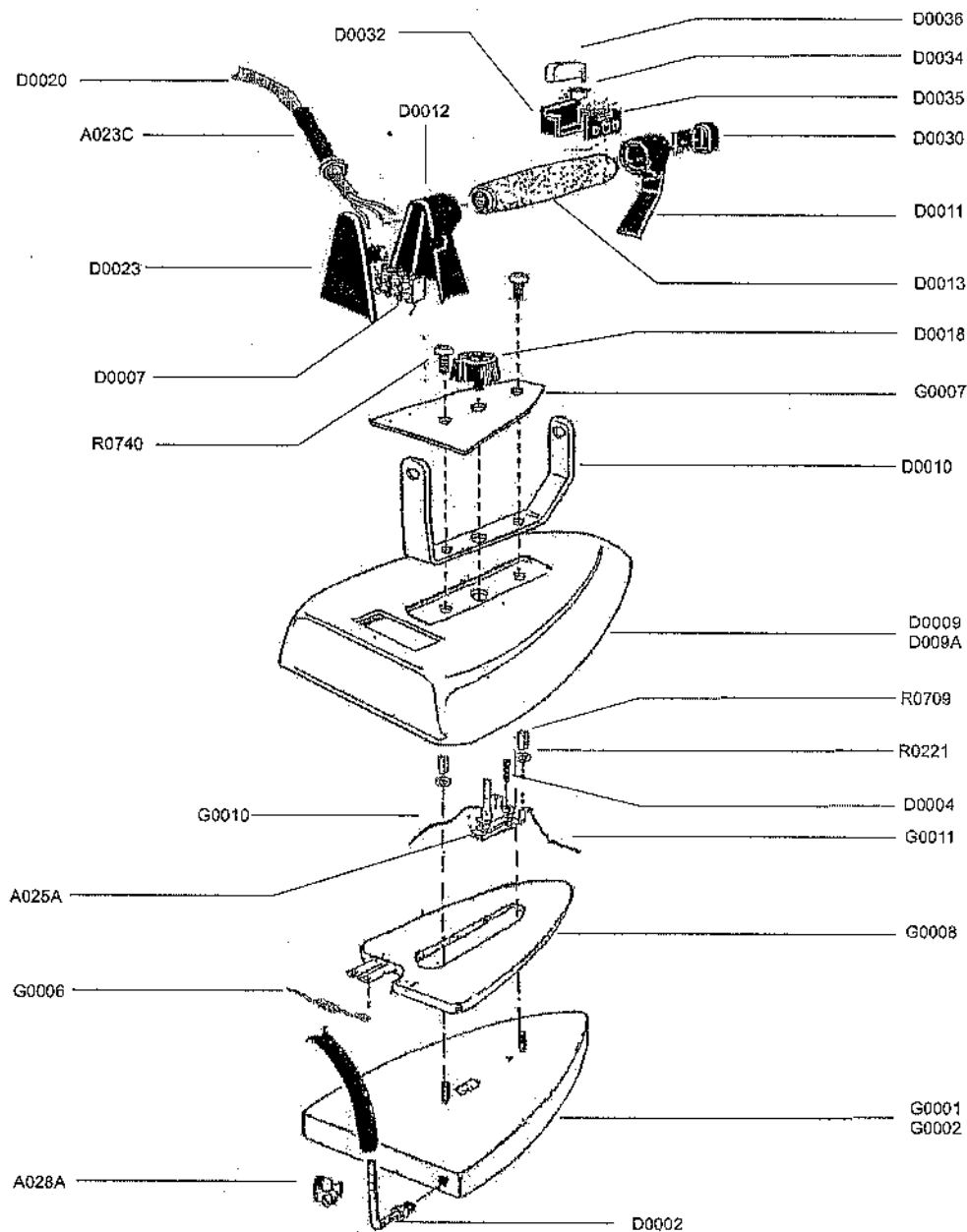

REF.	DESCRIPTION	Q
A023C	STEAM HOSE SLEEVE	1
A025A	THERMOSTAT	1
A028A	STEAM HOSE CLAMP	1
D0002	STEAM HOSE ELBOW	1
D0004	SCREW	2
D0007	JUNCTION BOX	1
D0009	SMALL CHROMIUM-PLATED COVER	1
D009A	BIG CHROMIUM-PLATED COVER	1
D0010	CHROMIUM-PLATED BRACKET	1
D0011	FRONT HANDLE SUPPORT	1
D0012	BACK HANDLE SUPPORT	1
D0013	CORK HANDLE	1
D0018	MARKED TAG	1
D0020	FLEX	1
D0023	BACK CAP	1
D0030	FRONT CAP	1
D0032	MICRO SWITCH HOLDER	1
D0034	MICROSWITCH	1
D0035	SPACING TAG	1
D0036	RED PUSH BUTTON	1
G0001	SMALL IRON BASE	1
G0002	BIG IRON BASE	1
G0006	THERMAL CUT-OUT	1
G0007	MARKED TAG	1
G0008	HEATING ELEMENT	1
G0010	WIRE	1
G0011	WIRE	1
R0221	WASHER	2
R0709	SPACING TAG	2
R0740	SCREW	2

* PIECES PER UNIT (IN THIS VIEW)

N.B. The above view is intended as a pure indication. It serves to show all the component parts of the unit to make any service easier.

Cornel R I C A M B I

IRON TYPE MOD.721
PAB - GAB

COMPONENT PARTS

20/01/2006

IFER-0014

DESCRIPTION

TYPE

LAST CHANGE DATE

VIEW REF.

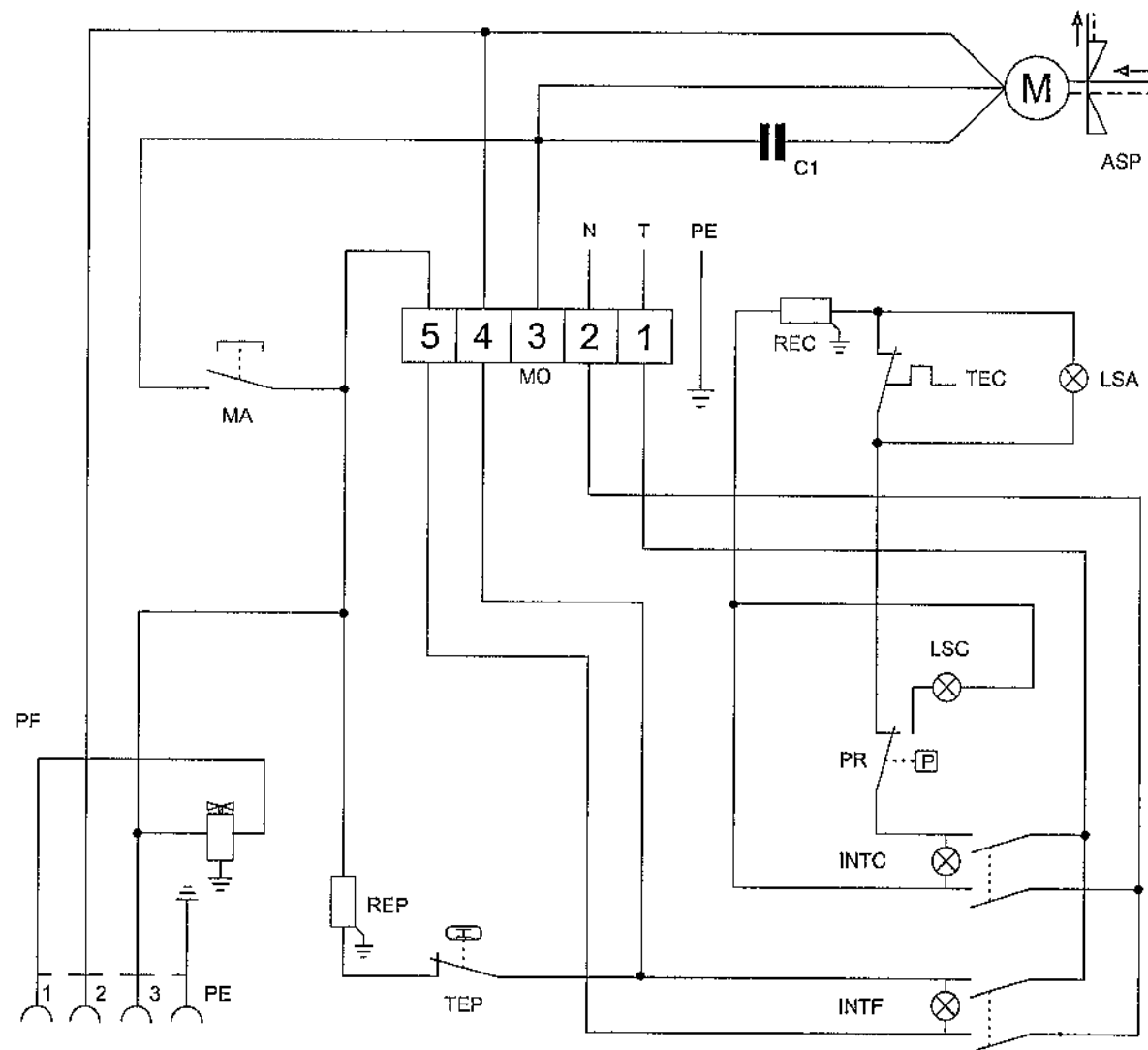

REF. DESCRIPTION

INTF	IRON ON/OFF SWITCH
INTC	BOILER ON/OFF SWITCH
TEP	BOARD THERMOSTAT
REP	BOARD HEATING ELEMENT
PF	IRON SOCKET
PR	PRESSURE SWITCH
LSC	STEAM WARNING LIGHT
MA	PEDAL MICROSWITCH
MO	CLAMP
REC	BOILER HEATING ELEMENT
TEC	BOILER THERMOSTAT
LSA	WATER WARNING LIGHT
C1	CONDENSER
ASP	SUCTIONING MOTOR
N	NEUTRAL WIRE
T	LIVE WIRES
PE	EARTH

ComelELETTRICO

WIRING DIAGRAM

COMELUX - FUTURA
- SUPERBA C

26/10/1999

ISE-0054

DESCRIPTION

TYPE

LAST CHANGE DATE

VIEW REF.