



LED Panel Light, Backlit with PIR Sensor Base

Pre-Select 3 Wattage
Pre-Select 3 CCT 3500K-4000K-5000K

SKU#123000
123001
123002

Available Sizes

- 2x2(602x602x30mm)
- 2x4(602x1209x30mm)
- 1x4(298x1209x30mm)

PIR Sensor Base



Features

- DLC 5.1 Premium Certified
- Optional PIR motion sensor which can automatically switch on/off based on ambient light and human motion.
- 5 years warranty.

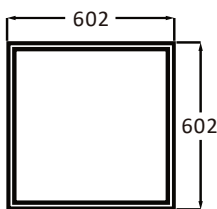
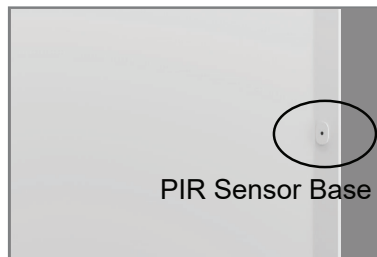

602*602mm

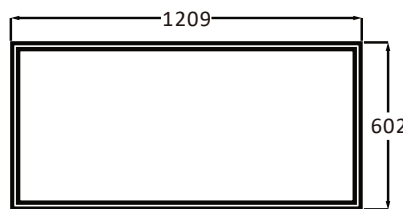

602*1209mm

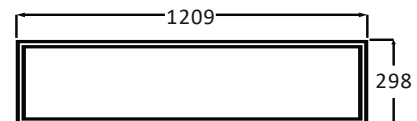

298*1209mm

Product Parameter

Model	2x2	1x4	2x4
Wattage(W)	25-30-40w Selectable	30-40-50w Selectable	30-40-50w Selectable
Efficacy(lm/w)	125lm/W	125lm/W	125lm/W
Colour Temp(K)	3500-4000-5000K selectable	3500-4000-5000K selectable	3500-4000-5000K selectable
CRI	>80		
Voltage	120-347V		
PF	>0.9		
Beam angle	110°		
Working Temperature	-25°C ~ +40°C (-13°F ~ +104°F)		
Relative Humidity	10%-90%RH		
Gross weight	2.0kg	2.3kg	4.1kg
Carton size	L662xW185xH667mm 4PCS/CTN	L1269xW185xH363mm 4PCS/CTN	L1269xW185xH667mm 4PCS/CTN

• Surface Mounted Frame

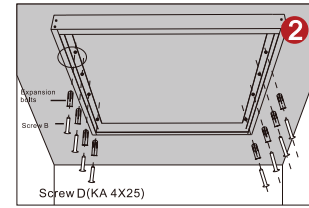
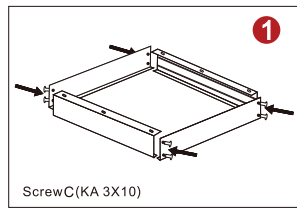
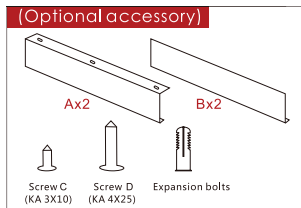

1. Assemble the four frames with Screw C to a whole square

2. Fix the square frames to the ceiling with Screw D

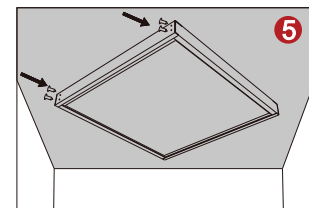
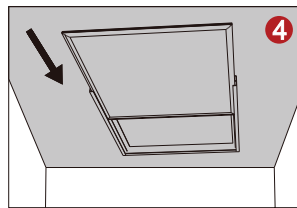
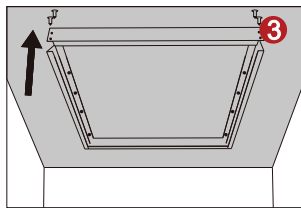

3. Demount one frame

4. Put the panel into the frame square.

5. Fix the last frame with screw C.

• Recessed Frame

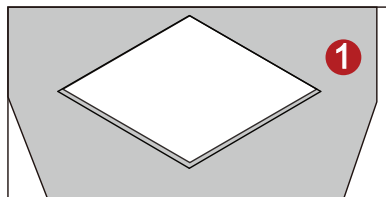

1. Open a hole on the ceiling

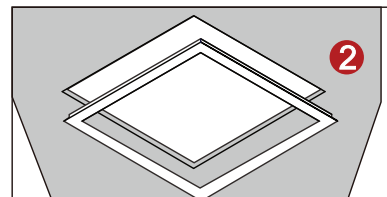

2. Fix the frame to the hole

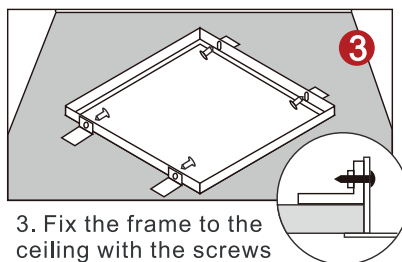

3. Fix the frame to the ceiling with the screws and "L" accessory

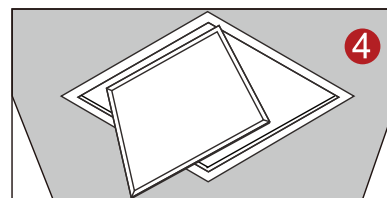

4. Put the panel into the frame

• Wiring Diagram

