

## Sure Seal™ Shower Tray Installation Instructions

1. Ensure that the walls are plumb and square. The bottom plates must be square to each other to allow the tray to sit in its correct position. For Alcove three sided showers we recommend building the third wall once the tray is onsite to ensure the correct opening is achieved
2. We recommend adding additional studs into the wall that finish flush with the tray ends, this gives the shower installer a solid fixture to screw his Door set into and eliminates the need for wall anchors  
Install a horizontal batten to the bottom plate to support the Gib board's lower edge when cut

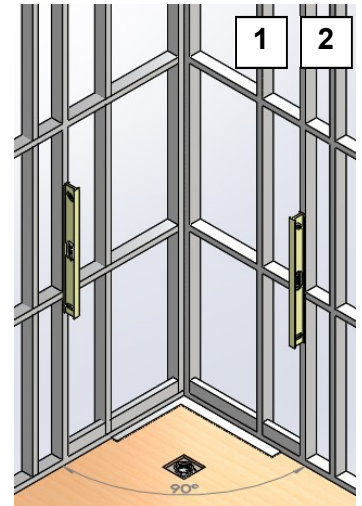

3. Ensure the floor is level  
A Useful Guide  
For every millimetre the tray is out of level, adjustment of the enclosure will be reduced by 2mm.  
e.g. if the tray is 5mm out of level there may be no adjustment left to accommodate out of plumb walls.

### **If the floor is not level**

- Concrete floors - level using a leveling compound available from most flooring outlets.
- Wood floors - Sand or level using a leveling compound

4. Have a qualified plumber install the shower fittings and the waste

### **IMPORTANT:**

- **Hole cut out for waste must not exceed 170mm square**
- **Concrete floors must be back filled around the waste area particularly where any additional cuts in the concrete. (use concrete or a similar solid fill material)**

5. Line the framing with 10mm virgin Gib board or an equivalent plaster board to the suppliers recommendations. If installing a 3 sided shower tray it is recommended to line the walls after the tray is installed (Villa board is also an acceptable wall substrate)

### **DO NOT**

**Gib Stop, sand, seal or paint the wallboard surface as this will affect the adhesion of the acrylic wall liner**

6. Place the shower tray against the Gib board. Scribe a pencil line on the Gib board 5mm above the tray. Scribe a pencil line directly down the front as the tray will be rebated back under the plasterboard

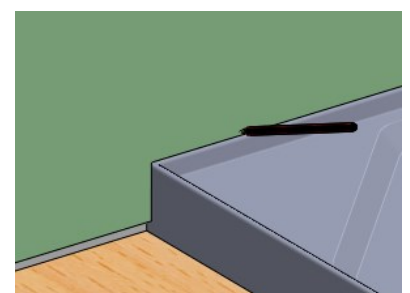
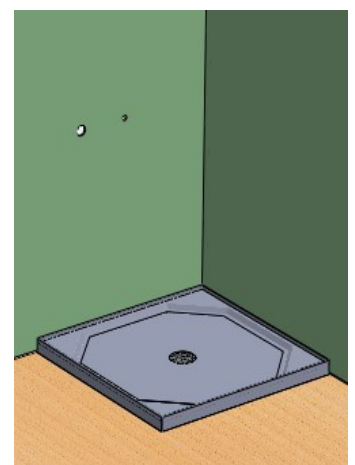
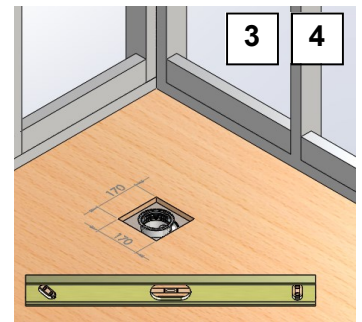

7. Remove the tray and cut out the rebate in the Plasterboard

### Pre-installation checks

8. Check that the tray is level, if not correct before progressing any further

#### **DO NOT**

- Under any circumstance pack the perimeter of the tray to level
- Lay tiles or vinyl under the tray area
- Use expanding foams to support the tray, these are of low density and will collapse over time
- Modify the tray in any way

**Warranty will be voided if the shower tray is not correctly supported**

9. Place the tray back into the recess checking ensure that the waste outlet will align with the waste body already installed into the floor
10. Check to that the tray's upstand front face does not protrude further than the Gib board surface. (this could be a result of the walls not being set 90° to each other) If the upstand does protrude further than the Plasterboard surface the tray will need to be rebated into the bottom plate
11. Sweep the immediate area where the tray will be installed to ensure it is free from any dust or contaminants

### Installation

12. The tray is supplied with a clear protective film to prevent surface damage. Remove the film from the upstand and waste area leaving the film intact on the remainder of the tray. This will protect the surface until installation is complete.
13. Apply a bead of Silicone sealant to the face of the Bottom plates. This will prevent the possibility of any squeaking.
14. Using the supplied Showerbond adhesive apply a generous bead to each of the support rings on underside of the tray.
15. Within 15 minutes place the tray into its final position & push down lightly to set in place

#### **IMPORTANT**

- Do not place any weight on the tray as this will cause the adhesive to be dislodged from under the support rings and compromise adhesion
  - Do not stand on the tray until the Showerbond has cured (approx 24hrs).
16. Install the easy clean waste as per the instructions provided with the waste (This must be fitted by a qualified plumber)

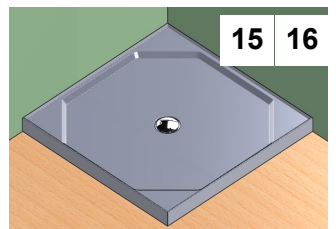
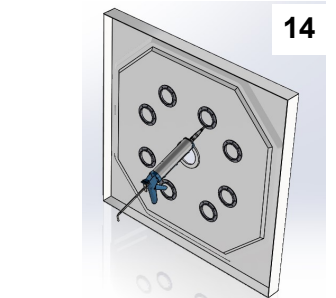
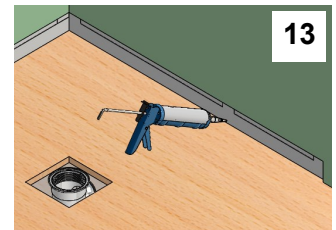
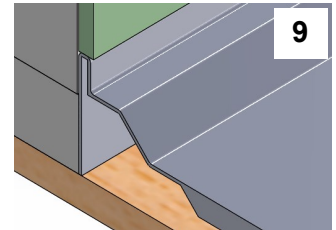
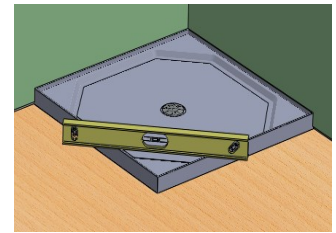
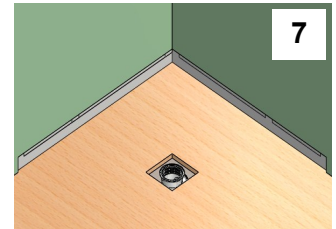

Clearlite Bathrooms  
54-58 Hillside Rd  
Glenfield  
Auckland  
Ph (09) 4443780  
info@clearlite.co.nz  
Clearlite.co.nz