

USING METOD FOR BATHROOMS GUIDE

We love the functionality of IKEA's Metod series for kitchens, but we don't believe that the sturdy cabinets are limited to just one area of the home. They're also great for laundry rooms, bathrooms or anywhere that you need great modular storage.

This guide offers helpful tips for using Metod frames in the bathroom. You can view example vanity configurations along with associated price indications [here](#).

- The Metod series has cabinets designed specifically for sinks and plumbing, so be sure to select the **base cabinets for sinks** wherever you plan to have washbasins.
- You can use the **base cabinets for sinks** in 37 or 60cm depths. Note however that the IKEA planner does not offer drawers as an option below the sink in the 37cm deep frame. Bear in mind also that the 37cm cabinet will require a small, narrow basin.
- When planning your basin style, keep in mind that base cabinets for sinks with shelves and doors allow more space for a drop-in or undermount basins.
- If you select **base cabinets for sink** with drawers in 60cm depth, then the IKEA planner automatically suggests a drawer configuration to allow room for the siphon to pass through. Keep in mind that above-counter / overmount basins tend to be the better option with drawers.
- The 40cm tall drawers obviously allow more space for plumbing under the sink, however if you select the 20cm high drawer front at the top of your bathroom vanity, you will need to ensure that you have sufficient space available for the plumbing. Furthermore, to assist with maximum space allowance, the 20cm high drawers must be mounted on IKEA's lowest drawer runner, named Maximera Low. You CANNOT use the drawers named Maximera Middle or High that you might normally use for a 20 cm high drawer.
- A 10cm high drawer can not be functional in the top drawer position of the bathroom vanity. It can however be placed in that position as a dummy (non-opening) drawer.
- Refer to our drawings below for visual illustration of the two frames depths and space required for plumbing.

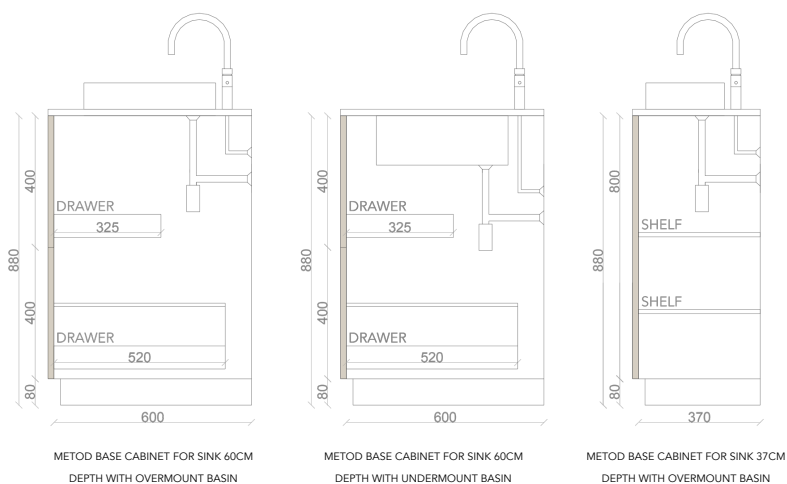

All measurements displayed in millimetres.

USING METOD FOR BATHROOMS GUIDE

- Metod Cabinets are sturdy and mounted to either the wall or floor (for islands). This allows you to use stone / marble countertops with ease. For more stability, you can also add wooden or metal support frames around the sink.
- Measurements for your stone/quartz countertop should be taken after all of the doors, sides and other Fronteriors components have been installed.
- If you are installing a natural or quartz built in basin, you will need to be aware that the base cabinets have a metal structure that holds the frame together. This would need to be accounted for in the measurements for a custom basin.

YOU WILL NEED FROM IKEA

- Base cabinet frames
- Metod 8cm legs and plinths
- Hinges
- Suspension rails
- Internal shelves and/or drawer fittings, as required

For detailed assembly information, please have a look at our Metod Installation Guide [here](#).

You can plan your Metod vanity with the IKEA planning tools on their website. Once you have your plan ready, send it over to us on info@fronteriors.co with your desired design, color and hardware options. We can make a proposal and a quote for you once we have this information. You can also shop independently online [here](#).