

## USE WITH PROVIDED HARDWARE

Arrange pieces as shown and attach to the camera body using the included screw and Allen wrench.

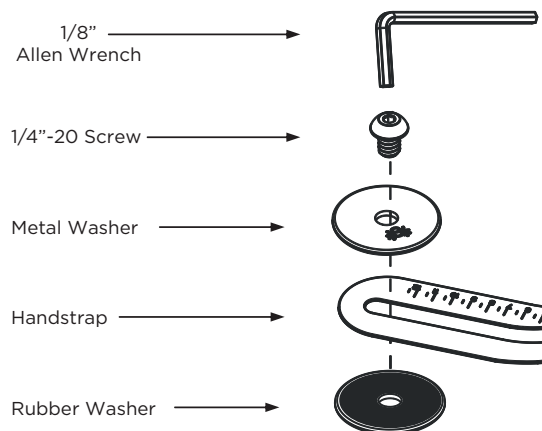

### IMPORTANT:

The rubber washer must be underneath the SpiderPro Handstrap to prevent rotation.

The 1/4"-20 screw should be checked regularly to ensure that it is tightened adequately.

## USE WITH SPIDER PIN

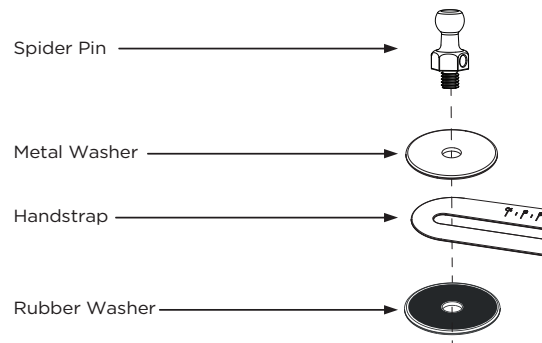

### IMPORTANT:

Spider Pin must be tightened with provided wrench. Spider Pin should be checked regularly to ensure that it is tightened adequately.

## USE WITH SPIDER PLATES

Spider Camera Plates attach to the universal tripod connection on the bottom of your camera.

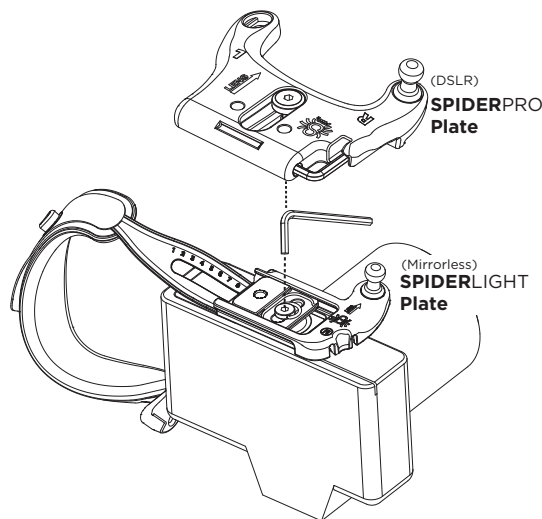

## USE WITH TRIPOD PLATES

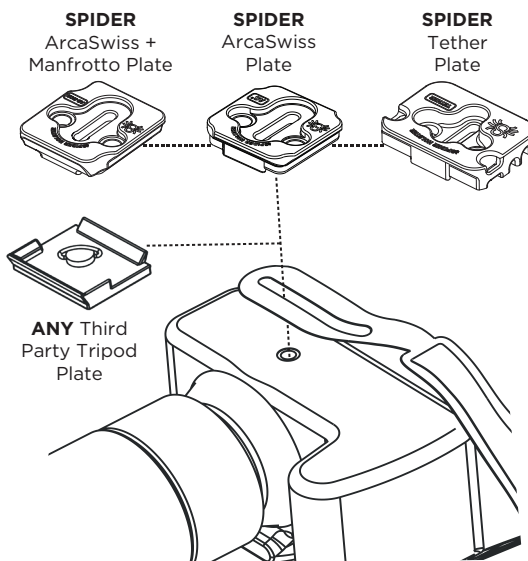

### IMPORTANT:

All tripod plates should be checked regularly to ensure that they are properly tightened.

## USE WITH SLING/SWIVEL STRAPS

Arrange parts as shown and attach to the camera body.

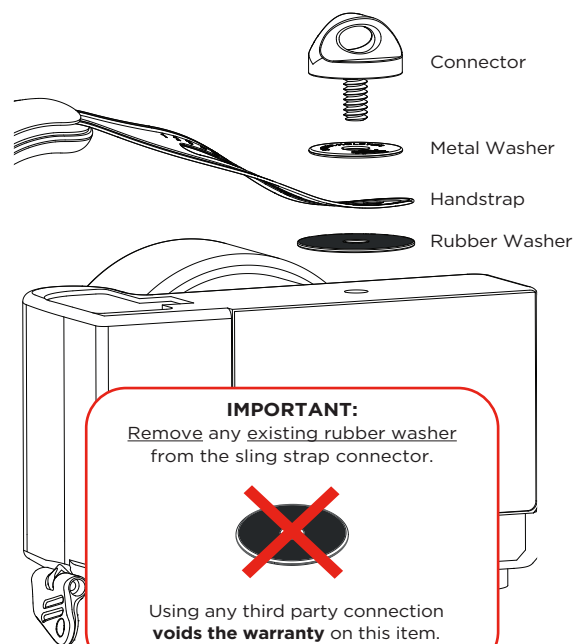

Do not use the SpiderPro Hand Strap as a handle for grabbing or carrying your camera.

Improper use can lead to damage of this product and/or your equipment. Read all instructions carefully, and watch the installation and setup video on our website.



## MORE INFORMATION ONLINE

Visit our website at the link below:

[SPIDERHOLSTER.COM/SPIDERPRO-HANDSTRAP-V2](https://spiderholster.com/spiderpro-handstrap-v2)



## SPIDERPRO HAND STRAP v2

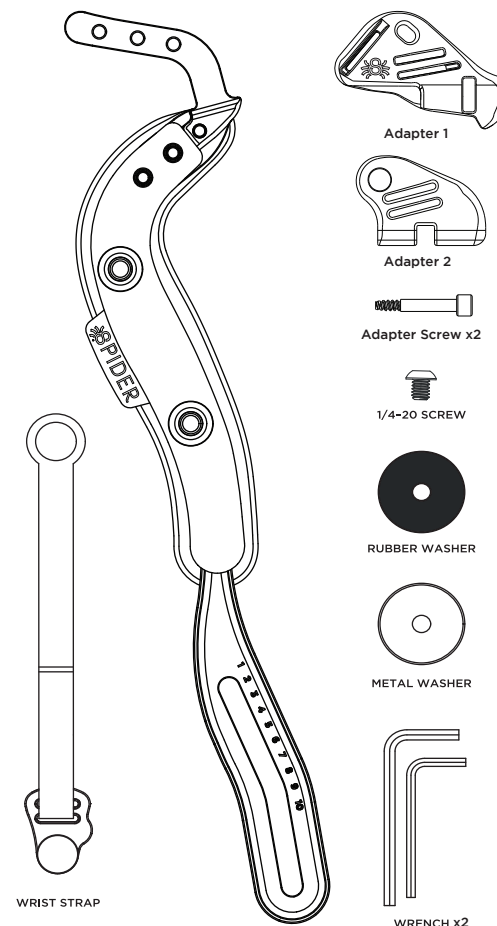

## SLOT CONNECTION

1. Insert the hand strap through the slot and fold.

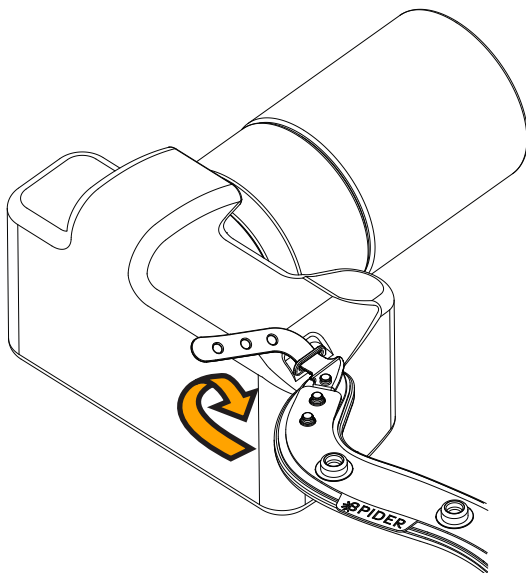

2. Match the snap features and click into place.

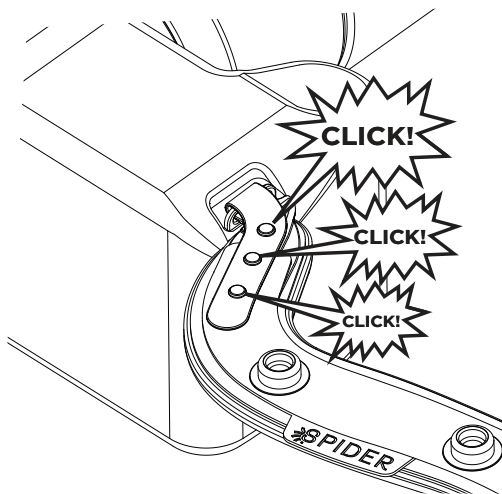

## EYELET CONNECTION

For camera utilizing an eyelet connection, install one of our provided adapters.



### Eyelet Adapter 1

Designed for smaller cameras with mirrorless style body ergonomics.



### Eyelet Adapter 2

Designed for larger cameras with DSLR style bodies.

**NOTE:** Each adapter was crafted to best suit a specific style of camera body, but they are interchangeable. Choose the best fit for your camera.

### Eyelet Adapter Installation

Remove triangle. Place adapter over the camera's eyelet and use the smaller 5/64" allen wrench to tighten the adapter screw.

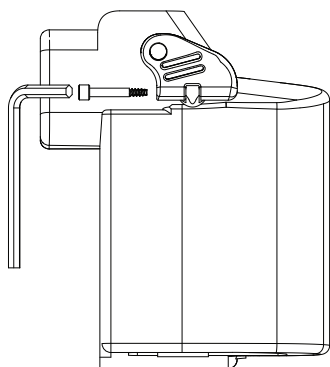
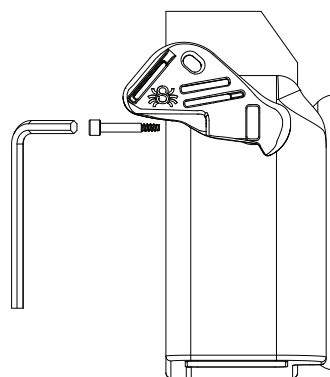

## EYELET ADAPTER 1 CONNECTION

### Top Slot

Allows for more room for your hand to access camera controls.

### Bottom Slot

Install handstrap here for a tighter fit on your hand.

Insert handstrap through slot A and back through slot B.

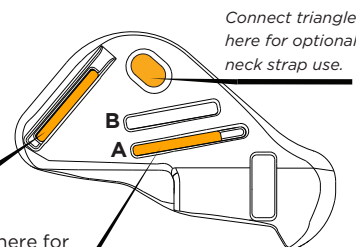

1. Insert the hand strap through the adapter slot and fold.

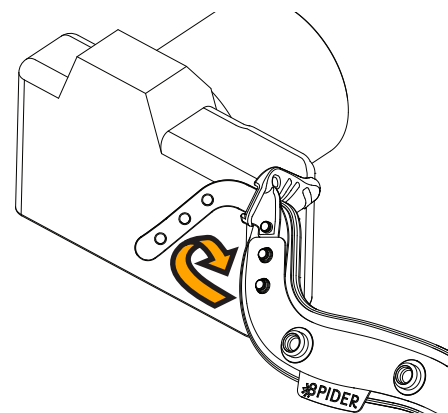

2. Match the snap features and click into place.

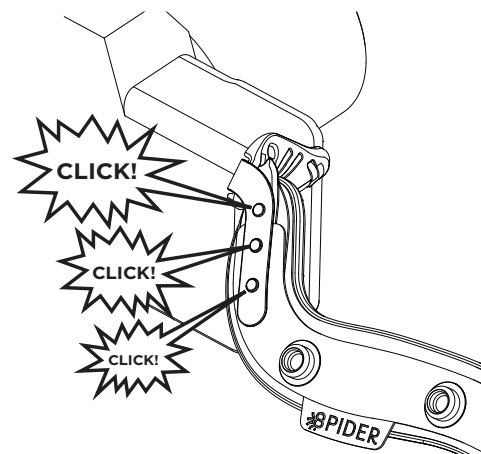

## WARRANTY INFORMATION

Spider Gear LLC., ("Spider Gear") warrants this products against defects in material or workmanship for a period of one (1) year from the original date of purchase of the product. Pursuant to this Limited Warranty, Spider Gear will, at its option, (i) repair the product using new or refurbished parts or (ii) replace the product with a new or refurbished product. In the event of a defect, these are your exclusive remedies. For purposes of this Limited Warranty, "refurbished" means a product or part that has been returned to its original specifications.

This Limited Warranty only covers product issues caused by defects in material or workmanship during ordinary consumer use; it does not cover product issues caused by other reason, including but not limited to product issues due to commercial use, acts of God, misuse or modification of or to any part of the Spider Gear Product. Scratches, blemishes, discolorations, etc, produced by ordinary wear-and-tear are excluded.

The warranty provided is for repair or replacement of the product only. Any parts or products replaced under this Limited Warranty will become the property of Spider Gear.

**LIMITATIONS ON DAMAGES:** SPIDER GEAR SHALL NOT BE LIABLE FOR ANY DIRECT, INDIRECT, INCIDENTAL, SPECIAL, OR CONSEQUENTIAL DAMAGES FOR BREACH OF ANY EXPRESS OR IMPLIED WARRANTY OR CONTRACT OR TORT CLAIM ON THIS PRODUCT.

**DURATION OF IMPLIED WARRANTIES:** EXCEPT TO THE EXTENT PROHIBITED BY APPLICABLE LAW, ANY IMPLIED WARRANTY OF MERCHANTABILITY OR FITNESS FOR A PARTICULAR PURPOSE ON THIS PRODUCT IS LIMITED IN DURATION TO THE DURATION OF THIS WARRANTY.

Some states do not allow the exclusion or limitation of incidental or consequential damages, or allow limitations on how long an implied warranty lasts, so the above limitations or exclusions may not apply to you. This Limited Warranty gives you specific legal rights and you may have other rights which vary from state to state.

For specific instructions on how to obtain warranty service for your product, visit <https://www.spiderholster.com> or email us at "hello@spiderholster.com"

**U.S. AND INTERNATIONAL PATENTS PENDING  
COPYRIGHT ©2019 SPIDER GEAR LLC.  
ALL RIGHTS RESERVED.**